

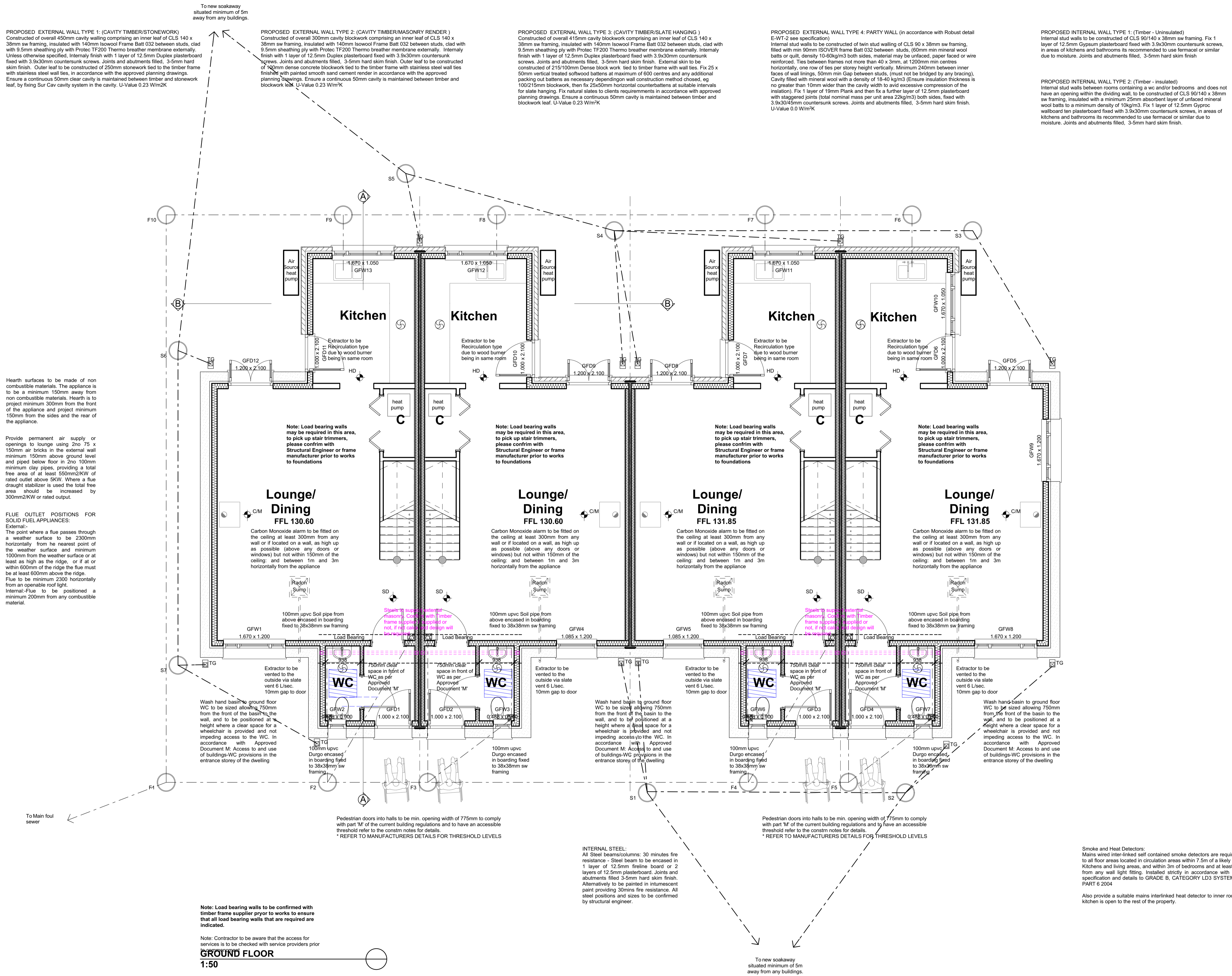

Notes:

Rev.	Description	Drawn	Date
A	Various changes following BBS plan check report	JCV	13/7/15
B	Change of heating system, and adjustment to thermal elements to match revised SAP	JCV	20/7/15



Rev.	Description	Drawn	Date
A	Various changes following BBS plan check report	JCV	13/7/15
B	Change of heating system, and adjustment to thermal elements to match revised SAP	JCV	20/7/15

laurence associates  
 planning | architecture | landscape

Lander House, May Court  
 Three Milestone Business Park  
 Truro, Cornwall TR4 9LD  
 t: +44 (0) 1872 225 259  
 e: hello@laurenceassociates.co.uk  
 w: www.laurenceassociates.co.uk

Project Title:	
PROPOSED RESIDENTIAL DEVELOPMENT	
Project Address:	
LEAT ROAD PENDEEN CORNWALL	
Client:	
GOLOWJI LTD	
Drawing Title:	
GROUND FLOOR PLAN	
Scale:	Drawn:
1:50@A1	JCV
Date:	Checked:
8/7/15	JP
Drawing No:	Rev.
14097.103	B