

Alecto Video Door System

2-wire Series

Installation and User Manual



Digital Touch Screen 7 inch Monitor

PRECAUTIONS

- Read this manual through before using the product
- Slots or openings in the back of the monitor, are provided for ventilation and to ensure reliable operation of the video monitor or equipment and to protect it from overheating. These openings must not be blocked or covered. The monitor should never be placed near or over a radiator or heat register and should not be placed in a built-in installation such as a bookcase unless proper ventilation is provided
- All parts should be protected from violence vibration. And not allow be impacting, knocking and dropping
- For clean the LCD screen, using hands or wet cloth is forbidden
- Please do the cleanness with soft cotton cloth, please do not use the organic or chemical clean impregnate. If necessary, please use pure water or dilute soap water to clean the dust
- Image distortion may occur if the video door phone is mounted too close to magnetic field e. g. Microwaves, TV, computer etc.
- Please keep away the video door monitor from wet, high temperature, dust, and caustic and oxidation gas in order to avoid any unpredictable damage
- Do NOT open the device in any condition, call the administrator for help if there is any problem or malfunction happens

CONTENT

1. Monitor Parts and Functions	4
2. Monitor Mounting	6
3. Main Menu	7
4. System Configuration	8
4.1 Entering Installer Setup	8
4.1.1 Entering Help page	8
4.1.2 Entering Address setting page	9
5. Monitor Setup Instructions	11
5.1 Date & Time Settings	11
5.2 Ring Tone Settings	11
5.3 Ring Volume Settings	12
5.4 Enabling/Disabling the Operational Sound	12
5.5 Naming Door Station & CCTV Camera	12
5.6 Monitoring Time Settings	13
5.7 Changing Language	14
5.8 Restoring to Factory Default Settings	14
5.9 Enable/Disable Intercom Function	15
5.10 Enabling/Disabling Motion Detection Function	15
5.11 Electric Lock Release Settings	17
6. Basic Operations	18
6.1 Answering a Door Call	18
6.2 Adjusting Colour, Brightness and Talk Volume	18
6.3 Pan-Tilt & Zoom	19
6.4 Intercom Between Monitors Function	20
6.5 Manual Monitoring	21
6.6 Pictures and Video Recording	22
6.7 SD Card Formatting.....	22
6.8 Copying Recordings onto SD Card	23
6.9 Pictures and Video Playback	23
6.10 Voicemail	24
6.11 Viewing Visitor's Voicemails	24
6.12 Viewing Call Records	25
6.13 SMS function	26
6.14 Call Divert Function	27
6.15 Setting divert number	27
6.16 Do Not Disturb	28
6.17 Operating Security Light	28
7. Changing Colour of LED on the Button	29
8. Specification	29

1. Monitor Parts and Functions

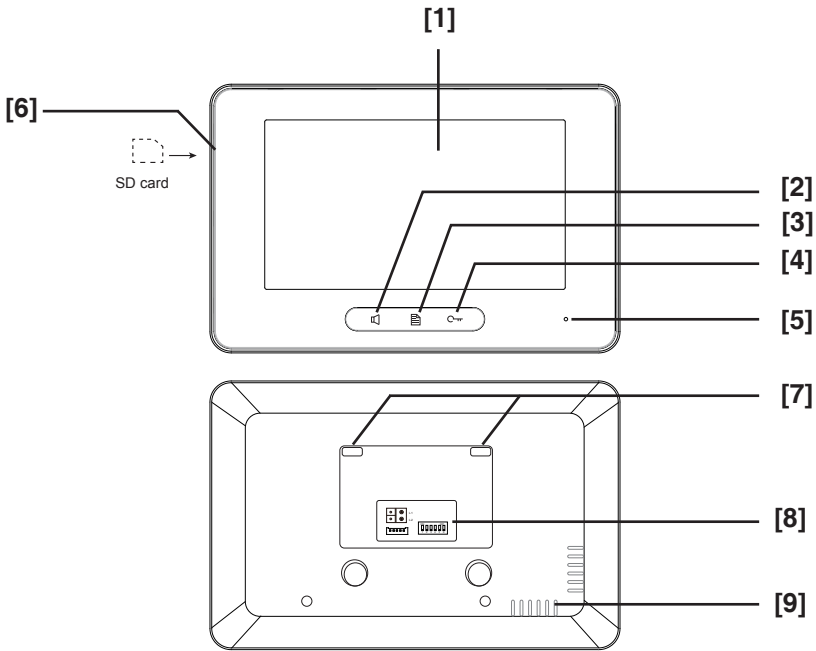

NO.	Item	Description
[1]	Digital LCD touch screen	Display visitors' image
[2]	Talk/Mon button	<ul style="list-style-type: none"> • Press to communicate hands free with visitor • Press to view outside the property in standby
[3]	Menu button	Press to open Main Menu
[4]	Unlock button	Press to Unlock door or gate
[5]	Microphone	Transmits the audio from door station
[6]	SD card slot	Use to insert micro-SD card
[7]	Mounting hook	Use to hang the monitor
[8]	Connection port	Bus connection terminal
[9]	Speaker	Visitors voice coming from speakers

1.1. Monitor Terminals

L1, L2: Bus line terminal

SW+,SW-: External Call button connection port

Ring,GND: External ringer connection port

NC: Not in use

DIP switches

- DIP1~DIP5: User Code setting
- DIP6: End of line setting. Set **ON** if the monitor is at the end of the line or if connected with DBC4

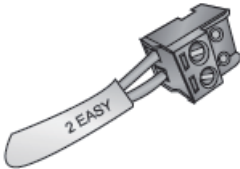
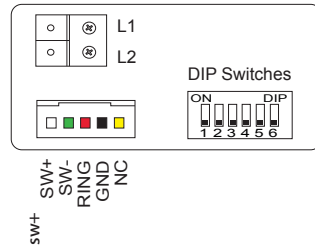
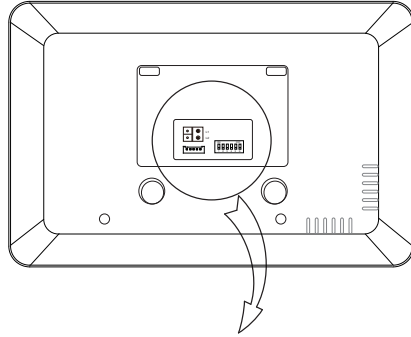

Additional Call Button

Additional call button can be connected to a monitor via terminals SW+ White and SW- Green wires.

Please note: There will be no video on the monitor when somebody rings this call button

Additional External Ringer

Additional external ringer can be connected to a monitors via terminals RNG Red wire to a Positive and GND Black wire to a Negative. One Ringer per monitor. Locate a ringer in a position where you are unlikely to hear the ringing of the monitors; like a garage, shed, or carport

2. Monitor Mounting

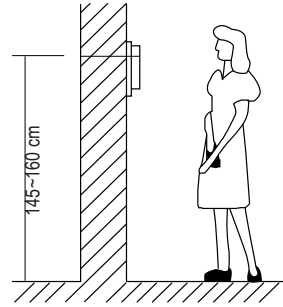
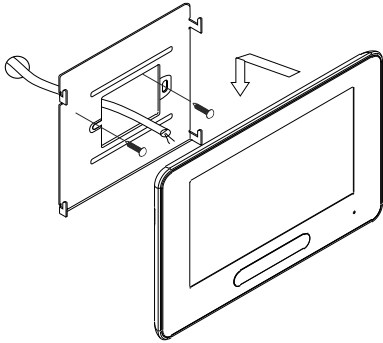

1. Use the screws to fix the mounting bracket on the wall
2. Hang the Monitor on the mounting bracket firmly

PARTS AND FUNCTIONS

Screen

Main Menu

The Main menu is your starting point for using all the applications of the monitor
 Touch screen anywhere and 'Main menu' will appear as following:

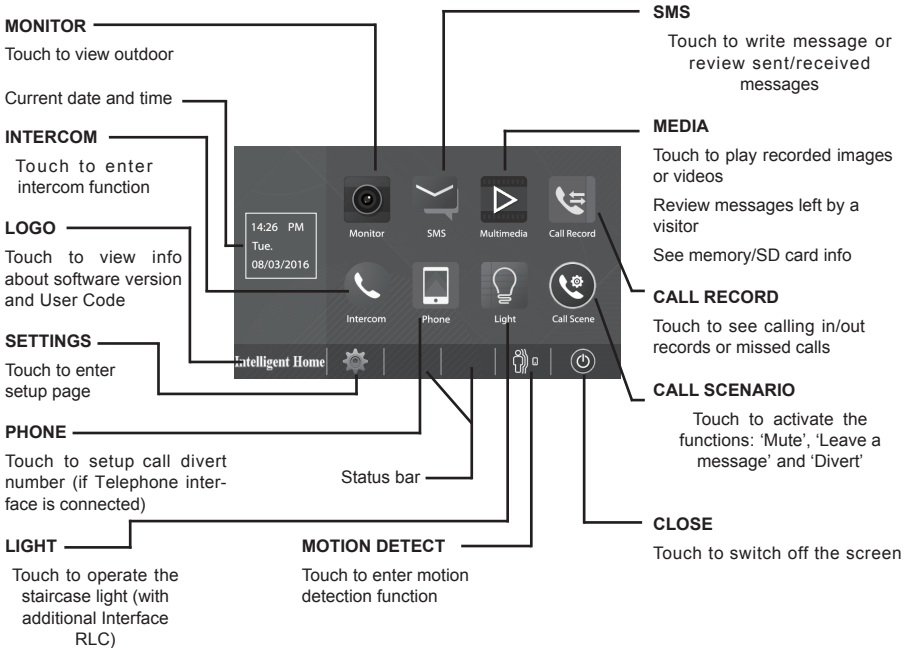

Icons Visible during Talking

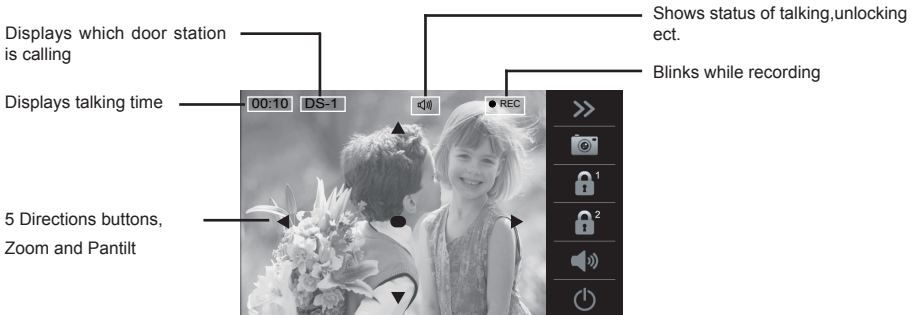

Note: The 5 directions operation only available with Fish-Eye Door Station

SYSTEM CONFIGURATION

Entering Installer Setup

- On the Main menu page touch [Logo] icon to enter About page
- Press and hold for 2 sec UNLOCK  button
- Digital keypad will be shown

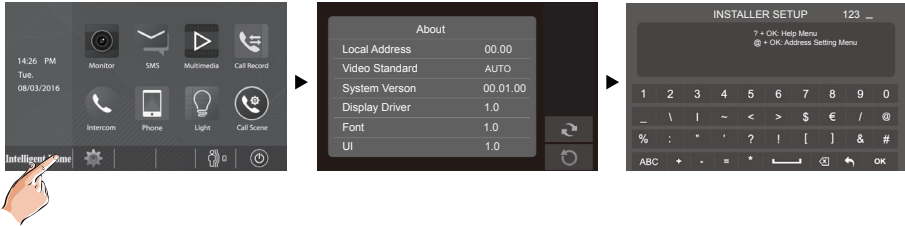

■ Entering Help page

Type in '?' and 'OK' to open Help instructions where you will find all codes for programming

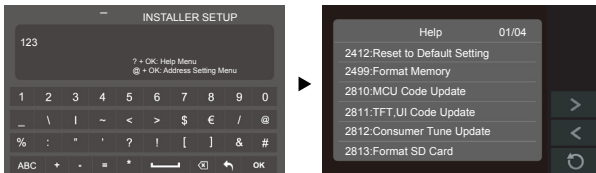

Code	Function	Code	Function
2412	Reset to Default Setting	8018-8020	Video Display Standard
2499	Format Memory	8040-8050	LED Color Setting For Calling
2810	MCU Code Update	8051-8055	LED Color Setting For Standby
2811	TFT,UI Code Update	8300-8301	Auto Recording ON/OFF
2812	Consumer Tune Update	8302-8303	Manual Recording ON/OFF
2813	Format SD Card	8401-8499	Unlock Time
2910	Broadcast Namelist	9006-9007	Unlock Alert Disable/Enable
8004-8005	Guard Unit Enable	9008-9010	Tune Source Default/Custom
8008-8009	Date Format	9011-9012	Namelist First Name"00/01"
8010-8011	Unlock Mode:Close/Open	9017-9019	Touch Key Sensitivity Adjust
8012-8013	Time Format:12/24 hours	9020-9021	Hearing Aid Function On/Off
8016-8017	Bypass Enable/Disable	9030-9039	Fish Eye Control

SYSTEM CONFIGURATION

■ Entering Address setting page

Type in '@' and OK to open Address Setting menu

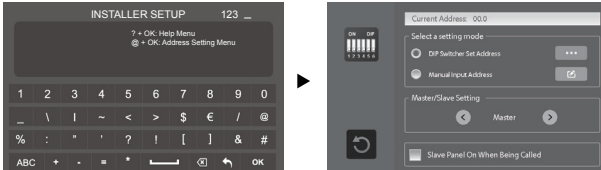

Multiple Monitor System Configuration

There are two way of connecting multiple monitors:

- 1. Daisy Chain**- each monitor connects to the next monitor
- 2. Star Connection**- all monitors connects to a central point

Up to 16 video monitors can be connected in a House system. Up to 4 monitors in each apartment for Apartment systems. Each monitor in either system must be programmed with a 'User Code'- the address

How to program the 'User Code' for Daisy Chain connection

All monitors must have same User Code '0' and programmed as Master/Slaves.

Program first monitor as Master, all others as Slave1, Slave2, Slave3.

If there are more than 3 Slave monitors in the system, program them with different user codes starting with code 0, 1, 2, 3, 4 and so on as for Star connection. In addition to user code programming, last monitor in the chain have to have DIP6 set On (end of line). Applicable Intercom Function for Master/ Slave programming: 'Inner Broadcast' and 'Inner Call'- all monitors ring at the same time. Intercom by 'NameList' requires different programming, same as for Star connection

How to program the 'User Code' for Star connection

All monitors must be connected to an additional hub- DBC4A distributor. One DBC4A can connect up to a 4 video monitors. Each monitor in the system should be assigned with the unique 'User Code' according the table and have DIP6 set 'On' in each monitor in the system.

There are two ways to program User Codes: via DIP-switches on the back of the monitor or via 'Address settings' menu. Choose 'Manual Input Address' option and type two digits and OK to confirm.

Allways start with user code 00 for House system and 01 for Apartments system. Range of user codes available 00-31. In addition to user code programming, program all monitors as 'Master'. Applicable Intercom Function for such programming: 'Intercom by NameList' - to call to a specific monitor in the system

Power Saving Mode On/Off

By default the system is set to power saving mode, where only the first monitor in the system comes On with video when door station called. All other monitors will ring but without video. Video will be transferred to the monitor which answers the doorbell call.

To switch the power saving mode off: (so all monitors ring with video), tick 'Slave Panel On' in the 'Address Setting' menu

User Codes Table

On 'Address Setting' page, select DIP Switch Set Address setting, then touch icon  to see 32 User Codes configuration. Same table can be found in the Door Station Manual

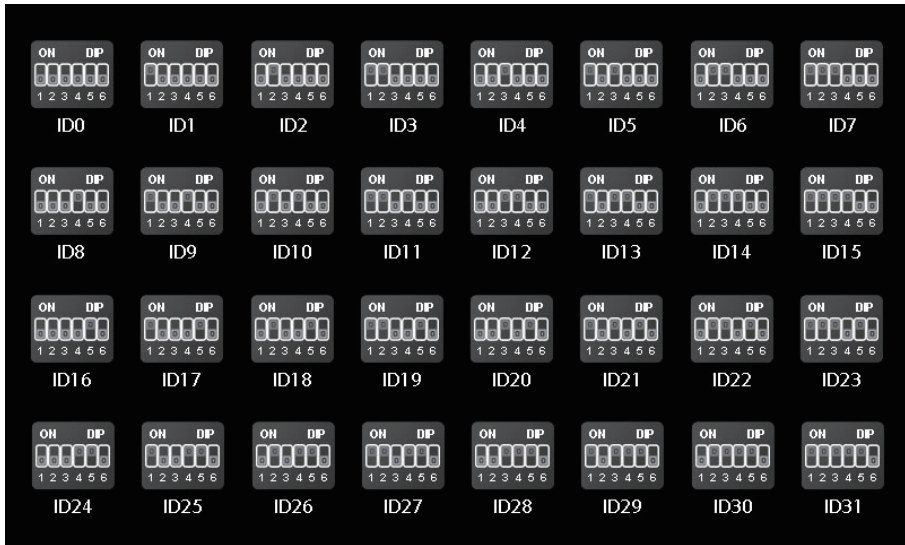

Note: In Apartment systems, program Apartment 32 with User Code '0'

Manual Input of User Code

In the 'Address Setting' menu choose 'Manual Input Address' option and program user codes via menu rather than DIP switches. Range of User Codes are 00~31

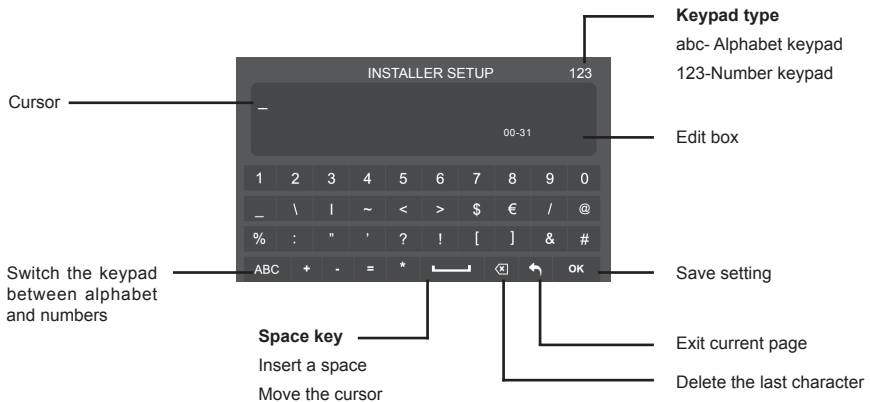

SETUP INSTRUCTIONS

Date and Time Settings

Here you can set date and time. On the Main Menu page touch  settings icon and choose 'Date & Time'. Change values using up and down arrows (▲ ▼) and click (✔) icon to save new settings

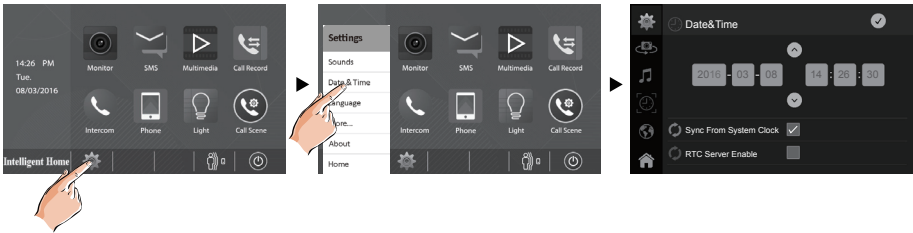

Note: 'Sync System Clock' icon allows to set date and time on one monitor in multiple monitor system and sync all monitors to the same settings quickly

Touch  icon to exit and return to the Main Menu page

Ring Tone Settings

Here you can set ring tones for multiple Door Stations and Intercom between monitors to distinguish different calling sources. Choice of 20 ring tones are available

On the Main menu page, touch  settings icon -> 'Sounds'

Touch Door Station, Intercom, Bell Button and Alert tone individually

Touch (◀ / ▶) icon to change. Settings will perform immediately

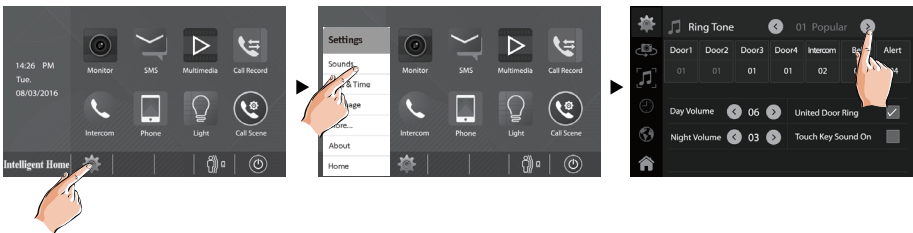

Note: If 'United' ring tone is selected, the ring tones of all Door Stations will be the same

Touch  icon to exit and return to the Main Menu page

SETUP INSTRUCTIONS

Ring Volume Settings

Here you can set Day/Night ring volume. The setting range is 0~9

On the Main menu page touch  settings icon -> 'Sounds'

Select **Volume** setting, touch  /  icon to adjust levels. Settings will perform immediately

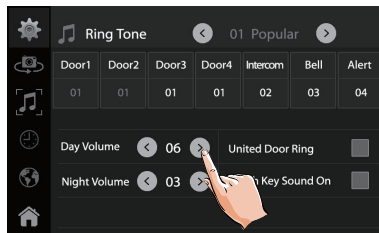

Note: The day time is from 06:00am to 18:00pm. The night time is from 18:00pm~06:00am.

Touch  icon to exit and return to the Main menu page

Enabling/Disabling the Operational Sound

Here you can Enable/Disable touch screen sounds

On the main menu page touch  settings icon -> 'Sounds'

Click **Touch Key Sound On** ✓

Unlick to cancel

Naming Door Station & CCTV Camera

Here you can give descriptions to your Door Stations & CCTV cameras i.e. Front Door, Back Door, Gate

On the main menu page touch  settings icon -> 'More'

Touch the icon of the door station or cctv camera you want to rename, the digital keypad will open. Type in your new description and touch arrow button to save

SETUP INSTRUCTIONS



* Up to 12 characters can be entered for a name

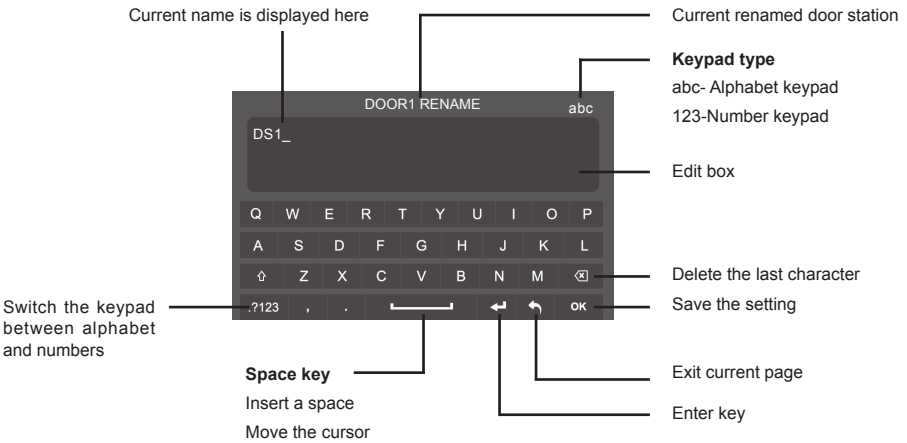

Monitoring Time Settings

Monitoring time is a time monitors stays open when 'Manual Monitoring' is performed. Available to choose: 30s, 40s, 50s, 1min, 2min, 3min, 4min, 5min, 6min, 7min, 8min, 9min, 10minutes

On the Main menu page touch settings icon -> 'More'

Select **Monitor Time Set**

Touch / icon to adjust levels. Settings will perform immediately

SETUP INSTRUCTIONS

Changing Language

On the Main menu page touch  settings icon -> 'Language' to set the operating language



Restoring to Factory Default Settings

To recover factory settings

On the main menu page touch  settings icon -> 'About'

Touch  icon, a message "Restore To Default?" will appear

Touch icon to confirm. Touch  icon to cancel

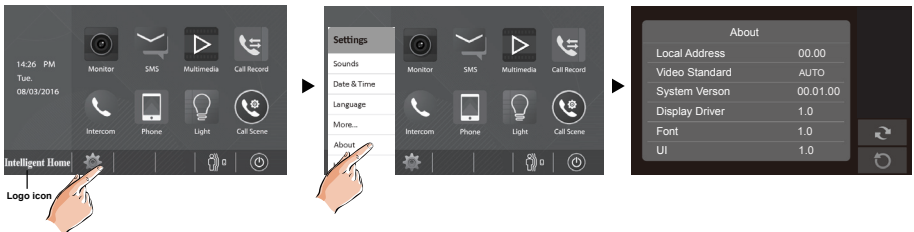

About page can be entered from [Logo] icon as well

SETUP INSTRUCTIONS

Enable/Disable Intercom Function

Here you can enable or disable Intercom between monitors function

On the Main menu page touch  settings icon -> 'More'

Click / Unclick **Intercom Disable** icon

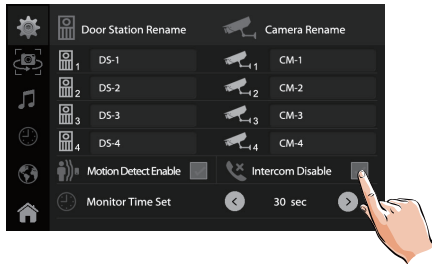

Enabling/Disabling Motion Detection Function

Here you can Enable/Disable Motion Detection function which is available only when Door Station Model 607 and additional Motion Detection Interface are installed

On the main menu page touch  settings icon -> 'More'

Click/Unlick **Motion Detect Enable** icon ✓



Motion Detection icon  will be displayed on the Home page when enabled

SETUP INSTRUCTIONS

Door Station Model 607 and Motion Detection Interface must be connected and system must be powered up to make settings



- **Detection Off:** deactivate Motion Detection function
- **Detection On:** activate Motion Detection function

Example of Door Station Detection Settings

On the Main menu page touch icon

Touch DS1=>Door Station 1

Tick desirable tasks for both Door Station and Video monitor and save

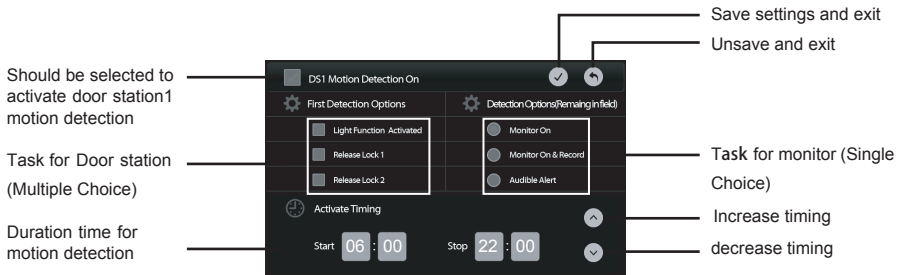

To see all recorded detection touch 'Multimedia' -> 'Motion Detection' icon

SETUP INSTRUCTIONS

Electric Lock Release Settings

You can open the lock by touching  **UNLOCK** Button or touching  icon on the screen.

There are two icons **Lock1** and **Lock2** which means you can have up to 2 electric locks connected and opened independently. If system connected to a lock, remember to set unlocking time and lock mode. Settings are changed on the 'Installer Setup' page. To access the page, touch 'Logo' icon on the left hand side, at the bottom

Touch and hold 'Unlock' button for 2 seconds to open digital keypad page. Using the keypad, type in the following codes:

8010 # for Power-on-to open lock

8011 # for Power-off-to open lock

To set the unlocking time, use codes 8401-8499 # for 1 to 99 seconds

Example: Type in 8401 # for 1 second unlocking time, 8499 # for 99 secs unlocking time

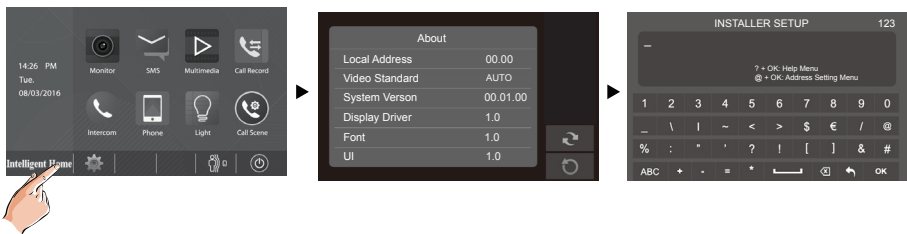

- On the Main menu page touch [Logo] icon to enter About page
- Press and hold for 2 sec UNLOCK  button
- Digital keypad will be shown

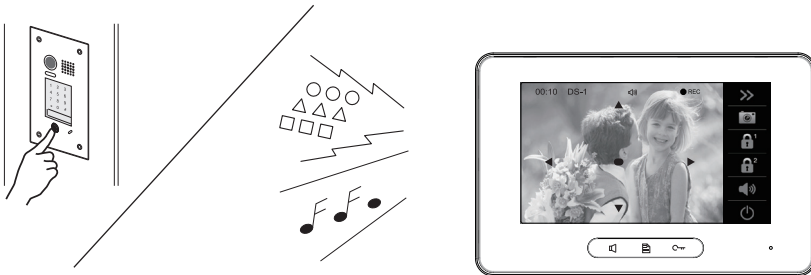

BASIC OPERATIONS

Answering a Door Call

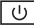

- When Door Station is rung, the monitor comes On with video
- To start conversation touch  **TALK/MON** icon on the button or  **Talk** icon on the screen
- To end conversation touch  **TALK/MON** icon on the button once again or touch  icon on the screen. Monitor will shut down automatically after 40 seconds

Adjusting Colour, Brightness and Talk Volume

Here you can adjust your monitor properties such as Contrast, Brightness and Colour. Following adjustments can be performed in Manual Monitoring mode with video from Door Station on a screen



4 scene modes are available to select: **Normal, Bright, Soft and User**



Screen Contrast. The range is 0~9. Touch - or + to set desired levels



Screen Brightness. The range is 0~9. Touch - or + to set desired levels



Screen Colour. The range is 0~9. Touch - or + to set desired levels



Speaker volume. The range are 0 (Mute) ~9. Touch - or + to set desired levels

BASIC OPERATIONS

Pan-Tilt & Zoom

Pan-Tilt & Zoom function only available with **Fish-Eye** Door Station installed

When the video from Door Station is displayed, move to the desired position by touching ▲ ▼ ● ◀ ▶ using the 5 Direction Pad on the screen to view the image in Zoom mode



Example:

- Touch ● icon to zoom center of the image

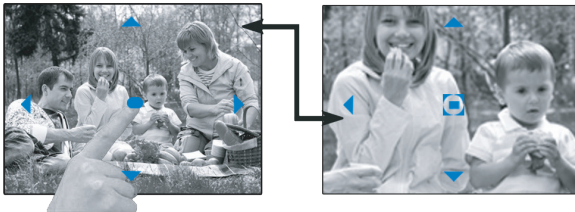

- Touch ▶ icon to zoom right side of the image

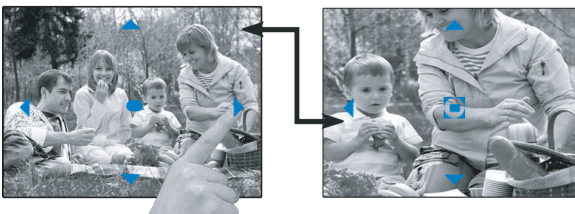

BASIC OPERATIONS

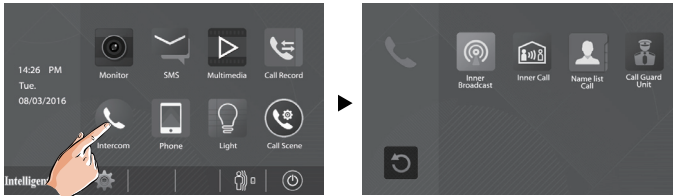

Intercom Between Monitors Function

Touch 'Intercom' icon on the Home page. It will open new page with available Intercom options



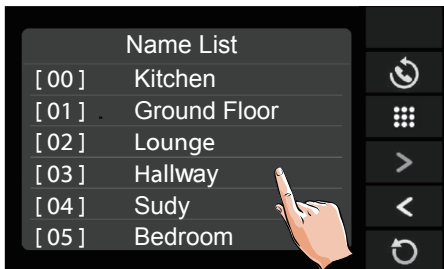

1. **'Inner Broadcast'**: use 'Inner Broadcast' to talk to all monitors at the same time. Your speech will be heard from all monitors right away with no need to do anything else even if monitors are not active
2. **'Inner Call'**: use 'Inner Call' to ring to all monitors in the system. When one of them answered your call, all other monitors will stop ringing. Conversation will be established only between two monitors
3. **'Name List Call'**: use 'Intercom by Name List' to call to a specific monitor in the system. Name list of monitors have been created after installation is complete and user codes of monitors are known. '00' or '01' - are the user codes (addresses) of the monitors



- * Use < or > to scroll pages
- * Touch  to name the monitor
- * Touch  to dial selected monitor
- * If nobody answers the call it will automatically ends in 30s

4. **'Call Guard Unit'** Intercom: use to call the concierge in Apartment systems

- * Use "  " or "  " to adjust 'Talk' volume
- * Touch  icon to end the call

BASIC OPERATIONS

Manual Monitoring

You can manually monitor the entrance at any time even if nobody rings the bell

- 1.Touch screen of the monitor in standby
- 2.Touch 'MONITOR' icon on the Main Menu page to enter **Monitor Select** page

*Note: Press  TALK/MON icon on the button to see view from Door Station 1

Monitoring Door Stations/ CCTV cameras:

- DS1~4 and CAM1~4 can be monitored individually if the system has multiple door stations and CCTV cameras

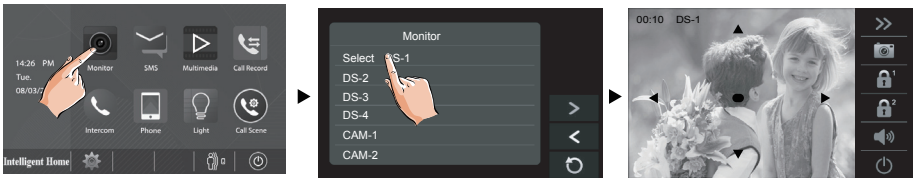

* There is no audio during Manual monitoring

* To activate audio during monitoring, touch  icon

* During Manual monitoring following functions are available: manual recording, Pan-Tilt &Zoom, unlocking, adjusting screen settings and talk volume

Video Quad Monitoring:

Video quad monitoring is available with an additional QSW Interface

- On 'Monitor Select' page touch  icon to scroll to a next page
- Select **QUAD-1** to activate video quad monitoring

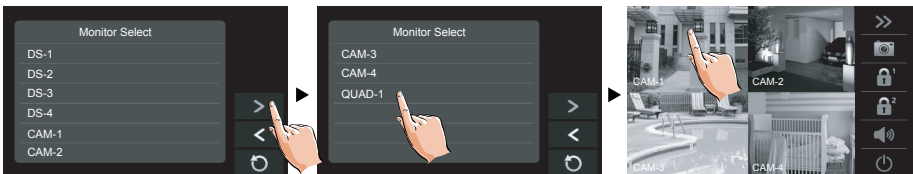

* Touch one of the quad views to switch to the full view of corresponding camera

BASIC OPERATIONS

Pictures and Video Recording

When door station is rung, the monitor will record a picture of the visitor automatically. The monitor has built-in memory for 118 pictures. An additional Micro SD card up to 32GB can be installed to increase memory storage. The SD card will enable video clips recording. Clips are 10sec each. Video clips with sound can be recorded only when 'Talk' button is activated. Otherwise video clips will not have sound. Pictures and video clips can be downloaded from the monitor via SD card. Brand new SD card have to be formatted by monitor

Automatic Recording

- Recording starts in 3 seconds after Door Station is rung
- While recording ●REC blinks
- Captures one picture for each call



Manual Recording

If nobody rings the door bell but you see something via manual monitoring and want to take a picture of video clip of the event, touch 'Record' icon . If you want your manual video clip recording with sound, remember to hit the 'Talk' icon

SD Card Formatting

Micro-SD card need to be formatted when used in the monitor for the first time

- * All existing data on a card will be erased after formatting
- * To **VIEW SD CARD INFO** touch 'Multimedia' -> 'Memo information'

1. On the Main Menu page, touch **Multimedia** -> **Format SD Card**

2. Touch icon to continue with formatting. Touch  icon to cancel formatting

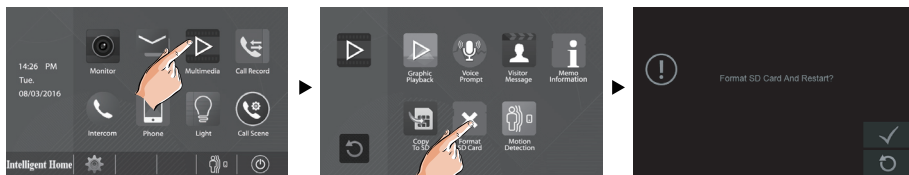



- * When double beep sounds and a blue screen is displayed, formatting is complete
- * It may take a few minutes to complete the formatting

BASIC OPERATIONS

Copying Recordings onto SD Card

You can copy recordings (images) stored in the built-in memory onto a SD card

- On the Main Menu page touch 'Media' -> 'Copy to SD'
- Touch  icon to copy. Touch  icon to cancel

When copying is completed, 'BKUP_PIC' folder is created on the Micro SD card. Copied images are stored with the following file names

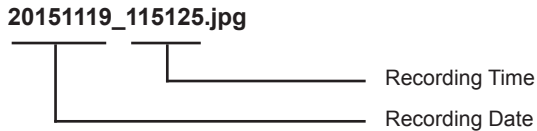



Notes :

- * This action will overwrite all existing images in the 'BKUP_PIC' folder on the micro SD card
- * If the number of images or folders exceed the limit of micro SD card, they cannot be copied
- * The images from the micro SD card cannot be copied into the built-in memory
- * If copying is failed, try to format the SD card again

Pictures and Video Playback

All recorded images/videos can be viewed on the monitor

- On the Main Menu page touch 'Media' -> 'Graphics Playback' icon
- Touch < or > to scroll through recordings, touch  to delete current image/video. If recordings are videos, touch  icon to play/pause the videos



To stop

Touch  icon

BASIC OPERATIONS

Voicemail

Voicemail function is useful when you are away from home. Micro SD card has to be installed to support this function. Lengths of Voicemail is limited to 10 sec. When you have new Voicemail, the **LO** icon will appear in the status bar on the Home page

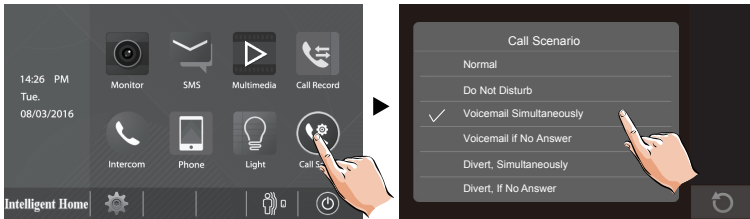

Voicemail Immediately: The system will prompt a visitor to leave a voicemail immediately

Voicemail If No Answer: The visitor will wait for 30 sec for someone to answer and then system will prompt visitor to leave a voicemail

Touch  icon to exit

Viewing Visitor's Voicemails

On the Main Menu page touch 'Multimedia' -> 'Visitor Message' icons

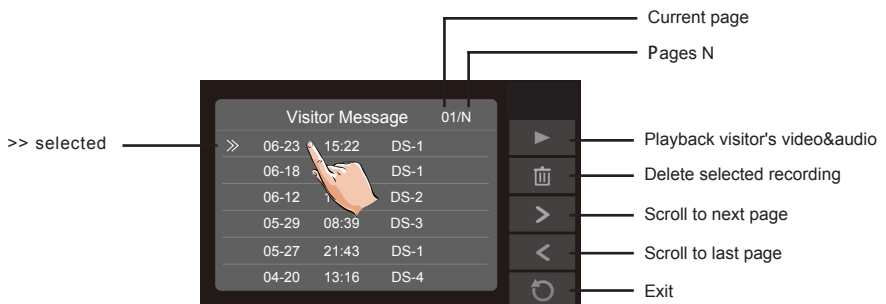
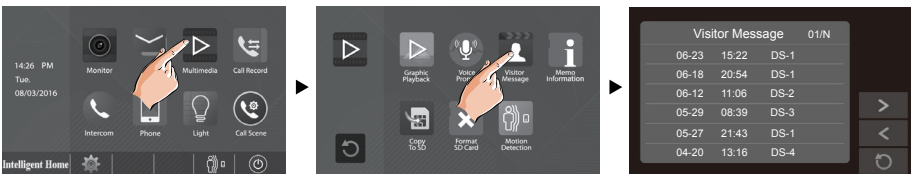

Notes:

* Max. 100 messages can be displayed

BASIC OPERATIONS

Viewing Call Records

All calls from Door Station/s or other monitors will be recorded and can be reviewed afterwards. On the Main Menu page touch 'Call Record' icon

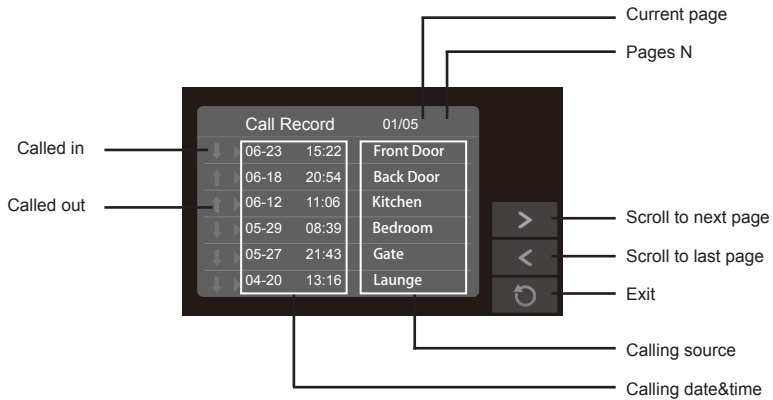

Touch one record of the calling list

Touch  icon to view the visitor's image



Notes:

- * Vertical Arrow Red - missed calls
- * If the missed calls have been viewed, the arrow will change to blue
- * Vertical Arrow Blue - call was answered
- * Max. 100 calling records can be displayed
- * When the capacity is full, the oldest calling records will be deleted automatically to make room for new records

BASIC OPERATIONS

SMS function

You can exchange messages between monitors in multiple monitors system

Writing a message

- On the Main Menu page touch 'SMS' -> 'Write a SMS' icon, and then select the monitor address (User Code of a monitor)
- Write a message using on-screen keypad. Up to 78 characters can be entered
- Touch 'OK' to send the message

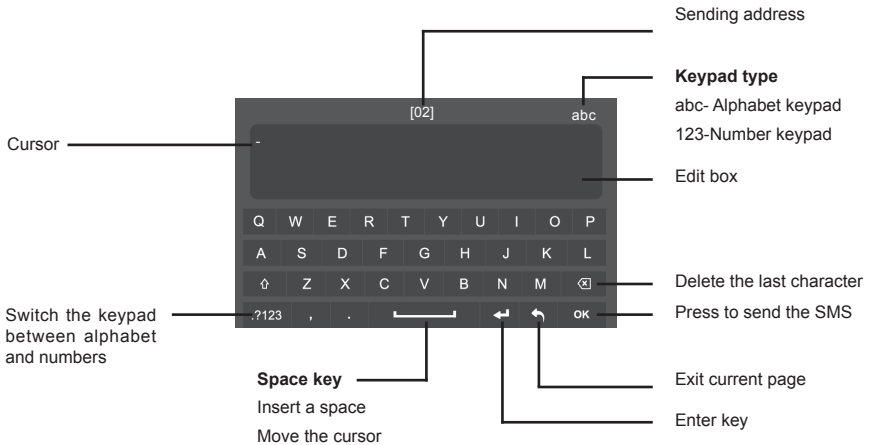

Reviewing received messages

- On the Main Menu page touch 'SMS' -> 'Inbox' icon, the most recent received messages will be displayed

Reviewing sent out messages

- On the Main Menu page touch 'SMS' -> 'Outbox' icon, the most recent sent out messages will be displayed

Notes:

It's available to reply to messages or delete messages in Inbox/Outbox page

Use < or > to scroll pages

Touch  icon to exit

BASIC OPERATIONS

Call Divert Function

Forwarding a call from the Door Station to a mobile phone requires an additional TPS Telephone Interface or GSM Interface. Up to 3 mobile or landline numbers can be programmed



There are two Divert Modes:

- 1. Divert, Simultaneously:** call will be diverted immediately. All monitors and telephone handsets will ring. All monitors will come On with video from door station. Call can be answered from any monitor or telephone handset
- 2. Divert, If No Answer:** if monitor is not answered within 30s, call will be diverted to the number programmed. Monitors will stop ringing after the diversion. Talking time is limited to 90 seconds. The status bar on the Main Menu page will show (↪) icon

Setting divert number

On main menu page, touch 'Phone' -> 'Divert'.

Touch the telephone number frame and type in the number using digital keypad



* Touch  icon on the screen to save the setting

* Touch  icon on the screen to cancel



BASIC OPERATIONS

Do Not Disturb

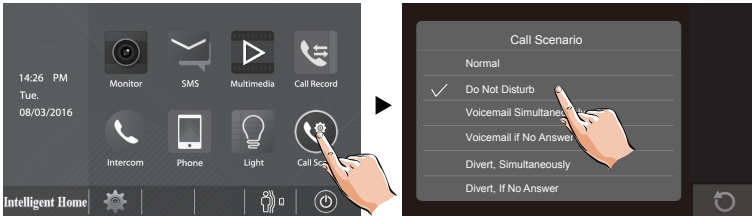
Do Not Disturb function will set the monitor to not react to door station or other monitors calls

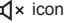

Notes :

- * This function will perform immediately if selected, and the status bar on the Main Menu page will show  icon
- * Touch  icon to save and exit

Operating Security Light

This function will be activated only when actual security light connected with an additional Light/Lock Control **RLC Interface**. Touch '**Light**' icon on the main Menu page or touch  icon during monitoring or talking to turn the light On. It will be turned Off automatically within 60 seconds



*Touch '**Light**' icon again to turn Off the light

*Touch  icon again to turn Off the light

Changing Colour of LED on the Button

Default: Standby: Green; Call Waiting: Red flashing

Available colours to choose and codes for setting:

Standby	Call Waiting
8051 Red	8045 Red flashing
8052 Green	8046 Green flashing
8053 Blue	8047 Blue flashing
8054 Yellow	8048 Yellow flashing
8055 Purple	8049 Purple flashing
8056 White	8050 White flashing
8057 Off	

Specification

Power supply:	DC 20~28V
Power consumption:	Standby 0.27W; Working 7W
Communication:	Handsfree
Screen:	7 Inch digital color TFT
Display Resolutions:	800*3(R, G, B) x 480 pixels
Video signal:	1Vp-p,75Ω,CCIR standard
Mounting:	Surface wall-mount
Material:	Aluminum front panel
Color:	White
Wiring:	2 wires, no-polarity
Dimensions:	H139×W212×D15mm

WARRANTY CARD

NB Please keep this document safe, as it is proof of your Warranty
Your Video door system comes with a one year Manufacturers Warranty. When used normally, the following services are offered:

1. Replacement for malfunctioning parts in first three months
2. Repair free of charge for malfunctioning parts in first year

The following actions will void the Warranty:

1. Damage to the device during installation
2. Damage to the device through misuse
3. Opening and/or disassembling the device
4. Attempting to force the device to perform functions for which it is not intended
5. Attaching the device to power supplies other than those recommended by the manufacturer

Distributor for Warranty purposes:

Intelligent Home Online Ltd

62 Hartley Old Road

Purley

Surrey

CR8 4HJ

+44 (0)20 86170015

www.intelligenthomeonline.com

Product: _____

Serial Number: _____

Invoice N: _____

Purchase Date _____



Alecto 2-wire series

The design and specifications can be changed without notice to the user.
Right to interpret and copyright of this manual are preserved.