



QUOTE REQUEST FORM

ALL FIELDS WITH RED FRAME NEED TO BE COMPLETED BEFORE THIS FORM WILL BE SENT

CUSTOMER DETAILS

DATE:	
NAME:	
CONTACT NUMBER:	
EMAIL:	

VEHICLE DETAILS

MAKE OF CAR:			
MODEL OF CAR:			
YEAR & MONTH OF CAR (NEED MONTH AS WELL):	<table border="1"> <tr> <td>MONTH</td> <td>YEAR</td> </tr> </table>	MONTH	YEAR
MONTH	YEAR		
RW TO QUOTE ON: TRAY BAR BOTH	HOW WOULD YOU LIKE TO RECEIVE THESE ITEMS?		
VEHICLE COLOUR:	<table border="1"> <tr> <td>TRAY COLOUR:</td> <td>BAR COLOUR:</td> </tr> </table>	TRAY COLOUR:	BAR COLOUR:
TRAY COLOUR:	BAR COLOUR:		

IMPORTANT INFORMATION REQUIRED FOR TRAY- TYRE SIZE	
IMPORTANT INFORMATION REQUIRED FOR TRAY- SENSORS/CAMERA	SENSORS CAMERA
IMPORTANT INFORMATION REQUIRED FOR BAR- SNORKLE	
IMPORTANT INFORMATION REQUIRED FOR BAR- EXHAUST SIZE	
IMPORTANT INFORMATION REQUIRED FOR BAR- FRONT PARKING SENSORS	
IMPORTANT INFORMATION REQUIRED FOR BAR- ARE FOGLIGHTS FITTED	
IMPORTANT INFORMATION REQUIRED FOR BAR- ARE FLARES FITTED	



TRAY SPEC SHEET

GAL MESH 50X50
GAL MESH 100X100

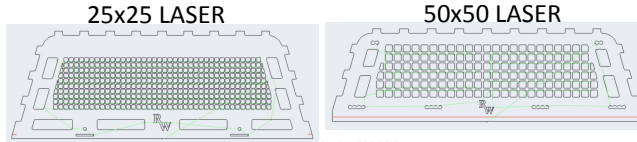

STANDARD H/BOARD
2.5 INCH PIPE
2x 20NB HORIZONTAL BARS

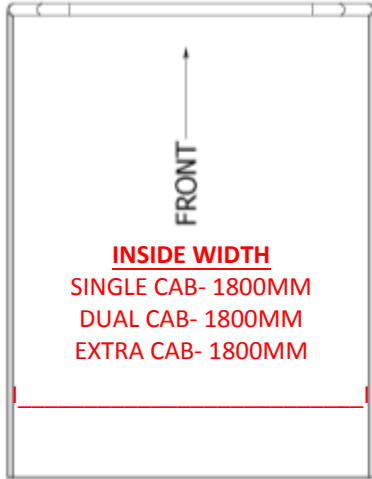

INSIDE WIDTH
SINGLE CAB- 1800MM
DUAL CAB- 1800MM
EXTRA CAB- 1800MM

TOP VIEW

DROP SIDE PROFILE OPTIONS. PLEASE SELECT

INSIDE VIEW	OUTSIDE VIEW	INSIDE VIEW	OUTSIDE VIEW	INSIDE VIEW	OUTSIDE VIEW	INSIDE VIEW	OUTSIDE VIEW
OPTION 1: <input type="checkbox"/>	OPTION 2: <input type="checkbox"/>	OPTION 3: <input type="checkbox"/>	OPTION 4: <input type="checkbox"/>	OPTION 1: <input type="checkbox"/>	OPTION 2: <input type="checkbox"/>	OPTION 3: <input type="checkbox"/>	OPTION 4: <input type="checkbox"/>

TIE DOWN POINTS

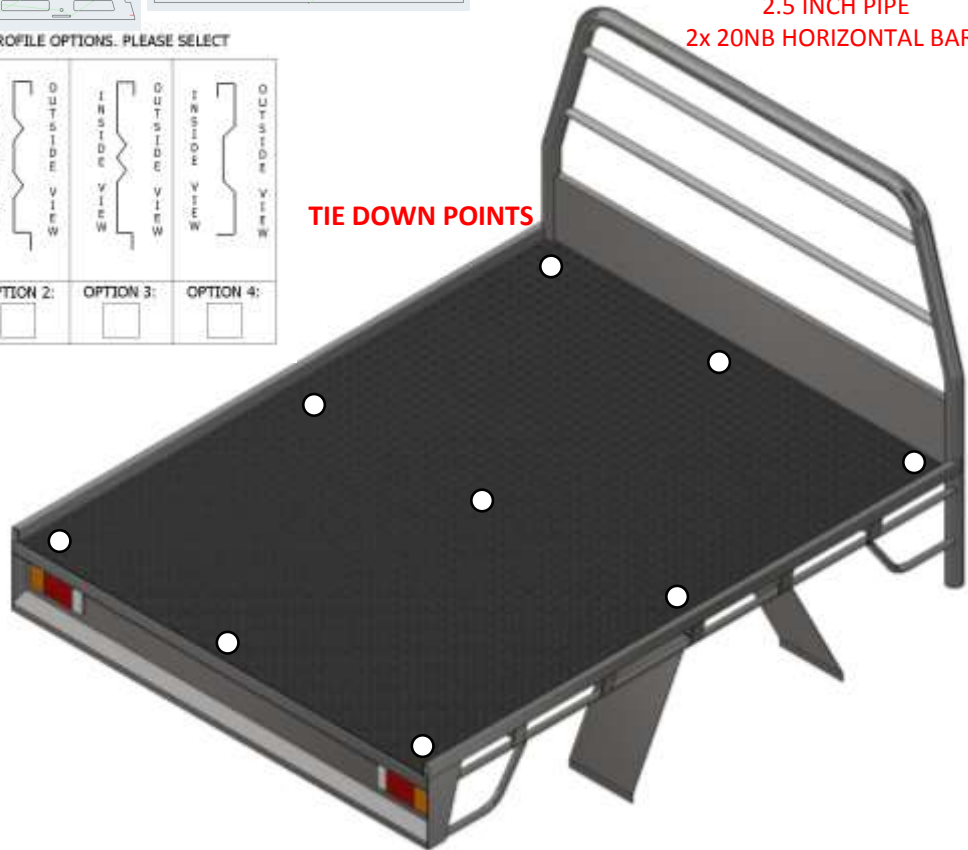

EXTRA NOTES:

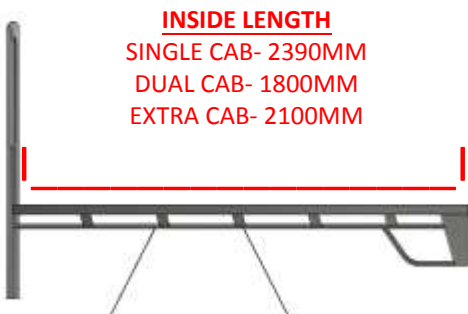

PASSENGER SIDE VIEW

INSIDE LENGTH
SINGLE CAB- 2390MM
DUAL CAB- 1800MM
EXTRA CAB- 2100MM



REAR VIEW

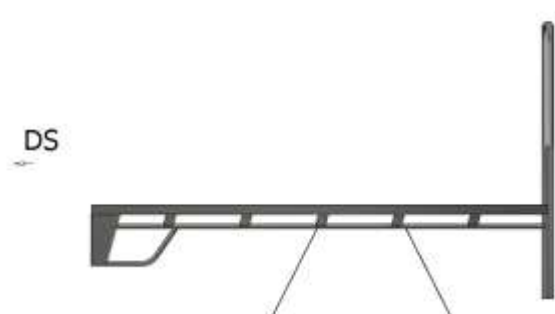

DRIVER SIDE VIEW

EXTRA NOTES: NOTE: DIAGRAMS ARE FOR REFERENCE ONLY. ACTUAL BUILD TO BE AS PER SELECTED OPTIONS



BAR SPEC SHEET

NOTE: DIAGRAMS ARE FOR REFERENCE ONLY. ACTUAL BUILD TO BE AS PER SELECTED OPTIONS

Landcruiser 4post Bar Dual Rails and HiLux 2post Bar No Side Railes Image Shown

FRONT VIEW

2 POST BAR

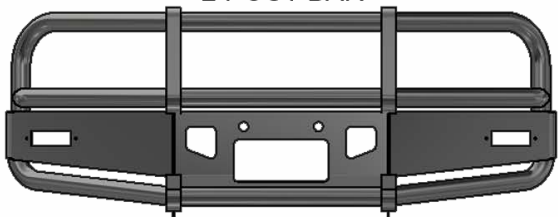

4 POST BAR

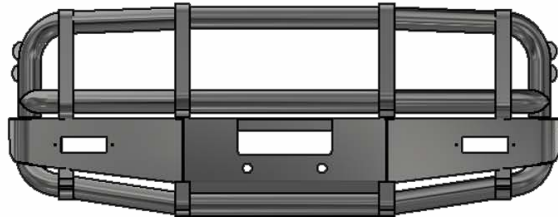

SIDE VIEW

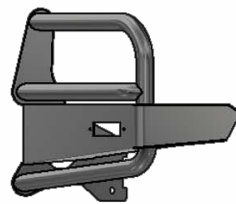

TOP VIEW

2 POST BAR

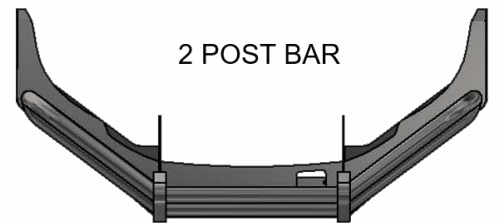

4 POST BAR

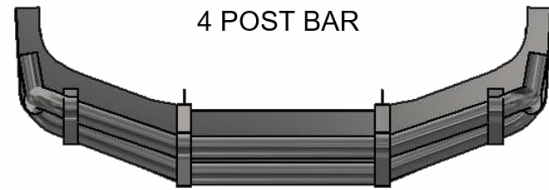

Rydweld Bars Are Compatible With The Spec's Of
9000pd Warn Winch, Iron Man 12000pd
If Larger We Require Winch When Making Bar

4 Post Bars Single & Dual Rails Only Fit The
Toyota Single & Dual Cab Models.
2 Post Bars Single & Dual Rails Fit, L/Cruiser Tray Backs &
Wagons, HiLux, Ranger, BT50, Colorado, DMax.
Dual Rails Do NOT Fit Prado Or Pre 2014 HiLux

EXTRA NOTES:

SPOTLIGHT MOUNTING



AERIAL MOUNTING

