

Pumps Diaphragm Pump

altek produces high-quality products. This is reflected in everything we do. Thus, it is one of our principles that our performance data represent genuine values under practical conditions. Besides other attributes, altek pumps are especially well known for their robustness, reliability and long service life. Due to its compact design, altek piston diaphragm pumps can be easily mounted in a wide range of sprayers. In addition to that, thanks to the modular principle utilised by altek, all pumps can be constructed in such way, that suction and pressure connections can be fitted on the left- and the right-hand side of the machine.

- Long service life and operational reliability
- Easy to repair
- Flexible mounting
- Safe to run dry
- Liquid fertiliser-proof
- Self-priming up to 4 meters
- Integrated accumulator ensures, that constant pressure is maintained
- Perbunan® (NBR) or Desmopan® (dp) diaphragms



P70

- linear steady state characteristics
- integrated hydraulic accumulator
- safe to run dry (liquid)
- self-priming up to 4 meters depth
- liquid fertiliser-proof (AHL/UAN)

Capacity at 5 bar:	70 l/min
Nominal speed:	540 rpm
Operating time pressure:	max. 15 bar
Short-term pressure:	max. 20 bar
Speed range:	450-600 rpm
Spline shaft:	DIN 9611 / ISO 500
Standard working diaphragms:	2 x NBR
Accumulator diaphragms:	1 x NBR
Inlet- ϕ suction side:	AS40
Outlet- ϕ pressure side:	AS30
Lubrication:	Oil bath
Weight:	8,7 kg
Material:	Cast aluminium, partially anodised, NBR seals, POM, stainless steel: 1.4305

Options:

- **Desmopan® diaphragms**
- **Through shaft**
- **Hydraulic drive**

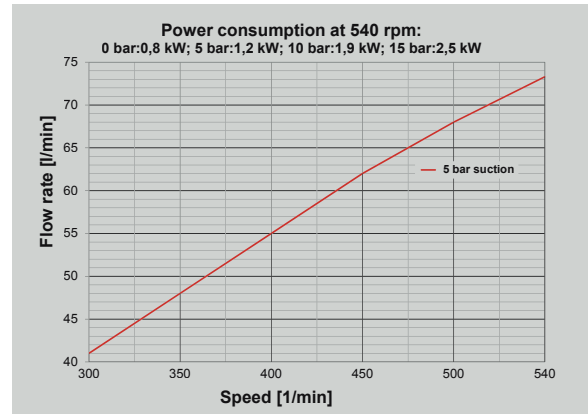

Pump options

Article-No.	Type
82372	Piston diaphragm pump P70 with bracket and pto protection
More variations on request	
Recommended fittings inlet (AS2)	
08275	Plug-in hose tail AS40/ ϕ 39/90° cpl
06247	Plug-in hose tail AS40/ ϕ 39 cpl
Recommended fittings outlet (AS1)	
08337	Plug-in hose tail AS30/ ϕ 25/90° cpl
33793	Plug-in hose tail AS30/ ϕ 33/90° cpl
81119	Plug-in hose tail AS30/ ϕ 25 cpl
01399	Plug-in hose tail AS30/ ϕ 33 cpl

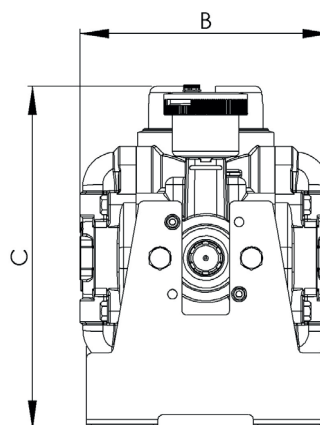
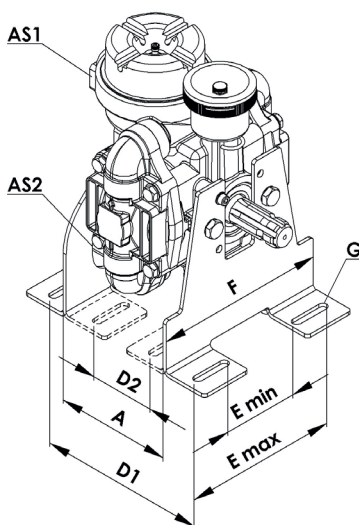

A	B	C
152	250	351
D1	D2	E _{Min}
282	132	110
E _{Max}	F	G
225	250	M12
specified in mm		



P100

- linear steady state characteristics
- integrated hydraulic accumulator
- safe to run dry (liquid)
- self-priming up to 4 meters depth
- liquid fertiliser-proof (AHL/UAN)

Capacity at 5 bar:	100 litres/min
Nominal speed:	540 rpm
Operating time pressure:	max. 15 bar
Short-term pressure:	max. 20 bar
Speed range:	450-600 rpm
Spline shaft:	DIN 9611 / ISO 500
Standard working diaphragms:	2 x NBR
Accumulator diaphragms:	1 x NBR
Inlet- ϕ suction side:	AS40
Outlet- ϕ pressure side:	AS30
Lubrication:	Oil bath
Weight:	11,8 kg
Material:	Cast aluminium, partially anodised, NBR seals, POM, stainless steel: 1.4305

Options:

- Desmopan® diaphragms
- Hydraulic drive

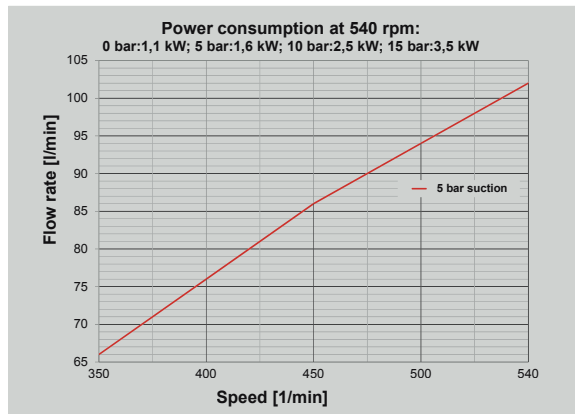

Pump options

Article-No.	Type
83117	Piston diaphragm pump P100 with bracket and pto protection
More variations on request	

Recommended fittings inlet (AS2)

17409	Plug-in hose tail AS40/ ϕ 46 cpl
08275	Plug-in hose tail AS40/ ϕ 39/90° cpl
06247	Plug-in hose tail AS40/ ϕ 39 cpl

Recommended fittings outlet (AS1)

08337	Plug-in hose tail AS30/ ϕ 25/90° cpl
33793	Plug-in hose tail AS30/ ϕ 33/90° cpl
81119	Plug-in hose tail AS30/ ϕ 25 cpl
01399	Plug-in hose tail AS30/ ϕ 33 cpl

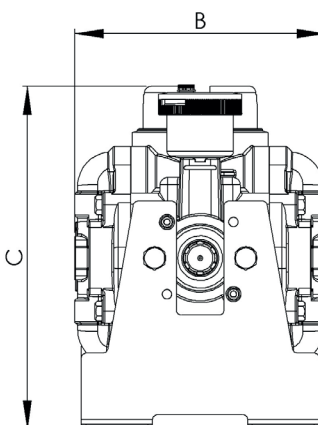
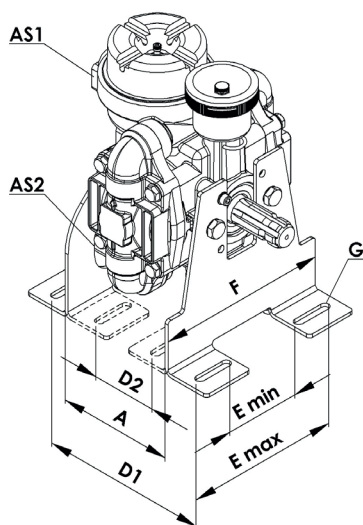

A	B	C
170	264	361
D1	D2	E _{Min}
245	95	110
E _{Max}	F	G
225	250	M12
specified in mm		



P120

- linear steady state characteristics
- integrated hydraulic accumulator
- safe to run dry (liquid)
- self-priming up to 4 meters depth
- liquid fertiliser-proof (AHL/UAN)

Capacity at 5 bar:	120 l/min
Nominal speed:	540 U/min
Operating time pressure:	max. 15 bar
Short-term pressure:	max. 20 bar
Speed range:	450-600 U/min
Spline shaft:	DIN 9611/ISO 500
Standard working diaphragms:	2 x NBR
Accumulator diaphragms:	2 x NBR
Inlet- ϕ suction side:	AS50
Outlet- ϕ pressure side:	AS30
Lubrication:	Oil bath
Weight:	13,2 kg
Material:	Cast aluminium, partially anodised, NBR seals, POM, stainless steel: 1.4305

Options:

- Desmopan® diaphragms
- Hydraulic drive

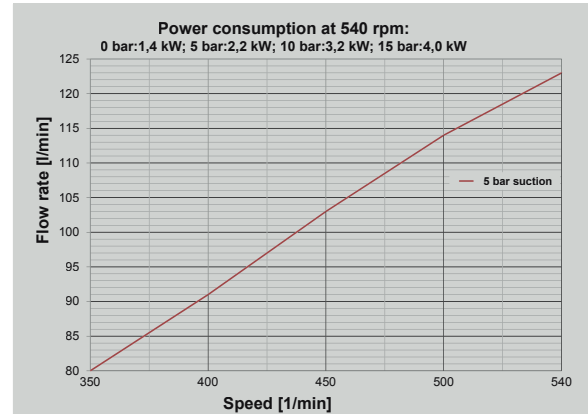

Pump options

Article-No.	Type
83035	Piston diaphragm pump P120 with bracket and pto protection

More variations on request

Recommended fittings inlet (AS2)

17157	Plug-in hose tail AS50/ ϕ 46 cpl
17330	Plug-in hose tail AS50/ ϕ 46/90° cpl
22040	Plug-in hose tail AS50/ ϕ 39 cpl
24891	Plug-in hose tail AS50/ ϕ 39/90° cpl

Recommended fittings outlet (AS1)

08337	Plug-in hose tail AS30/ ϕ 25/90° cpl
33793	Plug-in hose tail AS30/ ϕ 33/90° cpl
81119	Plug-in hose tail AS30/ ϕ 25 cpl
01399	Plug-in hose tail AS30/ ϕ 33 cpl

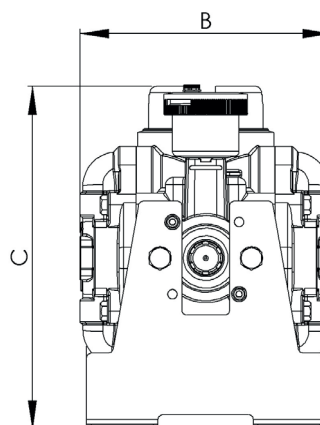
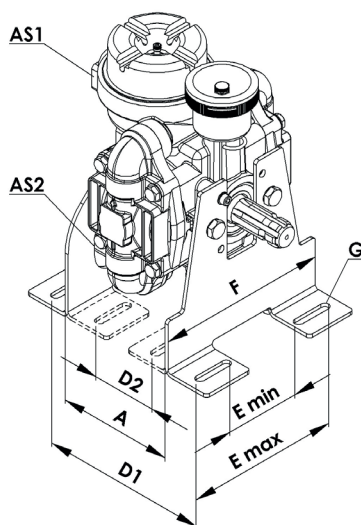

A	B	C
174	264	364
D1	D2	E _{Min}
254	104	110
E _{Max}	F	G
225	250	M12
Specified in mm		



P150

- linear steady state characteristics
- integrated hydraulic accumulator
- safe to run dry (liquid)
- self-priming up to 4 meters depth
- liquid fertiliser-proof (AHL/UAN)

Capacity at 5 bar:	150 l/min
Nominal speed:	540 U/min
Operating time pressure:	max. 15 bar
Short-term pressure:	max. 20 bar
Speed range:	450-600 U/min
Spline shaft:	DIN 9611/ISO 500
Standard working diaphragms:	4 x NBR
Accumulator diaphragms:	1 x NBR
Inlet- ϕ suction side:	AS50
Outlet- ϕ pressure side:	AS30
Lubrication:	Oil bath
Weight:	16,2 kg
Material:	Cast aluminium, partially anodised, NBR seals, POM, stainless steel: 1.4305

Options:

- Desmopan® diaphragms
- Hydraulic drive

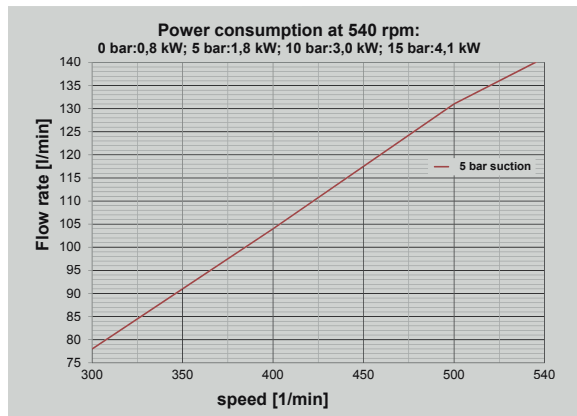

Pump options

Article-No.	Type
82378	Piston diaphragm pump P150 with bracket and pto protection
More variations on request	

Recommended fittings inlet (AS2)

17157	Plug-in hose tail AS50/ ϕ 46 cpl
17330	Plug-in hose tail AS50/ ϕ 46/90° cpl
22040	Plug-in hose tail AS50/ ϕ 39 cpl
24891	Plug-in hose tail AS50/ ϕ 39/90° cpl

Recommended fittings outlet (AS1)

08337	Plug-in hose tail AS30/ ϕ 25/90° cpl
33793	Plug-in hose tail AS30/ ϕ 33/90° cpl
81119	Plug-in hose tail AS30/ ϕ 25 cpl
01399	Plug-in hose tail AS30/ ϕ 33 cpl

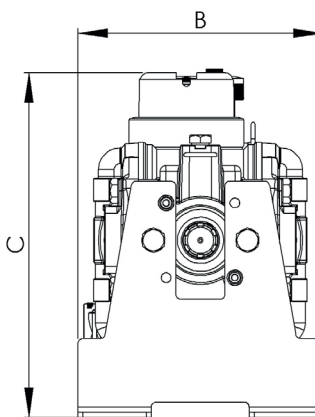
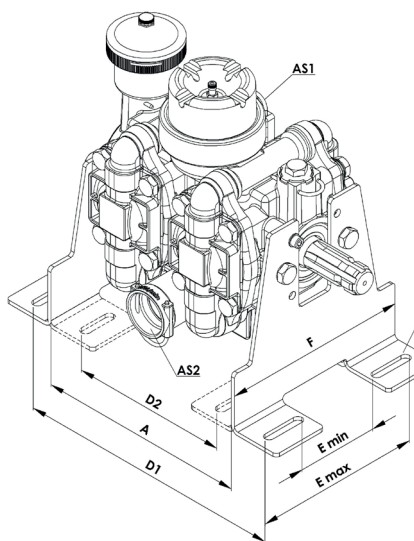

A	B	C
281	250	350,5
D1	D2	E _{Min}
361	211	110
E _{Max}	F	G
225	250	M12
Specified in mm		



P200

- linear steady state characteristics
- integrated hydraulic accumulator
- through shaft
- safe to run dry (liquid)
- self-priming up to 4 meters depth
- liquid fertiliser-proof (AHL/UAN)

Capacity at 5 bar:	200 l/min
Nominal speed:	540 U/min
Operating time pressure:	max. 15 bar
Short-term pressure:	max. 20 bar
Speed range:	450-600 U/min
Spline shaft:	DIN 9611/ISO 500
Standard working diaphragms:	4 x NBR
Accumulator diaphragms:	1 x NBR
Inlet- ϕ suction side:	AS50
Outlet- ϕ pressure side:	AS30
Lubrication:	Oil bath
Weight:	22 kg/26 kg
Material:	Cast aluminium, partially anodised, NBR seals, POM, stainless steel: 1.4305

Options:

- Desmopan® diaphragms
- Through shaft
- Hydraulic drive

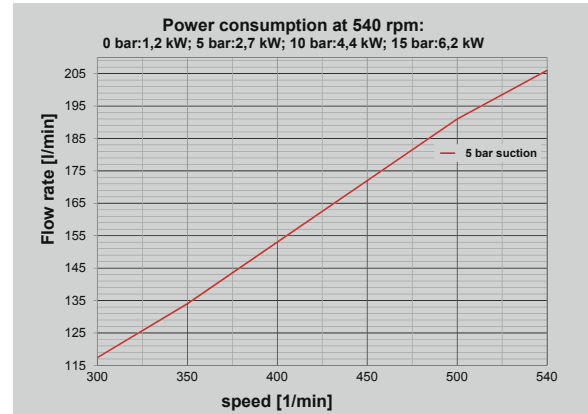

Pump options

Article-No.	Type
82406	Piston diaphragm pump P200 with bracket and pto protection

More variations on request

Recommended fittings inlet (AS2)

17330	Plug-in hose tail AS50/ ϕ 46/90° cpl
17157	Plug-in hose tail AS50/ ϕ 46 cpl

Recommended fittings outlet (AS1)

08337	Plug-in hose tail AS30/ ϕ 25/90° cpl
33793	Plug-in hose tail AS30/ ϕ 33/90° cpl
81119	Plug-in hose tail AS30/ ϕ 25 cpl
01399	Plug-in hose tail AS30/ ϕ 33 cpl

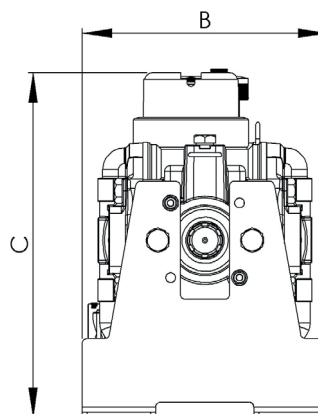
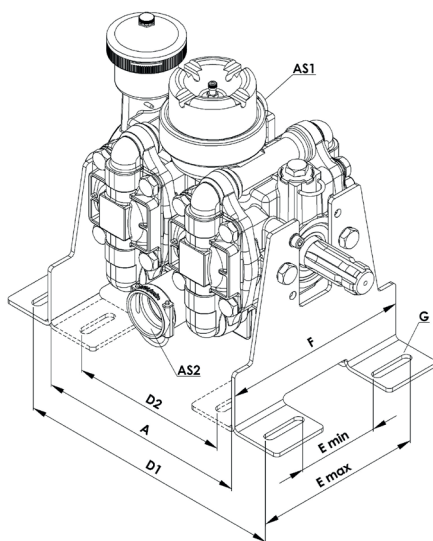

A	B	C
310	274	357
D1	D2	E _{Min}
390	240	110
E _{Max}	F	G
225	250	M12
Specified in mm		



P260

- linear steady state characteristics
- integrated hydraulic accumulator
- through shaft
- safe to run dry (liquid)
- self-priming up to 4 meters depth
- liquid fertiliser-proof (AHL/UAN)

Capacity at 5 bar:	260 l/min
Nominal speed:	540 U/min
Operating time pressure:	max. 15 bar
Short-term pressure:	max. 20 bar
Speed range:	450-600 U/min
Spline shaft:	DIN 9611/ISO 500
Standard working diaphragms:	4 x NBR
Accumulator diaphragms:	1 x NBR
Inlet- ϕ suction side:	G2 (BSP) male; d=47
Outlet- ϕ pressure side:	AS30
Lubrication:	Oil bath
Weight:	30 kg
Material:	Cast aluminium, partially anodised, NBR seals, POM, stainless steel: 1.4305

Options:

- Desmopan® diaphragms
- Through shaft
- Hydraulic drive

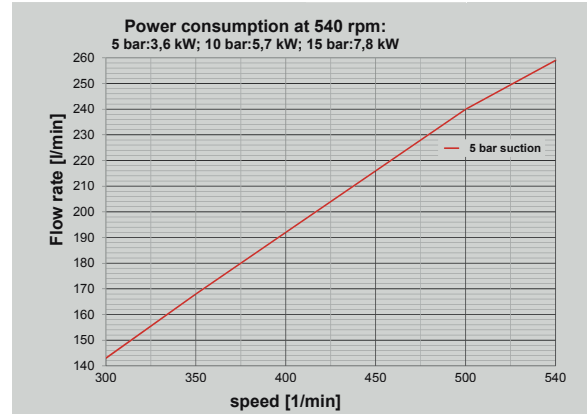

Pump options

Article-No.	Type
82566	Piston diaphragm pump P260
82454	Piston diaphragm pump P260 with hydraulic motor OMR 50 and bracket
More variations on request	
Recommended fittings inlet (AS2)	
--	Fittings to suit G2" male
Recommended fittings outlet (AS1)	
33793	Plug-in hose tail AS30/ ϕ 33/90° cpl
01399	Plug-in hose tail AS30/ ϕ 33 cpl

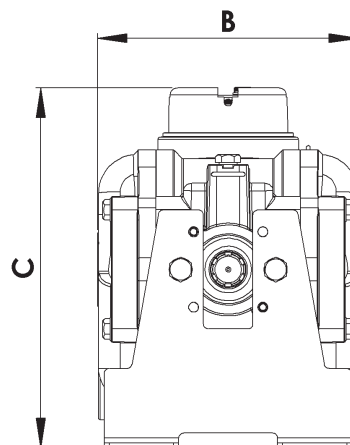
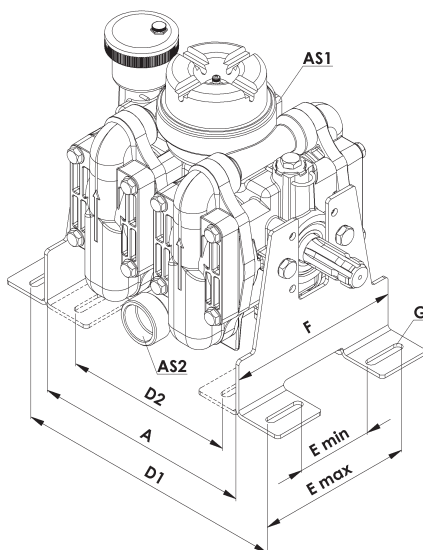

A	B	C
316	264	360
D1	D2	E _{Min}
396	246	110
E _{Max}	F	G
225	250	M12
Specified in mm		



P300

- linear steady state characteristics
- integrated hydraulic accumulator
- through shaft
- safe to run dry (liquid)
- self-priming up to 4 meters dept
- liquid fertiliser-proof (AHL/UAN)

Capacity at 5 bar:	300 l/min
Nominal speed:	540 U/min
Operating time pressure:	max. 15 bar
Short-term pressure:	max. 20 bar
Speed range:	450-600 U/min
Spline shaft:	DIN 9611/ISO 500
Standard working diaphragms:	6 x NBR
Accumulator diaphragms:	1 x NBR
Inlet- ϕ suction side:	2 x G2½ (BSP)
Outlet- ϕ pressure side:	AS40
Lubrication:	Oil bath
Weight:	38 kg
Material:	Cast aluminium, partially anodised, NBR seals, POM, stainless steel: 1.4305

Options:

- Desmopan® diaphragms
- Through shaft
- Hydraulic drive
- Through shaft

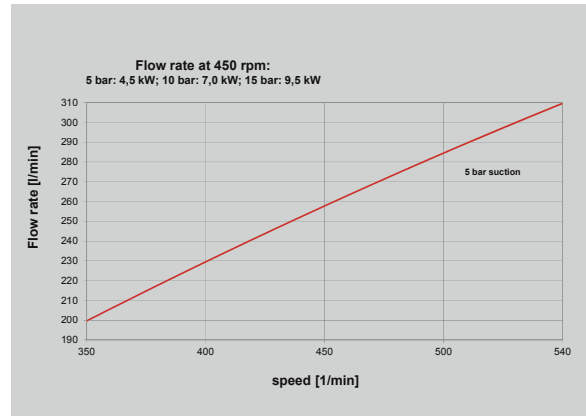

Pump options	
Article-No.	Type
81942	Piston diaphragm pump P300 with bracket and pto protection
More variations on request	
Recommended fittings inlet (AS2 and AS4)	
--	Fittings G2½ male
Recommended fittings outlet (AS1 and AS3)	
08874	Plug-in hose tail AS40/ø33/90° cpl
08275	Plug-in hose tail AS40/ø39/90° cpl
04581	Plug-in hose tail AS40/ø33 cpl
06247	Plug-in hose tail AS40/ø39 cpl
80333	Blank Plug AS40 cpl

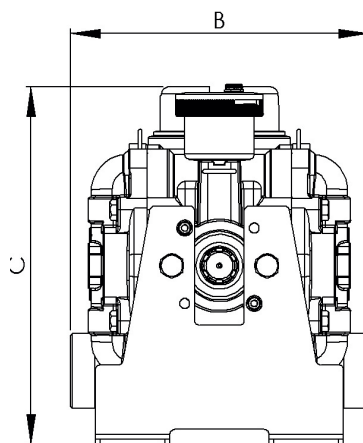
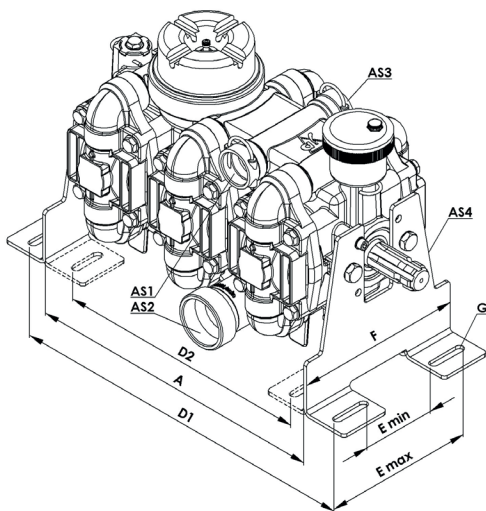

A	B	C
450	300	360
D1	D2	E _{Min}
530	390	110
E _{Max}	F	G
225	250	M12
Specified in mm		



P380

- linear steady state characteristics
- integrated hydraulic accumulator
- through shaft
- safe to run dry (liquid)
- self-priming up to 4 meters depth
- liquid fertiliser-proof (AHL/UAN)

Capacity at 5 bar:	380 l/min
Nominal speed:	540 U/min
Operating time pressure:	max. 15 bar
Short-term pressure:	max. 20 bar
Speed range:	450-600 U/min
Spline shaft:	DIN 9611/ISO 500
Standard working diaphragms:	6 x NBR
Accumulator diaphragms:	1 x NBR
Inlet- ϕ suction side:	2 x G2½ (BSP)
Outlet- ϕ pressure side:	2 x AS40
Lubrication:	Oil bath
Weight:	44 kg
Material:	Cast aluminium, partially anodised, NBR seals, POM, stainless steel: 1.4305

Options:

- **Desmopan® diaphragms**
- **Through shaft**
- **Hydraulic drive**
- **Through shaft**

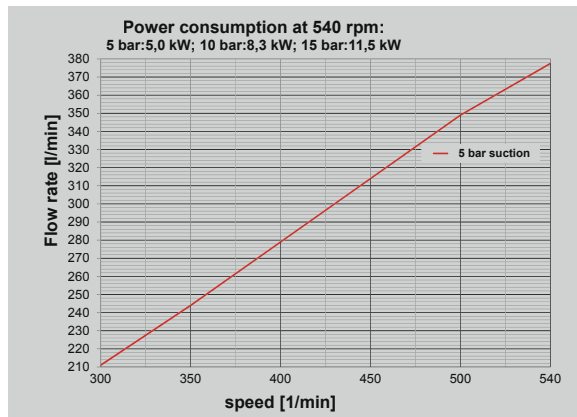

Pump options

Article-No.	Type
83887	Piston diaphragm pump P380
83888	Piston diaphragm pump P380 with bracket and pto protection
More variations on request	
Recommended fittings inlet (AS2 and AS4)	
--	Fittings G2½ male
Recommended fittings outlet (AS1 and AS3)	
08874	Plug-in hose tail AS40/ ϕ 33/90° cpl
08275	Plug-in hose tail AS40/ ϕ 39/90° cpl
04581	Plug-in hose tail AS40/ ϕ 33 cpl
06247	Plug-in hose tail AS40/ ϕ 39 cpl
80333	Blank Plug AS40 cpl

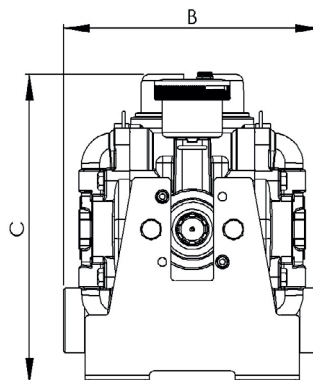
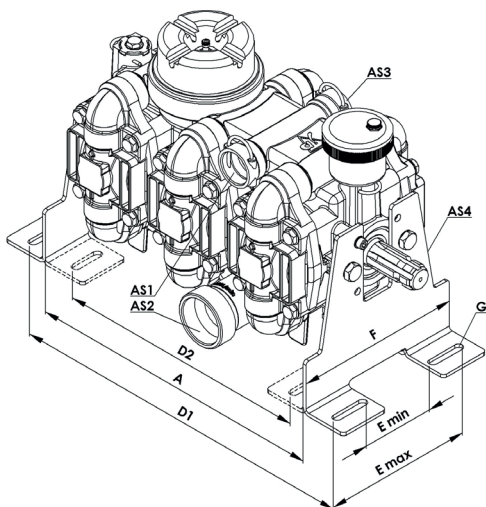

A	B	C
456	300	363
D1	D2	E _{Min}
536	386	110
E _{Max}	F	G
225	250	M12
Specified in mm		



P200/P200

- linear steady state characteristics
- integrated hydraulic accumulator
- safe to run dry (liquid)
- self-priming up to 4 meters depth
- liquid fertiliser-proof (AHL/UAN)

Capacity at 5 bar:	2 x200 l/min
Nominal speed:	540 U/min
Operating time pressure:	max. 15 bar
Short-term pressure:	max. 20 bar
Speed range:	450-600 U/min
Spline shaft:	DIN 9611/ISO 500
Standard working diaphragms:	8 x NBR
Accumulator diaphragms:	2 x NBR
Inlet- ϕ suction side:	2 x AS50
Outlet- ϕ pressure side:	2 x AS30
Lubrication:	Oil bath
Weight:	49,6 kg
Material:	Cast aluminium, partially anodised, NBR seals, POM, stainless steel: 1.4305

Options:

- Desmopan® diaphragms
- Hydraulic drive

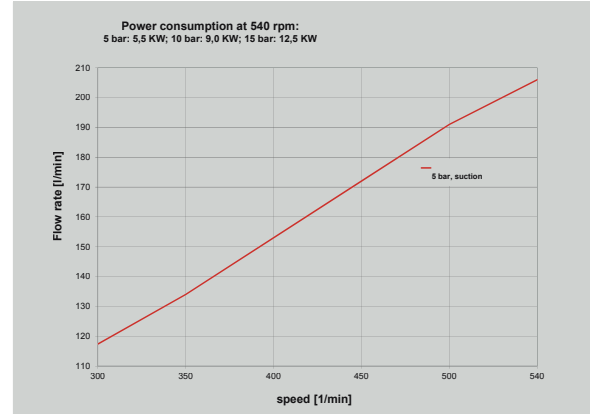

Pump options	
Article-No.	Type
83126	Piston diaphragm pump with bracket and pto protection with two separate P200/P200 out puts
More variations on request	
Recommended fittings inlet (AS2 and AS4)	
17330	Plug-in hose tail AS50/ ϕ 46/90° cpl
17157	Plug-in hose tail AS50/ ϕ 46 cpl
Recommended fittings outlet (AS1 and AS3)	
08337	Plug-in hose tail AS30/ ϕ 25/90° cpl
33793	Plug-in hose tail AS30/ ϕ 33/90° cpl
81119	Plug-in hose tail AS30/ ϕ 25 cpl
01399	Plug-in hose tail AS30/ ϕ 33 cpl

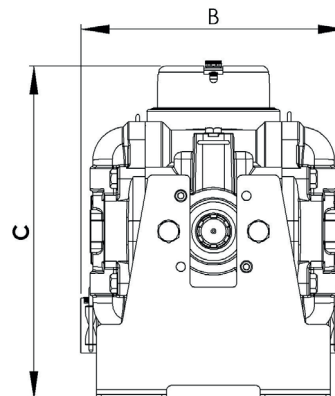
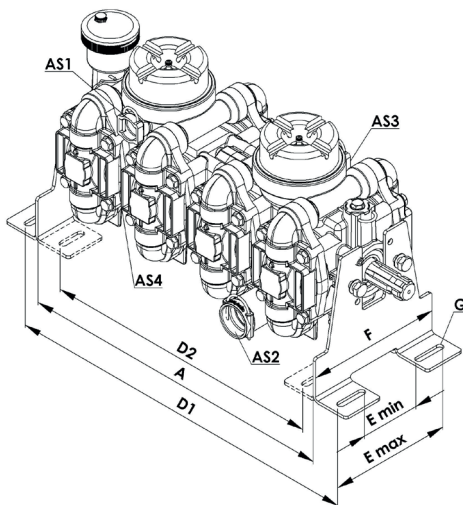

A	B	C
590	283	357
D1	D2	E _{Min}
670	520	110
E _{Max}	F	G
225	250	M12
Specified in mm		



P500

- linear steady state characteristics
- integrated hydraulic accumulator
- safe to run dry (liquid)
- self-priming up to 4 meters depth
- liquid fertiliser-proof (AHL/UAN)

Capacity at 5 bar:	500 l/min
Nominal speed:	540 U/min
Operating time pressure:	max. 15 bar
Short-term pressure:	max. 20 bar
Speed range:	450-600 U/min
Spline shaft:	DIN 9611/ISO 500
Standard working diaphragms:	8 x NBR
Accumulator diaphragms:	1 x NBR
Inlet- \varnothing suction side:	2 x G3 male; d=75 mm
Outlet- \varnothing pressure side:	AS40
Lubrication:	Oil bath
Weight:	52,5 kg
Material:	Cast aluminium, partially anodised, NBR seals, POM, stainless steel: 1.4305

Options:

- Desmopan® diaphragms
- Hydraulic drive



Pump options	
Article-No.	Type
82656	Piston diaphragm pump P500
More variations on request	
Recommended fittings inlet (AS2 and AS4)	
--	Fittings to G3" male
Recommended fittings outlet (AS1 and AS3)	
08874	Plug-in hose tail AS40/ \varnothing 33/90° cpl
08275	Plug-in hose tail AS40/ \varnothing 39/90° cpl
04581	Plug-in hose tail AS40/ \varnothing 33 cpl
06247	Plug-in hose tail AS40/ \varnothing 39 cpl
80333	Blank Plug AS40 cpl

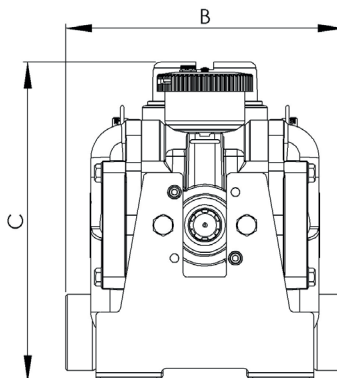
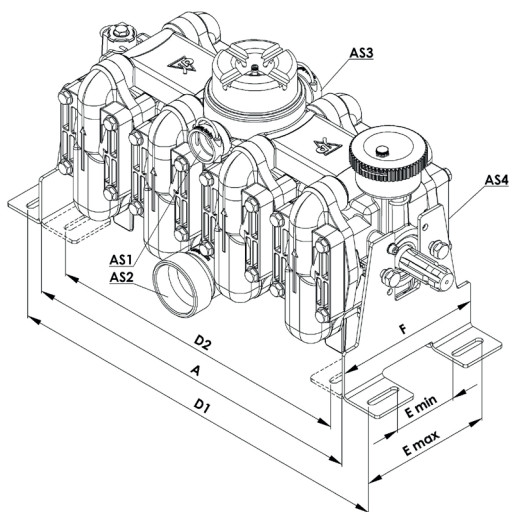

A	B	C
596	320	367,5
D1	D2	E _{Min}
676	526	110
E _{Max}	F	G
225	250	M12
Specified in mm		



P260/P260

- linear steady state characteristics
- integrated hydraulic accumulator
- safe to run dry (liquid)
- self-priming up to 4 metres depth
- liquid fertiliser-proof (AHL/UAN)

Capacity at 5 bar:	2 x 260 l/min
Nominal speed:	540 U/min
Operating time pressure:	max. 15 bar
Short-term pressure:	max. 20 bar
Speed range:	450-600 U/min
Spline shaft:	DIN 9611/ISO 500
Standard working diaphragms:	8 x NBR
Accumulator diaphragms:	2 x NBR
Inlet- \varnothing suction side:	2 x G2 male, d=47
Outlet- \varnothing pressure side:	2 x AS30
Lubrication:	Oil bath
Weight:	56 kg
Material:	Cast aluminium, partially anodised, NBR seals, POM, stainless steel: 1.4305

Options:

- Desmopan® diaphragms
- Hydraulic drive

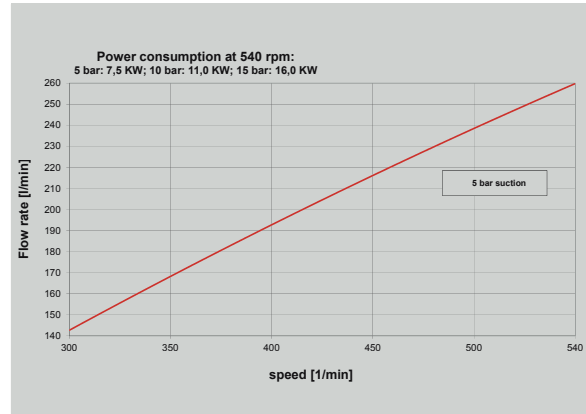

Pump options

Article-No.	Type
83419	Kolbran pump P260/P260 with bracket and pto protection
More variations on request	
Recommended fittings inlet (AS2)	
--	Fittings G2" BSP male
Recommended fittings outlet (AS1)	
33793	Plug-in hose tail AS30/ \varnothing 33/90° cpl
01399	Plug-in hose tail AS30/ \varnothing 33 cpl

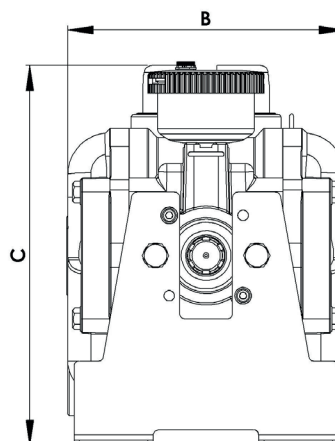
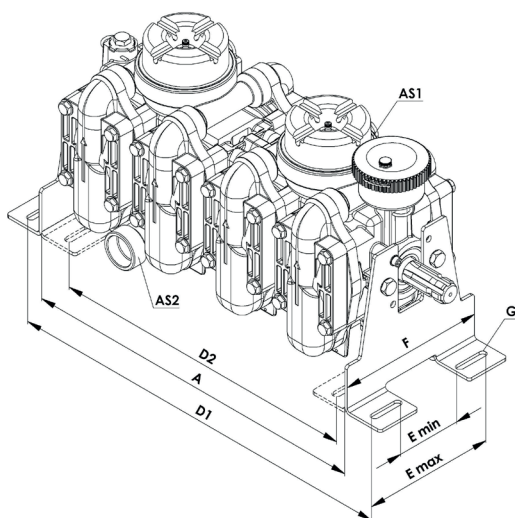

A	B	C
596	262	360
D1	D2	E _{Min}
676	526	110
E _{Max}	F	G
225	250	M12
Specified in mm		



P260/P260/P260

- linear steady state characteristics
- integrated hydraulic accumulator
- safe to run dry (liquid)
- self-priming up to 4 metres depth
- liquid fertiliser-proof (AHL/UAN)

Capacity at 5 bar:	3 x 260 l/min
Nominal speed:	540 U/min
Operating time pressure:	max. 15 bar
Short-term pressure:	max. 20 bar
Speed range:	450-600 U/min
Spline shaft:	DIN 9611/ISO 500
Standard working diaphragms:	12 Desmopan®
Accumulator diaphragms:	3 x NBR
Inlet-Ø suction side:	3 x G2" male; d=47
Outlet-Ø pressure side:	3 x AS30
Lubrication:	Oil bath
Weight:	86 kg
Material:	Cast aluminium, partially anodised, NBR seals, POM, stainless steel: 1.4305

Options:

- Hydraulic drive

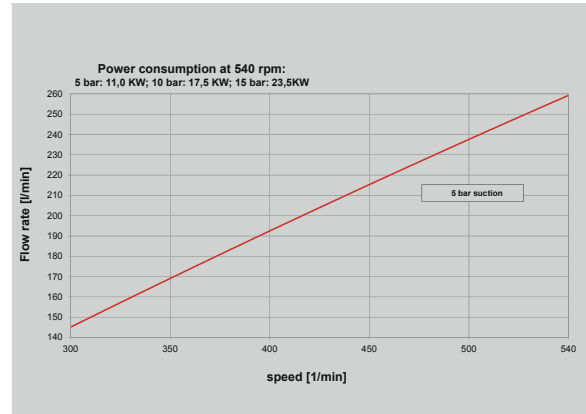

Pump options	
Article-No.	Type
83347	piston diaphragm pump P260/P260/P260 with bracket and pto protection
More variations on request	
Recommended fittings inlet (AS2 / AS4 / AS6)	
--	Fittings to G3" male
Recommended fittings outlet (AS1 / AS2 / AS5)	
33793	Plug-in hose tail AS30/Ø33/90° cpl
01399	Plug-in hose tail AS30/Ø33 cpl

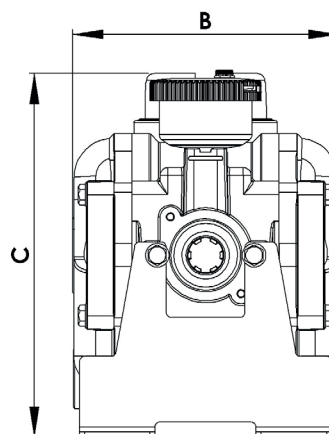
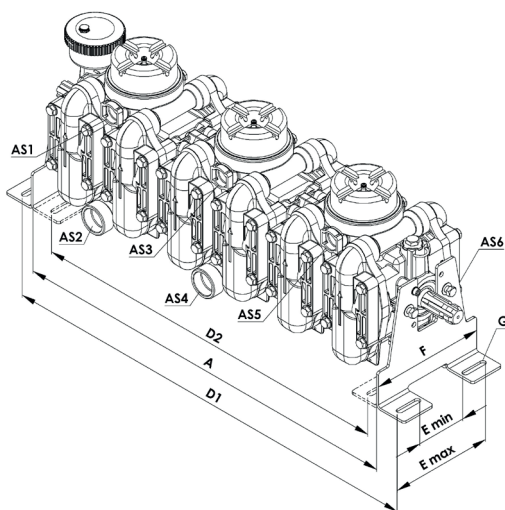

A	B	C
876	264	360
D1	D2	E _{Min}
956	806	110
E _{Max}	F	G
225	250	M12
Specified in mm		



Working diaphragms

- high durability
- materials for all purposes
- solvent proof
- low cost

Product	Article-No.	Type	Material	D mm	d mm
1 Working diaphragms 	80629	Diaphragm N P70/P150 with double-side lip and hole, standard series	NBR	106	--
	80630	Diaphragm N P100/P200/P300 with double-side lip and hole, standard series	NBR	121	--
	81522	Diaphragm N P120/P260/P380/P500 with double-side lip and hole, standard series	NBR	127	14
2 Working diaphragms 	83443	Diaphragm D-LL P70/P150 with double-side lip and hole	Desmopan®	106	14
	83441	Diaphragm D-LL P100/P200/P300 with double-side lip and hole,	Desmopan®	121	14
	83228	Diaphragm D-LL P120/P260/P380/P500 with double-side lip and hole	Desmopan®	127	14
3.1 Working diaphragms 	07239	Diaphragm N P70/P150 without hole	NBR	106	-
	22800	Diaphragm N P100/P200/P300 without hole	NBR	121	-
	19056	Diaphragm N P120 without hole	NBR	127	-
	80075	Diaphragm N P260/P380/P500 with hole and one-side lip	NBR	127	14
3.2 Working diaphragms 	13969	Diaphragm V P70/P150 without hole	Viton®	106	-
	19057	Diaphragm V P120 without hole	Viton®	127	-
4 Accumulator diaphragms 	02627	Accumulator diaphragms N P70/P150/P50	NBR	101	-
	02709	Accumulator diaphragms N P100/P120/P200/P260/P300/P380/P500	NBR	128	-

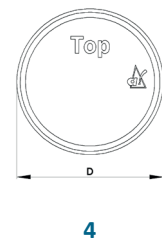
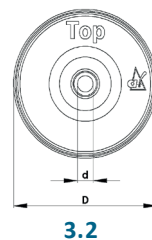
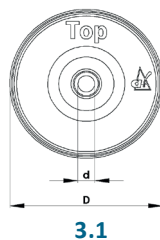
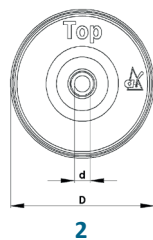
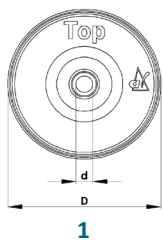

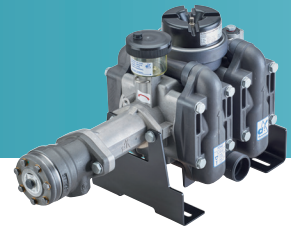

Mounting parts hydraulic drive P70–P380

- retrofitable to existing pumps
- hydraulic easy mounting of motors

P70–P380		
Article-No.	Type	Material
81572	coupling hydraulic motor P70-P380	Steel
81574	mounting flansh for hydraulic motor P70- P380	Aluminium
81576	hydraulic motor OMR 50 151-0710	Steel
81571	shim (4x)	Steel
02622	bracket	Steel
47561	bolt for bracket (2x)	Steel
02644	bolt for mounting flansh for hydrulic motor (2x)	Steel



82607



81572



81576



81571



Mounting parts hydraulic drive >P380

> P380		
Article-No.	Type	Material
83442	Coupling hydraulic motor P500	Steel
82607	Mounting flansh for hydraulic motor P500	Aluminium
83387	Hydromotor OMS 100	Steel
81571	shim (4x)	Steel
02622	bracket	Steel
47561	bolt for bracket (2x)	Steel
02644	Schrauben für den Flansch für Hydromotoren (2x)	Steel



82607



83442



83387 OMS 100



81571



Mounting parts pump variation

Mounting parts pump variation	
Article-No.	Type
81568	Safety cap through drive pump
81595	pto guard, D= 210 mm; L = 19 mm
83925	pto guard, D= 260 mm; L = 210 mm



81568

Safety cap through drive pump

81595

