

SECURE IT WITH EASE

QWIK-CLAMP™

- MULTI-FUNCTIONALITY
- QUICK AND EASY INSTALLATION
- SECURE, ROBUST AND CORROSION RESISTANT

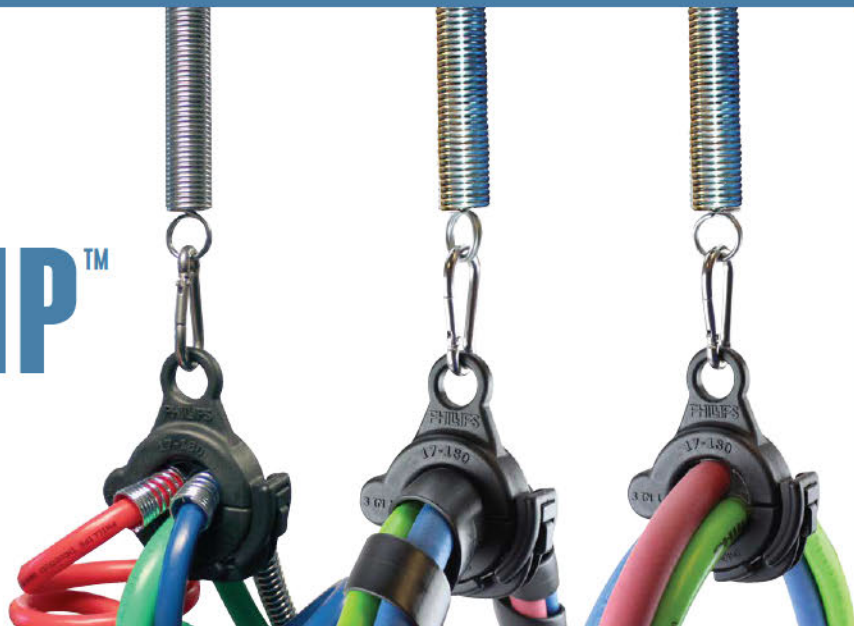

Multi-Functionality

Can be converted from a 1, 2, or 3-hose holder to a cable clamp for a 3-IN-1 by removing the insert.

For 3-IN-1 Applications

Without insert



Non-Corrosive and UV Resistant

Clamp and insert are made of non-corrosive and UV resistant durable nylon for extreme weather, corrosion and impact resistance.

Working Temperature

-40°F to 150°F (-40°C to 66°C)

Patent No. 10436352

17-180 QWIK-CLAMP™ with insert

17-181 QWIK-CLAMP™ without insert*

*Standard on all Phillips premium 3-IN-1 electrical and air combination assemblies with QCP™ or QCMS2™/QCP™ plugs.

WE MAKE PRODUCTS THAT MAKE A DIFFERENCE®

Stainless Steel Snap-On Clip

For quick installation onto a tender spring or pogo stick.

No Hassle Installation

Quick, easy, and no tools required. Installs in seconds, and cable location adjustment is easy.

Secure Draw Latch

No accidental releases, clamp remains secure and tightly locked.

Positive Lock

Stays connected at over 100lbs of pull force.

Clamp Ridges

Clamp remains in place, securely gripping the 3-IN-1, no sliding.

Recommended Assembly/Cable Sizes

3-IN-1: Clamp will support Phillips 3-IN-1s or assemblies approximately 1.60" in diameter.

Hose Holder: Supports straight ABS electrical cables and 3/8" rubber air hoses, or coiled ABS electrical cables and nylon air lines with longer leads.

12070 BURKE STREET, SANTA FE SPRINGS, CA 90670

800.423.4512 FAX 800.597.7757

PHILIPS

INSTALLATION INSTRUCTIONS

WITH INSERT FOR INDIVIDUAL CABLES

1. Unlock the QWIK-CLAMP™
2. Remove the insert
3. Place insert on the hose(s)
Note: For installation on coiled nylon air lines, the insert should be placed on the spring guard of a 40", or longer, tractor side lead. It should never be installed directly on the tubing.
4. With the insert installed on the hose(s), place the insert in the open clamp. We recommend the heaviest cable be placed at the bottom and that the edges of the insert line up with the clamp ridges.
5. Close, lock, and install the QWIK-CLAMP™ on a tender spring or pogo stick

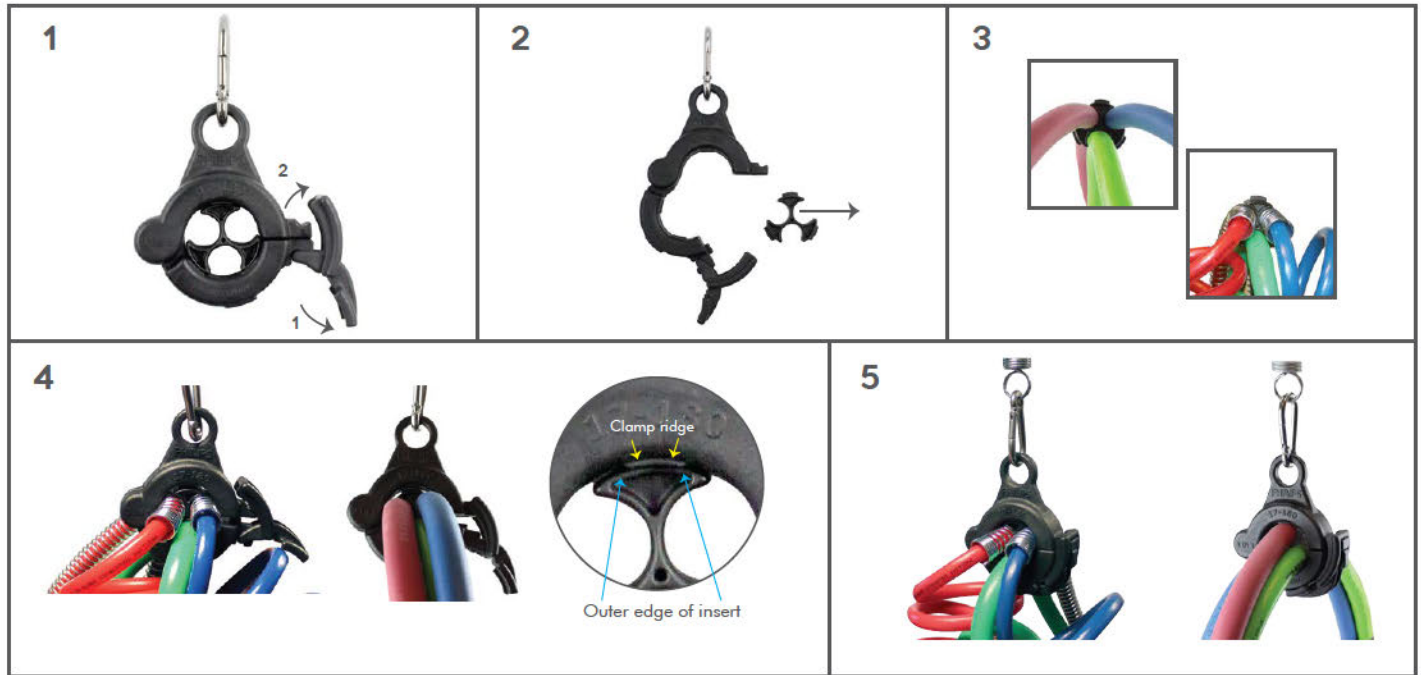

WITHOUT INSERT - FOR 3-IN-1

1. Unlock the QWIK-CLAMP™
2. If there is an insert, remove it and store in a safe place if needed for later
3. Place 3-IN-1 in the QWIK-CLAMP™
4. Close, lock and install the QWIK-CLAMP™ on a tender spring or pogo stick



WE MAKE PRODUCTS THAT MAKE A DIFFERENCE®

12070 BURKE STREET, SANTA FE SPRINGS, CA 90670
800.423.4512 FAX 800.597.7757

PHILIPS