

KS/KSE 104 Multipole Cable Mounted Receptacles

All dimensions see note 1)

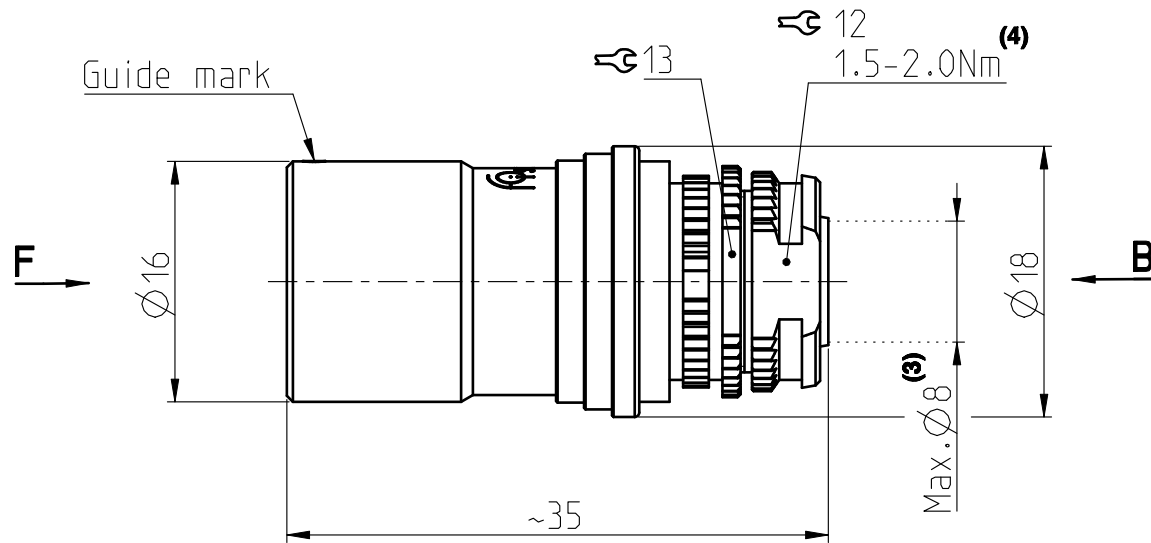

Contact polarity A

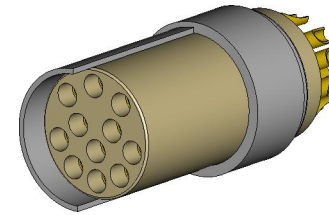

Contact polarity Z

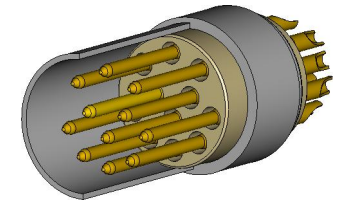

CONTACT CONFIGURATION			Contacts	Solder cup \varnothing	Crimp cup \varnothing ⁽²⁾
104	A Z	051	2	1.86	-
104	A Z	040	3	1.86	1.78
104	A Z	037	4	1.18	1.18
104	A Z	087	4	0.79/2.48	-
104	A Z	053	5	1.18	-

Contact configuration for polarity A (View from B)

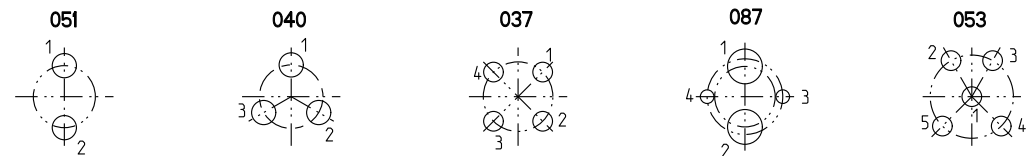

Keying codes (View from F)

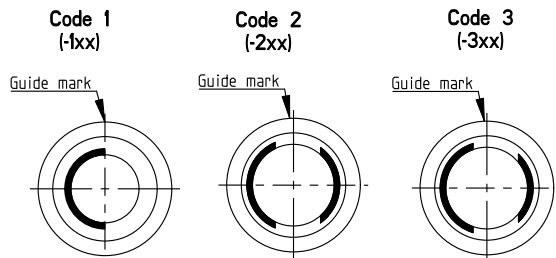

Contact configuration for polarity Z (View from B)

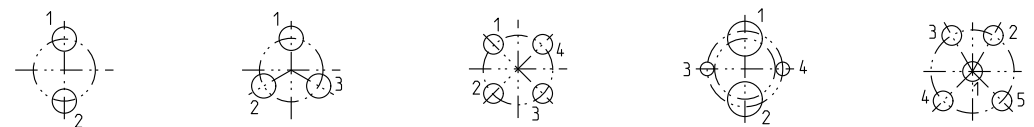

All dimensions in mm

600524

Rev.

2

Pages

1/3

Notes :

- 1) All tolerances resulting from connector assembly are typically $\pm 0.3\text{mm}$
 - 2) For optimum crimping refer to available crimping manual.
 - 3) Max cable diameter below shield
- Part number example : KSE 104 A056-130

4) This torque is a recommended value that may be influenced by the characteristics of the cable. Tests have to be made to evaluate the exact value. To secure the back nut, we recommend the use of thread locking adhesive.

fischer
CONNECTORS

www.fischerconnectors.com

KS/KSE 104 Multipole Cable Mounted Receptacles

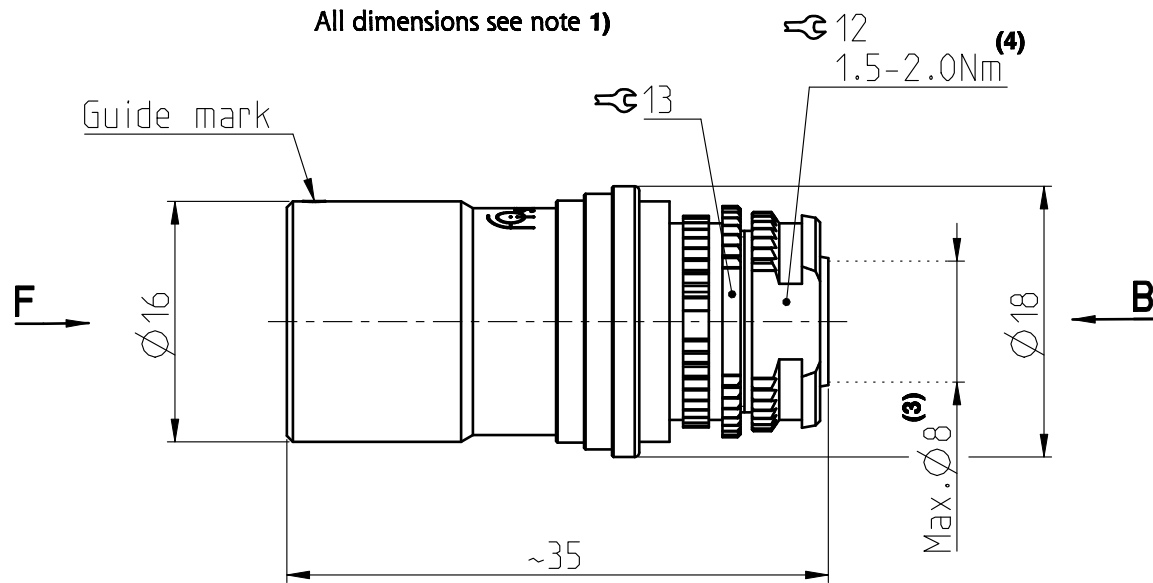

Contact polarity A

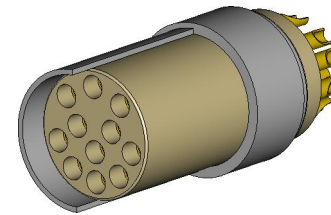

Contact polarity Z

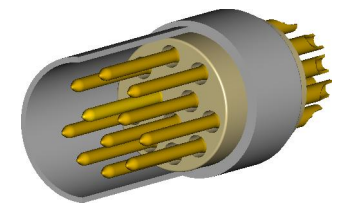

CONTACT CONFIGURATION	Contacts	Solder cup Ø		Crimp cup (2) Ø
104 A Z 065	6	0.79		0.80
104 A Z 054	7	0.79		-
104 A Z 066	8	0.79		0.80
104 A Z 055	9	0.79/1.18		-
104 A Z 056	11	0.79		0.80

Contact configuration for polarity A (View from B)

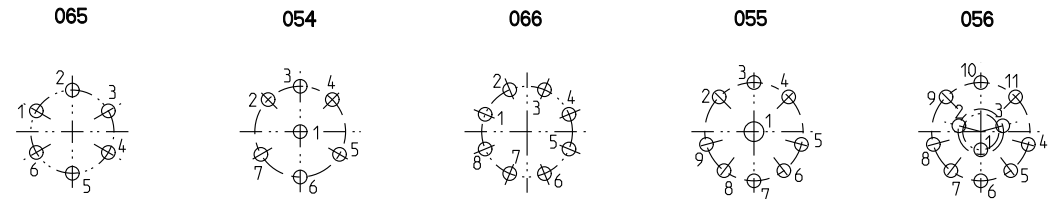

Keying codes (View from F)

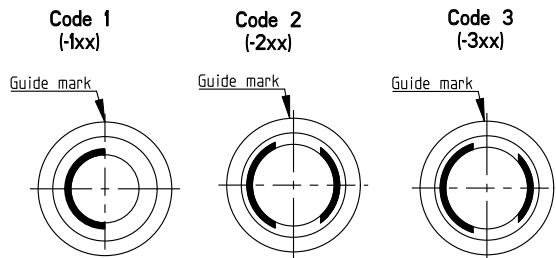

Contact configuration for polarity Z (View from B)

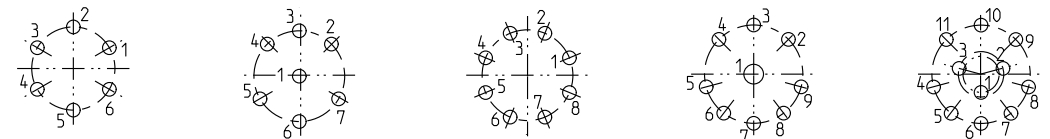

All dimensions in mm

600524

Rev.

2

Pages

2/3

Notes:

- 1) All tolerances resulting from connector assembly are typically ± 0.3 mm
 - 2) For optimum crimping refer to available crimping manual.
 - 3) Max cable diameter below shield
- Part number example : KSE 104 A056-130

4) This torque is a recommended value that may be influenced by the characteristics of the cable. Tests have to be made to evaluate the exact value. To secure the back nut, we recommend the use of thread locking adhesive.

fischer
CONNECTORS

www.fischerconnectors.com

KS/KSE 104 Multipole Cable Mounted Receptacles

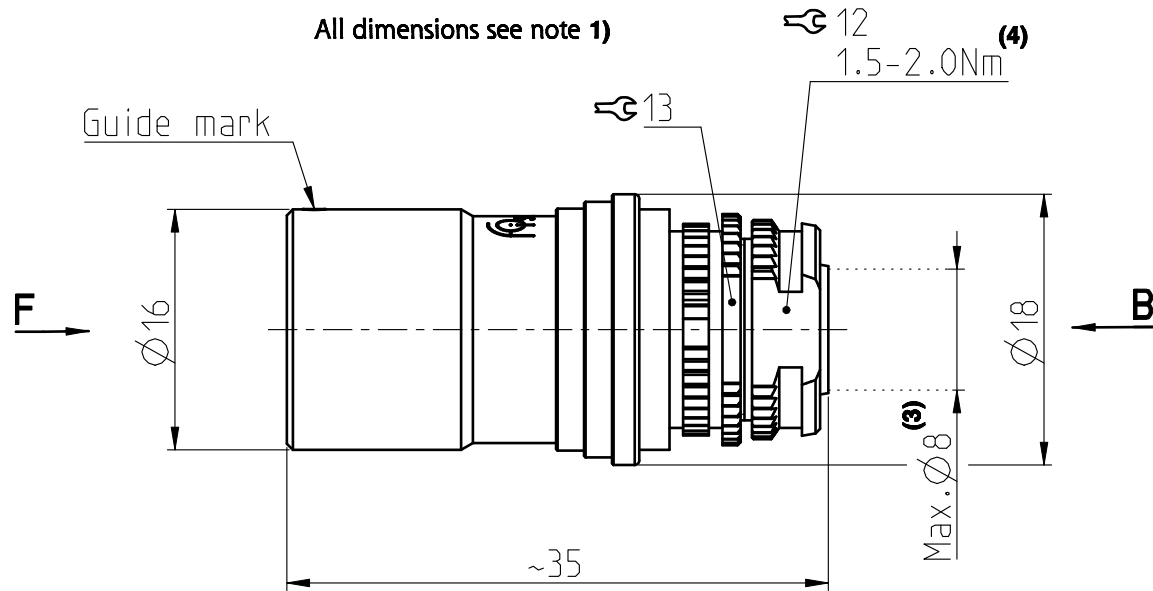

Contact polarity A

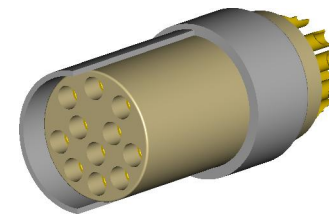

Contact polarity Z

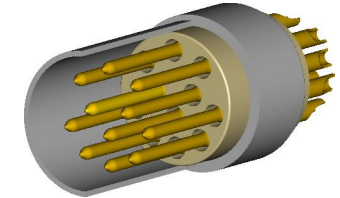

CONTACT CONFIGURATION	Contacts	Solder cup Ø	Crimp cup Ø ⁽²⁾
104 A Z 086	16	0.79	0.60
104 A Z 092	19	0.79	0.60
*104 A 124	27	-	0.43

*Please contact us for additional information

Contact configuration for polarity A (View from B)

086

092

124

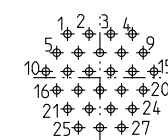
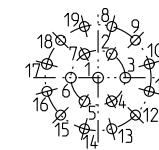
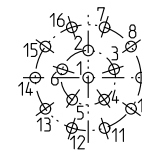

Keying codes (View from F)

Code 1 (-1xx)

Code 2 (-2xx)

Code 3 (-3xx)

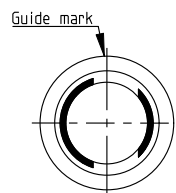
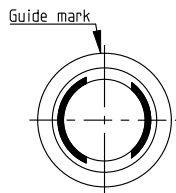
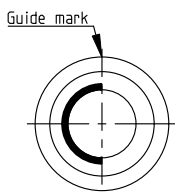

Contact configuration for polarity Z (View from B)

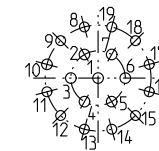
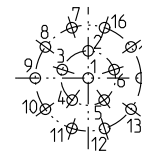

All dimensions in mm

600524

Rev.

2

Pages

3/3

Notes :

- 1) All tolerances resulting from connector assembly are typically ± 0.3 mm
 - 2) For optimum crimping refer to available crimping manual.
 - 3) Max cable diameter below shield
- Part number example : KSE 104 A056-130

4) This torque is a recommended value that may be influenced by the characteristics of the cable. Tests have to be made to evaluate the exact value. To secure the back nut, we recommend the use of thread locking adhesive.

fischer
CONNECTORS

www.fischerconnectors.com