

# PUH-TOKE WEST | *In the Pines*



A true source of pride for your family for years to come, the Puh-Toke West home is log home living at its finest. Complete with a porte cochere and covered outdoor deck, this 6000 sf plan handles family and friends with ease. Enjoy views from a two story Glass Forest® while entertaining from your custom bar, or spend warm summer nights on the cozy front porch. Designed for practical living with superior attention to detail evident in each log, Puh-Tok West will make you wish every day was a weekend away at the cabin.

Client Wants: A log vacation home that is warm, sturdy, and fits into the mountain setting. Lots of windows, two master separated by living space, minimal bedrooms, but the ability to sleep many guests.



13526 Hwy 55  
McCall, ID 83638  
ph#: (208) 634-0055

6254 E. Parks Rd (PO Box 509)  
Athol, Idaho, 83801  
ph#: 208-683-1444  
fax: 208-683-0549

brian@edgewoodlog.com  
www.edgewoodlog.com

# PUH-T O K E W E S T | *In the Pines*

**Square Footage:** 6,382

**Location:** Breckenridge, Colorado

**Bedrooms / Baths:** 3 / 6

**Contractor:** Owner / Builder

**Built:** 2001

**Services by Edgewood:** Master Site/Project Planning, Architectural Design/Structural Engineering, Interior and Lighting Design, Delivery, On-site Installation of Edgewood's Custom Weathertight Materials Package

**Package Details:** Custom Full Log Package consisting of massive 13" ave. diameter log walls, loft, and 16" ave. diameter log roof structure. Custom solid wood windows and doors with precut log bucks around.

**Special Features:** Edgewood's proprietary engineered architectural Glass Forest®. Custom hand-crafted spiral stair system.

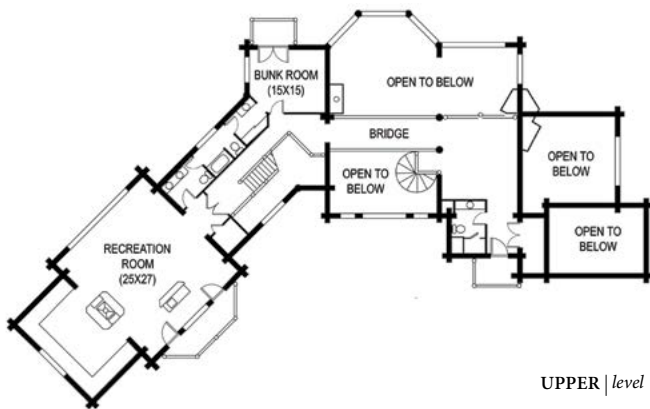
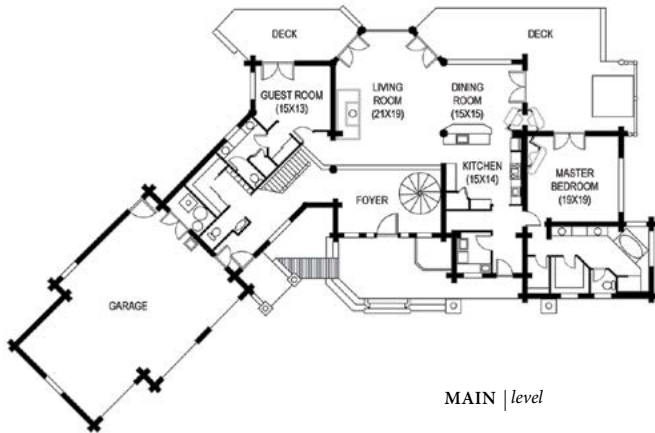

### Reference Letter from Owner:

*"We've all heard stories from people that have had bad experiences building custom homes. It has been a pleasant surprise to be able to look back and realize that, with Edgewood's guidance, it was a smooth and error free experience for us. Thanks to everyone".*

*~ Homeowner*



13526 Hwy 55  
McCall, ID 83638  
ph#: (208) 634-0055

6254 E. Parks Rd (PO Box 509)  
Athol, Idaho, 83801  
ph#: 208-683-1444  
fax: 208-683-0549

brian@edgewoodlog.com  
www.edgewoodlog.com