

**Please use these install instructions in conjunction with the Natural Light Tubular Skylight fitting instructions (available from [rooflightsandglazing.co.uk](http://rooflightsandglazing.co.uk)) to complete the entire installation.**

**All electrical products should be fitted by a fully trained electrical contractor.**

**1.** Locate the desired placement for the ceiling diffuser to achieve the most light in the room, making sure that there are no obstructions in the roof void. Locate the centre of the ceiling trusses or framing and tap nail to the centre of the location where the unit will be installed. Attach a 7.375" (187.5mm) piece of string to the end of the nail and to a pencil (see Figure 1). Scribe a circle on the ceiling and using a drywall saw, cut out a 14.75" (375mm) circle.

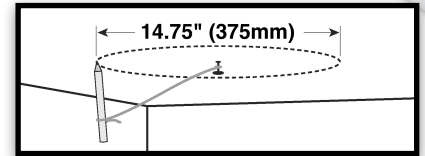

Figure 1

**2.** Install the decorative diffuser trim ring into the cowling (exhaust) with (2) self tapping screws (Figure 2). **NOTE:** Raw aluminium ceiling ring from 10" (254mm) Tubular Skylight kit is extra and not used in this install.

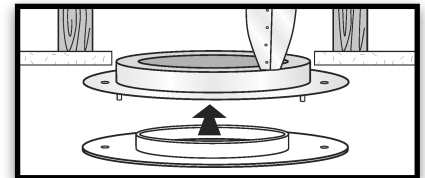

Figure 2

**3.** Install the large cowling (exhaust) into the ceiling, directing the exhaust tube towards the where the fan motor (supplied & installed by others) will be installed. Secure unit with (4) speed nut anchors and screws provided (see Figure 3).

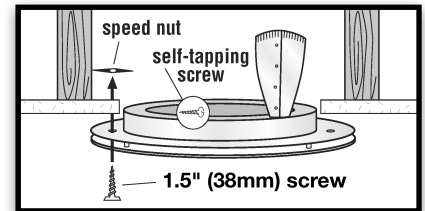

Figure 3

**4.** Install the decorative trim ring into the larger cowling until snug (see Figure 4) after light pipe has been installed in the roof void.

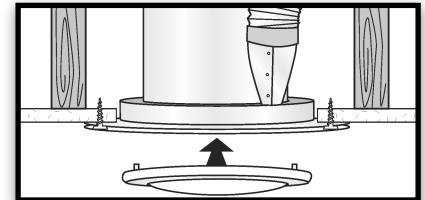

Figure 4

**5.** Install the fan motor (supplied & installed by others) in a suitable location as far away from the ceiling assembly as possible (approximately 3 to 4 feet) a noise reducing mounting bracket should be used if possible. Wire the fan motor according to your local or national electrical codes.

**6.** Install 4" (100mm) foil ducting (supplied & installed by others) from the SVFAN to the fan motor (supplied & installed by others) using 4" (100mm) hose clamps on the motor clamp the duct pipe into position around the vent exhaust section (see Figure 5).

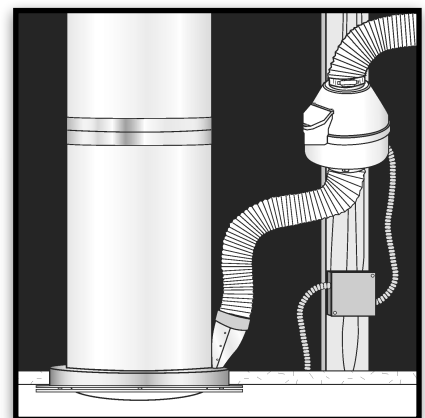

Figure 5

**7.** Install 4" (100mm) foil ducting (supplied & installed by others) from the fan motor output to a suitable vent on the roof or soffit/fascia (see Figure 6).

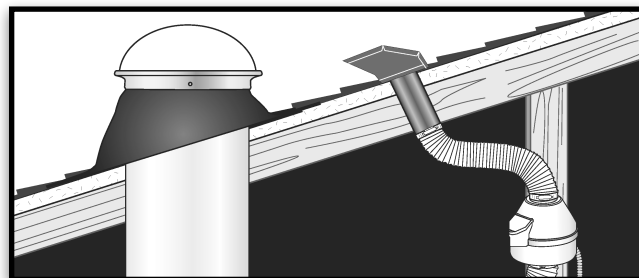

Figure 6

**8.** Complete the installation of the 10" (254mm) tubular skylight using the installation instructions.