

duo swing

INSTALLATION INSTRUCTION

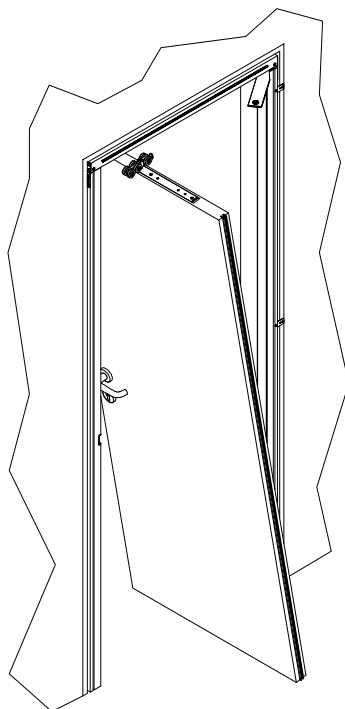

All rights are reserved - Duplication or divulgation without authorization is strictly forbidden.

1

Parts list

No.	Qty.	Description
100	1	Track
115	1	Upper arm
120	1	Hinge-side bracket
130	1	Lock-side bracket
145	1	Track cover
155	1	Upper plate with carriage
165	1	Connecting rod
175	1	Lower plate
185	1	Lower arm
195	1	Lower bracket
205	4	Screws TSPei M4x10
210	5	Screws TSPcr Ø4x40
220	2	Screws TSPcr Ø3x10
230	1	Screws TSPei M5x12
240	2	Track cover cap
250	2	Insert for cover track fixing
260	7	Screws TSPcr Ø3,5x30
270	1	Set for lock "Mediana Evolution"
280	1	Hexagonal screwdriver mm 2,5
295	2	Spacer
305	1	Doorpost
315	1	Upper pivot
325	2	Rod rotation brass
335	1	Fixing pin upper arm
345	8	Screws TSPcr Ø3,5x22
355	3	Fixing clamp
365	3	Screws TCor Ø3,5x13
375	1	Hexagonal key mm 2,5

2

* Please ignore this page if a standard UK door size is being used (686x1981 , 762x1981, 838x1981 mm).
If the door width is non standard size, the top track can be cut accordingly, please follow the steps below ;
Base - Large - Small

1st step: cut the track on the shown side
side to cut

2nd step: drill the hole Ø5 on both sides for M5 TSPei screw and shorten the small wings

3rd step: shorten the profile of the track cover on the shown side. Cover track length with cap LC = A - (1+2 mm.)

connecting rod side

Minimum dimension 681 mm. with arm LB = LFM - 29 mm
Minimum dimension 581 mm. with arm [BASE] (With "Soft Opening" minimum dimension 771 mm)
Minimum dimension 1071 mm. with arm [SMALL] (With "Soft Opening" minimum dimension 571 mm)
Minimum dimension 1071 mm. with arm [LARGE] (With "Soft Opening" minimum dimension 1071 mm)

LFM	LB
WALL HOLE WIDTH	TRACK LENGTH
700	671
725	696
750	721
775	746
825	796
875	846
925	896
975	946

LB = LFM - 29

track cover caps

3

Please note that door preparation is explained in full technical instruction.

* arm side

* lock side

Cut 2 slots for the brush strip supplied (6/6.5mm)

Upper plate

1 - pull the existing spring latch

2 - put the spring latch

Serratura Mechanical lock (AGB Mediana Evolution)

Serratura Magnetic lock

Lower plate

4

Install the upper and lower arms into the rod which is already inside the aluminium profile and mind the alignment, when you insert the brasses be careful to the kingpins on the bearing brasses: they must be inserted in the hexagons screws.

Attention !
Tighten firmly the screws (205) with the allen key 2.5 mm. Make sure that the arm firmly screwed on the connecting rod.

Part List		
No.	Qty.	Description
115	1	Upper arm
165	1	Connecting rod
185	1	Lower arm
305	1	Doorpost
325	2	Rod rotation brass
205	4	Screw TSPei M4x10

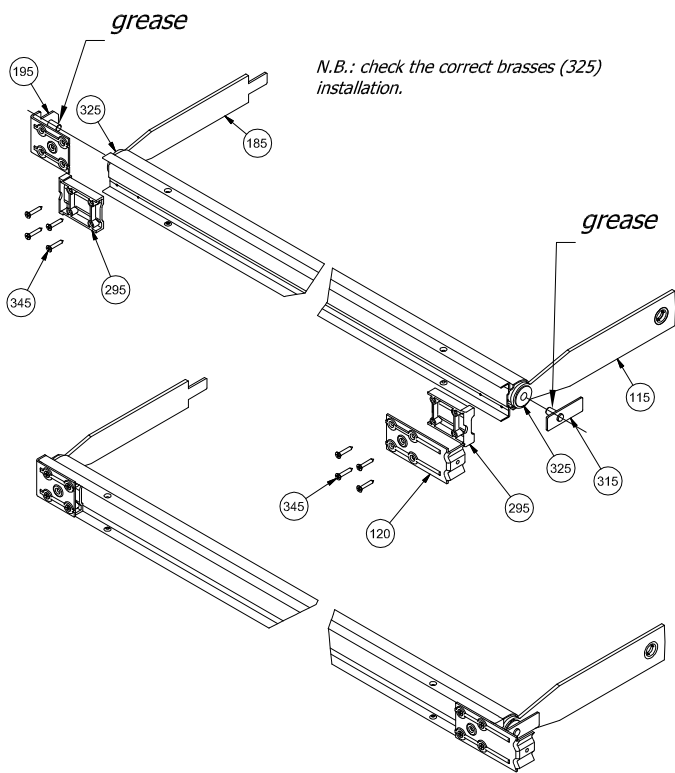

N.B.: check the correct brasses (325) installation.

Parts list		
No.	Qty.	Description
115	1	Upper arm
120	1	Hinge-side bracket
185	1	Lower arm
195	1	Lower Bracket
295	2	Spacer
315	1	Upper pivot
325	2	Rod rotation brass
345	8	Screw TSPcr Ø3,5x22

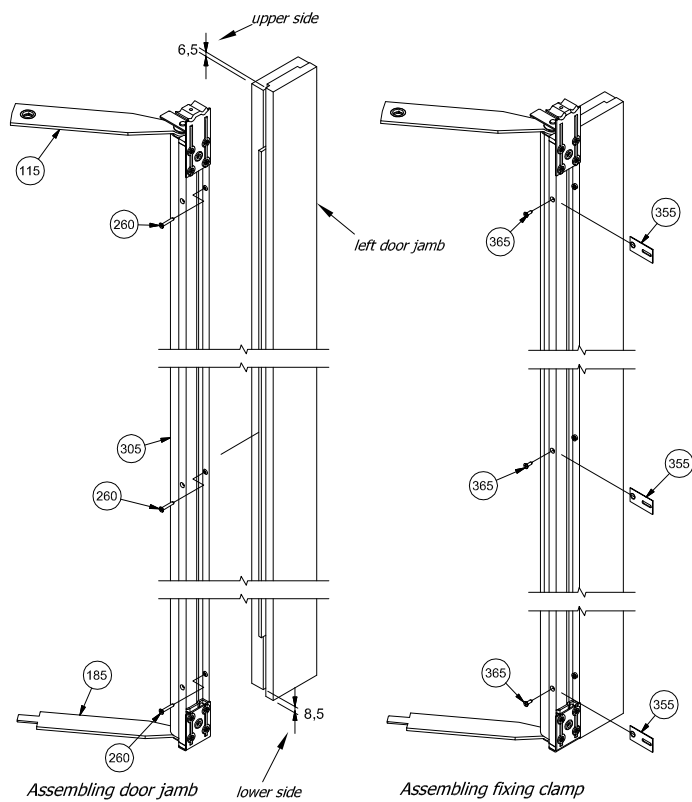

Parts list		
No.	Qty.	Description
115	1	Upper arm
185	1	Lower arm
260	3	Screw TSPcr Ø3,5x30
305	1	Doorpost
355	3	Fixing clamp
365	3	Screw TSPcr Ø3,5x13

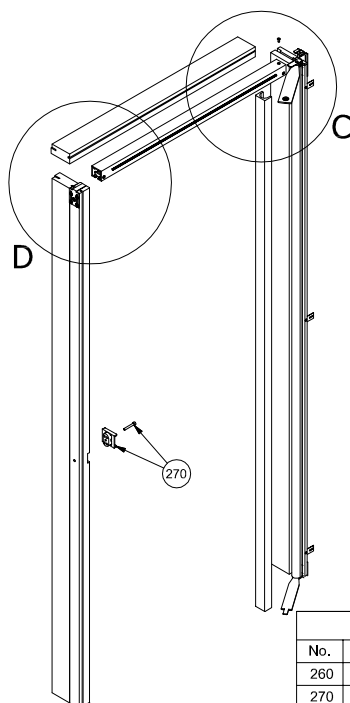

Please note that jamb kit preparation is explained in full technical instruction.

N.B. details (see page 8) C - D

Part list		
No.	Qty.	Description
260	3	Screws TSPcr Ø3,5x30
270	1	Set for lock
355	3	Fixing clamp
365	3	Screw TSPcr Ø3,5x13

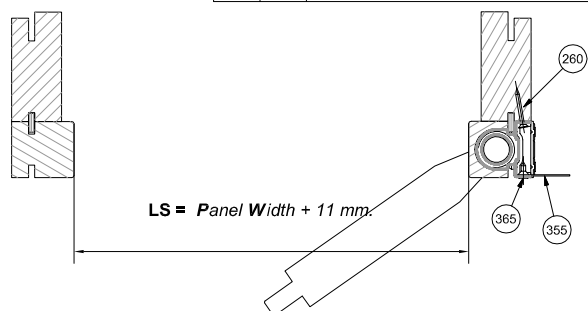

LS = Panel Width + 11 mm.

details C - D

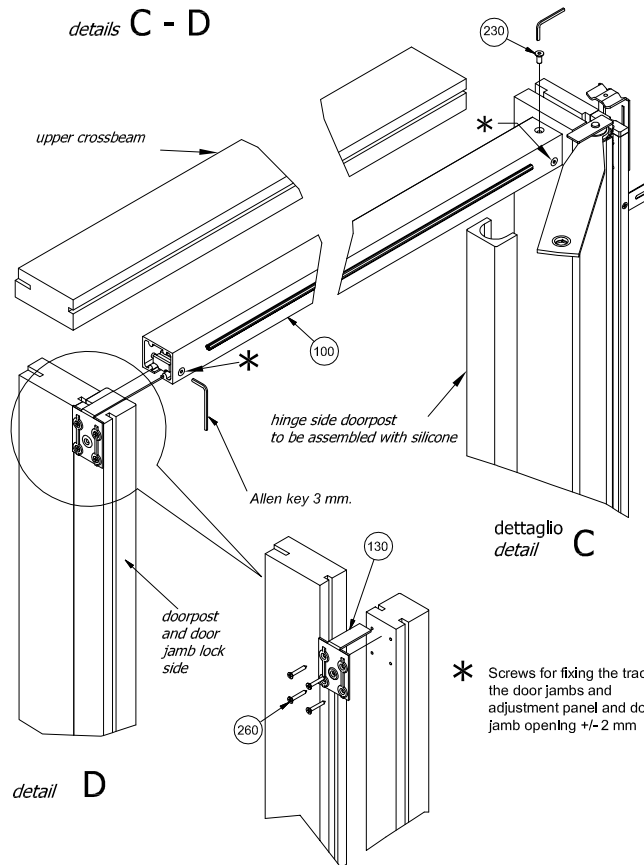

* Screws for fixing the track to the door jambs and adjustment panel and door jamb opening +/- 2 mm

Parts list		
No.	Qty.	Description
100	1	Track
130	1	Lock-side bracket
230	1	Screw TSPei M5x12
260	4	Screws TSPcr Ø3,5x30

N.B. The top track and door jambs must be levelled and plumbed precisely.

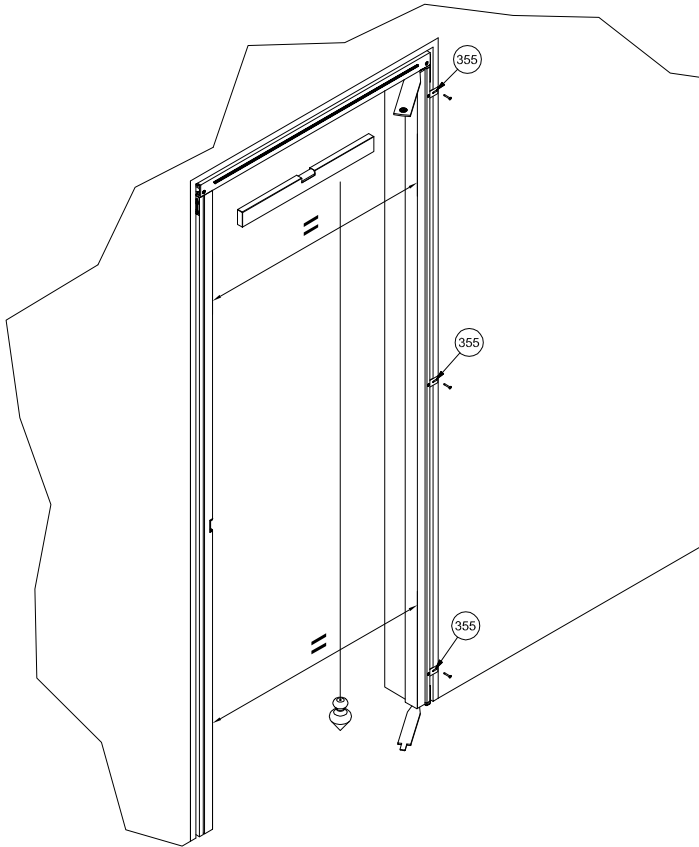

Parts list		
No.	Qty.	Description
355	3	Fixing clamp

DOOR PANEL INSTALLATION

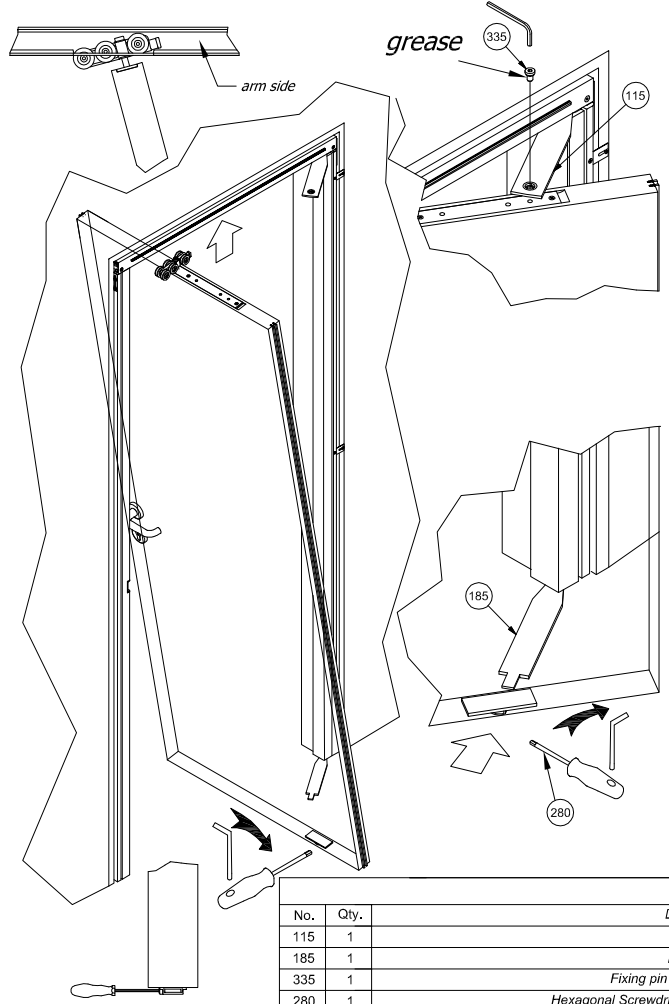

Parts list		
No.	Qty.	Description
115	1	Upper arm
185	1	Lower arm
335	1	Fixing pin upper arm
280	1	Hexagonal Screwdriver 2,5mm

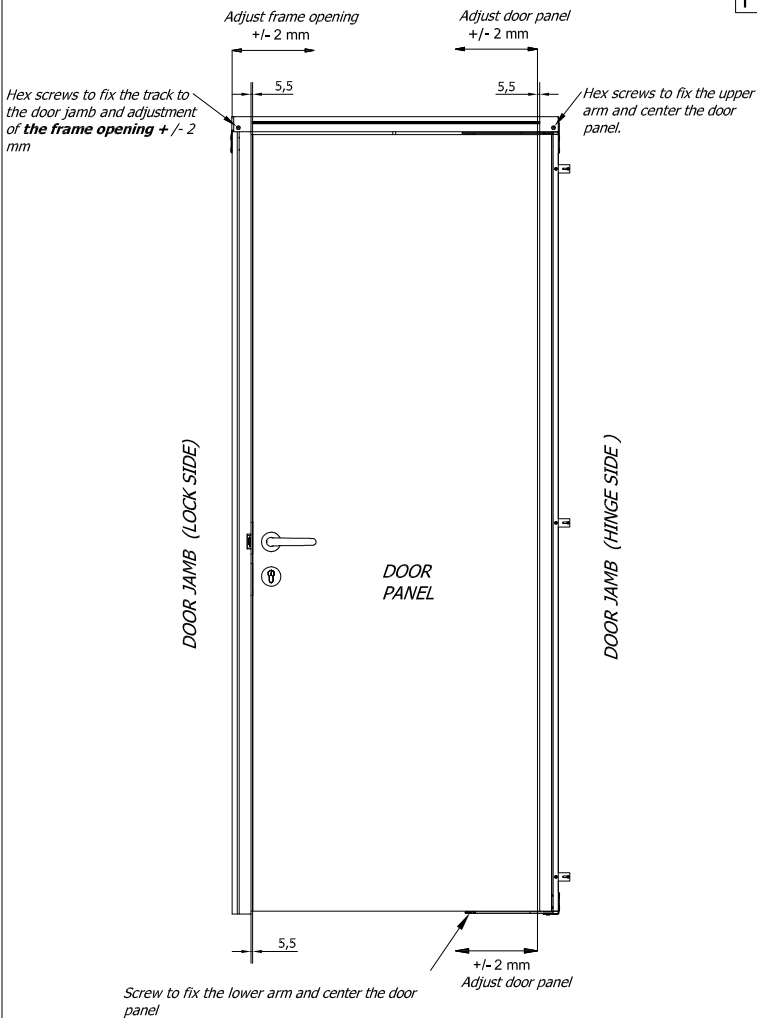

Parts list		
No.	Qty.	Description
145	1	Track cover
220	2	Screw TSPcr Ø3x10
240	2	Track cover cap
250	2	Insert for cover track fixing

