

EDITION  
05



**WESTCOUNTRY**  
GROUP

**INSPIRATIONAL SPACES**

THE EDUCATION INTERIOR EXPERTS

# CONTENTS

06. ST JOHNS  
BEAUMONT

08. SEXEY'S  
SCHOOL

10. KINGSWOOD  
HOUSE

12. LATYMER  
UPPER  
SCHOOL

14. TRURO HIGH  
SCHOOL FOR  
GIRLS

16. JOHN  
KEATS  
SCHOOL

18. KINGS PARK  
SCHOOL

20. WELLINGTON  
SCHOOL

22. BOXGROVE  
PRIMARY  
SCHOOL

24. PORTSMOUTH  
GRAMMAR  
SCHOOL

26. STONEHENGE  
SCHOOL

28. NISHKAM  
SCHOOL

# WELCOME

**Hello and welcome! Great ideas are meant for sharing so we thought we'd show you what we've been up to in schools and colleges near you!**

Driven by our ever-increasing desire to advance school facilities and maximise potential from every student, Westcountry Group have become a leading supplier of educational refurbishments and furniture in the South of England.

#### **Our customers love us because we:**

- ▶ Offer free and informal consultations to discover your needs and help you achieve your dreams for your school
- ▶ Combine over 40 years experience with your visions to maximum effect – all within your budget
- ▶ Deliver and install our concepts within your timescales and to your complete satisfaction

- ▶ Genuinely care about the results – whatever size the project is
- ▶ Supply, assemble and install the furniture – there are no flat pack horror stories here!
- ▶ Leave your school clean and tidy – leave the clearing up to us!

So, grab a coffee, take a good look through our portfolio and see what we could do for your school! Then give us a no-obligation call to discuss your needs, however great or small, whether it be space and storage or expanding pupil numbers, and we'll see how we can be of assistance.

Still stuck for inspiration? Check out our website at [westcountrygroup.com](http://westcountrygroup.com) for more projects and ideas. With warmest regards,

*Miles Liesching*

Miles Liesching  
Managing Director



# THE 4 KEY STAGES OF OUR PROJECTS

For a free space plan consultation call our expert team today on **0330 030 0330**

**01** ▶ **Define**  
You share your ideas. We create a solution tailored to your needs.

**02** ▶ **Design**  
We craft a design built on your vision. You give us your thoughts.

**03** ▶ **Installation**  
You focus on key tasks while we deliver, on time and on budget.

**04** ▶ **Handover**  
Once everything is perfect we handover the project. You love it.

# COMPLETE TURNKEY REFURBISHMENT SOLUTIONS

From a single chair to a complete school fit-out, a classroom through to a washroom, no job is too big or too small for us.

Let us take you on a journey and discover the exciting environment you want your school to be.

- ▶ **CLASSROOM FURNITURE**
- ▶ **FLOORING, CEILINGS & WALL GRAPHICS**
- ▶ **RECEPTION AREAS**
- ▶ **WASHROOMS**
- ▶ **STAFF ROOMS**
- ▶ **SCIENCE LABS & FOOD TECH**

*“Westcountry Group have been of great help to Crofton School. They have a partnership approach which has really worked for us.”*

**Jon Hickey** Operations Director, Crofton School





## PROJECT OVERVIEW

St Johns Beaumont had a large area of unused space which they needed to put to good use. The existing area was a tired breakout space which they wanted to convert into a top-class washroom and shower area for students. Westcountry Group were once again the only supplier who could complete the specialist project in the tight time-scale required.



## ST JOHNS BEAUMONT SCHOOL

We produced the whole specification from the flooring to the lighting, incorporating individual storage for their toiletries, charging points for electric toothbrushes and a wet-room floor in the shower area to make cleaning and maintenance much easier. We think the results speak for themselves!

**PROJECT**  
Washroom

**LOCATION**  
Old Windsor,  
Berkshire



## PROJECT OVERVIEW

Sexey's School required a relocation of their reception area to a new part of the school to create a stunning first impression for students and parents alike. The space needed to have an independent school 'feel' that would reflect its deep and rich heritage.



## SEXEY'S SCHOOL

We combined rich wood tones in the reception desk with bolder red and grey comfortable seating to create a modern yet classy ambience. The spacious desk provides the receptionist with a sleek, modern and practical workspace.

**PROJECT**  
Reception Area

**LOCATION**  
Bruton,  
Somerset



# PROJECT OVERVIEW

Kingswood House were in need of a holistic, colour-coordinated furniture and storage solution for their new build school that would maximise space in each room and stand up to years of use, so they turned to the trusted advisors at Westcountry to come up with the perfect solution!

## KINGSWOOD HOUSE SCHOOL

**PROJECT**  
Breakout Area

▼

**LOCATION**  
Epsom,  
Surrey

We engaged directly with the staff at Kingswood as part of our design process to ensure that their aspirations and needs were fully met and achieved. The finished result is a light, airy and colourful space that's exactly in line with their aspirations and goals in this project and has created a fun learning area for students.



## PROJECT OVERVIEW

Latymer Upper School's innovative teaching style meant that ordinary tables simply wouldn't cut it when it came to classroom furniture. That's why they turned to the trusted experts at Westcountry Group to deliver a unique solution tailored to their needs.

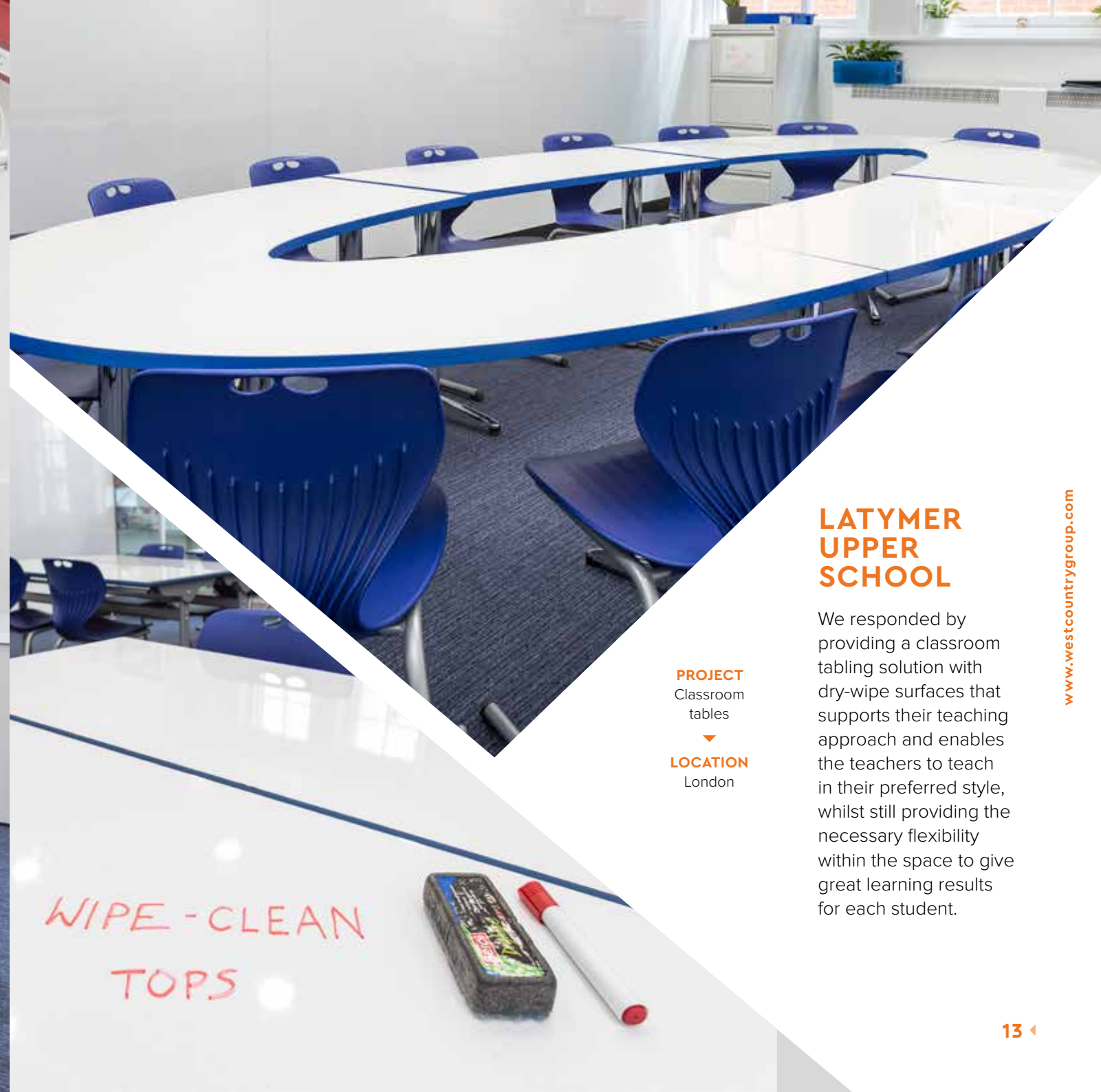

## LATYMER UPPER SCHOOL

**PROJECT**  
Classroom tables

▼  
**LOCATION**  
London

We responded by providing a classroom tabling solution with dry-wipe surfaces that supports their teaching approach and enables the teachers to teach in their preferred style, whilst still providing the necessary flexibility within the space to give great learning results for each student.

WIPE-CLEAN  
TOPS







## PROJECT OVERVIEW

Truro High School for Girls approached Westcountry Group when they required a total transformation of their staffroom into a space-saving, modern classroom which would make best use of space in order to create a tidy and inviting learning facility.



## TRURO HIGH SCHOOL FOR GIRLS

The expert team at Westcountry Group created a stud wall on which we installed a bespoke storage wall, complete with an integrated screen, trays and sliding whiteboards panels. Now the girls at Truro High have a bright and attractive learning space from which they can learn, grow and prosper.

**PROJECT**  
Classroom refurbishment

**LOCATION**  
Truro, Cornwall



## PROJECT OVERVIEW

Our teams of interior designers and specifiers worked closely with the team at John Keats to deliver a solution tailored to their exact needs and requirements. The built-in corridor furniture means the school is able to optimise space in a high-use area whilst the complimenting breakout furniture provides a relaxed quiet space for student study.



## JOHN KEATS SCHOOL

Westcountry Group were delighted to be chosen as the preferred supplier to Communitas Education Trust to fit out their new John Keats Primary School. This project involved designing, supplying and installing built-in corridor storage, breakout furniture, our popular wall pocket dining tables and heavy-duty blinds, as well as a manifestation in their dining hall.

**PROJECT**  
Corridor  
Furniture

▼  
**LOCATION**  
London



# PROJECT OVERVIEW

This multi-room refurbishment project encompassed fixed furniture, electrical supply upgrades to provide additional capacity, decorating, flooring, ventilation, plumbing and cubicle panels across several rooms.



## KINGS PARK SCHOOL

**PROJECT**  
Food technology and textile rooms

**LOCATION**  
Bournemouth, Dorset

Westcountry Group provided a full design through to completion package which included full 3D design input, layout drawings, mechanical and electrical calculations and colour and finish selections to ensure this project was a resounding success for the school.



## PROJECT OVERVIEW

Wellington School was in need of a flexible, robust and multi-use dining furniture solution that could be used for a variety of activities throughout the school day. The furniture needed to stand up to years of daily use from over 1,300 students.



## WELLINGTON SCHOOL

Our Benchmark and ConverTables provided the perfect solution to meet their specific needs. Benchmark's ability to instantly create a dining table for 20 students combined with ConverTable's flexibility to switch from lecture bench to lunch table created a truly winning, agile combination.

### PROJECT

Benchmark and ConverTables



### LOCATION

Altrincham,  
Cheshire





## PROJECT OVERVIEW

Boxgrove's multi-use hall was the perfect candidate for the Wall Pocket system. They struggled daily with seating their students in a tight timeframe and only had a very limited area to store their dining furniture. So we installed two quadruple and one triple Wall Pocket systems in the hall, complete in the school's brand colours.

## BOXGROVE PRIMARY SCHOOL

**PROJECT**  
Wall pockets

▼  
**LOCATION**  
London

Now, the primary school can store over 17 metres of tables and benching in under 60cms on the wall - that's seating for up to 80 students! In the words of the Premises Manager, "We are extremely pleased with the Wall Pocket system as it is quick and easy to use. It has created more space in the dining hall and looks very stylish and modern."



## PROJECT OVERVIEW

As part of our ongoing refurbishment programme at Portsmouth Grammar School, the Head there required a classy refurbishment of her office within the old building to create a unique and grand space that would impress staff, students and parents alike.

## PORTSMOUTH GRAMMAR SCHOOL

As part of our ongoing refurbishment programme at Portsmouth Grammar School, the Head there required a classy refurbishment of her office within the old building to create a unique and grand space that would impress staff, students and parents alike.

**PROJECT**  
Head's office

▼  
**LOCATION**  
Portsmouth,  
Hampshire



# PROJECT OVERVIEW

Our interior designers combined luxury striped wall paper and neutral tones to bring out the beauty of this grand building. We also re-upholstered the seating, decorated the room and fitted new curtains to provide the Head with a superb office she can be truly proud of.

## STONEHENGE SCHOOL

Our teams engaged with the senior leadership team at Stonehenge and designed each area according to their exact needs and purpose for each space. We then engaged with the architect to provide a fully congruent design package, including signage and graphics to give this space the real wow factor!

**PROJECT**  
Breakout and learning space

**LOCATION**  
Salisbury, Wiltshire

*Westcountry have recently overseen the design and installation of furniture in our brand new £6.5m building at The Stonehenge School. The project ran smoothly and on time under the direction of their team of dedicated staff..After care has been excellent, ensuring that we are happy with every aspect of the service. The expertise of the staff has been evident throughout, particularly with obtaining best value for money and equipping the school with quality, long lasting furniture.*

**Claire Busby,**  
Business Manager





## PROJECT OVERVIEW

This breath-taking building benefited from our end-to-end furniture service which included our teams specifying, delivering and installing nearly 2,500 furniture items across three floors and two wings. Our interior designers carefully selected each item on a room-by-room basis, value engineering to the final specification to meet their budget.



## NISHKAM SCHOOL

**PROJECT**  
Whole school fit-out

▼  
**LOCATION**  
Isleworth, Middlesex

From auditoriums to classrooms, staffrooms to dining rooms the team at Westcountry Group delivered the complete interior package - well in advance of the school's opening date. Staff and students alike are absolutely thrilled with the resulting inspiring learning environment and we're sure you can see why!



*Taunton School has used Westcountry Group furniture for a number of high-profile refurbishment projects across the campus. Their range and pricing as well as the quality has been a significant factor in our selection of them as a preferred supplier and we would wholly endorse them for such projects.*

**Terry Harris**  
Estates Manager, Taunton School

*Westcountry Group are my go-to people. They never fail to provide the best service, with quality products, at a reasonable price. I have no reservations in highly recommending this company who I have been using for nearly ten years.*

**Katie Wyatt**  
Administrator, Torre C of E Academy

*Just wanted to say what a fantastic experience we've had working with you, how efficient you were and also how responsive you were to any of our needs.*

**Nick Tildesley**  
CEO, Communitas Education Trust

*Westcountry have recently overseen the design and installation of furniture in our brand new £6.5m building at The Stonehenge School. The project ran smoothly and on time under the direction of their team of dedicated staff. Management of the project was made easier by having Westcountry overseeing all of the design process, from advising us on colour schemes to installing signage, wall graphics and engaging furniture removers.*

*Some legacy furniture was moved from our existing buildings and installed alongside brand new furniture under the expert eye of the design team. After care has been excellent, ensuring that we are happy with every aspect of the service. The expertise of the staff has been evident throughout, particularly with obtaining best value for money and equipping the school with quality, long lasting furniture.*

**Claire Busby**  
Business Manager,  
The Stonehenge School

*We are very pleased with the work that Westcountry Group have just completed at our school. Neville and his team have completed the project calmly and efficiently. They have done this with minimum disruption to school and have been friendly and courteous at all times. We would definitely use West Country again and have recommended them to other local schools.*

**Gill Matthews,**  
School Business Manager,  
Wonersh & Shamley Green Primary

*Westcountry Group have been of great help to Crofton School. They have a partnership approach which has really worked for us.*

**Jon Hickey** Operations Director,  
Crofton School

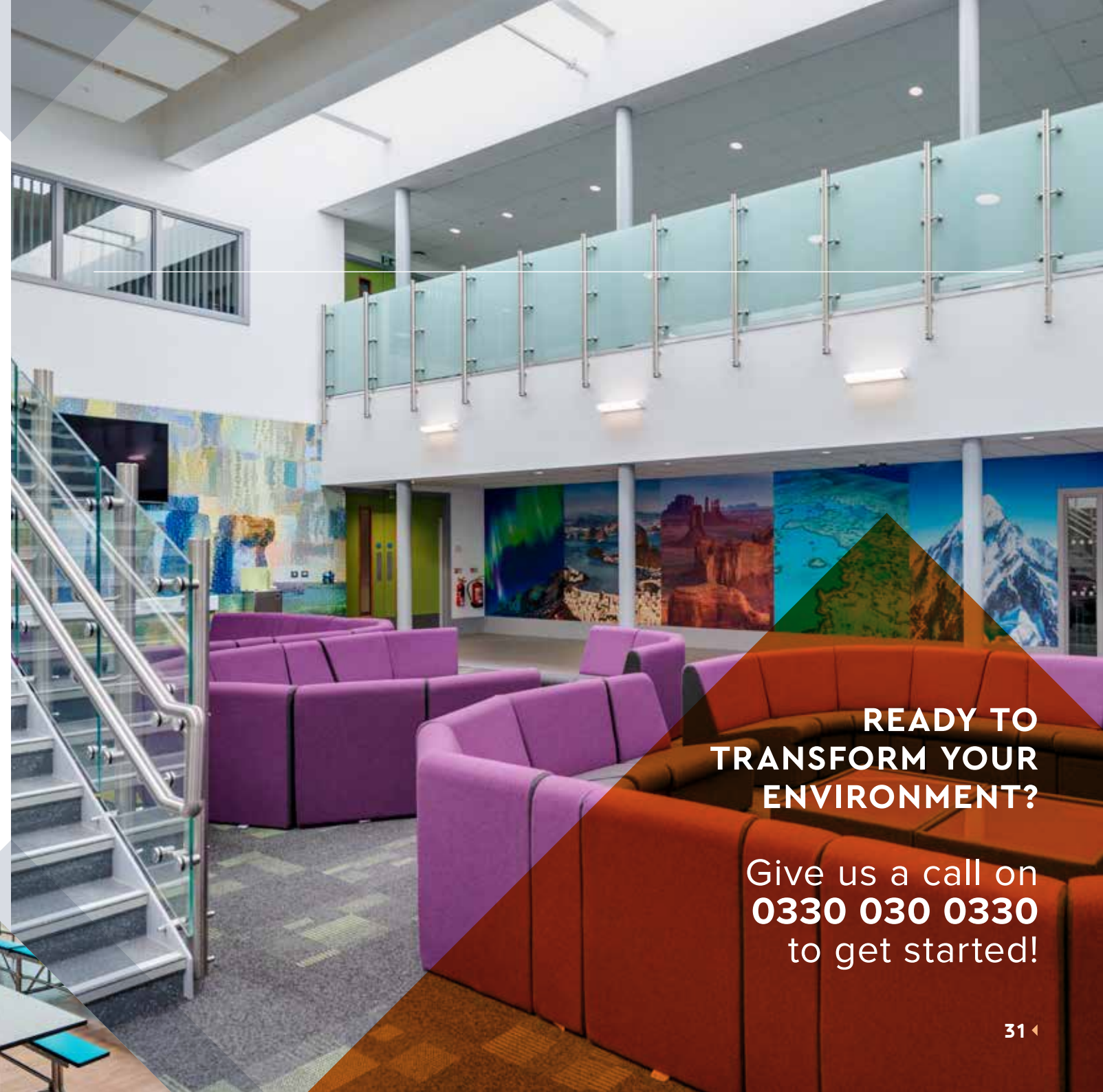

**READY TO  
TRANSFORM YOUR  
ENVIRONMENT?**

Give us a call on  
**0330 030 0330**  
to get started!





**[WWW.WESTCOUNTRYGROUP.COM](http://WWW.WESTCOUNTRYGROUP.COM)**

Cranmere House  
Darklake View  
Plymouth  
PL6 7TW

Warne House, Central Way  
Walworth Industrial Estate  
Andover, Hants  
SP10 5AN

**T: 01752 696 300**

**T: 01264 303 103**

