

CITY OF EDMONTON
LANDSCAPING REQUIREMENTS
(PER DWELLING):
1 DECIDUOUS TREE
1 CONIFEROUS TREE
4 SHRUBS

LOWEST BOTTOM
OF FOOTING 77.95

LOWEST OPENING
ELEVATION AT THE
BUILDING 80.40

WING WALLS & OR
RETAINING STRUCTURES
MAY BE REQUIRED FOR
DRAINAGE PURPOSES

THIS PLAN IS TO BE USED AS A
GUIDE ONLY. ALL MINIMUM SIDEYARD
DISTANCES MUST BE VERIFIED BY
STANTEC GEOMATICS.

DRAINAGE TYPE – STANDARD SPLIT
WALKOUT BASEMENT

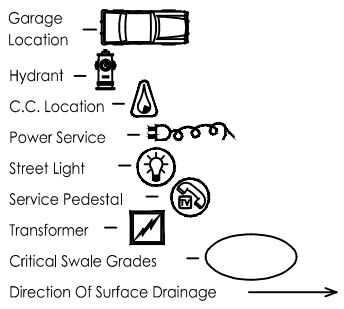

House Type _____
 Finished Floor _____
 Bottom Footing _____
 Finished Grade Front _____
 Finished Grade Back _____
 Bottom Back Door Sill _____
 Bottom Bsm't Window _____
 Top Conc. Bsm't Wall _____
 Finished Garage Floor _____
 Sanitary Sewer Invert 79.94
 JOIST _____ CONC.WALL _____ FOOTING _____



WALKWAY

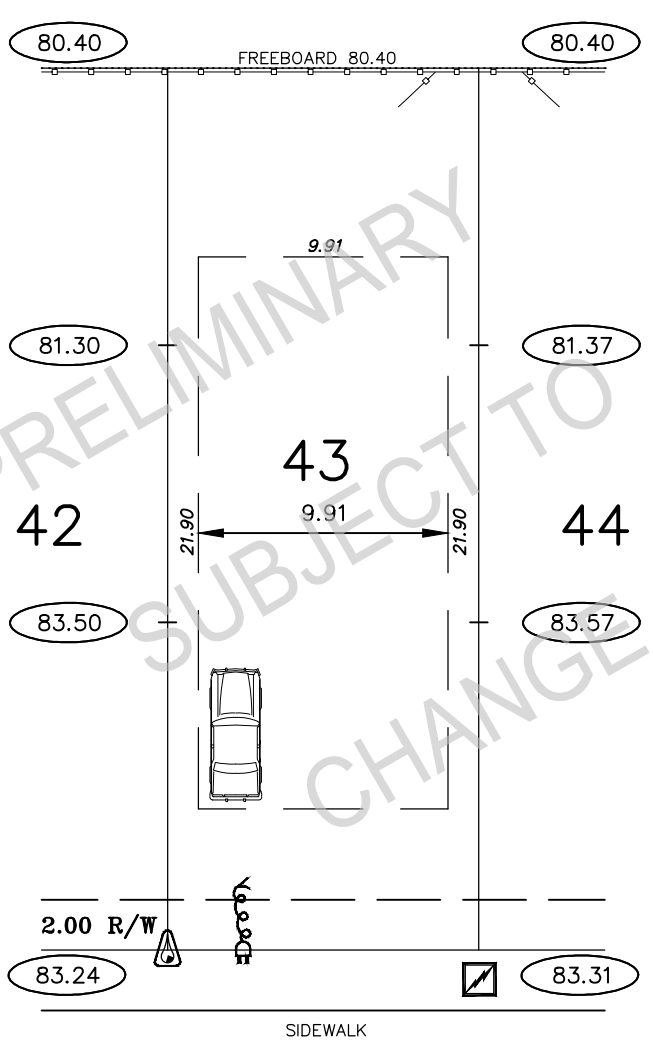

FRONT
LOT AREA = 432.25m²

Foundation Wall Height: ' "

*It is the responsibility of the builder to contact the soils consultant to determine if there are any special considerations pertaining to house foundation construction.
 *The elevation of this house has been designed so that it will be in conformance with the lot grading plan.
 *This plan is subject to the approval of the local approving authority and the agent responsible for the architectural control guidelines.
 *Stantec Geomatics will accept no responsibility for any costs incurred due to an error or omission on this plan if construction starts prior to the subject approvals.
 *All dimensions and services shown must be confirmed by contractor prior to excavation.
 *All distances shown are in metres and decimals thereof.



Stantec Geomatics Ltd.
10160-112th Street NW
Edmonton, Alberta, Canada
T5K 2L6
Tel. 780-917-7000
Fax. 780-917-7289
www.stantec.com

Legal Description
LOT 43 BLOCK 5 PLAN UN-REG.
KESWICK
Municipal Address
EDMONTON
Builder
Title
Plot Plan
Your File:
VES-06/06/2017