

# Advantech Flagship Ubiquitous Touch Terminal

Touch Toward Convenience and Business Success

- ／ Hotel Self Check-In
- ／ Transportation Check-In
- ／ Retail Product Display and Event Announcement
- ／ Public Transportation Self Ticketing
- ／ Library Information Station
- ／ Restaurant Smarter Queuing and Digital Menu

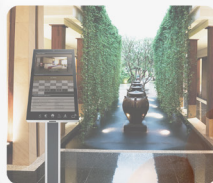

**ADVANTECH**

*Enabling an Intelligent Planet*

[www.advantech.com](http://www.advantech.com)

# All-in-One UTC-620 for Optimized Customer Experience

The UTC-620 is a slender 21.5" multifunction touch computer. Its embedded software system allows retail administrators to remotely manage all systems at once which in turn will help reduce energy consumption along with maintenance costs. The customized mounting kits, I/O, and accessory offerings meet requirements of various fields. The high resolution display and multi-touch screen will no doubt successfully captivate users' engagement.

## Fully Integrated I/O for All Applications

Simple deployment

## OS Compatibility

- Windows
- Linux

## Dust and Liquid Resistance

Front IP65 solid standard protection

## Built-in WiFi/ Bluetooth or 3G UMTS

Provide social connections

## Versatile Add-on Value

Implement scalable applications

## Easy Installation

- Support wall mount solution
- Support vertical and horizontal display







### Hotel Self Check-In

- Room types information
- Special discounts
- Membership registration and maintenance
- Bonus redemption
- Customer service center
- Room rates



### Transportation Check-In

- Self check-in and identification system
- Flight schedule information
- Luggage notification
- Map and direction finder
- Remote real-time video chat

## Application & Scenario

UTC-620 embraces many useful and practical functions that can be applied to a broad range of scenarios. With its multitude of features, the unit can be applied to environments needing functions in digital signage, bill payment, barcode scanning, social video chat, and membership maintenance, to name a few. UTC-620 provides business adopters greater management and customers services. Its interactive system easily engages with customers and stimulates consumer interests.



### Library Information Station

- Staff, member and visitor identification
- Book, DVDs information
- Collect, renew and return service
- Book review and grading
- Due dates fine payment



### Restaurant Smarter Queuing and Digital Menu

- Digital menu display
- Ingredients checking
- Calling and queuing alarm
- Kitchen preparation live broadcast
- Restaurant intelligent POS
- Order service



### Retail Product Display and Event Announcement

- Endless aisle
- Loyalty Member Program
- Promotional news
- Online ordering



### Public Transportation Self Ticketing

- Bus/train time schedule information
- Incoming bus/train location
- Route search
- Ticket purchasing
- Online entertainment while waiting

## UTC-620 Design Descriptions

Sleek, water/dust proof in front panel and low battery consumption, along with built-in camera, Wifi, NFC, MSR, 2D Barcode scanner, all-in-one design enables integrators to reach a broad base of clientele.

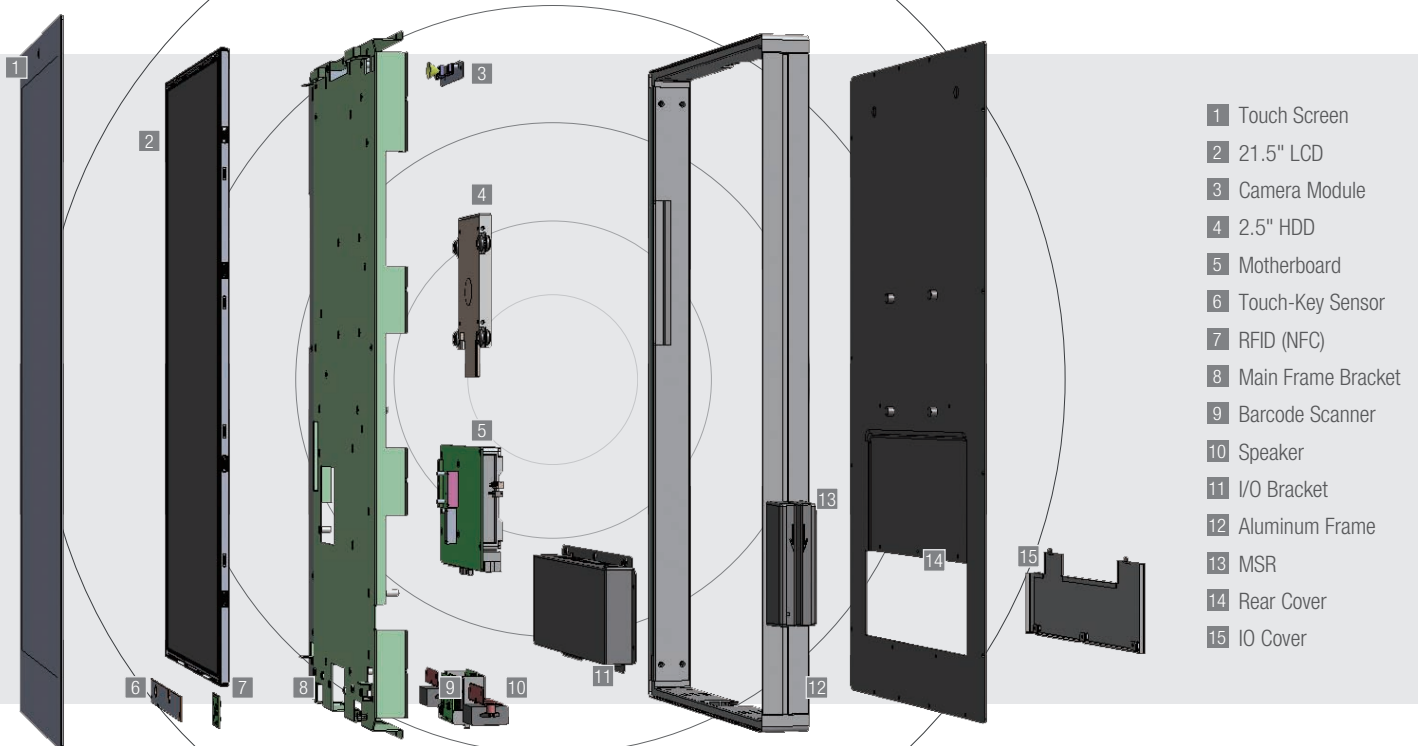

# UTC-620 Series Specifications

*Choose The Right One for You*  
21.5" Retail Touch Computer



		UTC-620C with Ivy Bridge	UTC-620D with Bay Trail	UTC-620E with Haswell
Processor System	CPU	Intel Core™ i7 3517UE 1.7 GHz	Intel Celeron® J1900 2.0 GHz	Intel Core™ i5 4300U 1.9 GHz
	Chipset	Intel QM77	N/A	N/A
	L2 Cache	1 MB (L3, 4MB)	2MB	(L3, 3MB)
	Memory	1 x SO-DIMM DDR3 1600MHz up to 8GB	1 x SO-DIMM DDR3L 1600MHz up to 8GB	1 x SO-DIMM DDR3L 1600MHz up to 8GB
	HDD	1 x 2.5 internal SATA HDD bay		
	Network (LAN)	2 x Gigabit Ethernet ports		
	I/O Ports	1 x RS-232 COM (RS-422/485)* 2 x USB 2.0, 2 x USB 3.0 2 x Gigabit Ethernet (RJ-45) 1 x VGA & HDMI Audio Line-out x 1 /Mic in x 1	2 x RS-232 COM (RS-422/485)* 3 X USB 2.0, 1 X USB 3.0 2 x Gigabit Ethernet (RJ-45) 1 x VGA & HDMI Audio Line-out x 1 /Mic in x 1	2 x RS-232 COM (RS-422/485)* 2 x USB 2.0, 2 x USB 3.0 2 x Gigabit Ethernet (RJ-45) 1 x VGA & HDMI Audio Line-out x 1 /Mic in x 1
	Stereo Speaker	2Wx2		
	Bus expansion	Full-size MiniPCIe/msATA		
	Build-in Peripheral	5MP Camera, MSR, 2D Barcode scanner, NFC(RFID)		
	Function Key	5 programmable touch soft-key		
	Dimensions (W x H x D)	344.71 (w/ MSR) x 565.24 x 43.5 (mm)		
	Weight	8 kg (17.6 lb)		
OS Support		Embedded Windows 7, Embedded Windows 8, Embedded Linux 3.0		
Environmental Specifications	Operating Temperature	0 ~ 40° C (32 ~ 104° F)		
	Relative Humidity	10 ~ 95% @ 40° C non-condensing		
	Vibration	0.5G		
	Shock	10 G peak acceleration (11 msec. duration)		
	EMC	CE, FCC, UL, CCC, BSMI		
Power	Input Rating	12 V/7 A (84W ITE Adapter)		
	Power consumption	Typical 55W, Max. 75W		
LCD Display	Size/Type	21.5" TFT LCD with LED backlight		
	Max. Resolution	1920 x 1080		
	Max. Color	16.7 M		
	Pixel Pitch (mm)	248.25 (H) x 248.25 (V)		
	Brightness (cd/m2)	250 (Optional 400)		
Touch Screen Option	View Angle	178°/178°		
	Type	Projected Capacitive Touch Panel (Pcap. Flat Glass)/Analog Resistive 5-wires (Res. Flat Glass)*		
	Light Transmission	90% ± 2% / 80% ± 5%		
	Controller	USB Interface		



# Solid, Steady, and Secure



Industrial-grade products  
at competitive cost



ISO-certified products



Global logistics and  
customer services  
with local support



Product longevity up to  
3-5 years, and superior  
warranty service options



Leadership &  
Partnership

## Regional Service & Customization Centers

<b>China</b> Kunshan 86-512-5777-5666	<b>Taiwan</b> Taipei 886-2-2792-7818	<b>Netherlands</b> Eindhoven 31-40-267-7000	<b>Poland</b> Warsaw 48-22-33-23-730	<b>USA</b> Milpitas, CA 1-408-519-3800
--	---	--	---	---

## Worldwide Offices

### Greater China

<b>China</b>	
Toll Free	800-810-0345
Beijing	86-10-6298-4346
Shanghai	86-21-3632-1616
Shenzhen	86-755-8212-4222
Chengdu	86-28-8545-0198
Hong Kong	852-2720-5118
<b>Taiwan</b>	
Toll Free	0800-777-111
Rueiguang	886-2-2792-7818
Yang Guang	886-2-2792-7818
Xindian	886-2-2218-4567
Taichung	886-4-2378-6250
Kaohsiung	886-7-229-3600

### Asia Pacific

<b>Japan</b>	
Toll Free	0800-500-1055
Tokyo	81-3-6802-1021
Osaka	81-6-6267-1887
<b>Korea</b>	
Toll Free	080-363-9494
Seoul	82-2-3663-9494
<b>Singapore</b>	
Singapore	65-6442-1000
<b>Malaysia</b>	
Toll Free	1800-88-1809
Kuala Lumpur	60-3-7724-3555
Penang	60-4-397-3788
	60-4-397-4188
<b>Thailand</b>	
Bangkok	66-2-248-3140
<b>India</b>	
Toll Free	1800-425-5071
Bangalore	91-80-2545-0206
<b>Indonesia</b>	
Jakarta	62-21-751-1939
<b>Australia</b>	
Toll Free	1300-308-531
Melbourne	61-3-9797-0100
Sydney	61-2-9477-2521

### Europe

Toll Free	00800-2426-8080
<b>Germany</b>	
Munich	49-89-12599-0
Hilden	49-2103-97-885 -0
<b>France</b>	
Paris	33-1-4119-4666
<b>Italy</b>	
Milano	39-02-9544-961
<b>Benelux &amp; Nordics</b>	
Breda	31-76-5233-100
Roosendaal	31-165-550-505
<b>UK</b>	
Reading	44-0118-929-4540
<b>Poland</b>	
Warsaw	48-22-33-23-740 / 741
<b>Russia</b>	
Toll Free	8-800-555-01-50
Moscow	7-495-232-1692

### Americas

<b>North America</b>	
Toll Free	1-888-576-9668
Cincinnati	1-513-742-8895
Milpitas	1-408-519-3898
Irvine	1-949-420-2500
<b>Brazil</b>	
Toll Free	0800-770-5355
Saude-São Paulo	55-11-5592-5355

# ADVANTECH

*Enabling an Intelligent Planet*

[www.advantech.com](http://www.advantech.com)

Please verify specifications before ordering. This guide is intended for reference purposes only. All product specifications are subject to change without notice. No part of this publication may be reproduced in any form or by any means, electronic, photocopying, recording or otherwise, without prior written permission of the publisher. All brand and product names are trademarks or registered trademarks of their respective companies. © Advantech Co., Ltd. 2014

8600000119