

Rotary Switches Series SRS5



General Specifications	
Switching Combination	: see over leaf
Current Rating	: 130mA
Voltage Rating	: 5VA(Max)
Contact Resistance	: 25m Ohm Max.(initial)
Insulation Resistance	: 100M Ohm Min.
Operating Force	: 1kgf-cm(Max)
Indexing Angle	: 30°
Operating Life non load	: 20000 CYCLES Min.
Operating Life at full load	: 15000 CYCLES Min.
Switching Mode	: Shorting and non shorting
Solder Specifications	: 260 deg for 3 seconds
Operating Temperature	: -10deg~+60deg

Materials	
Cap	: Polyamide (PA)
Movement	: Polyamide (PA)
Case	: Polyamide (PA)
Fixed Contact	: Brass with gold over silver plating
Moving Contact	: Phosphor bronze (PBS) with gold over silver plating
Spring	: Stainless steel

Dimension

Cap style A

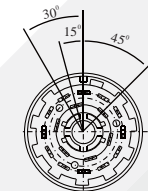
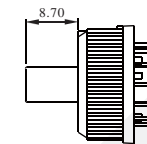
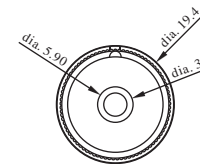

Cap style B

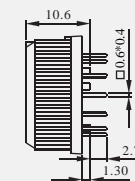
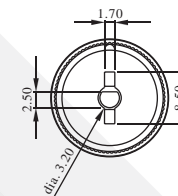

Cap style C

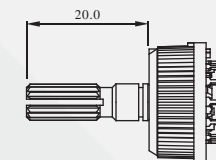
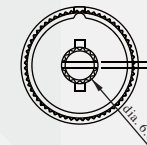

Cap style C1 (with E-ring)

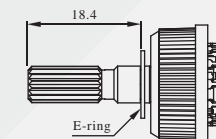
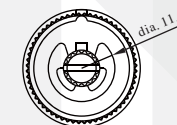

Rotary Switches Series SRS5

P.C. Board layout & Contact configuration

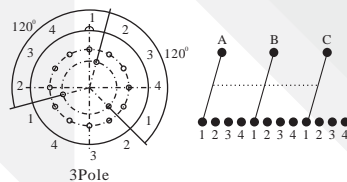
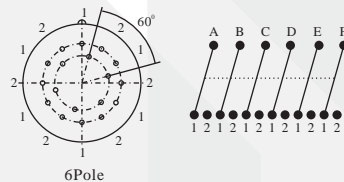
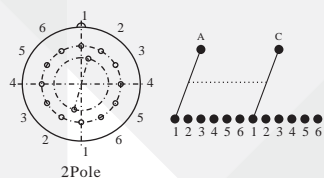
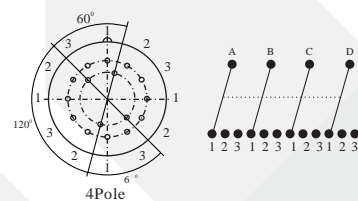
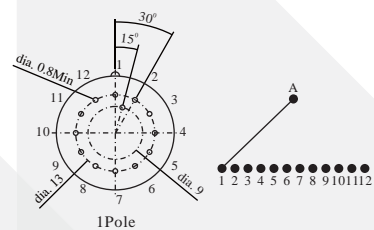

How to Order

S R S 5 — — — —

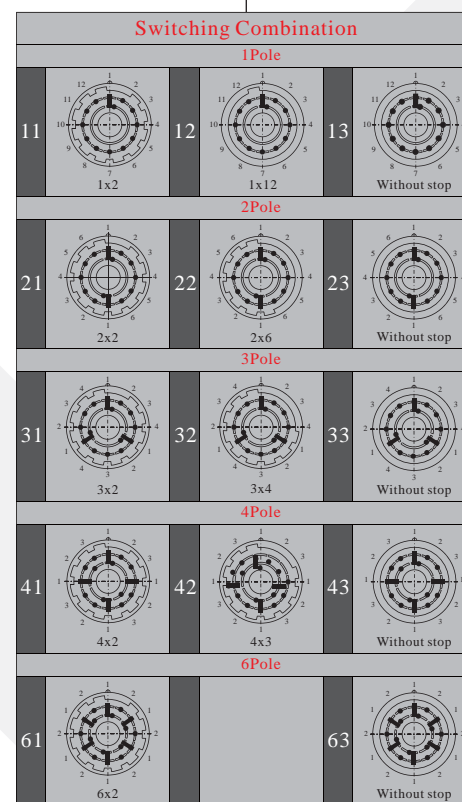
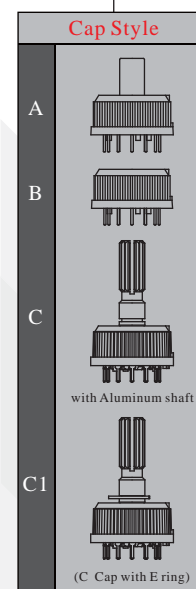

Operating Mode

YS	Shorting(make-before-break)
NS	Non-Shorting(break-before-make)



EXAMPLE : SRS5-A-33-NS
Rotary switch - "A" cap - 3 Pole 3x4 switch combination - Non short