

091160



SPIRIT OF WATER



HYLAS
SAILING YACHTS





HYLAS OVERVIEW

Hylas Yachts are built by Queen Long Marine, a third-generation family-owned yacht builder. Queen Long's collaboration with globally recognized designers - German Frers (Argentina), Bill Dixon (UK) and Sparkman and Stephens (USA) has established them as a preeminent brand in sail and power across multiple geographic and lifestyle markets.

Hylas Yachts International and Queen Long Marine ensures we have control from design to delivery and beyond. Every step of the process is focused on quality and service. Every department recognizes that our success can only come from delivering a product and support that our clients will want to share with others as their dreams take them across oceans in safety and style.



HISTORY OF HYLAS YACHTS

The Hylas brand was established in 1985 by Queen Long Marine who's shipyard was founded in 1978 by the Huang family and remains in full family operation and ownership to this day. The 117,300 sq ft shipyard is home to a 32,000 sq ft main construction hall, dedicated 18,000 sq ft laminating hall, a large paint facility, extensive design and administration offices and their famous on-site 3m-deep full-sized yacht testing tank complete with a thriving population of ornamental Koi Carp. Some 76 shipwrights, laminators, engineers, electricians and painters are employed directly by the shipyard to build the Hylas range of motor and sailing yachts. Of which over 500 have been launched to date. The Taiwan based team have an impeccable reputation for hosting our clients. We very much encourage visits during the build process.





WALK THROUGH DECK



BRIDGE DECK

DESIGNED WITH PRECISION

- ≈ Designed for ease of sail handling - 100% jib, in-mast furling, ease of access to sprit for "A Sail"
- ≈ Clean flush decks - Flush hatches and below deck control line conduits
- ≈ Open side decks - Shrouds lead to toe rails
- ≈ Greater visibility with twin helms
- ≈ Greater performance with twin rudders
- ≈ Lightweight cored hull and deck without compromising structural integrity
- ≈ Walk through and bridge deck cockpit options available
- ≈ An uncluttered social cockpit with all lines being lead under combings to winches that are readily accessible at the helm/workstations
- ≈ Convenient self tacking staysail



- Call
- Air
- Tank
- Pump
- Bilge
- Radio
- Light 1
- Light 2
- Light 3
- Stereo
- Winch
- Media
- Anchor
- Pump
- Engine
- Navigation

SALON



NAVIGATION STATION



GALLEY



MASTER CABIN



VIP CABIN



MASTER CABIN



MASTER HEAD



VIP CABIN



VIP HEAD



SALOON-TEAK



NAVIGATION STATION-TEAK



GALLEY-TEAK



MASTER CABIN — TEAK



VIP CABIN — TEAK



MASTER CABIN — TEAK



MASTER HEAD — TEAK



VIP CABIN — TEAK



VIP HEAD — TEAK

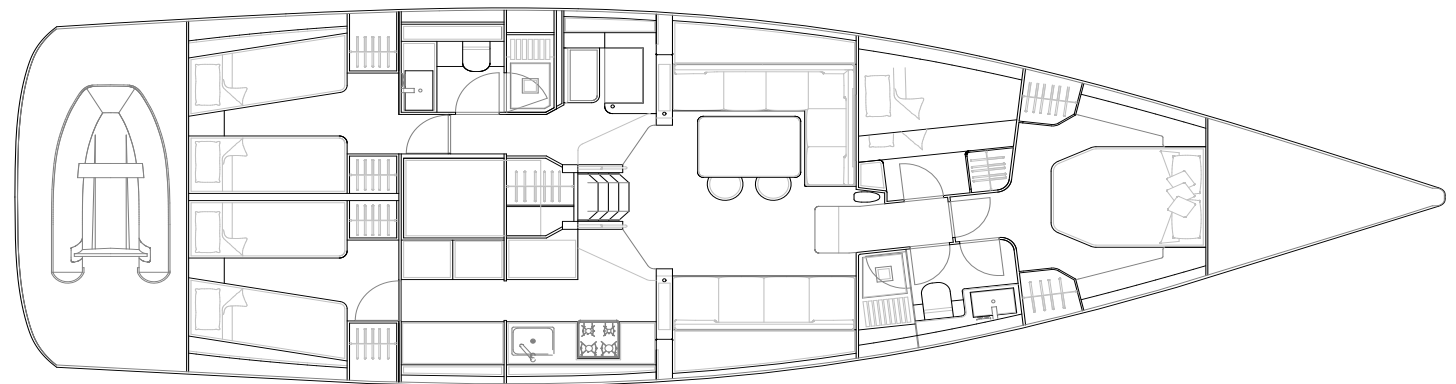
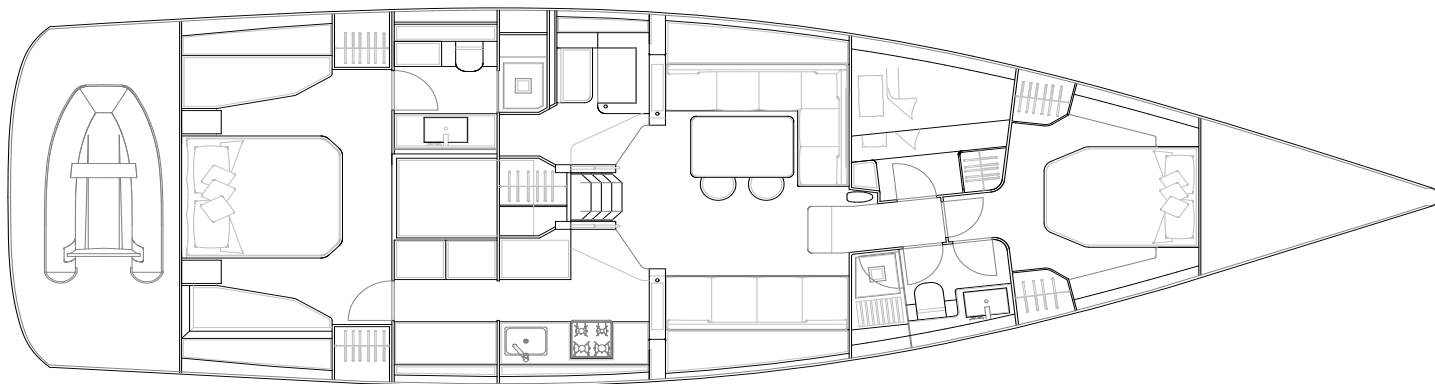
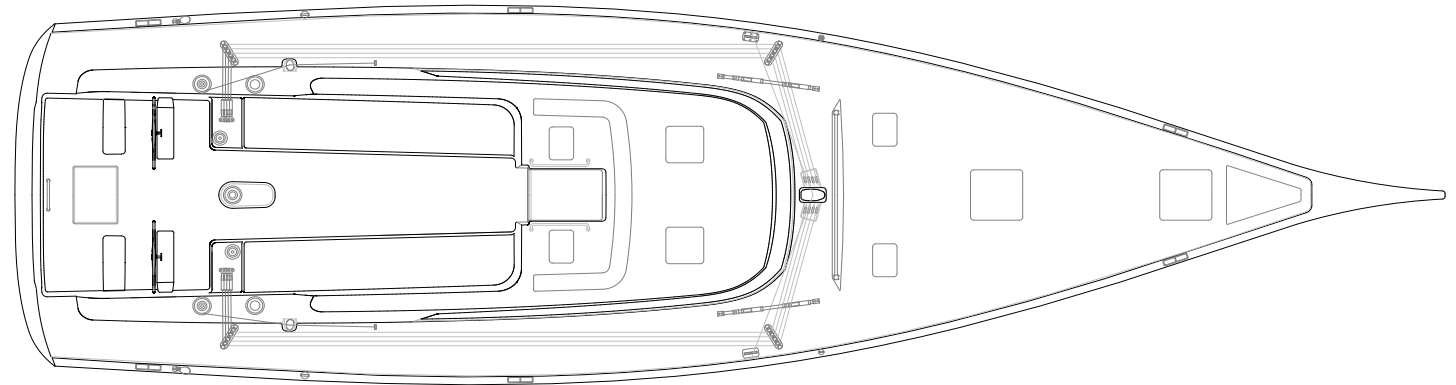
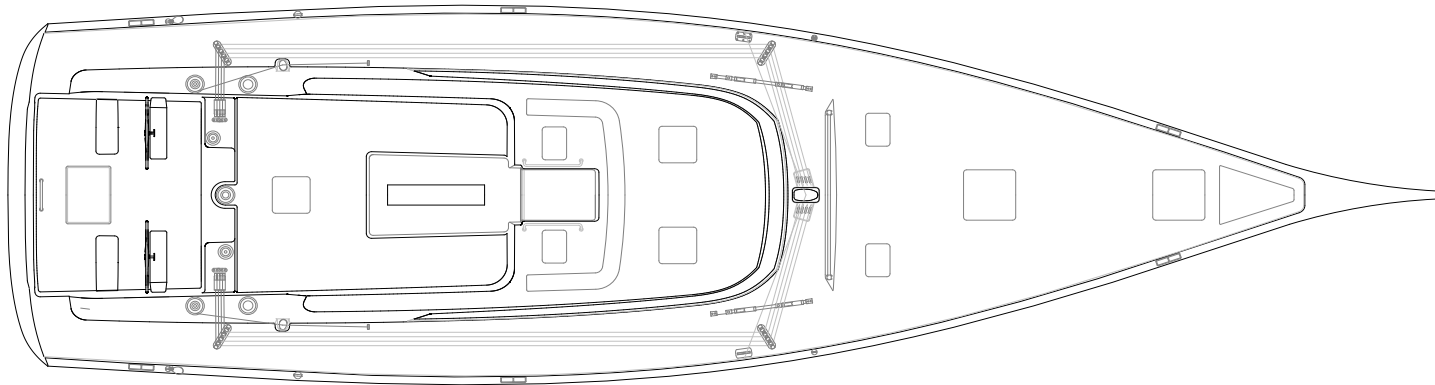
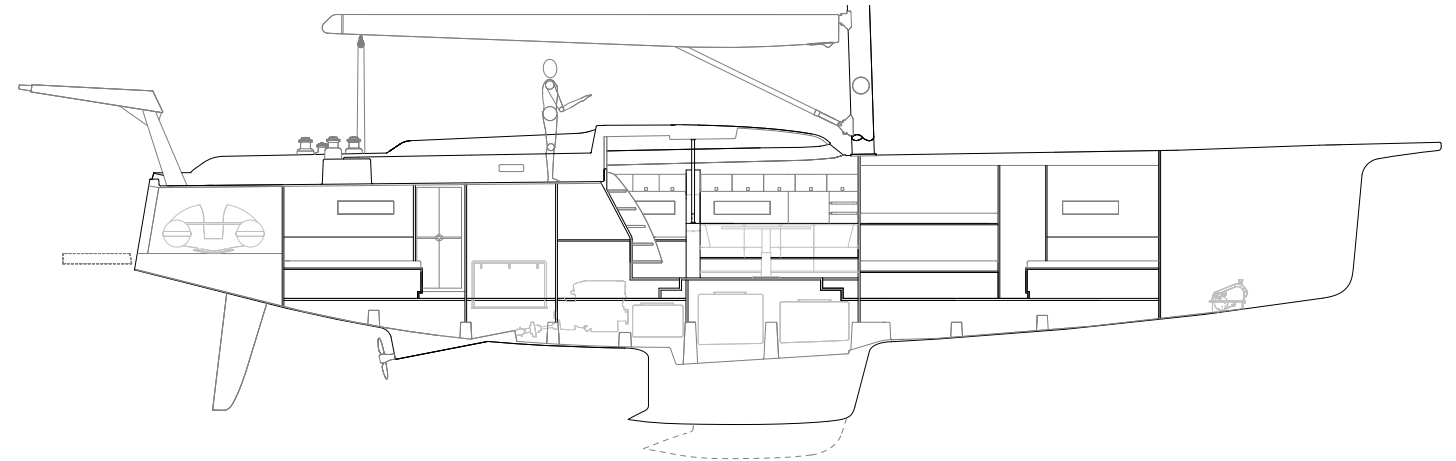
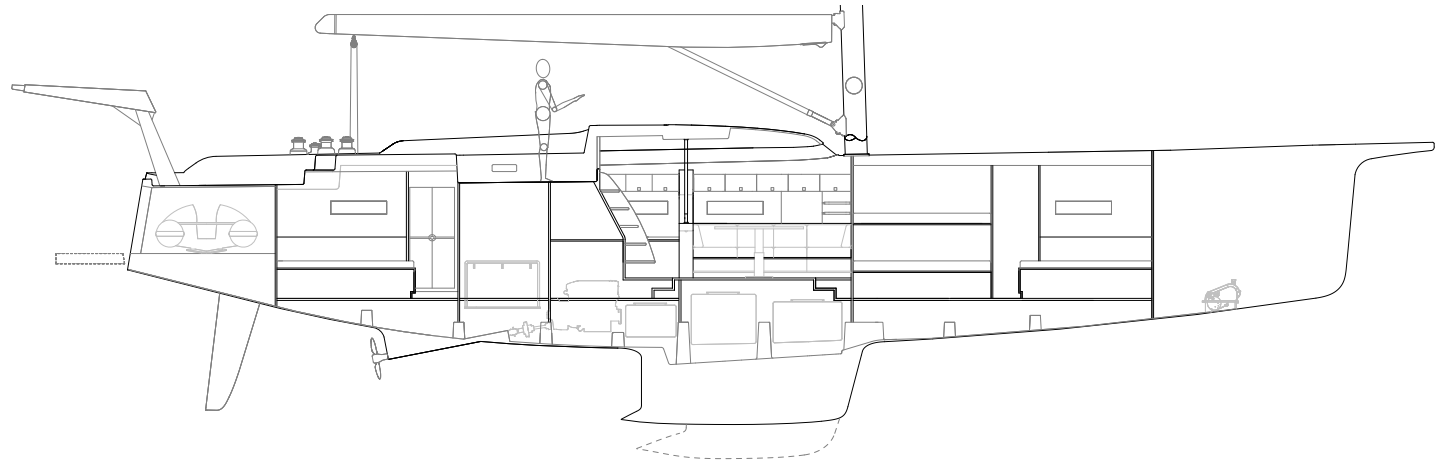

OWNERS AFT

OWNERS FWRD

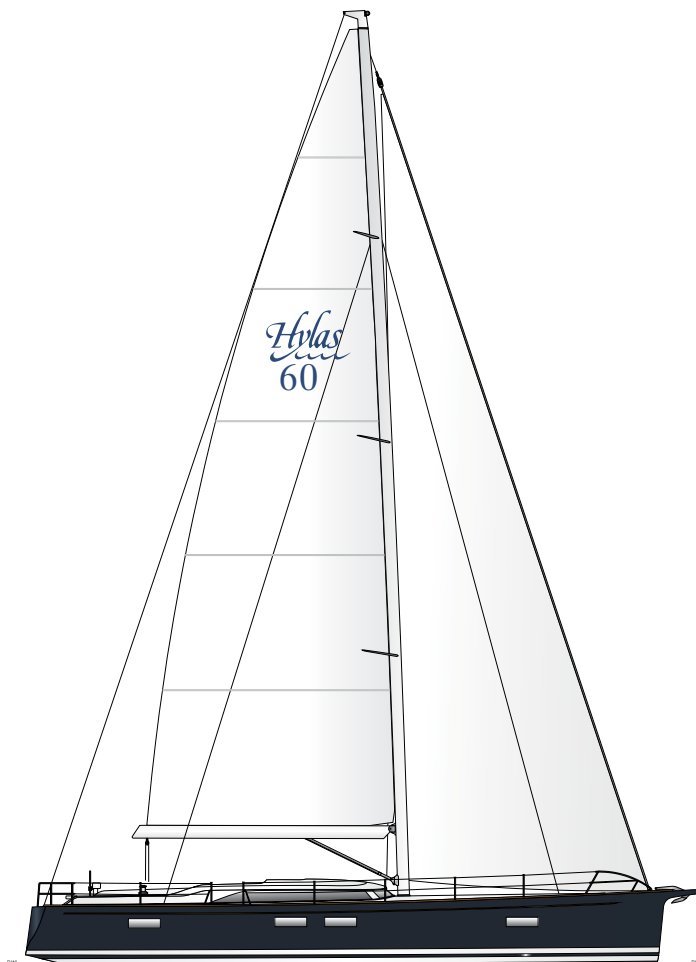

SPECIFICATIONS

LENGTH OVERALL	59'2" 18.05 m
LENGTH OF WATERLINE	54'9" 16.74 m
BEAM	17'3" 5.26 m
DRAFT	Shoal 6'6" 2.0 m / Deep 8'2" 2.5 m
DISPLACEMENT	65,256 lbs 29,600 kg
WATER TANKAGE	400 gal 1514 litres
FUEL TANKAGE	370 gal 1400 litres
SAIL AREA	1827 sq. ft w/135% Genoa 169.73 m ²
ENGINE	150 hp
BALLAST / DISPLACEMENT RATIO	.39
DESIGNER	Germán Frers
INTERIOR	HotLab Studio

0611



HYLAS
SAILING YACHTS





H60

HEADQUARTERS | QUEEN LONG MARINE | TAIWAN | +886 7 831 5216 | QLMARINE@HYLASYACHTS.COM.TW

US SALES OFFICE | HYLAS YACHTS | MIAMI BEACH FL | +1 786 497 1882 | INFO@HYLASYACHTS.COM

UK SALES OFFICE | LONDON UK | +44(0)1590 673715 | ENQUIRIES@HYLASYACHTS.CO.UK

ITALY SALES OFFICE | VIAREGGIO ITALIA | +39 333 74 89 281 | INFO@HYLASYACHTS.IT

HYLASYACHTS.COM

Hylas
Yachts