



ASM SERIES MINIATURE HIGH TEMPERATURE PRESSURE TRANSDUCER

The ASM Series of High Performance Pressure Transducers have been designed for High Temperature installations in motorsport and automotive applications; ideal for high precision data acquisition or control systems. These transducers can also be installed directly onto vehicles, as part of a test stand or dyno.

Offering a high level of reliability and endurance the ASM is protected against the high vibration, shock and high temperatures found in motorsport. With a modular construction and programmable amplifier, this provides a fast delivery time for standard and custom configurations.

Pressure ranges are available between 50 and 400 Bar in either Absolute or Sealed Gauge reference. Industry standard 3-wire electrical connections allow configuration with most common ECU's and data logging systems.

The ASM Series are race proven in many formula around the world.

TECHNICAL SPECIFICATIONS

Pressure Reference	Absolute and Sealed Gauge
Standard Pressure Ranges (Bar)	50, 100, 200, 400
Proof Pressure (Overrange)	150% of Range
Burst Pressure	>300% of Range
Accuracy	±0.2% FS Combined Linearity & Hysteresis (CNLH)
Thermal Accuracy	Zero ±0.01% FS/°C (Sensitivity ±0.01% of Reading /°C)
Output	0.5V to 4.5V (±0.5%)
Supply	5V (±0.5V) Ratiometric or 8-16Vdc (<20mA)
Operating Temperature Range	-20°C to +150°C
Compensated Temperature Range	0°C to +125°C
Bandwidth	0-1000Hz, 5000Hz (Selectable at time of Order)
Construction	Stainless Steel
Electrical Connection	26AWG, 55 Spec Wire + DR25 Sleeve
Process Connection (Thread Size)	Please see Part Number Configurator
Protection Class	IP67
EMC Protection & Vibration	EN E50082-1 and Mil-Std-810C, Curve L, 20G
Weight	28g (Including Cable)
Options	Cable Spec, Connector Fitted, Labelling & Thread Size

Ka Sensors adopts a continuous development program which sometimes necessitates specification changes without notice.

Sensors For Motorsport

Features

- High Temperature
- Miniature Size
- 50 to 400 Bar Range
- Rugged Construction
- Amplified Output
- ±0.2% Accuracy

Applications

- Coolant
- Brakes
- Water
- Boost
- Fuel
- Oil

kasensors.com
sales@kasensors.com
+44(0)1476 568057

ASM 01.20

PART NUMBER CONFIGURATOR

Pressure Reference

Pressure Range

Supply Voltage

Accuracy (CNLH)

Accuracy (Thermal Shift)

Electrical Connection

Process Connection

Bandwidth

Cable Length

Special Code

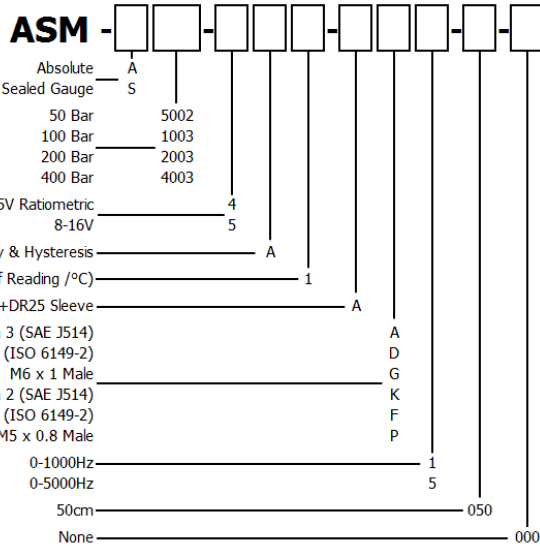

The KA configuration tool is used to specify a standard KA Sensor, other options are available.

MECHANICAL DETAILS

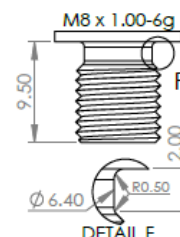
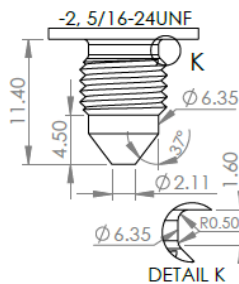
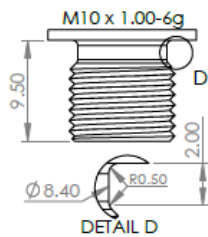
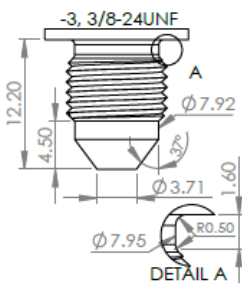
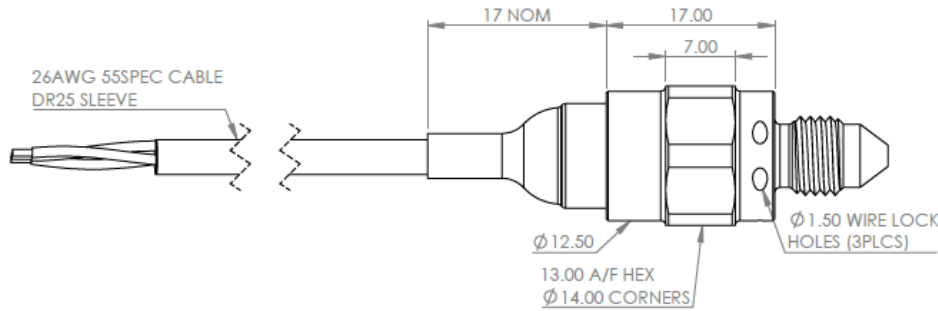

CONNECTION DETAILS

+Ve Supply	0V Supply	Signal
Red	Black	White

Sense
Analyse
Control

Services for:

- Data Logging
- Telemetry
- Controls
- Wiring

Contact us

KA Sensors Ltd
 Unit 14 & 15
 The Old Malthouse
 Springfield Road
 Grantham
 Lincolnshire
 United Kingdom
 NG31 7BG

kasensors.com
 sales@kasensors.com
 +44(0)1476 568057

ASM 01.20