

Piezo Switch with Extended Protection against Vandalism



PSE HI 22

**Description**

- Switch available in version Standard or with Lettering/Symbols - Assembly by mounting with nut - Quick connect terminals or wires

Approvals

- Fire Test according to DIN EN 81-71: stress class 1 + 2 (Elevators)
- MIL-STD Certificate Number: 416D Method RS103
- VDE Certificate Number: DIN EN 61000-4-2, DIN EN 61000-4-4

Characteristics

- Housing and actuating area material: high-quality stainless steel
- High reliability, long lifetime with more than 20 mill. actuations
- piezo switch with enhanced vandal proof protection to IK 06 impact resistance rating
- For use in harsh environments, both indoors and outdoors

Weblinks

[html-datasheet](#), [General Product Information](#), [Approvals](#), [RoHS](#), [CHINA-RoHS](#), [e-Shop](#), [CAD-Drawings](#), [Product News](#), [Detailed request for product](#)

Technical Data**Electrical Data**

Switching Function	N.O.
Switching Voltage	max. 42 / 60 VAC/DC
Switching Current	max. 100 mA
Rated Breaking Capacity	1 W
Lifetime	20 mill. at Rated Braking Capacity
Switch Resistance OFF	> 10 MΩ
Switch Resistance ON	< 20 Ω
Capacity	30 pF
N.O. Closing Impulse Duration	20- 1000 ms depending on actuating force, time and speed
Contact Configuration	free polarity

Mechanical Data

Actuating Force	2 - 5 N
Actuating Travel	0.002 mm
Shock Protection	IK 06
Starting Torque	2.5 Nm

Climatical Data

Operating Temperature	-20 to +60 °C
Storage Temperature	-20 to +60 °C
IP-Protection	IP 67 , from front side,
Salt Spray Test (acc. to DIN 50021-SS)	24 h / 48 h / 96 h Residence Time

Material

Housing	Stainless Steel
Actuating Area	Stainless Steel

Dimensions

PSE M22 HI with Pins

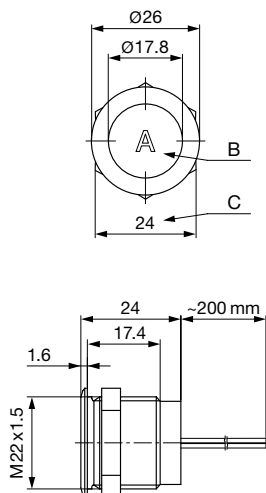

Lettering Colour of Laser Lettering

Material	Lettering Colour
Stainless Steel	black Filled letters

Variants

Mounting Diameter [mm]	Terminal	Housing Material	Actuator area	Type	Order Number
22	Flexible wire	Stainless Steel	Stainless Steel	PSE M 22 HI	1241.3993
22	Flexible wire	Stainless Steel	Stainless Steel	PSE M 22 HILE	1241.3993.061

Legend:

Type:

HI = High Impact

LE = Lettered

The nut with gasket are enclosed in the box.

The listed item numbers represent a selection from the range of piezo switches.

Other mounting diameters, materials, colors and connections are available on request.