

## UL Certified LED Panel Light(0-10V Dimming)

125LM/W, PREMIUM VERSION

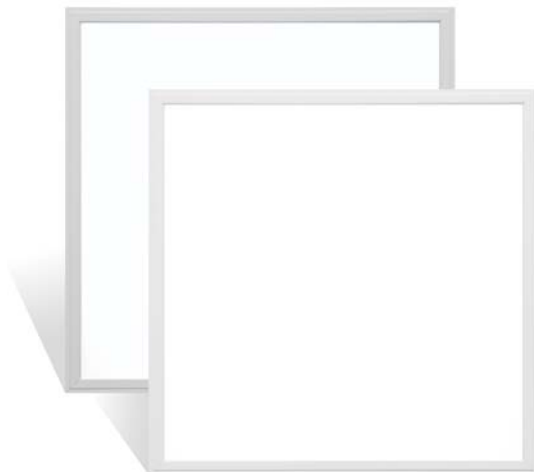

### Description

LED Panel Light . Using Light Guide Diffuser, it features uniform and smooth light distribution, low glare, low light pollution, and excellent protection from eyestrain. It can be used as interior lighting in shops, supermarkets, malls, hospitals, etc.

### Features

#### 1. Visual uniformity

- The edge-lit LED panels blend with various ceiling details and produces a soft natural light

#### 2. Low glare lighting

- The edge mounted LEDs give an even glare free illumination with a comfortable lighting environment.

#### 3. LED efficiency

- High lumen LED efficacy paired with high power factor drivers reduce operating cost.

#### 4. Luminaire construction

- A powder coat painted extruded aluminum frame encompasses the perimeter of multi-layered acrylic panel system..The fireproof metal junction box is attached at the backside of the panel light.

#### 5. Cost and energy saving

- 50% or more energy saving compared to fluorescent tubes.
- Low heat generation, extra energy savings through reduction of HVAC load.
- Easy installation: only 3 steps in 2 minutes, labor cost saving
- 9mm thickness with very light weight, space and transportation cost saving

#### 6. Long life time

- More than 50,000 hours life time and 5 years warranty.

## Specifications

Model	CCT	SIZE (feet)	Color	LED Type	Lumen(lm) (±10%)	CRI	Beam angle	Power(W) (±10%)	Voltage (V)	Dimmer	Current (A)	PF
EPS-20W-600-30K-2	3000K	2*2	warm white	2835	2400 lm	>80	110°	20W	AC100-277V 50/60Hz	0-10V	0.5	>0.95
EPS-20W-600-40K-2	4000K	2*2	natural white		2500 lm	>80	110°					
EPS-20W-600-50K-2	5000K	2*2	cool white		2500 lm	>80	110°					
EPS-25W-600-30K-2	3000K	2*2	warm white	2835	3000 lm	>80	110°	25W	AC100-277V 50/60Hz	0-10V	0.5	>0.95
EPS-25W-600-40K-2	4000K	2*2	natural white		3125 lm	>80	110°					
EPS-25W-600-50K-2	5000K	2*2	cool white		3125 lm	>80	110°					
EPS-30W-600-30K-2	3000K	2*2	warm white	2835	3600 lm	>80	110°	30W	AC100-277V 50/60Hz	0-10V	0.5	>0.95
EPS-30W-600-40K-2	4000K	2*2	natural white		3750 lm	>80	110°					
EPS-30W-600-50K-2	5000K	2*2	cool white		3750 lm	>80	110°					
EPS-40W-600-30K-2	3000K	2*2	warm white	2835	4800 lm	>80	110°	40W	AC100-277V 50/60Hz	0-10V	0.5	>0.95
EPS-40W-600-40K-2	4000K	2*2	natural white		5000 lm	>80	110°					
EPS-40W-600-50K-2	5000K	2*2	cool white		5000 lm	>80	110°					
EPS-20W-300-30K-2	3000K	1*4	warm white	2835	2400 lm	>80	110°	20W	AC100-277V 50/60Hz	0-10V	0.5	>0.95
EPS-20W-300-40K-2	4000K	1*4	natural white		2500 lm	>80	110°					
EPS-20W-300-50K-2	5000K	1*4	cool white		2500 lm	>80	110°					
EPS-30W-300-30K-2	3000K	1*4	warm white	2835	3600 lm	>80	110°	30W	AC100-277V 50/60Hz	0-10V	0.5	>0.95
EPS-30W-300-40K-2	4000K	1*4	natural white		3750 lm	>80	110°					
EPS-30W-300-50K-2	5000K	1*4	cool white		3750 lm	>80	110°					
EPS-40W-300-30K-2	3000K	1*4	warm white	2835	4800 lm	>80	110°	40W	AC100-277V 50/60Hz	0-10V	0.5	>0.95
EPS-40W-300-40K-2	4000K	1*4	natural white		5000 lm	>80	110°					
EPS-40W-300-50K-2	5000K	1*4	cool white		5000 lm	>80	110°					
EPS-30W-1200-30K-2	3000K	2*4	warm white	2835	3600 lm	>80	110°	30W	AC100-277V 50/60Hz	0-10V	0.5	>0.95
EPS-30W-1200-40K-2	4000K	2*4	natural white		3750 lm	>80	110°					
EPS-30W-1200-50K-2	5000K	2*4	cool white		3750 lm	>80	110°					
EPS-40W-1200-30K-2	3000K	2*4	warm white	2835	4800 lm	>80	110°	40W	AC100-277V 50/60Hz	0-10V	0.5	>0.95
EPS-40W-1200-40K-2	4000K	2*4	natural white		5000 lm	>80	110°					
EPS-40W-1200-50K-2	5000K	2*4	cool white		5000 lm	>80	110°					
EPS-50W-1200-30K-2	3000K	2*4	warm white	2835	6000 lm	>80	110°	50W	AC100-277V 50/60Hz	0-10V	0.5	>0.95
EPS-50W-1200-40K-2	4000K	2*4	natural white		6250 lm	>80	110°					
EPS-50W-1200-50K-2	5000K	2*4	cool white		6250 lm	>80	110°					

## Applications

X Series Square Panel Light can be used in hotels, meeting rooms, factories, offices, commercial purposes, residential, institution buildings, schools, hospitals, places which need energy saving and high color rendering index lighting.



## Dimensions (Unit: feet)

### 2x2 feet

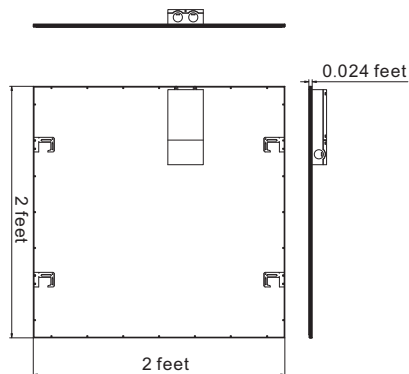

All dimension tolerance is  $\pm 0.5\text{mm}$  unless otherwise noted.

### 1x4 feet

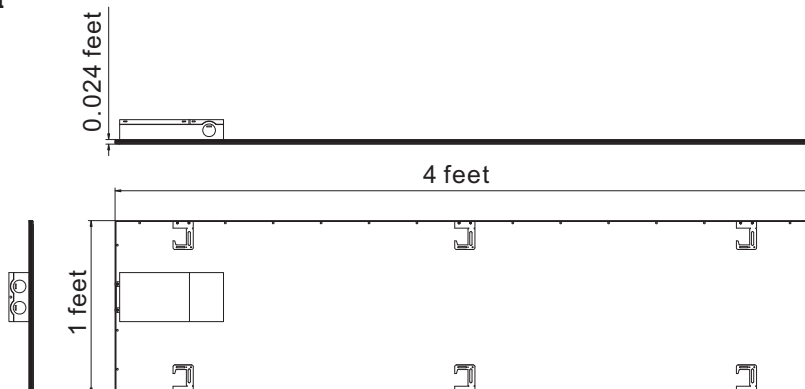

All dimensions tolerance is  $\pm 0.5\text{mm}$  unless otherwise noted.

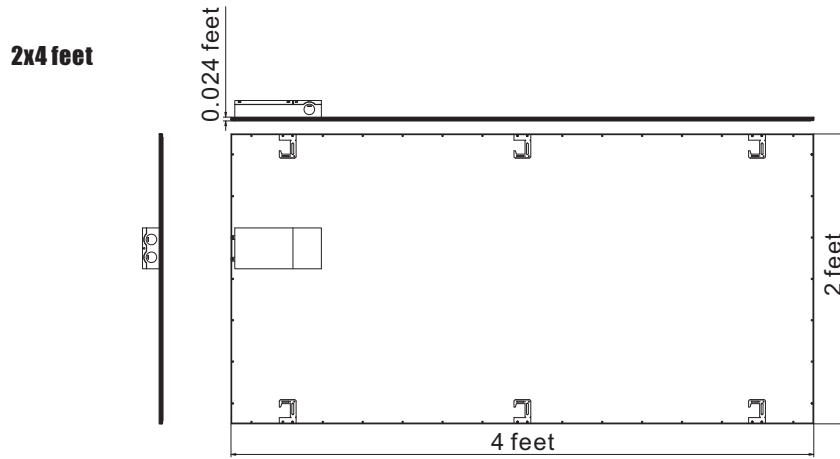

All dimension tolerance is  $\pm 0.5\text{mm}$  unless otherwise noted.

## Electrical Connection

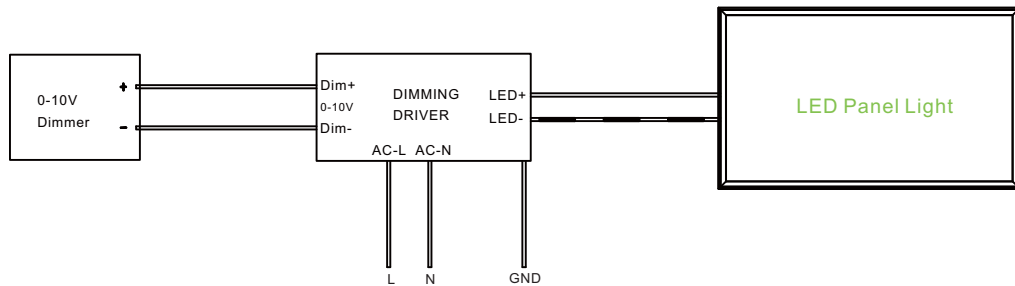

## Installation Instructions

### Embedded Installation

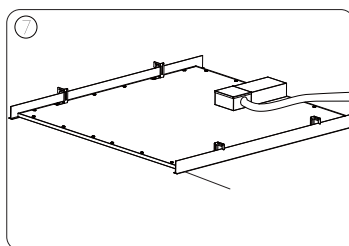
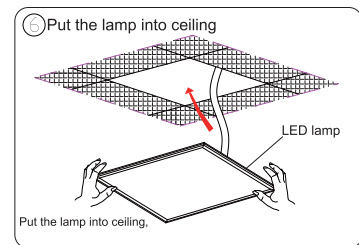
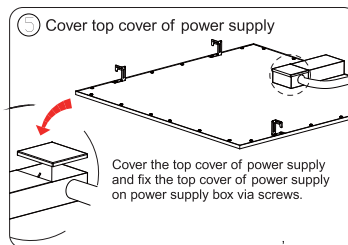
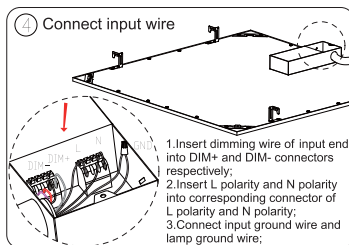
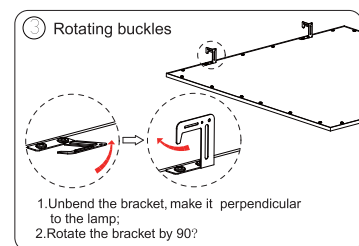
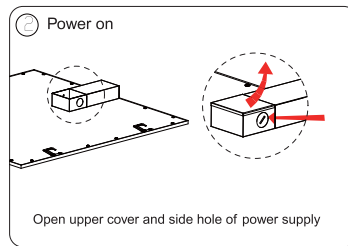
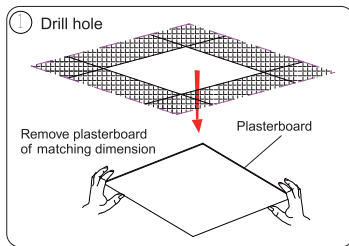

**Product packaging information:**

<b>2*2</b>	<b>1*4</b>	<b>2*4</b>
<ul style="list-style-type: none"><li>● Net weight/PC: 3.0kg</li><li>● gross weight/CTN: 15kg</li><li>● Inner size: 649X647X108mm</li><li>● Carton size: 670X675X240mm</li><li>● 2pcs/inner box,2 inner boxes/carton</li></ul>	<ul style="list-style-type: none"><li>● Net weight/PC: 3.0kg</li><li>● gross weight/CTN: 17kg</li><li>● Inner size: 1256X349X108mm</li><li>● Carton size: 1280X240X375mm</li><li>● 2pcs/inner box,2 inner boxes/carton</li></ul>	<ul style="list-style-type: none"><li>● Net weight/PC: 6.0kg</li><li>● gross weight/CTN: 28kg</li><li>● Inner size: 1255X647X94mm</li><li>● Carton size: 1290X680X220mm</li><li>● 2pcs/inner box,2 inner boxes/carton</li></ul>

**! Notice**

- 1.Please read the specification first, to make sure the service environment matches the condition in the specification before using.
- 2.Please confirm corerct power supply before using.
- 3.Make sure to switch off product before connecting to the power supply to prevent electric shock.
- 4.Operating outside of recommended guidelines may damage your property even harm to your personal safety.
- 5.Preliminarily estimate required quantity of LED panel lights, based on the power rating of each single panel light figure out the total power and design power supply plan.
- 6.Dangerous high voltage, Non-professionals are not allowed to maintain the products.
- 7.If the exterior flexible cable or wire is damaged, it must exchanged by the supplier, its agent or other similar qualified personnels to avoid dangers.