

Solution for Mass Production of Small High-Precision Parts

*Workpiece size less than 50mm,
Tolerance requirement 5 μ m ~ 10 μ m*



Part dimension variation over time	: Less than 5μm
Part dimension variation at short time stop	: 2μm (After 30min stop)
Roundness	: Less than 0.4μm
Surface finish	: 1.0μm (Ry)

*Above results are based upon extensive tests under our prescribed conditions.

The most suitable machine for automated line!!

- MW40 achieve less than 5 μ m of thermal displacement even with the indexing style turrets.
- An integral, intelligent 3-axis CNC gantry loader offers versatile automation.

- Live tool drive and Y-axis function is available as an option. MW40 is ideal for process integration of small parts production.

Separate bed constructions eliminate the transfer of harmonic vibrations.

Completely separated bed construction minimizes the transfer of harmonic vibrations from the opposite spindle. The rigidity of the turret design of the MW40 machine enables processing of high precision parts.

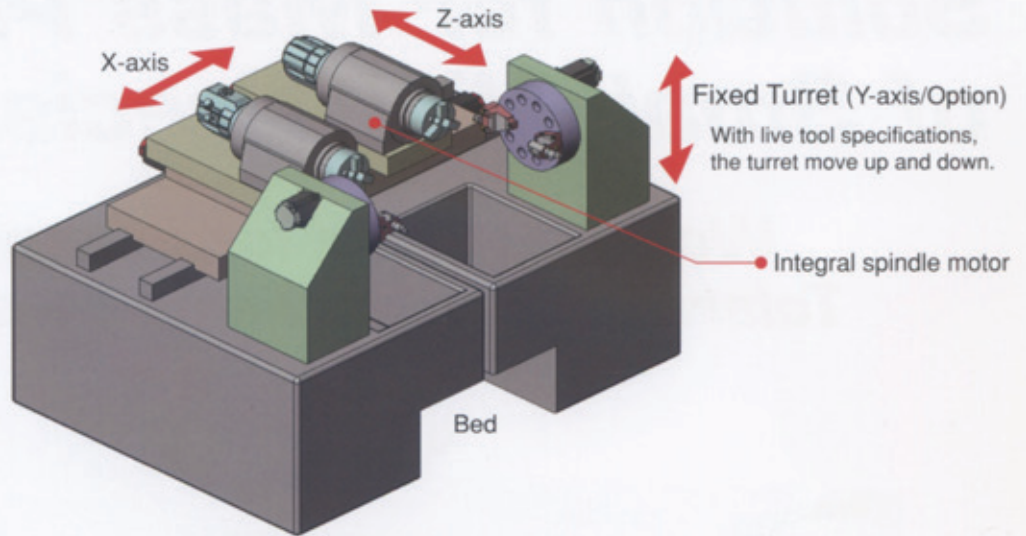

Specifications

Workpiece size	ø50 mm × 90L mm	
Chuck size	4inch (ø110 mm)	
	5inch (ø135 mm)	
Spindle drive motor	3.7 kW/30min (2.2 kW/continuous)	
Spindle speed range	8,000 rpm. (Option:10,000 rpm)	
Number of turret stations	Turret 10 x 2	
Spec. of axes	X-axis	155 mm (15 m/min)
	Z-axis	170 mm (15 m/min)
Use tool	O.D tool	□16 mm, □20 mm
	I.D tool	ø25 mm
Foot print	1,590 mm x 1,950 mm	
Total weight	3,500 kg	

Live tooling specifications (Option)

Live tool drive motor	1.4 kW / 5,000 rpm (Max. torque 2.8 Nm)	
Maximum speed	6,000 rpm	
Maximum tool shank size	Milling	ø7
	Tapping	M6
Y-axis stroke	±25mm (12m/min)	

Floor Plan

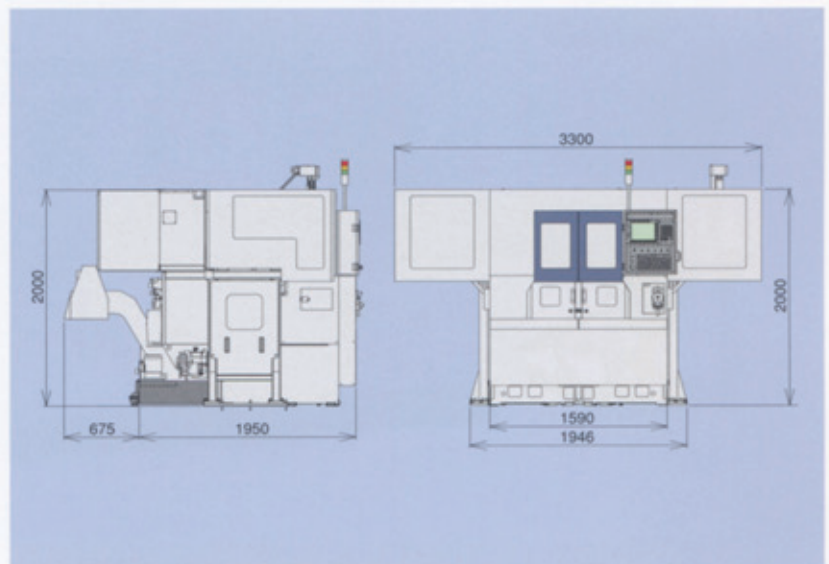

EXTERNAL COLOR light gray/gray blue
Other colors available on special order.

* Machine appearance may differ to that shown in the catalogue pictures
* All specifications are subject to change without advanced notice

MURATA MACHINERY, LTD. MACHINE TOOLS DIVISION

International Business Dept.
2, Nakajima, Hashizume, Inuyama-shi, AICHI 484-8502, JAPAN
TEL: +81-(0)568-61-3645 FAX: +81-(0)568-61-6455

Headquarters
136, Takeda-Mukaishiro-cho, Fushimi-ku, KYOTO 612-8686, JAPAN
TEL: +81-(0)75-672-8138 FAX: +81-(0)75-672-8691

<http://www.muratec.co.jp>
e-mail info@muratec.co.jp

MURATA MACHINERY USA, INC.

2120 Queen City Drive, P.O.Box 667609,
Charlotte, N.C. 28208, U.S.A.
TEL: +1-704-875-9280 FAX:+1-704-392-6541
<http://www.muratec-usa.com>

MURATA MACHINERY EUROPE GmbH

Hanns-Martin-Schleyer-Straße 3, D-47877, Willich, GERMANY
TEL: +49-(0)2154-914-250 FAX: +49-(0)2154-914-283
<http://www.muratec-europe.de/>
e-mail info@muratec.de

MURATA DO BRASIL COMERCIO E REPRESENTACAO DE MAQUINAS LTDA.

Estrada de Santa Isabel, 3383-KM 38,5,
Itaquaquecetuba-SP,CEP 08599-000, BRASIL
TEL: +55 (11) 4648-6222 FAX: +55 (11) 4648-6737
<http://www.muratec.com.br>
e-mail muratec@muratec.com.br

MURATA MACHINERY (SHANGHAI) CO.,LTD.

[Registry Add]
135 Fu Te Xi Yi Rd., Wai Gao Qiao Free Trade Zone,
Pudong, Shanghai, CHINA
[Contact Add]

150 Xin Gao Rd., Qingpu Industrial Zone,
Shanghai, 201700, CHINA
TEL: +86-(0)21-6921-2300 FAX: +86-(0)21-6921-2330

MURATA (THAILAND) CO., LTD.

896/14 S.V.City Building 1, 9th Floor, Rama 3 Road
Bangpongpan, Yannawa, Bangkok 10120, THAILAND
TEL: +66-(0)2294-7734-40 FAX: +66-(0)2294-7732

