

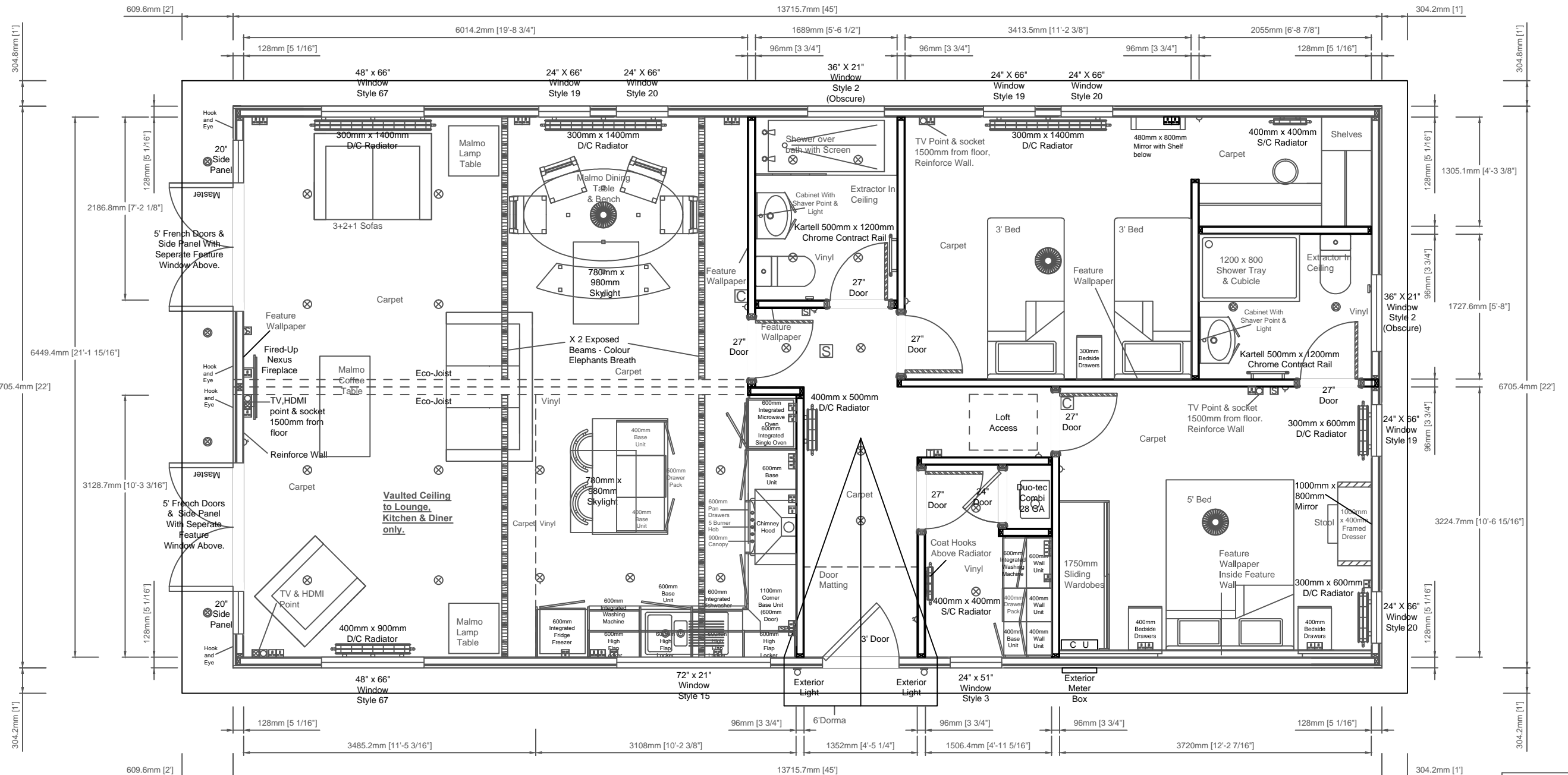

Elevations Are For Illustrative Purposes Only



| Room Sizes | | |
|---------------|--------|-------|
| Rooms | Length | Width |
| Lounge/ Diner | 19'9" | 21'2" |
| Kitchen | 10'3" | 10'4" |
| Bathroom | 5'7" | 7'3" |
| Bedroom 1 | 12'3" | 10'7" |
| Bedroom 2 | 11'3" | 10'4" |
| Ensuite | 6'9" | 5'8" |
| Wardrobe | 6'9" | 4'4" |



Unit 4, Pychley Lodge Road Industrial Estate, Kettering, Northants NN15 6JQ
 Tel: 01536 518513 Fax: 01536 523438
 Email: sales@prestigeparkandleisurehomes.com
 Visit our website: www.prestigeparkandleisurehomes.com

Prestige Contemporary 45' x 22' (13.72m x 6.70m)
 1Double 1Twin, En-Suite, WiW, Utility

Customers Signature: _____
 Date: _____

| | | | |
|------------|----------|--|---------------------|
| Date: | | This home is designed in accordance with BS3632 | |
| Scale: | Relative | Legend △ Light Switch † Exterior Tap ○ Pull Card Switch □ TV Point ▽ Batten Holder ⊞ Phone Point ⊙ Globe Light ⊠ HDMI Point ⊗ Exterior Light ⊞ Thermostat ⊙ Downlight ⊞ CO ₂ Alarm ⊞ Single Socket ⊞ Smoke Alarm ⊞ Double Socket ⊞ Radiator ⊞ Spur Socket ⊞ Consumer Unit ⊞ Switching Plate ⊞ Exterior Meter Box | |
| Drawn: | | Rev | Date By Description |
| Code: | | | |
| Dwg No: | | | |
| Serial No: | | | |

Notes:
 • Timber Ogee Door Casings

This plan is a guide and should be used for illustrative purposes only