

# SS/SSC 103 Multipole Plugs

All dimensions see note 1)

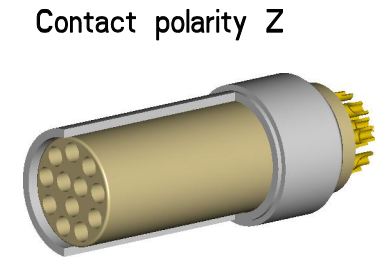
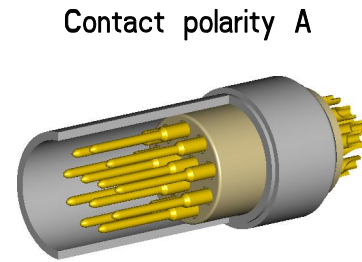
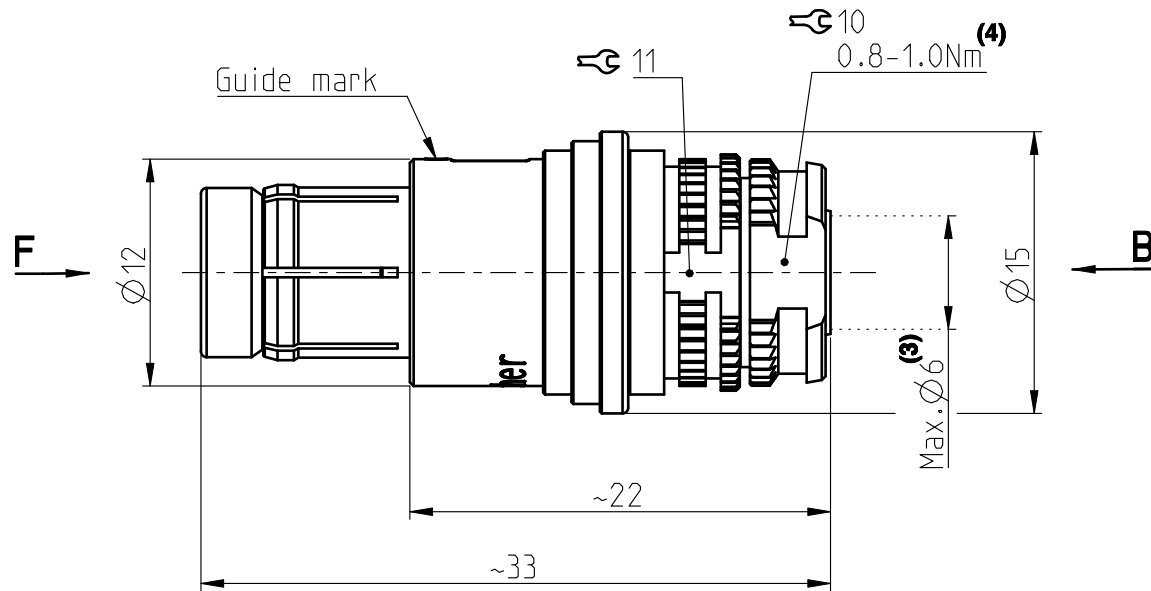

CONTACT CONFIGURATION	Contacts	Solder cup $\varnothing$	Crimp <sup>(2)</sup> $\varnothing$
103 A Z 051	2	1.18	1.18
103 A Z 052	3	1.18	-
103 A Z 053	4	0.79	-
103 A Z 054	5	0.79	0.80

Contact configuration for polarity A (View from B)

051

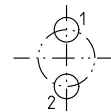

052

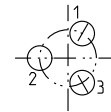

053

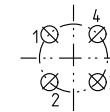

054

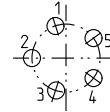

Keying codes (View from F)

Code 1 (-1xx)

Code 2 (-2xx)

Code 3 (-3xx)

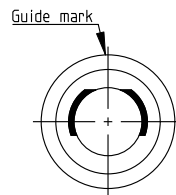
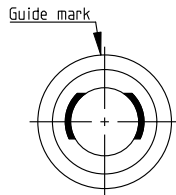
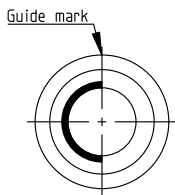

Contact configuration for polarity Z (View from B)

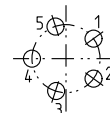
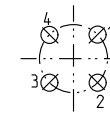
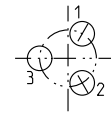
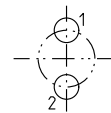

All dimensions in mm

Rev.

Pages

Notes :

600493

2

1/2

1) All tolerances resulting from connector assembly are typically  $\pm 0.3\text{mm}$   
 2) For optimum crimping refer to available crimping manual.  
 3) Max cable diameter below shield  
 Part number example : SS 103 A062-130

4) This torque is a recommended value that may be influenced by the characteristics of the cable. Tests have to be made to evaluate the exact value. To secure the back nut, we recommend the use of thread locking adhesive.

**fischer**  
CONNECTORS

www.fischerconnectors.com

# SS/SSC 103 Multipole Plugs

All dimensions see note 1)

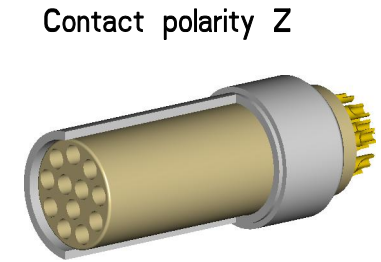
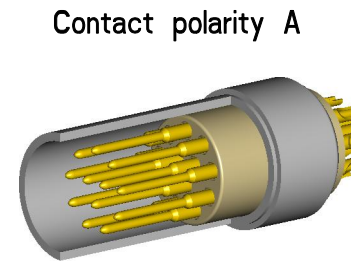
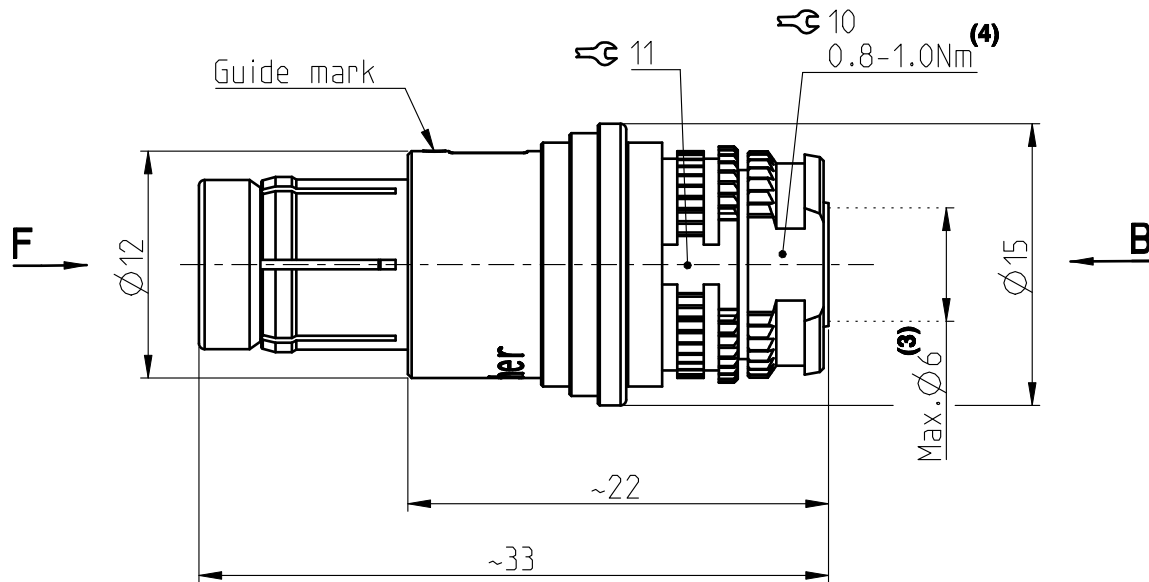

CONTACT CONFIGURATION	Contacts	Solder cup Ø	Crimp cup Ø <sup>(2)</sup>
103 A Z 056	6	0.79	0.60
103 A Z 057	7	0.79	0.60
103 A Z 058	8	0.79	0.60
103 A Z 062	12	0.43	-

Contact configuration for polarity A (View from B)

056 (5)

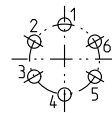

057 (5)

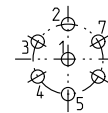

058

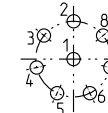

062

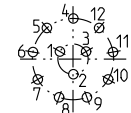

Keying codes (View from F)

Code 1 (-1xx)

Code 2 (-2xx)

Code 3 (-3xx)

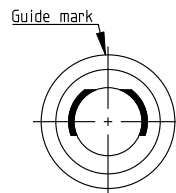
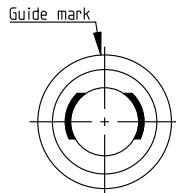
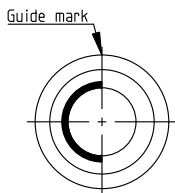

(5)

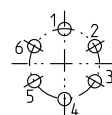

(5)

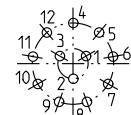
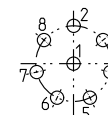
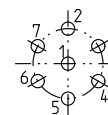

Contact configuration for polarity Z (View from B)

All dimensions in mm

600493

Rev.

2

Pages

2/2

Notes :

- 1) All tolerances resulting from connector assembly are typically  $\pm 0.3\text{mm}$
  - 2) For optimum crimping refer to available crimping manual.
  - 3) Max cable diameter below shield
- Part number example : SS 103 A062-130

4) This torque is a recommended value that may be influenced by the characteristics of the cable.

Tests have to be made to evaluate the exact value.

To secure the back nut, we recommend the use of thread locking adhesive.

5) Only valid for Code 1. For other codes please contact us.

**fischer**  
CONNECTORS

www.fischerconnectors.com