

**40-50 PRINCES STREET  
IPSWICH IP1 1RJ**



## **FOR SALE/TO LET:**

**13,813 sq ft of Modern Office Space over 4 floors** (can be sub divided)  
Would suit owner/occupier or investor



## LOCATION:

Situated 70 miles north-east of London, Ipswich (together with Chelmsford and Colchester) is a key commercial centre within the A12 corridor. It is the administrative and county town of Suffolk and one of the principal commercial and financial centres of East Anglia. Located at the intersection of the A12 and A14, Ipswich occupies a strategic position with the A14 being a major arterial route connecting the M1/A1 in the west to the Port of Felixstowe, the UK's largest container port, 9 miles to the south. Ipswich also benefits from an excellent train service, with fast train times of only 70 minutes into London Liverpool Street.

Ipswich has an urban population of 133,400 and serves a primary catchment population estimated at over 275,000. It is home to employers such as Willis, AXA, Churchill Insurance, WNS, BT plus a concentration of public sector providers such as Ipswich Borough Council, Suffolk County Council and Suffolk Police.



## SITUATION:

The premises are on a highly prominent position on the west side of Princes Street, just to the north of Civic Drive/Franciscan Way, thereby affording the property superb visibility when approaching from the south. It is in the heart of the town's central business district, moments from Cornhill, the prime pedestrianised pitch of Butter Market and the Butter Market Shopping Centre.

Directly opposite the property is Norman Foster's iconic listed Willis Building, a local landmark occupying an island site and recognised for its dark glass facades and almost Pompidou Centre qualities, with the building's feature plant visible through the glass facades. Other occupiers in the vicinity include Barclays Bank and several national estate agencies and recruitment companies, whilst the town's leading law firms such as Birketts, Gotelee and Prettys are close by.

Ipswich mainline station is approximately 8 minutes walk away, while numerous bus routes operate in the area.



# DESCRIPTION:

The building was constructed in 2009 and comprises bright, contemporary air-conditioned office accommodation over 4 floors. It is currently fully let, with 50% available to let from January 2019.

|                            |                     |
|----------------------------|---------------------|
| GROUND FLOOR               | 3,684 sq ft         |
| FIRST FLOOR                | 4,091 sq ft         |
| SECOND FLOOR               | 3,541 sq ft         |
| THIRD FLOOR                | 2,497 sq ft         |
| <b>Total Internal Area</b> | <b>13,813 sq ft</b> |

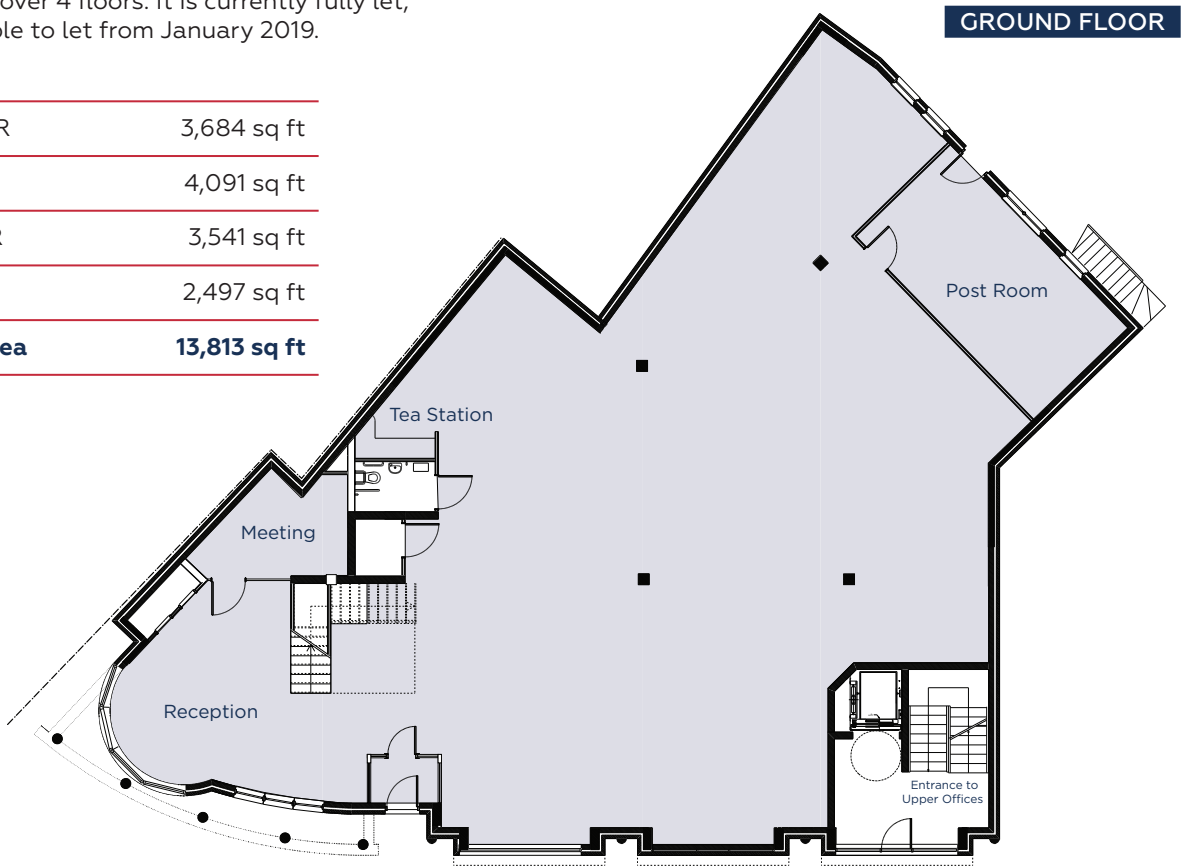

The specification includes the following:

- VRV air cooling/heating
- Full access raised floors
- Eight person passenger lift
- Contemporary plastered ceilings
- LG7 compliant lighting
- Video access entry system
- Excellent natural light from generous fenestration
- Parking for at least 10 cars



SECOND FLOOR

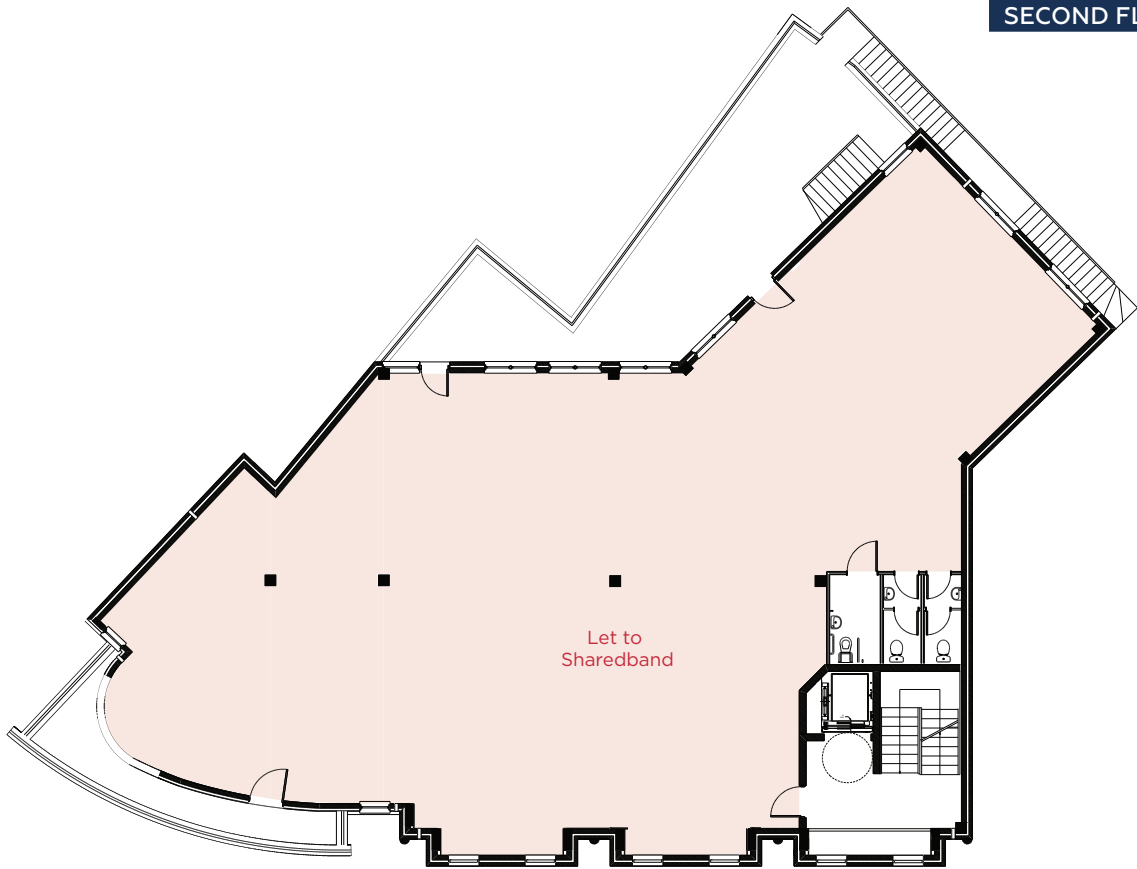

THIRD FLOOR







## TENURE:

Part let investment for sale, freehold price upon application

## TERMS:

The premises are available by way of assignment at a rent of £20 per sq ft.

Tenant part first plus second and third floors, 7,363 sq ft; lease term 29.06.12 to 28.06.27, rent review 28.06.27; break 29.06.22 – rent £85,000 pa, service charge cap £17,558.38 subject to RPI increases.

The service charge covers facilities costs, health and safety, utilities (electricity), refuse removal, pest control, external landscaping, repairs and maintenance – air conditioning, fire prevention, repairs and maintenance – external including car park barrier and electricity supply, management fee and service charge budget auditing.

## LEGAL COSTS:

Each party to bear their own legal costs.

### Notices relating to Property Misrepresentation, Property Misdescriptions & Financial Services Acts

Penn Commercial and Reader Commercial as agents for vendors/lessors of this property give notices that: 1. The information contained within these particulars has been checked and is understood to be materially correct at the date of publication. 2. All descriptions, statements, dimensions, references to availabilities, conditions and permissions for use and occupations or other details are given in good faith. However, they are made without responsibility, and should not be relied upon as representations of fact. Intending purchasers or tenants should, by enquiry to this office, satisfy themselves as to the correctness and availability in each case before arrangements are made to travel and view. 3. Unless otherwise stated, all prices, rents and other charges are quoted exclusive of Value Added Tax (VAT). Any intending purchasers or tenants must satisfy themselves independently as to the incidence of VAT in respect to any transaction. 4. All plant, machinery, equipment, services and fixtures and fittings referred to in these particulars were present at the date of publication. They have not, however, been tested and nor any person in their employment have any authority to make or give, any representation or warranty whatsoever in relation to this property. 5. Penn Commercial and Targetfollow Estates do not hold themselves out as providing any legal, financial or other advice. These particulars do not constitute advice and you should not rely on this material in making (or refraining from making) any decision to take (or refrain from taking) any action. 6. The information contained in these particulars is of general nature and may not be applicable to your own specific circumstances. If you are in any doubt, please seek professional advice.

## VIEWING:

Strictly by prior arrangement with joint agents:



01473 211933

[www.penn.commercial.co.uk](http://www.penn.commercial.co.uk)

[vanessa@penncommercial.co.uk](mailto:vanessa@penncommercial.co.uk)

Contact: Vanessa Penn



01473 289600

[www.readercommercial.com](http://www.readercommercial.com)

[martin@readercommercial.com](mailto:martin@readercommercial.com)

Contact: Martin Reader