

# WISE Quick Guide

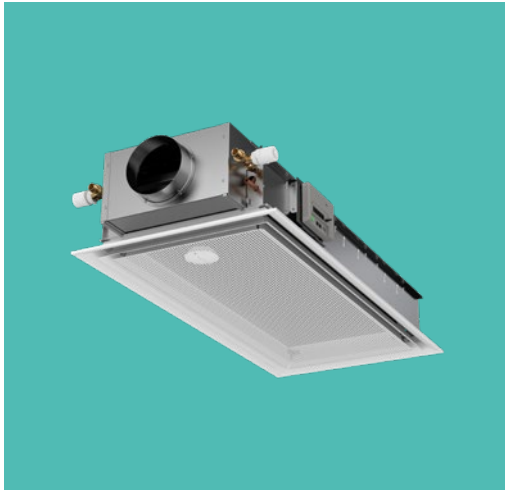

System and Product Overview.

# This is how WISE works!

Step by step

## System selection

Simple construction of the WISE system

WISE gives you a choice of airborne and waterborne room products, or a combination of both. Use Swegon ESBO to easily verify your system choices.



## Project planning

Complete overall solution

WISE is a complete system to give you maximum freedom to create the best combinations of products for each individual interior.



## Installation

Wireless communication minimises cable routing

Wireless communication between the products significantly reduces installation time and eliminates the risk of misconnections. Logistics throughout the building process are simplified, as no unique pre-configurations are required – all you need to do is install the right type of product in the right place.





## Operation

### Flexible

The SuperWISE interface gives you an instant overview and control over the entire system. If any system requirements need to be adjusted, for instance, if walls are moved or activities in the premises change, the system configuration can be altered. Product updates are sent out via the radio network with a minimum of disruption to existing activities.

## Commissioning

### Quick and easy!

The system's components are digitally matched with the role they assume in the system. The first time the system is started, each component is configured automatically, which saves time and eliminates the risk of human error. Moreover, Swegon engineers will always be present for your systems commissioning to ensure that everything is up and running.



## Additional help

I would like to know more about the WISE system in general

I would like help to plan the electricity, water and air

I would like detailed data for individual products

I would like help early in the construction process to select the system type

I want to check and see an overview of a specific WISE-system

See the System Guide

See the Project planning guides

See the Product data sheets

Log in to Swegon ESBO

Log in to SuperWISE

# WISE products and accessories

Wireless communication for easy system design

**SuperWISE II**  
With or without Swegon Connect  
Communication unit  
Wi-Fi / 



**WISE DIR**  
Director  
Central control unit  
Wi-Fi / 



**WISE Damper**  
Active damper  
Wi-Fi / 



**WISE Measure**  
Unit of Measurement  
Wi-Fi / 



**WISE Parasol**  
Comfort module with integrated flow control. Requires nozzle setting.  
Wi-Fi / 



**WISE Parasol Zenith**  
Comfort module with integrated variable flow control  
Wi-Fi / 



**WISE Colibri C**  
Active air diffuser  
Wi-Fi / 



**WISE Sphere C**  
Active air diffuser  
Wi-Fi / 



**WISE Sphere F**  
Active air diffuser  
Wi-Fi / 



**Air and waterborne products**  
Products for constant air flow (Can require controllers)  



**WISE DPS Modbus**  
Duct pressure sensors  

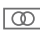

**WISE CU \***  
Controller Unit  
Wi-Fi / 



**WISE SMA \***  
Sensor Module Advanced  
Air quality sensor  





**WISE SMB \***  
Sensor Module Basic  
Temperature/occupancy sensor  





**WISE IORE \***  
Input Output Radio Extender  
Radio communication bridge  
Wi-Fi / 



**WISE RTA**  
Room Temperature Adjuster  
Setpoint selector switch  
Wi-Fi / 

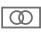

**WISE IAQ**  
Indoor Air Quality Sensor  
Air quality/temperature and moisture sensor  
Wi-Fi / 



**WISE IRT**  
Infra Red Temperature Sensor  
Temperature sensor  
Wi-Fi / 

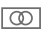

**WISE OCS**  
Occupancy Sensor  
Presence sensor  
Wi-Fi / 



**WISE WCS**  
Window Contact Sensor  
Combined window/door contact  
Wi-Fi / 



**WISE RTS**  
Room Temperature Sensor  
Temperature sensor  
Wi-Fi / 



**WISE IRE**  
Input Radio Extender  
Radio communication bridge  
Wi-Fi / 



**TuneWISE**  
Hand-held terminal  
Wi-Fi / 

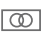

**Scanner TuneWISE**  
Hand scanner  
Wi-Fi / 



\*Factory-fitted accessories

# WISE - Solution for the

Large conference room  
Water and airborne

**WISE IAQ CO2**  
Air quality/temperature and moisture sensor

**WISE RTA**  
Setpoint selector switch

**WISE Parasol Zenith**

**WISE Colibri C**

**WISE Damper**

Small conference room  
Water and airborne

**WISE RTA**  
Setpoint selector switch

**WISE Parasol Zenith**

**WISE Colibri C**

**WISE Damper**

Rest room  
Airborne

**WISE WCS**  
Combined window/door contact

**WISE RTA**  
Setpoint selector switch

**WISE Sphere C**

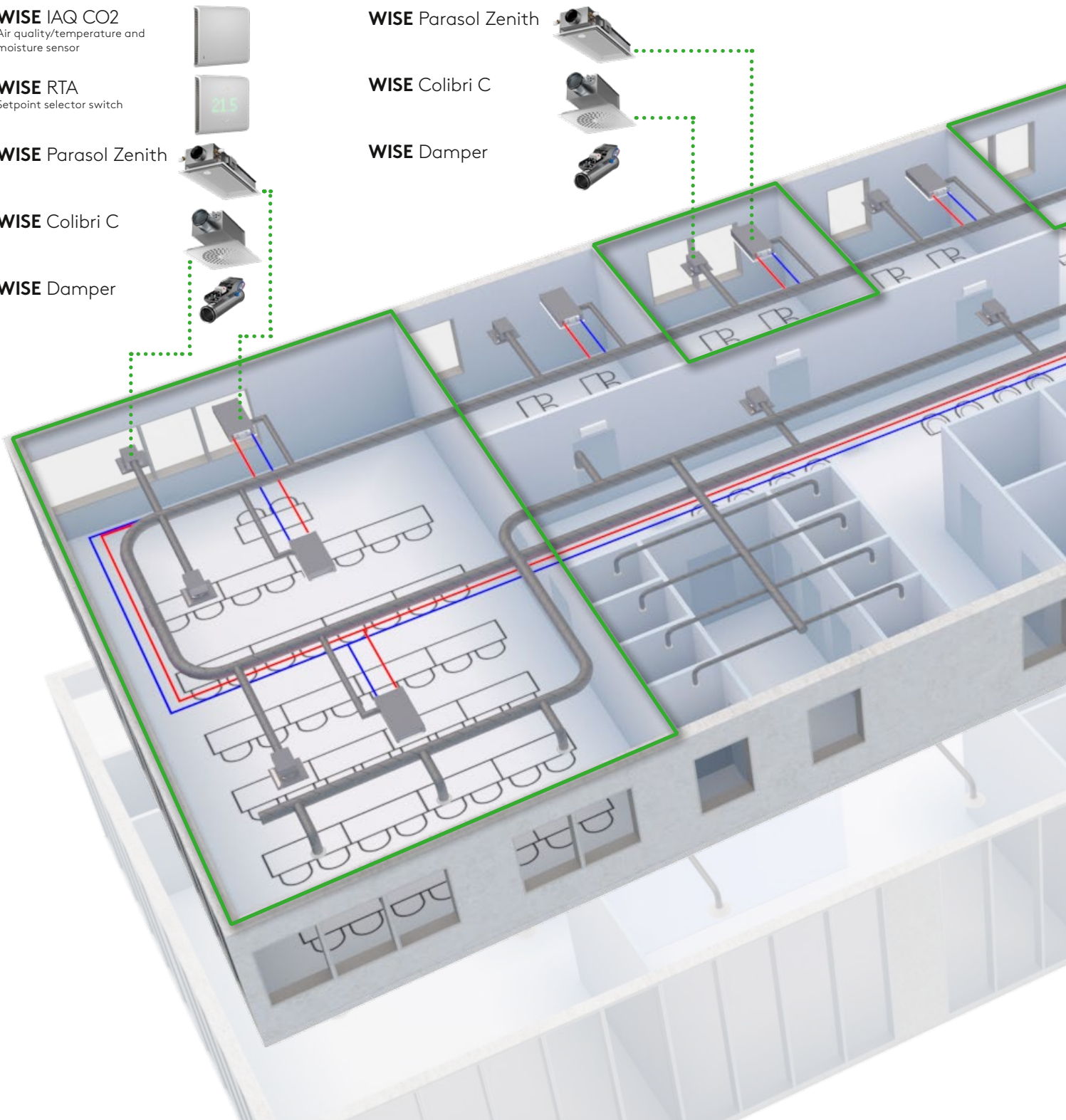

# the best indoor climate!

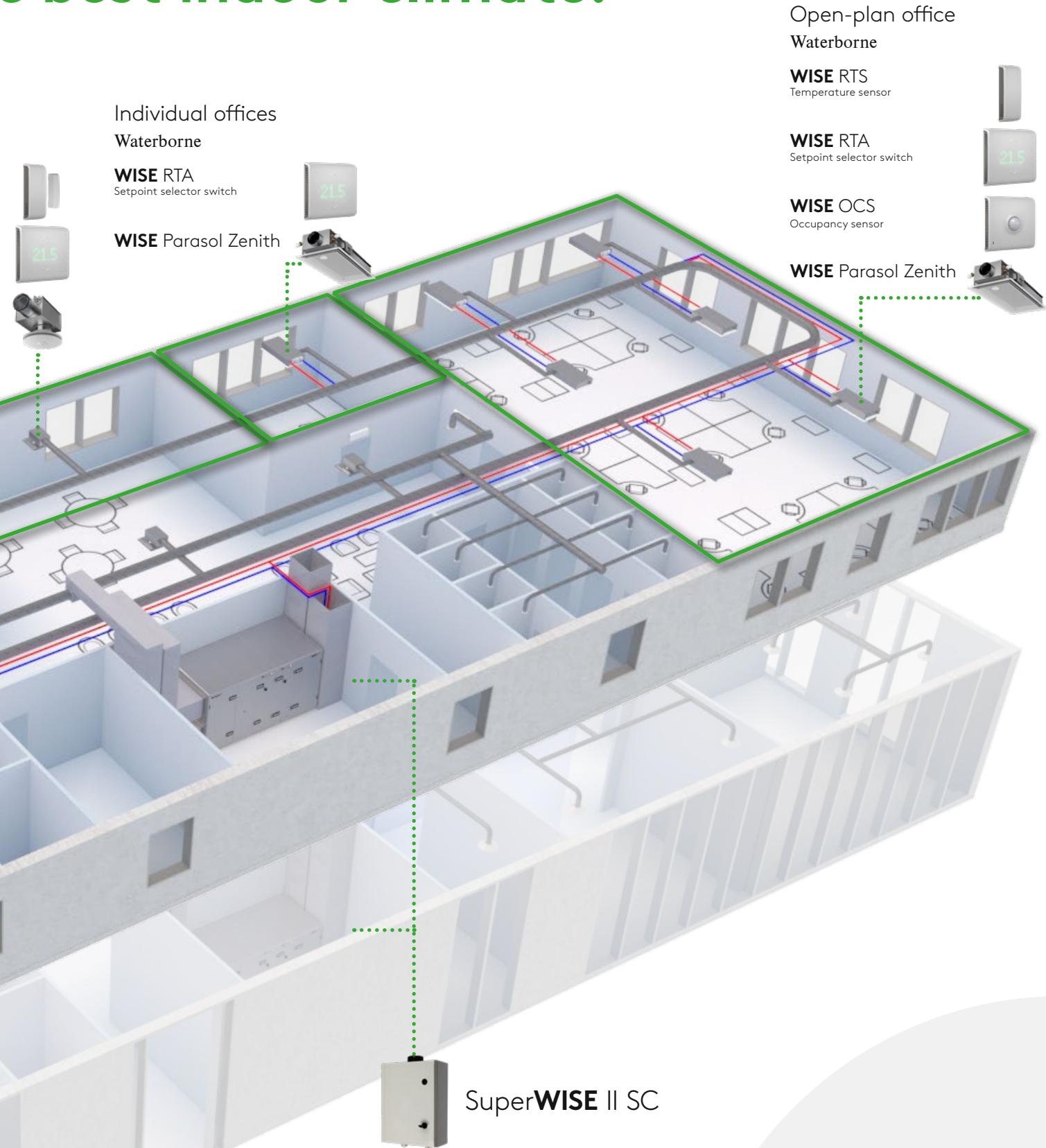

Individual offices  
Waterborne

**WISE RTA**  
Setpoint selector switch

**WISE Parasol Zenith**

Open-plan office  
Waterborne

**WISE RTS**  
Temperature sensor

**WISE RTA**  
Setpoint selector switch

**WISE OCS**  
Occupancy sensor

**WISE Parasol Zenith**

Super**WISE** II SC



Waterborne office with setpoint selector switch and occupancy sensor for demand-controlled ventilation, cooling and heating.



Conference room with setpoint selector switch and demand-controlled air regulation as well as waterborne cooling and control of radiators.



Office landscape with demand-controlled air regulation with setpoint selector switch and control of radiators.



Classroom with demand-controlled air regulation, occupancy sensor and control of radiators.



Hotel room with setpoint selector switch, waterborne cooling and heating as well as demand-controlled air. Key card holder for occupancy.

We make every breath count.

EN-WISE 2019-10-07

**Swegon**