

Interdoor UK  
315 Ideal Business Park  
National Avenue  
Hull HU5 4JB  
(United Kingdom)

Tel: +44 (0) 1482 247 375  
Email: [service@interdoor.uk](mailto:service@interdoor.uk)  
Web: [www.interdoor.uk](http://www.interdoor.uk)



## Technical Data

### Stacking Doors SPACELITE® HT 80 and HT80XL

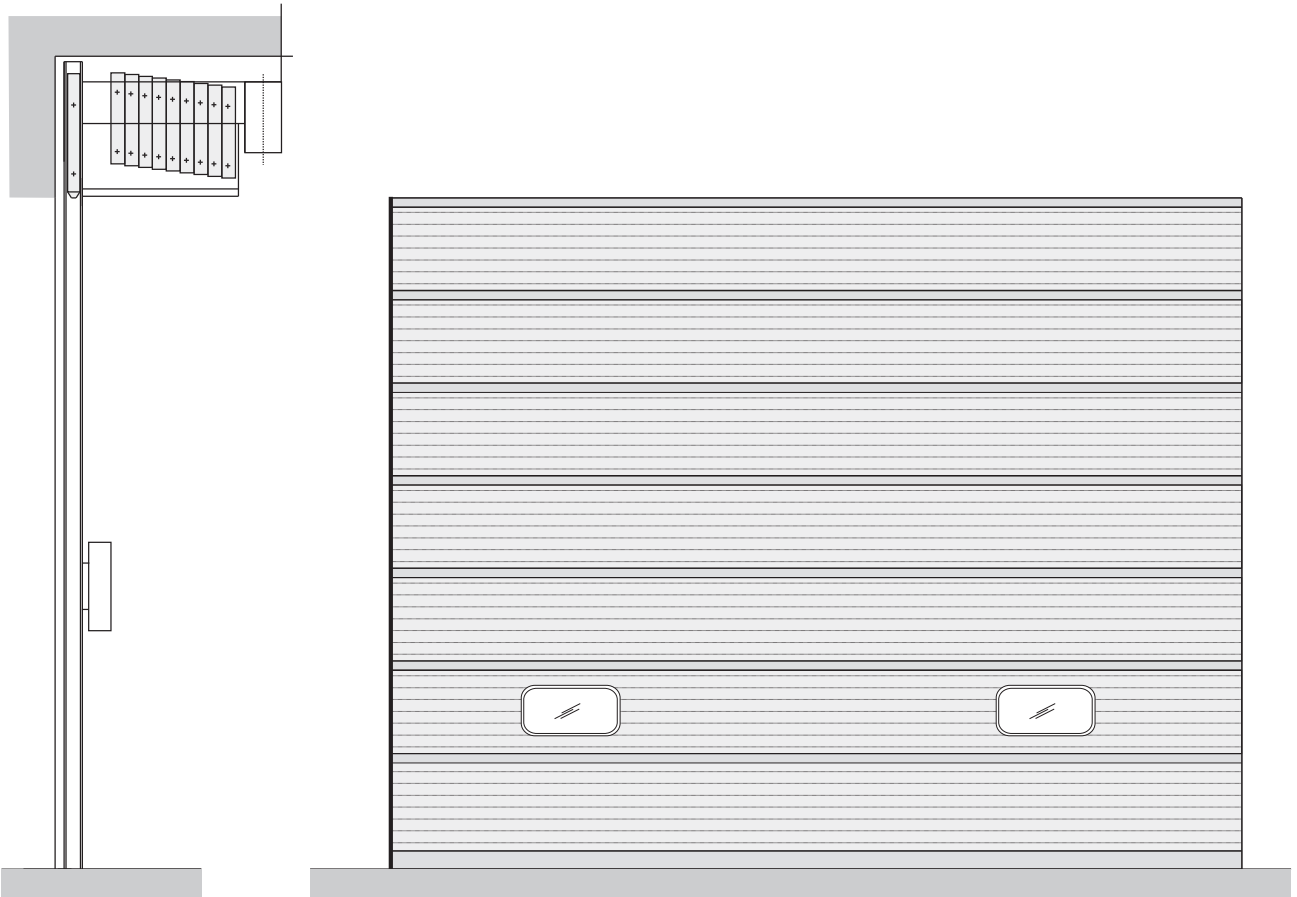

#### Mounting and Fixing Modes

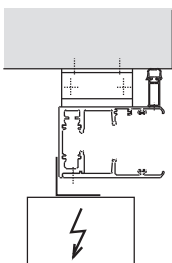

Assembly behind the reveal

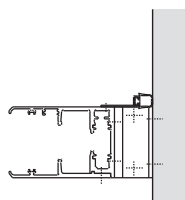

Assembly within the reveal

**Technical Data Stacking Doors · SPACELITE HT80 and HT80XL**

		HT80	HT80XL
<b>Door dimensions [mm]*</b>	Width min. / max.	2000 / 10 000	2000 / 10 000
	Height min. / max.	2000 / 6000	2000 / 16 000
<b>Required lintel height [mm]*</b>	min. / max.	1250	1300 / 1430
<b>Door panel height [mm]</b>	Approximate value (slight differences depending on type of door)	1000	1000
<b>Opening speed [cm/s]*</b>	(standard) / (optional) up to	14	14
<b>Opening cycles / duration in use*</b>	Number of cycles for continuous operation	5 cycles/hour	5 cycles/hour
	Increased number of cycles for a duration of max. 1 hour	10 cycles/hour	10 cycles/hour
<b>Opening cycles*</b>	Typically up to ..... cycles annually	30 000	30 000
<b>Resistance to wind load*</b>	Classification acc. to EN 12424**	2 - 4	2 - 4
<b>Air permeability</b>	Classification acc. to EN 12426**	2	3
<b>Resistance to water penetration</b>	Classification acc. to EN 12425**	2	2
<b>Airborne sound insulation Rw (C;Ctr)</b>	In dB according to EN ISO 717-1**	25	25
<b>Operating forces / safe opening</b>	According to EN 13241-1	achieved	achieved
<b>Up-Value* (door) attainable</b>	In W/m <sup>2</sup> K	1.6	1.6
<b>Cassettes</b>	Steel, galvanised	■	■
<b>Drive unit</b>	Gear motor including brake and integrated anti-drop device	■	-
	Gear motor including brake	-	■
	Driving power [kW]*	0.85 - 1.1	3
<b>Tracks vertical</b>	Trilaterally closed solid aluminium profile (standard: mill-finished)	■	■
<b>Door panel with fibreglass filling</b>	Twin-walled fibreglass panel, thickness in [mm]	80	80
	Colour shades fibreglass brilliant / emerald-green / sapphire-blue	■	■
	Vision elements with double glazing / size w x h [mm]	□/800x400	□/800x400
	U <sub>p</sub> -value for fibreglass incl. the max. no. of insertion foils in W/m <sup>2</sup> K	1.1	1.1
	Light transmission (depending on colour and U <sub>p</sub> -value) up to	41 - 75%	41 - 75%
	Fire behaviour acc. to EN13501 / building material class acc. to DIN 4102	E / B2	E / B2
<b>Emergency operation</b>	By hoist chain	■	■
	With uninterruptable power source	upon request	upon request
<b>Control</b>	<b>BDC E800 R / S</b> Relay / contactor control, mains connection <b>400 V/50 Hz</b> (L1,L2,L3,N,PE), fuse-protection <b>10 A</b> type C	■	■
<b>Safety</b>	TÜV-approved anti-drop device integrated inside the tracks	■	■
	Drive unit with integrated anti-drop device	■	-
	Closing edge monitored by an optoelectronic sensor, power supply either by energy chain or conductor rail	■	■
	External photo eye	□	□
	External light curtain	□	□
	Laser sensor	□	□
	Anti-push-up device	■	■
<b>Aluminium profile surfaces</b>	Mill-finished	■	■
	Anodised E6-C0 (EV1)	□	□
	RAL colour coated	□	□
	Anodised acc. to British Standard	□	□
<b>Options</b>	Car wash kit	upon request	upon request
	Lintel cover made of fibreglass	□	□
	Roofing for external installation	□	□
	Pivotable side-frame available either with or without passdoor, to increase the total passage width	□	□
	Tracks that are horizontally movable between two door systems	□	□