

Description

Soundis dry ScreedPanel 28 MF is a composite panel for acoustic flooring applications, consisting of an upper surface of 18mm reinforced gypsum fibre panel factory bonded to a 10mm recycled fibrous resilient layer. These dry fit screed replacement panels reduce floor height and save on drying times.

Soundis dry ScreedPanel 28 MF is ideally suited for acoustic flooring applications where high levels of impact sound performance are required; such as residential, care homes and student accommodation schemes.



Buildup visualisation

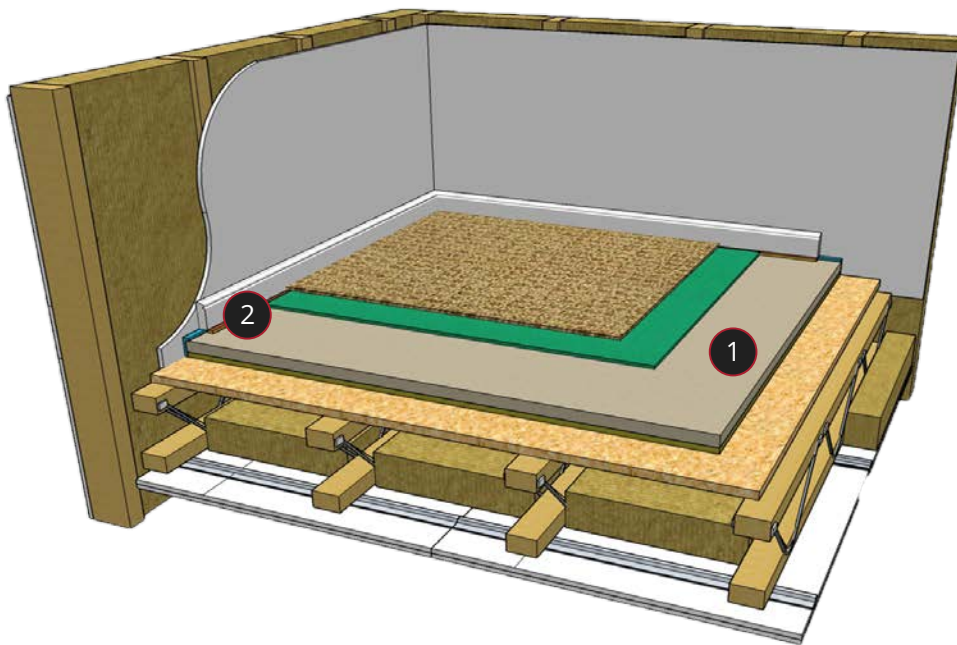

Visualisation buildup includes:

1. Soundis dry ScreedPanel 28 MF
2. L Shaped Flanking Strip

Product Weight and Dimensions

Panel Dimension	600mm (W) x 1200mm (L) x 28mm (H)
Panel m ²	0.72 m ² Per Panel
Panel Per Pallet	66 Panels (47.5 m ²)
Panel Weight	22.6 kg/m ² - 16.3 kg Per Panel
Pallet Dimensions	1200mm (W) x 1200mm (L) x 1050mm (H)
Pallet Weight	1100 kg
Density	1200 kg/m ³

Key Benefits



Ceramic and porcelain floors can be laid directly without decoupling mat



Non-combustible (A2)



T&G no screws required



Excellent impact sound performance



High Density

Typical Acoustic Performances

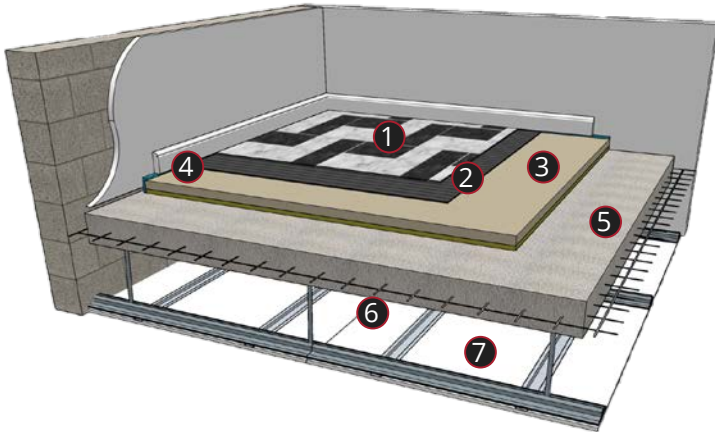

Concrete Insitu Floor

1. Ceramic tiles
2. Electric UFH cables set in tile adhesive
3. Dry ScreedPanel 28 MF
4. L Shaped Flanking strip
5. 200mm Reinforced insitu concrete slab
6. MF ceiling (min 100mm void)
7. 1 x 9.5mm acoustic plasterboard

DnT,w + Ctr
51dB
LnT,W
47dB
ΔL_w
22dB

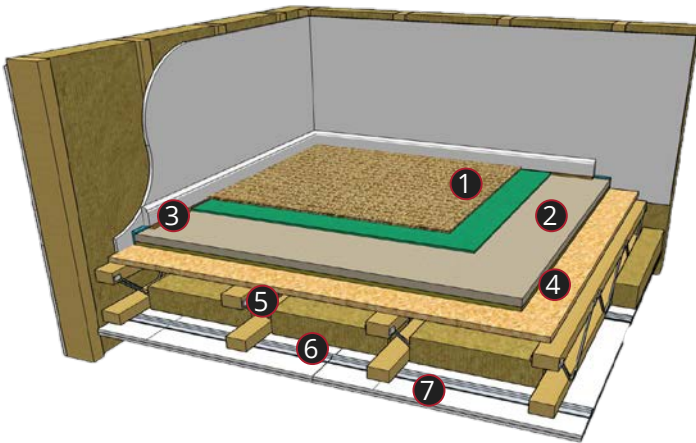

Timber Joisted Floor

1. Carpet & underlay
2. Dry ScreedPanel 28 MF
3. L Shaped Flanking Strip
4. 18mm (min) OSB or Chipboard subfloor
5. 225mm (min) timber floor joist
6. 16mm resilient bars
7. 2 x 15mm acoustic plasterboard

DnT,w + Ctr
50dB
LnT,W
56dB

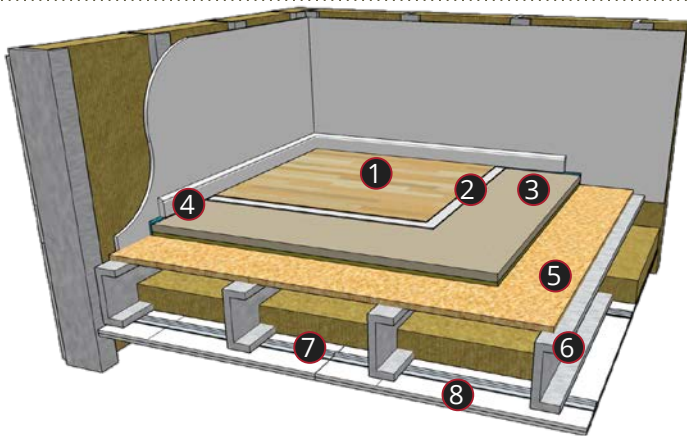

Steel Joisted Floor

1. LVT or sheet vinyl flooring
2. Self-levelling & adhesive layers
3. Dry ScreedPanel 28 MF
4. L Shaped Flanking Strip
5. 18mm (min) OSB chipboard subfloor
6. 225mm (min) steel floor joists
7. 16mm resilient bars
8. 2 x 15mm acoustic plasterboard

DnT,w + Ctr
53dB
LnT,W
55dB

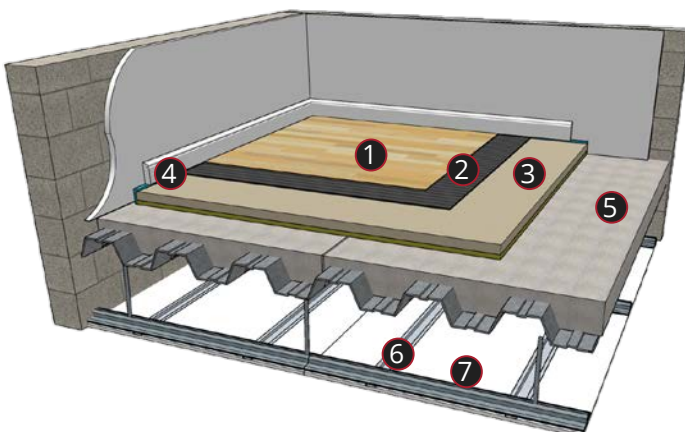

Profiled Metal Deck

1. Engineer timber flooring
2. Adhesive or decoupling layer
3. Dry ScreedPanel 28 MF
4. L Shaped Flanking Strip
5. 130mm concrete on profiled metal deck
6. MF ceiling (min 100mm void)
7. 1 x 9.5mm acoustic plasterboard

DnT,w + Ctr
52dB
LnT,W
47dB