

Timber to timber joist hangers; designed for use in loft conversions where the hanger extends below the support.

- The superior design does not require wide straps making them easier to install on site.
- Loads below are from tests where the Long Leg is hung 100mm below the support with all available holes nailed.
- Far greater load carrying capabilities than other leading brands.
- 450mm and 600mm legs available.

SPECIFICATION

- Tested by Lucideon Ltd.

INSTALLATION

- All holes should be nailed using 30 x 3.75 square twist nails or equivalent, for stainless steel products use 30 x 3.75 stainless steel annular ring shank nails.
- Always ensure that compatible corrosion resistant fixings are used, i.e. do not use galvanised fixings with stainless steel products or vice versa.

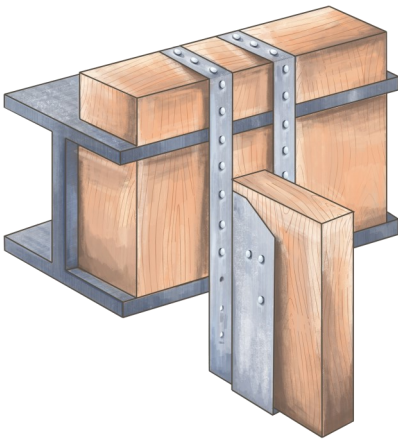

LL47X600 & LL47X450

Code	Product	Product Dimensions (mm)			Joist size (mm)	Characteristic Value (kN) for Eurocode 5	Safe Working Load for BS5268 (kN)			Box Qty.
		Width	Leg	Joist bearing			Short Term	Medium Term	Long Term	
Pre Galvanised Steel EN 10346 DX51D Z275 - 1.4mm										
LL38X450	Woody Long Leg	38	450	50	38 x 175 to 250	28.04	14.02	13.35	11.68	25
LL38X600	Woody Long Leg	38	600	50	38 x 210 to 300	28.04	14.02	13.35	11.68	25
LL44X450	Woody Long Leg	44	453	50	44 x 150 to 250	28.04	14.02	13.35	11.68	25
LL44X600	Woody Long Leg	44	600	50	44 x 200 to 300	28.04	14.02	13.35	11.68	25
LL47X450	Woody Long Leg	47	445	50	47 x 150 to 250	28.04	14.02	13.35	11.68	25
LL47X600	Woody Long Leg	47	600	50	47 x 200 to 300	28.04	14.02	13.35	11.68	25
LL50X450	Woody Long Leg	50	445	50	50 x 150 to 250	28.04	14.02	13.35	11.68	25
LL50X600	Woody Long Leg	50	600	50	50 x 200 to 300	28.04	14.02	13.35	11.68	25
LL63X450	Woody Long Leg	63	440	50	63 x 175 to 250	28.04	14.02	13.35	11.68	25
LL63X600	Woody Long Leg	63	600	50	63 x 220 to 300	28.04	14.02	13.35	11.68	25
LL76X450	Woody Long Leg	76	435	50	76 x 175 to 250	28.04	14.02	13.35	11.68	25
LL76X600	Woody Long Leg	76	600	50	76 x 220 to 300	28.04	14.02	13.35	11.68	25
LL90X450	Woody Long Leg	90	425	50	90 x 150 to 250	28.04	14.02	13.35	11.68	25
LL90X600	Woody Long Leg	90	600	50	90 x 200 to 300	28.04	14.02	13.35	11.68	25
LL100X450	Woody Long Leg	100	420	50	100 x 150 to 250	28.04	14.02	13.35	11.68	25
LL100X600	Woody Long Leg	100	600	50	100 x 200 to 300	28.04	14.02	13.35	11.68	25
LL125X450	Woody Long Leg	125	450	50	125 x 175 to 250	28.04	14.02	13.35	11.68	15
LL125X600	Woody Long Leg	125	600	50	125 x 220 to 300	28.04	14.02	13.35	11.68	25
LL132X450	Woody Long Leg	132	450	50	132 x 175 to 250	28.04	14.02	13.35	11.68	15
LL142X450	Woody Long Leg	142	450	50	142 x 175 to 250	28.04	14.02	13.35	11.68	15
LL142X600	Woody Long Leg	142	600	50	142 x 220 to 300	28.04	14.02	13.35	11.68	25
LL150X450	Woody Long Leg	150	450	50	150 x 175 to 250	28.04	14.02	13.35	11.68	15
LL150X600	Woody Long Leg	150	600	50	150 x 220 to 300	28.04	14.02	13.35	11.68	25
Grade 1.4301 Austenitic Stainless Steel to EN 10088-2- 1mm										
LLSS38X450	Woody Long Leg	38	450	50	38 x 175 to 250	-	-	-	-	-
LLSS38X600	Woody Long Leg	38	600	50	38 x 210 to 300	-	-	-	-	-
LLSS44X450	Woody Long Leg	44	453	50	44 x 150 to 250	-	-	-	-	-
LLSS44X600	Woody Long Leg	44	600	50	44 x 200 to 300	-	-	-	-	-
LLSS47X450	Woody Long Leg	47	445	50	47 x 150 to 250	-	-	-	-	-
LLSS47X600	Woody Long Leg	47	600	50	47 x 200 to 300	-	-	-	-	-
LLSS63X450	Woody Long Leg	63	440	50	63 x 175 to 250	-	-	-	-	-
LLSS63X600	Woody Long Leg	63	600	50	63 x 220 to 300	-	-	-	-	-
LLSS76X450	Woody Long Leg	76	435	50	76 x 175 to 250	-	-	-	-	-
LLSS76X600	Woody Long Leg	76	600	50	76 x 220 to 300	-	-	-	-	-
LLSS90X450	Woody Long Leg	90	425	50	90 x 150 to 250	-	-	-	-	-
LLSS90X600	Woody Long Leg	90	600	50	90 x 200 to 300	-	-	-	-	-
LLSS100X450	Woody Long Leg	100	420	50	100 x 150 to 250	-	-	-	-	-
LLSS100X600	Woody Long Leg	100	600	50	100 x 200 to 300	-	-	-	-	-
LLSS125X450	Woody Long Leg	125	450	50	125 x 175 to 250	-	-	-	-	-
LLSS125X600	Woody Long Leg	125	600	50	125 x 220 to 300	-	-	-	-	-
LLSS150X450	Woody Long Leg	150	450	50	150 x 175 to 250	-	-	-	-	-
LLSS150X600	Woody Long Leg	150	600	50	150 x 220 to 300	-	-	-	-	-