

**IPTEC**

**UK**

PROFESSIONAL SECURITY PRODUCTS



# PRODUCT CATALOG 2020



# CONTENTS

Foreword	1
IPTEC HD-TCX - Full HD 1080P Cameras & DVR	2 - 18
Videoteknika IP Cameras / NVRs / Accessories / VVMS- Advanced	19 - 37
Vivotek IP Cameras & NVRs	38 - 40
TDSi	41
Camera Housing / Bracket / Lenses	42
Power Supplies / Adapter / Power Cables	43
Fingertec	44 - 45
IPBio Biometric Access Control and Panels	46
ZKTeco Access Controls / Hotel Locks	47 - 51
Access Control - Magnetic Locks	52 - 53
Pyronix Intruder Alarm Systems	54 - 57
RF Shop Anti-Theft System	58
Mice Video Door Phone	59
YALE Security	60 - 62
GARRETT Metal Detectors	63 - 64
Notes	65



All products in this catalogue are manufactured under strict quality controls and carry all or some of the above quality certifications

# IPTEC

# UK

## PROFESSIONAL SECURITY PRODUCTS

### HD-TCX

CCTV OVER COAX

### HIKVISION

### XXVIDEOTEKNIKA

IP Network Security Solutions

### TDSI

ACCESS EVERYWHERE

### VIVOTEK

### mice

INTERCOM FONE

### Pyronix

### FING@RTEC

Beyond Biometrics

### ZKT<sup>®</sup>ECO

### GARRETT

METAL DETECTORS



Welcome to IPTEC's 2020 catalogue.

IPTEC UK 2019 catalogue is the essential reference guide for all the leading system integrators in the security industry, featuring an extensive lineup of products from World leading brands such as Bosch, Videoteknika, Geovision, Pyronix, Vivotek, Digiever, Entrostar, Fingertec etc. With the introduction of HD CCTV, the catalogue encompasses a complete lineup of carefully selected products ensuring a satisfactory choice in purchasing IPTEC's world leading security products.

Continuing with IPTEC's customer support policy, we understand our customer's requirements and offer unbiased honest professional advice. Through IPTEC's R&D team, we continuously sharpen our skills in being at the forefront of Digital Security Technology, thus selecting the best products for our customers. We pride ourselves on being market visionaries in the security market and only carry products that have been field tested and include a manufacturer's warranty.

We also advise our customers to carefully be aware of other self proclaimed security manufacturers who although present themselves as professionals, are simply importing no-name security products that are not field tested and do not carry manufacturer's warranty.

IPTEC General Trading LLC is a British Security Industry Associate Member, HD CCTV Alliance Associate Member and is an ISO 9001: 2008 company certified by International and UK Certification Boards.

Thank you for your continued support.

**PETER L. MONKS**  
General Manager



## SALES : 0044 7768 444888

IPTEC UK Registered in Companies House Cardiff Wales UK  
Registration No. 09208016

#### IPTEC UK Head Office

United Kingdom

Belize House, Belsize Road,  
London, NW6 4BT, England  
Website : [www.ipteccctv.co.uk](http://www.ipteccctv.co.uk)  
Email : [sales@iptecccctv.co.uk](mailto:sales@iptecccctv.co.uk)  
Sales : 0044 208-9933377  
Fax : 0044-208-9933388



#### IPTEC UK Warranty / Technical Dept.

United Kingdom

Belize House, Belsize Road,  
London, NW6 4BT, England  
Website : [www.ipteccctv.co.uk](http://www.ipteccctv.co.uk)  
Technical : [support@iptecccctv.co.uk](mailto:support@iptecccctv.co.uk)  
Tel : 0044 208-9933366  
Fax : 0044-208-9933388



**HIGH DEFINITION**

**TRANSMISSION OVER COAX CABLES**



**FULL HD**  
1920X1080

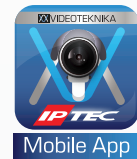

**3 YEARS WARRANTY**  
On Selected Models

**ADVANTAGE**

- HD-TCX is a format of HD Analog Technology delivering up to Full HD 1080p – Megapixel Resolution surveillance video that provide forensic detail and zoom capabilities for facial recognition and license plate identification.
- No IP Networking required! No stable IP address or DDNS setup or Router setup is needed. It's simple to install and operate just like traditional Analog CCTV Solution.
- Monitor video in real-time, without the ZERO latency or transmission delays commonly found with IP solutions.
- Up to 500m High Definition long distance transmission via coaxial cable.
- Cost-Effective Analog HD Solution as no expensive network infrastructure is required. HD-TCX enables you to use your existing (RG59 coax and Cat5/6 cables) thus save money on cabling and installation costs.
- HD Video, Data signal and Audio signal on single coax cable along with the ability to control OSD menu & PTZ control functions over single coax cable.



**FULL HD LIVE**



**FULL HD RECORD**



**FULL HD PLAYBACK**





# IR DOME CAMERA

**HD-TCX**  
CCTV OVER COAX

**IPHD-TCX-D2310IR/VF**

**Full HD 1080p, 1/3" Progressive Scan CMOS, IR Varifocal Dome Camera (30m IR range)**

SPECIFICATIONS	IPHD-TCX-D2310IR	IPHD-TCX-D2310IR/VF
Image Sensor	2.1 Megapixel, 1/3" Progressive Scan CMOS Sensor	
Resolution @ FPS	FULL HD 1080p (1920x1080) @ 25fps	
Min. Illumination	0 Lux with IR LED On	
Lens	3.6mm	2.8 ~ 12mm
Iris Mode	Fixed Iris	Varifocal Auto Iris
IR Range (IR LED's)	30 metres (Smart IR LED's)	
Electronic Shutter	1/60 (1/50) to 1/1/100,000 sec	
OSD Image Settings	AGC / BLC / WBL / Contrast / Sharpness / Motion / Privacy / Mirror / Camera ID / Shutter	
Gamma	0.45	
S/N Ratio	=> 52dB	
Mounting	Ceiling	
Power Source	DC12V	

# IPHD-TCX-D3810IRVF(WDR)

**Full HD 1080p, 1/3" Progressive Scan CMOS, IR Varifocal Dome Camera (35m IR range)**

SPECIFICATIONS	IPHD-TCX-D3810IRVF(WDR)
Image Sensor	2.1 Megapixel, 1/3" Progressive Scan CMOS Sensor
Resolution @ FPS	FULL HD 1080p (1920x1080) @ 25fps
Min. Illumination	0 Lux with IR LED On
Lens	2.8~12mm
Iris Mode	Vari focal Iris
IR Range (IR LED's)	35 metres (Smart IR LED's)
Electronic Shutter	1/60 (1/50) to 1/1/100,000 sec
OSD Image Settings	AGC / BLC / WBL / Contrast / Sharpness / Motion / Privacy / Mirror / Camera ID / Shutter
Wide Dynamic Range	120dB WDR
S/N Ratio	=> 52dB
Mounting	Ceiling
Power Source	DC12V

**HD-TCX** **HDTV1**  
CCTV OVER COAX High Definition Transport Video Interface

[www.ipotecworld.com](http://www.ipotecworld.com)

**FULL HD 1080p** | Internal/External | 40 Mtrs | MADE IN KOREA  
**1/3" CMOS** | SMART IR LED'S | DC12V  
**0 LUX** | DAY & NIGHT | IP68 IP Rating

**HD-TCX** CCTV OVER COAX  
**Full HD 1920x1080**  
**IPTEC SUPREME**

**3 YEAR WARRANTY**

**Full HD 1080p, 1/3" Progressive Scan CMOS, IR Fixed Bullet Camera (40m IR range)**

SPECIFICATIONS	IPHD-TCX-B3004IR	IPHD-TCX-B3006IR
Image Sensor	2.1 Megapixel, 1/3" Progressive Scan CMOS Sensor	
Resolution @ FPS	<b>FULL HD 1080p</b> (1920x1080) @ 25fps	
Min. Illumination	0 Lux with IR LED On	
Lens	Fixed 4mm	Fixed 6mm
IR Range (IR LED's)	30 metres (Smart IR LED's)	40 metres (Smart IR LED's)
Day & Night	ICR (Auto / Color / B&W)	
Shutter Speed	1/60 ~ 1/100,000 sec.	
OSD Image Settings	2DNR, AWB, BLC, AGC, Anti-Flicker, Mirror, Freeze, Defog, BC, DE, Privacy Masking, Motion Detection	
S/N Ratio	52dB or more (AGC off)	
IP Rating	IP68	
Mounting	Wall / Ceiling / Slope	
Power Source	DC12V	

IPHD-TCX-VD3810PVR

IR DOME CAMERAS

**FULL HD 1080p** | Internal/External | 35 MTRS | MADE IN KOREA  
**1/3" CMOS** | SMART IR LED'S | DIGITAL WDR | Vandal Proof  
**0 LUX** | DAY & NIGHT | DC12V

**HD-TCX** CCTV OVER COAX  
**Full HD 1920x1080**  
**IPTEC SUPREME**

BRK-VD3810PVR Wall Mount Bracket

**3 YEAR WARRANTY**

**Full HD 1080p, 1/3" Progressive Scan CMOS, IR Varifocal Dome Camera (35m IR range)**

SPECIFICATIONS	IPHD-TCX-VD3810PVR
Image Sensor	2.1 Megapixel, 1/3" Progressive Scan CMOS Sensor
Resolution @ FPS	<b>FULL HD 1080p</b> (1920x1080) @ 25fps
Min. Illumination	0 Lux with IR LED On
Lens	2.8 ~ 12mm
Iris Mode	Varifocal Auto Iris
IR Range (IR LED's)	35 metres (Smart IR LED's)
Electronic Shutter	1/60 (1/50) to 1/1,100,000 sec
OSD Image Settings	AGC / BLC / WBL / Contrast / Sharpness / Motion / Privacy / Mirror / Camera ID / Shutter
Wide Dynamic Range	Digital WDR
S/N Ratio	=> 52dB
Mounting	Ceiling
Power Source	DC12V

# IR DOME CAMERA

**HD-TCX**  
CCTV OVER COAX

**IPHD-TCX-D203IR-N**

**Full HD 1080p, 1/2.9" Progressive Scan CMOS, IR Fixed Dome Camera (30m IR range)**

SPECIFICATIONS	IPHD-TCX-D203IR-N
Image Sensor	2 Megapixel, 1/2.9" Progressive Scan CMOS Sensor
Resolution @ FPS	<b>FULL HD 1080p</b> (1920x1080) @ 25fps
Min. Illumination	0 Lux with IR LED On
Lens	2.8 mm / 3.6 mm
Iris Mode	Fixed Iris
IR Range (IR LED's)	30 metres (Smart IR LED's)
Electronic Shutter	1/25s~1/50,000s , 1/30s~1/60,000s
OSD Image Settings	<b>4 IN 1</b> (AHD+CVI+TVI+CVBS), One-key switch, D-WDR, 3DNR, Smart IR
Wide Dynamic Range	Digital WDR
S/N Ratio	=> 50dB
Mounting	Ceiling
Power Source	DC12V

# IPHD-TCX-D5702IRVF-N

**Full HD 1080p, 1/2.9" Progressive Scan CMOS, IR Varifocal Dome Camera (35m IR range)**

SPECIFICATIONS	IPHD-TCX-D5702IRVF-N
Image Sensor	2 Megapixel, 1/3" Progressive Scan CMOS Sensor
Resolution @ FPS	<b>FULL HD 1080p</b> (1920x1080) @ 25fps
Min. Illumination	0 Lux with IR LED On
Lens	2.8 ~ 12mm
Iris Mode	Varifocal Auto Iris
IR Range (IR LED's)	35 metres (Smart IR LED's)
Electronic Shutter	1/25s~1/50,000s , 1/30s~1/60,000s
OSD Image Settings	<b>4 IN 1</b> (AHD+CVI+TVI+CVBS), One-key switch, D-WDR, 3DNR, Smart IR
Wide Dynamic Range	Digital WDR
S/N Ratio	=> 50dB
Mounting	Ceiling
Power Source	DC12V

**HD-TCX** **HDTV I**  
CCTV OVER COAX High Definition Transport Video Interface

[www.ipotecworld.com](http://www.ipotecworld.com)

Professional Security Products



# IPHD-TCX-B301IR-N

**HD-TCX**  
CCTV OVER COAX

# IR BULLET CAMERA

**Full HD 1080p, 1/2.9" Progressive Scan CMOS, IR Fixed Bullet Camera (up to 30m IR range)**

SPECIFICATIONS	IPHD-TCX-B301IR-N
Image Sensor	2 Megapixel, 1/2.9" Progressive Scan CMOS Sensor
Resolution @ FPS	<b>FULL HD 1080p</b> (1920x1080) @ 25fps
Min. Illumination	0 Lux with IR LED On
Lens	3.6mm
Iris Mode	Fixed Iris
IR Range (IR LED's)	35 metres (Smart IR LED's)
Electronic Shutter	1/25s~1/50,000s, 1/30s~1/60,000s
OSD Image Settings	<b>4 IN 1</b> (AHD+CVI+TVI+CVBS), One-key switch, D-WDR, 3DNR, Smart IR
Wide Dynamic Range	Digital WDR
Mounting	Wall / Ceiling
Power Source	DC12V
Weight	400g Approx.

# IPHD-TCX-B5612IRVF-N

**Full HD 1080p, 1/3" Progressive Scan CMOS, IR Varifocal Bullet Camera (up to 50m IR range)**

SPECIFICATIONS	IPHD-TCX-B5612IRVF-N
Image Sensor	2 Megapixel, 1/2.9" Progressive Scan CMOS Sensor
Resolution @ FPS	<b>FULL HD 1080p</b> (1920x1080) @ 25fps
Min. Illumination	0 Lux with IR LED On
Lens	2.8 ~ 12mm
Iris Mode	Varifocal Auto Iris
IR Range (IR LED's)	50 metres (Smart IR LED's)
Electronic Shutter	1/60 (1/50) to 1/1/100,000 sec
OSD Image Settings	<b>4 IN 1</b> (AHD+CVI+TVI+CVBS), One-key switch, D-WDR, 3DNR, Smart IR
Wide Dynamic Range	Digital WDR
Mounting	Wall / Ceiling
Power Source	DC12V
Weight	750g approx.

**Full HD 1080p, 1/3" Progressive Scan CMOS, Box Camera**

SPECIFICATIONS	IPHD-TCX-G5500(WDR)
Image Sensor	2.1 Megapixel, 1/3" Progressive Scan CMOS Sensor
Resolution @ FPS	<b>FULL HD 1080p</b> (1920x1080) @ 25fps
Min. Illumination	0.001 Lux @(F1.2,AGC ON)
Shutter Time	1/25(1/30) ~ 1/50,000 s
Lens Mount	C/CS mount
Wide Dynamic Range	120dB WDR
OSD Image Settings	AGC, BLC, Privacy Mask, Motion Detection, Eclipse, DNR, Slow shutter, Mirror, Defog, Defect pixel correction, SMART D-ZOOM
Mounting	Wall / Ceiling
Power Source	DC12V
Dimensions	70x58x149 mm
Weight	410g approx.

**IPHD-TCX-B301R WDR**

**Full HD 1080p, 1/3" Progressive Scan CMOS, IR Fixed Mini Bullet Camera (up to 30m IR range)**

SPECIFICATIONS	IPHD-TCX-B301R(WDR)
Image Sensor	2.1 Megapixel, 1/3" Progressive Scan CMOS Sensor
Resolution @ FPS	<b>FULL HD 1080p</b> (1920x1080) @ 25fps
Min. Illumination	0 Lux with IR LED On
Lens	Fixed 3.6mm / 6mm
IR Range (IR LED's)	30 metres (Smart IR LED's)
Wide Dynamic Range	(120dB) WDR
IP Rating	IP67
OSD Image Settings	3DNR, Smart IR
Power Source	DC12V
Dimensions	157 x 62 mm
Weight	400g approx.

# IPHD-TCX-B331IR

**HD-TCX**  
CCTV OVER COAX

# BULLET CAMERAS

**Full HD 1080p, 1/3" Progressive Scan CMOS, IR Fixed Bullet Camera (up to 30m IR range)**

SPECIFICATIONS	IPHD-TCX-B331IR
Image Sensor	2.1 Megapixel, 1/3" Progressive Scan CMOS Sensor
Resolution @ FPS	<b>FULL HD 1080p</b> (1920x1080) @ 25fps
Min. Illumination	0 Lux with IR LED On
Lens	4mm / 6mm
Iris Mode	Fixed Iris
Viewing Angle	88°
IR Range (IR LED's)	35 metres (Smart IR LED's)
Electronic Shutter	1/60 (1/50) to 1/1/100,000 sec
IP Rating	IP67
Mounting	Wall / Ceiling
Power Source	DC12V

# IPHD-TCX-B5513IR WDR

**Full HD 1080p, 1/3" Progressive Scan CMOS, IR Fixed Bullet Camera (up to 80m IR range)**

SPECIFICATIONS	IPHD-TCX-B5513IR WDR
Image Sensor	2 Megapixel, 1/2.9" Progressive Scan CMOS Sensor
Resolution @ FPS	<b>FULL HD 1080p</b> (1920x1080) @ 25fps
Min. Illumination	0 Lux with IR LED On
Lens	4mm / 6 mm
Iris Mode	Fixed Iris
IR Range (IR LED's)	40/80 metres (Smart IR LED's)
Electronic Shutter	1/60 (1/50) to 1/1/100,000 sec
OSD Image Settings	<b>4 IN 1</b> (AHD+CVI+TVI+CVBS), One-key switch, D-WDR, 3DNR, Smart IR
Wide Dynamic Range	120dB WDR
IP Rating	IP67
Mounting	Wall / Ceiling
Power Source	DC12V

[www.iptecworld.com](http://www.iptecworld.com)

**HD-TCX** **HDTV1**  
CCTV OVER COAX High Definition Transport Video Interface



# BULLET CAMERAS

**HD-TCX**  
CCTV OVER COAX

**IPHD-TCX-B5612IRVF-MZ(WDR)**

**Full HD 1080p, 1/3" Progressive Scan CMOS, IR Varifocal Bullet Camera (up to 60m IR range)**

SPECIFICATIONS	IPHD-TCX-B5612IRVF-MZ(WDR)
Image Sensor	2 Megapixel, 1/2.9" Progressive Scan CMOS Sensor
Resolution @ FPS	<b>FULL HD 1080p</b> (1920x1080) @ 25fps
Min. Illumination	0 Lux with IR LED On
Lens	2.8 ~ 12mm
Iris Mode	Motorized Varifocal Iris
IR Range (IR LED's)	60 metres (Smart IR LED's)
Electronic Shutter	1/25s~1/50,000s , 1/30s~1/60,000s
OSD Image Settings	One-key switch, 3DNR, Smart IR
Wide Dynamic Range	120dB WDR
S/N Ratio	=> 50dB
Mounting	Ceiling
Power Source	DC12V

## IPHD-TCX-B5650IRVF-MZ(WDR)

**Full HD 1080p, 1/3" Progressive Scan CMOS, Motorized Varifocal IR Bullet (up to 120m IR range)**

SPECIFICATIONS	IPHD-TCX-B5650IRVF-MZ(WDR)
Image Sensor	2.1 Megapixel, 1/3" Progressive Scan CMOS Sensor
Resolution @ FPS	<b>FULL HD 1080p</b> (1920x1080) @ 25fps
Min. Illumination	0 Lux with IR LED On
Lens	5 ~ 50mm (Motorized lens)
Iris Mode	Varifocal Motorized Iris
IR Range (IR LED's)	120 metres (Smart IR LED's)
Electronic Shutter	1/60 (1/50) to 1/1,100,000 sec
OSD Image Settings	Digital Zoom / DNR / AGC / BLC / WBL / Contrast / Sharpness / Motion / Privacy / Mirror / Camera ID / Shutter
Wide Dynamic Range	120dB WDR
S/N Ratio	=> 52dB
Mounting	Ceiling
Power Source	DC12V

**HD-TCX** **HDTV1**  
CCTV OVER COAX High Definition Transport Video Interface

[www.ipotecworld.com](http://www.ipotecworld.com)

Professional Security Products

IPHD-TCX-B3349PVRH

**HD-TCX** IR BULLET / DOME CAMERA  
CCTV OVER COAX

**Full HD 1080p, 1/3" Progressive Scan CMOS, IR Fixed Bullet Camera (up to 60 m IR range)**

2 YEAR WARRANTY

SPECIFICATIONS	IPHD-TCX-B3349PVRH
Image Sensor	2.1 Megapixel, 1/3" Progressive Scan CMOS Sensor
Resolution @ FPS	<b>FULL HD 1080p</b> (1920x1080) @ 25fps
Min. Illumination	0 Lux with IR LED On
Lens	2.8~12mm
Iris Mode	Varifocal Iris
IR Range (IR LED's)	60 metres (Smart IR LED's)
Shutter Speed	1/60 (1/50) to 1/100,000 sec
OSD Image Settings	BLC, AGC, Anti-Flicker
Mounting	Wall / Ceiling
Power Source	DC12V
Dimensions	120 x 50 mm
Weight	335g approx.

IPHD-TCX-D203IR/WDR

**Full HD 1080p, 1/3" Progressive Scan CMOS, IR Fixed Dome Camera (up to 30m IR range)**

2 YEAR WARRANTY

SPECIFICATIONS	IPHD-TCX-D203	IPHD-TCX-D203IR(WDR)
Image Sensor	2.1 Megapixel, 1/3" Progressive Scan CMOS Sensor	
Resolution @ FPS	<b>FULL HD 1080p</b> (1920x1080) @ 25fps	
Min. Illumination	0 Lux with IR LED On	
Lens	3.6mm / (Optional = 2.8mm)	
Iris Mode	Fixed Iris	
IR Range (IR LED's)	25 metres (Smart IR LED's)	30 metres (Smart IR LED's)
Wide Dynamic Range	Digital WDR	(120dB) WDR
OSD Image Settings	4 IN 1 (AHD+CVI+TVI+CVBS), One-key switch, 3DNR, Smart IR	
IP Rating	IP66	
Mounting	Wall / Ceiling	
Power Source	100 x 66 mm	DC12V
Dimensions	135g approx.	98 x 76 mm

www.ipotecworld.com

**HD-TCX** **HDTV**  
CCTV OVER COAX High Definition Transport Video Interface

Professional Security Products

**Full HD 1080p, 1/3" Progressive Scan CMOS, IR Varifocal Dome Camera (up to 40m IR range)**

SPECIFICATIONS	IPHD-TCX-D5702IRVF-EMZ(WDR)
Image Sensor	2.1 Megapixel, 1/3" Progressive Scan CMOS Sensor
Resolution @ FPS	<b>FULL HD 1080p</b> (1920x1080) @ 25fps
Min. Illumination	0 Lux with IR LED On
Lens	2.8 ~12 mm
Iris Mode	Motorized Varifocal Iris
IR Range (IR LED's)	40 metres (Smart IR LED's)
Wide Dynamic Range	(120dB) WDR
Shutter Speed	1/60 (1/50) to 1/1/100,000 sec
Mounting	Wall / Ceiling
Power Source	DC12V
Dimensions	135 x 124 x 112 mm

## PTZ CAMERAS

## IPHD-TCX-S7832IR(WDR)

**Full HD 1080p, 2.1MP 1/3" Progressive Scan CMOS, 32x Optical Zoom Speed Dome (up to 150m IR range)**

SPECIFICATIONS	IPHD-TCX-S7832IR(WDR)	IPHD-TCX-S5725IR(WDR)
Image Sensor	2.1 Megapixel, 1/3" Progressive Scan CMOS Sensor	
Resolution @ FPS	<b>FULL HD 1080p</b> (1920x1080) @ 25fps	
Min. Illumination	0 Lux IR LED On	
Lens / Optical Zoom	Varifocal 4.3 ~129mm (32x Optical Zoom)	Varifocal 4.8~120mm (25x Optical Zoom)
IR Range (IR LED's)	150 metres (Smart IR LED's)	100 metres (Smart IR LED's)
Pan & Tilt	360° Endless Pan Rotation [Speed 240°/sec] and -15°~90° (Auto-Flip) Tilt Range [Speed 200°/sec]	
Functions	256 Preset points, 8 Patrols, 4 Patterns, Park Action, Preset Freezing, PTZ Position Display	
OSD Image Settings	8x Privacy Masking Zones, <b>120dB WDR</b> , 3D-DNR, Electronic Image Stabilizer, AWB, AGC, BLC	
IP Rating & Vandalproof	IP66 rated & (Outdoor Models = Vandalproof)	
Operating Temp.	-40°C~+60°C	
Mounting / Power Source	[Wall / Ceiling / Corner / Pole / Power Box / Etc. ] / [ AC 24V ]	
Dimensions (Weight)	222 x 355 mm ( 4.5kg approx. without Mounting options)	222 x 308 mm ( 4.1kg approx. without Mounting options)



**4K ULTRAHD**

TRANSMISSION OVER COAX CABLES



**4K**  
ULTRAHD

**3 YEARS WARRANTY**  
On Selected Models



## INTRODUCING NEW 8MP SERIES OVER COAXIAL CABLE

8MP video and makes high-definition surveillance systems possible without replacing existing cabling or switching to IP cameras. Eliminating compatibility issues whenever you have to mix old technology with new products, and making installation simple and cost-effective.



# 5MP IR DOME CAMERA **HD-TCX** CCTV OVER COAX

**IPHD-TCX-D5802IRMZ/IEMZ**

**5MP, Full HD 1080p, 1/3" Progressive Scan CMOS, IR Fixed / Varifocal Camera (up to 40m IR range)**

SPECIFICATIONS	IPHD-TCX-D536IR	IPHD-TCX-D5802IRMZ	IPHD-TCX-D5802IEMZ(WDR)
Image Sensor	5 Megapixel, 1/3" Progressive Scan CMOS Sensor		
Resolution @ FPS	Full HD 1080p (1920x1080) @ 25fps		
Min. Illumination	0 Lux with IR LED On		
Lens	2.4/ 2.8 /3.6 / 6 mm Fixed lens	2.8 ~12mm Motorized Varifocal lens	2.7 ~13.5 mm Motorized Varifocal lens
IR Range (IR LED's)	20 metres (Smart IR LED's)	40 metres (Smart IR LED's)	
Shutter Time	1/25(1/30) ~ 1/50,000 s		
Wide Dynamic Range	DWDR		120dB(WDR)
IP Rating			IP67
Mounting	Wall / Ceiling		
Power Source	DC12V		
Dimensions	85 x 80 mm	136 x 102 mm	124 X135 mm
Weight	143g approx.	900g approx.	580g approx.

# 5MP IR BULLET CAMERAS

**IPHD-TCX-B501IR/B555IR**

**5MP, Full HD 1080p, 1/3" Progressive Scan CMOS, IR Fixed Bullet Camera (up to 50m IR range)**

SPECIFICATIONS	IPHD-TCX-B501IR	IPHD-TCX-B555IR
Image Sensor	5 Megapixel, 1/3" Progressive Scan CMOS Sensor	
Resolution @ FPS	Full HD 1080p (1920x1080) @ 25fps	
Min. Illumination	0 Lux with IR LED On	
Lens	Fixed 3.6	
IR Range (IR LED's)	30 metres (Smart IR LED's)	50 metres (Smart IR LED's)
Shutter Time	1/25(1/30) ~ 1/50,000 s	
Wide Dynamic Range	DWDR	
IP Rating	IP67	
Mounting	Wall / Ceiling	
Power Source	DC12V	
Dimensions	58 x 61 x 163 mm	87 x 82 x 226 mm
Weight	350g approx.	680g approx.

5MP, Internal/External, DAY & NIGHT, FULL HD 1080p, 0 LUX, IP67, 1/3" CMOS, 60 Mtrs, DC12V, Full HD 1920x1080, 2 YEAR WARRANTY

**5MP, Full HD 1080p, 1/3" Progressive Scan CMOS, IR Varifocal Bullet Camera (up to 60m IR range)**

SPECIFICATIONS	IPHD-TCX-B5812IRVFMZ	IPHD-TCX-B5812IRVFMZ(WDR)
Image Sensor	5 Megapixel, 1/3" Progressive Scan CMOS Sensor	
Resolution @ FPS	FULL HD 1080p (1920x1080) @ 25fps	
Min. Illumination	0 Lux with IR LED On	
Lens	2.8 ~12mm Motorized Varifocal lens	2.7 ~13.5mm Motorized Varifocal lens
IR Range (IR LED's)	60 metres (Smart IR LED's)	
Shutter Time	1/25(1/30) ~ 1/50,000 s	
Wide Dynamic Range	DWDR	120dB(WDR)
IP Rating	IP67	
Mounting	Wall / Ceiling	
Power Source	DC12V	
Dimensions	92 x 84.8 x 269.6 mm	
Weight	Approx. 885 g	

IPHD-TCX-6104/8/16

FULL HD 1080p, Terabyte, USB Backup, Mobile Support, H.265+, MOTION DETECTION, RS485, P2P Cloud, HDMI, USB Mouse, CMS, DC12V, Ultra HD 4K, 2 Year Warranty

**4/8/16 Ch (H.265+) Full HD 1080p, High Performance HD-TCX DVR with HDMI & Network**

SPECIFICATIONS	IPHD-TCX-6104	IPHD-TCX-6108	IPHD-TCX-6016
Built-in Technology	HD-TCX (High Definition - Transmission over Coax Cables)		
Video Compression	H.265+ / H.265 / H.264+ and Dual Stream		
Format	Full HD 1080p		
Channel Inputs	4 x Channels	8 x Channels	16 x Channels
Encoding resolution	FULL HD 1080p Up to 4Mp		
Display Interface	1 x HDMI(4K), 1 x VGA, 1 x BNC(Spot)		1 x HDMI(4K), 1 x VGA, 1 x BNC(Spot)
Audio Input / Output	Audio In x 1 / Audio Out x 1(2 Way Audio)		
HDD Storage Capacity	Up to 8TB (1 SATA HDD's x 8TB each)		
Communication Ports	1 x RJ-45 Ethernet , 1 x RS-485 for PTZ Control , 2 x USB 2.0 port ( 1 Rear / 1 Front )		
Backup / Power Source	[USB Device / Network] / [DC12V]		
Supported Cameras	HD-TCX, TVI, AHD, CVBS, CVI, IP		
Weight & Dimensions	1.6 KG approx. (Without HDD) & 320(W) x 245(D) x 45(H)mm		



# HD-TCX DVR



IPHD-TCX-6116/6224/32

**16/24/32 Ch (H.265+) Full HD 1080p, High Performance HD-TCX DVR with HDMI & Network**

SPECIFICATIONS	IPHD-TCX-6116	IPHD-TCX-6224	IPHD-TCX-6232
Built-in Technology	<b>HD-TCX</b> (High Definition - Transmission over Coax Cables)		
Video Compression	H.265+ / H.265 / H.264+ and Dual Stream		
Format	Full HD 1080p		
Channel Inputs	16 x Channels	24 x Channels	32 x Channels
Encoding resolution	<b>FULL HD 1080p</b> Up to 4Mp		
Display Interface	1 x HDMI( <b>4K</b> ), 1 x VGA, 1 x BNC (Spot)		
Audio Input / Output	Audio In x 1 / Audio Out x 1 (2 Way Audio)		
HDD Storage Capacity	Up to 16TB (2 SATA HDD's x 8TB each)		
Communication Ports	1 x RJ-45 Ethernet , 1 x RS-485 for PTZ Control , 2 x USB 2.0 port ( 1 Rear / 1 Front )		
Backup / Power Source	[USB Device / Network ] / [DC12V]		
Supported Cameras	HD-TCX, TVI, CVBS, CVI, IP		
Weight & Dimensions	2 KG approx. (Without HDD) & 382(W) x 282(D) x 50(H)mm	2 KG approx. (Without HDD) & 382(W) x 320 (D) x 50(H)mm	

## IPHD-TCX-6416

**16 Ch (H.265+) Full HD 1080p, High Performance HD-TCX DVR with HDMI & Network**

SPECIFICATIONS	IPHD-TCX-6416
Built-in Technology	<b>HD-TCX</b> (High Definition - Transmission over Coax Cables)
Video Compression	H.265+ / H.265 / H.264+ and Dual Stream
Format	Full HD 1080p
Channel Inputs	16x Channels
Encoding resolution	<b>FULL HD 1080p</b> Up to 4Mp
Display Interface	1 x HDMI( <b>4K</b> ), 1 x VGA, 1 x BNC (Spot)
Audio & Alarm	Audio In x 4 / Audio Out x 1 (2 Way Audio) and Alarm In x 8 / Alarm Out x 4
DD Storage Capacity	Up to 32TB (4 SATA HDD's x 8TB each)
Communication Ports	1 x RJ-45 Ethernet , 1 x RS-485 for PTZ Control , 3 x USB 2.0 port ( 1 Rear / 1 Front )
Backup / Power Source	[USB Device / Network ] / [AC 100 ~ 240V]
Supported Cameras	HD-TCX, TVI, CVBS, CVI, IP
Weight & Dimensions	5.1 KG approx. (without HDD) & 1.5U Case - 442(W) x 382(D) x 72(H)mm



www.iptecworld.com

Professional Security Products

**32 Ch (H.265+) Full HD 1080p, High Performance HD-TCX DVR with HDMI & Network**

SPECIFICATIONS	IPHD-TCX-6432
Built-in Technology	<b>HD-TCX</b> (High Definition - Transmission over Coax Cables)
Video Compression	H.265+ / H.265 / H.264+ and Dual Stream
Format	Full HD 1080p
Channel Inputs	32 x Channels
Encoding resolution	<b>FULL HD 1080p</b> Up to 4Mp
Display Interface	1 x HDMI(4K), 1 x VGA
Audio & Alarm	Audio In x 4 / Audio Out x 2 (2 Way Audio) and Alarm In x 16 / Alarm Out x 4
HDD Storage & eSATA	Up to 24TB (4 SATA HDD's x 6TB each) + 1 x eSATA interface
Communication Ports	1 x RJ-45 Ethernet , 1 x RS-485 for PTZ Control , 1 x RS-232 Serial Port , 3 x USB 2.0 port ( 1 Rear / 2 Front )
Backup / Power Source	[USB Device / Network ] / [AC 100 ~ 240V]
Supported Cameras	HD-TCX, TVI, CVBS, IP
Weight & Dimensions	5.1 KG approx. (Without HDD) & 1.5 U casing of 442(W) x 387(D) x 75(H)mm

IPHD-TCX-4HQ

**4 Ch (H.264) Full HD 1080p, High Performance HD-TCX DVR with HDMI & Network**

SPECIFICATIONS	IPHD-TCX-4HQ
Built-in Technology	<b>HD-TCX</b> (High Definition - Transmission over Coax Cables)
Video Compression	H.264 and Dual Stream
Format	Full HD 1080p
Channel Inputs	4 x Channels
Encoding resolution	<b>FULL HD 1080p</b>
Display Interface	1 x HDMI, 1 x VGA, 1 x BNC (Spot)
Audio Input / Output	Audio In x 1 / Audio Out x 1(2 Way Audio)
HDD Storage Capacity	Up to 12TB (2 SATA HDD's x 6TB each)
Communication Ports	1 x RJ-45 Ethernet , 2 x USB 2.0 port
Backup / Power Source	[USB Device / Network ] / [DC12V]
Supported Cameras	HD-TCX, TVI, CVBS
Weight & Dimensions	1.6 KG approx. (Without HDD) & 375(W) x 281(D) x 61(H)mm

# HD-TCX DVR



# IPHD-TCX-8ZS

**8 Ch (H.264) Full HD 1080p, High Performance HD-TCX DVR with HDMI & Network**

SPECIFICATIONS	IPHD-TCX-8ZS
Built-in Technology	<b>HD-TCX</b> (High Definition - Transmission over Coax Cables)
Video Compression	H.264 and Dual Stream
Format	Full HD 1080p
Channel Inputs	8 x Channels
Encoding resolution	<b>FULL HD 1080p</b>
Display Interface	1 x HDMI, 1 x VGA, 1 x BNC (Spot)
Audio & Alarm	Audio In x 4 / Audio Out x 1 (2 Way Audio) and Alarm In x 8 / Alarm Out x 4
DD Storage Capacity	Up to 12TB (2 SATA HDD's x 6TB each)
Communication Ports	1 x RJ-45 Ethernet , 1 x RS-485 for PTZ Control , 2 x USB 2.0 port
Backup / Power Source	[USB Device / Network ] / [DC12V]
Supported Cameras	HD-TCX, TVI, CVBS
Weight & Dimensions	2.6 KG approx. & 430 x 338 x 65 mm

# IPHD-TCX-16Z

**16 Ch (H.264) Full HD 1080p, High Performance HD-TCX DVR with HDMI & Network**

SPECIFICATIONS	IPHD-TCX-16Z
Built-in Technology	<b>HD-TCX</b> (High Definition - Transmission over Coax Cables)
Video Compression	H.264 and Dual Stream
Format	Full HD 1080p
Channel Inputs	16 x Channels
Encoding resolution	<b>FULL HD 1080p</b>
Display Interface	1 x HDMI, 1 x VGA, 1 x BNC (Spot)
Audio & Alarm	Audio In x 2 / Audio Out x 1 (2 Way Audio) and Alarm In x 8 / Alarm Out x 4
DD Storage Capacity	Up to 18TB (3 SATA HDD's x 6TB each)
Communication Ports	1 x RJ-45 Ethernet , 1 x RS-485 for PTZ Control , 2 x USB 2.0 port
Backup / Power Source	[USB Device / Network ] / [DC19V]
Supported Cameras	HD-TCX, TVI, AHD, CVBS
Weight & Dimensions	5.1 KG approx. & 432 x 326 x 90 mm



[www.ipotecworld.com](http://www.ipotecworld.com)



**4/8 Ch (H.265+) 4K, High Performance HD-TCX DVR with HDMI & Network**

SPECIFICATIONS	IPHD-TCX-5204	IPHD-TCX-5208	IPHD-TCX-5216
Built-in Technology	<b>HD-TCX</b> (High Definition - Transmission over Coax Cables)		
Video Compression	H.264+ and Dual Stream		
Format	Full HD 1080p		
Channel Inputs	4 x Channels	8 x Channels	16 x Channels
Encoding resolution	Up to 5Mp	<b>FULL HD 1080p</b> Up to 8Mp	
Display Interface	1 x HDMI( <b>4K</b> ), 1 x VGA, BNC		
Audio & Alarm	Audio In x 4 / Audio Out x 1 (2 Way Audio) and Alarm In x 4 / Alarm Out x 1 (8ch In /4ch)		
HDD Storage & eSATA	Up to 8TB (1 SATA HDD's x 8TB each)	Up to 16TB (2 SATA HDD's x 8TB each)	
Communication Ports	1 x RJ-45 Ethernet , 1 x RS-485 for PTZ Control , 2 x USB 2.0 port ( 1 Rear / 1 Front )		
Backup / Power Source	[USB Device / Network ] / [DC 12V]		
Supported Cameras	HD-TCX, TVI, CVI, CVBS, IP		
Weight & Dimensions	2 KG approx. (Without HDD) 320(W) x 245(D) x 45(H) mm	2.5 KG approx. (Without HDD) 382(W) x 321(D) x 50(H) mm	

IPHD-TCX-5416/24/32

**16/32 Ch, (H.265+), 4K, High Performance HD-TCX DVR with HDMI & Network**

SPECIFICATIONS	IPHD-TCX-5416	IPHD-TCX-5424	IPHD-TCX-5432
Built-in Technology	<b>HD-TCX</b> (High Definition - Transmission over Coax Cables)		
Video Compression	H.265+/H.265/H.264+/H.264		
Format	HDMI up to 4K (3840 x 2160) resolution		
Channel Inputs	16 x Channels	24 x Channels	32 x Channels
Encoding resolution	<b>FULL HD 1080p</b> Up to 8Mp		
Display Interface	1 x HDMI( <b>4K</b> ), 1 x VGA, 1 X BNC		
Audio & Alarm	Audio In x 4 / Out x 2 (2 Way Audio) and Alarm In x 16 / Alarm Out x 4		
HDD Storage & eSATA	Up to 32TB (4 SATA HDD's x 8TB each) + 1 x eSATA		
Communication Ports	1 x RJ-45 Ethernet , 1 x RS-485 for PTZ Control , 1 x RS-232 Serial Port , 3 x USB 2.0 port ( 1 Rear / 2 Front )		
Backup / Power Source	[USB Device / Network ] / [AC 100 ~ 240V]		
Supported Cameras	HD-TCX, TVI, CVBS, IP		
Weight & Dimensions	5.1 KG approx. (Without HDD) 445(W) x 390(D) x 70(H)mm	10 KG approx. (Without HDD) 440(W) x 470(D) x 90(H)mm	



# XX VIDEOTEKNIKA

## IP Network Security Solutions



Above Items are for Illustration only

# IP Cameras & NVR Systems

## VDE41-I 2/4 MP, Full HD (1080p) Real time, IP IR Dome

2 Years Warranty

- Full HD (1080p) Real time, Up to 4 MP (1920 x 1080) Res.
- H.265, H.264+, H.264 : Video Compressions.
- **Built-in Mic**
- Fixed Lens 2.8mm/3.6mm
- True Day & Night IR Cut Mechanical Filter.
- 3D DNR, DWDR, BLC.
- Dual Stream, Fixed Iris, M12 Lens Mount.
- RJ45 (10M/100M) Ethernet interface.
- IP66 rated fully cable managed Housing & Bracket.



SPECIFICATIONS	VDE21-I	VDE41-I
CCD Sensor	1/2.8" progressive scan CMOS	
Mega Pixel	2 MP (Full HD 1080p)	4 MP (Full HD 1080p)
Max. Image Res.	1920 x 1080	2688 x 1520
Frame Rate in Real Time	25 fps (1920 x 1080)	
Min. Illumination	0 Lux with IR LED On	
IR LED's Range	30 metres	
Lens	2.8mm/ 3.6mm	
Wide Dynamic Range	D WDR	
Communication	1 x RJ45 (10M/100M) Ethernet port	
Alarm Trigger	Motion, Face & Intrusion detection ; network disconnect ; IP address conflict ; storage exception	
Image Settings	Saturation, brightness, contrast adjustable through client software or web browser	
IP Rating	IP 66	
Operating Temperature	-30 °C ~ 60 °C	
Power Source	12 VDC ± 10%, PoE (802.3af)	
Dimensions	302 x 106 mm	
Weight	500g Approx.	

## VBE41-I 2/4 MP, Full HD (1080p) Real time, IP IR Bullet Cameras

2 Years Warranty

- Full HD (1080p) Real time, Up to 4 MP (1920 x 1080) Res.
- H.265, H.264+, H.264 : Video Compressions.
- Fixed Lens 3.6mm
- True Day & Night IR Cut Mechanical Filter.
- 3D DNR, DWDR, BLC.
- Dual Stream, Fixed Iris, M12 Lens Mount.
- RJ45 (10M/100M) Ethernet interface.
- IP66 rated fully cable managed Housing & Bracket.



SPECIFICATIONS	VBE21-I	VBE41-I
CCD Sensor	1/2.8" progressive scan CMOS	1/2.7" progressive scan CMOS
Mega Pixel	2 MP (Full HD 1080p)	4 MP (Full HD 1080p)
Max. Image Res.	1920 x 1080	2688 x 1520
Frame Rate in Real Time	25 fps (1920 x 1080)	
Min. Illumination	0 Lux with IR LED On	
IR LED's Range	35 metres	
Lens	3.6mm	
Wide Dynamic Range	D WDR	
Communication	1 x RJ45 (10M/100M) Ethernet port	
Alarm Trigger	Motion, Face & Intrusion detection ; network disconnect ; IP address conflict ; storage exception	
Image Settings	Saturation, brightness, contrast adjustable through client software or web browser	
IP Rating	IP 66	
Operating Temperature	-30 °C ~ 60 °C	
Power Source	12 VDC ± 10%, PoE (802.3af)	
Dimensions	302 x 106 mm	
Weight	400g Approx.	

## VDE42-IM

2/4 MP, Full HD (1080p) Real time, IP IR Dome

2 Years Warranty

- Full HD (1080p) Real time, Up to 4 MP (1920 x 1080) Res.
- H.265, H.264+, H.264 : Video Compressions.
- Motorized Varifocal Lens 2.8 ~ 12mm(VDE42-IM)
- True Day & Night IR Cut Mechanical Filter.
- 3D DNR, DWDR, BLC.
- Dual Stream.
- RJ45 (10M/100M) Ethernet interface.
- IP66 rated fully cable managed Housing & Bracket.



SPECIFICATIONS	VDE22-I	VDE42-IM
CCD Sensor	1/2.8" progressive scan CMOS	
Mega Pixel	2 MP (Full HD 1080p)	4 MP (Full HD 1080p)
Max. Image Res.	1920 x 1080	2688 x 1520
Frame Rate in Real Time	25 fps (1920 x 1080)	
Min. Illumination	0 Lux with IR LED On	
IR LED's Range	35 metres	
Lens	Varifocal Lens 2.8 ~ 12mm	Motorized Varifocal Lens 2.8 ~ 12mm
Wide Dynamic Range	D WDR	
Communication	1 x RJ45 (10M/100M) Ethernet port	
Alarm Trigger	Motion, Face & Intrusion detection ; network disconnect ; IP address conflict ; storage exception	
Image Settings	Saturation, brightness, contrast adjustable through client software or web browser	
IP Rating	IP 66 & IK10	
Operating Temperature	-30 °C ~ 60 °C	
Power Source	12 VDC ± 10%, PoE (802.3af)	
Dimensions	302 x 106 mm	
Weight	1000g Approx.	

## VBE42-IM

2/4 MP, Full HD (1080p) Real time - IP IR Bullet Cameras

2 Years Warranty

- Full HD (1080p) Real time, Up to 4 MP (1920 x 1080) Res.
- H.265, H.264+, H.264 : Video Compressions.
- Motorized Varifocal Lens 2.8 ~ 12mm(VBE42-IM)
- True Day & Night IR Cut Mechanical Filter.
- 3D DNR, DWDR, BLC.
- Dual Stream.
- RJ45 (10M/100M) Ethernet interface.
- IP66 rated fully cable managed Housing & Bracket.



SPECIFICATIONS	VBE22-I	VBE42-IM
CCD Sensor	1 / 2. 8" progressive scan CMOS	
Mega Pixel	2 MP (Full HD 1080p)	4 MP (Full HD 1080p)
Max. Image Res.	1920 x 1080	2688 x 1520
Frame Rate in Real Time	25 fps (1920 x 1080)	
Min. Illumination	0 Lux with IR LED On	
IR LED's Range	60 metres	65 metres
Lens	Varifocal Lens 2.8 ~ 12mm	Motorized Varifocal Lens 2.8 ~ 12mm
Wide Dynamic Range	D WDR	
Communication	1 x RJ45 (10M/100M) Ethernet port	
Alarm Trigger	Motion, Face & Intrusion detection ; network disconnect ; IP address conflict ; storage exception	
Image Settings	Saturation, brightness, contrast adjustable through client software or web browser	
IP Rating	IP 66	
Operating Temperature	-30 °C ~ 60 °C	
Power Source	12 VDC ± 10%, PoE (802.3af)	
Dimensions	302 x 106 mm	
Weight	1000g Approx.	

## VBA61-I 2/4/6 MP, Full HD (1080p) Real time - IP IR Bullet Cameras

2 Years Warranty

- 1/3" progressive scan CMOS.
- Full HD (1080p) Real time, Up to 6 MP (3072 x 2048) Res.
- H.265+, H.265, H.264+, H.264 : Video Compressions.
- Fixed Lens 4mm (Optional : 6mm)
- True Day & Night IR Cut Mechanical Filter.
- **Triple Stream**, Audio & Alarm Interface.
- Built-in Micro SD / SDHC card slot for storage up to 128GB.
- 3D DNR, Defog, HLC, BLC, Picture Overlay, EIS, ROI.
- IP67 rated fully cable managed Housing & Bracket.



**FULL HD**  
1920X1080

VVMS - Advanced™  
Video Management Software

SPECIFICATIONS	VBA21-I WDR	VBA41-I WDR	VBA61-I WDR
CCD Sensor	1/2.8" progressive scan CMOS	1/3" Progressive Scan CMOS	
Mega Pixel	2 MP (Full HD 1080p)	4 MP (Full HD 1080p)	6 MP (Full HD 1080p)
Max. Image Res.	1920 x 1080	2688x1520	3072x2048
Frame Rate in Real Time	30 fps (1920 x 1080)		
Min. Illumination	0 Lux with IR LED On		
IR LED's Range	30 metres		
Lens	4 mm (Fixed) (option: 6 mm)		
Wide Dynamic Range	120dB WDR		
Communication	1 x RJ45 (10M/100M) Ethernet port		
Alarm Trigger	Motion, Face & Intrusion detection ; network disconnect ; IP address conflict ; storage exception		
Image Settings	Saturation, brightness, contrast adjustable through client software or web browser		
IP Rating	IP 67		
Operating Temperature	-30 °C ~ 60 °C		
Power Source	12 VDC ± 10%, PoE (802.3af)		
Dimensions	70 x 155 x 61 mm		
Weight	420 g		

## VDA61-I 2/4/6 MP, Full HD (1080p) Real time - IP IR Dome Cameras

2 Years Warranty

- 1/3" progressive scan CMOS.
- Full HD (1080p) Real time, Up to 6 MP (3072 x 2048) Res.
- H.265+, H.265, H.264+, H.264 : Video Compressions.
- Fixed Lens 2.8mm (Optional : 4mm)
- True Day & Night IR Cut Mechanical Filter.
- **Triple Stream**, Audio & Alarm Interface.
- Built-in Micro SD / SDHC card slot for storage up to 128GB.
- 3D DNR, Defog, HLC, BLC, Picture Overlay, EIS, ROI.
- IP67 & IK10 rated fully cable managed Housing & Bracket.



**FULL HD**  
1920X1080

VVMS - Advanced™  
Video Management Software

SPECIFICATIONS	VDA21-I WDR	VDA41-I WDR	VDA61-I WDR
CCD Sensor	1/2.8" progressive scan CMOS	1/3" Progressive Scan CMOS	
Mega Pixel	2 MP (Full HD 1080p)	4 MP (Full HD 1080p)	6 MP (Full HD 1080p)
Max. Image Res.	1920 x 1080	2688x1520	3072x2048
Frame Rate in Real Time	30 fps (1920 x 1080)		
Min. Illumination	0 Lux with IR LED On		
IR LED's Range	30 metres		
Lens	2.8 mm (Fixed) (Optional: 4 mm)		
Wide Dynamic Range	120dB WDR		
Communication	1 x RJ45 (10M/100M) Ethernet port		
Alarm Trigger	Motion, Face & Intrusion detection ; network disconnect ; IP address conflict ; storage exception		
Image Settings	Saturation, brightness, contrast adjustable through client software or web browser		
IP Rating	IP 67		
Operating Temperature	-30 °C ~ 60 °C		
Power Source	12 VDC ± 10%, PoE (802.3af)		
Dimensions	112 x 83 mm		
Weight	610 g		



## VBA62-IMA 2/4/6 MP , Full HD (1080p) Real time - IP IR Bullet Cameras

2 Years Warranty

- 1/3" progressive scan CMOS.
- Full HD (1080p) Real time, Up to 6MP (3072 x 2048) Res.
- H.265+, H.265, H.264+, H.264 : Video Compressions.
- Motorized Varifocal Lens 2.8 ~ 12mm
- True Day & Night IR Cut Mechanical Filter.
- **Triple Stream**, Audio & Alarm Interface.
- Built-in Micro SD / SDHC card slot for storage up to 128GB.
- 3D DNR, Defog, HLC, BLC, Picture Overlay, EIS, ROI.
- IP67 & IK10 rated fully cable managed Housing & Bracket.



**FULL HD**  
1920X1080

VVMS-Advanced™  
Video Management Software

ONVIF

PSIA

SPECIFICATIONS	VBA22-IMA <b>WDR</b>	VBA42-IMA <b>WDR</b>	VBA62-IMA <b>WDR</b>
CCD Sensor	1/2.8" progressive scan CMOS	1/3" Progressive Scan CMOS	
Mega Pixel	2 MP (Full HD 1080p)	4 MP (Full HD 1080p)	6 MP (Full HD 1080p)
Max. Image Res.	1920 x 1080	2688x1520	3072 x 2048
Frame Rate in Real Time	30 fps (1920 x 1080)		
Min. Illumination	0 Lux with IR LED On		
IR LED's Range	60 metres		
Lens	Motorized Varifocal Lens 2.8 ~ 12mm		
Wide Dynamic Range	120dB WDR		
Communication	1 x RJ45 (10M/100M) Ethernet port		
Alarm Trigger	Motion, Face & Intrusion detection ; network disconnect ; IP address conflict ; storage exception		
Image Settings	Saturation, brightness, contrast adjustable through client software or web browser		
IP Rating	IP 67		
Operating Temperature	-30 °C ~ 60 °C		
Power Source	12 VDC ± 10%, PoE (802.3af)		
Dimensions	145 x 333 mm		
Weight	1740 g		

## VDA62-IMA 2/4/6 MP, Full HD (1080p) Real time - IP IR Dome Cameras

2 Years Warranty

- 1/3" progressive scan CMOS.
- Full HD (1080p) Real time, Up to 6 MP (3072 x 2048) Res.
- H.265+, H.265, H.264+, H.264 : Video Compressions.
- Motorized Varifocal Lens 2.8 ~ 12mm
- True Day & Night IR Cut Mechanical Filter.
- **Triple Stream**, Audio & Alarm Interface.
- Built-in Micro SD / SDHC card slot for storage up to 128GB.
- 3D DNR, Defog, HLC, BLC, Picture Overlay, EIS, ROI.
- IP67 & IK10 rated fully cable managed Housing & Bracket.



**FULL HD**  
1920X1080

VVMS-Advanced™  
Video Management Software

ONVIF

PSIA

SPECIFICATIONS	VDA22-IMA <b>WDR</b>	VDA42-IMA <b>WDR</b>	VDA62-IMA <b>WDR</b>
CCD Sensor	1/2.8" progressive scan CMOS	1/3" Progressive Scan CMOS	
Mega Pixel	2 MP (Full HD 1080p)	4 MP (Full HD 1080p)	6 MP (Full HD 1080p)
Max. Image Res.	1920 x 1080	2688x1520	3072 x 2048
Frame Rate in Real Time	30 fps (1920 x 1080)		
Min. Illumination	0 Lux with IR LED On		
IR LED's Range	50 metres		
Lens	Motorized Varifocal Lens 2.8 ~ 12mm		
Wide Dynamic Range	120dB WDR		
Communication	1 x RJ45 (10M/100M) Ethernet port		
Alarm Trigger	Motion, Face & Intrusion detection ; network disconnect ; IP address conflict ; storage exception		
Image Settings	Saturation, brightness, contrast adjustable through client software or web browser		
IP Rating	IP 67		
Operating Temperature	-30 °C ~ 60 °C		
Power Source	12 VDC ± 10%, PoE (802.3af)		
Dimensions	154 x 134 mm		
Weight	1800 g		

## VXE21

### 2/3 MP, Full HD (1080p) Real time - IP Box Cameras

### 2 Years Warranty

- Full HD (1080p) Real time, Up to 3 MP (2048 x 1536) Res.
- H.265, H.264+, H.264 : Video Compressions.
- True Day & Night IR Cut Mechanical Filter.
- 3D DNR, Defog, HLC, BLC, Picture Overlay, EIS, ROI.
- Triple Stream, ePTZ, C/CS Lens Mount.
- Audio & Alarm Interface.
- Power Over Ethernet (POE).
- Built-in Micro SD / SDHC card slot for storage.



**FULL HD**  
1920x1080

SMART VU IPCCTV



\* NOTE : Excluding Lens \*

SPECIFICATIONS	VXE21 <b>WDR</b>	VXE31 <b>WDR</b>
CCD Sensor	1/3" progressive scan CMOS	
Mega Pixel	2 MP (Full HD 1080p)	3 MP (Full HD 1080p)
Min. Illumination	0.01 lux	
Max. Image Res.	1920 x 1080	2048x1536
Frame Rate in Real Time	30 fps (1920 x 1080)	
Wide Dynamic Range	120dB WDR	
Iris Mode	Auto Iris - DC Drive	
Audio In / Out	Audio Interface	
Alarm In / Out	1 / 1	
Alarm Trigger	Motion, Face & Intrusion detection ; network disconnect ; IP address conflict ; storage exception	
Communication	RJ45 Ethernet port, RS-485, RS-232	
SD Card Storage	Built-in micro SD/SDHC card slot, up to 64 GB storage	
Operating Temperature	-30 °C ~ 60 °C	
Power Source	24 VAC ± 10%, 12 VDC ± 10%, PoE (802.3af)	
Dimensions	70 x 58 x 145 mm	
Weight	835g	

## VBA61-I5/I8

### 2/4/6 MP, Full HD (1080p) Real time - IP IR Bullet Cameras

### 2 Years Warranty

- Full HD (1080p) Real time, Up to 6 MP (3072 x 2048) Res.
- H.265+, H.265, H.264+, H.264 : Video Compressions.
- Fixed Lens 4mm (Optional : 6 /8/16mm)
- True Day & Night IR Cut Mechanical Filter.
- Triple Stream, ePTZ, (optional : 2-Way Audio & Alarms)
- Built-in Micro SD / SDHC card slot for storage up to 64GB.
- 3D DNR, Defog, HLC, BLC, Picture Overlay, EIS, ROI.
- IP67 rated fully cable managed Housing & Bracket.



**FULL HD**  
1920x1080

SMART VU IPCCTV



SPECIFICATIONS	VBA21-I5/I8 <b>WDR</b>	VBA41-I5/I8 <b>WDR</b>	VBA61-I5/I8 <b>WDR</b>
CCD Sensor	1/2.8" progressive scan CMOS	1/3" Progressive Scan CMOS	
Mega Pixel	2 MP (Full HD 1080p)	4 MP (Full HD 1080p)	6 MP (Full HD 1080p)
Max. Image Res.	1920 x 1080	2688x1520	3072 x 2048
Frame Rate in Real Time	30 fps (1920 x 1080)		
Min. Illumination	0 Lux with IR LED On		
IR LED's Range	50 metres / 80 metres		
Lens	4 mm (Fixed) (Optional: 6 /8/16mm)		
Wide Dynamic Range	120dB WDR		
Communication	1 x RJ45 (10M/100M) Ethernet port, 1 x RS-485, 1 x RS-232		
Alarm Trigger	Motion, Face & Intrusion detection ; network disconnect ; IP address conflict ; storage exception		
Image Settings	Saturation, brightness, contrast adjustable through client software or web browser		
IP Rating	IP 67		
Operating Temperature	-30 °C ~ 60 °C		
Power Source	12 VDC ± 10%, PoE (802.3af)		
Dimensions	302 × 106 mm		
Weight	1225g		

## VDM61-IA Up to 6 MP, Full HD (1080p) Real time - IP Compact Vandal Dome

2 Years Warranty

- Full HD (1080p) Real time, 6MP
- H.265+, H.265, H.264+, H.264 : Video Compressions.
- Fixed Lens 4mm (Optional : 2.8mm / 6mm).
- 15m IR Range ,Electronic Day & Night.
- WDR, Built in Microphone, 2-Way Audio, Dual Stream, ePTZ.
- Alarm Triggering Motion Detection.
- Built-in SD/SDHC slot, up to 128 GB storage.
- Vandal IK10 & IP66 rated fully cable managed Housing.
- Built in Microphone



**FULL HD**  
1920X1080

VVMS-Advanced™  
Video Management Software

**ONVIF**  
**PSIA**

SPECIFICATIONS	VDM41-IA <b>WDR</b>	VDM61-IA <b>WDR</b>
CCD Sensor	1/3" progressive scan CMOS	1/1.8" progressive scan CMOS
Mega Pixel	3 MP (Full HD 1080p)	6 MP (Full HD 1080p)
Max. Image Res.	1536x1536	3072 x 2048
Frame Rate in Real Time	30 fps (1536x1536)	30 fps (3072x2048)
Lens	Fixed 4mm, AoV: 79° (Optional 2.8mm or 6mm)	
Min. Illumination	0 Lux with IR LED's On	
WDR / Audio	120dB WDR / 2-Way Audio(Built in Microphone)	
IR LED's Range	Effective up to 30 metres	
Adjustment Range	Pan: ± 15°, tilt: 0 ~ 90°, rotation: ± 15°	
Communication	1 x RJ45 (10M/100M) Ethernet port	
Alarm Trigger	Motion detection, network disconnect, IP address conflict, storage exception	
Image Settings	Saturation, brightness, contrast adjustable through client software or web browser	
Operating Temperature	-30 °C ~ 60 °C	
Power Source	12 VDC ± 10%, PoE (802.3af)	
Dimensions	100 x 98 x 53 mm	
Weight	615g	

## VFP61-IA Up to 6 MP, Full HD (1080p) Real time - IP 360° panoramic view Fisheye

2 Years Warranty

- 1/2" progressive scan CMOS.
- Full HD (1080p) Real time, Up to 6 MP (3072 x 2048) Res.
- H.265+, H.265, H.264+, H.264 : Video Compressions.
- Fixed Lens 1.05mm @F2.8, angle of view: 180°/360°.
- True Day & Night, 15m IR Range.
- **WDR** - Wide Dynamic Range 120dB. (**VFP31-IA - 3MP**)
- Two-way Audio, Dual Stream, Virtual PTZ, M12 Lens Mount.
- Built-in Micro SD card slot, microphone and speaker.
- IK10 rated protective Vandal Resistant, (IP66 - Optional).



**FULL HD**  
1920X1080

SMART VU IPcCTV



SPECIFICATIONS	VFP31-IA <b>WDR</b>	VFP61-IA
CCD Sensor	1/3" progressive scan CMOS	1/1.8" progressive scan CMOS
Mega Pixel	3 MP (Full HD 1080p)	6 MP (Full HD 1080p)
Max. Image Res.	1536x1536	3072 x 2048
Frame Rate in Real Time	30 fps (1536x1536)	30 fps (3072x2048)
Min. Illumination	0 Lux IR LED On	
IR LED's Range	Effective up to 15 metres	
Lens	Fixed 1.19mm @F2.0, Angle of View: 180°/360°	Fixed 1.27mm @F2.8, Angle of View: 180°/360°
Wide Dynamic Range	120dB WDR	Digital WDR
Audio In / Out	1 In / 1 Out	
Communication	1 x RJ45 (10M/100M) Ethernet port	
Alarm Trigger	Motion detection, dynamic analysis, tamper alarm, network dc, IP address conflict, storage full, storage error	
Image Settings	Saturation, brightness, contrast adjustable through client software or web browser	
Operating Temperature	-30 °C ~ 60 °C	
Power Source	12 VDC ± 10%, PoE (802.3af)	
Dimensions	140 x 115mm	
Weight	1400g	

## VSE21

2 MP, Full HD (1080p) Real time, 32x Zoom, IP PTZ Speed Dome

1 Year Warranty

- 1/2.8" progressive scan CMOS.
- Full HD (1080p) Real time, 2 MP (1920x1080) Resolution.
- H.265+, H.265, H.264+, H.264 : Video Compressions.
- 20x or 30x Optical Zoom with 4.8 ~ 153 mm Focal Length.
- 150m IR Range, True Day & Night IR Cut Mechanical Filter.
- Auto Focus, 3D Intel-Positioning, 3D-DNR, BLC, AGC, WB.
- **120 dB WDR**, Triple Stream, 2-Way Audio, ePTZ, Privacy Masking.
- Up to 64GB built-in Micro SD/SDHC card slot for local storage.
- IP66 rated housing, lightning & surge protection.



FULL HD  
1920X1080

SMART VU IPCCTV



### SPECIFICATIONS

### VSE22-32x

CCD Sensor	1/2.8" progressive scan CMOS
Mega Pixel	2 MP (Full HD 1080p)
Max. Image Res.	1920 x 1080
Frame Rate in Real Time	30 fps (1920 x 1080)
Min. Illumination	0 Lux with Smart IR LED's On
IR Range	150m
Optical Zoom	32x Optical Zoom
Lens	4.8 ~ 153 mm, AoV: 55.6° ~ 2.04°
Adjustment Range	Pan: 0°~360° Continuous Rotation, Tilt: -2°~90° (Auto-Flip)
Preset / Patrol / Patterns	256 Presets / 8 Patrols / 4 Patterns
Communication	1 x 10Base-T / 100Base-TX, RJ45 Ethernet connector
Alarm Input / Output	7 inputs / 2 relay outputs
Operating Temperature	-30 °C ~ 65 °C
Power Source	AC24V / ( PoE)
Dimensions	220 x 354 mm
Weight	4.5 kg

## VXP41

2/4 MP, Full HD (1080p) Real time - IP Box Cameras

2 Years Warranty

- Full HD (1080p) Real time, Up to 4MP (2688x1520) Res.
- H.265+, H.265, H.264+, H.264 : Video Compressions.
- True Day & Night IR Cut Mechanical Filter.
- 3D DNR, Defog, HLC, BLC, Picture Overlay, EIS, ROI.
- Triple Stream, ePTZ, C/CS Lens Mount.
- **140dB WDR**, Motion, Face & Intrusion Detection, EIS, ROI.
- 2-Way Audio with Built-in Mic
- Power Over Ethernet (POE).
- Up to 256GB built-in Micro SD/SDHC card slot for local storage.



FULL HD  
1920X1080

SMART VU IPCCTV



\* NOTE : Excluding Lens \*

### SPECIFICATIONS

### VXP21 WDR

### VXP41 WDR

CCD Sensor	1/1.8" progressive scan CMOS	
Mega Pixel	2 MP (Full HD 1080p)	4 MP (Full HD 1080p)
Min. Illumination	0.01 lux	
Max. Image Res.	1920 x 1080	2688x1520
Frame Rate in Real Time	30 fps (1920 x 1080)	
Wide Dynamic Range	140dB WDR	
Iris Mode	Auto Iris - DC Drive	
Audio In / Out	1-ch built-in microphone input / 1-ch audio out interface	
Alarm In / Out	2 / 2	
Alarm Trigger	Motion, Face & Intrusion detection ; network disconnect ; IP address conflict ; storage exception	
Communication	RJ45 Ethernet port, RS-485, RS-232	
SD Card Storage	Built-in micro SD/SDHC card slot, up to 256 GB storage	
Operating Temperature	-30 °C ~ 60 °C	
Power Source	24 VAC ± 10%, 12 VDC ± 10%, PoE (802.3af)	
Dimensions	143 x 70 x 68 mm	
Weight	730 g	



## VDP42-IMA Full HD (1080p) Real time - IP Vandal Dome Cameras

2 Years Warranty

- Full HD (1080p) Real time, Up to 4 MP ( 2688 ×1520 ) Res.
- H.265+, H.265, H.264+, H.264 : Video Compressions.
- Motorized Varifocal Lens 2.8 ~ 12mm / 8 ~ 32 mm P-Iris
- True Day & Night IR Cut Mechanical Filter.
- **Five Streams, 1Audio (line in) + 1 Audio Out (Mono) & Alarm In/Out**
- **140dB WDR**, Motion, Face & Intrusion Detection, EIS, ROI.
- Built-in Micro SD / SDHC card slot for storage up to 128GB.
- 3D DNR, Defog, HLC, BLC, Picture Overlay, EIS, ROI.
- **Nema X**, IP67 & IK10 rated fully cable managed Housing & Bracket

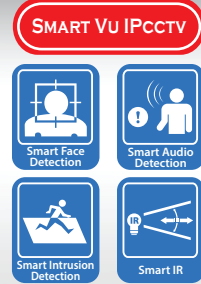

SPECIFICATIONS	VDP22-IMA <b>WDR</b>	VDP42-IMA <b>WDR</b>
CCD Sensor	1/1.8" progressive scan CMOS	
Mega Pixel	2 MP (Full HD 1080p)	4 MP (Full HD 1080p)
Max. Image Res.	1920 x 1080	2688x1520
Frame Rate in Real Time	60 fps (3840 × 2160)	
Min. Illumination	0 Lux with Smart IR LED's On	
IR LED's Range	Effective up to 50 metres	
Lens	Motorized Varifocal Lens 2.8 ~ 12 mm / 8 ~ 32 mm @F1.4 , Angle of view: 96° ~ 32.6° with Distortion-free	
Adjustment Range	Pan: 0°~355°, Tilt: 0°~75°	
Wide Dynamic Range	140dB Wide Dynamic Range	
Communication	1 x RJ45 (10M/100M) Ethernet port	
Audio / Alarm	1 Audio (line in) + 1 Audio Out (Mono) / 1 Alarm In + 1 Alarm Out	
Alarm Trigger	Motion detection, network disconnect, IP address conflict, storage exception	
Operating Temperature	-30 °C ~ 60 °C	
Power Source	12 VDC ± 10%, PoE (802.3at)	
Dimensions	162 × 141 mm	
Weight	1450 g	

## VBP42-IMA Full HD (1080p) Real time - IP Vandal Bullet Cameras

2 Years Warranty

- Full HD (1080p) Real time, Up to 4 MP ( 2688 ×1520 ) Res.
- H.265+, H.265, H.264+, H.264 : Video Compressions.
- Motorized Varifocal Lens 2.8 ~ 12mm/ 8 ~ 32 mm P-Iris
- True Day & Night IR Cut Mechanical Filter.
- **Five Streams, Alarm In/Out**
- **140dB WDR**, Motion, Face & Intrusion Detection, EIS, ROI.
- Built-in Micro SD / SDHC card slot for storage up to 128GB.
- 3D DNR, Defog, HLC, BLC, Picture Overlay, EIS, ROI.
- **Nema X**, IP67 & IK10 rated fully cable managed Housing & Bracket

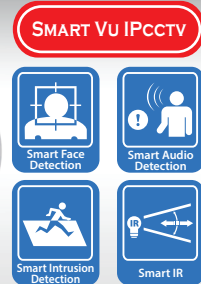

SPECIFICATIONS	VBP22-IMA <b>WDR</b>	VBP42-IMA <b>WDR</b>
CCD Sensor	1/1.8" progressive scan CMOS	
Mega Pixel	2 MP (Full HD 1080p)	4 MP (Full HD 1080p)
Max. Image Res.	1920 x 1080	2688x1520
Frame Rate in Real Time	60 fps (1920 × 1080)	
Min. Illumination	0 Lux with Smart IR LED's On	
IR LED's Range	Effective up to 50 metres	
Lens	Motorized Varifocal Lens 2.8 ~ 12 mm / 8 ~ 32 mm @F1.4 , Angle of view: 96° ~ 32.6° with Distortion-free	
Adjustment Range	Pan: 0°~355°, Tilt: 0°~75°	
Wide Dynamic Range	140dB Wide Dynamic Range	
Communication	1 x RJ45 (10M/100M) Ethernet port	
Audio / Alarm	2 Alarm In + 2 Alarm Out	
Alarm Trigger	Motion detection, network disconnect, IP address conflict, storage exception	
Operating Temperature	-30 °C ~ 60 °C	
Power Source	12 VDC ± 10%, PoE (802.3at)	
Dimensions	144 × 347 mm	
Weight	2450 g	

## VXP81

### 8 MP, 4K ULTRA HD (2160p) Real time - IP Box Camera

2 Years Warranty

- 4K ULTRA HD (2160p) Real time, 8 MP (4096 x 2160) Res.
- H.265, H.265+, H.264+, H.264 : Video Compressions.
- True Day & Night IR Cut Mechanical Filter.
- Smart Focus Motorized Lens (optional) available.
- D-WDR, 3D DNR, Defog, HLC, BLC, Picture Overlay, EIS, ROI.
- Triple Stream, ePTZ, C/CS Lens Mount.
- 2-Way Audio.
- Built-in 128GB Micro SD / SDHC card slot for storage.



\* NOTE : Excluding Lens \*

SPECIFICATIONS	VXP81
CCD Sensor	1/1.7" progressive scan CMOS
Mega Pixel	8 MP - 4K ULTRA HD (2160p)
Min. Illumination	0.001 lux
Max. Image Res.	4096 x 2160 (4K Ultra HD Res.)
Frame Rate	30 fps (4096 x 2160)
Wide Dynamic Range	Digital WDR
Iris Mode	Auto Iris - DC drive
Audio In / Out	1-ch built-in microphone input / 1-ch audio out interface
Alarm In / Out	1 / 1
Alarm Trigger	Motion, Face & Intrusion detection ; network disconnect ; IP address conflict ; storage exception
Communication	RJ45 Ethernet port, RS-485, RS-232
SD Card Storage	Up to 128 GB storage
Operating Temperature	-30 °C ~ 60 °C
Power Source	24 VAC ± 10%, 12 VDC ± 10%, PoE (802.3at)
Dimensions	70 x 58 x 145 mm
Weight	835g

## VDP82-IMA

### 8MP, 4K ULTRA HD (2160p) Real time - IP Vandal Dome Cameras

2 Years Warranty

- 4K ULTRA HD (2160p) Real time, 8 MP (4096 x 2160) Res.
- H.265, H.265+, H.264+, H.264 : Video Compressions.
- Smart Focus Motorized Varifocal Lens 2.8 ~ 12mm.
- True Day & Night IR Cut Mechanical Filter.
- Triple Stream, ePTZ, 2-Way Audio.
- Built-in 128GB Micro SD / SDHC card slot for storage.
- **120dB WDR**, 3D DNR, Defog, HLC, BLC, Picture Overlay, EIS, ROI.
- IP66 weatherproof & IK10 Vandal rated Housing.



SPECIFICATIONS	VDP82-IMA
CCD Sensor	1/2.5" progressive scan CMOS
Mega Pixel	8 MP - 4K ULTRA HD (2160p)
Max. Image Res.	3840 x 2160 (4K Ultra HD Res.)
Frame Rate in Real Time	30 fps (3840 x 2160)
Min. Illumination	0 Lux with Smart IR LED's On
IR LED's Range	Effective up to 40 metres
Lens	Motorized Varifocal Lens 2.8 ~ 12 mm @F1.4 , Angle of view: 96° ~ 32.6° with Distortion-free
Adjustment Range	Pan: 0°~355°, Tilt: 0°~75°
Wide Dynamic Range	120dB Wide Dynamic Range
Communication	1 x RJ45 (10M/100M) Ethernet port, 1 x RS-485, 1 x RS-232
Audio / Alarm	1 Audio In + 1 Audio Out / 1 Alarm In + 1 Alarm Out
Alarm Trigger	Motion detection, network disconnect, IP address conflict, storage exception
Operating Temperature	-30 °C ~ 60 °C
Power Source	12 VDC ± 10%, PoE (802.3at)
Dimensions	154 x 134 mm
Weight	1287g

## VBP82-IMA 8MP, 4K ULTRA HD (2160p) Real time - IP IR Bullet Cameras

2 Years Warranty

- 4K ULTRA HD (2160p) Real time, 12 MP (4000 x 3000) Res.
- H.265, H.265+, H.264+, H.264 : Video Compressions.
- Smart Focus Motorized Varifocal Lens 2.8~12mm.
- True Day & Night IR Cut Mechanical Filter.
- Triple Stream, ePTZ, 2-Way Audio.
- Built-in 128GB Micro SD / SDHC card slot for storage.
- **120dB WDR**, 3D DNR, Defog, HLC, BLC, PO, EIS, ROI.
- IP67 rated fully cable managed Housing & Bracket.

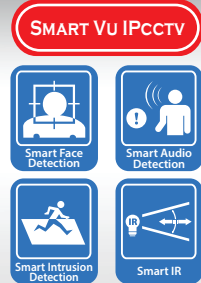

SPECIFICATIONS	VBP82-IMA
CCD Sensor	1/2.5" progressive scan CMOS
Mega Pixel	8 MP - 4K ULTRA HD (2160p)
Max. Image Res.	3840 x 2160 (4K Ultra HD Res.)
Frame Rate in Real Time	20 fps (3840 x 2160)
Min. Illumination	0 Lux with Smart IR LED's On
IR LED's Range	50 metres
Varifocal Lens	Motorized Varifocal Lens 2.8 ~ 12 mm @F1.4 , Angle of view: 96° ~ 32.6° with Distortion-free
Wide Dynamic Range	120dB Wide Dynamic Range
Audio Input / Output	1-ch Mic in or Line in / 1-ch audio out interface
Communication	1 x RJ45 (10M/100M) Ethernet port, 1 x RS-485, 1 x RS-232
Alarm Trigger	Motion, Face & Intrusion detection ; network disconnect ; IP address conflict ; storage exception
Built-in Heater	(Optional)
Operating Temperature	-30 °C ~ 60 °C (Default) / -40 °C ~ 60 °C (with optional built-in Heater)
Power Source	12 VDC ± 10%, PoE (802.3at)
Dimensions	100 x 105 x 315 mm
Weight	2025g

## VDP81-I 8 MP, 4K ULTRA HD Real time - IP Vandal Dome Cameras

2 Years Warranty

- 4K ULTRA HD Real time, 8 MP (3840 x 2160) Res.
- H.265, H.265+, H.264+, H.264 : Video Compressions.
- Fixed 2.8mm (Optional : 4mm, 6mm, 8mm, 12mm).
- True Day & Night IR Cut Mechanical Filter.
- Triple Stream, ePTZ
- Built-in 128GB Micro SD / SDHC card slot for storage.
- **120dB WDR**, 3D DNR, Defog, HLC, BLC, Picture Overlay, EIS, ROI.
- IP67 weatherproof & IK10 Vandal rated Housing.



SPECIFICATIONS	VDP81-I
CCD Sensor	1/2.5" progressive scan CMOS
Mega Pixel	8 MP - 4K ULTRA HD (2160p)
Max. Image Res.	3840 x 2160 (4K Ultra HD Res.)
Frame Rate in Real Time	30 fps (3840 x 2160)
Min. Illumination	0 Lux with Smart IR LED's On
IR LED's Range	Effective up to 40 metres
Lens	Fixed 2.8mm (Optional : 4mm, 6mm, 8mm, 12mm)
Adjustment Range	Pan: 0°~355°, Tilt: 0°~75°
Wide Dynamic Range	120dB WDR
Communication	1 x RJ45 (10M/100M) Ethernet port, 1 x RS-485, 1 x RS-232
Audio / Alarm	1 Audio In + 1 Audio Out / 1 Alarm In + 1 Alarm Out (Optional)
Alarm Trigger	Motion detection, network disconnect, IP address conflict, storage exception
Operating Temperature	-30 °C ~ 60 °C
Power Source	12 VDC ± 10%, PoE (802.3at)
Dimensions	111 x 83 mm
Weight	500 g



## VBP81-I 8 MP, 4K ULTRA HD Real time - IP IR Mini Bullet Cameras

2 Years Warranty

- 4K ULTRA HD Real time, 8 MP (3840 × 2160) Res.
- H.265, H.265+, H.264+, H.264 : Video Compressions.
- Fixed 2.8mm (Optional : 4mm, 6mm, 8mm, 12mm).
- True Day & Night IR Cut Mechanical Filter.
- Triple Stream, ePTZ
- Built-in 128GB Micro SD / SDHC card slot for storage.
- **120dB WDR**, 3D DNR, Defog, HLC, BLC, PO, EIS, ROI.
- IP67 rated fully cable managed Housing & Bracket.

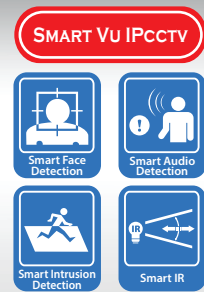

SPECIFICATIONS	VBP81-I
CCD Sensor	1/2.5" progressive scan CMOS
Mega Pixel	8 MP - 4K ULTRA HD (2160p)
Max. Image Res.	3840 × 2160 (4K Ultra HD Res.)
Frame Rate in Real Time	30 fps (3840 × 2160)
Min. Illumination	0 Lux with Smart IR LED's On
IR LED's Range	40m
Varifocal Lens	Fixed 2.8mm (Optional : 4mm, 6mm, 8mm, 12mm)
Wide Dynamic Range	120dB WDR
Communication	1 x RJ45 (10M/100M) Ethernet port,
Alarm Trigger	Motion, Face & Intrusion detection ; network disconnect ; IP address conflict ; storage exception
Built-in Heater	(Optional)
Operating Temperature	-30 °C ~ 60 °C (Default) / -40 °C ~ 60 °C
Power Source	12 VDC ± 10%, PoE (802.3at)
Dimensions	70 × 156 mm
Weight	410 g

## VBP81-I5/I8 8 MP, 4K ULTRA HD Real time - IP IR Bullet Cameras

2 Years Warranty

- 4K ULTRA HD Real time, 8 MP (3840 × 2160) Res.
- H.265, H.265+, H.264+, H.264 : Video Compressions.
- Fixed 2.8mm (Optional : 4mm, 6mm, 8mm, 12mm).
- True Day & Night IR Cut Mechanical Filter.
- Triple Stream, ePTZ
- Built-in 128GB Micro SD / SDHC card slot for storage.
- **120dB WDR**, 3D DNR, Defog, HLC, BLC, PO, EIS, ROI.
- IP67 rated fully cable managed Housing & Bracket.

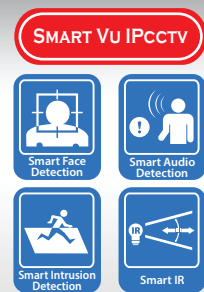

SPECIFICATIONS	VBP81-I5/I8
CCD Sensor	1/2.5" progressive scan CMOS
Mega Pixel	8 MP - 4K ULTRA HD (2160p)
Max. Image Res.	3840 × 2160 (4K Ultra HD Res.)
Frame Rate in Real Time	20 fps (3840 × 2160)
Min. Illumination	0 Lux with Smart IR LED's On
IR LED's Range	50/ 80m, optional
Varifocal Lens	Fixed 2.8mm (Optional : 4mm, 6mm, 8mm, 12mm)
Wide Dynamic Range	120dB WDR
Communication	1 x RJ45 (10M/100M) Ethernet port, 1 x RS-485, 1 x RS-232
Alarm Trigger	Motion, Face & Intrusion detection ; network disconnect ; IP address conflict ; storage exception
Built-in Heater	(Optional)
Operating Temperature	-30 °C ~ 60 °C (Default) / -40 °C ~ 60 °C
Power Source	12 VDC ± 10%, PoE (802.3at)
Dimensions	386 × 156 × 155 mm
Weight	1200 g

## VSP82-36X 8 MP, Full HD (1080p) Real time, 36x Optical Zoom, IP IR PTZ Speed Dome 1 Years Warranty

- Full HD (1080p) Real time, 8 MP (4096 x 2160) Res.
- H.265+, H.265, H.264+, H.264 : Video Compressions.
- 36x Optical Zoom with up to 6.2~202 mm Focal Length.
- 200m IR range, True Day & Night IR Cut Mechanical Filter.
- Auto Focus, 3D Intel-Positioning, 3D-DNR, DWDR, BLC, AGC
- Triple Stream, 2-Way Audio, ePTZ, Privacy Masking.
- Up to 128GB built-in Micro SD/SDHC card slot for local storage.
- IP66 rated & IK10 Vandal proof housing.



VVMS - Advanced™  
Video Management Software



SPECIFICATIONS	VSP82-36X
CCD Sensor	1/1.9" progressive scan CMOS
Mega Pixel	8 MP (Full HD 1080p)
Max. Image Res.	4096 x 2160
Frame Rate in Real Time	30 fps (1920 x 1080)
Min. Illumination	0 Lux with Smart Laser IR LED On
IR LED's Range	200 metres IR range
Optical Zoom	36x Optical Zoom
Lens	6.2 ~ 202mm, AoV: 56.8° ~ 2.02°
Adjustment Range	Pan: 0°~360° Continuous Rotation, Tilt: -2°~90° (Auto-Flip)
Preset / Patrol / Patterns	300 Presets / 8 Patrols / 4 Patterns
Communication	1 x 10Base-T / 100Base-TX, RJ45 Ethernet connector
Alarm Input / Output	7 inputs / 2 relay outputs
Operating Temperature	-40 °C ~ 65 °C
Power Source	AC24V & PoE+
Dimensions	268 x 366 mm
Weight	8.15kg

## VFP121-IA 12 MP, Full HD (1080p) Real time, IP Fisheye Network Camera 2 Years Warranty

- Full HD (1080p) Real time, Up to 12 MP (4000 x 3072 ) Res.
- H.264 / MJPEG : Video Compressions.
- Fixed Lens 1.98mm
- 3D DNR, DWDR, BLC.
- Dual Stream, Fixed Iris, M12 Lens Mount.
- RJ45 (10M/100M) Ethernet interface.
- Up to 128GB built-in Micro SD/SDHC card slot for local storage.
- IP66 rated fully cable managed Housing & Bracket.



VVMS - Advanced™  
Video Management Software



SPECIFICATIONS	VFP121-IA
CCD Sensor	1/1.7" Progressive Scan CMOS
Mega Pixel	12 MP (Full HD 1080p)
Max. Image Res.	4000 x 3072
Frame Rate in Real Time	20 fps(4000 x 3072)
Min. Illumination	0 Lux with Smart Laser IR LED On
IR LED's Range	15 metres IR range
Lens	1.98mm @F2.4
Wide Dynamic Range	D-WDR
Bit Rate	32 Kbps ~ 16 Mbps
Communication	1 x 10Base-T / 100Base-TX, RJ45 Ethernet connector
Dual Stream	Yes
Operating Temperature	-40 °C ~ 65 °C
Power Source	AC24V & PoE+
Dimensions	182(W) x 152.8(H) x 43.8(D) mm
Weight	1400g

## VBP22-ANPR 2 MP, Full HD (1080p) Real time, IP ANPR IR Bullet Camera

2 Years Warranty

- Full HD (1080p) Real time, Up to 2 MP (1920 x 1080) Res.
- H.265+, H.265, H.264+, H.264 : Video Compressions.
- Motorized Varifocal 2.8 ~ 12 mm / 8 ~ 32 mm
- **ANPR & High accuracy Face Detection**
- True Day & Night IR Cut Mechanical Filter.
- 3D DNR, DWDR, BLC.
- Five Stream, Fixed Iris, M12 Lens Mount.
- RJ45 (10M/100M) Ethernet interface.
- IP67, IK10 rated fully cable managed Housing & Bracket.

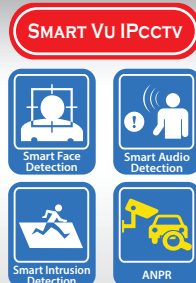

SPECIFICATIONS	VBP22-ANPR
CCD Sensor	1/1.8" progressive scan CMOS
Mega Pixel	2 MP (Full HD 1080p)
Max. Image Res.	1920 x 1080
Frame Rate in Real Time	60 fps (1920 x 1080)
Min. Illumination	0 Lux with IR LED On
IR LED's Range	50 metres / 100 metres
Lens	Motorized Varifocal 2.8 ~ 12 mm / 8 ~ 32 mm
Wide Dynamic Range	140dB WDR
Communication	1 x RJ45 (10M/100M) Ethernet port
Alarm Trigger	Motion, Face & Intrusion detection ; network disconnect ; IP address conflict ; storage exception
Image Settings	Saturation, brightness, contrast adjustable through client software or web browser
IP Rating	IP67, IK10
Operating Temperature	-30 °C ~ 60 °C
Power Source	12 VDC ± 10%, PoE (802.3af)
Dimensions	144 x 347 mm
Weight	2450g Approx.

## VDP23-FR 2MP, Full HD (1080p) Real time, IP Face Recognition IR Bullet Camera

2 Years Warranty

- Full HD (1080p) Real time, Up to 2 MP (1920 x 1080) Res.
- H.265+, H.265, H.264+, H.264 : Video Compressions.
- Fixed 4 mm Lens
- **Face Recognition**
- True Day & Night IR Cut Mechanical Filter.
- 3D DNR, DWDR, BLC.
- Five Stream, Fixed Iris, F1.6 Lens Mount.
- RJ45 (10M/100M) Ethernet interface.
- IP67, IK10 rated fully cable managed Housing & Bracket.



SPECIFICATIONS	VDP23-FR
CCD Sensor	1/ 2. 8" progressive scan CMOS
Mega Pixel	2 MP (Full HD 1080p)
Max. Image Res.	1920 x 1080
Frame Rate in Real Time	25 fps (1920 x 1080)
Min. Illumination	0 Lux with IR LED On
IR LED's Range	10 metres
Lens	Fixed Lens 4mm
Wide Dynamic Range	120 dB WDR
Communication	1 x RJ45 (10M/100M) Ethernet port
Alarm Trigger	Motion, Face & Intrusion detection ; network disconnect ; IP address conflict ; storage exception
Image Settings	Saturation, brightness, contrast adjustable through client software or web browser
IP Rating	IP 66
Operating Temperature	-30 °C ~ 60 °C
Power Source	36 VDC
Dimensions	180.5 x 147 x 118 mm
Weight	1500g Approx.

## VCP13-IA 1.3 MP, Full HD (1080p) Intelligent Dome Camera With Smart People Counting 2 Years Warranty

- 1/3" progressive scan CMOS.
- H.264+ / H.264 / MJPEG : Video Compressions.
- Fixed Lens 2.1/2.8mm(Optional)@F2.2 , Angle of view: 115°.
- **Smart People Counting**, Electronic Day & Night.
- 3D DNR, Defog, BLC, Picture Overlay, EIS, ROI etc.
- D-WDR Audio Interface.
- Dual Stream, M12 Lens Mount.
- Built-in Micro SD / SDHC card slot for storage.



SPECIFICATIONS	VCP13-IA
CCD Sensor	1/3" progressive scan CMOS
Mega Pixel	1.3MP(HD 720p)
Max. Image Res.	640 × 960
Frame Rate in Real Time	25 fps (640 × 480)
Min. Illumination	0.01 Lux @ (F1.2, AGC ON)
Wide Dynamic Range	D-WDR
Lens	2.0/2.8mm optional , Angle of view: 115°
Audio In	(Optional)
Communication	1 x RJ45 (10M/100M) Ethernet port , 1 x RS-485 interface (Optional)
Alarm Trigger	Motion detection, dynamic analysis, tamper alarm, network dc, IP address conflict, storage full, storage error
Image Settings	Saturation, brightness, contrast adjustable through client software or web browser
<b>People Counting</b>	<b>Realtime people counting data.</b>
Operating Temperature	-10 °C ~ 40 °C
Power Source	12 VDC ± 10%, PoE (802.3af)
Dimensions	194 × 71 × 36 mm
Weight	300 g

## VIDEOTEKNIKA NEW PREMIUM IP STORAGE SERVER

Hybrid SAN product creates a network with access to data storage servers

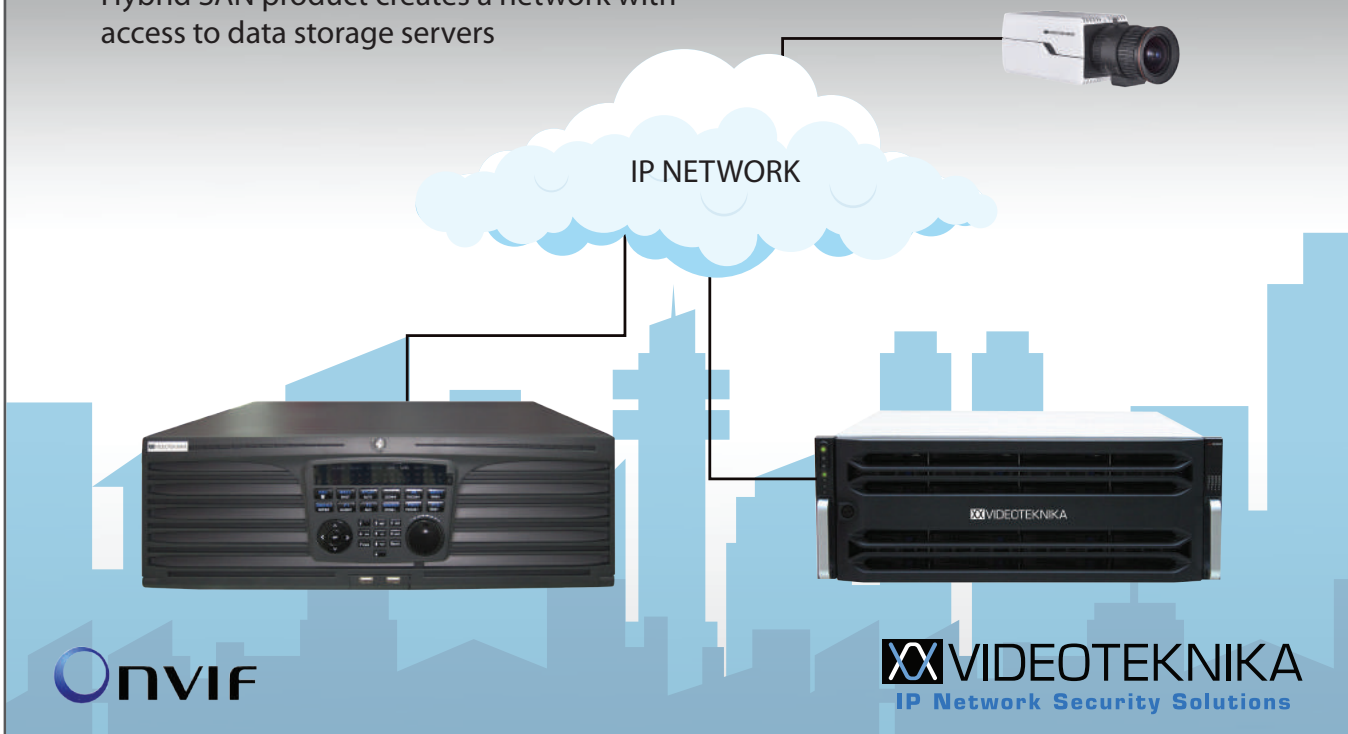



## VSS24D/S

## 320ch / 448ch Hybrid SAN

2 Years Warranty

- 64-bit multi-core processor.
- **Direct Streaming 320ch / 448ch** recording + playback
- Modular design, Dual controller & Real-time cache.
- PCI-E 2.0 bus, Optional Backup Battery
- High-Performance and Extendable Hardware Platform
- 4 X 1000M Ethernet interfaces per controller.
- SAS interface for storage enclosure.
- High-density chassis. 4U chassis: 24 HDDs.
- HDD Detection and Repair/RAID Optimization
- Fault Detection & repair, Global and local hot spare.
- RAID 0, 1, 3, 5, 6, 10, 50. & Quick RAID building.



VVMS - Advanced™  
Video Management Software

ONVIF

PSIA

SPECIFICATIONS	VSS24S	VSS24D
IPSAN	180-ch recording + playback	256-ch recording + playback
Processor	64 BIT Multi-core Processor	
Cache	4 GB ( extendable to 32 GB )	8 GB ( extendable to 32 GB )/controller
HDD	24	
Interface/Capacity	SSD (optional), SAS/1TB,2TB,3TB,4TB,6TB,8TB	
Hot-swapping	Supported	
RAID	RAID 0,1,3,5,6,10,50,JBOD,Hot-spare	
Network interface	4 x 10GbE or 2 x 10GbE Extendable	
MiniSAS	Supported	
USB / VAG/ HDMI	2 x USB 3.0 / 2 x HDMI	3 x USB 3.0 / 1xVGA
Protocol	iSCSI,RTSP,ONVIF,PSIA	
Power supply	Redundant	
Comsumption	≤430W	≤507W
Chassis	19 inch 4U	
Dimensions (mm)	447 x 172 x 550 mm	
Weight	≤ 33.5 Kg	

## VSSEXP24D/S

## EXPANSION

2 Years Warranty

- Mini SAS 3.0 with transmission ability 4 times faster than 12G.
- Support cascading expansion.
- Support SAS HDD interfaces
- Up to 6TB capacity for each HDD.



VVMS - Advanced™  
Video Management Software

ONVIF

PSIA

SPECIFICATIONS	VSSEXP24S	VSSEXP24D
Processor	1 Controller	2 Controller
HDD	24	
Interface/Capacity	SAS	
Hot-swapping	Supported	
Network interface	4 x 10GbE or 2 x 10GbE Extendable	
MiniSAS	3 SAS interfaces each controller(12Gbps), 2 (Upper-level) & 1 (Lower-level)	
Protocol	iSCSI,RTSP,ONVIF,PSIA	
Power supply	Redundant (1+1)	
Comsumption	≤ 430 W	≤550W
Chassis	4U Chassis	
Dimensions (mm)	447 × 172 × 525 mm	486 × 173 × 760 mm
Weight	≤ 41 Kg	≤ 30 Kg

<b>VK300/105</b>	<b>Network Joystick Control Keyboard</b>	<b>1 Year Warranty</b>
<ul style="list-style-type: none"> <li>• 7" TFT touch screen at 800 x 480 resolution</li> <li>• 1-ch HD video stream decoding @ 1080p</li> <li>• 2-Way Audio</li> <li>• Speed dome, video decoder &amp; DVR control</li> <li>• Simultaneous HDMI &amp; VGA outputs</li> <li>• Support 15 users, and each operate up to 256 devices</li> <li>• USB 2.0 interface for video backup</li> </ul>		 <p><b>VK300</b></p>  <p><b>VK105</b></p>

<b>VDC08/12/16</b>	<b>Video Decoders</b>	<b>1 Year Warranty</b>
<p><b>VIDEO DECODER :</b></p> <ul style="list-style-type: none"> <li>• Compatible with standard H.264, MPEG4.</li> <li>• Support dynamic &amp; cycle decoding (up to 720p resolution).</li> <li>• High performance hardware decoding supporting DHCP, DDNS.</li> </ul>		

<b>VPS4104/8/16/24</b>	<b>PoE Switch</b>	<b>1 Year Warranty</b>
<ul style="list-style-type: none"> <li>• 4/8/16/24 -Port 10/100Mbps Fast Ethernet ports</li> <li>• Shared combo interfaces</li> <li>• Console interface for Switch basic management and setup</li> <li>• Reset button for system management</li> <li>• Up to 24 IEEE 802.3x devices powered</li> <li>• 4 KV surge protection for PoE ports</li> <li>• 4K MAC address entries</li> <li>• Auto detect powered device (PD)</li> </ul>		 

<b>VVMS</b>	<b>IP Video Surveillance - Intelligent Video Management Software</b>	<b>License Based</b>
<ul style="list-style-type: none"> <li>• Supports up to 1024 IP Cameras (<i>License based</i>)</li> <li>• Intelligent Video Management Systems</li> <li>• NVR / DVR / IP Camera compatible</li> <li>• Local &amp; Remote Viewing Facilities</li> <li>• Live View / Instant Playback &amp; PTZ Control</li> <li>• E-MAP Facility including POI Function</li> <li>• Multi-Level User &amp; Administrator Parameters</li> <li>• Auto Search Facility for Videoteknika Cameras</li> </ul>		 <ul style="list-style-type: none"> <li>• VVMS Advanced</li> <li>• VVMS Xpert/300ch(64 /300Channel)</li> <li>• VVMS Xpert/ch(Per Channel license )</li> <li>• VVMS-Xpert/site module(Remote Site Module )</li> <li>• VVMS-Xpert/ANPR module</li> <li>• VVMS-Xpert/Video Wall</li> </ul>

<b>Affiliations</b>		<b>Our Partners</b>		
 <p>Open Network Interface Forum</p>	 <p>Authorized Partner</p>			 <p>IP Surveillance System</p>
 <p>Physical Security Interportability</p>		 <p>Software for Video Security</p>	 <p>Video Surveillance and Security Solutions</p>	 <p>Technologies</p>

## VN2016-P 16 ch, H.265+, Full HD 1080p Real Time HDMI output with 16 PoE 2 Years Warranty

- Up to 16 Channels recording (up to 8MP resolution).
- Up to 12 TB of HDD storage (6TB x 2 HDD's).
- H.265+, H.265, H.264+, H.264 : Video Compressions.
- HDMI(4K) & VGA (Full HD 1080p) local display.
- Dual Simultaneous Streaming.
- Simultaneous HDMI & VGA outputs.
- 2-Way Audio, RS-232, RS-485.
- Self Adaptive 10m/100m/1000m network interface.
- 8/16 x PoE Interfaces, USB / Network Backup.

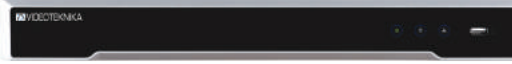

\*\*\* Note : NVR picture shown above is of VN2016 model \*\*\*



SPECIFICATIONS	VN2004K1-4P	VN2008K2-8P	VN2016K2-16P
IP Video Input	4 ch	8 ch	16 ch
HDD Storage	8 TB = ( 8TB x 1 HDD's )	16TB = ( 8TB x 2 HDD's )	16 TB = ( 8TB x 2 HDD's )
Recording Resolution	8MP / 6MP / 5MP / 3MP /1080P /UXGA /720P /VGA /4CIF /DCIF /2CIF /CIF /QCIF		
HDMI Output	1-ch, Res:4K (3840 x 2160) / 2K(2560 x 1440) / 1920 x 1080P / 1600 x 1200 / 1280 x 1024 / 1280 x 720 / 1024 x 768		
VGA Output	1-ch, Res: 1920 x 1080P / 1600 x 1200 / 1280 x 1024 / 1280 x 720 / 1024 x 768		
Video Compression	H.265+, H.265, H.264+, H.264		
Audio In / Out	1 In / 1 Out		
Serial / Network Int.	1 x RJ-45, 1 x RS-485	1 x RJ-45, 1 x RS-485	1 x RJ-45, 1 x RS-232, 1 x RS-485
USB Interfaces	1 x USB 2.0, 1 x USB 3.0	2 x USB 2.0	
Incoming Bandwidth	40 Mbps	80 Mbps	160 Mbps
Power over Ethernet	4 x PoE	8 x PoE	16 x PoE
Power Source	DC 48V	100 ~ 240 VAC, 3 A	100 ~ 240 VAC, 6.3 A
Operating Temp	-10 °C ~ 55 °C		
Chassis	1U casing	19" rack-mount, 1.5U casing	
Dimensions (mm)	317 (W) x 232 (D) x 45 (H)	445 (W) x 261 (D) x 70 (H)	
Weight	≤ 2 Kg	≤ 4 Kg	

## VN4032K4/16P 32 ch, H.265+, Full HD 1080p Real Time HDMI output with 16 PoE 2 Years Warranty

- Up to 32 Channels recording (up to 8MP resolution).
- Up to 24 TB of HDD storage (6TB x 4 HDD's) + 1x eSATA
- H.265+, H.265, H.264+, H.264 : Video Compressions.
- HDMI(4K) & VGA (Full HD 1080p) local display.
- Dual Simultaneous Streaming.
- Simultaneous HDMI, VGA & CVBS outputs.
- 2-Way Audio, Alarm, RS-232, RS-485.
- Self Adaptive 10m/100m/1000m network interface.
- 16 x PoE Interfaces, USB / Network / DVD Backup.



SPECIFICATIONS	VN4016K4/16P	VN4032K4/16P
IP Video Input	16 ch	32 ch
HDD Storage / eSATA	32 TB = ( 8TB x 4 HDD's ) + 1 x eSATA	
Recording Resolution	8MP / 6MP / 5MP /3MP /1080P /UXGA /720P /VGA /4CIF /DCIF /2CIF /CIF /QCIF	
HDMI Output	1-ch, Res:4K (3840 x 2160) / 2K(2560 x 1440) / 1920 x 1080P / 1600 x 1200 / 1280 x 1024 / 1280 x 720 / 1024 x 768	
VGA Output	1-ch, Res: 1920 x 1080P / 1600 x 1200 / 1280 x 1024 / 1280 x 720 / 1024 x 768	
CVBS Output	1-ch, BNC Res: 704 x 576 (PAL); 704 x 480 (NTSC)	
Audio In / Out	1 In / 2 Out	
Alarm In / Out	16 In / 4 Out	
Serial / Network Int.	1 x RJ-45 Ethernet, 1 x RS-232, 1 x RS-485	
USB Interfaces	3 x USB 2.0	
Incoming Bandwidth	160 Mbps	256 Mbps
Power over Ethernet	16 x PoE	
Power Source	100 ~ 240 VAC, 6.3 A, 50 ~ 60 Hz	
Chassis	19" rack-mount, 2U casing	
Dimensions (mm)	440 (W) x 390 (D) x 90 (H)	
Weight	≤ 5 Kg	

## VN8064Pro+ 64 ch, H.265+, Full HD 1080p Real Time HDMI output

2 Years Warranty

- Up to 64 Channels recording (up to 12MP resolution).
- **RAID 0, 1, 5, 10** with Redundant Power Supply (**Optional**).
- Up to 64 TB of HDD storage (6TB x 8 HDD's).
- HDMI & VGA (Full HD 1080p) local display.
- H.265+,H.265 video, Dual Simultaneous Streaming.
- Simultaneous HDMI, VGA & CVBS outputs.
- 2-Way Audio, Alarm, RS-232, RS-485.
- 2 x Self Adaptive 10m/100m/1000m network interface.
- USB / Network / DVD Backup.



SPECIFICATIONS	VN8032 Pro+	VN8064 Pro+
IP Video Input	32 ch	64 ch
HDD Storage / eSATA	80 TB = ( 10TB x 8 HDD's) + 1 x eSATA	
Disk Array Type	RAID 0, RAID 1, RAID 5, RAID 10	
Recording Resolution	12MP / 8MP / 6MP / 5MP / 3MP / 1080P / UXGA / 720P / VGA / 4CIF / DCIF / 2CIF / CIF / QCIF	
HDMI Output	1-ch, Res: 1920 x 1080P / 1600 x 1200 / 1280 x 1024 / 1280 x 720 / 1024 x 768	
VGA Output	1-ch, Res: 1920 x 1080P / 1600 x 1200 / 1280 x 1024 / 1280 x 720 / 1024 x 768	
Audio In / Out	1 In / 2 Out	
Alarm In / Out	16 In / 4 Out	
Serial / Network Int.	2 x RJ-45 Ethernet, 1 x RS-232, 1 x RS-485	
USB Interfaces	3 x USB 2.0	
Incoming Bandwidth	320 Mbps or (200 Mbps when RAID is enabled)	
Operating Temp	-10 °C ~ 55 °C	
Power Source	100 ~ 240 VAC, 6.3 A, 50 ~ 60 Hz	
Chassis	19" rack-mount, 2U casing	
Dimensions (mm)	445 (W) x 470 (D) x 90 (H)	
Weight	≤ 8 Kg	

## VN1664 Pro 64 ch, RAID, H.265+, Full HD 1080p Real Time HDMI output

2 Years Warranty

- Up to 64 Channels recording (up to 12MP resolution).
- **RAID 0, 1, 5, 10** with Redundant Power Supply (**Optional**).
- Up to 128 TB of HDD storage (8TB x 16 HDD's).
- HDMI & VGA (Full HD 1080p) local display.
- H.265+,H.265 video, Dual Simultaneous Streaming.
- Simultaneous HDMI, VGA & CVBS outputs.
- 2-Way Audio, Alarm, RS-232, RS-485.
- 2 x Self Adaptive 10m/100m/1000m network interface.
- USB / Network Backup.



SPECIFICATIONS	VN1632 Pro+	VN1664 Pro+
IP Video Input	32ch	64ch
HDD Storage / eSATA	160 TB = (10TB x 16 HDD's) + 1 x eSATA	
Disk Array Type	RAID 0, RAID 1, RAID 5, RAID 10	
Recording Resolution	12MP / 8MP / 6MP / 5MP / 3MP / 1080P / UXGA / 720P / VGA / 4CIF / DCIF / 2CIF / CIF / QCIF	
HDMI Output	1-ch, Res: 4K (3840 x 2160) / 2560 x 1440 / 1920 x 1080P / 1600 x 1200 / 1280 x 1024 / 1280 x 720 / 1024 x 768	
VGA Output	1-ch, Res: 2K (2560 x 1440) / 1920 x 1080P / 1600 x 1200 / 1280 x 1024 / 1280 x 720 / 1024 x 768	
Audio In / Out	1 In / 1 Out	
Alarm In / Out	16 In / 8 Out	
Serial / Network Int.	2 x RJ-45 Ethernet, 1 x RS-232, 1 x RS-485	
USB Interfaces	4 x USB 2.0	
Incoming Bandwidth	320 Mbps or (200 Mbps when RAID is enabled)	
Operating Temp	-10 °C ~ 55 °C	
Power Source	100 ~ 240 VAC, 6.3 A, 50 ~ 60 Hz	
Chassis	19" rack-mount, 3U casing	
Dimensions (mm)	442 (W) x 513 (D) x 155 (H)	
Weight	≤ 18 Kg	



## FD9360-H/FD9367-HTV



- 2-Megapixel CMOS Sensor
- H.265 Compression Technology
- 30fps @ 1920x1080 (WDR Pro on)
- 2.8 mm Fixed Lens / 2.8 ~12mm Vari-focal
- Removable IR-cut Filter for Day & Night Function
- Built-in IR Illuminators, Effective up to 20 Meters
- Built-in 802.3af Compliant PoE
- Built-in MicroSD/SDHC/SDXC Card Slot for On-board Storage
- Supports ONVIF Standard to Simplify Integration & Enhance Interoperability
- SNV (Supreme Night Visibility) for Low Light Conditions
- TSmart Stream II to Optimize Bandwidth Efficiency
- Weather-proof IP66 and Vandal-proof IK10-rated Housing
- Trend Micro IoT Security within Standard Warranty Period



- ### IB9360-H/IB9368-HT
- FEATURES**
- 2-Megapixel CMOS Sensor
  - H.265 Compression Technology
  - 30 fps @ 1920x1080
  - 3.6 mm Fixed Lens / 2.8 ~12mm Vari-focal
  - Removable IR-cut Filter for Day & Night Function
  - Built-in IR Illuminators, Effective up to 30 Meter
  - Built-in 802.3af Compliant PoE
  - Built-in MicroSD/SDHC/SDXC Card Slot for On-board Storage
  - Supports ONVIF Standard to Simplify Integration & Enhance Interoperability
  - Weather-proof IP66-rated and Vandal-proof IK10-rated Metal Housing
  - Smart Stream II to Optimize Bandwidth Efficiency
  - 3D Noise Reduction, Smart IR Technology to Avoid Overexposure
  - Smart IR Technology to Avoid Overexposure
  - SNV (Supreme Night Visibility) for Low Light Conditions



- ### FD9391-EHTV
- FEATURES**
- 8-Megapixel CMOS Sensor
  - H.265 Compression Technology
  - 30 fps @ 3840x2160 (WDR Pro on)
  - 3.9 ~ 10mm Vari-focal Lens
  - 120 fps @ 1920x1080 (WDR Pro off)
  - Smart Stream III to Optimize Bandwidth Efficiency
  - Built-in IR Illuminators, Effective up to 50 Meters
  - Smart IR II Technology to Avoid Overexposure
  - WDR Pro for Unparalleled Visibility in Extremely Bright & Dark Environments
  - SNV (Supreme Night Visibility) for Low Light Conditions
  - Weather-proof IP66-rated, Vandal-proof IK10 and NEMA 4X-rated Housing
  - -50°C ~ 60°C Wide Temperature Range for Extreme Weather Conditions (IR Off)
  - Trend Micro IoT Security within Standard Warranty Period
  - Smart Motion Detection to Reduce False Alarms



- ### IB9391-EHT
- FEATURES**
- 8-Megapixel CMOS Sensor
  - H.265 Compression Technology
  - 3.9 ~ 10mm Vari-focal Lens
  - 120 fps @ 1920x1080 (WDR Pro off)
  - Smart Stream III to Optimize Bandwidth Efficiency
  - Built-in IR Illuminators, Effective up to 50 Meters
  - Smart IR II Technology to Avoid Overexposure
  - WDR Pro for Unparalleled Visibility in Extremely Bright & Dark Environments
  - SNV (Supreme Night Visibility) for Low Light Conditions
  - Weather-proof IP66-rated, Vandal-proof IK10 and NEMA 4X-rated Housing
  - -50°C ~ 60°C Wide Temperature Range for Extreme Weather Conditions (IR Off)
  - Trend Micro IoT Security within Standard Warranty Period
  - Smart Motion Detection to Reduce False Alarms



**12MP 360° Surround View Vandal Fisheye Fixed Dome**

### FEATURES

- 12-Megapixel CMOS Sensor
- 30 fps @ 2816x2816
- Real-time H.265, H.264 and MJPEG Compression (Triple Codec)
- 1.29 mm Panomorph Lens for 180° Panoramic View and 360° Surround View
- Removable IR-cut Filter for Day & Night Function
- 360° 20M IR with Smart IR II
- Panoramic PTZ Function with Speed Dome Camera for Monitoring Detailed Regional View
- WDR Pro (120dB) to Provide Extreme Visibility in High Light Contrast Scenes
- Smart Motion Detection to Reduce False Alarms
- Smart 360 VCA (Intrusion Detection, Crowd Detection, Loitering Detection)
- Trend Micro IoT Security
- Support Client Side Dewarping
- Vandal-proof IK10-rated and Weather-proof IP66-rated Housing

## SD9366-EH



**2MP FullHD 1080p WDR Pro 20x / 30x Zoom Extreme Weatherproof PoE Plus**

### FEATURES

- 2-Megapixel CMOS Sensor
- Real-time H.265, H.264 and MJPEG Compression (Triple Codec)
- 4.3~129 mm Vari-focal Lens (30x zoom)
- 60 fps @ 1080p Full HD
- 30x Zoom Lens
- 250M IR with Smart IR II (Vari-Angle IR)
- WDR Pro for Unparalleled Visibility in High Contrast Environments
- Weather-proof IP66, Vandal-proof IK10 and NEMA 4X-rated Housing
- -50°C ~ 55°C Wide Temperature Range for Extreme Weather
- Conditions (AC 24V/ PoH)
- Smart Stream II to Optimize Bandwidth Efficiency
- EIS
- Easy Cleaning with Built-in Wiper

### SPECIFICATIONS

Model No.	SD9363-EHL	SD9366-EH
Image sensor	2MP 1/2.8" Progressive CMOS	
Video Frame Rates	60 fps @ 1080p Full HD; 60 fps @ 1080p Full HD	
Pan	Pan Range: 360° continuous rotation , Pan Speed 0.05° ~ 450° / sec , Auto Pan Mode	
Tilt	Tilt Range 0° ~ 220° flip , Tilt Speed 0.05° ~ 450° / sec , Auto Patrol Mode	
Zoom	20x Optical Zoom	30x Optical Zoom
Lens / Angle of View	4.7 ~ 94mm / 3° ~ 55°	4.3 ~ 129mm / 2.3° ~ 64°
WDR Technology	WDR Pro	
Shutter Time	1/8 sec to 1/30,000 sec	1 sec to 1/10,000 sec
Video Compression	H.265, H.264, MJPEG, MPEG-4	
Minimum Illumination	0.01 Lux (Colour) / 0.001 Lux (B&W)	
IR Illuminators	150 m	250 m
Networking	10/100 Mbps Ethernet, RJ-45	
Protocols	IPv4, IPv6, TCP/IP, HTTP, HTTPS, UPnP, RTSP/RTP/RTCP, IGMP, SMTP, FTP, DHCP, NTP, DNS, DDNS, PPPoE, CoS, QoS, SNMP and 802.1X	
Alarm and Event Management	Triple-window video motion detection, 3 D/I & 2 D/O for external sensor and alarm, Audio detection	
On-board Storage	SD/SDHC/SDXC card slot, Stores snapshots and video clips	
LED Indicator	System power and status indicator, System activity and network link indicator	
Housing	Weather-proof IP66-rated & NEMA 4X-rated housing	



TAIWAN  
2 YEARS WARRANTY

16/32-ch VAST Inside, Standalone NVR with 16-port 802.3af Compliant PoE

**FEATURES**

- Plug & Play One Button Auto Setup
- EZConnect by Scanning QR Code for 24/7 Mobile Viewing
- Intuitive, Elegant Interaction UI
- 16x 802.3af Compliant PoE Ports
- VIVOTEK Camera Configuration and VAST CMS Integrated
- Live and Playback Fisheye Dewarp
- Embedded Linux OS
- 4x 8 TB Internal Storage, e-SATA for Extension Storage
- Support RAID 0/1/5 Storage
- Story Board Event Search
- ONVIF Open Platform
- Up to 12MP Camera Liveview & Playback

**VAST INSIDE : Vivotek's VAST Central Management Software**



NR9581/9682/9782



TAIWAN  
2 YEARS WARRANTY

32/64/128-ch H.265, VAST Inside, Standalone NVR with Redundant Power

**FEATURES**

- H.265/H.264 Compression Technology
- 32-CH/ 64-CH/128-CH Recording, 1+31 / 64Display
- Support HDMI, Display Port, VGA and DVI Simultaneous Output
- Up to 16 Hot-Swappable HDD Bays, Redundant Power
- Support RAID 0/1/5/6/10 Storage
- Max Support up to 80TB HDD
- VIVOTEK VAST Inside (LiveClient/Playback)
- Dual Lan Giga Network Ports
- ONVIF Open Platform
- VIVOTEK Camera Configuration and VAST CMS Integrated
- Multiple Fisheye Dewarp Support
- Multiple Video Search Modes

**VAST INSIDE : Vivotek's VAST Central Management Software**





## Delivering Peace of Mind

TDSi Management Software & Hardware Equipment



GARDiS Mullion Reader

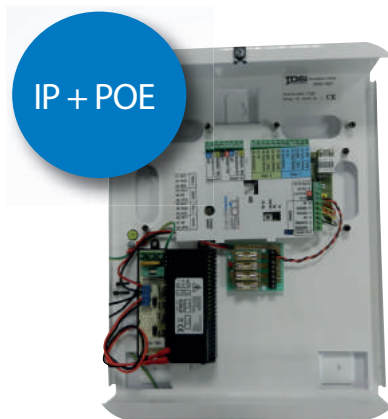

MICROgarde II



GARDiS Square Reader



Software

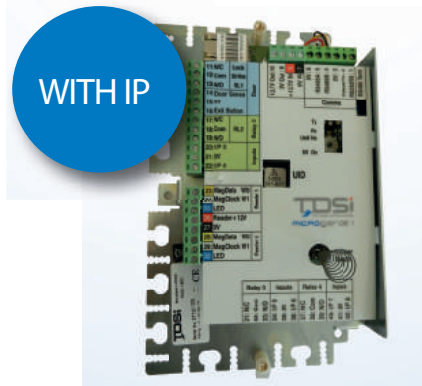

MICROgarde I



Accessories

[WWW.TDSi.CO.UK](http://WWW.TDSi.CO.UK)



Made in the UK



# HOUSING

# HOUSING, BRACKETS & LENSES



**IPH-605/B/HB**  
External/Internal Camera Housing  
IP54 Rating  
1 YEAR WARRANTY



**IPH-606/B/HB**  
External/Internal Camera Housing  
IP66 Rating  
1 YEAR WARRANTY



**IPH-1000/B/HB**  
Professional Heavy Duty Housing  
IP67 Rating  
1 YEAR WARRANTY

## SPECIFICATIONS

MODEL	DIMENSIONS	WEIGHT	DESCRIPTION
IPH-605/B/HB	370 x 115 x 142 (DHW)	1.5Kg	IPH-605 Housing with Optional Blower & Heater
IPH-606/B/HB	405 x 105 x 120 (DHW)	1.3Kg	IPH-606 Housing with Optional Blower & Heater
IPH-1000/B/HB	400 x 110 x 155 (DHW)	2.5Kg	IPH-1000 Professional Heavy Duty Housing with Optional Blower & Heater

# BRACKETS



**IPB-1**  
1 YEAR WARRANTY



**IPB-3**  
1 YEAR WARRANTY



**IPB-5**  
1 YEAR WARRANTY

### SPECIFICATIONS

MODEL	IPB-1
Type	Internal
Dimensions	40 x 100 (L)
Weight	0.1Kg
Max Load	2.0Kg

### SPECIFICATIONS

MODEL	IPB-3
Type	External
Dimensions	100 x 230 (L)
Weight	0.7Kg
Max Load	8.0Kg

### SPECIFICATIONS

MODEL	IPB-5
Type	External
Dimensions	120x72x420(L)
Weight	0.5Kg
Max Load	2.0Kg

### SPECIFICATIONS

2 Megapixel Lens				
Model	Focal Length(mm)	F/No.	Angle of View	Format
IP-1634A	1.6 - 3.4mm	1.4	160° to 98°	1/3"
IP-358M	3.5 - 8mm	1.2	95° to 36°	1/3"
IP-358A	3 - 8mm	1.2	98° to 36°	1/3"
IP-2812A	2.8 - 12mm	1.2	104° to 21°	1/3"
IP-550A	5 - 50mm	1.6	63° to 6.9°	1/3"
IP-585A	5.5 - 85mm	1.7	55° to 2.9°	1/3"



**AUTO IRIS**  
Auto-Iris Camera Lenses  
1 YEAR WARRANTY

## AUTO OR MANUAL IRIS

Generally we tend to use iris lenses externally there are variations in the lighting levels, manual iris lenses are normally for internal applications where the light level remains constant

The Angles in the above tables are taking into account that cameras are furnished with a 1/3" CCD

## PS-301



**3Amp Wall Mount Power Supply**

### SPECIFICATIONS

- Box Size : 203 x 163 x 74mm
- Input Power : 96-264VAC, 47~63Hz
- Output Power : 12VDC±15%
- Output Current : 3Amp Max.
- Standby Battery : 12V 7AH
- Output Short-Circuit Protection
- Output current-limiting and over-voltage protection

1 YEAR WARRANTY

## PS-1009/1218



**CCTV Power Store 10/20Amp 9/16 Way Distribution Box Power Supply**

### SPECIFICATIONS

- Box Size : 205X205X50 mm / 310X205X55mm
- Input Power : 96-264VAC, 47~63Hz
- Output Power : 12VDC±10%
- Peak Value: 12A
- Output Current: 10A/ 20A
- 9/16 Individually fuse protected outputs rated 750mAmp each
- Output current-limiting and over voltage protection

1 YEAR WARRANTY

## ADAPTER

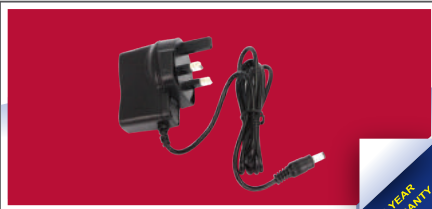

**Model: IP-ADP1.0A**

### Switching Adapter

- 2 Pin AC Switching Power
- Regulated 12V DC
- Light & convenient for use.

Input : ~ 100 - 240V 50/60Hz  
Output : 12V---1Amp  
Regulated Output

1 YEAR WARRANTY



**Model: IP-ADP1.5A**

### Switching Adapter

- 2 Pin AC Switching Power
- Regulated 12V DC
- Light & convenient for use.

Input : ~ 100 - 240V 50/60Hz  
Output : 12V---1.5Amp  
Regulated Output

1 YEAR WARRANTY



**Model: IP-ADP3.0A**

### AC Adapter

- Desktop 3 pin (IEC C6) inlet.
- Over voltage protection.
- Short protection.
- Wide AC input : 90~264 Vac.

Input : ~ 100 - 240V 47-63Ghz  
Output : 12V---3Amp  
Regulated Output

1 YEAR WARRANTY

## HIGH QUALITY VIDEO CABLES



**Model: IP-20M/40M**

**20 / 40 metres Standard Plug and Play Cables**



**Model: IP-100M/300M/DC**

**100/300 metres Video/Power RG59 DC Cable**

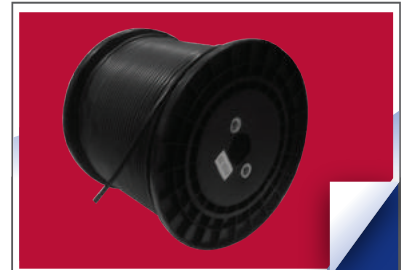

**Model: IP-300M/500M/RG59**

**100/ 300/500 metres Video Signal RG59 Cable**

## ALARM CABLE



**Model: IP-100M/4C**

**100 Metres Reel - 4 Core**



**Model: IP-100M/8C**

**100 Metres Reel - 8 Core**

## NETWORK CABLE

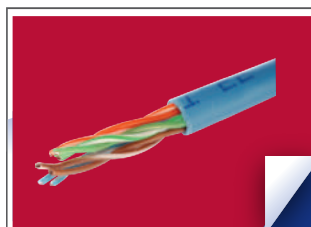

**Model: IP-305M/CAT5e**

**305 Metres - CAT5E**

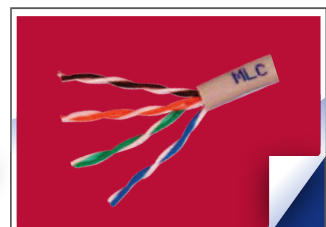

**Model: IP-305M/CAT6**

**305 Metres - CAT6**

# KADEX READER

# BIOMETRIC ACCESS CONTROL TIME & ATTENDANCE

**Access Control & Time Attendance Card Reader System**

- ### FEATURES
- Standalone compact all in one access control reader, access by PIN or RF Card
  - Easy and fast enrollment of up to 30,000 cards
  - LCD Screen and easy to use menu
  - Flush mount, cables enter from rear
  - Includes IPTime Software and software licence
  - Connection through TCP/IP or USB Flash Disk (supplied)
  - 26 bits Wiegand input/output anti-passback feature together with 50 Times Zones with 5 groups to control accessibility.
  - Powerful Time Attendance Software: IPTime Time Control
  - Management System software is bundled with every reader to provide effective human resource data management

SPECIFICATIONS	KADEX READER
Surface Finishing	(ABS) & (PC)
Type Of Scanner	Non coated optical scanner
Microprocessor	360 MHz
Memory	128 MB flash memory & 16 MB SDRAM
Algorithm	BioBridge VX 10.0
Dimension	184 x 38 x 134 mm
Fingerprint / Transactions	2000 / 80000
Cards	Made to order
Enrollment Methods	Password & RFID card
Recommended Fingerprint	Per user ID
Card Technology	RFID, MIFARE
Communications	TCP/IP, USB disk
Power input	DC 12V
Siren, Work codes, Greeting Voice	Yes
Display	2.8" 3k color TFT screen
Short messaging	Yes
Internal backup battery	Yes (2-hours working, 4-h)

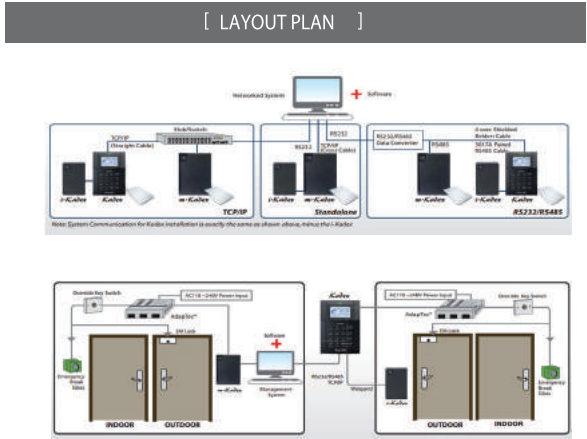

## Face ID 2

**2-in-1 Face & Fingerprint Recognition Terminal**

- ### FEATURES
- Mighty Face Recognition Technology
  - Have additional 3 other powerful clocking options, including precise fingerprint verification of up to 10,000 templates, 10,000 cards (RFID Default and Optional Mifare and HID) & password.
  - Contactless at its best, you just need to go near Face ID 2 to activate the camera
  - Face ID2 is loaded with 1.2GHz microprocessor, possessing the speed equivalent to most of the best smartphones around
  - Loaded with a sizeable 128 MB flash memory & 128 MB SDRAM capacity that supports up to a whopping 200,000 transactions
  - Supports TCP/IP, RS232, RS485, USB disk, providing versatility to data communication and transfer
  - Supports Wifi, GPRS and 3G optional modules for wireless communication
  - Compatible with cloud-based solution for time attendance, TimeTec TA
  - Packed with 2000mAH Large capacity Lithium-ion Battery for a fully operation device for approximately 4 hours in case of any power interruptions

SPECIFICATIONS	Face ID 2
Surface Finishing	Acrylonitrile butadiene styrene (ABS) & acrylic
Type Of Scanner	Hi-res infrared camera & fingerprint scanner
Microprocessor	1.2GHz
Memory	128MB Nand flash & 64MB Nand flash
Algorithm	Face BioBridge VX8.0, Fingerprint BioBridge VX9.0 / 10.0
Dimension	194 x 110 x 145 mm
Fingerprint / Face/ Card/ Transactions	10000 / 1200 / 10000 / 200000
Card Technology	RFID, MIFARE, HID
Enrollment Methods	Face (1:1, 1:N), fingerprint (1:1, 1:N), card & password
Recommended Fingerprint	2
Verification time (sec)	Face < 2, Fingerprint < 1
Communications	TCP/IP, RS232, RS485, USB disk, (Optional WIFI & 3G)
Power input	DC 12V
Display	4.3" 65K color TFT touch screen panel

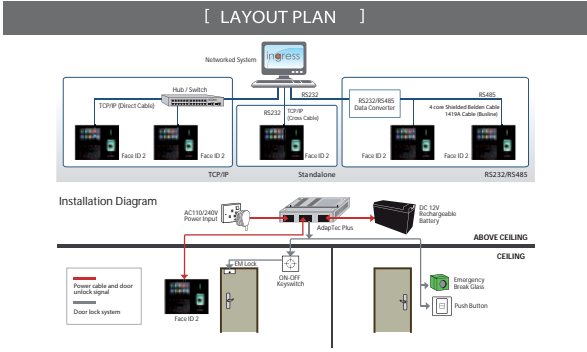

# BIOMETRIC ACCESS CONTROL TIME & ATTENDANCE

TA-500

## FEATURES

**Plug and Play :** TA500 is easy to operate, connect it to the power source and it's ready to roll! Comes with in-built battery, you can make it portable for your convenience.

**Easy Data Management :** IP communication and USB Flash disk are available for your choice of connectivity

**Versatile and Secured Verification :** TA500 gives you a variety of verification options such as fingerprint, password or card, or combination of options, providing you security and versatility you need.

**Intuitive Navigation:** Equipped with colored screen LCD and intuitive icons, navigation in TA500 is made simple.

**Sturdy Exterior:** Made from robust materials, TA500 can stand the wear and tear for years to come and it comes with 3 years limited warranty.

**Small in Size, Large in Storage:** The compact TA500 can contain up to 2,000 fingerprints and 80,000 transaction logs, more than sufficient for your office requirements.

**Manage Your Data Easily :** TCMS V3 is loaded with useful features complete with various reports for your business. Its data integration to 3rd party software is made available through the readily available SDK.

[ LAYOUT PLAN ]

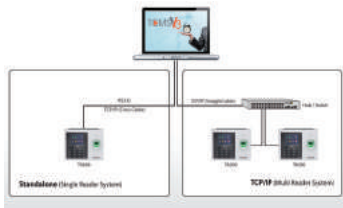

## Fingerprint, Code, Time & Attendance

SPECIFICATIONS	TA-500
Type Of Scanner	Non coated optical scanner
Microprocessor	360 MHz
Memory	128 MB flash memory & 16 MB SDRAM
Algorithm	BioBridge VX 10.0
Dimension	184 x 38 x 134 mm
Fingerprint templates	2000
Transactions	80000
Enrollment Methods	Fingerprint & password (Optional RFID card)
Recommended Fingerprint	Per user ID
Card Technology	RFID, MIFARE
Communications	TCP/IP, USB disk
Operating Temperature (°C)	0 ~ 45
Power input	DC 12V
Display	2.8" 3k color TFT screen

## FEATURES

- **Multiple Verification Methods:** From fingerprint to card and password verification, R3 provides the possibilities. Optimize your security threshold, with fingerprint verification as your primary enrolment form.
- **Precise Recognition with Biometrics:** R3 utilizes minutiae matching technology that ensures only enrolled users are granted access, eradicating buddy punching scenarios.
- **Comprehensive Access Solution:** Complement your R3 access control terminal with a R2c slave exit reader for a complete door-in and door out experience.
- **High Definition Color Display and Touch Panel :** Combining vibrance and function in a single stroke, our 2.4" color LCD and touch panel is bound to please in terms of aesthetics and function.
- **Data Management Simplified:** R3 is equipped with TCP/IP connectivity and when that is not available, a USB flash drive is available to transfer transaction logs into your computer.
- **Built In Alarm:** R3 allows installation of external alarm to your access system to alert you during emergencies and break-ins. Secure your premise with GroupTimeZone and Group Verify functions.



## Fingerprint, Card, Code, Access Control, Time & Attendance

SPECIFICATIONS	R3
Type Of Scanner	Optical fingerprint scanner
Microprocessor	400 MHz
Memory	32MB SDRAM   256MB Flash & 32MB SDRAM
Algorithm	BioBridge VX 10.0
Dimension	78 x 32 x 190mm
Fingerprint templates	3000
Cards	10000
Enrollment Methods	Fingerprint (1:1, 1:N), card or password
Recommended Fingerprint	per user ID 2
Card Technology	RFID, MIFARE:
Communications Method	TCP/IP, RS232, RS485, Flash disk
Power input	DC 12V 3A
Display	2.4" 3k color LCD



## Q2i

**Fingerprint, Code, Card, Access Control, Time & Attendance**

**1 YEAR WARRANTY**

# BIOMETRIC ACCESS CONTROL TIME & ATTENDANCE

SPECIFICATIONS	Q2i
Surface Finishing	Acrylonitrile Butadiene Styrene (ABS)
Type Of Scanner	Optical
Microprocessor	800 MHz
Memory	256MB flash memory and 64MB SDRAM
Algorithm	BioBridge VX 9.0 / VX 10.0
Dimension	200 x 56 x 160mm
Fingerprint templates	10000
Transactions	200000
Enrollment Methods	Fingerprint (1:1, 1:N), Card & Password
Recommended Fingerprint	per user ID 2
Fingerprint placement	Any angle
Card Technology	RFID, MIFARE:
Communications Method	TCP/IP, RS232, RS485, USB (Opt: WiFi, GPRS & 3G)
Baud rates	9600, 19200, 38400, 57600, 115200
Wiegand	26-bit input/output
Operating Temperature (°C)	0 ~ 45
Humidity (%)	20 ~ 80
Power input	DC 12V 3A
Siren	Yes (relay output)
Work codes	Yes
Greeting Voice	Yes
Display	3.5" 65k color TFT screen
Short messaging	Yes
EM-Lock Driving Output	12VDC/Relay output
Alarm output	Yes (NO & NC)
Antipassback	Yes

### OVERVIEW

FingerTec's Q2i & TA200 Plus are astounding hi-tech fingerprint time attendance and door access devices with an impressive design. With an exceptional storage capacity and equipped with the latest precision fingerprint scanning algorithm, the Q2i & TA200 Plus give you some amazing and convenient features such as work codes and short message display for either personal or public recipients for effective staff communication. The terminals also come with many options and methods for you to sync your terminal to the bundled software, FingerTec's TCMS V2 for further processing of attendance data to ease report generating and payroll processes.

## Ingress I/II/IV

**The Perfect System For Advanced Access Control**

**2 YEAR WARRANTY**

# THE PERFECT SYSTEM FOR ADVANCED ACCESS CONTROL

SPECIFICATIONS	Ingressus I	Ingressus II	Ingressus IV
Main Features	Door opening time (0-999s), Inter-locking (Ingressus II & IV only), Anti-pass back (Local only), Multi card unlocking, First card unlocking, Time zone (50), Holiday time zone, Permanent door release/lock time zone, Day light saving time zone,		
Security Features	Door force open alarm, Door open time out alarm, Fire linkage, Duress alarm, Door status and event (51 types)		
Ingress	Bundled		
Communications	TCP/IP, RS485		
Fingerprints	3000		
Cards	30000		
Passwords	30000		
Transactions	100000		
Quantity of terminal	2 x 26-bit Wiegand input. Each for 1 slave terminal (1 x RS485 input to support RS485 network) (max 2 units)	4 x 26-bit Wiegand input. Each for 1 slave terminal (1 x RS485 input to support RS 485 network) (max 4 units)	4 x 26-bit Wiegand input. Each for 1 slave terminal (1 x RS485 input to support RS 485 network) (max 8 units)
Quantity of terminal	2	4	4
Push release button	1	2	4
Door sensor	1	2	4
AUX	1	2	4
Types of AUX input supported	Motion detector, passive DIR detector, curtain passive infrared detector, pet immunity PIR detector, two beam digital active infrared detector, heat detector		
Door lock (12VDC 10A form C relay)	1	2	4
AUX output (30VDC 2A form C relay)	1	2	4
Types of AUX output supported	Gas detector and compatible sensors, Piezo strobe siren, electronic siren		
Operating temperature (°C)	0 - 55		
Operating humidity (%)	10 - 80		
CPU	32-bit, 400MHz		
Flash memory (MB)	128		
SDRAM (MB)	32		
Polarity protection	Yes		
Power input	12V DC		

### OVERVIEW

FingerTec's Ingress is an integrated access control management application that runs on the familiar MS Windows operating environment. The software is a complete solution for centralizing, managing, and monitoring door activity in FingerTec access control devices. Bundled together with the Ingressus Controller, Ingress is an advanced, easy to use, and IT-friendly software that provides elaborate access control features such as real-time monitoring, database administration and report management, all in a single unified system. Ideally suited for self-managed organizations of below 100-door environment, Ingress is also capable of seamlessly integrating its access control functions with alarm monitoring and other intrusion detection devices.

# BIOMETRIC ACCESS CONTROL PANEL

## InBio-460



**InBio-160 : 1 Door (In/Out)**  
**InBio-260 : 2 Doors (In/Out)**  
**InBio-460 : 4 Doors (In/Out)**

**Advanced Biometric Access Control Panel**

**1 YEAR WARRANTY**

**OVERVIEW**

IPBIO400 a new concept access controller based on biometric identification aims to improve the security of users' life and information. It is specially designed for applications like home, offices & enterprises, users may choose from serial communication or Ethernet to get linked to software for central management. The distance between controller & RS485 readers could be more than 800m. IPBIO400 is very convenient and safe for users to connect other security products for its groove socket, even quietly brilliant to see its working status through LED indicators on surface. Web-based management helps know about the local events on e-map & video remotely in real time.

**FEATURES**

- Flexibility to apply different Readers.
- Truly Internal Biometric Identification.
- External SD-Card support & 5 LED Indicators inside housing.
- Interlock, Anti-Pass Back, First Card Opening, Multi-Card Opening, Duress Password & Fingerprint, Remote Monitoring & E-Map Linkage.
- Dual Communication Mode (TCP/IP mode & RS485 mode).

SPECIFICATIONS	InBio-460
Processor	: 32bit MIPS CPU, 32M bits RAM, 128M bits Flash Memory
Fingerprint Capacity	: 3,000
ID Card Capacity	: 30,000
Backup	: SD Memory Card
Wiegand Reader Port	: 4 x (26bit Wiegand, 8bit Burst for PIN)
RS485 Reader Port	: 1 x Extended RS485 Port
Communication	: RS485, TCP/IP
Input Port	: 8 ( 4 x Exit Buttons ; 4 x Door Sensors )
Output Port	: 4 x (4 FORM-C Relay Output) 4 x (4 Aux FORM-C Relay Output)
LED Indicator	: LED indication for communication, power, status & card
Software	: ZKAccess 5.0 (Web-based) ; ZKAccess 3.5 (Standalone)
Housing Material	: PVC
Operating Temp	: 0° C ~ 55° C
Dimension (mm)	: 106 (L) x 226 (H) x 36 (D)
Power Supply	: DC 9.6V-14.4V, Rated Max.1A

**OPTIONAL ACCESSORIES**



IP1200    IP4500    IP600E    IP602E    Power Supply    SD Card    Electric Lock    RS232/485 Converter    Alarm

**IPBIO™ 250**



**Standard Biometric Digital Door Lock**

**1 YEAR WARRANTY**

MALAYSIA

Fingerprint  
Pin Code  
MECHANICAL KEY  
BATTERY 1.5V

**FEATURES**

- Secured locking methods: Features three types of secured lociang methods which include fingerPrint, password and mechanical key for better protection.
- Advanced sensor technology: Keylock deploys the cutting edge matching fingerprint technology to ensure reliability to every fingerprint reading.
- Scanner Protection: Keylock is equipped with a cover which slides upward to protect the scanner from dust, moist, and weather effects, for a longer lasting and a more reliable scanner.
- Robust Structure: Keylock employs nanotechnology and its pure stainless steel mechanical rotating structure can make it lasts for 10 years under normal usage.
- Easy Installation: No additional hole is required to install Keylock, as it utilizes the existing doorknob hole available.
- Battery Lifetime: Only four 1.5V standard alkaline batteries needed and with its energy saving design, the batteries can last up to 15,000 unlocking activities under normal use.
- OLED display screen with visual menu



[www.ipotecworld.com](http://www.ipotecworld.com)

Professional Security Products

# ST-520

# IPTEC BIOMETRIC ACCESS CONTROL PANEL



**Standalone RFID / Pincode Access Control**

- SPECIFICATIONS**
- Mini Standalone Access Control
  - Vandal Resistant
  - Access by PIN code / RF Card
  - Keypad with Backlight
  - Dual Relay outputs
  - Built-in (LDR) Pick-Proof Alarm Function
  - 1000 Card capacity
  - Suitable for Internal / External use
  - Read Range 5-10 cms
  - Dimensions (mm) : 123L x 22H x 79W
  - IP Rating - IP67

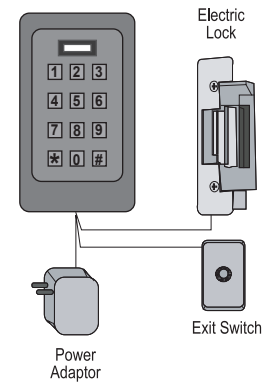

# ST530



**Standalone RFID / Pincode Access Control**

- SPECIFICATIONS**
- Mini Standalone Access Control
  - Weatherproof & Vandal Resistant
  - Access by PIN code / RF Card
  - Keypad with Backlight
  - Dual Relay outputs
  - Built-in (LDR) Pick-Proof Alarm Function
  - 1000 Card capacity
  - Wiegand(Optional)
  - Suitable for Internal / External use
  - Read Range 5-10 cms
  - Dimensions (mm) : 152L x 24H x 45W

**CONNECTIONS**

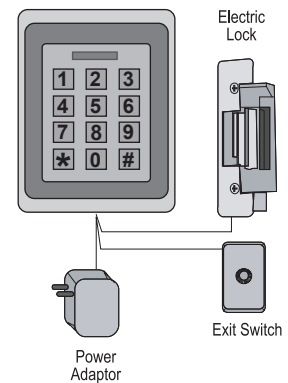

# ST-531/ ST-532



**Standalone RFID / Pincode Access Control**

- SPECIFICATIONS**
- With internal EM reader.
  - Frequency: 125KHz.
  - Effective distance: 5cm.
  - ZONE 1: up to 1000 passwords & card holders. ZONE 2: up to 10 passwords OR card holders.
  - Card access, code access and combined access.
  - Digital keypad operation.
  - Built-in pickproof function.
  - Watchdog timer, powerful reboot and self-recovery. Watchdog can connect with the external unlock button.
  - Dual relay outputs.
  - Unlock output delay time: 0-99s.
  - IP rating: 65.
  - Dimension: 150.44'24mm.
  - Dual relay outputs for door opening, door stat detecting, open door by button. The function of door status detecting is for ZONE 1 only.



**Standalone Fingerprint / RFID / Pincode Access Control**

**1 YEAR WARRANTY**

### SPECIFICATIONS

- Standard ID Card while Mifare card as optional feature.
- Upto 2000 Card Capacity
- Upto 200 Fingerprint Capacity
- Password capacity up to 8 groups
- 1 touch 1-second user recognition
- Reads Fingerprint / Password / Card
- Rugged and elegant design
- For : 3rd Party Electric Lock, Alarm, Door Sensor, Exit Button & Doorbell
- Dimensions (mm) : 88 L x 33.6 H x 88 W

### PRINTABLE PROXIMITY CARDS

**SC-10**

**SC-20**



- Read Range : 15-25 cm
- Can be printed (SC-10)
- ISO Standard Card
- Thickness : 0.8 mm (SC-10)
- Thickness : 1.8 mm (SC-20)



## BIOMETRIC ACCESS CONTROL & TIME ATTENDANCE

### iFace 900



**Facial Scanning, Pin Code, RFID, Time & Attendance / Access Control**

**2 YEARS WARRANTY**

### FEATURES

- 3,000 face and 4,000 fingerprint templates
- 4.3" TFT color touch screen display
- Multi-languages
- High verification speed
- Advanced and user-friendly UI
- Chip encryption for firmware protection
- Optional built-in battery backup providing approximately 4 hours of continuous operation
- Easy to extend functions and customize client's requirements
- One face template is registered for one user only

### SPECIFICATIONS

#### iFace 900

Face Capacity	: 3000 templates (1:N)
Fingerprint Capacity	: 4,000 templates
ID Card capacity	: 10,000 (Optional)
Display	: 4.3" TFT LCD Touch Screen
Logs Capacity	: 100,000
Communication	: TCP/IP, RS232/485, USB host.
Time Attendance	: Photo ID, Auto Status Switch, Standard Functions
Standard Functions	: Automatic Status Switch, Self-Service Query, Work Code SMS, DST, T9 Input, 9 Digit User ID, Scheduled Bell, Photo ID, ADMS
Access Control Interface	: 3rd Party Locks, Door Sensor & Exit Button
Power Supply	: DC12V%
Dimensions	: 193.6 (W) x 165.2 (H) x 111 (D)

### LAYOUT PLAN DIAGRAM

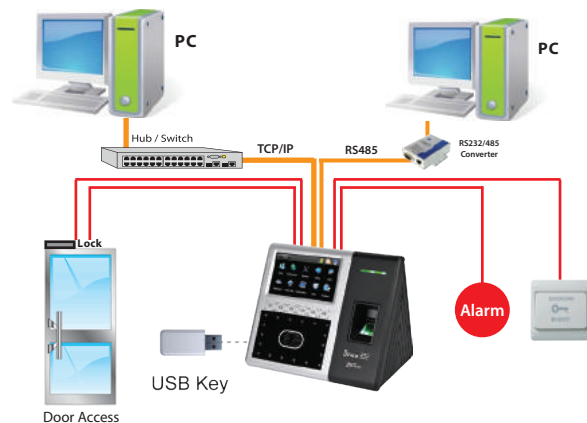

### OVERVIEW

iFace900 Multi-Biometric T&A and Access Control Terminal which supports 3,000 face templates, 4,000 fingerprint templates and 10,000 cards. It is equipped with ZKTeco latest hardware platform and algorithm, which provide clients with a brand new UI and user-friendly operating interface, bringing them a smooth using experience. With the advanced face algorithm and multi-biometric verification technology, the terminal's security level of verification is greatly enhanced.





F18

# BIOMETRIC ACCESS CONTROL & TIME ATTENDANCE



## Fingerprint Standalone Access Control

2 YEARS WARRANTY

### OVERVIEW

F18 is an innovative biometric fingerprint reader for access control applications, offering unparalleled performance using an advanced algorithm for reliability, precision and excellent matching speed. It features the fastest commercial-based fingerprint matching algorithm and ZK high-performance, high-image quality optical fingerprint sensor. The device offers the flexibility to be installed standalone or with any third party panel that supports 26-bit Wiegand. All the operation can be done on the TFT-LCD. The fingerprint image will display on the screen. That will guide the user to put the finger on to proper position and increase the recognition rate.

### FEATURES

- Fingerprint reader with durable and highly accurate ZK optical sensor
- 1 touch a-second user recognition
- Stores 3,000 templates, 5,000 cards and 30,000 transactions
- Reads Fingerprint and/or Card
- Optional integrated smart card reader
- Built-in Serial and Ethernet ports
- Tamper-proofs switch and alarm outputs
- Request-to-exit and alarm contacts
- Audio-Visual indications for acceptance and rejection of valid/invalid fingers

### SPECIFICATIONS F18

Fingerprint Capacity	: 3000 templates
ID card Capacity	: 5000
Transaction Capacity	: 30,000
Sensor	: ZK Optical Sensor
Algorithm Version	: ZK Finger v10.0
Communication	: RS232/485, TCP/IP, USB-host
Access Control Interface	: for 3rd party electric lock, door sensor, exit button, alarm, Door Bell
Wiegand Signal	: Output and Input
Display	: TFT LCD Screen
Standard function	: ID card, Webserver, DLST
Optional function	: Mifare card
Power Supply	: 12V DC 3A
Operating Temperature	: 0°C ~ 55°C
Operating Humidity	: 20% ~ 80%
Dimension (mm)	: 76 (W) x 180 (H) x 44 (D)

### LAYOUT PLAN DIAGRAM

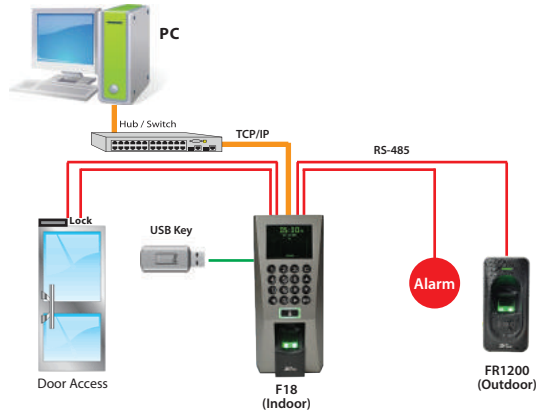

TF1700



## Waterproof Fingerprint Standalone Access Control

2 YEARS WARRANTY

### OVERVIEW

TF1700, one of the world's smallest IP-based fingerprint terminals used for access control and time attendance features. With its IP65 rated rugged structure, It offers extra durability in all weather conditions including outdoor environments. It is specially designed for standalone applications such as house, office, shop, garage, factory, etc.

- Rugged structure for outdoor installation and extra durability
- Slim and elegant design
- One of the world's smallest fingerprint terminals
- Fast and accurate fingerprint algorithm
- 1:3000 fingerprint identification in 1 sec
- Stores 2,200 fingerprint 10,000 cards & 30,000 transactions
- USB-host
- Full access control features
- Access control interface for 3rd party electric lock, door sensor, exit button
- Webserver
- Anti-passback setting
- Work without computer
- Graphic LCD and buzzer
- 3x5 keypads and doorbell

### SPECIFICATIONS TF1700

CPU	: 400MHz
Memory	: 128MB flash + 32MB RAM
Fingerprint Sensor	: 500 DPI optical sensor
Algorithm Version	: ZK Finger v10.0
Communication	: TCP/IP, RS485, USB-host
Fingerprint Capacity	: 2,200 fingerprints
Log Capacity	: 30,000 events
RF Card	: EM (Standard) / Mifare (Optional)
Authentication	: Finger Print / PIN Code / RFID Card
Wiegand Signal	: Inputs & Outputs
IP Rating	: IP65
LCD	: 128 x 64 OLED with white & black color
Keypad	: 3 x 5 keypads & doorbell
Sound	: Buzzer
Operating Temp	: -20° C ~ 55° C
Dimension (mm)	: 62.5 (W) x 185 (H) x 41.5 (D)
Power Supply	: 12V DC 3A

### LAYOUT PLAN DIAGRAM

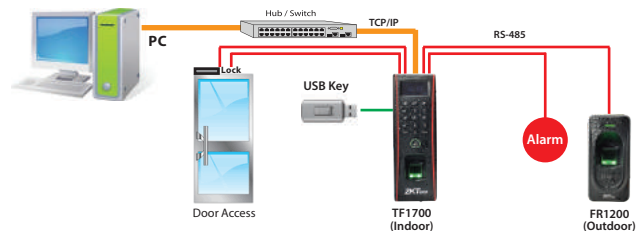

### OPTIONAL ACCESSORIES

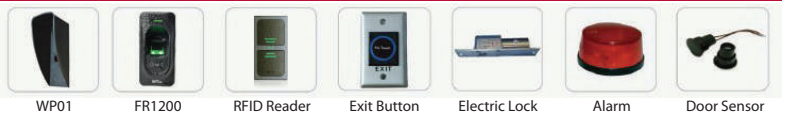

www.ipotecworld.com

ZKTeco®

Professional Security Products

**HL-100**



**Material : Stainless Steel**  
**Size : 242(L) x 78(W) x 26(H) mm**

3 YEARS WARRANTY

**HL-180**



**Material : Zinc Alloy**  
**Size : 283(L) x 73(W) x 17(H) mm**

3 YEARS WARRANTY

**HL-300**



**Material : Stainless Steel**  
**Size : 262(L) x 60(W) x 26(H) mm**

3 YEARS WARRANTY

**HL-360**



**Material : Zinc Alloy**  
**Size : 203(L) x 78(W) x 28(H) mm**

3 YEARS WARRANTY

**HL-400**



**Material : Zinc Alloy**  
**Size : 260(L) x 70(W) x 28(H) mm**

3 YEARS WARRANTY

**HL-500**



**Material : Zinc Alloy**  
**Size : 260(L) x 68(W) x 26(H) mm**

3 YEARS WARRANTY

**HL-CKS-100**



**Intelligent Hotel Card Key Switch (Energy Saver)**

3 YEARS WARRANTY

**HL-EN-100**



**Encoder with USB (Read & Write Mifare card)**

3 YEARS WARRANTY

### FEATURES

- Standalone electronic lock with 13.56MHz Mifare technology
- Elegant design that fit any type of hotel
- U.S. Mortise with 5 latches
- Robust housings with zinc alloy or stainless steel
- CE, FCC approved
- Low battery voltage warning
- 20,000 unlocking activities for one new battery pack
- Unlock with an emergency mechanical key

### TOTAL SOLUTION

- Hotel management software (included)
- Mifare card encoder - HL-EN100
- Card Key Switch (Energy Saver)- HL-CKS100

### SPECIFICATIONS

#### MAIN

Material	Zinc Alloy or Stainless Steel
Mortise	U.S.Mortise with 5 latches
Type of Card	13.56MHz Mifare
Encoder	Model No. HL-EN100

#### SOFTWARE

Type	Hotel Management Software
Operating System	Windows XP / Vista
Power Input	4 x 1.5V AA Battery
Low Battery Warning Volt.	< 4.8V

#### ENVIRONMENT & VERIFICATION

Temperature	0°C ~ 45°C
Humidity	20% ~ 80%
Backup Unlock Mechanism	Mechanical Key

### MIFARE CARD HOTEL LOCK SYSTEM PROCESS



Mifare Card received at Hotel Reception Desk



Tap the Mifare Card on the Door Lock to open the door



Put the Mifare Card in Hotel Card Key Switch (Energy Saver)

# MC-DL3

# ACCESS CONTROL LOCKS

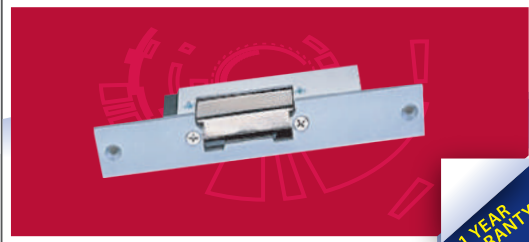

Strike Lock for Access Control

1 YEAR WARRANTY

### FEATURES

#### MC-DL3 Strike Lock (Wooden Door Striker)

- Power Supply : DC 12V
- Operation Current :360mA
- Fail-secure type : (Power to Unlock)  
Suitable for wooden, aluminium, and hollow metal doors.

# LBH-800C-N

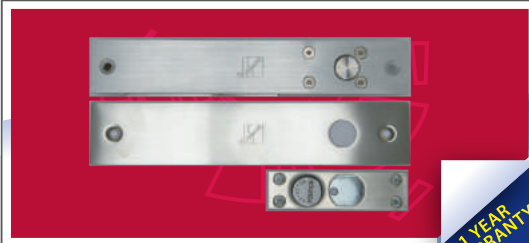

Electric Door Sensor Dropbolt

1 YEAR WARRANTY

### FEATURES

#### LBH-800C Door Sensor Dropbolt Fail Safe

- Application : Glass, Wooden, Aluminum Doors
- Description : Body : 230L x 34W x 42D mm  
Face Plate : 230L x 34W x 3D mm  
Cover Plate : 115L x 30W x 3D mm  
Bolt Diameter : 15.5mm
- Voltage : DC12V
- Start : 0.9A / Standby : 0.3A
- Time Delay : 0-2 to 5 sec

### DIAGRAM

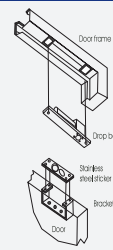

# LBH-600-N

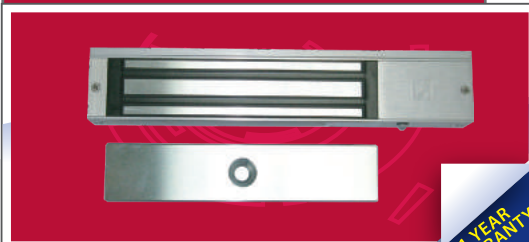

600 LBS Electromagnetic Lock with Door Sensor

1 YEAR WARRANTY

### FEATURES

#### LBH-600 - 600 LBS Door Sensor Electromagnetic Lock, Fail Safe

- Application : Glass, Wooden, Aluminum Doors
- Description : Body : 250L x 47W x 27D mm  
Magnet : 185L x 38W x 12.5D mm  
Holding: 600LBS  
Voltage : DC12V / DC24V
- Power Consumption : 12V/480mA

### DIAGRAM

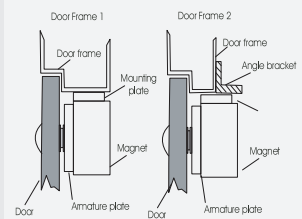

# LBH-602S

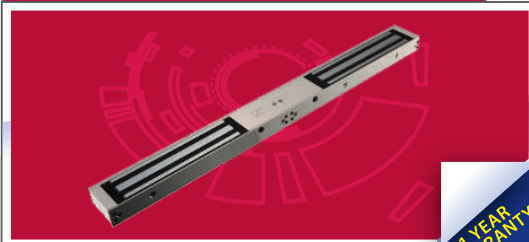

600 LBS Electromagnetic Lock with 2-Door Sensor

1 YEAR WARRANTY

### FEATURES

#### LBH-602S - 600 LBS Door Sensor Electromagnetic Lock, Fail Safe

- Application : Glass, Wooden, Aluminum Doors
- Description : Body : 500L x 47W x 27D mm  
Magnet : 185L x 38W x 12.5D mm  
Holding: 600LBS  
Voltage : DC12V / DC24V
- Power Consumption : 12V/480mA

### DIAGRAM

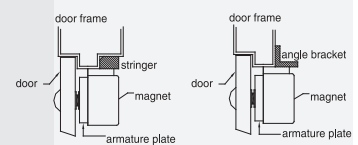

# LBH-1200



1200 LBS Electromagnetic Lock with Door Sensor

1 YEAR WARRANTY

### FEATURES

#### LBH-1200 - 1200 LBS Door Sensor Electromagnetic Lock, Fail Safe

- Application : Glass, Wooden, Aluminum Doors
- Description : Body : 260L x 73W x 41D mm  
Magnet : 220L x 52W x 11D mm  
Holding: 1200LBS  
Voltage : DC12V
- Power Consumption : 12V/480mA

### DIAGRAM

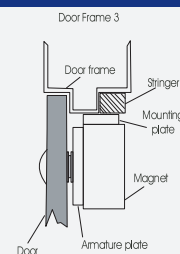



L Bracket for Inward opening Mag Lock

1 YEAR WARRANTY

### FEATURES

#### LBH-121L L Bracket for Inward opening mag lock for LBH-600.

- Application : Inward opening using L Bracket
- Description : Magnetic fitting for inward opening door

#### LBH-123L L Bracket for Inward opening mag lock for LBH-1200.

- Application : Inward opening using L Bracket
- Description : Magnetic fitting for inward opening door

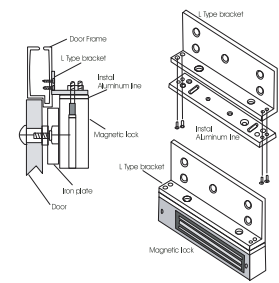

## LBH-122U-N



U Bracket for Glass Door Frameless

1 YEAR WARRANTY

### FEATURES

#### LBH-122U Bracket for Glass door frame

- Application : Glass Fixing U Bracket
- Description : Magnetic fitting for frameless glass door

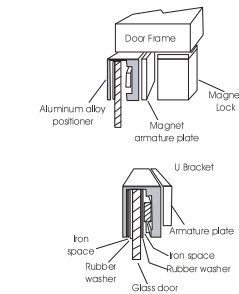

## LBH-701UD-N



D Bracket for Glass Door

1 YEAR WARRANTY

### FEATURES

#### LBH-701UD D Bracket for Glass Door

- Application : Drop Bolt Bracket for Glass Door with Glass Frame to be used with BHL-700C Drop Bolt

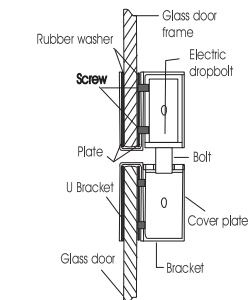

## Exit Buttons



Exit Button Access Control

1 YEAR WARRANTY

### FEATURES

#### PBP-103 Exit Push Button (Plastic)

- Application : N.O. / Com Push button for use with Access Control Door Locking Systems
- Dimensions : Inner Face : 86L x 86W x 32D mm / Outer Face : 100L x 60W x 8.2D mm

#### PBM-101 Exit Push Button (Metal)

- Application : Stainless steel button made of aluminium alloy for use with Access Control Door Locking Systems
- Dimensions : Inner Face : 60L x 60W x 8D mm / Outer Face : 80L x 80W x 8D mm

#### EMB-109 Emergency Exit Door (Green)

- Application : For integrated fire control device
- Dimensions : 97L x 91W x 55D mm

#### PBM-202 No Touch Infrared Sensor (Metal)

- Application : Exit button for electric lock at back of the door
- Dimensions : Inner Face 55L x 45W x 30D mm / Outer Face : 86L x 86W x 5D mm





**32 input Wireless Control Panel with PyronixCloud & HomeControl+ App**

### Features

- Two Way Wireless Technology
- Easy HomeControl+ app intergration
- Instant Two way Device Control (ITDC)
- Signal Strength Indicator (SSI)
- Pyronix High Security two way wireless data encryption Protocol (TDE)
- Programmable wireless supervision time
- Pyronix intelligent jamming detection
- Pyronix High Security Wireless Device Encryption
- One Push To Learn
- Battery Monitoring/Saving
- User Friendly Keyfobs
- User Automation Outputs
- SMS Text Notifications and Remote Control

### Specifications

- 4 Areas
- 32 Wireless inputs
- 2 Wired inputs (expandable to 34)
- 3 Wired outputs (expandable to 19)
- 80 User codes
- Up to 19 User Automation Outputs
- 32 wireless keyfobs with individual user ID
- Up to 3 Wired Keypads/Readers
- In built proximity reader
- 750 Event log with time and date
- 12V Auxiliary output
- Back up battery time 12 hours
- 868MHz Transceiver FM technology
- Supports PyronixCloud & HomeControl+ App
- Pyronix two way wireless technology
- Dimensions: 220x160x50mm / Weight: 1025g

The Enforcer 32-WE/APP is a wireless alarm system that has been designed with your security in mind; with quick and easy installation & minimal maintenance, the Enforcer 32-WE/APP protects your home with a multitude of unique features. Taking full advantage of Pyronix's innovative two way wireless technology, the wireless devices on the Enforcer 32-WE/APP system are constantly communicating with each other, using the Pyronix High Security Wireless Encryption Protocol. The Enforcer 32-WE/APP two way wireless devices are fully operational when the system is armed, making your system more secure, compared to other wireless systems, where devices are disabled for up to five minutes after every activation to save battery, therefore compromising your security. Using the HomeControl+ App linked with the PyronixCloud, your customers can control their security system from anywhere in the world. It has been engineered by Pyronix as a secure, reliable and easy to use wireless alarm system.

### WIRELESS ACCESSORIES



**DELTABELL-WE**  
External Siren with strobe and option of 12V AC/DC supply



**SMOKE-WE**  
Smoke Sensor



**KX12DT-WE**  
Dual Technology Detector



**WL-WE**  
Water Leak Sensor (supplied with cable)



**SHOCK-WE**  
Shock Sensor (also available in brown)



**RS2-WE**  
2 Channel (input) Universal Transmitter with Roller Shutter and Magnetic Contact Function

## EURO MINI

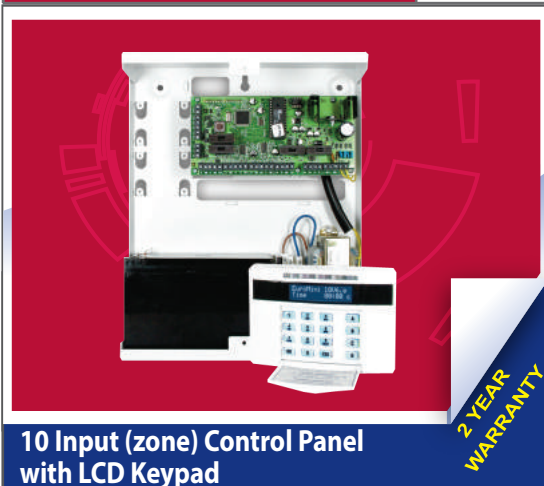

**10 Input (zone) Control Panel with LCD Keypad**

### Features

- Might in Miniature
- 10 DEOL inputs (zones) OR (9 Double Pole + 1 Tamper) Input
- Up to 7 programmable outputs
- On-board diagnostics
- Intelligent set
- 1A Power supply
- Prox keypad (option)
- 30 User codes
- 700 System Time & Date logs

### Specifications

Maximum Inputs	10
- EOL	10 on end station
- Double pole	9 on end station
Maximum Outputs	7
Set / unset	Pin
- Keypad type	LCD Keypad
- Keypads	Max. 4
- Readers	Max. 3 (mini prox)
User codes	30
- Areas	4 part sets
System logs	700
PSU	1A
EN Grade	2x
Casing Size (mm)	250 x 297 x 82

The EURO mini, 10 input (zone) control panel offers the reassurance and peace of mind for protecting your customer's property whilst meeting all the relevant standards. Programming of the EURO mini is the same as all the panels of the EURO range so this is the perfect alternative for your smaller installations. The slim contemporary blue LCD keypad with full English text operates the EURO mini. A combination of up to 4 slim contemporary LCD keypads can be added to the system. Castle Care-Tech Limited is a UK based designer of high technology control equipment for intruder alarms.

# INTRUDER ALARM DETECTORS

## DETECTOR RANGE

The KX Series comprising of 9 detectors in one common housing offers the ultimate in flexibility. Utilizing the latest detection technologies, this extensive range with interchangeable pcb modules allows simple exchange or easy upgrading

### Selectable Alarm Resistor Values

- 6K8 Ohm
- 4K7 Ohm
- 2K2 Ohm
- 1K Ohm

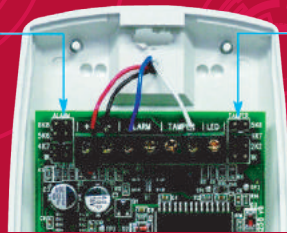





### Selectable Alarm Resistor Values

- 5K6 Ohm
- 4K7 Ohm
- 2K2 Ohm
- 1K Ohm



**1 YEAR WARRANTY**

## The KX Series (One Family for all your Detection Needs)

KX-15ED	KX-15DT	KX-10DP	KX-15DTAM	KX-10DTAM
 <p><b>SPECIFICATIONS</b> 15m Economy Dual PIR Detector  Selectable EOL Resistor Hi / Low Sensitivity Setting</p>	 <p><b>SPECIFICATIONS</b> 15m Dual Technology Digital Detector Selectable EOL Resistor Selectable NO/NC Relay and / or Technology Digital Signal Processing Digital Temperature-Compensation</p>	 <p><b>SPECIFICATIONS</b> 10m Digital Pet Digital Detector Selectable EOL Resistor Digital Signal Processing Immunity up to 15Kg-Animal. Digital Temperature-Compensation</p>	 <p><b>SPECIFICATIONS</b> 15mm Dual Technology Anti Masking Detector Selectable EOL Resistor Unique patented anti-masking detection. 15m Volumetric PIR-</p>	 <p><b>SPECIFICATIONS</b> 10m Dual Technology Anti Masking Detector  Selectable DEOL Resistor Unique patented anti-masking detection. Tri Digital Detection</p>
<p>COMMERCIAL / RESIDENTIAL Complies with EN50131-1 Environmental Class 2</p>	<p>INDUSTRIAL / COMMERCIAL / RESIDENTIAL Complies with EN50131-1 Security Grade 2 Environmental Class 2</p>	<p>INDUSTRIAL / COMMERCIAL / RESIDENTIAL Complies with EN50131-1 Security Grade 2 Environmental Class 2</p>	<p>Coverage: 5-15m Microwave Coverage, Active Self Test Selectable NO/NC Relay. Anti-Block Technology Security Grade 3</p>	<p>Digital Temperature compensation 2 Inverse (NO/NC) alarm relays Front and rear tamper switches</p>

## GRADE 3

## PCX78L/S

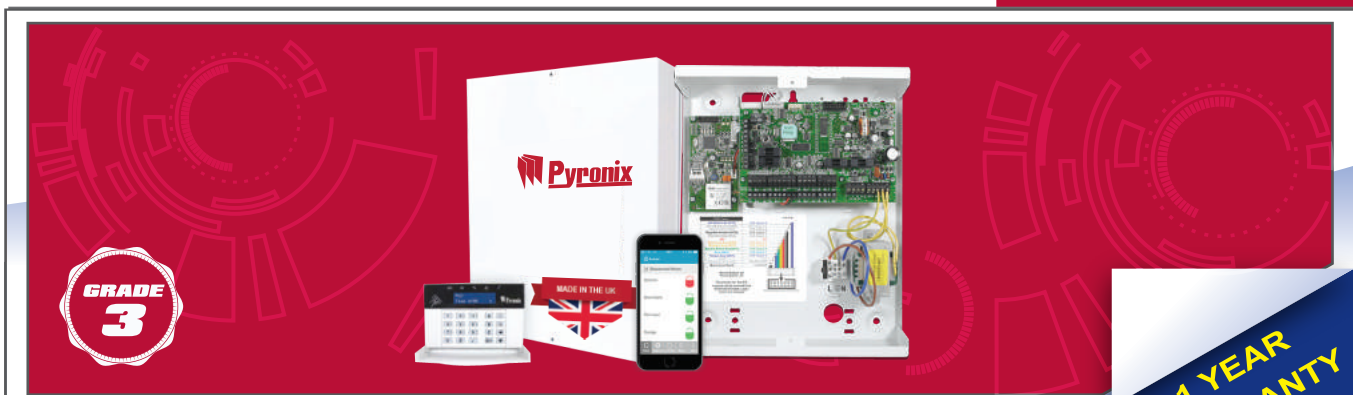

**1 YEAR WARRANTY**

### Grade 3, Hybrid panel, PCX Panels & Extender

<p><b>PCX46S</b></p> <ul style="list-style-type: none"> <li>● 8 Independent areas</li> <li>● Connect up to 78 wired and 64 wireless devices and up to 50 programmable outputs</li> <li>● GSM and/or fast PSTN modems</li> <li>● Communication: - ARC: Contact ID, SIA Level 3 - User alarms: SMS alarms - User remote control: SMS control commands</li> <li>● Fully electrical and wireless devices remote diagnostic</li> </ul>	<p><b>PCX-RIX8i</b></p> <ul style="list-style-type: none"> <li>● 8 inertia inputs</li> <li>● Complies with EN50131</li> </ul>	<p><b>PCX RIX32-WE</b></p> <ul style="list-style-type: none"> <li>● Expand Pyronix hybrid panels</li> <li>● 32 x wireless inputs/ 32 x wireless keyfobs</li> </ul>
	<p><b>DIGI-WIFI</b></p> <ul style="list-style-type: none"> <li>● WiFi Network communication module for the IP</li> </ul>	<p><b>DIGI-1200</b></p> <ul style="list-style-type: none"> <li>● PSTN communication module for the Pyronix control panels</li> </ul>
	<p><b>DIGI-GPRS</b></p> <ul style="list-style-type: none"> <li>● GPRS communication module for the Pyronix IP enabled control panels</li> </ul>	<p><b>DIGI-LAN</b></p> <ul style="list-style-type: none"> <li>● Network communication module for the IP connected control panels</li> </ul>



www.ipotecworld.com

## CONTACTS / PA BUTTONS

## GRADE 3 CONTACTS/PA BUTTONS

### Grade 3 Surface Contact with Magnetic Interference Detection

#### YEND74

##### SPECIFICATIONS

- Double door contacts
- installed on a 90 degree angle
- TACT Microswitch tamper
- Colour: White
- Environmental Class 2
- Operation Gaps: Make distance ~15mm break distance ~25mm
- Dimensions: 78mm x 25mm x 20mm
- Terminals: 4-Terminal Block Tamper
- TACT Microswitch
- Alarm Values: 1k, 4k7,5k6,6k8,8k2
- EOL Values: 1kr,2k2,4k7,5k6,8k2



1 YEAR WARRANTY

### Grade 3 Double Push Panic Button End Push

#### PA2ESR

##### SPECIFICATIONS

- Grade 3 Double Push Panic Button
- New rear / surface removal tamper
- End Push
- No resistors
- Colour: Black with stainless steel fascia
- Dimensions : 84mm x 65mm x 26 mm
- Environmental Class: 2
- Latching
- Materials: Black ABS, Stainless Steel
- Tamper: TACT Switch
- Activation: Microswitch



1 YEAR WARRANTY

### Grade 3 Shock / Tilt Sensor

#### SEISMO/ SD-G3

##### SPECIFICATIONS

- Sensitivity Auto calibration
- Selectable EOL and Alarm resistors
- Rear tamper detection
- Suitable for mounting in the 'V BOX'
- LED enable jumper
- Pulse count selectable on board
- Pulse count selectable via serial link
- Vibration and surface / tilt detection
- Heartbeat LED
- Serial connection option
- EOL Resistor options: 1k,2k2,4k1,4k7,5k6
- Dimensions(mm): 88 x 25 x 22.8



1 YEAR WARRANTY

### Grade 3 PIR sensor

#### KX-15DTAM

##### SPECIFICATIONS

- Patented anti-masking technology
- Dual technology
- Grade 3 compliant
- Selectable EOL (End Of Line) resistors
- Blue Wave Technology
- Auto sensitivity feature
- Digital temperature compensation
- Tamper proof brackets included
- Sealed optics
- ABS plastics
- Dual element pyro-electric sensor



1 YEAR WARRANTY

### Grade 3 Break Glass

#### FG162STAS

##### SPECIFICATIONS

- Power requirements : 6~18V DC, 12mA @ 12VDC
- Tamper switch
- Compatible with the FG-701 Breakglass simulator
- Dimensions (h x w x d): 98 x 62 x 21.8mm
- Range: 7.6m - 360° (adjustable range up to 7.6m)
- CE



1 YEAR WARRANTY

### Speech Dialer(GSM/PSTN)

#### V2GSM / V2TEL

##### SPECIFICATIONS

- Full duplex hands free (V2 GSM)
- Half duplex hands free (V2 TEL)
- On-board microphone and speaker
- Remote microphone and speaker outputs
- Full remote control via DTMF tones
- Output remote control
- External antenna (V2 GSM)
- A.N.R. (Answer Number Recognition or CLIP) feature
- 6 On-board programmable inputs (Expandable to 14 (V2 GSM))
- 4 On-board programmable outputs (Expandable to 52 (V2 GSM))
- Voice messages to each input (SMS messages for V2 GSM)
- 30 event memory log



1 YEAR WARRANTY

## EURO X2



1 YEAR WARRANTY

External Sounds with Ultra Bright 18 LED Strobe

##### OVERVIEW

Blue Colour Lens  
 White ABS Cover  
 Ultra bright 18 LED Strobe  
 110dB Audio Output Level at 1 Meter  
 100dB at 3 meters  
 Universal Mounting, Horizontal or Vertical, Smart LED Indicator  
 Weather Proof for Outdoor Use. 3 Way Tamper Switch (Cover, Wall & Screw)  
 Auto Cut-Off Timer (5 sec. ~ 10min or Latch)  
 Built-in 7.2V 280mA

##### SPECIFICATIONS

Power	DC12V +/- 2mA
Lens Colour	Blue
Cover Type	ABS
Strobe	Ultra bright 18 LED
Sounder Level	110dB at 1 Meter
Sounder Level	100dB at 3 Meter
Mounting Type	Horizontal or Vertical
Tamper Switch	3-way (Cover, Wall & Screw)
Auto Cut-off Timer	5 sec./10min or Latch
Battery Backup	Built-in 7.2V 280mAh Ni-MH Rechargeable
Power Source	DC12V to 15V Max. 0.8A
Dimensions (mm)	300(W)x194(H)x59(D)

# DETECTORS

BG-2000

- 8m detection range covering a 360 diameter
- Filters any unwanted noise in an environment
- The detector first picks up the high frequency 'shatter' of the glass and then the initial low frequency 'flex' of the glass
- The breakglass detector can be located in a convenient location, not necessarily positioned directly opposite the glass
- The low frequency detection of the flex is indicated by a green LED, The high frequency shatter of the glass by orange and an alarm activation by a red LED
- By utilising this feature in conjunction with the Break Glass Tester the sensitivity settings can be changed to suit the installation.
- Enables the detector which has triggered the alarm to be identified in the case where there is more than one detector connected to one zone (input).
- 3mm polished finish, reduces electrostatic interference on the PIR sensor



Break Glass Detector

## SPECIFICATIONS

- OCTOPUSDQ provides 360° detection coverage, the Octopus DQ easily and effectively detects from above, to watch over an entire room. Even if the room layout changes, the security doesn't.
- The Octopus DQ's Passive Infrared (PIR) sensor increases the detection capabilities when ceiling mounted, due to the crossing of opposing detection zones that are required to generate an alarm condition.
- The brand-new plastics of the Octopus DQ provide a better looking and more discreet detector. Smaller, slimmer and slicker, the new Octopus DQ delivers superior protection with a stylish and unobtrusive finish.
- This is an adjustable feature to determine the number of pulses that are required to be triggered before an alarm activation occurs.
- The sensitivity of the detector automatically adjusts when there are temperature fluctuations to increase or reduce the amount of opposing zones required to be crossed to create an alarm condition. This stabilises the detector in harsh environments

OCTOPUS DQ



360° Interlocking Quad Element PIR Ceiling Mount Detector

# SPEECH DIALLERS



Shutter & Door Contacts / Panic Buttons

## CONTACTS / PA BUTTONS

### Surface Mount Contacts SD1

5-terminal	single reed
Case Material	High Impact Polystyrene
Magnet	Ferrite
Temp Range	-40C to +50C
Size	67mm x 14mm x 13mm
Operating Gap	Approximately 20mm
Fixing Screws	Qty - 4
Voltage Range	1-100V DC, 125 AC Max

### Aluminium Shutter Contact SD2

Case Material	Aluminium
Magnet	Ferrite
Temp Range	-40C to +50C
Size Reed Side	150mm x 40mm x 15mm
Size Magnet Side	70mm x 45mm x 30mm
Colour	Silver
Operating Gap	Aprox 50 mm
Armoured Slewing	8mm Flexible - 1m Long



www.ipotecworld.com





**1 YEAR WARRANTY**

**202 Standard RF Anti-Theft system**

**OVERVIEW**

The 202 Standard RF Anti-Theft system is reliable and cost-effective using radio frequency (RF) technology and the full range of RF hard tags and labels. Like all RF antennas, this alarm system has an extremely high detection rate, helping to significantly reduce shoplifting. These functional antennas are ideal for many retail environments, their compact size makes them particularly suitable for shops with smaller entrances where space is at a premium. With its state-of-the-art digital processing technology, the 202 is not only an extremely reliable alarm system, but also cost-effective anti-theft-solution.

**FEATURES**

- Built on radio frequency (RF) technology
- Compact and space-saving
- Cost-effective solution
- Four different alarm sounds
- Dual alarm time

**SPECIFICATIONS**

Article Number	3022
Width	300mm
Height	1540mm
Standard colour	Chrome
Standard frequency	8.2MHz



**RF DEACTIVATORS & ACCESSORIES**



Deactivators 1 / 2 / 3

Deactivators Table Pad

Hand-Held Antenna

**1 YEAR WARRANTY**

**RF Deactivators - High-Security theft protection Hard Tags & Labels**

Model	Article No.	Width	Height	Length
Deactivator 1	3132	110mm	42mm	195mm
Deactivator 2	3133	110mm	42mm	195mm
Deactivator 3	3142	110mm	42mm	195mm
Hand-Held Antenna	3145	N/A	N/A	N/A
Table Pad	3135	305mm	8mm	253mm



Artical No: 3302R  
Diameter: 40mm  
Height: 22mm  
Weight: 12g  
Colour: Dark grey



Artical No: 3303R  
Diameter: 50mm  
Height: 25mm  
Weight: 20g  
Colour: Dark grey



Artical No: 3304R  
Diameter: 50mm  
Height: 25mm  
Weight: 20g  
Colour: Dark grey



Artical No: 3301R  
Diameter: 46mm  
Height: 18mm  
Weight: 13g  
Colour: Black



We offer high-quality paper labels, 40mm x 40mm, white, Art No Barcode: 3112 Art No Plain: 3113 Reequency 8.2Mhz



Artical No: 3231  
Diameter: 64mm  
Weight: 340g  
Colour: Chrome-plated



Artical No: 3232  
Diameter: 74mm  
Weight: 344g  
Colour: Chrome-plated



Artical No: 3233  
Diameter: 64mm  
Weight: 260g  
Colour: Chrome-plated



Artical No: 3235  
Colour: Dark grey

# COLOUR VIDEO DOOR ENTRY

## COLOUR VIDEO DOOR ENTRY



**MC-147 + (MC136)**  
7" Flat TFT LCD Video Indoor Monitor

**2 YEARS WARRANTY**

### Features

- 7" Sony High Resolution Surface Mount Pure Flat LCD Monitor
- High Resolution 1/3 inch Sony CCD Color Camera
- Built-in IR LED's ensuring high quality images even in complete darkness
- 92° Wide Angle View vandal resistant surface / flush mountable camera
- Multi monitor compatibility allows up to 3 monitors to be connected with 2 cameras
- Door release function from monitor
- Brightness / Contrast / Volume Control from monitor

### Specifications

Screen Size	7" Pure Flat LCD
Input Voltage	AC110-240V
Installation System	4 Wires (Polarity)
Call Tone	Music Chord Ring
Max Connecting length	50m / 165 feet (22AWG, 0.65mm 4wires)
Dimension Monitor	270(W) x 138(H) x 54.6(D) mm
Dimension Camera	143(W)x56(H)x50(D)mm (MC-136)
Operating Temperature	-10°C to +55°C (Monitor) -40°C to +70°C (Camera)
Weight	783kg (Monitor) 400g (MC-133) 600g (MC-134)
Camera	Choice of MC-133 / MC-134 outdoor camera



**MC-146M + (MC137)**  
4.3" Colour LCD Video Door Phone

**2 YEARS WARRANTY**

### Features

- 4.3" LCD monitor screen
- Two-way intercom
- 60S Talk Time
- 0.05 LUX illumination(MC137)
- Low battery voltage alarm
- Chord Melody
- CMOS Image Sensor (MC137)
- With unlock function

### Specifications

### MC-145M +(MC131)

Screen Size	4.3" TFT LCD
Input Voltage	DC 14.5V
Installation System	4 Wires (Polarity)
Ringtone	Several Options
Storage	100 Pictures
Dimension Monitor	180 x128 x 24 mm
Dimension Camera	55 x130 x130mm (MC-137)
Operating Temperature	-10°C to +55°C (Monitor) -20°C to +55°C (Camera)
Weight	Approx. =<1kg (Monitor) =<1kg (MC-137)
Camera	MC-137 outdoor camera



**MC-136**  
Outdoor Camera



**MC-137**  
Outdoor Camera



**MC-136MC**  
Outdoor Camera



**MC-DL5**  
Electric Lock



**MC-DL3**  
Electric Lock

## GENERAL DIAGRAM FOR ALL COLOUR VIDEO DOOR PHONES

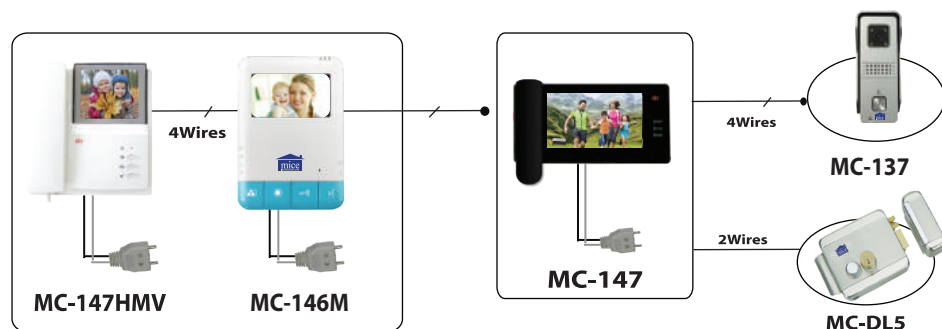

- WALK THROUGH METAL DETECTOR
- X-RAY BAGGAGE SCANNER
- HAND HELD METAL DETECTOR



YXBS-9650



**FEATURES**

- 19" High Resolution LCD Monitor
- Image storage upto 100,000 pictures(real time)
- 64 x Zoom
- Multi-Energy material identification
- Edge / Super image enhancement
- High / Low penetration display
- Brightness Control, Image recurrence, Image restoration
- Assist to detect drug and explosive powder
- Support multi-terminal check for baggage at same time
- Ray is transmitted under automatic control
- Automatic Self-diagnostic maintenance system

Specification	YXBS-9650
Tunnel Size	650 (W) x500 (H) mm
Power Requirement	220V AC (±10%) 50±3Hz
Power consumption	1.0KW (Max)
Noise level	<58dB
Conveyor Speed	0.22m/s
Conveyor Max Load	170 kg
Wire Resolution	40AWG
Spatial Resolution	1.0mm Horizontal and Vertical
Steel Penetration	40mm
Single inspection dosage	< 1.2μGy
Leakage radiation	<0.1μGy/h
Film Safety	Guarantee ISO1600 Film
<b>X-Ray Generator Specifications</b>	
Tube Current	0.4~1.2MA
Anode Voltage	100~160KV
Duty Cycle	100%Duty Cycle
Beam Direction	Upward
Beam Angle	80°
Detector	L-shaped Array

YXBS-9650: X-RAY BAGGAGE SCANNER

1 Year Warranty



## YXBS-5500



### FEATURES

- 19" High Resolution LCD Monitor
- Magnifier
- Multi-Energy material identification
- Edge / Super image enhancement
- High / Low penetration display
- Brightness Control, Image recurrence, Image restoration
- Assist to detect drug and explosive powder
- Support multi-terminal check for baggage at same time
- Ray is transmitted under automatic control
- Automatic Self-diagnostic maintenance system
- One Key shutdown control

Specification	YXBS-5500
Tunnel Size	500 (W) x300 (H) mm
Conveyor Speed	0.22m/s
Conveyor Max Load	150 kg
Single inspection dosage	< 1.32μGy
Wire Resolution	40AWG
Steel Penetration	12MM
Film Safety	< 1.2μGy
Leakage radiation	<0.1μGy/h
Film Safety	ISO 1600
<b>X-Ray Generator Specifications</b>	
Tube Current	0.4~1.2MA
Anode Voltage	100~160KV
Beam Angle	60°

## YXBS-5500: X-RAY BAGGAGE SCANNER

1 Year Warranty

## YXBS-7530



### FEATURES

- 19" High Resolution LCD Monitor
- Magnifier
- Multi-Energy material identification
- Edge / Super image enhancement
- High / Low penetration display
- Brightness Control, Image recurrence, Image restoration
- Assist to detect drug and explosive powder
- Support multi-terminal check for baggage at same time
- Ray is transmitted under automatic control
- Automatic Self-diagnostic maintenance system
- One Key shutdown control

Specification	YXBS-7530
Tunnel Size	530 (W) x350 (H) mm
Conveyor Speed	0.22m/s
Conveyor Max Load	150 kg
Single inspection dosage	<1.01μGy
Leakage radiation	<0.06μGy/h
Wire Resolution	40AWG
Steel Penetration	43mm
Film Safety	ISO 1600
<b>X-Ray Generator Specifications</b>	
Tube Current	0.2-1.25mA
Anode Voltage	80-160KV
Beam Angle	80°

## YXBS-7530: X-RAY BAGGAGE SCANNER

1 Year Warranty



www.ipotecworld.com



YWMD-600



**Multi Zone Walk-Through Metal Detector**

FEATURES

- User Friendly interactive interface
- Automatic Self-diagnostic maintenance system
- Adjustable Sensitivity
- Electro Magnetic Field Technologies
- Digital operation keyboard
- LCD screen, Infrared remoter controller
- Six mutual over-lapping detecting zones
- Simultaneous alarm from multi- zones;
- LED indicator light on both door panels
- Scan upto 50 persons per minute
- Computerized access code
- Harmless to human body
- Durable , weather-proof construction

Specification	YWMD-600
Electric current	AC 85 ~264V /50-60HZ
Power	<20W
Net weight	70KG
Workplace environment	-20° ~ 45°
Zone Indications	16 independent zones
<b>Standard Size</b>	
External	2235(H) X 840(W) X 585(D) mm
Internal	1995(H) X 705(W) X 500(D) mm
Standard	CE, GB15210-2003

1 Year Warranty

YHMD-500



FEATURES

- Operates on one 9V standard or rechargeable battery
- LED signal strength indicator
- Ultra sensitive response to metal objects
- Optimum sensitivity and depth range
- Simultaneous Sound (vibration) and light alarm
- Sharp audible alarm and bright red LED
- Toggle switch for led and alarm
- Leathery Outfits

Specification	YHMD-500
Power	9V "AA" battery
Alarm	Sound (vibration) & Light simultaneously
Dimension	440(L) X 60(W) X 110(H) mm



YHMD-500: HAND HELD METAL DETECTOR

1 Year Warranty





## 1165190 : Super Scanner® V



### OPTIONAL



1610800  
Recharger Kit



1611600  
Belt Holder

### 1165190 - Audible Alarm and Silent Vibrating Alarm

Originally designed for use at the Olympic Games, the Garrett Super Scanner(V) has become the most recognized hand-held metal detector in the world. The Super Scanner (V) offers outstanding performance, stability and extreme sensitivity in detecting the smallest objects. It features audible and silent vibrating alarm options, and extended battery life!

### FEATURES

- No tools required to change standard 9V battery
- Sharp audible alarm with bright red LED indicator
- Momentary push button eliminate ambient metal detection
- Large 8/ 10-inch scan surface for quick, thorough scanning
- Green LED indicates ON and Amber LED indicates Low Battery

**1165190, 1165180: Garrett Super Scanner® (V) Hand-Held Metal Detector** **2 Years Warranty**

## 1165800 : SuperWand®



From U.S. sporting events to airports, the SuperWand™ is the hand-held metal detector of choice for today's security screener. The SuperWand's exclusive 360° detection field provides uniform sensitivity and tip pinpointing to detect weapons and other metal objects with extreme accuracy.

### FEATURES

- Rugged injection molded construction
- Structurally isolated coil for added impact absorption
- Large 9.5-inch scan area allows thorough scanning
- Ergonomically designed grip fits comfortably in every hand
- Tip pinpointing for easy scanning from head to foot
- Easy and convenient to use with one-touch button
- Clear audible or Silent / Vibrate LED alarm signal
- Easy ON / OFF battery cover
- 9V battery (included) operation



SAFETY  
SECURITY  
PEACE OF MIND™

[www.ipotecworld.com](http://www.ipotecworld.com)



SuperScanner is the industry leader for more than 25 years.

## 1165190 : Super Scanner® V

**GARRETT**  
METAL DETECTORS



### OPTIONAL



1610800  
Recharger Kit



1611600  
Belt Holder

### 1165190 - Audible Alarm and Silent Vibrating Alarm

Originally designed for use at the Olympic Games, the Garrett Super Scanner(V) has become the most recognized hand-held metal detector in the world. The Super Scanner (V) offers outstanding performance, stability and extreme sensitivity in detecting the smallest objects. It features audible and silent vibrating alarm options, and extended battery life!

### FEATURES

- No tools required to change standard 9V battery
- Sharp audible alarm with bright red LED indicator
- Momentary push button eliminate ambient metal detection
- Large 8/ 10-inch scan surface for quick, thorough scanning
- Green LED indicates ON and Amber LED indicates Low Battery

**1165190, 1165180: Garrett Super Scanner® (V) Hand-Held Metal Detector**

**2 Years Warranty**

## 1165800: SuperWand®

**GARRETT**  
METAL DETECTORS



From U.S. sporting events to airports, the SuperWand™ is the hand-held metal detector of choice for today's security screener. The SuperWand's exclusive 360° detection field provides uniform sensitivity and tip pinpointing to detect weapons and other metal objects with extreme accuracy.

### FEATURES

- Rugged injection molded construction
- Structurally isolated coil for added impact absorption
- Large 9.5-inch scan area allows thorough scanning
- Ergonomically designed grip fits comfortably in every hand
- Tip pinpointing for easy scanning from head to foot
- Easy and convenient to use with one-touch button
- Clear audible or Silent / Vibrate LED alarm signal
- Easy ON / OFF battery cover
- 9V battery (included) operation





**CS 5000: Walk-Through Metal Detector**



The CS 5000™ is an affordable unit for the budget-conscious. With enhanced microprocessor-based technology, the CS 5000 provides improved detection performance and increased operating flexibility. It can be used in virtually any security checkpoint application and offers many of the same features found on our advanced walk-through units.

**FEATURES**

- Touchpads and backlit LCD screen offer clearer and easier use
- Uniform detection coverage from archway to floor
- Three ankle-boost sensitivity levels
- User-friendly programming for precise control of detection settings
- Computerized access codes ensure tamper-proof settings

**Garrett CS 5000 : Walk-Through Metal Detector**

**2 Years Warranty**

**PD 6500i: Multi Zone Walk-Through Metal Detector**



**OPTIONAL**



2225470  
Battery Backup  
Module

The PD 6500i™ is the world's highest performing walk-through metal detector and leads the industry with unmatched discrimination, superior pinpoint technology and sensitivity features. The PD 6500i™ is designed for maximum patron throughput without compromising safety, the PD 6500i™ is the walk-through of choice for security professionals worldwide.

**FEATURES**

- Enhanced Metal Detector
- Multi-dimensional coil design
- 33 distinct pinpoint zones
- Detection and location of guns and knives
- Circuitry with advanced Digital Signal Processor
- Individual zone boost adjustments allow
- Durable, IP 55 weather-proof construction.

**Garrett PD 6500i : Walk-Through Metal Detector**

**2 Years Warranty**







THE NEXT STEP  
IN SMART  
IP SURVEILLANCE



# HIKVISION



For further information on our range of  
products, please contact your local distributor:

**IPTEC** IPTEC General Trading. LLC

Showroom # 28/34 Gargash Center  
P. O Box 15448, Dubai, U.A.E.  
Tel: +971-4-227-8901 / 223-4446  
Fax: +971-4-221-9395  
Email: [sales@iptecworld.com](mailto:sales@iptecworld.com)  
Web: [www.iptecworld.com](http://www.iptecworld.com)

All specifications and warranty periods shown in this catalogue, are subject to change without notice, please confirm up to date details when ordering. All network specifications and recording times are based upon theoretical scenarios. Actual performance will vary depending on external factors. All errors and omissions excepted acknowledged. Local Distributors standard terms and conditions apply for all purchases.