



VAN AND REFRIGERATED BOX ACCESSORIES





5101-040-4

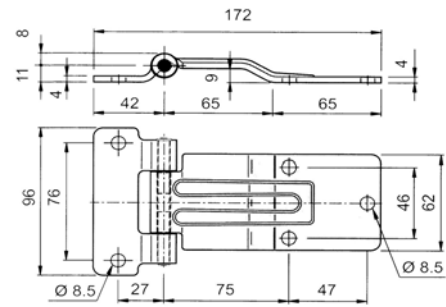

5101-050-4

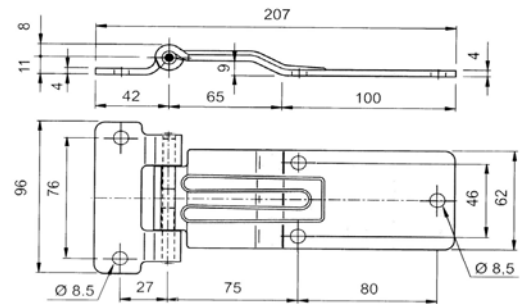

5101-111-4

5101-070-3

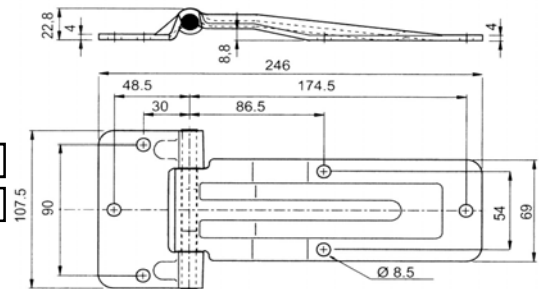

CODE.	DESCRIPTION	SURFACE	WEIGHT
5101-040-4	side door hinge 172x96	inox	0,44
5101-050-4	side door hinge 207x96	inox	0,49
5101-111-4	side door hinge 246x107,5	inox	0,73
5101-070-3	side door hinge 246x107,5	zinc plated	0,73



5101-080-4

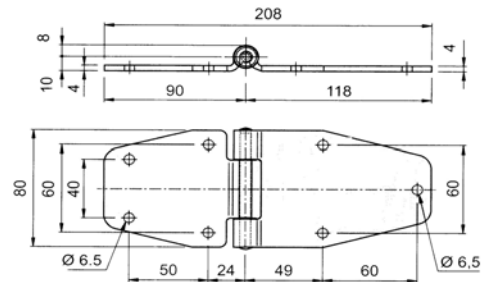

5101-095-4

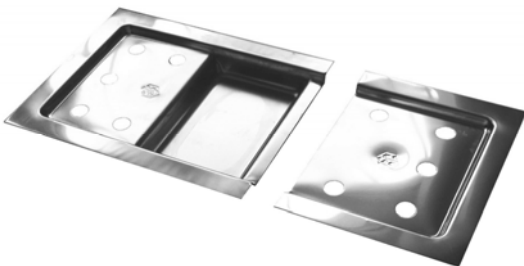
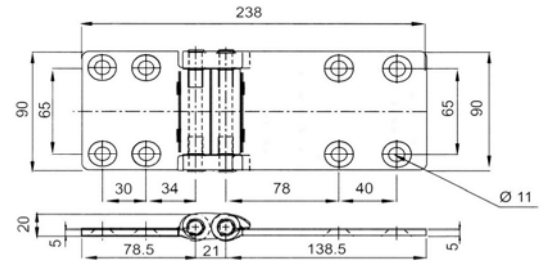

5101-115-4

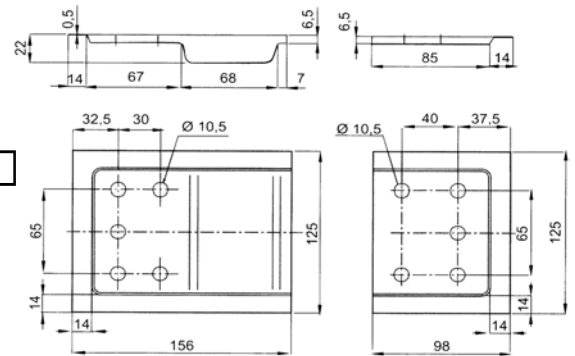

CODE.	DESCRIPTION	SURFACE	WEIGHT
5101-080-4	side door hinge 208x80	inox	0,52
5101-095-4	side door hinge 238x90	inox	1,08
5101-115-4	housing for 5101-095-4 hinge	inox	0,125

7.4

SIDE DOOR HINGES



5101-120-4

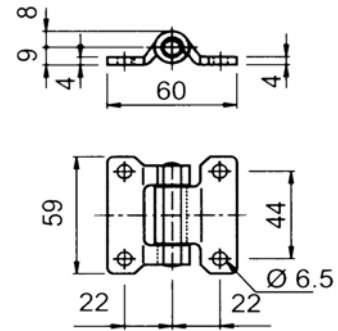

CODE.	DESCRIPTION	SURFACE	WEIGHT
5101-120-4	side door hinge 60X60	inox	0,14

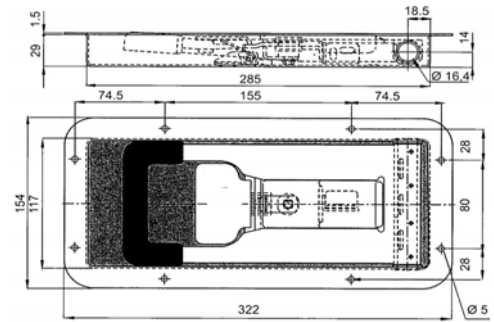

5102-010-4

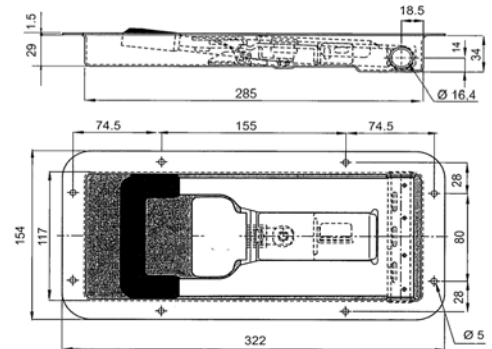

5102-020-4

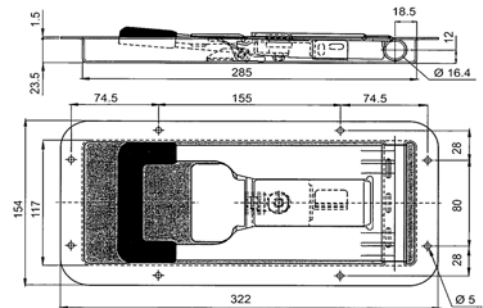

5102-030-4

CODE.	DESCRIPTION	SURFACE	WEIGHT
5102-010-4	recessed lock, d=16 h=30,5	inox	1,8
5102-020-4	recessed lock, d=16 h=35,5	inox	1,8
5102-030-4	recessed lock, d=16 h=25	inox	1,57

7.6

RECESSED DOOR LOCK

EUROWIND



5102-040-4

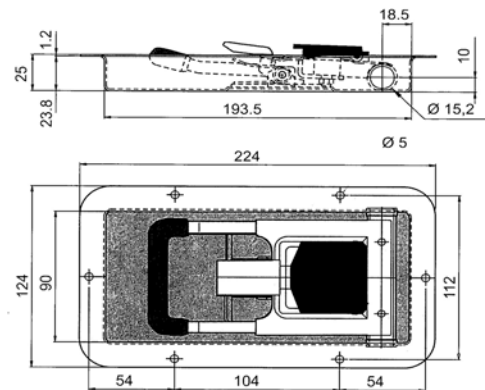

5102-050-5

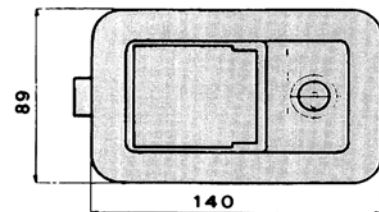
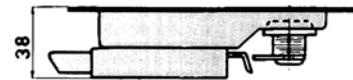

CODE.	DESCRIPTION	SURFACE	WEIGHT
5102-040-4	recessed lock, d=15 h=25	inox	0,82
5102-050-5	recessed side door lock - inox with key	paintad	0,42



5102-070-4
with plastic lug

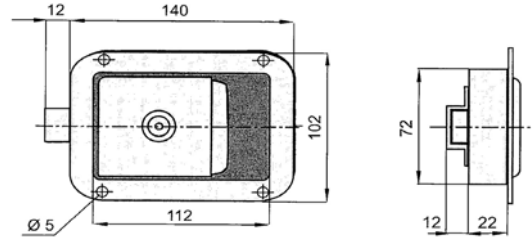

with metal lug

5102-075-4



5102-080-4

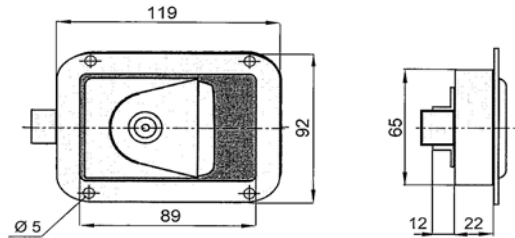

5102-061-0

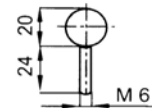

5012-062-4

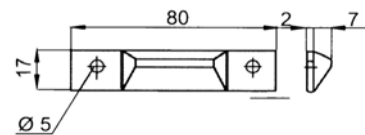

CODE.	DESCRIPTION	SURFACE	WEIGHT
5102-075-4	recessed side door lock with key and metal lug	inox	0,5
5102-070-4	recessed side door lock with key and plastic lug	inox	0,44
5102-080-4	recessed handle with one key	inox	0,3
5102-061-0	knob for internal opening (5102-075-4)		0,02
5102-062-4	catch (5102-075-4)	inox	0,01



5102-501-4

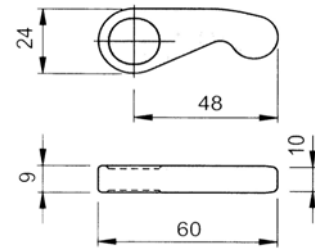

5102-502-DX4

5102-502-SX4

5102-502-DX3

5102-502-SX3

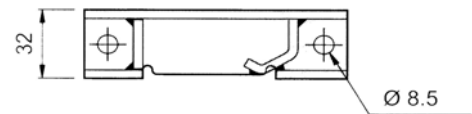
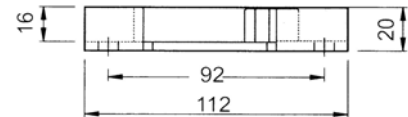

5102-503-4

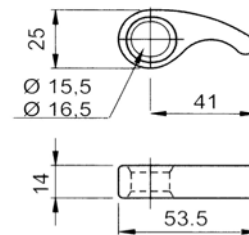

5102-503-3

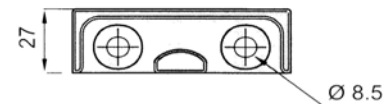
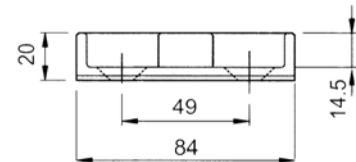

CODE.	DESCRIPTION	SURFACE	WEIGHT
5102-501-4	inox cam 48x60x10	inox	0,07
5102-502-DX4	sheet steel keeper - right 112x32x20	inox	0,16
5102-502-SX4	sheet steel keeper - left 112x32x20	inox	0,16
5102-502-DX3	sheet steel keeper - right 112x32x20	zinc plated	0,16
5102-502-SX3	sheet steel keeper - left 112x32x20	zinc plated	0,16
5102-503-4	inox cam 41x53x14	inox	0,07
5102-503-3	righthand/lefthand keeper 84x27x20	zinc plated	0,13

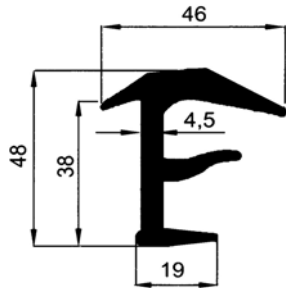

5109-38-16

5109-38-36

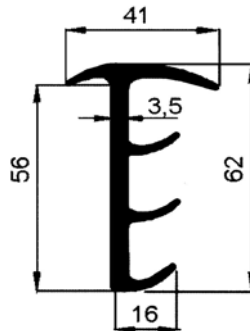

5109-60-16

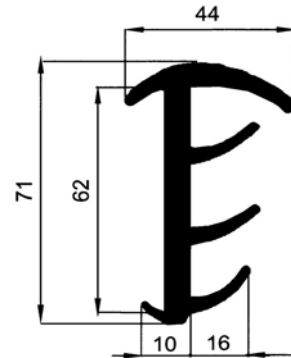

5109-62-16

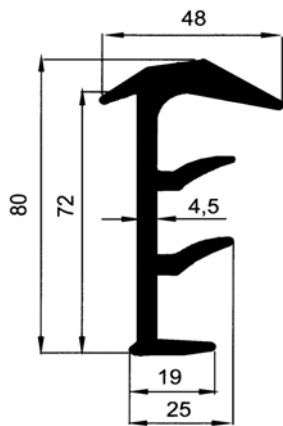

5109-72-16

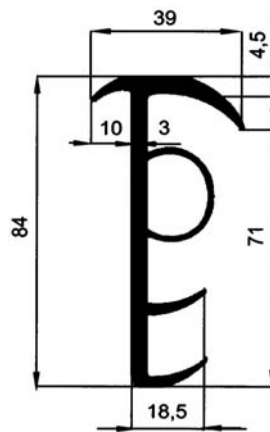

5109-80-16

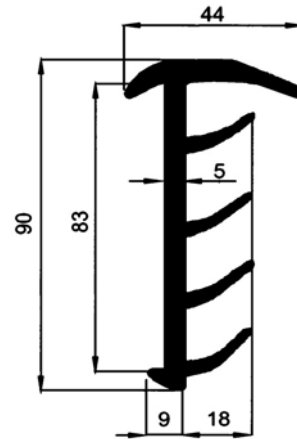

5109-82-16

CODE.	DESCRIPTION	SURFACE	WEIGHT
5109-38-16	EPDM rubber profile 38 2500 mm	black	1,5
5109-38-36	EPDM rubber profile 38 4200 mm	black	2,8
5109-60-16	EPDM rubber profile 60 13000 mm	black	7,55
5109-62-16	EPDM rubber profile 62 13000 mm	black	10
5109-72-16	EPDM rubber profile 72 10000 mm	black	9,4
5109-80-16	EPDM rubber profile 80 10000 mm	black	5,2
5109-82-16	EPDM rubber profile 83 10000 mm	black	11,4

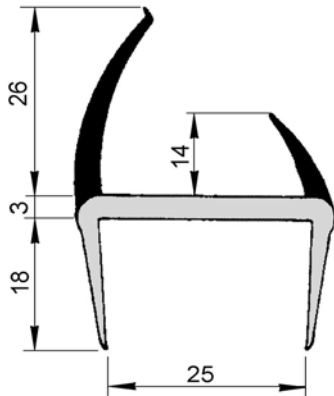

5108-25-17

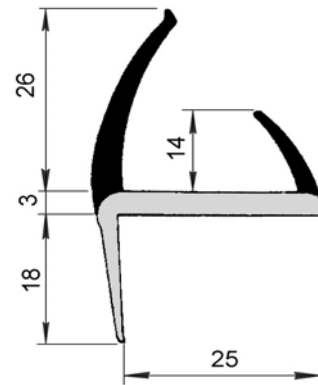

5108-25-27

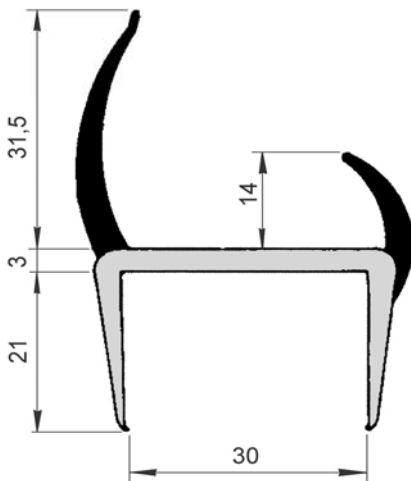

5108-30-17

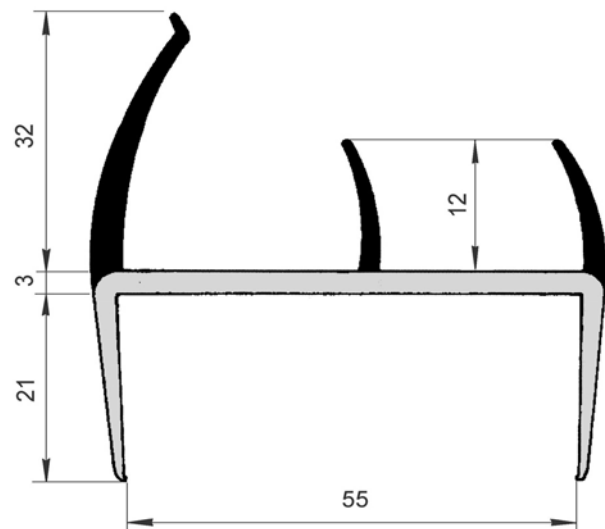

5108-55-17

SOFT ■

HARD ■

CODE.	DESCRIPTION	SURFACE	WEIGHT
5108-25-17	Dual hardness PVC seal profile t.25mm 2700m	grey/black	1,15
5108-25-27	Dual hardness PVC seal profile t.25mm 2700m	grey/black	1
5108-30-17	Dual hardness PVC seal profile t.30mm 2700m	grey/black	1,25
5108-55-17	Dual hardness PVC seal profile t.55mm 2700m	grey/black	1,53

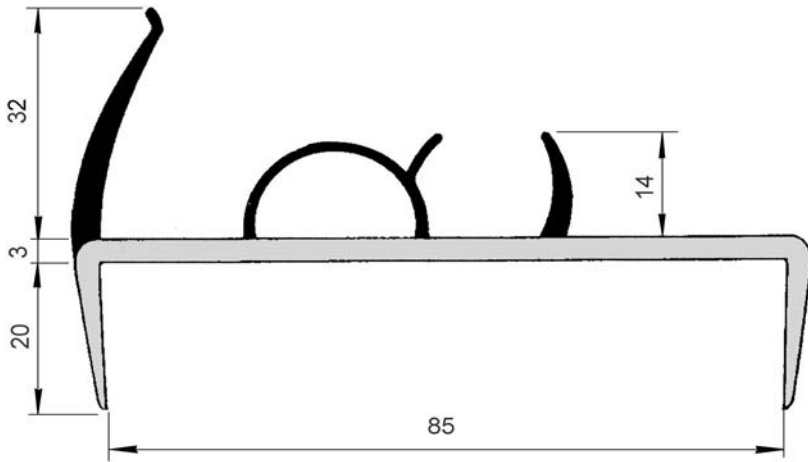

5108-85-17

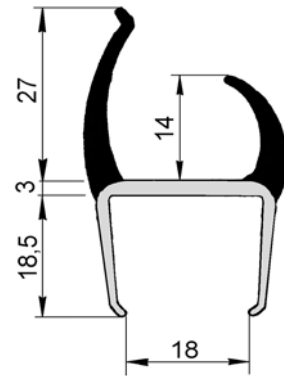

5108-20-17

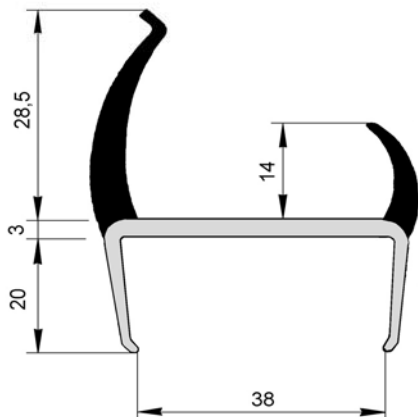

5108-40-17

5108-40-27

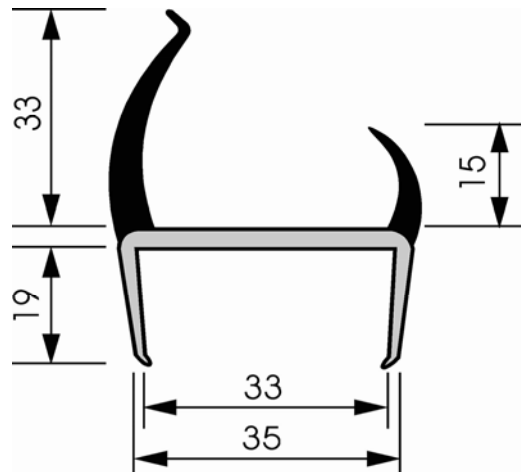

5108-35-17

SOFT ■

HARD ■

CODE.	DESCRIPTION	SURFACE	WEIGHT
5108-85-17	Dual hardness PVC seal profile t.85mm 2700mm	grey/grey	1,76
5108-40-17	Dual hardness PVC seal profile t.40mm 2700mm	grey/grey	1,35
5108-40-27	Dual hardness PVC seal profile t.40mm 5000mm	grey/grey	2,7
5108-35-17	Dual hardness PVC seal profile t.35mm 2700mm	grey/grey	1,2
5108-20-17	Dual hardness PVC seal profile t.20mm 2700mm	grey/grey	1

7.12

OTHER SEAL ACCESSORIES

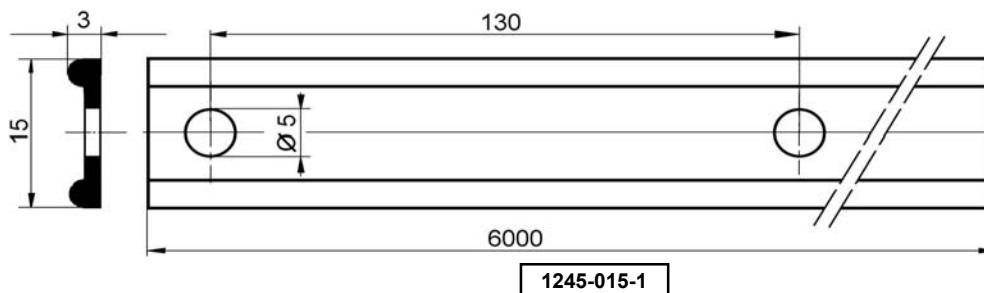
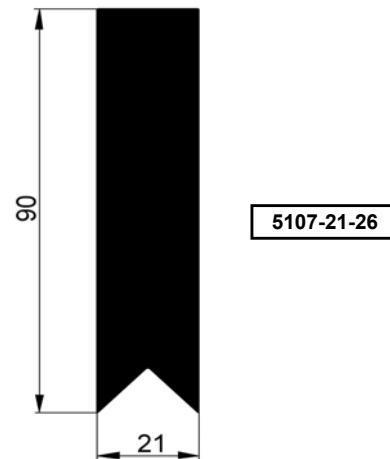
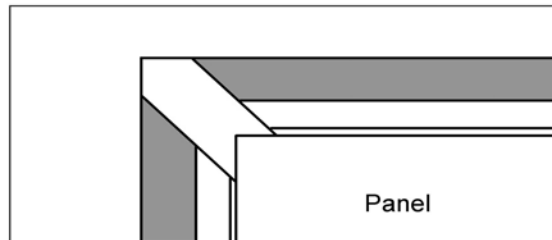
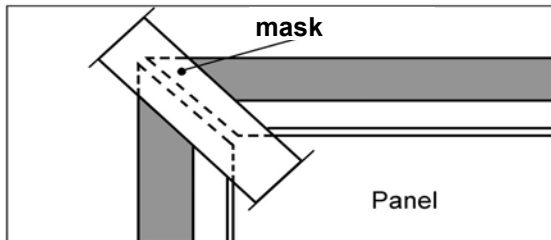
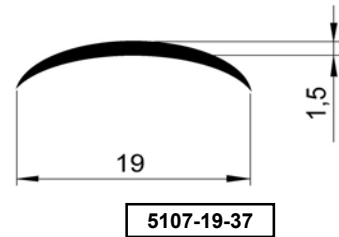
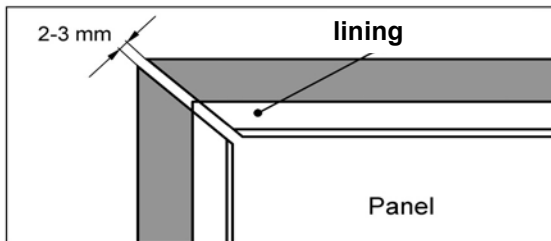

CODE.	DESCRIPTION	SURFACE	LENGTH m	WEIGHT
5107-19-37	PVC joint for angular connections on dual hardness profile - grey 100 m	nature	request	0,01/m
5107-21-26	mask for rubber seal - black	nature		0,001
5107-001-0	glue for rubber 20 gr			0,02
1245-015-1	aluminum seal fastening profile	nature	6	0,44

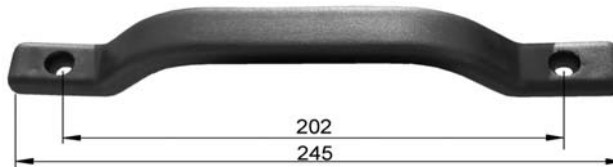

5117-001-7



5117-002-7

CODE.	DESCRIPTION	WEIGHT
5117-001-7	plastic climb-up handle	0,05
5117-002-7	plastic climb-up handle	0,13



5107-001-4

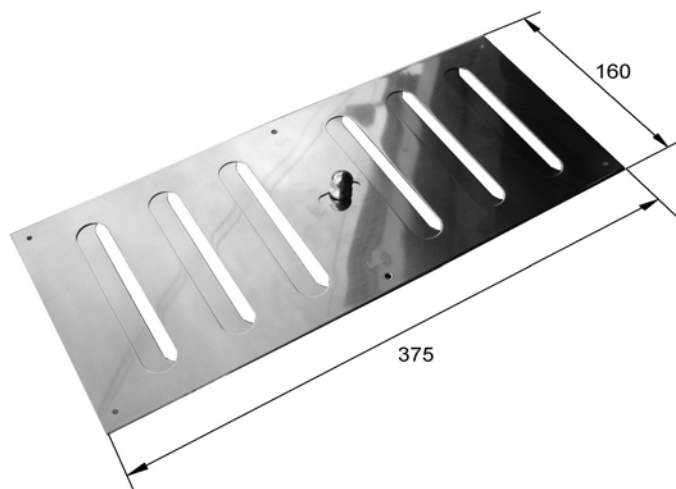

5107-002-4

CODE.	DESCRIPTION	WEIGHT
5107-001-4	aeration grates, narrow, sliding inox	0,248
5107-002-4	aeration grates, wide, sliding inox	0,435

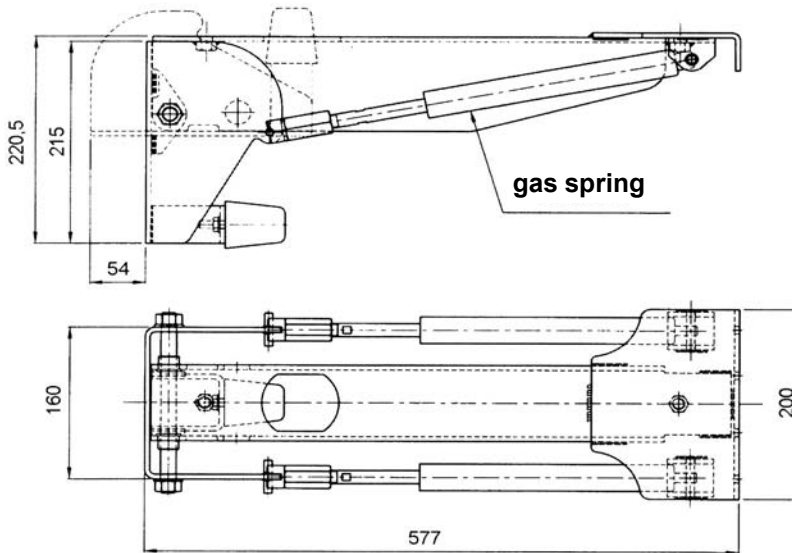

5124-010-0

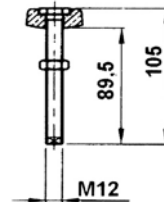

5124-020-0

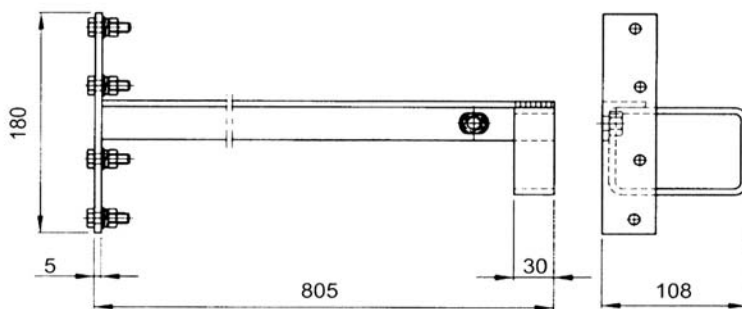

5124-030-0

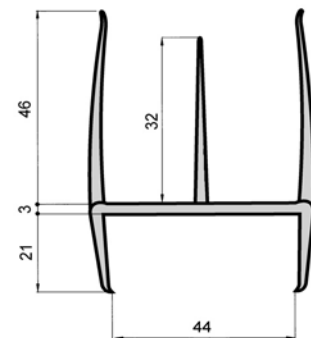

5124-441-7

CODE.	DESCRIPTION	WEIGHT
5124-010-0	hinge, with gas spring, for inside removable wall	3,7
5124-030-0	hinge lengthening for inside removable wall	2,35
5124-020-0	roller pin	0,11
5124-441-7	rubber seal for inside removable wall - length 2,6 m	1,83

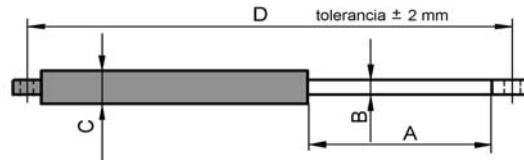

CODE.	A	Ø B	Ø C	D	Kg	CONNECTION
28-10255-00	85	8	19	255	10	A3-B3
28-20255-00	85	8	19	255	20	A3-B3
28-30255-00	85	8	19	255	30	A3-B3
28-35290-00	95	8	19	290	35	A3-B3
28-25355-00	130	8	19	355	25	A3-B3
28-50405-00	155	8	19	405	50	A3-B3
28-30485-00	185	8	19	485	30	A3-B3
28-50485-00	185	10	22	485	50	A3-B3
28-30550-00	220	8	19	550	30	A3-B3
28-40550-00	220	8	19	550	40	A3-B3
28-40590-00	239	10	22	590	40	A3-B3
28-30585-00	245	8	19	585	30	A3-B3
28-20600-00	250	8	19	600	20	A3-B3
28-30600-00	250	8	19	600	30	A3-B3
28-60600-00	255	10	22	600	60	A15 - B15
28-80600-00	255	10	22	600	80	A15 - B15
28-110600-00	255	10	22	600	110	A15 - B15
28-200700-00	300	14	28	700	200	A15 - B15
28-35700-00	310	10	22	700	35	A15 - B15
28-55700-00	310	10	22	700	55	A15 - B15
28-70700-00	310	10	22	700	70	A15 - B15
28-80800-00	360	10	22	800	80	A15 - B15
28-90800-00	360	10	22	800	90	A15 - B15
28-100800-00	350	14	28	800	100	A15 - B15
28-130800-00	350	14	28	800	130	A15 - B15
28-200800-00	350	14	28	800	200	A15 - B15

END PIECES

**B 3
Welded**

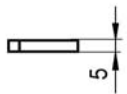
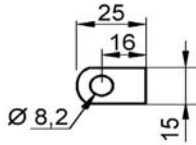

**A 3
Calked**

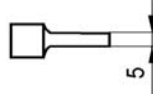
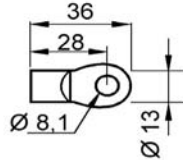

**B 15
Welded**

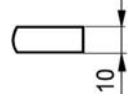
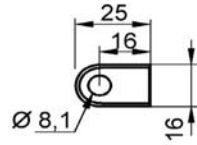

**A 15
Calked**

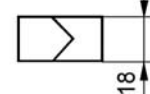
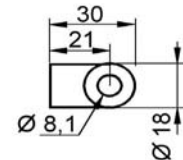

GAS SPRING BRACKETS

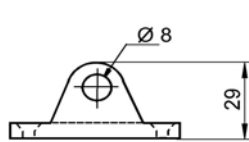
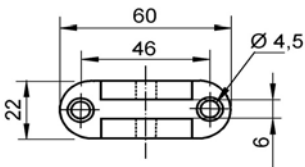
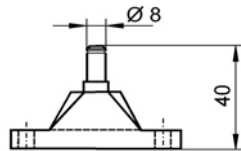
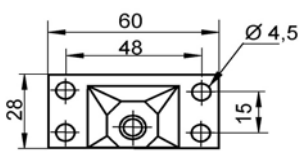

A3 - B3

CODE.	DESCRIPTION	WEIGHT
28-82514962	gas spring brackets	0,12

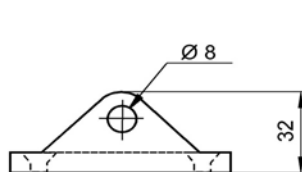
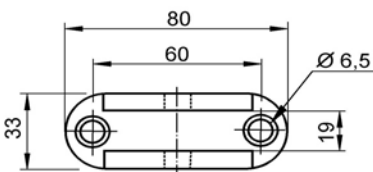
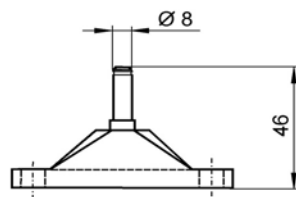
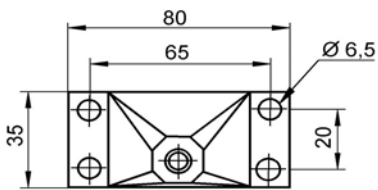

A15 - B15

CODE.	DESCRIPTION	WEIGHT
28-82513963	gas spring brackets	0,12

CALCULATE OVERPOWERING FORCE

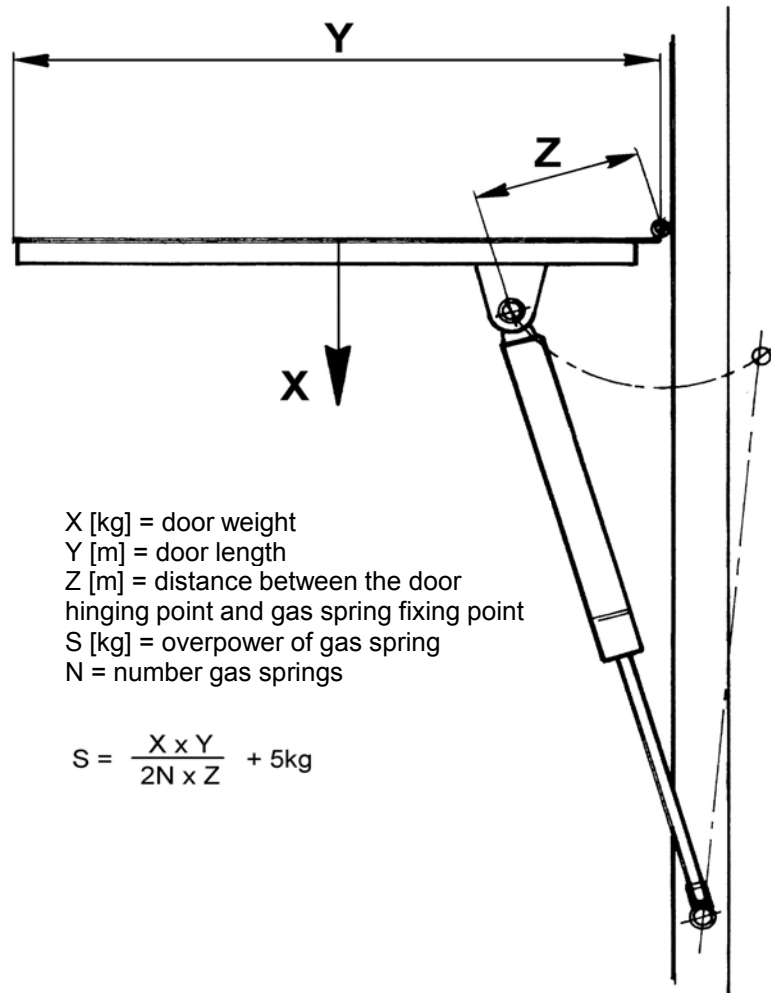

The thrust of a gas spring will be calculated at 20°, a higher or lower temperature would influence the thrust for about 3,5% every 10°C. The normal function proceeds within a temperature between -30°C and +80° C

The assembling must be carried out as following: in closed position the connection of the shaft has to be turned to the downside, this will facilitate the lubrication of the guide and of the seals and will permit a higher braking effect

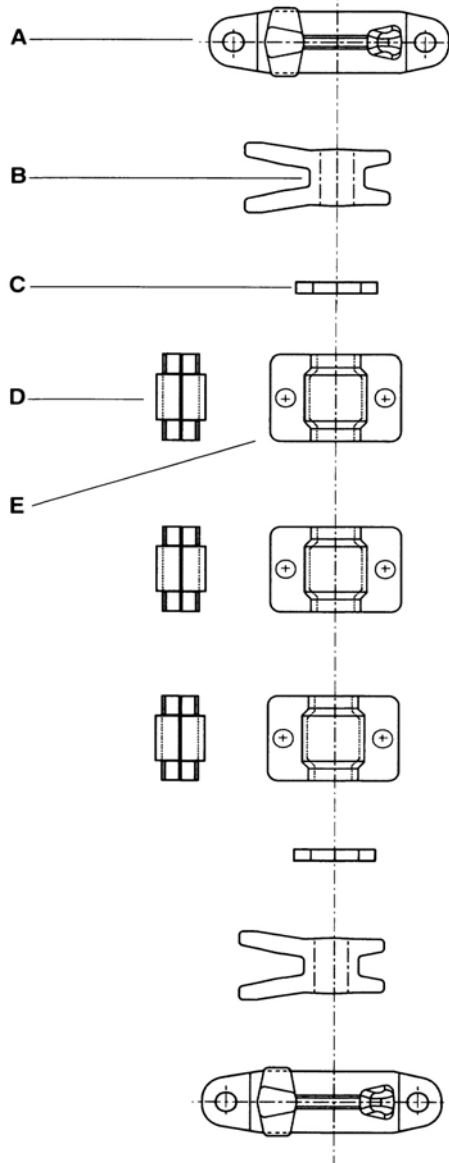

Ø16

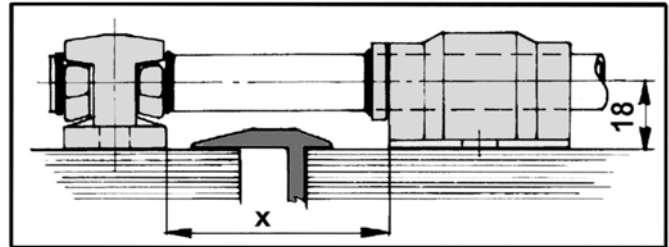

The anti-rack washer is welded onto the tube by the user. Measurement X is therefore undefined.

CODE.		DESCRIPTION	Number	WEIGHT
INOX	zinc plated			
5111-16-0104	5111-16-0103	external door gear kit d= 16 mm		2,312
A	5111-16-0114 5111-16-0113	Keeper	2	0,19
B	5111-16-0124 5111-16-0123	cam	2	0,8
C	5111-16-0134 5111-16-0133	washer	2	0,01
D	5111-16-0147 5111-16-0147	bush	6	0,007
E	5111-16-0154 5111-16-0153	clamp	3	0,09

7.20

EXTERNAL DOOR HANDLE FOR Ø16mm TUBE

EUROWIND

Ø16

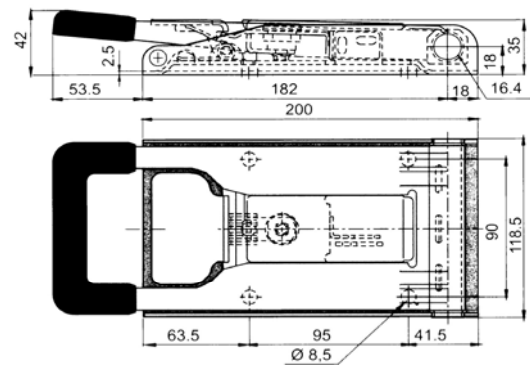

Note: only by request

CODE.		DESCRIPTION	WEIGHT
INOX	zinc plated		
5115-16-0104		EXTERNAL DOOR HANDLE FOR Ø16mm TUBE	1,58

Ø16

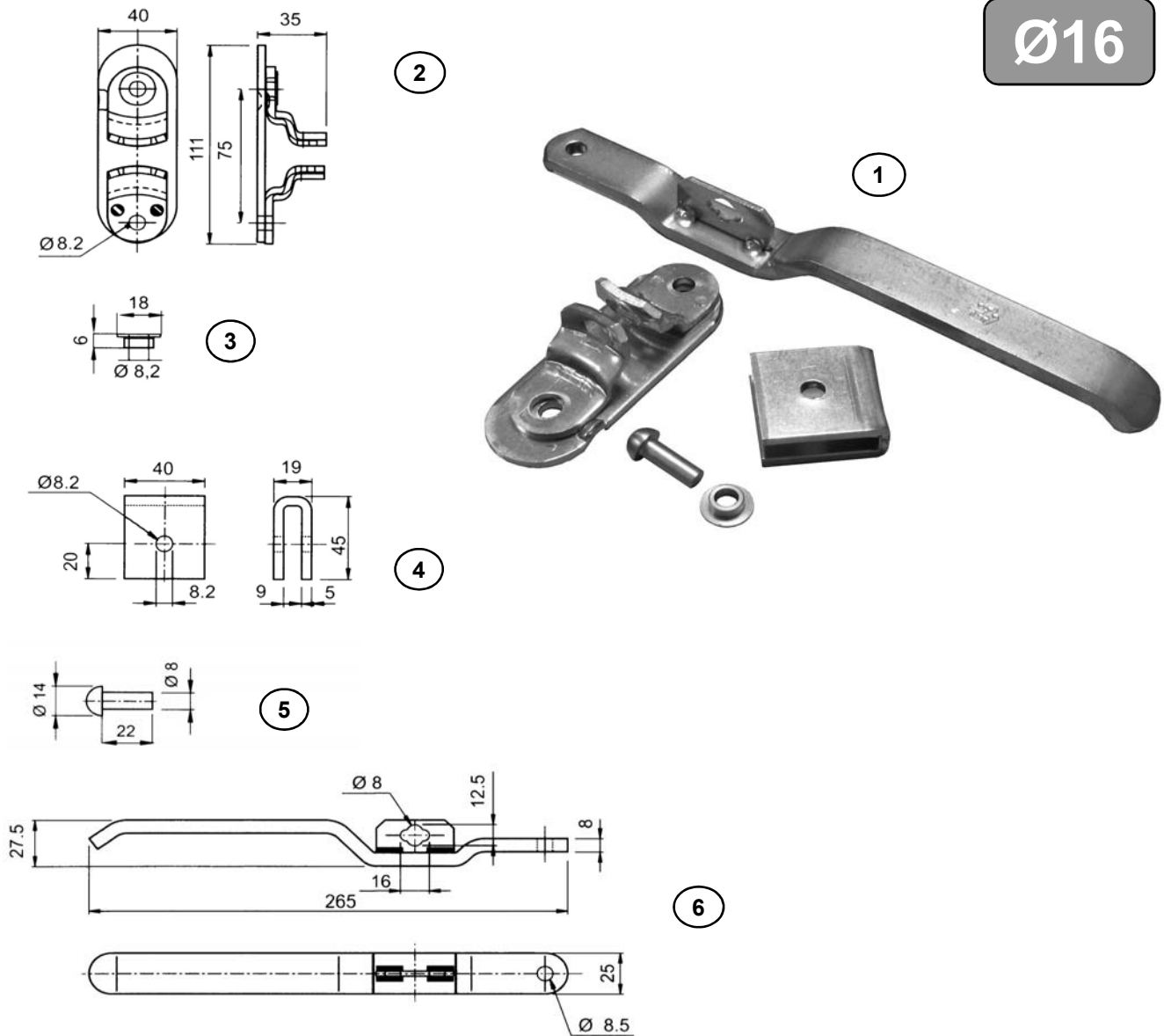

CODE.		DESCRIPTION	WEIGHT
INOX	zinc plated		
1	5115-16-0204	5115-16-0203 COMPONENTS KIT FOR LOCK Ø16mm	0,772
2	5115-16-0214	5115-16-0213 lever stay	0,216
3	5115-16-0224	5115-16-0223 bush	0,003
4	5115-16-0234	5115-16-0233 lever clamp	0,12
5	5115-16-0244	5115-16-0243 pin	0,013
6	5115-16-0254	5115-16-0253 Flat lever with side for padlock or custom seal	0,42

Ø16

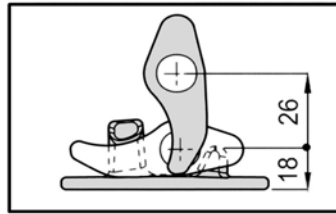
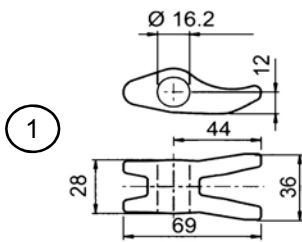
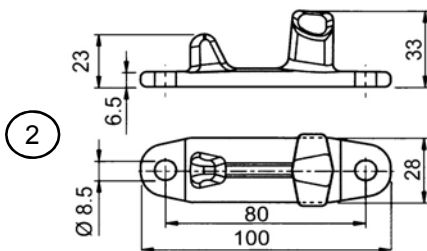
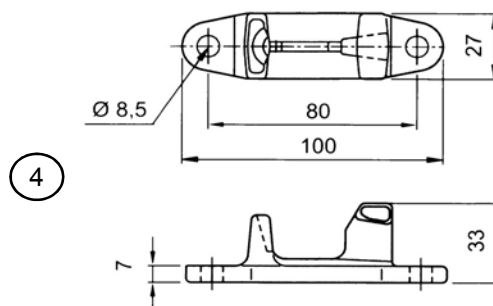
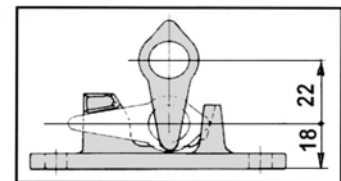
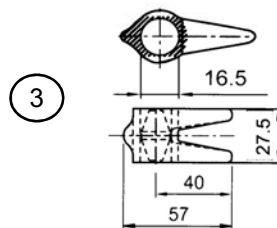
Difference between opened
and closed positionDifference between opened
and closed position

CODE.		DESCRIPTION	WEIGHT	
1	INOX 5111-16-0124	zinc plated 5111-16-0123	cam	0,08
2	5111-16-0114	5111-16-0113	keeper	0,19
3	5111-16-0164	5111-16-0163	cam	0,08
4	5111-16-0174	5111-16-0173	keeper	0,19

Ø22

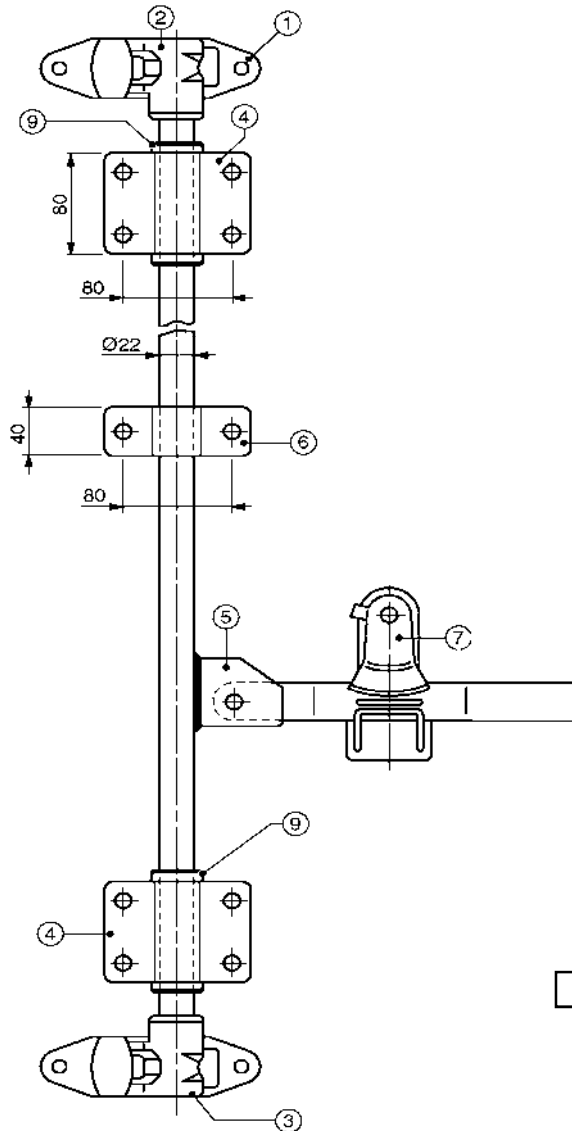

tube is not included in the set

CODE.	DESCRIPTION	Number	WEIGHT
5111-22-0103	EXTERNAL DOOR GEAR KIT Ø22 Zinc plated	1	3,85
1	5111-22-0113 keeper	2	0,38
2	5111-22-0123 cam left	1	0,43
3	5111-22-0133 cam right	1	0,43
4	5111-22-0143 tube clamp big	2	0,45
5	5111-2215DX3 lever clamp right	1	0,145
	5111-2215SX3 lever clamp left	1	0,145
6	5111-22-0163 tube clamp small	1	0,22
7	5111-22-0173 lever stay	1	0,34
8	5111-2218DX3 lever right	1	0,82
	5111-2218SX3 lever left	1	0,82
9	5111-22-0193 washer	2	0,05

7.24

EXTERNAL DOOR GEAR KIT Ø22

EUROWIND

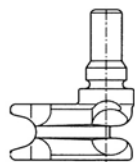
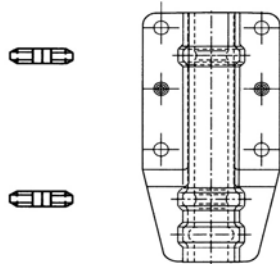
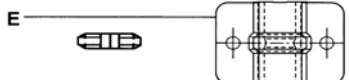
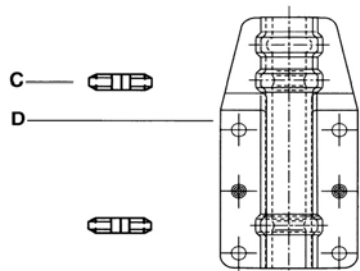
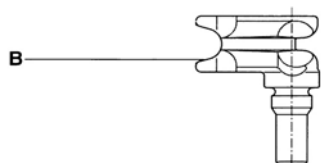

Ø22

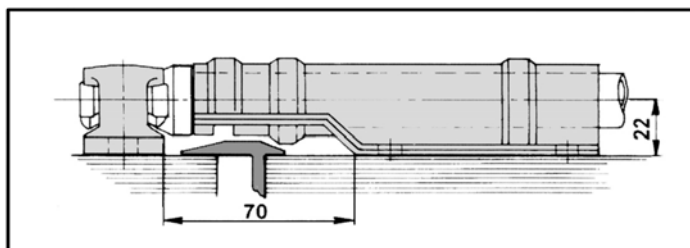

The anti-rack washer is an integral part of the forged cam so the measurement on the drawing cannot be modified.

CODE.	DESCRIPTION	Number	WEIGHT
INOX			
5111-22-0204	external door gear kit for Ø22 mm tube "BIG 6"		1,594
A	5111-22-0214 keeper "BIG 6"	2	0,34
B	5111-22-0224 cam "BIG 6"	2	0,33
C	5111-22-0237 bush	5	0,004
D	5111-22-0244 tube clamp big	2	0,64
E	5111-22-0254 tube clamp small	1	0,28

Ø22

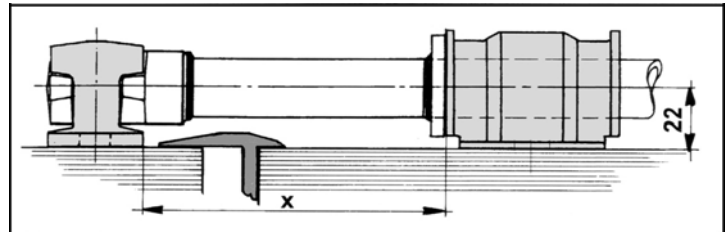
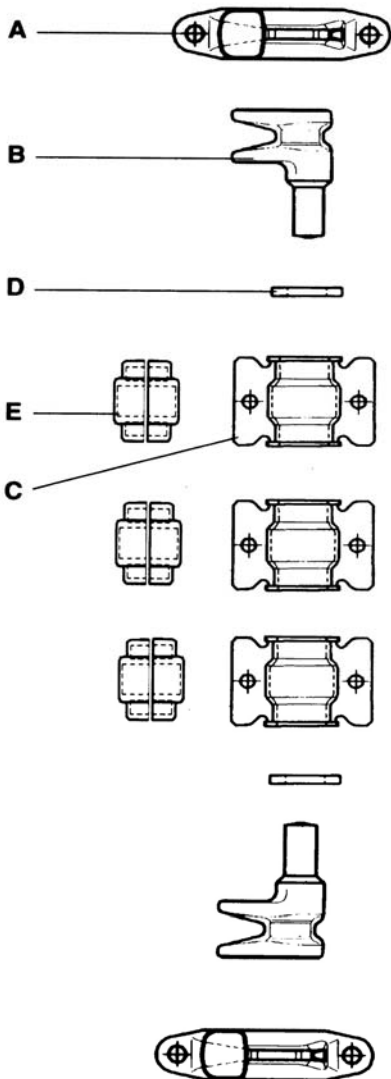

The anti-rack washer is welded onto the tube by the user. Measurement X is therefore undefined.

CODE.		DESCRIPTION	Number	WEIGHT	
INOX	zinc plated				
5111-22-0304	5111-22-0303	external door gear kit for Ø22 mm tube		1,88	
A	5111-22-0314	5111-22-0313	keeper	2	0,35
B	5111-22-0324	5111-22-0323	cam	2	0,33
C	5111-22-0334	5111-22-0333	tube clamp small	3	0,14
D	5111-22-0344	5111-22-0343	washer	2	0,029
E	5111-22-0357		bush	6	0,007

7.26

EXTERNAL DOOR GEAR KIT Ø22

EUROWIND

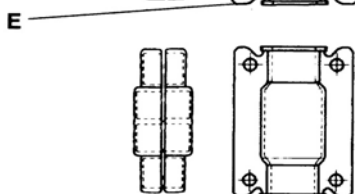
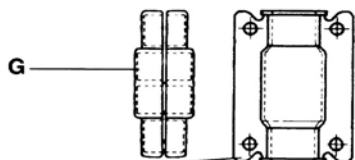
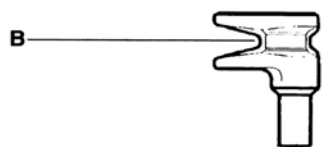

Ø22

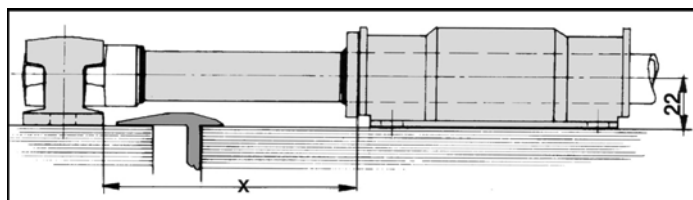

The anti-rack washer is welded onto the tube by the user.
Measurement X is therefore undefined.

CODE.		DESCRIPTION	Number	WEIGHT	
INOX	zinc plated				
5111-22-0404	5111-22-0403	external door gear kit for Ø22 mm tube		2,128	
A	5111-22-0314	5111-22-313	keeper	2	0,35
B	5111-22-0324	5111-22-323	cam	2	0,33
C	5111-22-0344	5111-22-343	washer	2	0,029
D	5111-22-0444	5111-22-0443	tube clamp big	2	0,25
E	5111-22-0334	5111-22-0333	tube clamp small	1	0,14
F	5111-22-0357		bush small	2	0,007
G	5111-22-0477		bush big	4	0,014

Ø22



1

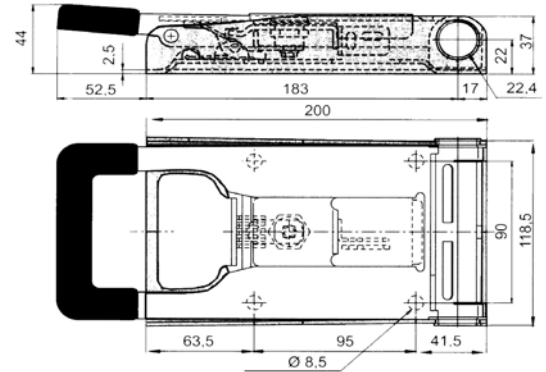

2

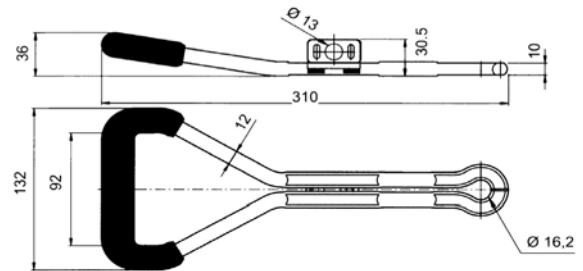

3

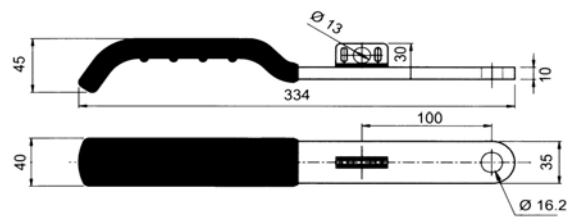

CODE.		DESCRIPTION	WEIGHT
1	INOX zinc plated 5115-22-0104	door handle	2,23
2	5115-22-0494 5115-22-0203	Lever	0,68
3	5115-22-0304 5115-22-0303	Lever	0,98

Ø22

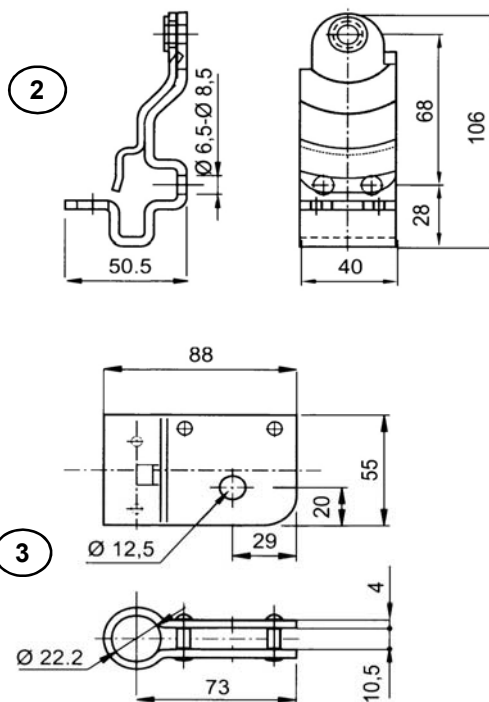
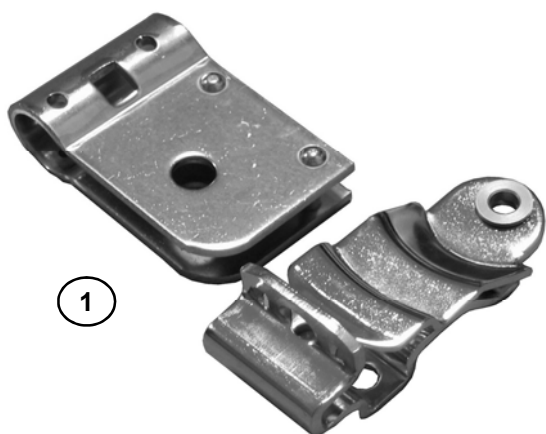

CODE.		DESCRIPTION	WEIGHT
INOX	zinc plated		
1	5115-22-0404	5115-22-0403 KIT lever stay and lever clamp	0,51
2	5115-22-0414	5115-22-0413 lever lock with holes for padlock and customs seal	0,24
2	5115-22-0424	5115-22-0423 lever lock with holes for padlock and customs seal	0,24
3	5115-22-0434	5115-22-0433 lever clamp	0,27

Ø22

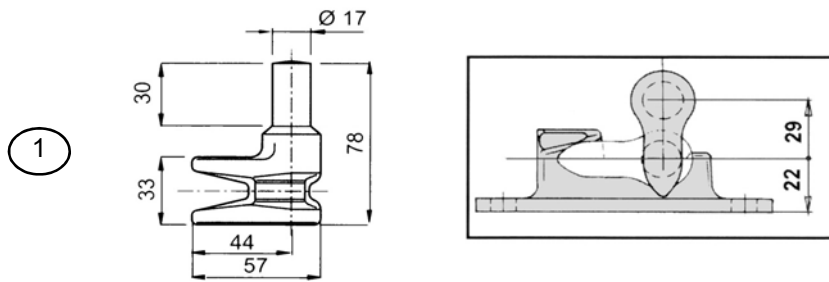

Difference in distance between centres of cam closed and open

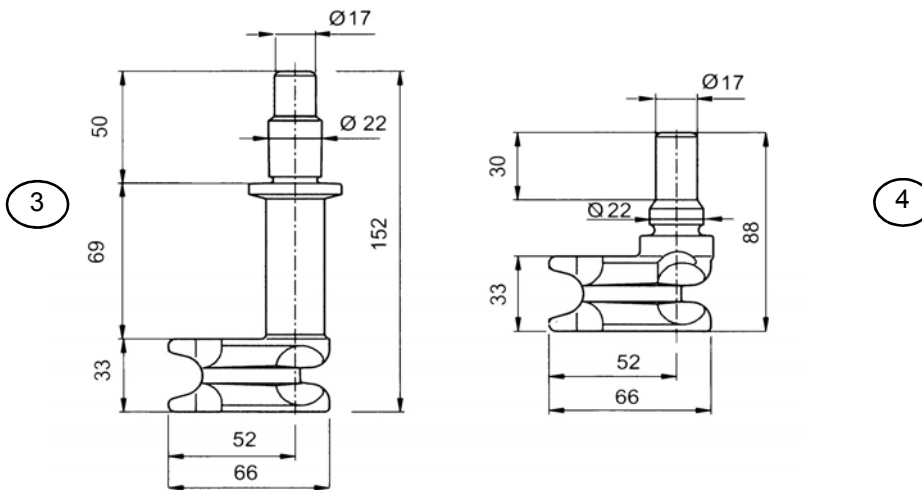
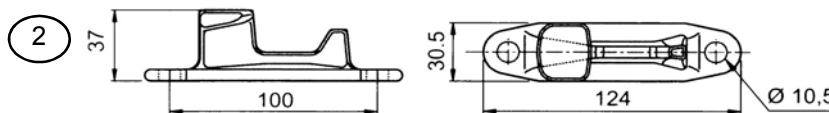

4

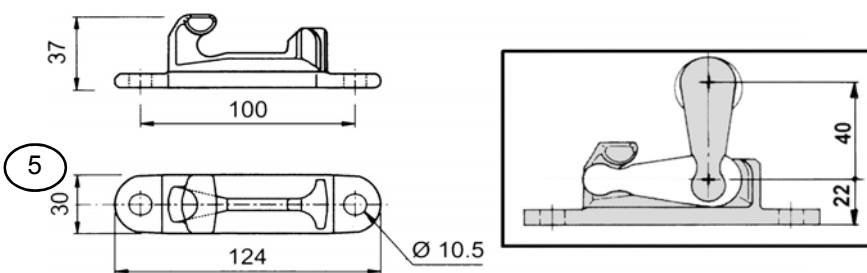

Difference in distance between centers of cam closed and open

CODE.		DESCRIPTION	WEIGHT
INOX	zinc plated		
1	5111-22-0324	5111-22-0323 cam	0,384
2	5111-22-0314	5111-22-0313 standard keeper	0,3
3	5111-22-0434	cam "BIG 9"	0,59
4	5111-22-0224	cam "BIG 6"	0,33
5	5111-22-0214	keeper for "BIG 6 - BIG 9"	0,34

7.30

EXTERNAL DOOR GEAR KIT Ø27

EUROWIND

Ø27

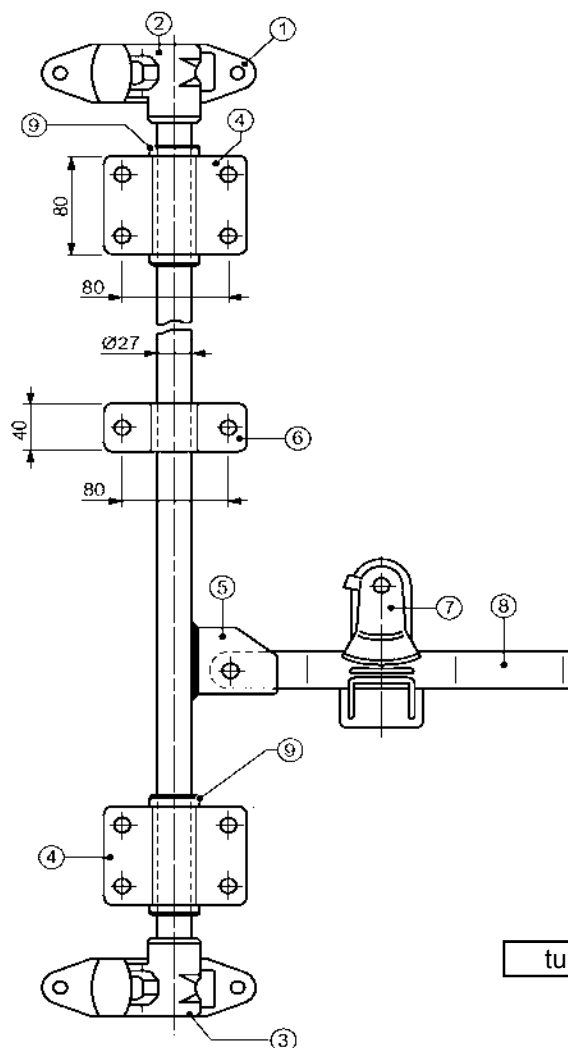

tube is not included in the set

CODE.	DESCRIPTION	Number	WEIGHT
5111-27-0103	EXTERNAL DOOR GEAR KIT Ø27 Zinc plated	1	3,85
1	5111-22-0113 keeper	2	0,38
2	5111-27-DX33 cam left	1	0,43
3	5111-27-SX23 cam right	1	0,43
4	5111-27-0143 tube clamp big	2	0,45
5	5111-2215DX3 lever clamp right	1	0,145
	5111-2215SX3 lever clamp left	1	0,145
6	5111-27-0163 tube clamp small	1	0,22
7	5111-22-0173 lever stay	1	0,34
	5111-2218DX3 lever right	1	0,82
8	5111-2218SX3 lever left	1	0,82
9	5111-27-0193 washer	2	0,05

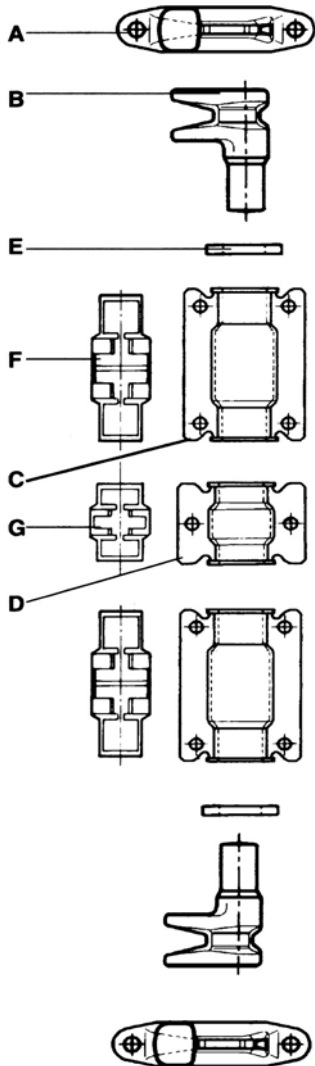

Ø27

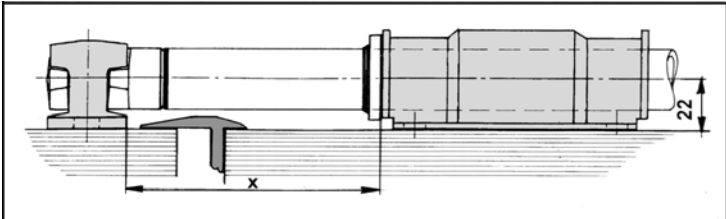

The anti-rack washer is welded onto the tube by the user. Measurement X is therefore undefined.

CODE.		DESCRIPTION	Number	WEIGHT	
INOX	zinc plated				
5111-27-0204	5111-27-0203	EXTERNAL DOOR GEAR KIT Ø27		2,032	
A	5111-22-0314	5111-22-0313	keeper	2	0,35
B	5111-27-0224	5111-27-0223	cam	2	0,33
C	5111-22-0444	5111-22-0443	tube clamp big	2	0,25
D	5111-22-0334	5111-22-0333	tube clamp small	1	0,14
E	5111-27-0254	5111-27-0253	washer	2	0,002
F	5111-27-0267		bush small	2	0,007
G	5111-27-0277		bush big	1	0,014

7.32

EXTERNAL DOOR GEAR KIT Ø27

EUROWIND

Ø27

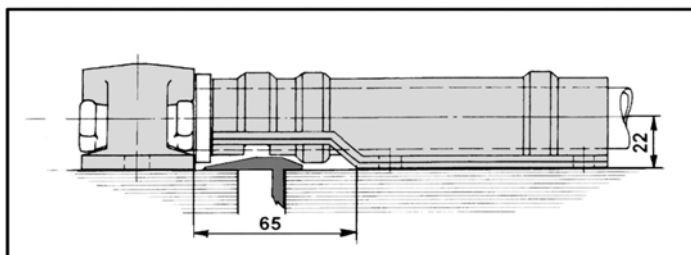
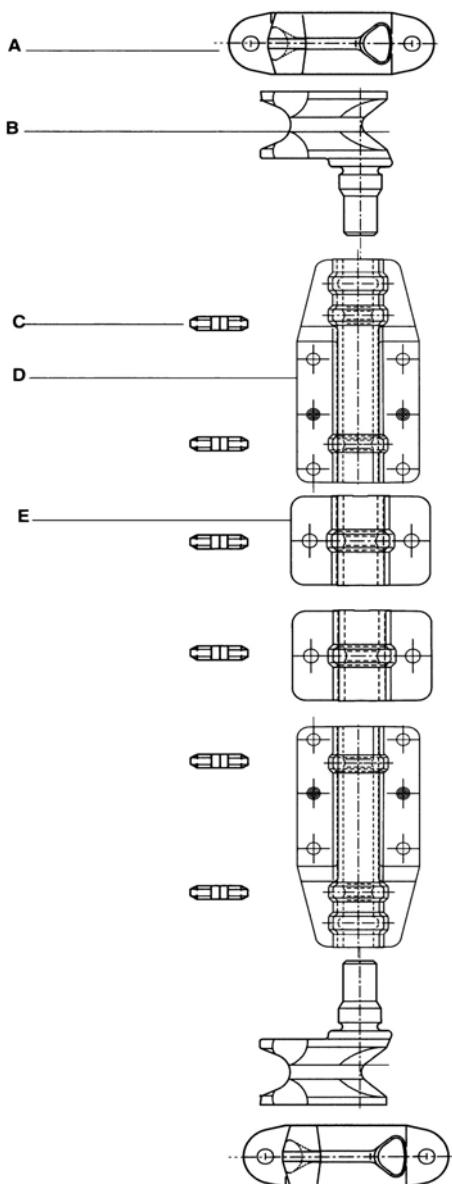

The anti-rack washer is an integral part of the forged cam so the measurement on the drawing cannot be modified.

CODE.	DESCRIPTION	Number	WEIGHT
INOX			
5111-27-0304	EXTERNAL DOOR GEAR KIT Ø 27 with "BIG 3" cam		4,252
A	5111-27-0314 keeper for "BIG 3"	2	0,57
B	5111-27-0324 cam for "BIG 3"	2	0,63
C	5111-27-0337 bush	6	0,002
D	5111-22-0244 tube clamp big	2	0,64
E	5111-22-0254 tube clamp small	2	0,28

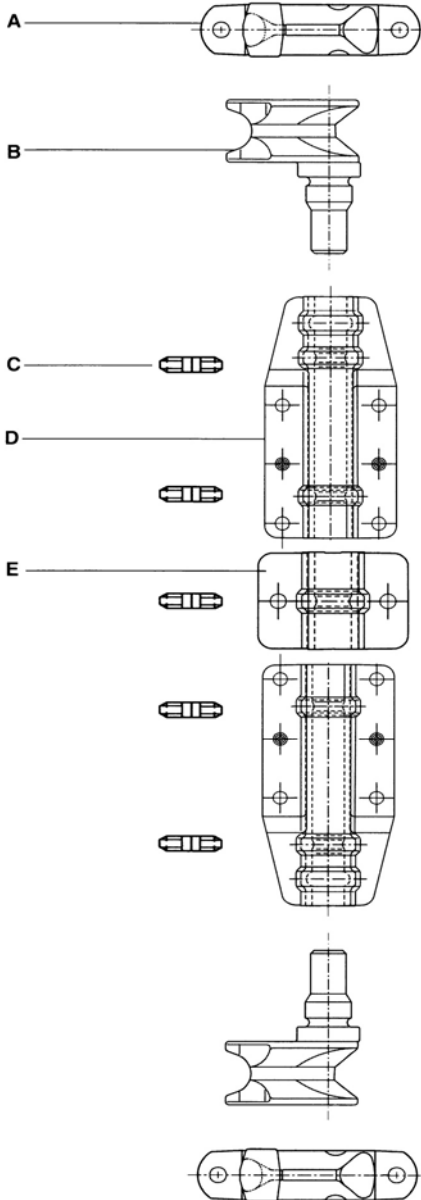

Ø27

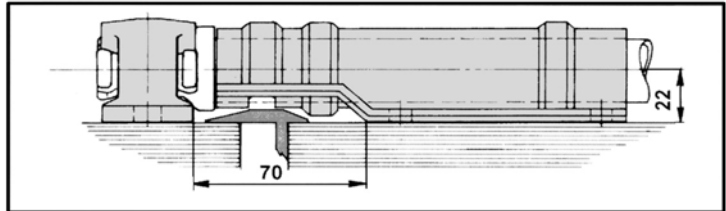

The anti-rack washer is an integral part of the forged cam so the measurement on the drawing cannot be modified.

CODE.		DESCRIPTION	Number	WEIGHT	
INOX	zinc plated				
5111-27-0404	5111-27-0403	EXTERNAL DOOR GEAR KIT Ø27 with "BIG 4" cam		3,656	
A	5111-27-0414	5111-27-0413	keeper for "BIG 4"	2	0,5
B	5111-27-0424	5111-27-0423	cam for "BIG 4"	2	0,543
C	5111-27-0337		bush	5	0,002
D	5111-22-0244	5111-22-0243	tube clamp big	2	0,64
E	5111-22-0254	5111-22-0253	tube clamp small	1	0,28

7.34

EXTERNAL DOOR HANDLES FOR Ø27 TUBE

EUROWIND

Ø27

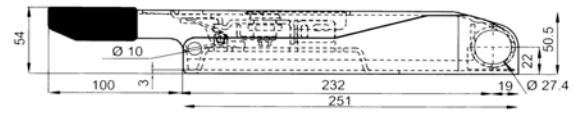

1

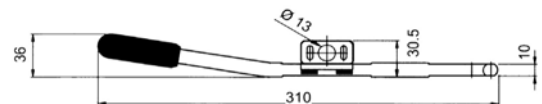
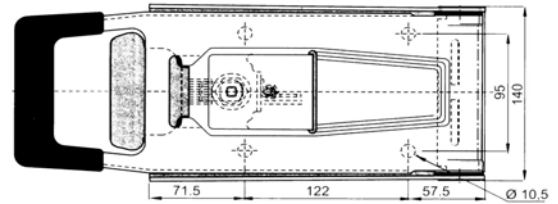

2

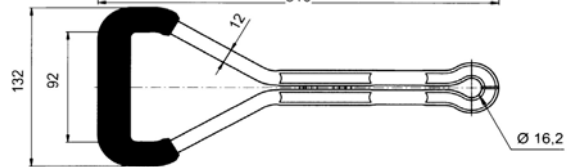

3

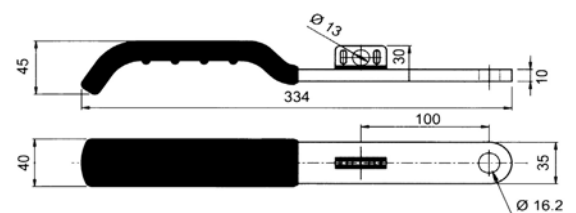

CODE.		DESCRIPTION	WEIGHT
1	INOX 5115-27-0104	zinc plated door handle	2,55
2	5115-22-0494	5115-22-0203 Lever	0,68
3	5115-22-0304	5115-22-0303 Lever	0,98

Ø27

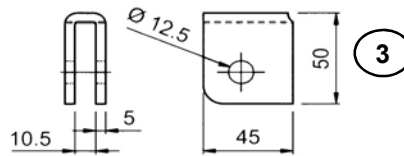
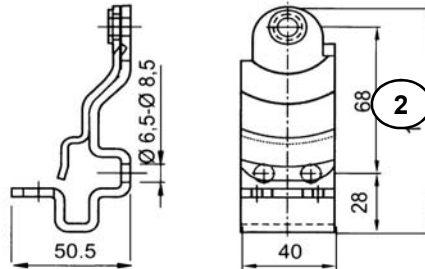

CODE.		DESCRIPTION	WEIGHT	
INOX	zinc plated			
1	5115-27-0504	5115-27-0503	KIT lever stay and lever clamp Ø27	0,51
2	5115-27-0414	5115-22-0413	lever lock with holes for padlock and customs seal Ø6,5	0,24
2	5115-22-0424	5115-22-0423	lever lock with holes for padlock and customs seal Ø8,5	0,24
3	5115-27-0514	5115-27-0513	lever clamp	0,27

7.36

**COMPLETING PARTS AND COMPONENTS FOR
Ø27**

EUROWIND

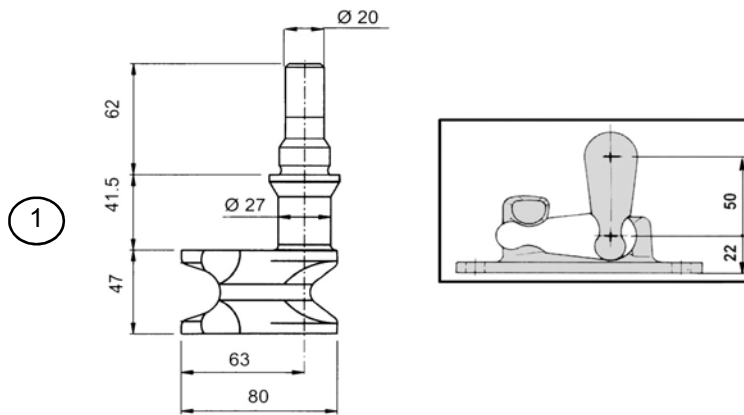
Ø27

Difference in distance between centres of cam closed and open

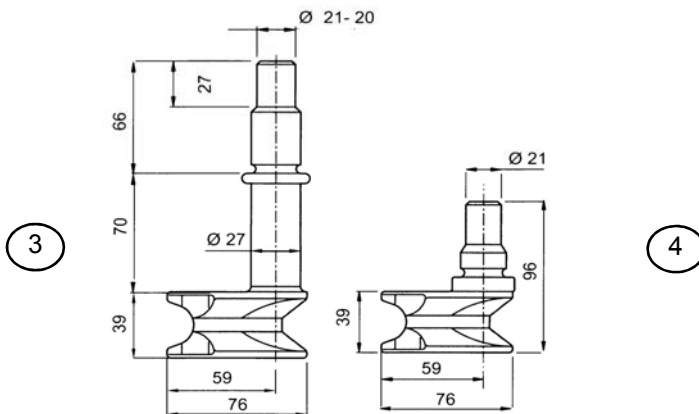
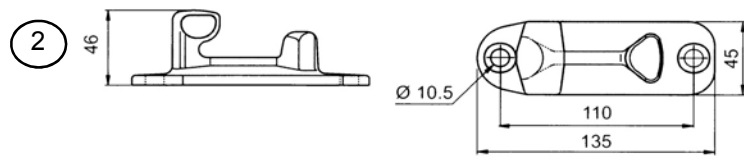

4

Difference in distance between centers of cam closed and open

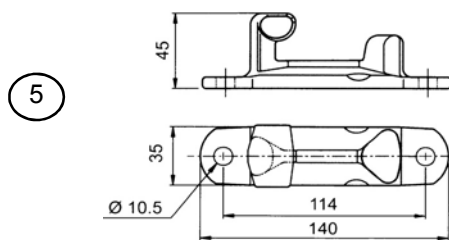
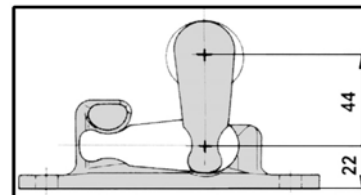

CODE		DESCRIPTION	WEIGHT	
	INOX			
	zinc plated			
1	5111-27-0454	cam "BIG 5" for shaft 27x3	0,77	
2	5111-27-0464	keeper	0,6	
3	5111-27-0474	cam "BIG 7" for shaft 27x2,5	0,89	
4	5111-27-0424	5111-27-0423	cam "BIG 4"	0,543
5	5111-27-0414	5111-27-0413	keeper for "BIG 4 - BIG 7"	0,5



1

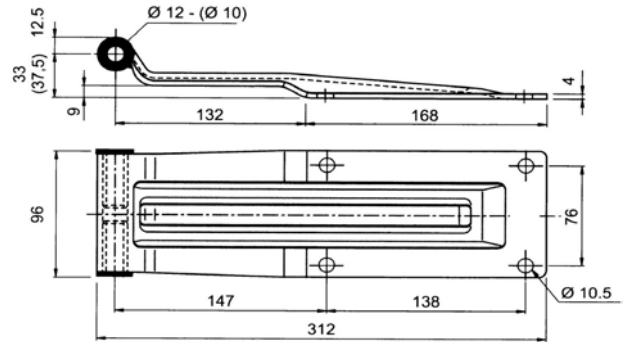

2

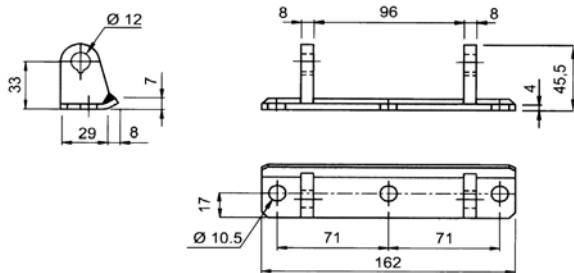

3

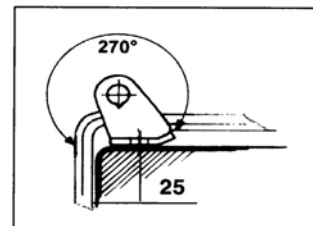
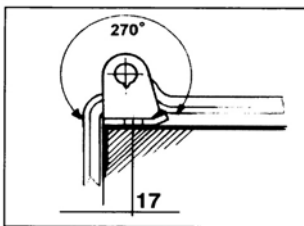
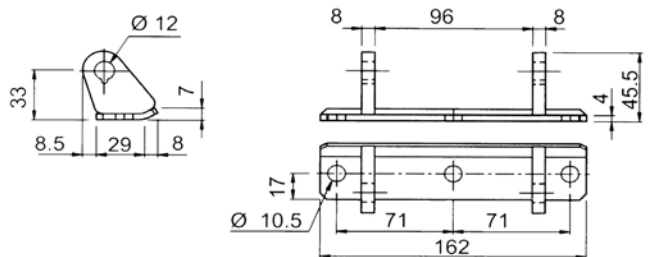

CODE.		DESCRIPTION	WEIGHT
INOX	zinc plated		
1	5120-285-014	5120-285-013 hinge	1,1
2	5120-285-024	flat bracket with pin and nut	0,43
3	5120-285-034	flat bracket with pin and nut	0,45

7.38

REAR DOOR HINGE AND BRACKETS

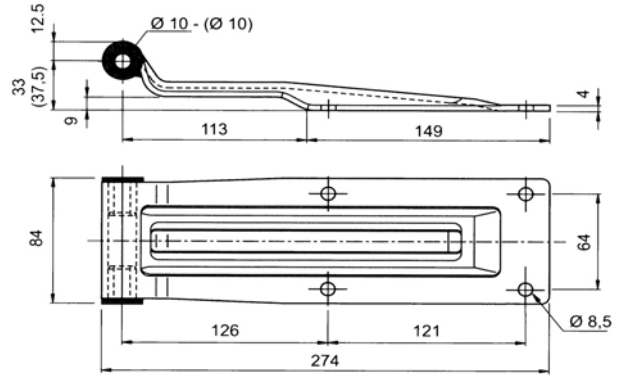

1



2

3

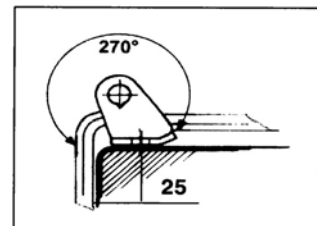
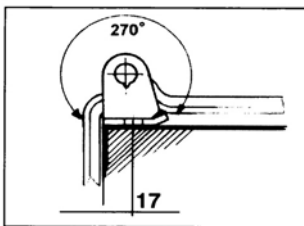
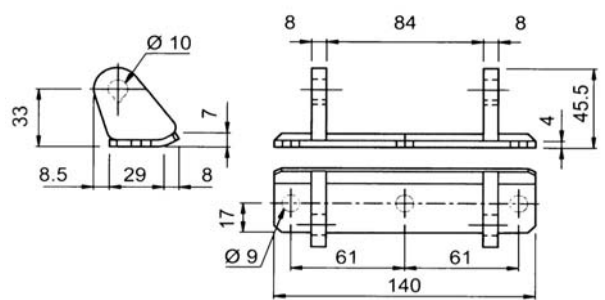
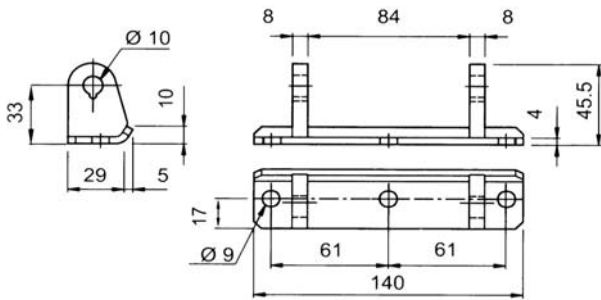

CODE.		DESCRIPTION	WEIGHT
1	INOX 5120-150-014	zinc plated 5120-150-013 hinge	1,1
2	5120-150-024	5120-150-023 flat bracket with pin and nut	0,353
3	5120-150-034	flat bracket with pin and nut	0,45

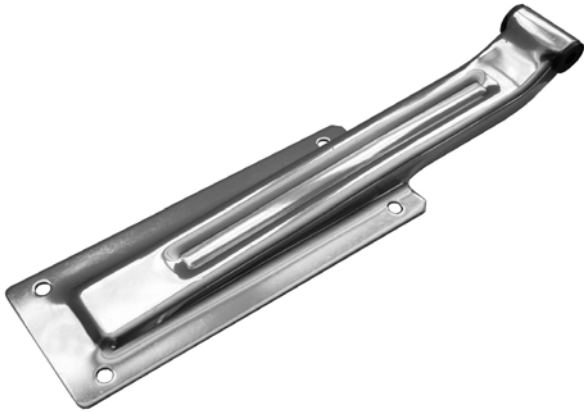

1

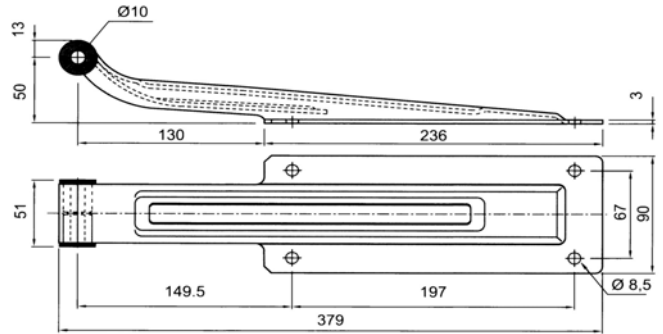

2

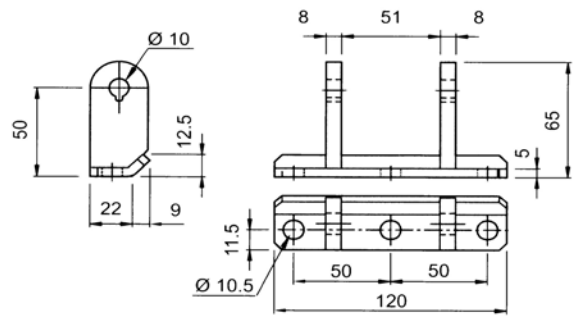

CODE.		DESCRIPTION	WEIGHT
INOX	zinc plated		
1	5120-365-014	5120-365-013 hinge	1,08
2	5120-365-023	5120-365-024 flat bracket with pin and nut	0,407

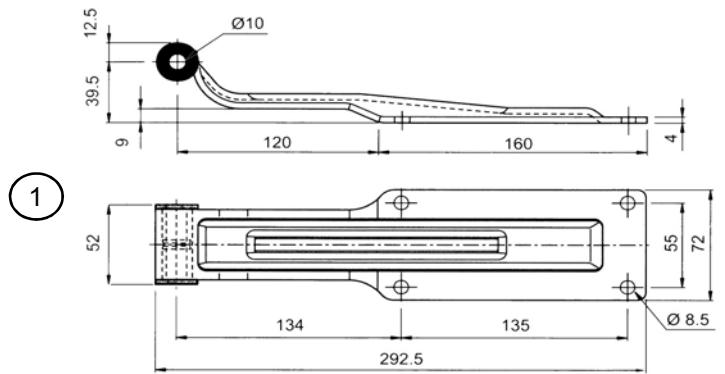

2



3

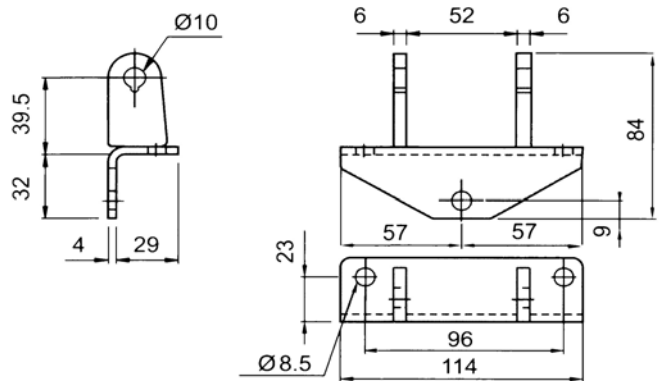
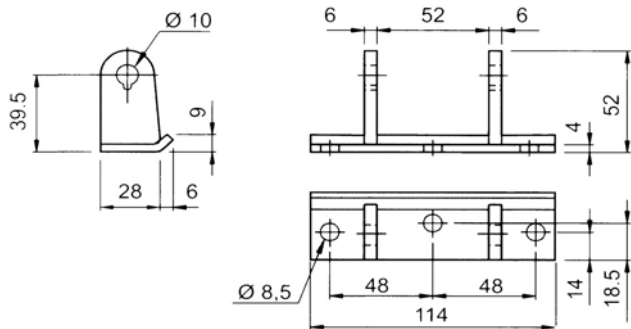

CODE.		DESCRIPTION	WEIGHT
INOX	POCINKOVAO		
1	5120-280-044	5120-280-013 hinge	0,66
2	5120-280-024	5120-280-023 flat bracket with pin and nut	0,29
3	5120-280-034	flat bracket with pin and nut	0,35

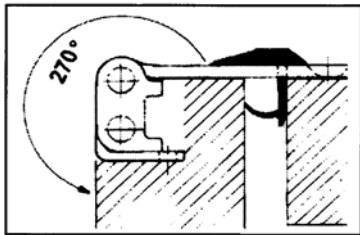

1

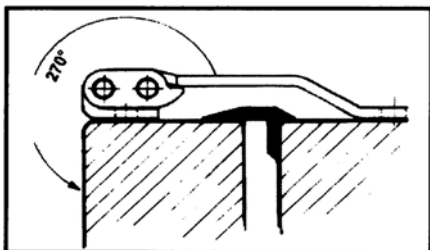
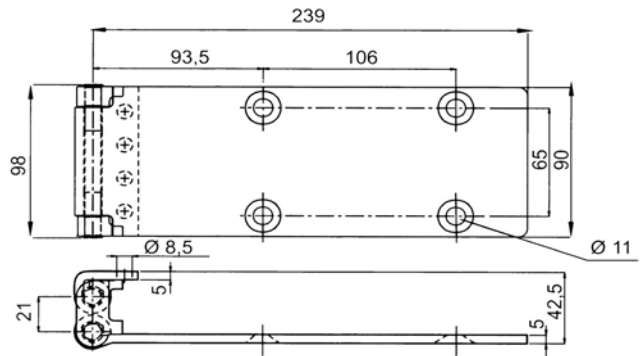

2

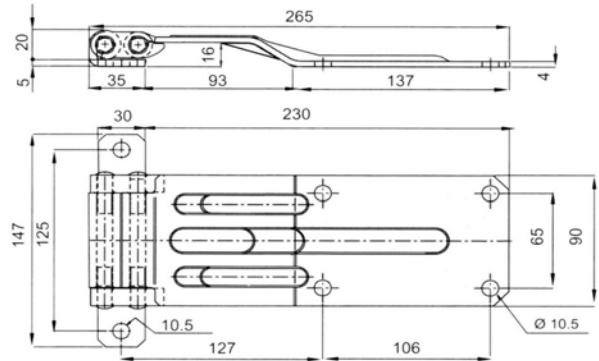

CODE.		DESCRIPTION	WEIGHT
1	INOX 5120-250-014	zinc plated hinge	1,278
2	5120-266-014	5120-266-013 hinge	1,225

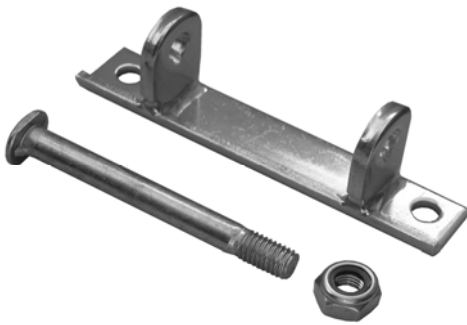
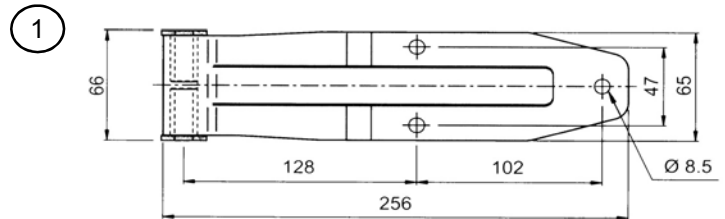
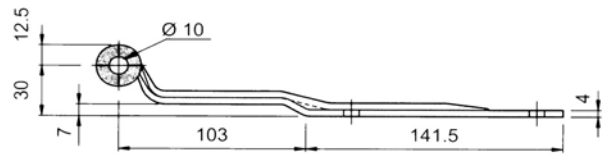

2

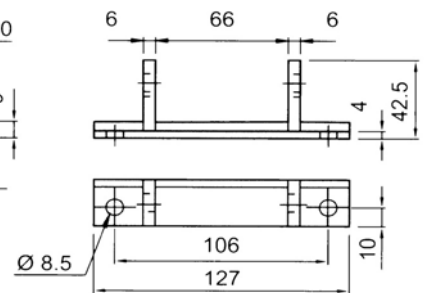
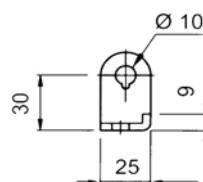

CODE.		DESCRIPTION	WEIGHT
1	INOX 5120-245-014	HORGANY. 5120-245-013 hinge	0,58
2	5120-245-024	5120-245-023 flat bracket with pin and nut	0,247

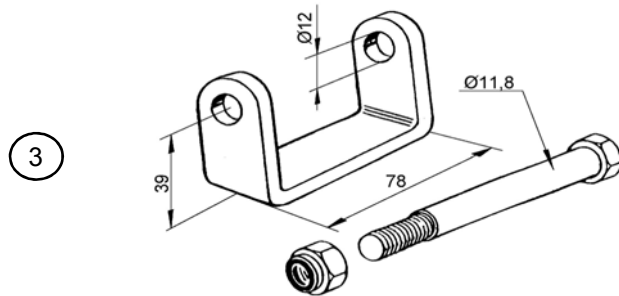
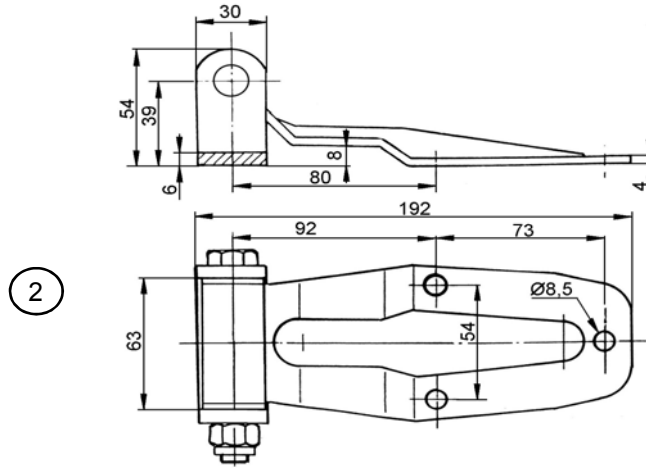
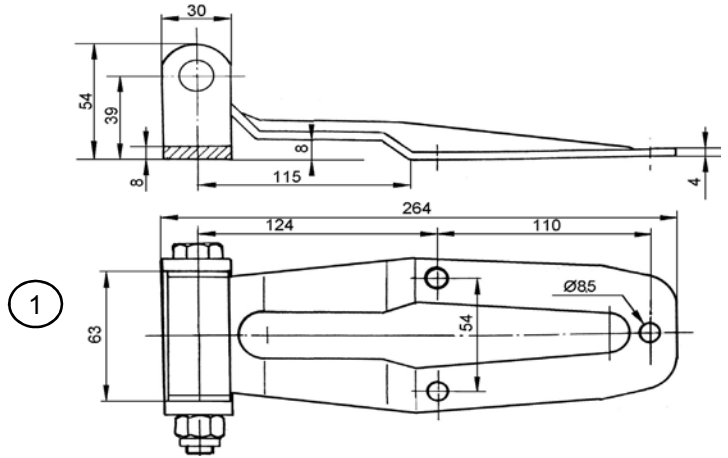

CODE.		DESCRIPTION	WEIGHT
1	INOX 5120-264-014	zinc plated hinge	0,64
2	5120-264-024	hinge	0,5
3	5120-264-034	flat bracket with pin and nut	0,2

7.43.1

REAR DOOR HINGE AND BRACKETS

EUROWIND

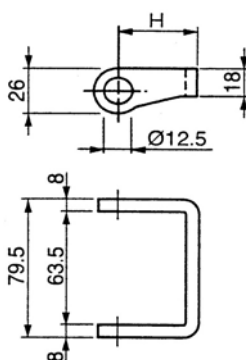
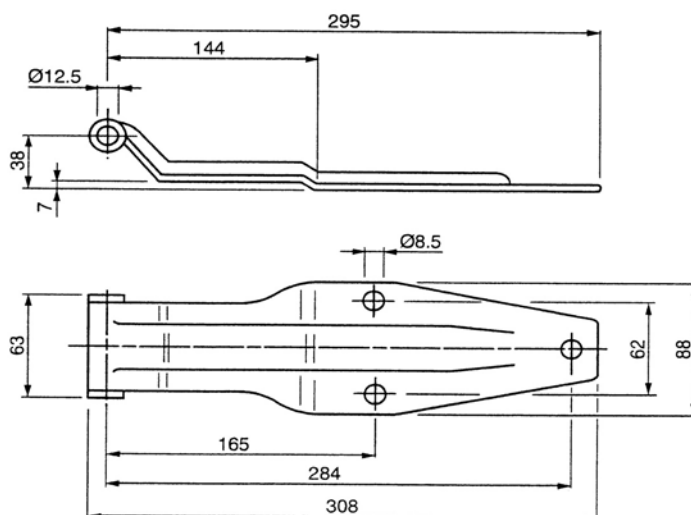

CODE		DESCRIPTION	WEIGHT
INOX	ZINC PLATED		
1	5153-308-013	hinge 308 mm	0,64
2	5153-102-018	flat bracket with pin and nut 308 mm	0,19

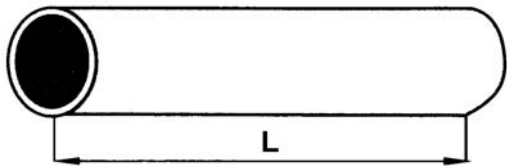

5121-606-012

5121-607-012

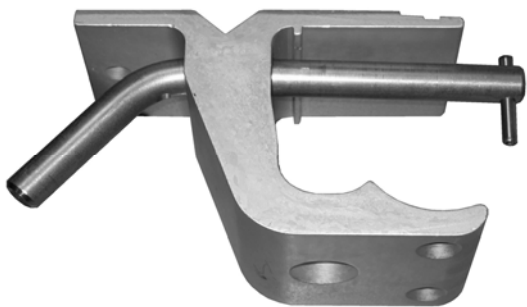
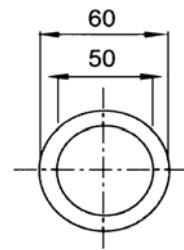

5121-010-2

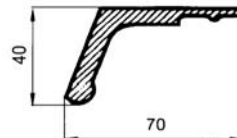
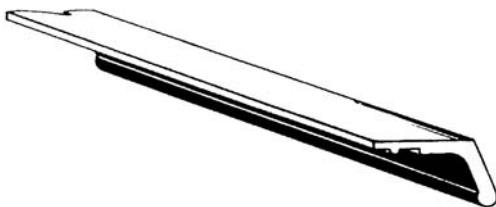
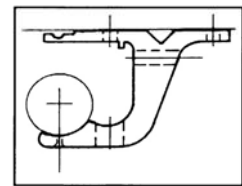
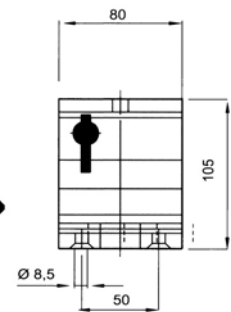
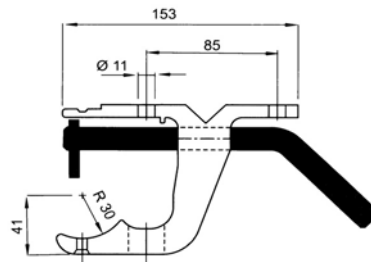

5121-001-2

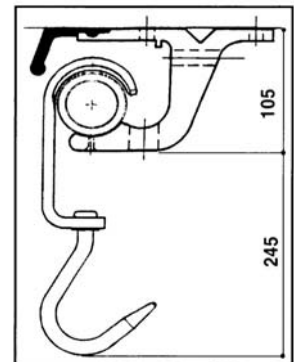

CODE.	DESCRIPTION	SURFACE	WEIGHT
5121-606-012	aluminium tube L=6000 mm	elox	14
5121-607-012	aluminium tube L=7000 mm	elox	16
5121-010-2	tube bracket	elox	1,295
5121-001-2	aluminium hook stop profile	elox	15

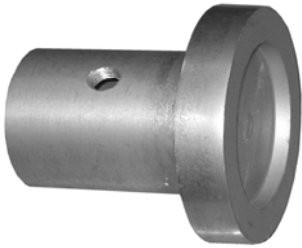

5121-60-012

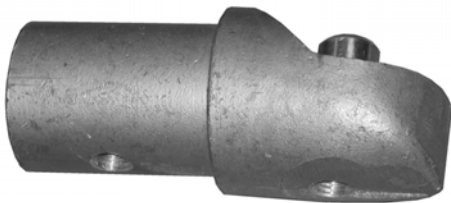
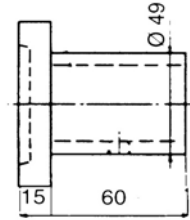

5121-60-022

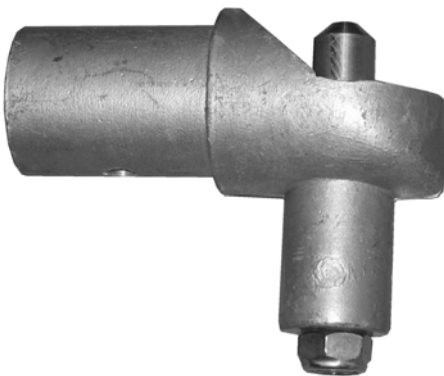
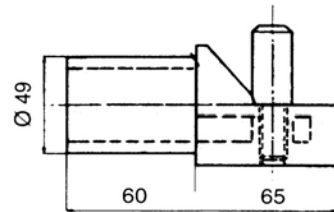

5121-60-032

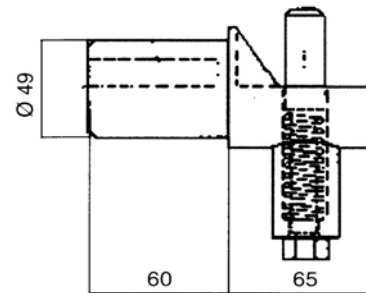

CODE.	DESCRIPTION	SURFACE	WEIGHT
5121-60-012	front cap	elox	0,29
5121-60-022	rear cap	elox	0,42
5121-60-032	rear cap	elox	0,74

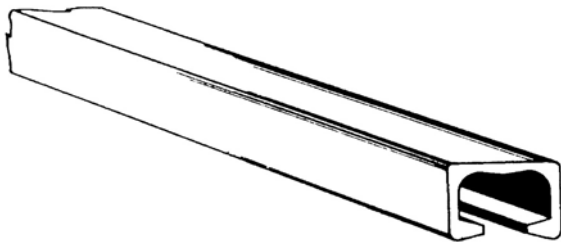

5121-406-012

5121-409-022

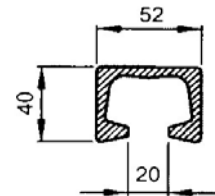

5121-40-022

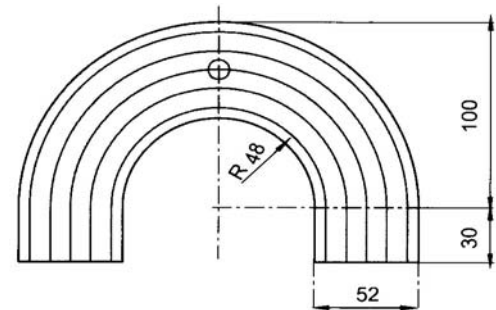

5121-010-4

5121-020-4

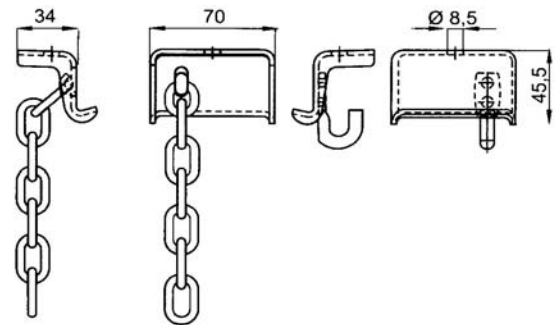

CODE.	DESCRIPTION	SURFACE	WEIGHT
5121-406-012	aluminium rail L=6000 mm	elox	13
5121-409-012	aluminium rail L=7000 mm	elox	15
5121-40-022	aluminium bend	natur	0,67
5121-010-4	set of two bracket with chain	inox	0,38
5121-020-4	set of two bracket without chain	inox	0,35



5121-030-4

EURO HOOK corresponding DIN 5047 standards, , shank of steel, hook AISI 316 inox

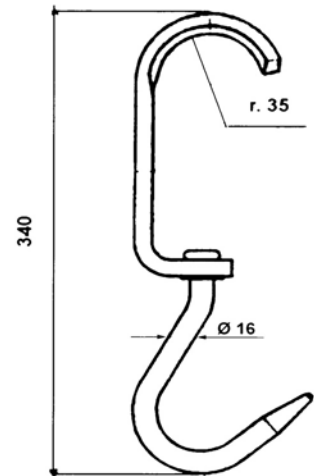

5121-040-4

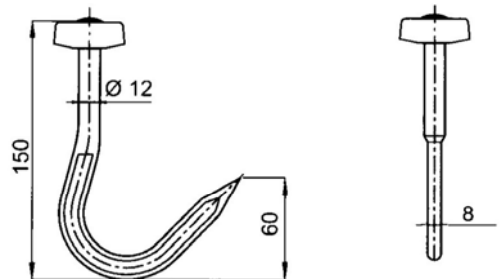

5121-050-4

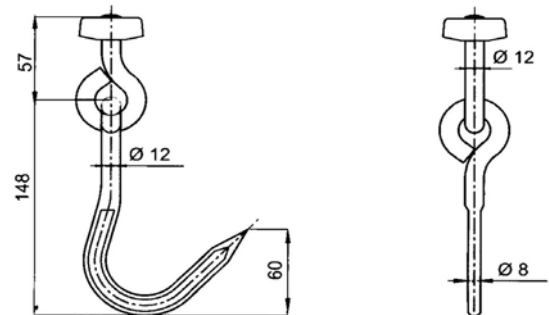

CODE.	DESCRIPTION	SURFACE	WEIGHT
5121-030-4	hook for tube Ø60	z pl./inox	1,35
5121-040-4	hook fixed with nylon washer	inox	0,15
5121-050-4	articulated hook with nylon washer	inox	0,4

7.48

RECESSED CEILING LIGHT

EUROWIND



5122-010-4

5122-020-4

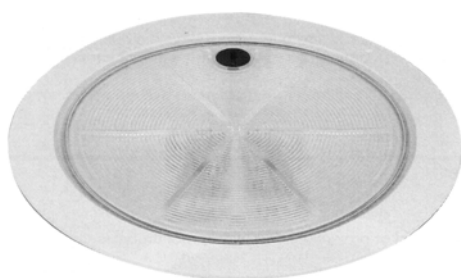
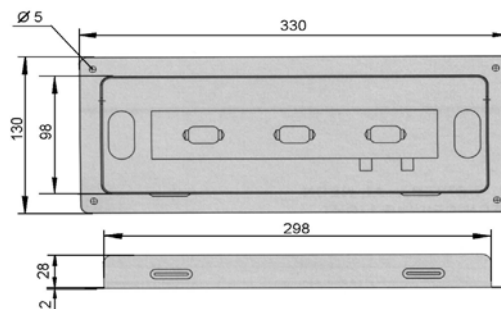

5122-030-7

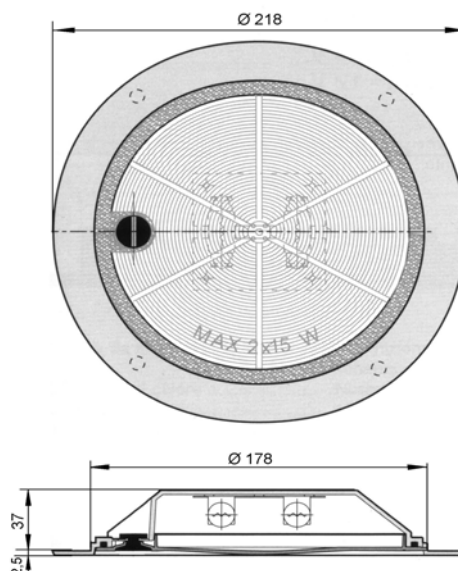

CODE.	DESCRIPTION	SURFACE	WEIGHT
5122-010-4	recessed ceiling light 24V	inox	0,32
5122-020-4	recessed ceiling light 12V	inox	0,32
5122-030-7	recessed ceiling light d=178	plastic	0,27



5123-011-4

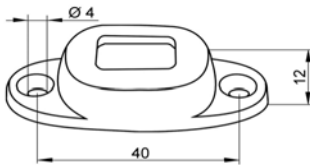

5123-012-6



5123-013-4

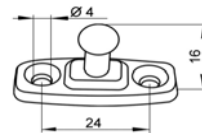

5123-020-G

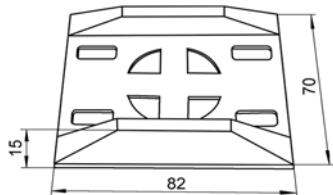

5123-021-7

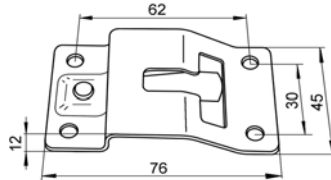

5123-022-4

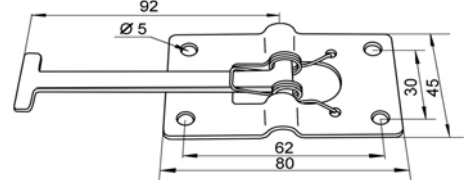

5123-023-4

CODE.	DESCRIPTION	SURFACE	WEIGHT
5123-011-4	housing	aluminium	0,012
5123-012-6	rubber female piece	rubber	0,004
5123-013-4	pin	aluminium	0,006
5123-020-G	door stay with spring return set	inox	0,186
5123-021-7	PVC protection plate	plastic	0,003
5123-022-4	flush female part	inox	0,05
5123-023-4	male part of door stay	inox	0,13

7.50

UNDER CHASSIS DOOR RETAINERS

EUROWIND



5123-030-4

5123-040-3

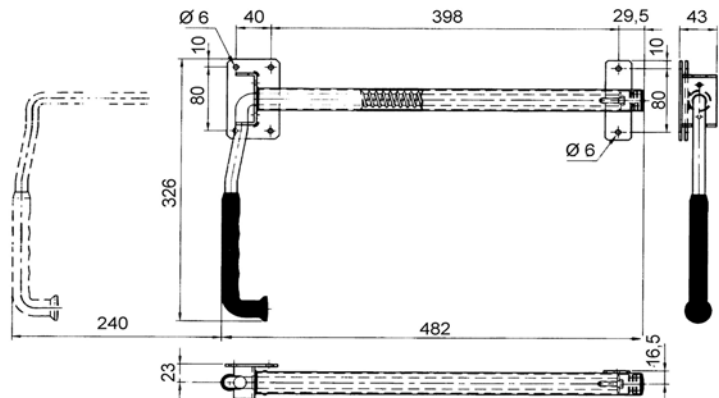

5123-050-4

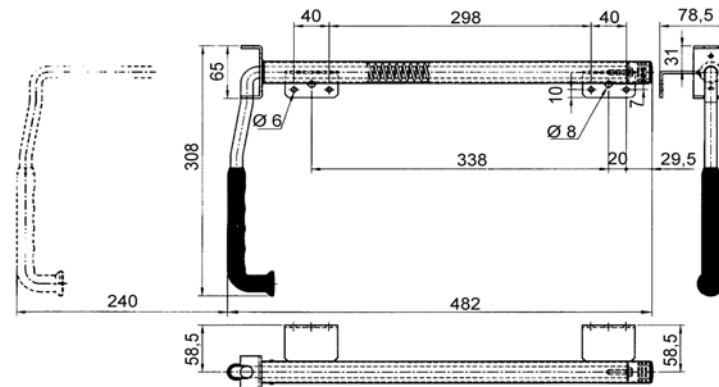

CODE.	DESCRIPTION	SURFACE	WEIGHT
5123-030-4	door retainer with ss spring 482 mm	inox	2
5123-040-3	door retainer with ss spring 482 mm	zinc plated	2
5123-050-4	door retainer with ss spring 482 mm	inox	1,14

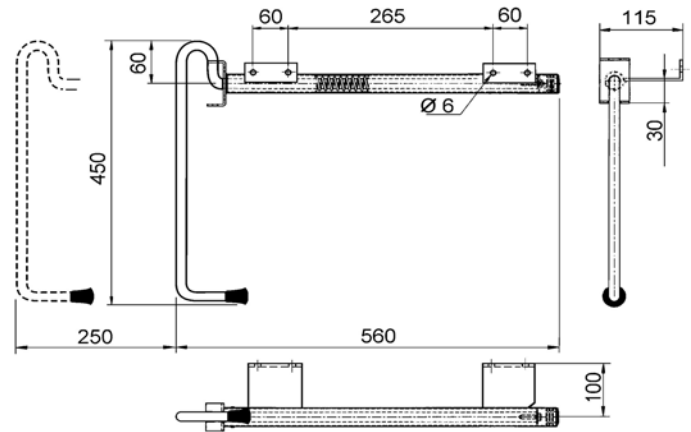

5123-060-4

CODE.	DESCRIPTION	SURFACE	WEIGHT
5123-060-4	door retainer with ss spring 560 mm	inox	2,8

