

## Portable Dot Peen Marking Machine (HS-PC)

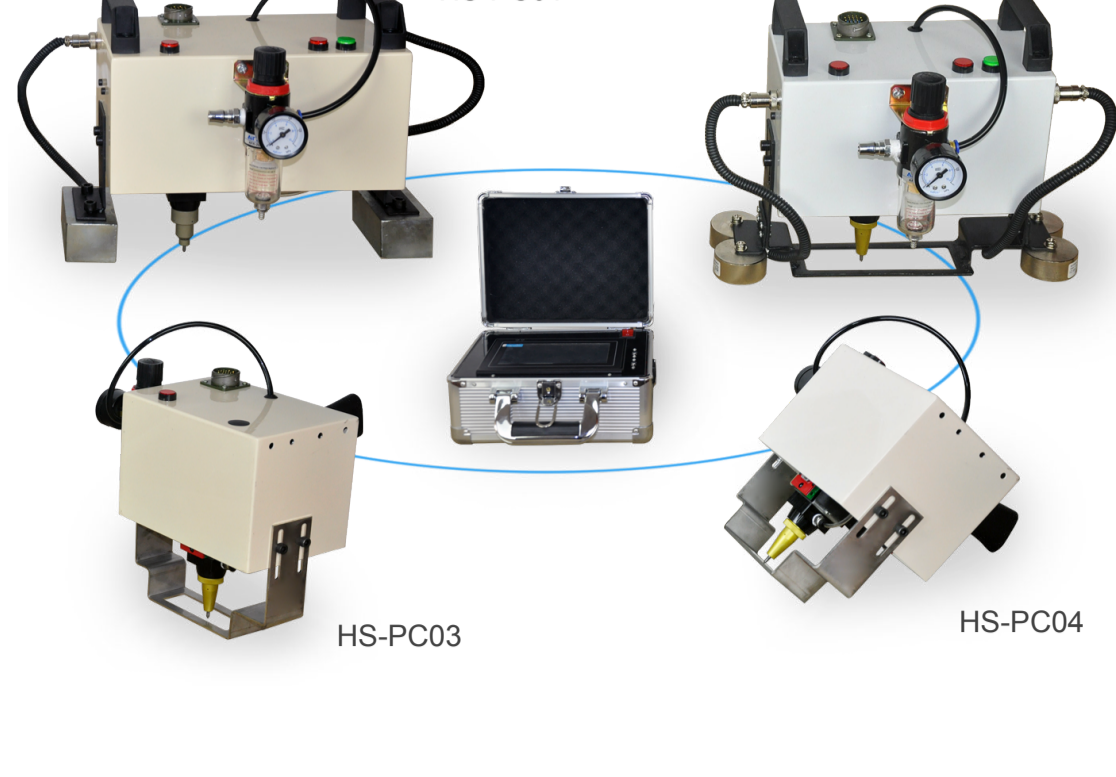

### HS-PC series:

- Marking Area:150mm x 50mm(HS-PC01)  
With electromagnetic basement
- Marking Area:120mm x 40mm(HS-PC02)  
With frame electromagnetic basement
- Marking Area:80mm x 25mm(HS-PC03)  
With frame window basement
- Marking Area:50mm x 25mm(HS-PC04)  
With frame window basement

## Portable Dot Peen Marking System



The HS-PC Series Portable Dot Peen Marking System is designed for marking heavy, large metal parts such as car chassis and VIN numbers. The machine controller comes fully integrated with software, touch screen and keyboard, eliminating the need for a PC. The lightweight portable head and a CNC controller combine to offer the best user experience through superior portability and convenience.



The HS Marking Dot Peen technology ensures consistent impact of the marking pin on the product surface, leading to clear and permanent marks. Round Text Marking and 2D Data matrix codes etc. is made possible through our software.

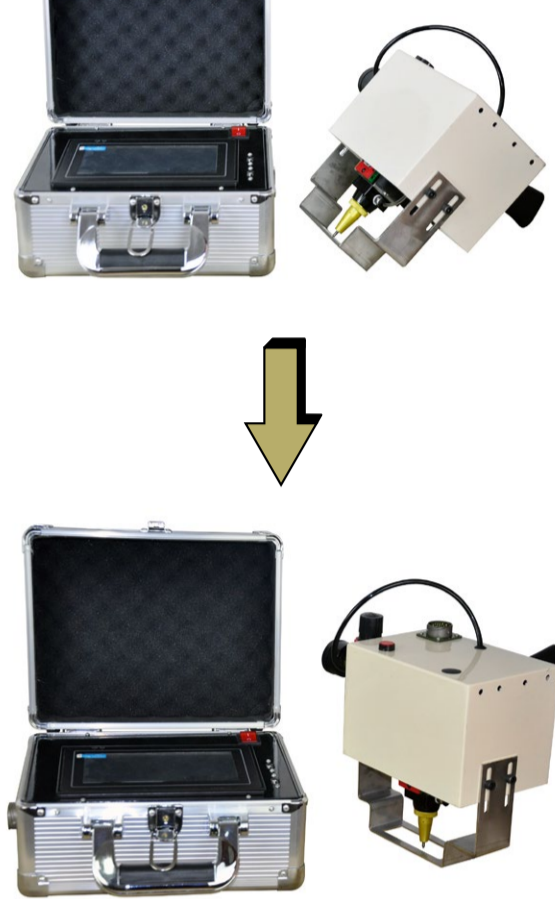

- Offers standard X-Y motion
- The imported stepper motor enhances stability
- The Dot Peen marking system requires air power
- The HS-PC series with CNC controller, integrated touched screen and software
- Hardened alloy tungsten marking pins make deep and clear marking

## Features & Benefits

### Performance

- Deep marking with hard alloy tungsten pins
- High marking precision and accuracy
- Marks on various materials in a variety of applications
- Marking speed of 30mm – 40mm/s
- Marks with ease up to a hardness of 60 HRC

### Ease of Use

- Compact and easy to install
- Robust shell offers strong shock resistance
- Easy to operate. No training required
- Low maintenance with 1-year marking-pin life
- Low electrical consumption

### Portability

- Lightweight marking head
- High flexibility
- CNC controller eliminates the need for PC

### Customization

- Marking window sizes as required
- Electromagnetic basement offers stability

## Applications

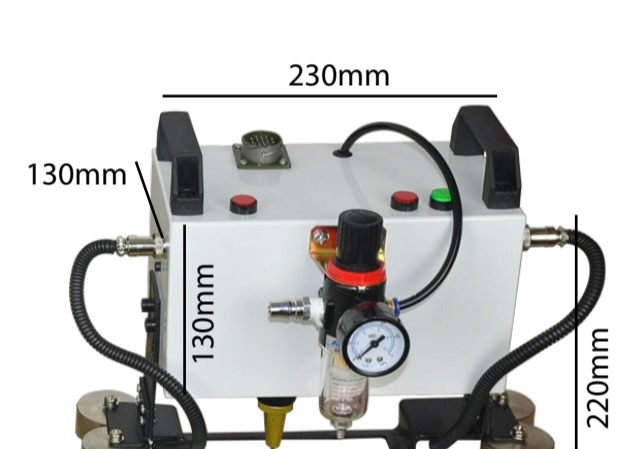
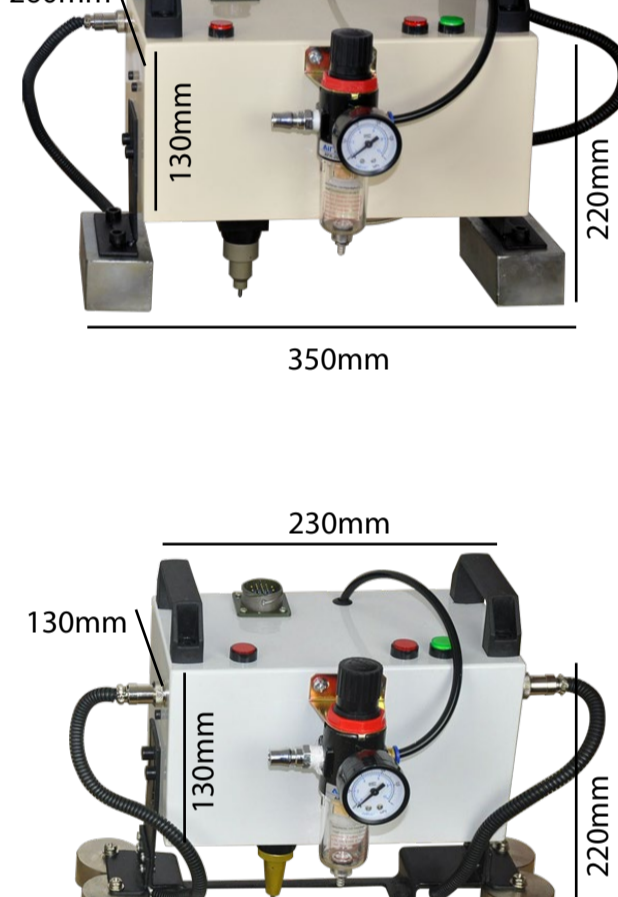
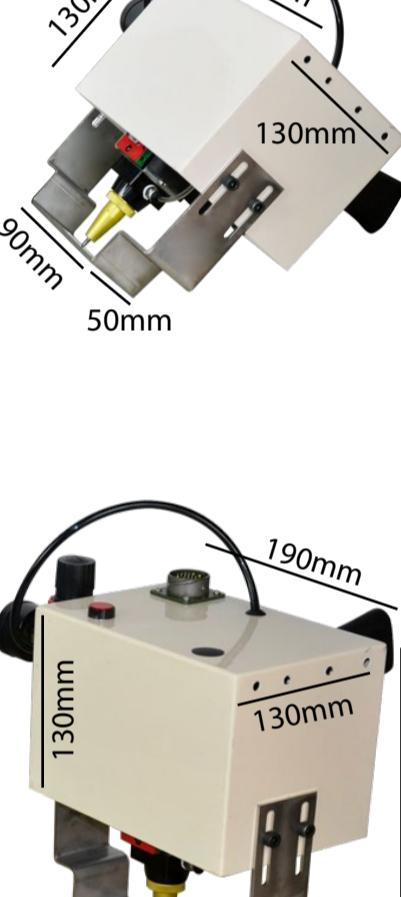

Model	HS-PC01	HS-PC02	HS-PC03	HS-PC04
Standard Marking Area	150mm x 50mm/120mm x 40mm/80mm x 25mm/50mm x 25mm			
Base Support	Electromagnetic basement	Frame and electromagnetic basement	Frame window basement	Frame window basement
Marking Speed	30mm~40mm/s			
Impact Frequency	300 times/s			
Repeated Accuracy	0.001mm			
Marking Depth	0.1mm~2mm (depends on material)			
Power Supply	AC220V 50Hz or AC110V 60HZ			
Air Power Request	0.2Mpa~0.6Mpa			
Humidity	0-90% (Non-condensing)			
Temperature	From 0 to 40 Centigrade Degree.			
Marking Content	English characters, number, all kinds of graphic, logo, dot matrix 2D codes, Barcode, Serial Number, circle Letter and etc.			
Software Compatible	Windows 98/XP/7 32bit (KT-PB series integrate software, keyboard and screen, no need connect to PC)			

## Applications

The Dot Peen marking system serves several industries beautifully. Our marking engraving machine fulfills the marking needs of the Aerospace, Electronics, Metal Processing, Vehicle, Medical and other industries. It offers efficiency and accuracy combined with utmost convenience.



### Marking

- Direct Part Marking (DPM)
- Component Identification & Traceability
- VIN code/numbers
- Serial Numbering
- Lot Numbering
- Metal marking and engraving (Aluminum, steel, copper etc.)
- Plates, tags, labels and pipes
- Logos
- Cast & Forge
- Security codes
- Health & safety appliances
- Time & date
- Equipment parts

## Options & Accessories

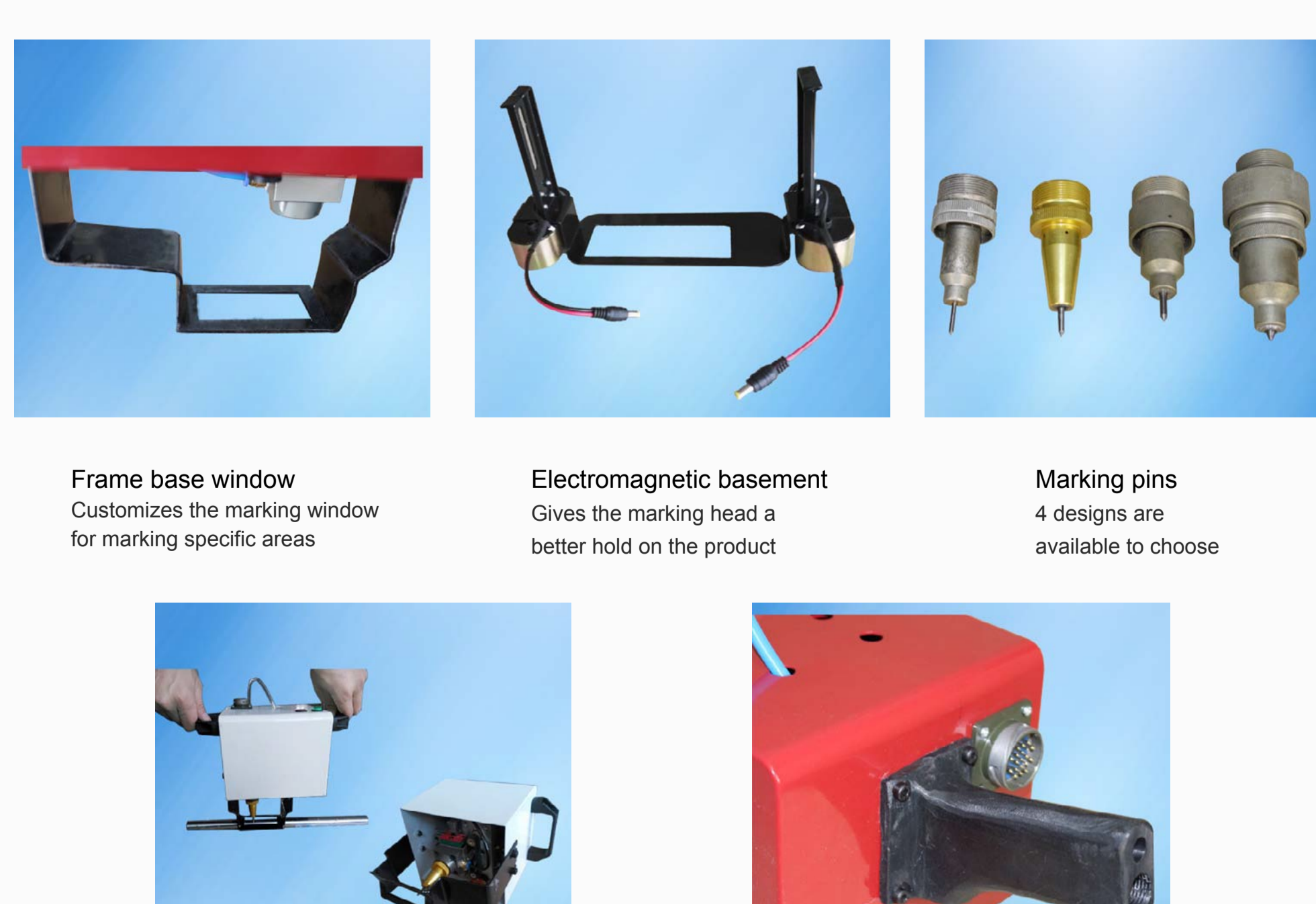

**Frame base window**  
Customizes the marking window for marking specific areas

**Electromagnetic basement**  
Gives the marking head a better hold on the product

**Marking pins**  
4 designs are available to choose



**V basement**  
For the tube or pipe marking



**Rotary device**

We customize to your requirement. Please contact us at: