



Ball Bearings



Industriepark Guldendelle
 Joseph Chantraineplantsoen, 5
 3070 KORTENBERG - BELGIUM
 TEL : +32-2-758 00 70 - FAX : +32-2-758 00 75
 E-MAIL : info@mtk-bearings.com
 www.mtk-bearings.com

Motion, Technology & Knowledge

MOTION, TECHNOLOGY & KNOWLEDGE



BALL BEARINGS

SINGLE-ROW DEEP GROOVE BALL BEARINGS

AVAILABLE SERIES

600 - 6000 - 6200 - 6300 - 6400 - 16000
61800 - 62200 2RS - 63000 2RS - 61900

AVAILABLE VERSIONS

Z(R) - ZZ(R) : one or two metal shields
RS(R) - 2RS(R) : one or two rubber seals
NR : circular groove on the outer ring with snap ring
N : circular groove for snap ring on the outer ring

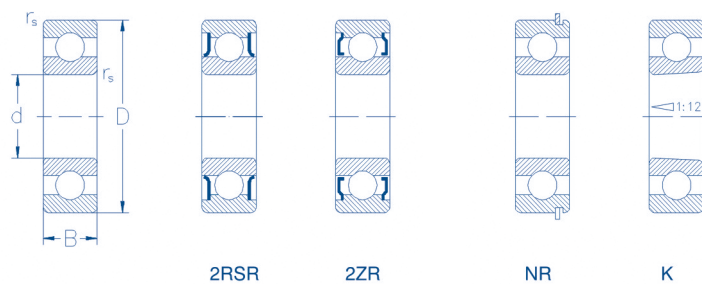

Bearings sealed and shielded on both sides are delivered filled with a Lithium based grease and can be used at temperatures between -30°C and +110°C.

MTK+ is offering the most popular ball bearings also in stainless steel, in ZZ and/or 2RS version.

Material used :

Stainless steel quality AISI 440 C for outer ring, inner ring and balls, stainless steel quality AISI 300 for cage and for the metal ring inside the seals.

MTK+ Manufactured According ISO & DIN Standards

SINGLE- & DOUBLE-ROW ANGULAR CONTACT BALL BEARINGS

AVAILABLE SERIES

Single-row :
7000 - 7200 - 7300

Double-row :
3200 - 3300

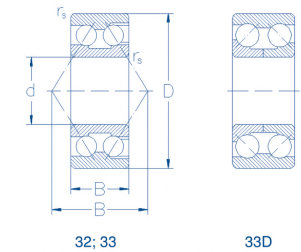
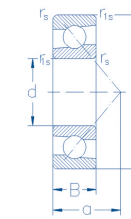

Angular contact ball bearings are non-separable and are designed to accommodate radial and axial loads. They can carry the axial loads in one direction only. For this reason, they are often mounted in pair. The angular contact ball bearings are suitable for high speed applications.

AVAILABLE VERSIONS

B : standard version – contact angle of 40°

A : contact angle of 25°

C : contact angle of 15°

All versions are also available for paired (universal matching) use, suffix BCB

SELF-ALIGNING BALL BEARINGS

AVAILABLE SERIES

1200 - 1300 - 2200 - 2300

AVAILABLE VERSIONS

Open : standard version of the basic design

2RS : sealed

K : tapered bore (taper 1:12)

K-2RS : combination of the above

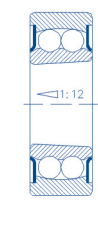
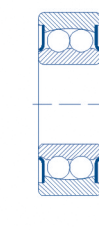
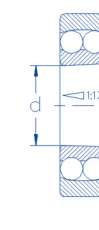
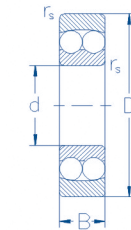

Self-aligning ball bearings have two rows of balls and they have a sphered raceway in the outer ring. This feature allows angular misalignment of the shaft in relation to the housing.

THRUST BALL BEARINGS

AVAILABLE SERIES

Single acting :
51100 - 51200 - 51300 - 51400

Double acting :
52200 - 52300 - 52400

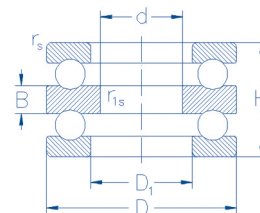
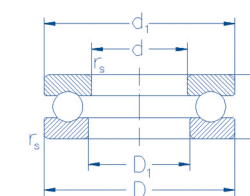

Thrust ball bearings are manufactured in two versions : single and double acting. Both designs can carry heavy axial (or thrust) loads in two directions. They cannot be used where radial loads are present. A thrust ball bearing is separable and is made up of a shaft washer, a housing washer with flat support surface and the ball and cage assembly.

More technical info on **MTK+** spherical roller bearings is available in our **catalogue** or via www.mtk-bearings.com