

# SAFELANE

## PANIC ALARM

Highway Resource Solution’s award winning Intellicone Safelane system helps deter workzone incursions by errant vehicles, and if they cannot be prevented warns the workforce of such events.

The Panic Alarm system provides Traffic Management (TM) Operatives at works entrance points with the ability to instantly alert the workforce regardless of distance or location.

A typical set up consists of a Red audio-visual Portable Site Alarm (PSA) with wearable panic buttons and optional camera as well as a Blue PSA for positioning near the workforce.

The Red PSA can be activated by TM Operatives at the work entrance in case of an incursion by errant or emergency vehicles. This will trigger a loud audio-visual alarm and optional camera as a deterrent whilst simultaneously activating the Blue PSA(s) positioned near the workforce.

### “RAISING THE BAR WITH SAFELANE”

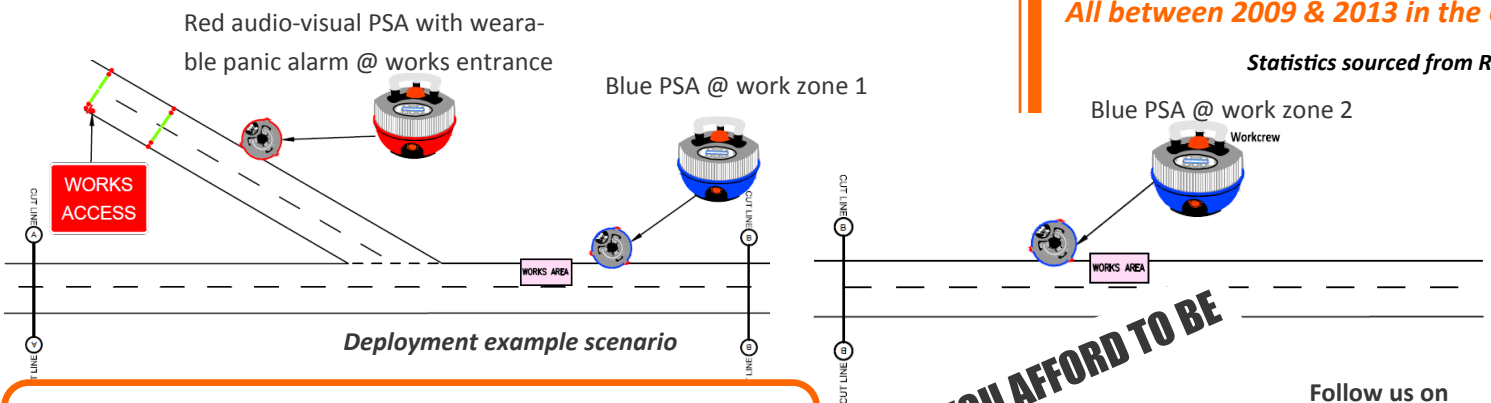

- **PROVEN AND AWARD WINNING**
- **INSTANT INCURSION ALERT**
- **AUDIO-VISUAL DETERRENT**



### SITUATION

*8 roadworkers killed*

*126 seriously injured*

*All between 2009 & 2013 in the UK*

*Statistics sourced from RSMA*

[www.highwayresource.com](http://www.highwayresource.com); [www.intellicone.co.uk](http://www.intellicone.co.uk)

**0800 206 13 19**

**CAN YOU AFFORD TO BE WITHOUT**

Follow us on



# HOW?



## Portable Site Alarm Red with CCTV and Panic Button

- For works access
- Audio-visual alarm with optional camera
- Panic button activated (wireless)
- GPS tracked & GSM & 3/4G enabled



## Portable Site Alarm Blue

- For work area
- Audio-visual alarm
- Activated by PSA Red (no limitation in distance)
- GPS tracked & GSM & 3/4G enabled

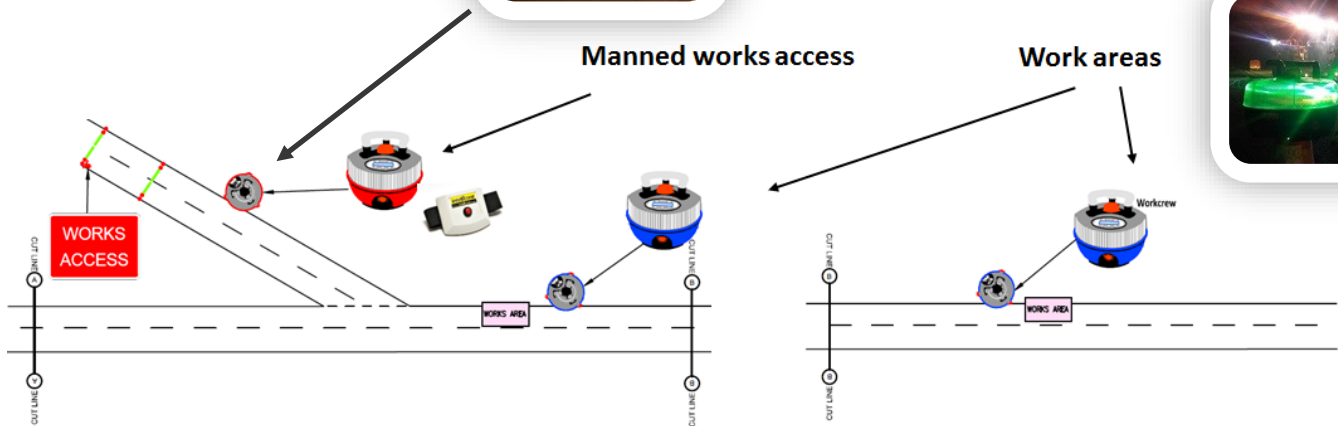

# CASE STUDY

## M25 JUNCTION 30/ A13

To **enhance the safety** of the workforce, the IntelliCone Safelane Panic Alarm system was deployed. The work crews who were resurfacing the highway were only 1/2 km further down the road. A few hours into the shift, the **closure was breached** by a flatbed truck driver.

The **Gateman immediately triggered** his **Panic Alarm**, simultaneously setting off the Blue Crew Alarm, alerting them to move to safety.

As the rogue driver saw the **mass of flashing beacons** in front of him, he sped up and forced his way through the holding point barrier, through the remainder of the roadworks and off site.

**All with the blatant disregard for the workforce.**

**"Thanks to the Safelane system, the Crews had just enough time to turn around and see the truck speeding towards them. As they safely moved out of the way, the truck smashed through the second 'holding barrier' sending the plastic barriers, cones and signs towards the Crews."**

