



VMAKS
enus

INDULGE IN LIFE



BMRDA
Approved



VMAKS VENUS

VMAKS



VMAKS BUILDERS dedicated to develop properties that bring assured appreciating values bringing you VMAKS VENUS, a name thats fast rewriting the rules of Bangalore's real estate Scenario. Each of our projects, its SUNDANCE, BLOSSOM, ROSEBAY, RESIDENCY, ROSELLE, HEIGHTS, CHALET, RIO, RANGOLI etc., stand testimony to our impeccable taste, our commitment to building one-of-a-kind homes and our ability to interpret with quality of dreams of those who dream of the special home. Your safety is further ensured in the quality of constructions and standard materials that go into the making of the complex. It shall be an assured appreciation of the Asset in case you plan a prudent investment too and one of the treasured acquisition of your lifetime.



VMAKS
venus
INDULGE IN LIFE

VMAKS VENUS a luxury residential apartment BMRDA approved with 160 flats with CC & OC RERA approved close to Electronic city Ananth nagar - Hosur road Bangalore. VMAKS VENUS is everything you wanted in a home & more, speciously well designed as a private Low Rise Apartment surrounded by the beauty of nature to give you a quality of life, with each flat offering functional layout Excellent natural light, Ventilation and privacy to the premium, specification, flextures and finishes. VMAKS VENUS has everything you need, an exclusive recreations facilities, children's play zone, party hall, peripheral jogging track, swimming pool and common areas makes the project complete in all respects. VASTU complaint designed rain water harvesting, security system an standby power ensure complete peace of mind and comfort for the Residence.



Project highlights

- Land Area: 1 Acres & 32 Guntas
- Location: Electronic City Phase 2, Bangalore
- 160 Smart Condos
 - 3 - Bedroom - 60 units
 - 2 - Bedroom - 100 units
- G+4 Floor
- No Common Wall
- Vaastu Compliant Homes





Master Plan

A BLOCK				
SL.NO	FLAT TYPE	FLAT NO.	CARPET AREA	SUPER BUILTUP AREA
1	3 BHK	1	929 SFT	1248 SFT
2	3 BHK	2,3,4,7,8,9 16,18,19	872 SFT	1176 SFT
3	3 BHK	5	838 SFT	1138 SFT
4	3 BHK	6	902 SFT	1215 SFT
5	3 BHK	10	906 SFT	1221 SFT
6	2 BHK	11	698 SFT	946 SFT
7	2 BHK	12,13,14,15	665 SFT	906 SFT
8	3 BHK	17	861 SFT	1161 SFT
9	3 BHK	20	933 SFT	1252 SFT

Block A



Block B



B BLOCK				
SL.NO	FLAT TYPE	FLAT NO.	CARPET AREA	SUPER BUILTUP AREA
1	2 BHK	21	649 SFT	914 SFT
2	2 BHK	22,23,24,25, 26,27,28,29,30	576 SFT	828 SFT
3	2 BHK	31,32,33,34,35, 36,37,38,39	646 SFT	879 SFT
4	2 BHK	40	691 SFT	942 SFT



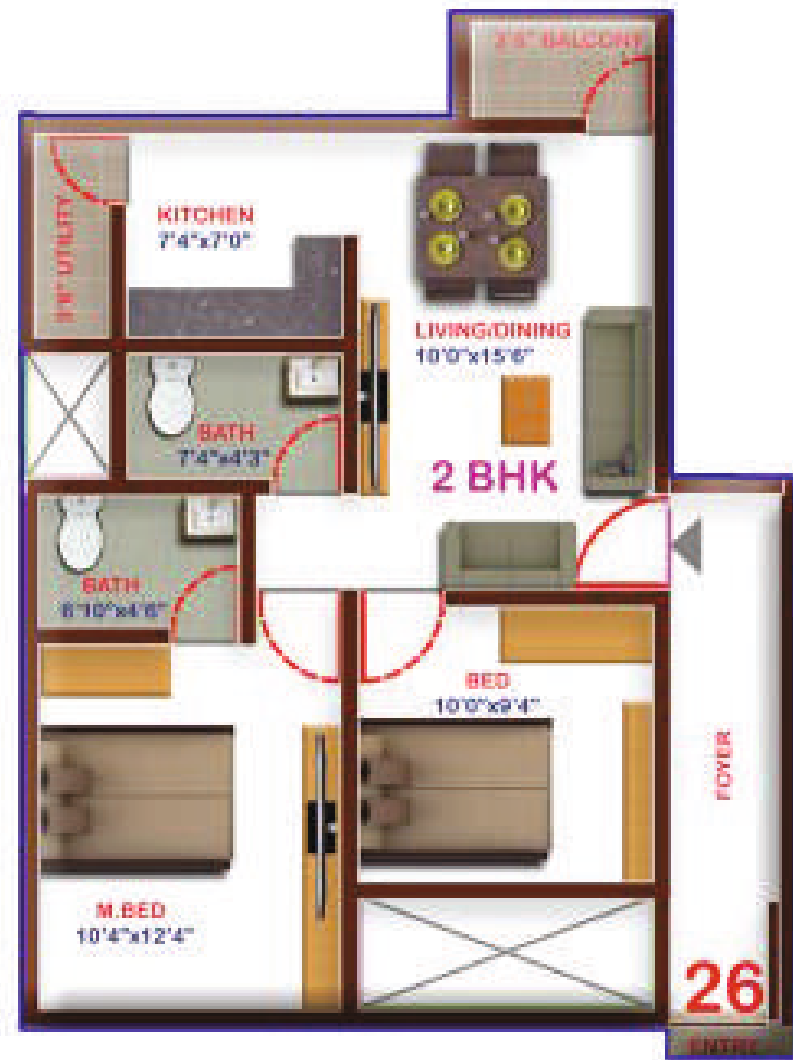

Unit 1 (2 BHK)
 Super built-up area 828 SQFT
 Carpet area 576 SQFT

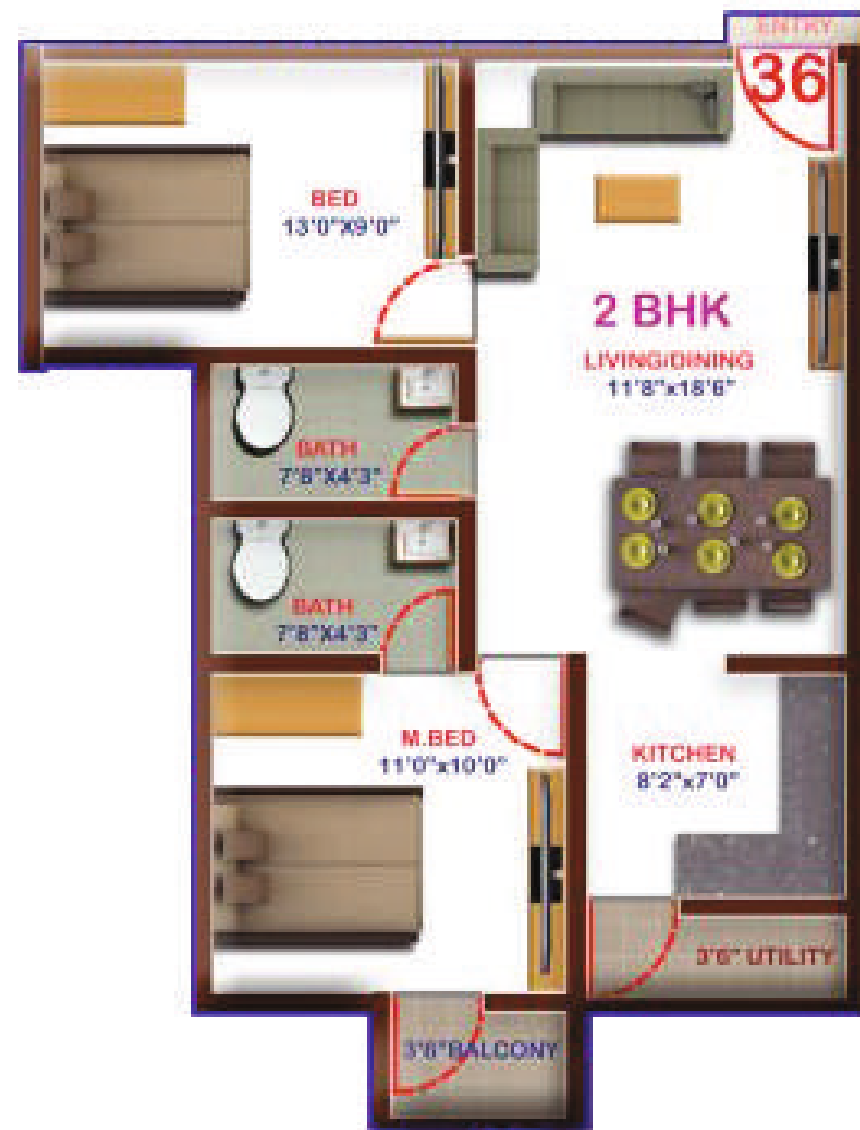

Unit 2 (2 BHK)
 Super built-up area 879 SQFT
 Carpet area 646 SQFT



Unit 3 (3 BHK)
 Super built-up area 1176 SQFT
 Carpet area 872 SQFT



Unit 4 (2 BHK)
 Super built-up area 906 SQFT
 Carpet area 665 SQFT

Amenities

- Skating Ring
- Basketball Court
- Swimming Pool
- Gymnasium
- Outdoor children's play area
- Outdoor Fitness Corner
- Table Tennis
- Badminton Court
- Multi -Purpose Hall
- Squash Court
- Stay Secured 24X7 (CCTV Surveillance system)
- Gaming Room
- Multiple Entertainment options & Learning Avenues
- Yoga / Dance Floor
- Work Place Pods



Specifications

Structure:

Buildings are Ground + 4 Upper Floors
Seismic Zone II compliant RCC Framed Structure
All walls are 6 inch Solid Block masonry walls
Internal Walls will be Plastered with Lime Finish
External Walls will be Plastered with Sponge Finish.

Doors & Windows:

Main Door will be of Teak Wood Frame with polished B.S.T shutters.
Internal Doors & Balcony Doors will be of Sal wood frame with molded shutters.
Three track Aluminum Windows with Mesh Shutters
Door/Window will be of sliding 3 Tracks Aluminum Windows with Mesh Shutt

Flooring:

Premium Vitrified Flooring in Living, Dining, Kitchen and Rooms-600x600
Digital Ceramic Tiles for Walls
Anti Skied Tiles in Utility & Balcony
Granite or Kota for Staircase, Lift & Lobby's
Heavy Duty REGENTO Vitrified Tiles for Corridors.

Lifts

2 Lifts in Block-A and 2 Lifts in Block-B
4 Lifts with Power Backup
Kone, Schindler or Equivalent

Kitchen:

Will be provided with 2ft Wide Granite Platforms with Sink & Drain Board & 2ft Dadoing of Ceramic Tile above the Granite.

Painting:

Internal Walls will be Finished with 2 coats of Putty & Emulsion of Asian or Equivalent make.
External Walls will be Finished with one coat of Cement primer & 2 coats of Weather Coat of Asian or Equivalent make
Grills & Balcony Railings will be of Enamel Paint.

Electrification:

Concealed modular switches of Anchor, Roma or Equivalent make with ISI copper wire, cables & pipes etc.
Powersupply for Each 2 BHK apartment to have 2 KVA & 3 BHK apartment to have 5 KVA.

Water Supply:

Under Ground Tanks & Over Head Tanks with Bore wells & Pumps will be provided.
Hind ware / Cera ware / equivalent sanitary fittings and quality CP fittings of ESSESS / equivalent will be provided with ISI pipes and fittings

Generator Back up:

100% Power back up for Lifts, Pumps & Common Area Lighting.
DC Back-up Power Supply of 0.5 KV in each flates.

Car Park:

Stilt Car Parking.

Routemap

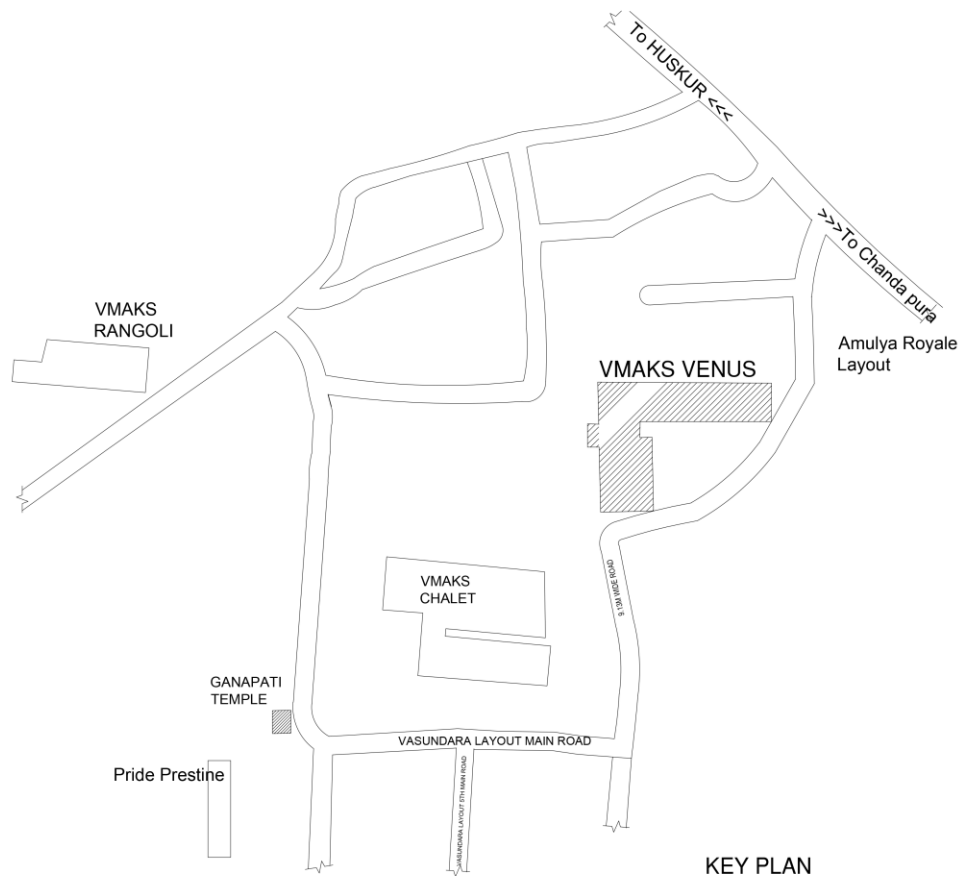

KEY PLAN

List of Neighbourhood

- Electroni City Toll Gate 1.5 KM
- Biocon 2.0 KM
- Brookfield School 2.0 KM
- Vimalaya Hospital 2.5 KM
- Forum Mall 14.0 KM
- M.G.Road 17.0 KM
- Ebenezer International School 1.0 KM
- Chaitanya International School 2.0 KM
- Narayana Hrudayala 4.0 KM
- International Airport 49.5 KM



An ISO 9001 : 2008 Company

#1(123), 14th Main, 16th B Cross,
3rd Block, Jayanagar East, Bangalore 560011
080 22440237
sales@vmaksbuilders.com
www.vmaksbuilders.com



Sy.No. 18/4, 18/9, 15/8, Sampige Nagar,
Electronic City Phase 2, Kammasandra,
Hobil Attibele Hobli Anekal Taluk, Bangalore 560100

Call us on: **7676319319**