



Quality Garden Buildings
Established 1982



Agent Stamp



Quality Garden Buildings
Established 1982

Established in 1982, A&J Sectional Buildings Ltd is a family run business, with customer service at its core. From its humble beginnings A&J has built a strong reputation to become the trusted supplier that it is today.

A&J Sectional Buildings Ltd manufacture, deliver & construct a wide range of quality garden buildings, most of which can be adapted to suit your personal requirements.

All of our buildings are constructed with the following specifications unless otherwise stated.

Tongue & groove shiplap cladding (Ex 15mm) 12mm finished on most walls.

Heavy Duty Shiplap cladding on all Barnwells (Ex 19mm) 15mm finish.

Tongue & groove Loglap cladding (Ex 19mm) 15mm finished on Euros & upgrade option.

Tongue & groove matching cladding (Ex 15mm) 12mm finished on the floors & roof.

18mm Moisture Resistant V313 Caberboard flooring on all buildings 8x8 feet or over in both directions (eg. 8x8 but not 9x7). Or as standard on the Barnwell, Holt & Weybourne ranges.

A legally required ventilation gap at the back of buildings at roof level.

Superior lock & key on doors (except Log stores, Deningtons & Playhouses).

3mm Toughened glass except acrylic on playhouses.

Corner covers on buildings (except Log Stores, Space Savers, Streamlines, Deningtons & Playhouses).

Heavy Duty Polyester based roofing felt used as standard.

All buildings (unless upgraded to painted) treated internally & externally with a spirit based preservative.



Contents



Quality Garden Buildings
Established 1982

4	PENT SHEDS
5	APEX SHEDS
6	WOODFORD SHEDS
7	DENINGTON & STREAMLINE SHEDS
8	SMALL STORAGE BUILDINGS
9	DUTCH BARNs
10	THE EURO
11	THE BRIxWORTH & THE EVESHAM
12	BARNWELL HEAVY DUTY BUILDINGS
13	POTTING SHEDS
14	THE GRENDON & THE TITCHMARSH
15	THE STANWELL
16	THE WHYTEWELL
17	THE ALDSWORTH
18	THE ASHBY
19	THE BARTON
20	THE BRIGHTON FLAT & BRIGHTON BOW
21	THE HOLT & THE WEYBOURNE
22	THE KELLING
23	THE WAENDAL
24	THE WILBYE
25	THE BRAMPTON
26	THE DODDINGTON & THE STRATFORD
27	BUILDINGS FOR CHILDREN
28	DUAL-PURPOSE COMBINATION BUILDINGS
29	BESPOKE BUILDINGS
30	FLOOR SIZES
31	BUILDING FEATURES
32-35	WINDOW LAYOUTS

Pent Sheds



CLASSIC PENT LAYOUT A



GEORGIAN PENT LAYOUT C



SECURITY PENT LAYOUT D



REVERSE PITCH GEO PENT LAYOUT G



GEO PENT LAYOUT C DOUBLE DOORS

The Pent garden shed is a traditional garden building which, with the amount of design options that we offer, should be the perfect style for any garden.

FLOOR

Most buildings will come with (Ex 15mm) 12mm finished tongue & groove matching fixed to 47mm x 47mm pressure treated floor joists, with an option to upgrade to Heavy duty V313 Caberboard flooring instead of matching. All buildings over 8' in both directions eg 8' x 8' but not 9' x 7' are upgraded as standard.

ROOF

All buildings come with (Ex 15mm) 12mm finished tongue and groove matching on 47mm x 47mm roof purlins, although some larger buildings will have these purlins upgraded where necessary. A Heavy Duty Polyester based roofing felt is used as standard on all buildings. On all of our buildings there is a ventilation gap along the back of the roof.

WALLS

All buildings have (Ex 15mm) 12mm finished tongue & groove shiplap fixed to 47mm x 47mm & 47mm x 22mm finished framework. We also offer an (Ex 19mm) 15mm finished tongue & groove loglap cladding as an upgrade on this building.

DOORS

All buildings feature a 0.76m (30") wide by 1.82m (72") tall box framed single personal door, fitted with a mortice lock & handle. The door can be left hinge or right hinge hung to suit your garden needs. This door can be upgraded to a 0.9m (36") door, a pair of doors 1.5m (60"), a 0.76m (30") stable door (this comes with a black knob handle) or a half glass door 0.76m (30") on most buildings.

WINDOWS

There are a choice of four window styles, All of the glass that we use is 3mm toughened.

Classic– Larger Panes with at least one opening sash as standard.

Georgian– Smaller all fixed panes (opening sash available as an upgrade).

Security– Short high level Pillar box style.

No windows– No window at all.

The amount of windows in your building size can be found on page 32.

HEIGHTS

The Pent garden building has a generous internal eaves height of 1.82m (6') rising to an internal ridge height of 2.06m (81"). Extra height can be added to the buildings as an upgrade. Please add an extra 7" on to these heights for the external dimension.

All standard buildings comply with the 2.5m maximum height restriction imposed when erecting a building under Permitted Development.

TREATMENT

Our buildings are treated both internally & externally with a spirit based preservative that helps to protect the timber from fungi, woodworm & blue stain. We do recommend that buildings are retreated within 6 months and then every year for continuous protection.

All of our buildings can be upgraded to a painted finish.

DESIGN LAYOUT OPTIONS

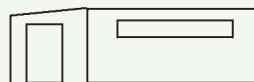

PENT A



PENT B



PENT C



PENT D



PENT E



PENT F

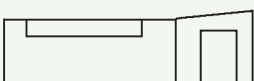

REVERSE PENT G

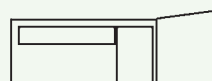

REVERSE PENT H

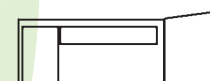

REVERSE PENT J



REVERSE PENT K

Apex Sheds



Quality Garden Buildings
Established 1982

The Apex garden shed is a traditional garden building which with the amount of design options that we offer should be the perfect style for any garden.

FLOOR

Most buildings will come with (Ex 15mm) 12mm finished tongue & groove matching fixed to 47mm x 47mm pressure treated floor joists, with an option to upgrade to Heavy duty V313 Caberboard flooring instead of matching. All buildings over 8' in both directions eg 8' x 8' but not 9' x 7' are upgraded as standard.

ROOF

All buildings come with (Ex 15mm) 12mm finished tongue and groove matching on 47mm x 47mm roof purlins, although some larger buildings will have these purlins upgraded where necessary. A Heavy Duty Polyester based roofing felt is used as standard on all buildings. On all of our buildings there is a ventilation gap along the back of the roof.

WALLS

All buildings have (Ex 15mm) 12mm finished tongue & groove shiplap fixed to 47mm x 47mm & 47mm x 22mm finished framework. We also offer an (Ex 19mm) 15mm finished tongue & groove loglap cladding as an upgrade on this building.

DOORS

All buildings feature a 0.76m (30") wide by 1.82m (72") tall box framed single personal door, fitted with a mortice lock & handle. The door can be left hinge or right hinge hung to suit your garden needs. This door can be upgraded to a 0.9m (36") door, a pair of doors 1.5m (60"), a 0.76m (30") stable door (this comes with a black knob handle) or a half glass door 0.76m (30") on most buildings.

WINDOWS

There are a choice of four window styles, All of the glass that we use is 3mm toughened.

Classic– Larger Panes with at least one opening sash as standard.

Georgian– Smaller all fixed panes (opening sash available as an upgrade).

Security– Short high level Pillar box style.

No windows– No window at all.

The amount of windows in your building size can be found on page 32.

HEIGHTS

The Pent garden building has a generous internal eaves height of 1.82m (6') rising to an internal ridge height of

2.06m (81") on 7' & 8' Gable ends

2.13m (84") on 9' Gable ends

2.18m (86") on 10' & 11' Gable ends

2.31m (91") on 12' Gable ends

Extra height can be added to the buildings as an upgrade. Please add an extra 7" on to these heights for the external dimension.

All standard buildings comply with the 2.5m maximum height restriction imposed when erecting a building under Permitted Development.

TREATMENT

Our buildings are treated both internally & externally with a spirit based preservative that helps to protect the timber from fungi, woodworm & blue stain. We do recommend that buildings are retreated within 6 months and then every year for continuous protection.

All of our buildings can be upgraded to a painted finish.



CLASSIC APEX STYLE A



GEORGIAN APEX STYLE B



CLASSIC APEX STYLE C



SECURITY WINDOW APEX STYLE A

DESIGN LAYOUT OPTIONS

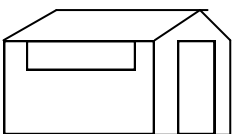

APEX A

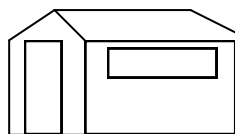

APEX B

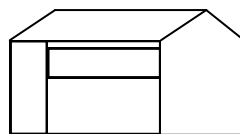

APEX C

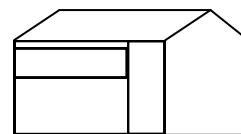

APEX D

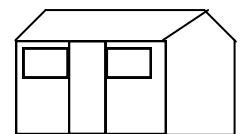

APEX E

Woodford Sheds



CLASSIC WOODFORD



GEORGIAN WOODFORD



**GEORGIAN WOODFORD
+ UPGRADED 1/2 GLASS DOOR**



CLASSIC WOODFORD PAINTED

The Woodford garden shed is a variation of the Apex shed, with the ridge reversed to give the building more of a Chalet style adding an air of elegance to your garden.

FLOOR

Most buildings will come with (Ex 15mm) 12mm finished tongue & groove matching fixed to 47mm x 47mm pressure treated floor joists, with an option to upgrade to Heavy duty moisture resistant V313 Caberboard flooring instead of matching. All buildings over 8' in both directions eg 8' x 8' but not 9' x 7' are upgraded as standard.

ROOF

All buildings come with (Ex 15mm) 12mm finished tongue and groove matching on 47mm x 47mm & 47mm x 22mm finished roof purlins, although some larger buildings will have these purlins upgraded where necessary. A Heavy Duty Polyester based roofing felt is used as standard on all buildings. On all of our buildings there is a ventilation gap along the back of the roof.

WALLS

All buildings have (Ex 15mm) 12mm finished tongue & groove shiplap fixed to 47mm x 47mm & 47mm x 22mm finished framework. We also offer a 15mm finished tongue & groove loglap cladding as an upgrade on this building.

DOORS

All buildings feature a 0.76m (30") wide by 1.82m (72") tall box framed single personal door, fitted with a mortice lock & handle. The door can be left hinge or right hinge hung to suit your garden needs. This door can be upgraded to a 0.9m (36") door, a pair of doors 1.5m (60"), a 0.76m (30") stable door (this comes with a black knob handle) or a half glass door 0.76m (30") on most buildings.

WINDOWS

There are a choice of four window styles, All of the glass that we use is 3mm toughened.

- Classic– Larger Panes with at least one opening sash as standard.
- Georgian– Smaller all fixed panes (opening sash available as an upgrade).
- Security– Short high level Pillar box style.
- No windows– No window at all.

The amount of windows in your building size can be found on page 33.

HEIGHTS

The Woodford has an internal eaves height of 1.82m (6') rising to an internal ridge height of

2.06m (81") on 7' & 8' Gable ends

2.13m (84") on 9' Gable ends

2.18m (86") on 10' & 11' Gable ends

2.31m (91") on 12' Gable ends

Extra height can be added to the buildings as an upgrade. Please add an extra 7" on to these heights for the external dimension.

All standard buildings comply with the 2.5m maximum height restriction imposed when erecting a building under Permitted Development.

TREATMENT

Our buildings are treated both internally & externally with a spirit based preservative that helps to protect the timber from fungi, woodworm & blue stain. We do recommend that buildings are retreated within 6 months and then every year for continuous protection.

All of our buildings can be upgraded to a painted finish.

DESIGN LAYOUT OPTIONS

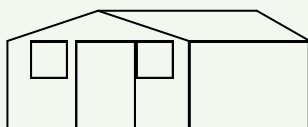

LAYOUT A

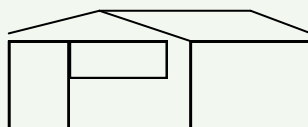

LAYOUT B

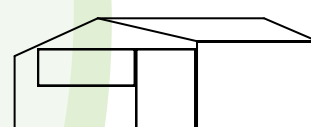

LAYOUT C

Denington Sheds



Quality Garden Buildings
Established 1982

The Denington is our most basic garden shed and is only available as a 1.8m x 1.2m (6'x4') , 2.1m x 1.5m (7'x5') or 2.4m x 1.8m (8'x6') building.

FLOOR

These buildings come with (Ex 15mm) 12mm finished tongue & groove matching fixed to 47mm x 22mm treated floor joists.

ROOF

All buildings come with (Ex 15mm) 12mm finished tongue and groove matching on 47mm x 47mm & 47mm x 22mm finished roof purlins. A Heavy Duty Polyester based roofing felt is used as standard on all buildings. On all of our buildings there is a ventilation gap along the back of the roof.

WALLS

All buildings have (Ex 15mm) 12mm finished tongue & groove shiplap fixed to 47mm x 22mm finished framework.

DOORS

The door is 0.76m (30") wide and is hung on 0.25m (10") T-inges, and comes with a Brenton padbolt.

WINDOWS

The Denington has 3mm toughened glass that is pinned behind the cladding.

HEIGHTS

The Pent garden building has a generous internal eaves height of 1.82m (6') rising to an internal ridge height of 2.06m (81"). Extra height can be added to the buildings as an upgrade. Please add an extra 7" on to these heights for the external dimension. All standard buildings comply with the 2.5m maximum height restriction imposed when erecting a building under Permitted Development.

TREATMENT

Our buildings are treated both internally & externally with a spirit based preservative that helps to protect the timber from fungi, woodworm & blue stain. We do recommend that buildings are retreated within 6 months and then every year for continuous protection. All of our buildings can be upgraded to a painted finish.



PENT DENINGTON A



APEX DENINGTON B

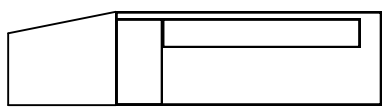

PENT DENINGTON A

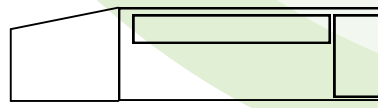

PENT DENINGTON B

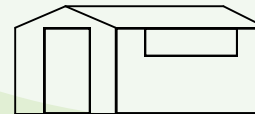

APEX DENINGTON A

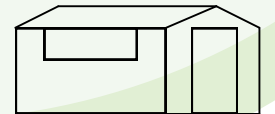

APEX DENINGTON B

Streamline Sheds

The Streamline is designed to fit in a narrow gap such as between a house and a fence. The Streamline is 0.9m (39") deep including the roof overhangs and from 1.2m(4') to 3.6m (12') long.

FLOOR

These buildings will come with (Ex 15mm) 12mm finished tongue & groove matching fixed to 47mm x 47mm treated floor joists.

ROOF

All buildings come with (Ex 15mm) 12mm finished tongue and groove matching on 47mm x 47mm finished roof purlins. A Heavy Duty Polyester based roofing felt is used as standard on all buildings. On all of our buildings there is a ventilation gap along the back of the roof.

WALLS

All buildings have (Ex 15mm) 12mm finished tongue & groove shiplap fixed to 47mm x 47mm & 47mm x 22mm finished framework.

DOORS

The door is 0.60m (24") wide and is hung on 0.25m (10") T-inges and comes with a rimlock & black knob.

WINDOWS

There are no windows in the Streamline building.

HEIGHTS

The Streamline garden building has an internal eaves height of 1.75m (69") rising to an internal ridge height of 1.98m (78"). Please add an extra 7" on to these heights for the external dimension. All standard buildings comply with the 2.5m maximum height restriction imposed when erecting a building under Permitted Development.

TREATMENT

Our buildings are treated both internally & externally with a spirit based preservative that helps to protect the timber from fungi, woodworm & blue stain. We do recommend that buildings are retreated every year for continuous protection. All of our buildings can be upgraded to a painted finish.



STREAMLINE A

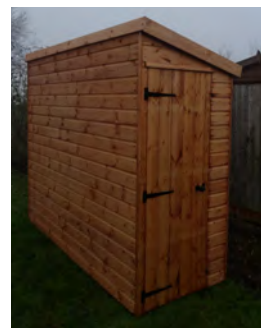

STREAMLINE B

Small Storage



LOGSTORE

The **Logstore** building has an internal height of 1.39m (55") at the front rising to 1.44m (57") at the rear. There are 0.3m (1') of boarding to each side on the front of the logstores. The Logstore is either 1.2m (4'), 1.5m (5') or 1.8m (6') wide and they are all 0.76m (30") in depth.

The buildings are constructed of (Ex 15mm) 12mm finished tongue & groove shiplap fixed on 45mmx45mm & 45mmx22mm finished framework. The floor has 18mm thick Decking boards fixed to 47mm x47mm finished pressure treated floor bearers. The roof is (Ex 15mm) 12mm finished tongue & groove matching fixed to 45mm x 45mm purlins which is covered with a Heavy Duty Polyester based roofing felt.

Our buildings are treated both internally & externally with a spirit based preservative that helps to protect the timber from fungi, woodworm & blue stain. We do recommend that buildings are retreated within 6 months and then every year for continuous protection.



SPACESAVER

The **Spacesaver** building has an internal height of 1.39m (55") at the front raising to 1.44m (57") at the rear. There is a single 0.45m (18") wide door hung on black t-hinges in the centre of the low wall. There is an option to upgrade to a double door on the 1500mm wide building. The Spacesaver is either 0.6m (2'), 0.9m (3') or 1.5m (5') wide and they are all 0.60m (24") in depth. The internal depth dimension of this building is 20 1/2".

The buildings are constructed of (Ex 15mm) 12mm finished tongue & groove shiplap fixed on 34mm x 34mm & 45mm x 22mm finished framework. The floor has an (Ex 15mm) 12mm finished tongue & groove matching fixed to 34mm x 34mm finished treated floor bearers. The roof is (Ex 15mm) 12mm finished tongue & groove matching fixed to 34mm x 34mm purlins which is covered with a Heavy Duty Polyester based roofing felt.

Our buildings are treated both internally & externally with a spirit based preservative that helps to protect the timber from fungi, woodworm & blue stain. We do recommend that buildings are retreated within 6 months and then every year for continuous protection. All of our buildings can be upgraded to a painted finish.



TIDY

The **Tidy** storage building has an internal height of 1.12m (44") at the front raising to 1.24m (49") at the rear. There is a single 0.76m (30") wide door hung on black t-hinges in the centre of the low wall. A Brenton padbolt also comes with the door. There is an option to upgrade to a double door on the 6' wide building. The Tidy is either 1.2m (4'), 1.5m (5') or 1.8m (6') wide and they are all 0.76m (30") in depth. The internal depth dimension of this building is 26".

The buildings are constructed of an (Ex 15mm) 12mm finished tongue & groove shiplap fixed on 45mm x 45mm & 45mm x 22mm finished framework. The floor has an (Ex 15mm) 12mm finished tongue & groove matching fixed to 47mm x 47mm finished pressure treated floor bearers. The roof is 12mm finished tongue & groove matching fixed to 45mm x 45mm purlins which is covered with a Heavy Duty Polyester based roofing felt.

Our buildings are treated both internally & externally with a spirit based preservative that helps to protect the timber from fungi, woodworm & blue stain. We do recommend that buildings are retreated within 6 months and then every year for continuous protection. All of our buildings can be upgraded to a painted finish.



REFUSE STORE (INTERNAL)

The **Refuse Store** is 1.5m (5') wide by 0.9m (3') deep, it has an internal height of 1.56m (61") at the front falling to 1.43m (56") at the rear. There are a pair of 0.61m (24") wide doors hung on black t-hinges in the centre of the low wall. A Brenton padbolt also comes with each door. The Refuse store comes with two storage shelves to one side of the building and one open side, alternatively the shelves can be left out and the building can then take two full height wheelie bins. The internal depth dimension of this building is 31".

The buildings are constructed of (Ex 15mm) 12mm finished tongue & groove shiplap fixed on 45mm x 45mm & 45mm x 22mm finished framework. The floor has (Ex 15mm) 12mm finished tongue & groove matching fixed to 47mm x47mm finished pressure treated floor bearers. The roof is an (Ex 15mm) 12mm finished tongue & groove matching fixed to 45mm x 45mm purlins which is covered with a Heavy Duty Polyester based roofing felt.

Our buildings are treated both internally & externally with a spirit based preservative that helps to protect the timber from fungi, woodworm & blue stain. We do recommend that buildings are retreated within 6 months and then every year for continuous protection. All of our buildings can be upgraded to a painted finish.

Dutch Barn & Dutch Barn Deluxe



Quality Garden Buildings
Established 1982

The Dutch Barn & the Dutch Barn Deluxe are very popular buildings with their unique roof style, these buildings are great for storing larger garden items or simply creating a feature in your garden.

FLOOR

All of our Dutch Barns & Dutch Barn Deluxes are supplied with a Heavy duty moisture resistant 18mm V313 Caberboard flooring on 47mm x 47mm pressure treated floor joists.

ROOF

All buildings come with (Ex 15mm) 12mm finished tongue and groove matching on sturdy roof purlins, A Heavy Duty Polyester based roofing felt is used as standard on all buildings.

This felt can be upgraded to felt tiles or Cedar Shingles to give your building a distinctive look. On all of our buildings there is a ventilation gap along the back of the roof.

WALLS

All buildings have (Ex 15mm) 12mm finished tongue & groove shiplap fixed to 47mm x 47mm finished framework. We also offer an (Ex 19mm) 15mm finished tongue & groove loglap upgrade on these buildings.

DOORS

The Dutch Barn has a pair of 0.66m (26") by 1.85m (73") tall doors giving a generous 1.5m (5') opening. They are hung on t-hinges & come with a mortice lock, key & handle

The Dutch Barn Deluxe have a pair of 0.66m (26") by 1.76m (70") tall Heavy Duty Joinery made doors also giving a generous 1.5m (5') opening. They are hung on T-hinges and come with a mortice lock, key & handle.

WINDOWS

In both building designs there are a choice of two window styles. All of the glass that we use is 3mm toughened.

Classic– Larger panes with at least one opening sash as standard.
Georgian– Smaller all fixed panes. (Opening sash available as an upgrade).

The Deluxe model has a pair of additional small windows above the doors.
The amount of windows in each building can be found at the bottom of this page.

LOFT SHELF

The Dutch Barn Deluxe also comes with a large, deep sturdy shelf to the rear of the building as standard at eaves height.

HEIGHTS

Both buildings have an internal eaves height of 1.82m (6') rising to an internal ridge height of 2.31m (91").

Extra height can be added to the buildings as an upgrade. Please add an extra 7" on to these heights for the external dimension.

All standard buildings comply with the 2.5m maximum height restriction imposed when erecting a building under Permitted Development.

TREATMENT

Our buildings are treated both internally & externally with a spirit based preservative that helps to protect the timber from fungi, woodworm & blue stain. We do recommend that buildings are retreated within 6 months and then every year for continuous protection.

All of our buildings can be upgraded to a painted finish.



DUTCH BARN



DUTCH BARN DELUXE



DUTCH BARN DELUXE SHELF

WINDOW AMOUNTS

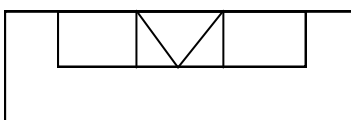

8' CLASSIC

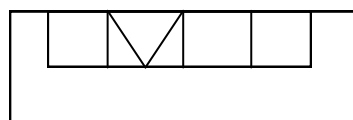

10', 12' & 14' CLASSIC

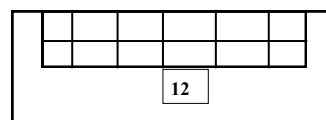

ALL SIZES GEORGIAN

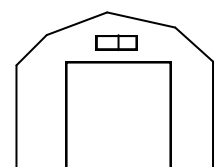

8' DELUXE END

The Euro



EURO OPTION A



EURO OPTION B



PAINTED EURO OPTION B

The Euro is a Chalet styled garden building which is enhanced by a 0.38m (15") roof canopy to the front of the building, standard loglap and a window box.

FLOOR

Most buildings will come with (Ex 15mm) 12mm finished tongue & groove matching fixed to 47mm x 47mm pressure treated floor joists, with an option to upgrade to Heavy duty V313 Caberboard flooring instead of matching. All buildings over 8' in both directions eg 8' x 8' but not 9' x 7' are upgraded as standard.

ROOF

All buildings come with (Ex 15mm) 12mm finished tongue and groove matching on 47mm x 47mm & 47mm x 22mm finished roof purlins, although some larger buildings will have these purlins upgraded where necessary. A Heavy Duty Polyester based roofing felt is used as standard on all buildings. On all of our buildings there is a ventilation gap along the back of the roof.

WALLS

All buildings have (Ex 19mm) 15mm finished tongue & groove loglap fixed to 47mm x 47mm & 47mm x 22mm finished framework.

DOORS

All buildings feature a 0.76m (30") by 1.82m (72") tall wide box framed single personal door, fitted with a mortice lock & handle. The door can be left hinge or right hinge hung to suit your garden needs.

WINDOWS

The Euro comes with one fixed Georgian style window evenly spaced between the edge of the door and the outside of the building. All of the glass is 3mm toughened for safety. The amount of window panes in the building depends on the building size. A guide for this can be found on page 33.

HEIGHTS

The Euro also has an internal eaves height of 1.82m (6') rising to an internal ridge height of

- 2.06m (81") on 7' & 8' Gable ends
- 2.13m (84") on 9' Gable ends
- 2.18m (86") on 10' & 11' Gable ends
- 2.31m (91") on 12' Gable ends

Extra height can be added to the buildings as an upgrade. Please add an extra 7" on to these heights for the external dimension.

All standard buildings comply with the 2.5m maximum height restriction imposed when erecting a building under Permitted Development.

TREATMENT

Our buildings are treated both internally & externally with a spirit based preservative that helps to protect the timber from fungi, woodworm & blue stain. We do recommend that buildings are retreated within 6 months and then every year for continuous protection.

All of our buildings can be upgraded to a painted finish.

LAYOUT DESIGNS

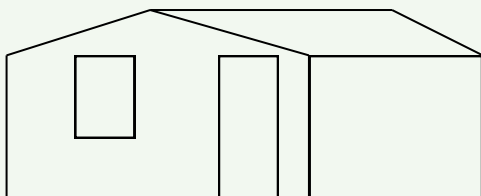

OPTION A

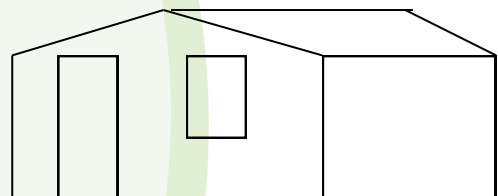

OPTION B

The Brixworth

The Brixworth features a unique part glazed door and deeper glazed windows.

FLOOR

These buildings will come with (Ex 15mm) 12mm finished tongue & groove matching fixed to 47mm x 47mm pressure treated floor joists, with an option to upgrade to Heavy duty moisture resistant V313 Caberboard flooring instead of matching. All buildings over 8' in both directions eg 8' x 8' but not 9' x 7' are upgraded as standard.

ROOF

All buildings come with (Ex 15mm) 12mm finished tongue and groove matching on 47mm x 47mm & 47mm x 22mm finished roof purlins. A Heavy Duty Polyester based roofing felt is used as standard on all buildings. On all of our buildings there is a ventilation gap along the back of the roof.

WALLS

All buildings have (Ex 15mm) 12mm finished tongue & groove shiplap fixed to 47mm x 47mm & 47mm x 22mm finished framework. We also offer a 15mm finished tongue & groove loglap cladding as an upgrade on this building.

DOORS

The part glazed door can be left hinge or right hinge hung to suit your garden needs.

WINDOWS

The Brixworth comes with a fixed two pane deep Classic style windows either side of the door and in each side panel. All of the glass is 3mm toughened for safety.

HEIGHTS

The Brixworth garden building has a generous internal eaves height of 1.82m (6') rising to an internal ridge height of 2.06m (81"). Please add an extra 7" on to these heights for the external dimension. All standard buildings comply with the 2.5m maximum height restriction imposed when erecting a building under Permitted Development.

TREATMENT

Our buildings are treated both internally & externally with a spirit based preservative that helps to protect the timber from fungi, woodworm & blue stain. We do recommend that buildings are retreated within 6 months and then every year for continuous protection. All of our buildings can be upgraded to a painted finish.



BRIXWORTH



PENT BRIXWORTH

The Evesham

The Evesham is a combined shed & veranda which makes an attractive building for any garden.

FLOOR

These buildings will come with (Ex 15mm) 12mm finished tongue & groove matching fixed to 47mm x 47mm pressure treated floor joists. The veranda section has 18mm thick decking boards instead of matching.

ROOF

All buildings come with (Ex 15mm) 12mm finished tongue and groove matching on 47mm x 47mm & 47mm x 22mm finished roof purlins. A Heavy duty polyester based roofing felt is used as standard on all buildings. On all of our buildings there is a ventilation gap along the back of the roof.

WALLS

All buildings have (Ex 15mm) 12mm finished tongue & groove shiplap fixed to 47mm x 47mm & 47mm x 22mm finished framework. We also offer an (Ex 19mm) 15mm finished tongue & groove loglap cladding as an upgrade on this building.

DOORS

All buildings feature a 0.76m (30") wide by 1.82m (72") tall box framed single personal door, fitted with a mortice lock & handle. The door can be left hinge or right hinge hung to suit your garden needs.

WINDOWS

The Evesham comes with two Georgian style windows evenly spaced between the edge of the door and the outside of the building. All of the glass is 3mm toughened for safety.

HEIGHTS

The Evesham garden building has a generous internal eaves height of 1.95m (77") rising to an internal ridge height 2.18m (86") Please add an extra 7" on to these heights for the external dimension. All standard buildings comply with the 2.5m maximum height restriction imposed when erecting a building under Permitted Development.

TREATMENT

Our buildings are treated both internally & externally with a spirit based preservative that helps to protect the timber from fungi, woodworm & blue stain. We do recommend that buildings are retreated within 6 months and then every year for continuous protection. All of our buildings can be upgraded to a painted finish.



EVESHAM OPTION A



EVESHAM OPTION B



CLASSIC APEX BARNWELL



GEORGIAN APEX BARNWELL



SECURITY WINDOW BARNWELL



GEORGIAN WINDOW PENT BARNWELL



PAINTED CLASSIC APEX BARNWELL



CLASSIC APEX BARNWELL WITH INTERNAL PARTITION



The Barnwell is our Heavy Duty Workshop. This is a great building to line & insulate to give you a building you can work in all year round.

FLOOR

All of our Barnwells are supplied with Heavy duty 18mm moisture resistant V313 Caberboard flooring on 47mm x 47mm tanalised floor joists.

ROOF

All buildings come with (Ex 15mm) 12mm finished tongue and groove matching on sturdy roof purlins. A Heavy Duty Polyester based roofing felt is used as standard on all buildings. On all of our buildings there is a ventilation gap along the back of the roof.

WALLS

All buildings have (Ex 19mm) 15mm finished tongue & groove shiplap fixed to 47mm x 47mm finished framework. This can be upgraded to loglap.

DOORS

All our Barnwell doors are made by us. They are fully framed, ledged & braced with a five lever mortice lock & handle. The doors are hung on 0.6m (24") wide heavy duty hook & band hinges. A metal threshold is provided on all sizes to prevent wear & tear. Any building with a 2.13m(7') or less Pent or Gable end, has a single 0.76m (30") wide by 1.76m (70") tall door, buildings with a 2.4m (8') or above Pent or Gable end will get a pair of 1.5m (5') wide by 1.76m (70") tall doors as standard. Wider doors are available as an upgrade.

WINDOWS

There are a choice of four window styles, All of the glass that we use is 3mm toughened.

Classic– Larger Panes with at least one opening sash as standard.

Georgian– Smaller all fixed panes. (opening sash available as an upgrade)

Security– Short high level Pillar box style.

No windows– No window at all.

The amount of windows in your building size can be found on page 34.

HEIGHTS

The Barnwell garden building has a generous internal eaves height of 1.95m (77") rising to an Internal ridge height of

2.1m (83") up to & inc 5' Gable ends

2.16m (85") on 6' to 8' Gable ends

2.3m (91") on 9' to 12' Gable ends

Extra height can be added to the buildings as an upgrade. Please add an extra 7" on to these heights for the external dimension.

All standard buildings comply with the 2.5m maximum height restriction imposed when erecting a building under Permitted Development.

TREATMENT

Our buildings are treated both internally & externally with a spirit based preservative that helps to protect the timber from fungi, woodworm & blue stain. We do recommend that buildings are retreated within 6 months and then every year for continuous protection.

All of our buildings can be upgraded to a painted finish.

Potting Sheds

Our Potting Shed range gives the gardener in you every opportunity to grow your own flowers & vegetables on the bench that comes as standard with these buildings

FLOOR

Most buildings will come with (Ex 15mm) 12mm finished tongue & groove matching fixed to 47mm x 47mm pressure treated floor joists, with an option to upgrade to Heavy duty moisture resistant 18mm V313 Caberboard flooring instead of matching. All buildings over 8' in both directions eg 8' x 8' but not 9' x 7' are upgraded as standard.

ROOF

All buildings come with (Ex 15mm) 12mm finished tongue and groove matching on sturdy roof purlins. A Heavy Duty Polyester based roofing felt is used as standard on all buildings. On all of our buildings there is a ventilation gap along the back of the roof.

With the Half Glass Potting shed range, the half of roof above the windows is replaced with our unique toughened glass roof design to allow the maximum amount of light to flood in.

WALLS

All buildings have (Ex 15mm) 12mm finished tongue & groove shiplap fixed to 47mm x 47mm & 47mm x 22mm finished framework. We also offer an (Ex 19mm) 15mm Tongue & groove loglap upgrade on these buildings.

DOORS

All our Potting Sheds feature a 0.76m (30") by 1.82m (72") tall wide box stable door fitted with a rimlock & black knob handle.

WINDOWS

The Potting Sheds have a double depth window right across the front of the building (larger panes with at least one opening sash) as well as a double depth fixed window on each end panel, the size of the pane in the door end will vary with the panel size. All of this glass is 3mm toughened for safety. The amount of windows in each building depends on the building size. A guide for this can be found on page 34.

HEIGHTS

The Pent Potting Shed has a generous internal eaves height of 1.82m (6') rising to an internal ridge height of 2.06m (81").

The Apex & Half Glass Potting Sheds also have an internal eaves height of 1.82m (6') rising to an internal ridge height of

- 2.06m (81") on 4' to 8' Gable ends
- 2.13m (84") on 9' Gable ends
- 2.18m (86") on 10' & 11' Gable ends
- 2.31m (91") on 12' Gable ends

Extra height can be added to the buildings as an upgrade. Please add an extra 7" on to these heights for the external dimension. All standard buildings comply with the 2.5m maximum height restriction imposed when erecting a building under Permitted Development.

TREATMENT

Our buildings are treated both internally & externally with a spirit based preservative that helps to protect the timber from fungi, woodworm & blue stain. We do recommend that buildings are retreated within 6 months and then every year for continuous protection.

All of our buildings can be upgraded to a painted finish.



PENT POTTING OPTION A



APEX POTTING OPTION B



1/2 GLASS POTTING OPTION B



INTERNAL VIEW 1/2 GLASS ROOF & BENCH

DESIGN LAYOUT OPTIONS

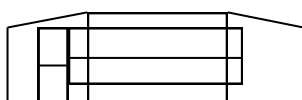

PENT POTTING A

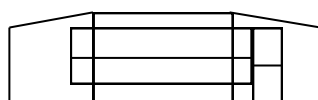

PENT POTTING B

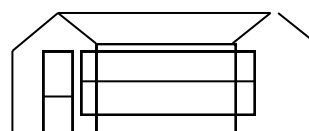

APEX POTTING A

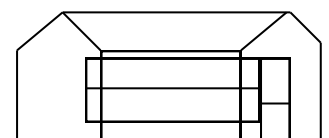

APEX POTTING B

The Grendon



THE GRENDON



INTERNAL GREENHOUSE SECTION



PAINTED GRENDON

The Grendon gives you a greenhouse combined with a storage building for your gardening tools. The greenhouse section is 6' x 6' with a fully glazed roof for that all important light to help your plants and vegetables grow. The shed section is 6' x 4' giving you a building that is 10' x 6' overall. The Grendon comes with a bench each side of the Greenhouse.

FLOOR

The shed section will come with (Ex 15mm) 12mm finished tongue a groove matching on 47mm x 47mm pressure treated floor joists, whilst there is no floor in the greenhouse section, there are 47mm x 47mm finished pressure treated floor joists around the edge.

ROOF

The shed section of the greenhouse has (Ex 15mm) 12mm finished tongue & groove matching on 47mm x 47mm roof purlins. The greenhouse section of the roof has a unique toughened glass roof design. A Heavy Duty Polyester roofing felt is used as standard on the shed section. On all of our buildings there is a ventilation gap along the back of the roof.

WALLS

The shed section & lower part of the greenhouse has (Ex 15mm) 12mm finished tongue & groove shiplap fixed to 47mm x 22mm & 47mm x 47mm finished framework. We also offer an (Ex 19mm) 15mm Tongue & groove loglap upgrade on these buildings.

DOORS

The shed section has a 0.60m (24") wide by 1.82m (72") Tall box door with a rimlock & black knob, whilst the greenhouse has a 0.66m (26") wide by 1.83m (72") Tall glazed door that comes with a brenton padbolt.

WINDOWS

The shed section comes with one opening window whilst the greenhouse section is fully toughened glass from the roof down to the top of the benches, with an opening sash in each side panel.

HEIGHT

The Grendon has a generous internal height of 1.82m (6') rising to an internal ridge height of 2.06m (81"). The buildings comply with the 2.5m maximum height restriction imposed when erecting a building under Permitted Development.

TREATMENT

Our buildings are treated both internally & externally with a spirit based preservative that helps to protect the timber from fungi, woodworm & blue stain. We do recommend that buildings are retreated within 6 months and then every year for continuous protection. All of our buildings can be upgraded to a painted finish.

The Titchmarsh

The Titchmarsh is our wooden greenhouse and it comes with one bench in it.

FLOOR

There is no floor in the Titchmarsh, but there are 47mm x 47mm finished pressure treated floor bearers around the edge.

ROOF

The Titchmarsh roof has a unique toughened glass roof design. On all of our buildings there is a ventilation gap along the back of the roof.

WALLS

The lower part of the Titchmarsh has (Ex 15mm) 12mm finished tongue & groove shiplap fixed to 47mm x 22mm & 47mm x 47mm finished framework. We also offer an (Ex 19mm) 15mm Tongue & groove loglap upgrade on these buildings.

DOORS

The Titchmarsh has a 0.66m (26") wide by 1.76m (70") tall glazed door that also comes with a brenton padbolt.

WINDOWS

The Titchmarsh has fully toughened glass from the roof down to the top of the benches, with an opening sash in each side.

HEIGHTS

The Titchmarsh has a generous internal height of 1.82m (6') rising to an internal ridge height of 2.06m (81"). The buildings comply with the 2.5m maximum height restriction imposed when erecting a building under Permitted Development.

TREATMENT

Our buildings are treated both internally & externally with a spirit based preservative that helps to protect the timber from fungi, woodworm & blue stain. We do recommend that buildings are retreated within 6 months and then every year for continuous protection. All of our buildings can be upgraded to a painted finish.



FRONT VIEW



REAR VIEW

The Stanwell Corner Building



Quality Garden Buildings
Established 1982

The Stanwell is our corner shed with a unique apex style roof which is available as a 1.8m x 1.8m (6'x6'), 2.1m x 2.1m (7'x7'), 2.4m x 2.4m (8'x8'), 2.7m x 2.7m (9'x9') or 3m x 3m (10'x 10') building.

FLOOR

The Stanwell comes with (Ex 15mm) 12mm finished tongued & groove matching on 47mm x 47mm pressure treated joists on all sizes with an option to upgrade to 18mm Heavy duty v313 Caberboard flooring.

ROOF

All buildings come with (Ex 15mm) 12mm finished tongue & groove matching on 47mm x 47mm roof purlins. A Heavy Duty Polyester based roofing felt is used as standard on all buildings. On all of our buildings there is a ventilation gap along the back of the roof.

WALLS

All buildings have (Ex 15mm) 12mm finished tongue & groove shiplap fixed to 47mm x 22mm & 47mm x 47mm finished framework. We also offer an (Ex 19mm) 15mm Tongue & groove loglap upgrade on these buildings.

DOORS

The Stanwell features a 0.76m (30") wide by 1.76m (70") tall box door, fitted with a mortice lock & handle. This door can be upgraded to a 0.76m (30") stable door (this comes with a rimlock & black knob handle) or a 1/2 glass door.

WINDOWS

The Stanwell comes with windows in the panels either side of the door. The Classic will have an opening sash in each section, whilst the Georgian are all fixed. All the glass we use in these buildings is toughened for safety. The amount of windows in each building depends on the building size. A guide for this can be found on page 33.

HEIGHTS

The Stanwell has a generous internal eaves height of 1.82m (6') rising to an internal ridge height of 2.06m (81"). Extra height can be added to the building as an up-grade. Please add an extra 7" on to these heights for the external dimension.

The buildings comply with the 2.5m maximum height restriction imposed when erecting a building under Permitted Development.

TREATMENT

Our buildings are treated both internally & externally with a spirit based preservative that helps to protect the timber from fungi, woodworm & blue stain. We do recommend that buildings are retreated within 6 months and then every year for continuous protection.

All of our buildings can be upgraded to a painted finish.



STANWELL CLASSIC



STANWELL GEORGIAN



PAINTED STANWELL CLASSIC



PAINTED STANWELL GEORGIAN + UPGRADE HALF GLASS DOOR

STANWELL FLOOR PLANS

6 X 6

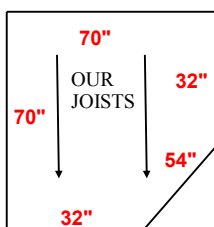

7 X 7

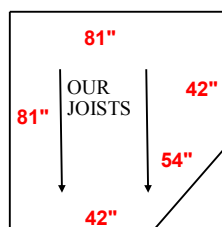

8 X 8

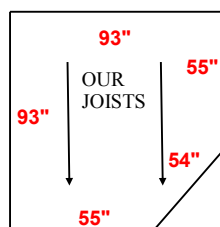

9 X 9

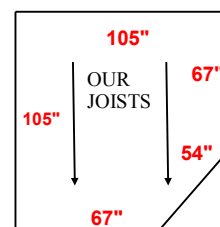

10 X 10

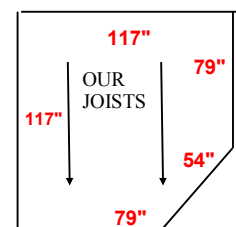

The Whytewell Corner Building



WHYTEWELL CLASSIC



WHYTEWELL GEORGIAN



PAINTED WHYTEWELL CLASSIC

The Whytewell is our corner Summerhouse with a unique apex style roof which is available as a 1.8m x 1.8m (6'x6'), 2.1m x 2.1m (7'x7'), 2.4m x 2.4 (8'x8'), 2.7m x 2.7m (9'x9') or 3m x 3m (10'x 10') building.

FLOOR

The Whytewell comes with (Ex15mm)12mm finished tongued & groove matching on 47mm x 47mm pressure treated joists on all sizes with an option to upgrade to 18mm Heavy duty moisture resistant V313 Caberboard flooring.

ROOF

All buildings come with (Ex 15mm) 12mm finished tongue & groove matching on 47mm x 47mm roof purlins. A Heavy Duty Polyester based roofing felt is used as standard on all buildings. On all of our buildings there is a ventilation gap along the back of the roof.

WALLS

All buildings have (Ex 15mm) 12mm finished tongue & groove shiplap fixed to 47mm x 22mm & 47mm x 47mm finished framework. We also offer an (Ex 19mm) 15mm finished Tongue & groove loglap upgrade on these buildings.

DOORS

The Whytewell features a pair of 0.6m (24") by 1.76m (70") tall 9 pane glazed doors which give a 1.2m (4') opening. The doors are hung on Antique style hinges and come with a 5 lever mortice lock & an Antique style handle. The Classic Whytewell has a single pane of glass in each door instead of the 6 panes.

WINDOWS

The Whytewell comes with a fully opening sash in the panels either side of the door. All the glass we use in these buildings is toughened for safety.

HEIGHTS

The Whytewell has a generous internal eaves height of 1.82m (6') rising to an internal ridge height of 2.05m (81"). Extra height can be added to the building as an upgrade.

The buildings comply with the 2.5m maximum height restriction imposed when erecting a building under Permitted Development.

TREATMENT

Our buildings are treated both internally & externally with a spirit based preservative that helps to protect the timber from fungi, woodworm & blue stain. We do recommend that buildings are retreated within 6 months and then every year for continuous protection.

All of our buildings can be upgraded to a painted finish.

WHYTEWELL FLOOR PLANS

6 X 6

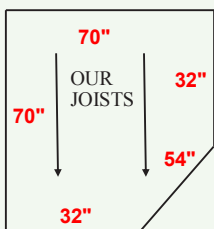

7 X 7

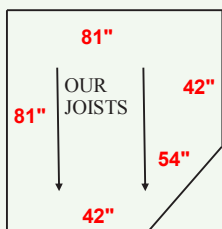

8 X 8

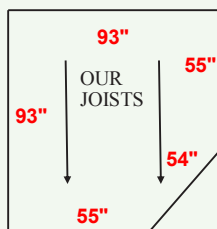

9 X 9

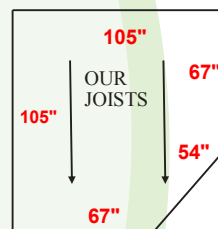

10 X 10

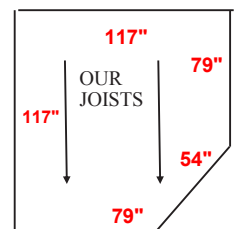

The Aldsworth

The Aldsworth is another of our Summerhouses that you can sit & relax in for hours on end, or even to use as a basic office perhaps.

FLOOR

Most buildings will come with (Ex15mm) 12mm finished tongue & groove matching on 47mm x 47mm pressure treated floor joists with an option to upgrade to a Heavy duty moisture resistant 18mm V313 Caberboard flooring. All buildings over 8' in each direction eg 8' x 8' but not 9' x 7' are upgraded as standard.

ROOF

All buildings come with (Ex15mm) 12mm finished tongue & groove matching on 47mm x 47mm & 47mm x 22mm roof purlins, although some larger buildings will have these purlins upgraded where necessary. There is a 0.38m (15") roof canopy over the front of the building as standard on the Aldsworth. A Heavy Duty Polyester based roofing felt is used as standard on all buildings. On all of our buildings there is a ventilation gap along the back of the roof. Apart from on the Pent style, there is the option to upgrade the felt to felt tiles or Cedar Shingles.

WALLS

All buildings have (Ex15mm) 12mm finished tongue & groove shiplap fixed to 47mm x 47mm & 47mm x 22mm finished framework. We also offer an (Ex19mm) 15mm Tongue & groove loglap upgrade on these buildings.

DOORS

The Aldsworth features a 0.9m (30") wide by 1.76m (70") tall 9 pane glazed door, hung on Antique style hinges. It is fitted with a mortice lock & antique style handle. The Classic Aldsworth has one single pane of glass instead of the 6 panes.

WINDOWS

The Aldsworth has a fixed window in the front & an opening window in one side panel. All the glass that we use is 3mm toughened for safety. The amount of window panes in your building size can be found on page 35.

VERANDA

A 2', 3' or 4' Veranda can be added to the Aldsworth as an optional extra. The 2' Veranda has an open front whilst the 3' & 4' Verandas have spindles across to the doors on the front.

HEIGHTS

The Pent Aldsworth has a generous internal eaves height of 1.82m (6') rising to an internal ridge height of 2.06m (81").

The Aldsworth also has an internal eaves height of 1.82m (6') rising to an internal ridge height of

- 2.06m (81") on 7' & 8' Gable ends
- 2.13m (84") on 9' Gable ends
- 2.18m (86") on 10' & 11' Gable ends
- 2.31m (91") on 12' Gable ends

Extra height can be added to the building as an upgrade. Please add an extra 7" on to these heights for the external dimension.

The buildings comply with the 2.5m maximum height restriction imposed when erecting a building under Permitted Development.

TREATMENT

Our buildings are treated both internally & externally with a spirit based preservative that helps to protect the timber from fungi, woodworm & blue stain. We do recommend that buildings are retreated within 6 months and then every year for continuous protection.

All of our buildings can be upgraded to a painted finish.



ALDSWORTH LAYOUT A



ALDSWORTH LAYOUT B



PAINTED CLASSIC ALDSWORTH OPTION A



PENT ALDSWORTH LAYOUT B

LAYOUT OPTIONS

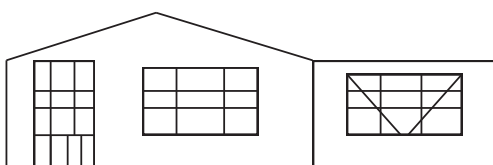

ALDSWORTH LAYOUT A

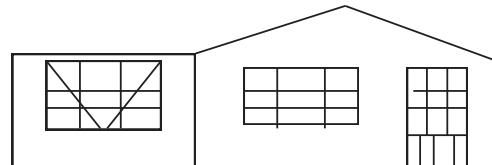

ALDSWORTH LAYOUT B

The Ashby



ASHBY LAYOUT A



ASHBY LAYOUT C



PENT ASHBY OPTION A



PAINTED ASHBY LAYOUT A

The Ashby is our basic Summerhouse that will still give you lots of relaxing time in your garden.

FLOOR

Most buildings will come with (Ex15mm) 12mm finished tongue & groove matching on 47mm x 47mm pressure treated floor joists with an option to upgrade to a Heavy duty moisture resistant 18mm v313 Caberboard flooring. All buildings over 8' in each direction eg 8' x 8' but not 9' x 7' are upgraded as standard.

ROOF

All buildings come with (Ex15mm) 12mm finished tongue & groove matching on 47mm x 47mm & 47mm x 22mm roof purlins, although some larger buildings will have these purlins upgraded where necessary. There is a 0.38m (15") roof canopy over the front of the building as standard on the Ashby. A Heavy Duty Polyester based roofing felt is used as standard on all buildings. On all of our buildings there is a ventilation gap along the back of the roof. Apart from on the Pent style, there is the option to upgrade the felt to felt tiles or Cedar Shingles.

WALLS

All buildings have (Ex15mm) 12mm finished tongue & groove shiplap fixed to 47mm x 47mm & 47mm x 22mm finished framework. We also offer an (Ex19mm) 15mm finished Tongue & groove loglap upgrade on these buildings.

DOORS

The Ashby has a pair of doors 0.6m (24") wide by 1.76m (70") tall that have 3 panes of toughened glass in each door. The doors open to give a 1.2m (4') opening. They are hung on silver hinges and come with a 5 lever lock & silver handle.

WINDOWS

The Ashby has fixed windows alongside the doors in the front of the building only as standard, but windows can be added to the sides as an optional extra. The amount of windows depends upon the size of the building, a guide for this can be found at the bottom of this page. All the glass that we use is 3mm toughened for safety.

VERANDA

A 2', 3' or 4' Veranda can be added to the Ashby as an optional extra. The 2' Veranda has an open front whilst the 3' & 4' Verandas have spindles across to the doors on the front.

HEIGHTS

The Pent Ashby has a generous internal eaves height of 1.82m (6') rising to an internal ridge height of 2.06m (81").

The Ashby also has an internal eaves height of 1.82m (6') rising to an internal ridge height of
 2.06m (81") on 7' & 8' Gable ends
 2.13m (84") on 9' Gable ends
 2.18m (86") on 10' & 11' Gable ends
 2.31m (91") on 12' Gable ends

Extra height can be added to the building as an upgrade. Please add an extra 7" on to these heights for the external dimension.

The buildings complies with the 2.5m maximum height restriction imposed when erecting a building under Permitted Development.

TREATMENT

Our buildings are treated both internally & externally with a spirit based preservative that helps to protect the timber from fungi, woodworm & blue stain. We do recommend that buildings are retreated within 6 months and then every year for continuous protection.

All of our buildings can be upgraded to a painted finish.

WINDOW LAYOUT OPTIONS



ALL SIZES OPTION A



12' & ABOVE OPTION B

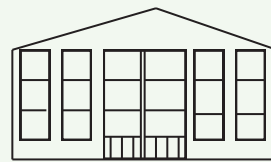

14' & ABOVE OPTION C



14' & ABOVE OPTION D

The Barton

The Barton is our Georgian style Summerhouse that you can sit & relax in for hours on end.

FLOOR

Most buildings will come with (Ex15mm) 12mm finished tongue & groove matching on 47mm x 47mm pressure treated floor joists with an option to upgrade to a Heavy duty moisture resistant 18mm V313 Caberboard flooring. All buildings over 8' in each direction eg 8' x 8' but not 9' x 7' are upgraded as standard.

ROOF

All buildings come with an (Ex15mm) 12mm finished tongue & groove matching on 47mm x 47mm & 47mm x 22mm roof purlins, although some larger buildings will have these purlins upgraded where necessary. There is a 0.38m (15") roof canopy over the front of the building as standard on the Barton. A Heavy Duty Polyester based roofing felt is used as standard on all buildings. On all of our buildings there is a ventilation gap along the back of the roof. Apart from on the Pent style, there is the option to upgrade the felt to felt tiles or Cedar Shingles.

WALLS

All buildings have (Ex15mm) 12mm finished tongue & groove shiplap fixed to 47mm x 47mm & 47mm x 22mm finished framework. We also offer an (Ex19mm) 15mm finished Tongue & groove loglap upgrade on these buildings.

DOORS

The Barton has a pair of doors 0.6m (24") wide by 1.76m (70") tall that have 6 panes of toughened glass in each door. The doors open to give a 4' opening. They are hung on black Antique style hinges and come with a 5 lever lock & black Antique style handle.

WINDOWS

The Barton has fixed windows alongside the doors in the front & an opening sash in each side panel. The amount of windows depends upon the size of the building, a guide for this can be found on page 35. All the glass that we use is 3mm toughened for safety.

VERANDA

A 2', 3' or 4' Veranda can be added to the Barton as an optional extra. The 2' Veranda has an open front whilst the 3' & 4' Verandas have spindles across to the doors on the front.

HEIGHTS

The Pent Barton has a generous internal eaves height of 1.82m (6') rising to an internal ridge height of 2.06m (81").

The Barton also has an internal eaves height of 1.82m (6') rising to an internal ridge height of 2.06m (81") on 7' & 8' Gable ends
2.13m (84") on 9' Gable ends
2.18m (86") on 10' & 11' Gable ends
2.31m (91") on 12' Gable ends

Extra height can be added to the building as an upgrade. Please add an extra 7" on to these heights for the external dimension.

The buildings complies with the 2.5m maximum height restriction imposed when erecting a building under Permitted Development.

TREATMENT

Our buildings are treated both internally & externally with a spirit based preservative that helps to protect the timber from fungi, woodworm & blue stain. We do recommend that buildings are retreated within 6 months and then every year for continuous protection.

All of our buildings can be upgraded to a painted finish.



BARTON LAYOUT A



PENT BARTON



BARTON + 3' VERANDA



PAINTED BARTON LAYOUT A

LAYOUT OPTIONS



7'-11' OPTION A



12' & ABOVE OPTION A



12' & ABOVE OPTION B



12' & ABOVE OPTION C

The Brighton



BRIGHTON FLAT LAYOUT A



BRIGHTON BOW OPTION D



BRIGHTON BOW OPTION C

The Brighton is one of our original Summerhouses and it still remains just as popular today. To accommodate the doors & windows the front has to be a minimum of 12' wide.

FLOOR

Most buildings will come with (Ex15mm) 12mm finished tongue & groove matching on 47mm x 47mm pressure treated floor joists with an option to upgrade to a Heavy duty moisture resistant 18mm V313 Caberboard flooring. All buildings over 8' in each direction eg 8' x 8' but not 9' x 7' are upgraded as standard.

ROOF

All buildings come with (Ex15mm) 12mm finished tongue & groove matching on 47mm x 47mm & 47mm x 22mm roof purlins, although some larger buildings will have these purlins upgraded where necessary. There is a 0.38m (15") roof canopy over the front of the building as standard on the Brighton. A Heavy Duty Polyester based roofing felt is used as standard on all buildings. On all of our buildings there is a ventilation gap along the back of the roof, there is the option to upgrade the felt to felt tiles or Cedar Shingles.

WALLS

All buildings have (Ex15mm) 12mm finished tongue & groove shiplap fixed to 47mm x 47mm & 47mm x 22mm finished framework. We also offer an (Ex19mm) 15mm finished Tongue & groove loglap upgrade on these buildings.

DOORS

The Brighton has a pair of doors 0.6m (24") wide by 1.76m (70") tall that have 3 panes of toughened glass in each door. The doors open to give a 1.2m (4') opening. They are hung on black antique style hinges and come with a 5 lever lock & black antique style handle.

WINDOWS

The Brighton Flat has a 12 pane window with the top two central panes opening in the front, whilst the Brighton Bow has a 12 pane fixed bay window in the front of the building instead of the flat window. Both the Brighton Flat & the Brighton Bow have a 6 pane fully opening sash in each side panel as standard.

VERANDA

A 2', 3' or 4' Veranda can be added to the Brighton as an optional extra. The 2' Veranda has an open front whilst the 3' & 4' Verandas have spindles across to the doors on the front.

HEIGHTS

The Brighton also has an internal eaves height of 1.82m (6') rising to an internal ridge height of 2.31m (91") on all fronts.

Extra height can be added to the building as an upgrade.

The buildings complies with the 2.5m maximum height restriction imposed when erecting a building under Permitted Development.

TREATMENT

Our buildings are treated both internally & externally with a spirit based preservative that helps to protect the timber from fungi, woodworm & blue stain. We do recommend that buildings are retreated within 6 months and then every year for continuous protection.

All of our buildings can be upgraded to a painted finish.

LAYOUT OPTIONS

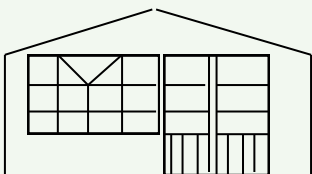

BRIGHTON FLAT OPTION A

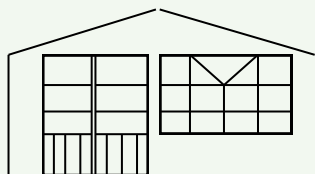

BRIGHTON FLAT OPTION B

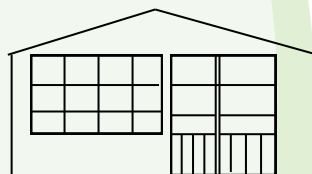

BRIGHTON BOW OPTION C

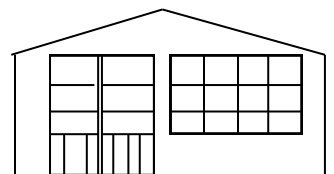

BRIGHTON BOW OPTION D

The Holt & The Weybourne make a stylish feature in any garden.

FLOOR

All buildings come with a Heavy Duty moisture resistant 18mm V313 caberboard flooring on 47mm x 47mm pressure treated floor joists.

ROOF

All buildings come with (Ex15mm) 12mm finished tongue & groove matching on 47mm x 47mm roof purlins, although some larger buildings will have these purlins upgraded where necessary. A heavy duty polyester based roofing felt is used as standard on all buildings. On all of our buildings there is a ventilation gap along the back of the roof, there is the option to upgrade the felt to felt tiles or cedar shingles.

WALLS

All buildings have (Ex19mm) 15mm finished tongue & groove shiplap fixed to 47mm x 47mm finished framework. We also offer an (Ex19mm) 15mm finished Tongue & groove loglap upgrade on these buildings.

DOORS

Both buildings feature a pair of 0.45m (18") wide doors by 1.76m (70") tall that give a 0.9m (36") entrance when both are open. The doors are hung on flush hinges and come with a 5 lever lock and antique style door handle.

WINDOWS

Both buildings have two top hung opening windows as standard, The Holt has just windows in the side panel whereas the Weybourne has both its doors & windows in the side panel. 3mm Toughened glass is used as standard.

HEIGHTS

Both buildings have an internal eaves height of 1.94m (76") with an internal ridge height of 2.28m (90").

Extra height can be added to the building as an upgrade.

The buildings complies with the 2.5m maximum height restriction imposed when erecting a building under Permitted Development.

TREATMENT

Our buildings are treated both internally & externally with a spirit based preservative that helps to protect the timber from fungi, woodworm & blue stain. We do recommend that buildings are retreated within 6 months and then every year for continuous protection.

All of our buildings can be upgraded to a painted finish.



HOLT



WEYBOURNE + FELT TILED ROOF



PAINTED WEYBOURNE + CEDAR SHINGLE ROOF

WINDOW GUIDE



8' WEYBOURNE



10' WEYBOURNE

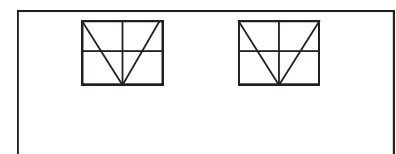

ALL HOLT

Kelling



KELLING

The Kelling is our most recent addition to our summerhouse range. The contemporary style doors and windows allows more light into your building.

FLOOR

Most buildings will come with (Ex15mm) 12mm finished tongue & groove matching on 47mm x 47mm pressure treated floor joists with an option to upgrade to a Heavy duty moisture resistant 18mm V313 Caberboard flooring. All buildings over 8' in each direction eg 8' x 8' but not 9' x 7' are upgraded as standard.

ROOF

All buildings come with (Ex15mm) 12mm finished tongue & groove matching on 47mm x 47mm & 47mm x 22mm roof purlins, although some larger buildings will have these purlins upgraded where necessary. There is a 0.38m (15") roof canopy over the front of the building as standard on the Kelling. A Heavy Duty Polyester based roofing felt is used as standard on all buildings. On all of our buildings there is a ventilation gap along the back of the roof. Apart from on the Pent style, there is the option to upgrade the felt to felt tiles or Cedar Shingles.

WALLS

All buildings have (Ex15mm) 12mm finished tongue & groove shiplap fixed to 47mm x 47mm & 47mm x 22mm finished framework. We also offer an (Ex19mm) 15mm finished Tongue & groove loglap upgrade on these buildings.

DOORS

The Kelling has a pair of doors 0.6m (24") wide by 1.76m (70") tall that have a large single pane of toughened glass in each door. The doors open to give a 4' opening. They are hung on antique style hinges and they come with a 5 lever lock & antique handle.

WINDOWS

The Kelling has fixed windows alongside the doors in the front of the building and an opening window in each side. Some larger buildings will have an extra fixed pane of glass in each side as well. A guide for this can be found at the bottom of this page. All the glass that we use is 3mm toughened for safety.

HEIGHTS

The Pent Kelling has a generous internal eaves height of 1.82m (6') rising to an internal ridge height of 2.06m (81").

The Kelling also has an internal eaves height of 1.82m (6') rising to an internal ridge height of

- 2.06m (81") on 7' & 8' Gable ends
- 2.13m (84") on 9' Gable ends
- 2.18m (86") on 10' & 11' Gable ends
- 2.31m (91") on 12' Gable ends

Extra height can be added to the building as an upgrade. Please add an extra 7" on to these heights for the external dimension.

The buildings complies with the 2.5m maximum height restriction imposed when erecting a building under Permitted Development.

TREATMENT

Our buildings are treated both internally & externally with a spirit based preservative that helps to protect the timber from fungi, woodworm & blue stain. We do recommend that buildings are retreated within 6 months and then every year for continuous protection.

All of our buildings can be upgraded to a painted finish.



PENT KELLING



PAINTED KELLING

KELLING LAYOUT OPTIONS & WINDOW AMOUNTS

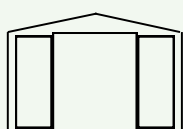

8' TO 11' FRONT

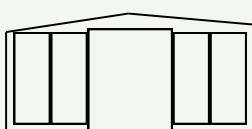

12' & ABOVE FRONT

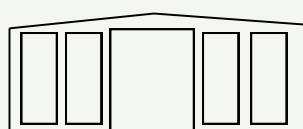

14' & ABOVE FRONT OPTION B

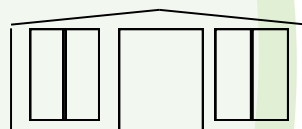

14' & ABOVE FRONT OPTION C

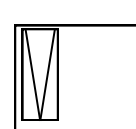

6' & 7' SIDES

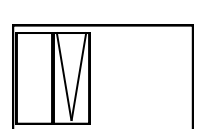

8' & ABOVE SIDES

Waendal



Quality Garden Buildings
Established 1982

The Waendal is our original Classic Summerhouse that you can sit & relax in for hours on end.

FLOOR

Most buildings will come with (Ex15mm) 12mm finished tongue & groove matching on 47mm x 47mm pressure treated floor joists with an option to upgrade to Heavy duty moisture resistant 18mm V313 Caberboard flooring. All buildings over 8' in each direction eg 8' x 8' but not 9' x 7' are upgraded as standard.

ROOF

All buildings come with an (Ex15mm) 12mm finished tongue & groove matching on 47mm x 47mm x 22mm roof purlins, although some larger buildings will have these purlins upgraded where necessary. There is a 0.38m (15") roof canopy over the front of the building as standard on the Waendal. A Heavy Duty Polyester based roofing felt is used as standard on all buildings. On all of our buildings there is a ventilation gap along the back of the roof. Apart from on the Pent style, there is the option to upgrade the felt to felt tiles or Cedar Shingles.

WALLS

All buildings have (Ex15mm) 12mm finished tongue & groove shiplap fixed to 47mm x 47mm & 47mm x 22mm finished framework. We also offer an (Ex19mm) 15mm finished Tongue & groove loglap upgrade on these buildings.

DOORS

The Waendal has a pair of doors 0.6m (24") wide by 1.76m (70") tall that have 2 panes of toughened glass in each door. The doors open to give a 1.2m (4') opening. They are hung on black antique style hinges and they come with a 5 lever lock & black antique style handle.

WINDOWS

The Waendal has fixed windows alongside the doors in the front & windows including an opening sash in each side panel. The amount of windows depends upon the size of the building. A guide for this can be found on page 35. All the glass that we use is 3mm toughened for safety.

VERANDA

A 2', 3' or 4' Veranda can be added to the Waendal as an optional extra. The 2' Veranda has an open front whilst the 3' & 4' Verandas have spindles across to the doors on the front.

HEIGHTS

The Pent Waendal has a generous internal eaves height of 1.82m (6') rising to an internal ridge height of 2.06m (81").

The Waendal also has an internal eaves height of 1.82m (6') rising to an internal ridge height of 2.06m (81") on 7' & 8' Gable ends
2.13m (84") on 9' Gable ends
2.18m (86") on 10' & 11' Gable ends
2.31m (91") on 12' Gable ends

Extra height can be added to the building as an upgrade. Please add an extra 7" on to these heights for the external dimension.

The buildings complies with the 2.5m maximum height restriction imposed when erecting a building under Permitted Development.

TREATMENT

Our buildings are treated both internally & externally with a spirit based preservative that helps to protect the timber from fungi, woodworm & blue stain. We do recommend that buildings are retreated within 6 months and then every year for continuous protection.

All of our buildings can be upgraded to a painted finish.



WAENDAL



PENT WAENDAL



WAENDAL + 2' VERANDA



PAINTED WAENDAL OPTION A

LAYOUT OPTIONS



OPTION A ALL SIZES

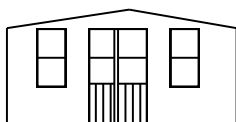

OPTION B 12' & ABOVE

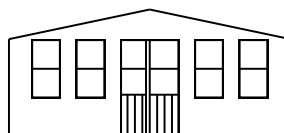

OPTION C 14' & ABOVE

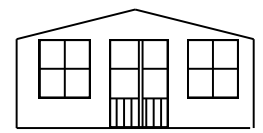

OPTION D 14' & ABOVE



WILBYE



WILBYE + 2' VERANDA



WILBYE + 4' VERANDA



**WILBYE OPTION B + FELT
TILED ROOF**

The Wilbye is another Georgian style Summerhouse but this time with full height glazing on the front & deeper side windows.

FLOOR

Most buildings will come with 12mm finished tongue & groove matching on 47mm x 47mm pressure treated floor joists with an option to upgrade to Heavy duty v313 Caberboard flooring. All buildings over 8' in each direction eg 8' x 8' but not 9' x 7' are upgraded as standard.

ROOF

All buildings come with 12mm finished tongue & groove matching on 47mm x 47mm & 47mm x 22mm roof purlins, although some larger buildings will have these purlins upgraded where necessary. There is a 0.38m (15") roof canopy over the front of the building as standard on the Wilbye. A Heavy Duty Polyester based roofing felt is used as standard on all buildings. On all of our buildings there is a ventilation gap along the back of the roof. Apart from on the Pent style, there is the option to upgrade the felt to felt tiles or Cedar Shingles.

WALLS

All buildings have a 12mm finished tongue & groove shiplap fixed to 47mm x 47mm & 47mm x 22mm finished framework. We also offer a 15mm Tongue & groove loglap upgrade on these buildings.

DOORS

The Wilbye has a pair of doors 0.6m (24") wide by 1.76m (70") tall that have 10 panes of toughened glass in each door. The doors open to give a 1.2m (4') opening. They are hung on black antique style hinges and they come with a 5 lever lock & black antique style handle.

WINDOWS

The Wilbye has fixed windows alongside the doors in the front & an opening sash in each side panel. The amount of windows depends upon the size of the building, a guide for this can be found on page 35. All the glass that we use is 3mm toughened for safety.

VERANDA

A 2', 3' or 4' Veranda can be added to the Wilbye as an optional extra. The 2' Veranda has an open front whilst the 3' & 4' Verandas have spindles across to the doors on the front.

HEIGHTS

The Pent Wilbye has a generous internal eaves height of 1.82m (6') rising to an internal ridge height of 2.06m (81").

The Wilbye also has an internal eaves height of 1.82m (6') rising to an internal ridge height of

- 2.06m (81") on 7' & 8' Gable ends
- 2.13m (84") on 9' Gable ends
- 2.18m (86") on 10' & 11' Gable ends
- 2.31m (91") on 12' Gable ends

Extra height can be added to the building as an upgrade. Please add an extra 7" on to these heights for the external dimension.

The buildings complies with the 2.5m maximum height restriction imposed when erecting a building under Permitted Development.

TREATMENT

Our buildings are treated both internally & externally with a spirit based preservative that helps to protect the timber from fungi, woodworm & blue stain. We do recommend that buildings are retreated every year for continuous protection.

All of our buildings can be upgraded to a painted finish.

LAYOUT OPTIONS

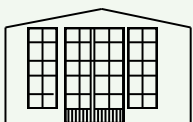

OPTION A ALL SIZES



OPTION B 12' & ABOVE



OPTION C 14' & ABOVE



OPTION D 14' & ABOVE

Octagonals

Our range of Octagonal buildings make a stunning feature in your garden whichever style you choose.

FLOOR

The Brampton comes with (Ex19mm) 15mm finish tongue and groove matching fixed to 47mm x 47mm pressure treated floor joists.

ROOF

The Brampton comes with (Ex15mm) 12mm finish tongue and groove matching fixed to 47mm x 47mm Roof purlins. The Brampton comes felt tiled as standard (there is a choice of colours) and there is the option to upgrade to Cedar shingles. A Gold or Black finial or ball is fitted as standard.

WALLS

The Brampton comes with (Ex19mm) 15mm finish tongue & groove loglap cladding fixed to 47mm x 47mm framework.

DOORS

The 8' X 8' Brampton comes with a single 0.9m (30") wide by 1.76m (70") tall door hung on antique style hinges. It is fitted with a mortice lock & antique style handle. The 10' x 10' & 12' x 12' models come with double doors as standard. The Brampton comes with 3mm toughened glass as standard.

WINDOWS

There are four choices of window style with the Brampton, either Standard, Lead light, Arch Top or Georgian, and each building comes with two opening windows & 3mm toughened glass as standard.

TREATMENT

Our buildings are treated both internally & externally with a spirit based preservative that helps to protect the timber from fungi, woodworm & blue stain. We do recommend that buildings are retreated within 6 months and then every year for continuous protection. All of our buildings can be upgraded to a painted finish.

THE BRAMPTON



STANDARD BRAMPTON



LEAD LIGHT BRAMPTON



BLACK BALL ROOF TOP FINISH



ARCH TOP BRAMPTON + PAINTED & CEDAR SHINGLED



INTERNAL ROOF FINISH ON OCTAGONAL BUILDINGS



GEORGIAN BRAMPTON + WINDOW BOXES

Octagonals

THE DODDINGTON



PAINTED DODDINGTON

FLOOR

The Doddington comes with (Ex19mm) 15mm finish tongue and groove matching fixed to 47mm x 47mm pressure treated floor joists.

ROOF

The Doddington comes with (Ex15mm) 12mm finish tongue and groove matching fixed to 47mm x 47mm roof purlins. The Doddington comes felt tiled as standard (there is a choice of colours) and there is the option to upgrade to Cedar shingles. A Gold or Black finial or ball is fitted as standard.

WALLS

The Doddington comes with (Ex19mm) 15mm finish tongue & groove matching cladding that is vertically fixed to 47mm x 47mm framework.

DOORS

The Doddington comes with a pair of 0.45m (16") wide by 1.76m(70") tall doors hung on antique style hinges, it is fitted with a mortice lock & antique style handle. It comes with 3mm toughened glass as standard.

WINDOWS

The Doddington comes with Arch Top detailed windows and each building comes with four opening windows and has 3mm toughened glass as standard.

TREATMENT

Our buildings are treated both internally & externally with a spirit based preservative that helps to protect the timber from fungi, woodworm & blue stain. We do recommend that buildings are retreated within 6 months and then every year for continuous protection.

All of our buildings can be upgraded to a painted finish.

THE STRATFORD



CEDAR SHINGLED STRATFORD

FLOOR

The Stratford comes with (Ex19mm) 15mm finish tongue and groove matching fixed to 47mm x 47mm pressure treated floor joists.

ROOF

The Stratford comes with (Ex15mm) 12mm finish tongue and groove matching fixed to 47mmx47mm Roof purlins. The Stratford comes felt tiled as standard (there is a choice of colours) and there is the option to upgrade to Cedar shingles. A Gold or Black finial or ball is fitted as standard.

WALLS

The Stratford comes with (Ex19mm) 15mm finish tongue & groove Shiplap cladding that is vertically fixed to 47mmx47mm framework.

DOORS

The Stratford comes with a pair of 0.45m (18") wide by 1.76m(70") tall doors hung on antique style hinges, it is fitted with a mortice lock & antique style handle. It comes with 3mm toughened glass as standard.

WINDOWS

The Stratford comes with four opening windows and has 3mm toughened glass as standard.

TREATMENT

Our buildings are treated both internally & externally with a spirit based preservative that helps to protect the timber from fungi, woodworm & blue stain. We do recommend that buildings are retreated within 6 months and then every year for continuous protection.

All of our buildings can be upgraded to a painted finish.

FLOOR PLANS

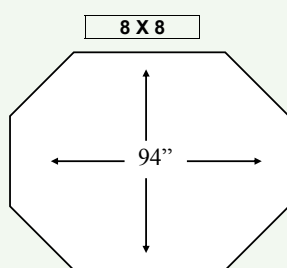

39 1/4"

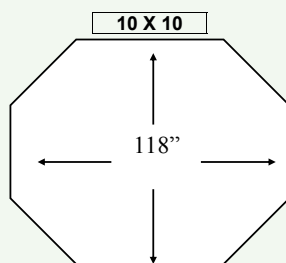

49 1/2"

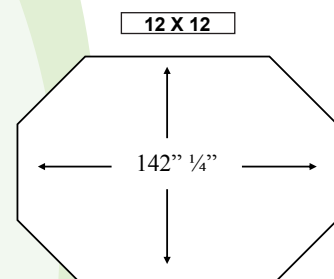

59"

Buildings For Children

The **Littlehouse** is available as a 1.8m x 1.2m (6'x4') or 1.8m x 1.8m (6'x6') building. The Littlehouse is 1.27m (50") high internally at the eaves & 1.52m (60") high internally at the ridge. The Littlehouse has a 0.6m (24") wide x 1.2m (48") high door, the heart shape in the door is optional. The door is hung on piano hinges, with a roller catch & pull handle, and there is acrylic in the windows for children's safety.

The buildings are constructed of (Ex15mm) 12mm finished tongue & groove shiplap fixed on 45mm x 45mm & 45mm x 22mm finished framework. The floor has (Ex15mm) 12mm finished tongue & groove matching fixed to 47mm x47mm finished pressure treated floor joists. The roof is (Ex15mm) 12mm finished tongue & groove matching fixed to 45mm x 45mm purlins which is covered with a Heavy Duty Polyester based roofing felt. There is a 0.38m (15") roof canopy as standard on the Littlehouse.

Our buildings are treated both internally & externally with a spirit based preservative that helps to protect the timber from fungi, woodworm & blue stain. We do recommend that buildings are retreated within 6 months and then every year for continuous protection. All of our buildings can be upgraded to a painted finish.



LITTLEHOUSE INC. OPTIONAL ♥ ON DOOR

The **Hideaway** is available in 1.8m x 1.8m (6'x6') or 1.8m x 2.4m (6'x8') including the balcony. The Hideaway is 1.27m (50") high internally at the eaves & 1.52m (60") high internally at the ridge. The Hideaway has a 0.6m (24") wide x 1.2m (48") high door, a heart shape in the door is optional. The door is hung on piano hinges, with a roller catch & pull handle, and there is acrylic in the windows for children's safety.

The buildings are constructed of (Ex15mm) 12mm finished tongue & groove shiplap fixed on 45mm x 45mm & 45mm x 22mm finished framework. The floor has (Ex15mm) 12mm finished tongue & groove matching fixed to 47mm x47mm finished pressure treated floor joists. The roof is (Ex15mm) 12mm finished tongue & groove matching fixed to 45mm x 45mm purlins which is covered with a Heavy Duty Polyester based roofing felt. There is a 0.6m (24") balcony as standard on the Hideaway.

Our buildings are treated both internally & externally with a spirit based preservative that helps to protect the timber from fungi, woodworm & blue stain. We do recommend that buildings are retreated within 6 months and then every year for continuous protection. All of our buildings can be upgraded to a painted finish.



HIDEAWAY

The **Alpine** is available as a 2.4m x 1.8m (8'x6') or 3m x 1.8m (10'x6") building, although a 2' balcony can be added to either size as an optional extra. The Alpine also features a second storey to the high side of the building with the platform, ladder & safety rail that come with this building. The Alpine is 1.04m (44") high internally at the low eaves, 1.73m(68") high internally at the high eaves & 2.31m (91") high internally at the ridge. The Alpine has a 0.6m (24") wide x 1.2m (48") high door, the heart shape in the door is optional. The door is hung on piano hinges, with a roller catch & pull handle, and there is acrylic in the windows for children's safety.

The buildings are constructed of (Ex15mm) 12mm finished tongue & groove shiplap fixed on 45mm x 45mm & 45mm x 22mm finished framework. The floor has (Ex15mm) 12mm finished tongue & groove matching fixed to 47mm x47mm finished pressure treated floor joists. The roof is (Ex15mm) 12mm finished tongue & groove matching fixed to 45mm x 45mm purlins which is covered with a Heavy Duty Polyester based roofing felt.

Our buildings are treated both internally & externally with a spirit based preservative that helps to protect the timber from fungi, woodworm & blue stain. We do recommend that buildings are retreated within 6 months and then every year for continuous protection. All of our buildings can be upgraded to a painted finish.



ALPINE



ALPINE LADDER & PLATFORM



ALPINE + VERANDA

Dual-Purpose Combination Buildings

Do you feel that you need two buildings in your garden, but feel that they will look too much in it. Why not go for a dual-purpose building. All of our buildings can have a partition put in them and then extra doors & windows added to give a summerhouse & shed storage building. If you just want a shed for you and one for your partner, the simple addition of a partition and door will solve this problem. All dual-purpose buildings are made to the standard specification of whichever building you choose to develop.



WAENDAL & SHED



BESPOKE ASHBY DUAL



BRIGHTON FLAT & SHED



TWO IN ONE



THE SYWELL

The Sywell combines a shed with an open fronted storage area that works well for the storage of many things especially logs. The shed section is 6' x 6' or 6' x 8' with the storage section being 6' x 2'.

FLOOR

The shed section comes with Heavy duty moisture resistant 18mm V313 caberboard flooring fixed to 47mm x 47mm pressure treated floor joists, whilst the open section has 18mm thick decking boards fixed to 47mm x 47mm pressure treated floor joists.

ROOF

The Sywell comes with (Ex15mm) 12mm finished tongue and groove matching on 47mm x 47mm & 47mm x 22mm finished roof purlins. A Heavy Duty Polyester based roofing felt is used as standard on all buildings. On all of our buildings there is a ventilation gap along the back of the roof.

WALLS

The Sywell has (Ex15mm) 12mm finished tongue & groove shiplap fixed to 47mm x 47mm & 47mm x 22mm finished framework. We also offer an (Ex19mm) 15mm finished tongue & groove loglap cladding as an upgrade on this building.

DOORS

The Sywell features a 0.76m (30") wide by 1.82m (72") Tall box framed single personal door, fitted with a mortice lock & handle. The door can be left hinge or right hinge hung to suit your garden needs.

WINDOWS

The Sywell has a 6 pane Georgian window next to the door. All of the glass is 3mm toughened for safety.

HEIGHTS

The Sywell garden building has a generous internal eaves height of 1.82m (6') rising to an internal ridge height of 2.06m (81"). Please add an extra 7" on to these heights for the external dimension. All standard buildings comply with the 2.5m maximum height restriction imposed when erecting a building under Permitted Development.

TREATMENT

Our buildings are treated both internally & externally with a spirit based preservative that helps to protect the timber from fungi, woodworm & blue stain. We do recommend that buildings are retreated within 6 months and then every year for continuous protection. All of our buildings can be upgraded to a painted finish.

Bespoke Buildings

All of our buildings are made to order in the UK & all of the buildings below have been made to customers own designs. Why not design the building of your dreams? Take your idea into your local agent and see if we can manufacture your dream building to the specification of your choice.



Floor Sizes

WIDTH

LENGTH	WIDTH									
	4'	5'	6'	7'	8'	9'	10'	11'	12'	
4'	46 x 47	46 x 59	46 x 70	46 x 81	46 x 93	46 x 105	46 x 117	46 x 129	46 x 141	
5'	58 x 47	58 x 59	58 x 70	58 x 81	58 x 93	58 x 105	58 x 117	58 x 129	58 x 141	
6'	70 x 47	70 x 59	70 x 70	70 x 81	70 x 93	70 x 105	70 x 117	70 x 129	70 x 141	
7'	82 x 47	82 x 59	82 x 70	82 x 81	82 x 93	82 x 105	82 x 117	82 x 129	82 x 141	
8'	94 x 47	94 x 59	94 x 70	94 x 81	94 x 93	94 x 105	94 x 117	94 x 129	94 x 141	
9'	106 x 47	106 x 59	106 x 70	106 x 81	106 x 93	106 x 105	106 x 117	106 x 129	106 x 141	
10'	118 x 47	118 x 59	118 x 70	118 x 81	118 x 93	118 x 105	118 x 117	118 x 129	118 x 141	
11'	130 x 47	130 x 59	130 x 70	130 x 81	130 x 93	130 x 105	130 x 117	130 x 129	130 x 141	
12'	142 x 47	142 x 59	142 x 70	142 x 81	142 x 93	142 x 105	142 x 117	142 x 129	142 x 141	
13'	154 x 47	154 x 59	154 x 70	154 x 81	154 x 93	154 x 105	154 x 117	154 x 129	154 x 141	
14'	166 x 47	166 x 59	166 x 70	166 x 81	166 x 93	166 x 105	166 x 117	166 x 129	166 x 141	
15'	178 x 47	178 x 59	178 x 70	178 x 81	178 x 93	178 x 105	178 x 117	178 x 129	178 x 141	
16'	190 x 47	190 x 59	190 x 70	190 x 81	190 x 93	190 x 105	190 x 117	190 x 129	190 x 141	
17'	202 x 47	202 x 59	202 x 70	202 x 81	202 x 93	202 x 105	202 x 117	202 x 129	202 x 141	
18'	214 x 47	214 x 59	214 x 70	214 x 81	214 x 93	214 x 105	214 x 117	214 x 129	214 x 141	
19'	226 x 47	226 x 59	226 x 70	226 x 81	226 x 93	226 x 105	226 x 117	226 x 129	226 x 141	
20'	238 x 47	238 x 59	238 x 70	238 x 81	238 x 93	238 x 105	238 x 117	238 x 129	238 x 141	
21'	250 x 47	250 x 59	250 x 70	250 x 81	250 x 93	250 x 105	250 x 117	250 x 129	250 x 141	
22'	262 x 47	262 x 59	262 x 70	262 x 81	262 x 93	262 x 105	262 x 117	262 x 129	262 x 141	
23'	274 x 47	274 x 59	274 x 70	274 x 81	274 x 93	274 x 105	274 x 117	274 x 129	274 x 141	
24'	286 x 47	286 x 59	286 x 70	286 x 81	286 x 93	286 x 105	286 x 117	286 x 129	286 x 141	

WIDTH

LENGTH	WIDTH							
	13	14	15	16	17	18	19	20
8	94x153	94x165	94x177	94x189	94x201	94x213	94x225	94x237
9	106x153	106x165	106x177	106x189	106x201	106x213	106x225	106x237
10	118x153	118x165	118x177	118x189	118x201	118x213	118x225	118x237
11	130x153	130x165	130x177	130x189	130x201	130x213	130x225	130x237
12	142x153	142x165	142x177	142x189	142x201	142x213	142x225	142x337

BALCONY FLOOR SIZES

BALCONY DEPTH

WIDTH	BALCONY DEPTH		
	2'	3'	4'
6'	70x22	70x34	70x47
7'	81x22	81x34	81x47
8'	93x22	93x34	93x47
9'	105x22	105x34	105x47
10'	117x22	117x34	117x47
11'	129x22	129x34	129x47
12'	141x22	141x34	141x47
13'	153x22	153x34	153x47
14'	165x22	165x34	165x47
15'	177x22	177x34	177x47
16'	189x22	189x34	189x47
17'	201x22	201x34	201x47
18'	213x22	213x34	213x47
19'	225x22	225x34	225x47
20'	237x22	237x34	237x47
21'	249x22	249x34	249x47
22'	261x22	261x34	261x47
23'	273x22	273x34	273x47
24'	285x22	285x34	285x47

METRIC CONVERSION CHART

22"= 559mm	154"= 3912mm
34"= 864mm	165"= 4191mm
46"= 1169mm	166"= 4216mm
47"= 1194mm	177"= 4496mm
58"= 1473mm	178"= 4521mm
59"= 1499mm	189"= 4801mm
70"= 1778mm	190"= 4826mm
81"= 2057mm	201"= 5105mm
82"= 2083mm	202"= 5131mm
93"= 2362mm	213"= 5410mm
94"= 2388mm	214"= 5436mm
105"= 2667mm	225"= 5715mm
106"= 2692mm	226"= 5740mm
117"= 2972mm	237"= 6020mm
118"= 2997mm	238"= 6045mm
129"= 3277mm	250"= 6350mm
130"= 3302mm	262"= 6655mm
141"= 3581mm	274"= 6960mm
142"= 3607mm	286"= 7265mm
153"= 3886mm	

Building Features



Quality Garden Buildings
Established 1982

SHED FEATURES



SHED HANDLE

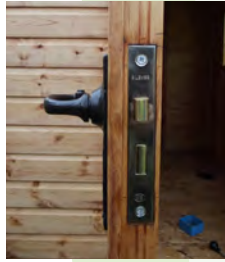

3 LEVER LOCK



SHED DOOR T HINGE

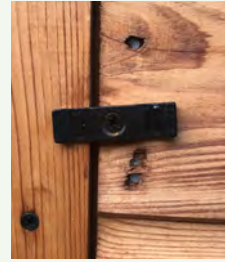

DOOR TURNBUTTON



BRENTON PADBOLT

MOST BUILDINGS



CORNER COVERS

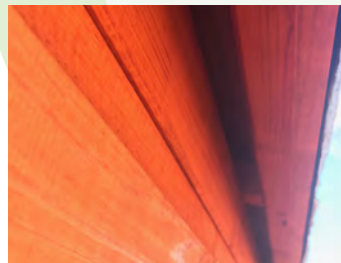

VENTILATION GAP

ALL BUILDINGS

STREAMLINE & POTTING SHEDS

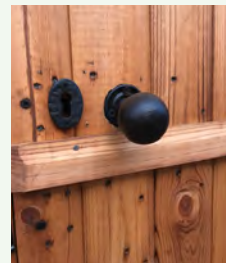

BLACK KNOB

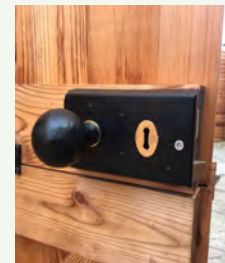

RIMLOCK

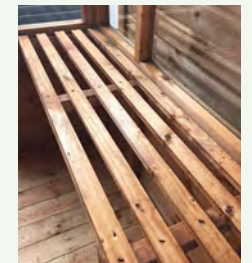

SLATTED BENCH

BARNWELLS



HOOK & BAND HINGE



SILVER HANDLE

PLAYHOUSES

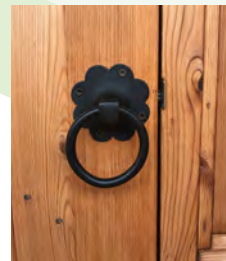

PULL HANDLE



ROLLER CATCH

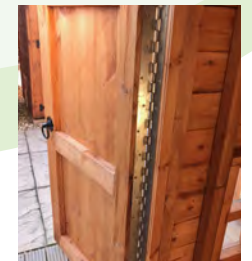

PIANO HINGE

SUMMERHOUSES

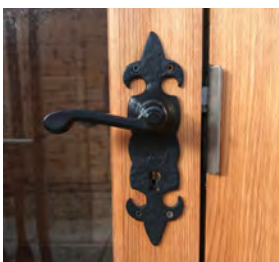

ANTIQUE HANDLE



5 LEVER LOCK



SUMMERHOUSE HINGE

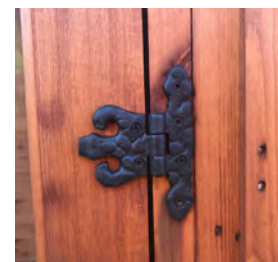

BUTTERFLY HINGE

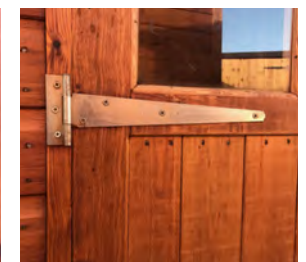

ASHBY HINGE

OPTIONAL UPGRADES



FELT TILES (RED SHOWN)



CEDAR SHINGLES



WORK BENCH

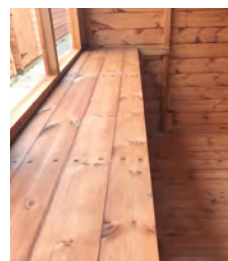

SOLID BENCH



15" CANOPY



V313 FLOORING

Pent & Apex Sheds

CLASSIC WINDOW AMOUNTS

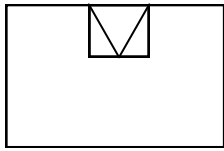

4' PENT OR APEX

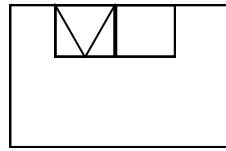

5' & 6' PENT OR APEX

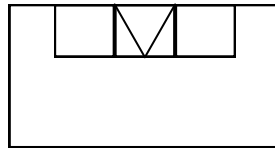

7', 8' OR 9' PENT OR APEX

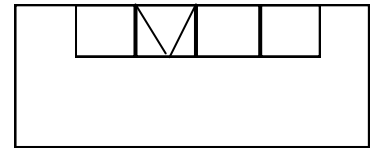

10' TO 15'' PENT OR APEX

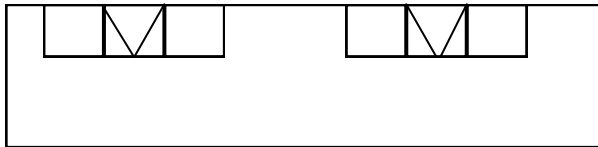

16' TO 20' PENT OR APEX

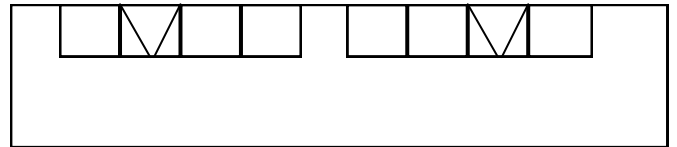

21' TO 24' PENT OR APEX

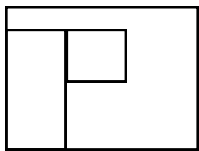

4' & 5' PENT OR APEX

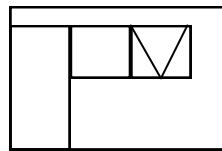

6' & 7' PENT OR APEX

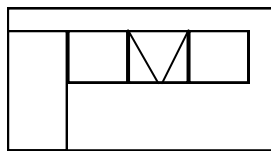

8' TO 11' PENT OR APEX

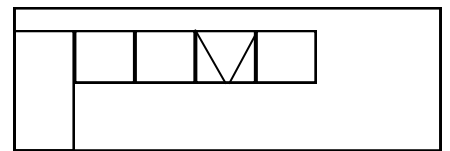

12' TO 15' PENT OR APEX

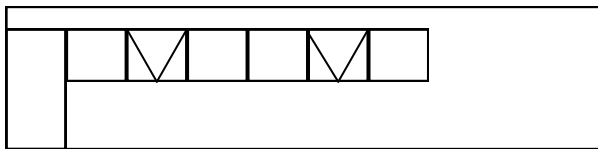

16' TO 20' PENT OR APEX

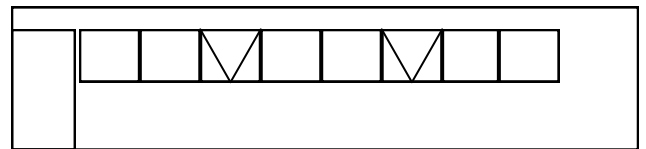

21' TO 24' PENT OR APEX

GEORGIAN WINDOW AMOUNTS

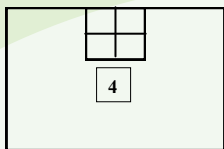

4' PENT OR APEX

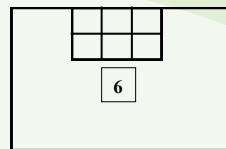

5' & 6' PENT OR APEX

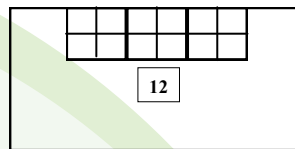

7' TO 13' PENT OR APEX

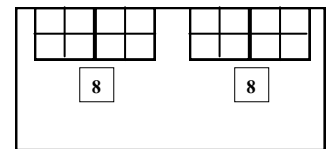

14' TO 17'' PENT OR APEX

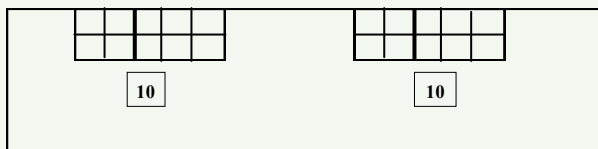

18' TO 21' PENT OR APEX

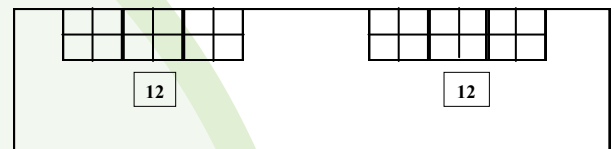

22' TO 24' PENT OR APEX

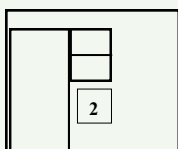

4' PENT OR APEX

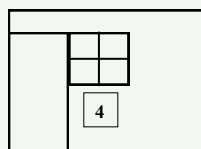

5' PENT OR APEX

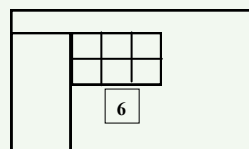

6' PENT OR APEX

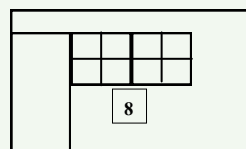

7' PENT OR APEX

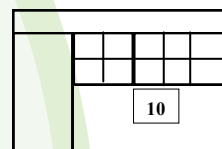

8' PENT OR APEX

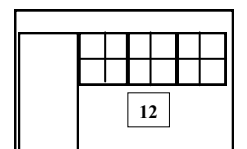

9' TO 13' PENT OR APEX

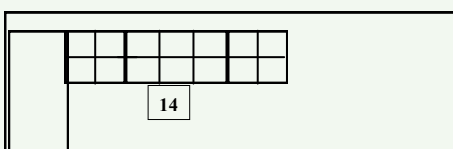

14' TO 17' PENT OR APEX

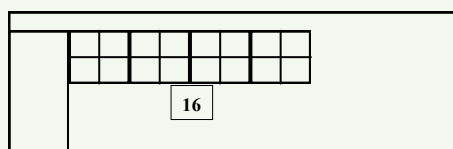

18' TO 21' PENT OR APEX

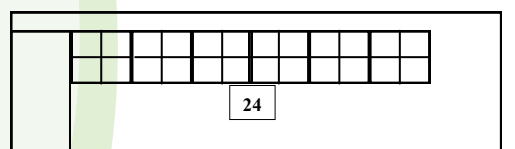

22' TO 24' PENT OR APEX

Woodford & Pent Sheds (Options E&K)



Quality Garden Buildings
Established 1982

CLASSIC WINDOW AMOUNTS

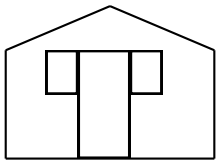

5' FRONT

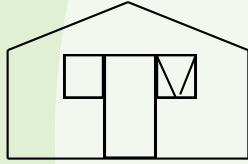

6' TO 9' FRONT

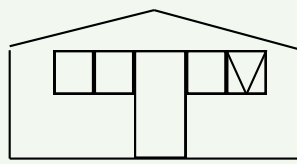

10' TO 14' FRONT

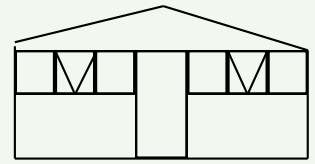

15' & ABOVE FRONT

GEORGIAN WINDOW AMOUNTS

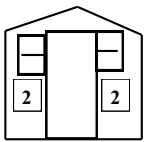

5' FRONT

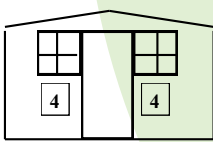

6' TO 9' FRONT

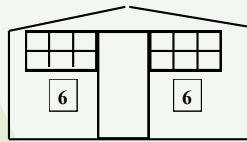

10' & 11' FRONT

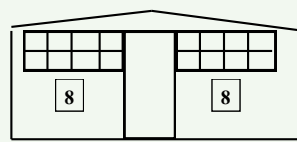

12' TO 14' FRONT

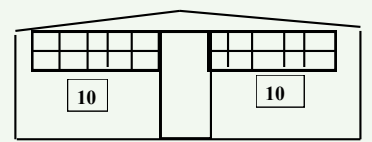

15' & ABOVE FRONT

DENNINGTONS

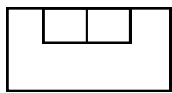

6' APEX FRONT

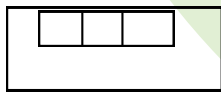

7' & 8' APEX FRONT

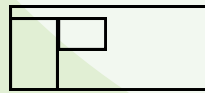

6' PENT FRONT

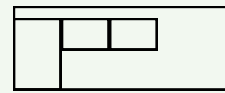

7' PENT FRONT

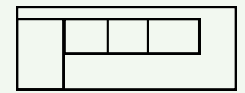

8' PENT FRONT

EUROS

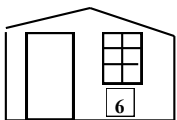

7' EURO FRONT

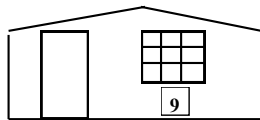

8' & ABOVE EURO

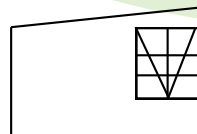

6'X6'

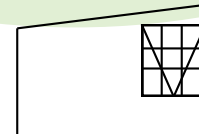

ALL OTHER SIZES

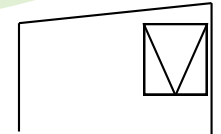

CLASSIC ALL SIZES

WHYTEWELL

STANWELLS

CLASSIC WINDOW AMOUNTS

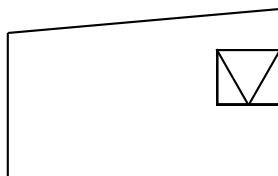

6'X6'

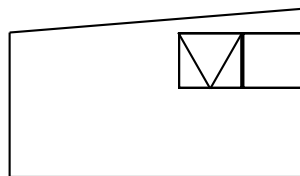

7'X7' & 8'X8'

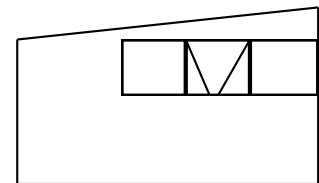

9'X9' & 10'X10'

GEORGIAN WINDOW AMOUNTS

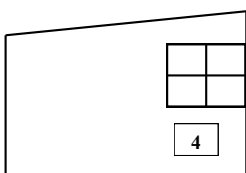

6'X6'

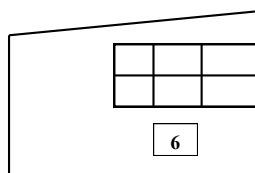

7'X7'

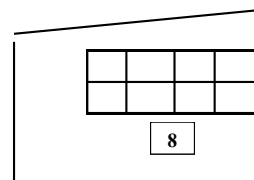

8'X8'

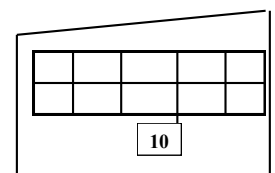

9'X9' & 10'X10'

Potting Sheds

ALL BUILDING STYLES

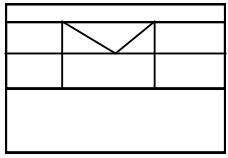

6' & 7' FRONT

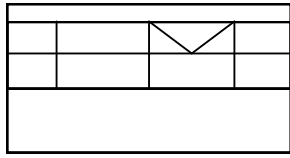

8' FRONT

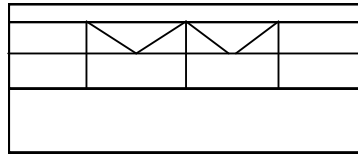

9', 10' & 11' FRONT

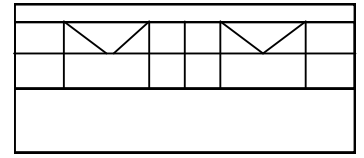

12' & ABOVE FRONT

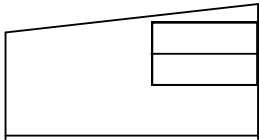

ALL SIZES PENT WINDOW END

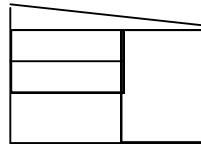

4' & 5' PENT DOOR END

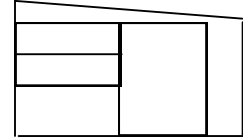

6' & ABOVE PENT DOOR END

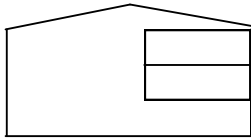

ALL SIZES APEX WINDOW END

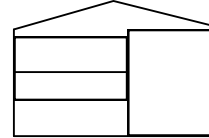

4' & 5' APEX DOOR END

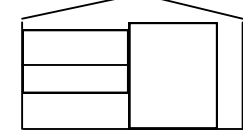

6' & ABOVE APEX DOOR END

BARNWELLS

CLASSIC

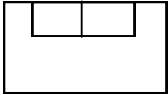

6' PENT OR APEX



7' TO 9' PENT OR APEX



10' TO 15' PENT OR APEX

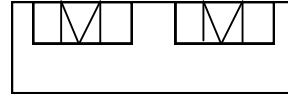

16' TO 19' PENT OR APEX

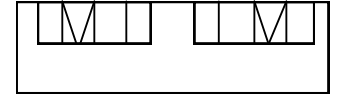

20' & ABOVE PENT OR APEX

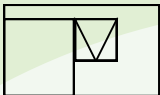

6' PENT OR APEX

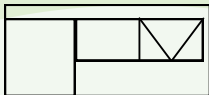

7' PENT OR APEX

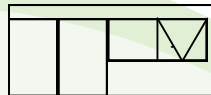

8' PENT OR APEX



9' TO 11' PENT OR APEX

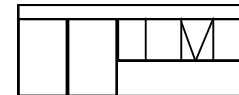

12' TO 16' PENT OR APEX

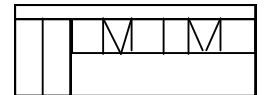

17' & ABOVE PENT OR APEX

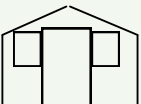

6' TRANS

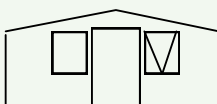

7' TRANS

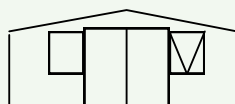

8' TO 11' TRANS

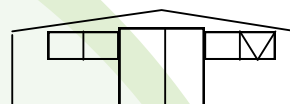

12' TO 14' TRANS

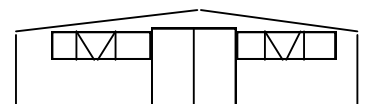

15' & ABOVE TRANS

GEORGIAN

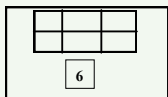

6' PENT OR APEX

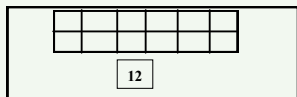

7' TO 15' PENT OR APEX

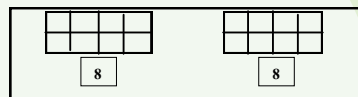

16' TO 19' PENT OR APEX

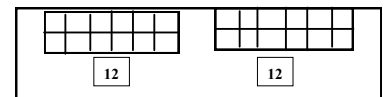

20' & ABOVE PENT OR APEX

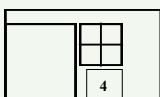

6' PENT OR APEX

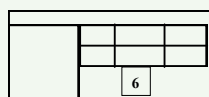

7' PENT OR APEX

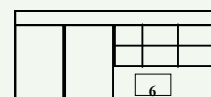

8' PENT OR APEX

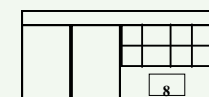

9' TO 11' PENT OR APEX

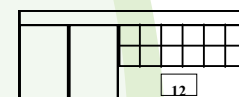

12' TO 16' PENT OR APEX

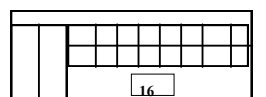

17' & ABOVE PENT OR APEX

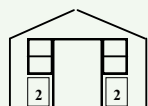

6' TRANS

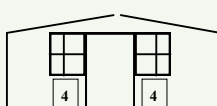

7' TRANS

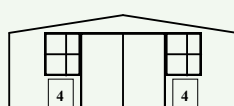

8' TO 11' TRANS

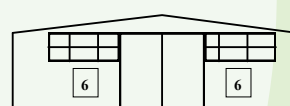

12' TO 14' TRANS

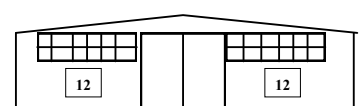

15' & ABOVE TRANS

Summerhouses



Quality Garden Buildings
Established 1982

ALDSWORTH

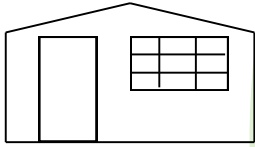

ALL SIZES

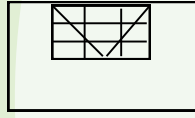

SIDE ALL SIZES

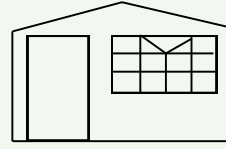

12' & ABOVE FLAT

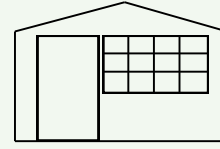

12' & ABOVE BOW

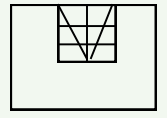

SIDES ALL SIZES

BARTONS

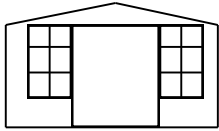

7' TO 11' FRONT

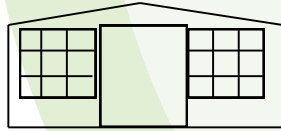

12' & 13' FRONT

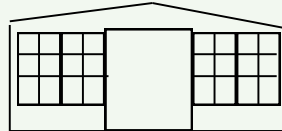

14' TO 17' FRONT

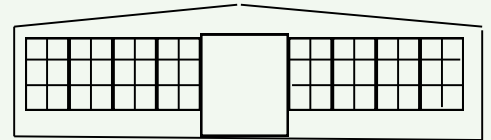

18' TO 20' FRONT

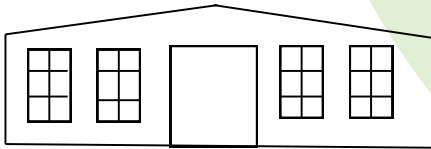

14' TO 20' FRONT OPTION B

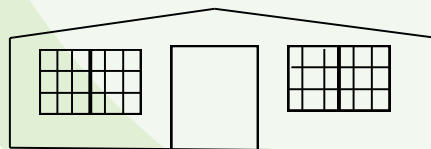

14' TO 20' FRONT OPTION C

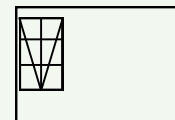

5' TO 7' SIDES

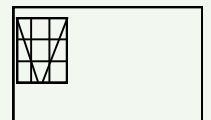

8' & ABOVE SIDES

WAENDALS

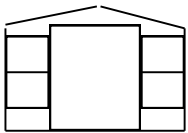

7' TO 11' FRONT

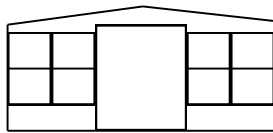

12' & ABOVE FRONT

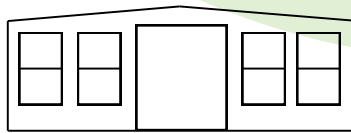

14' & ABOVE FRONT OPTION B

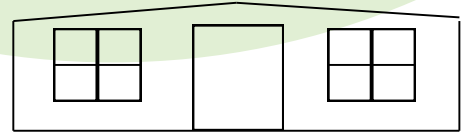

14' & ABOVE FRONT OPTION C

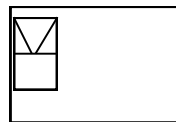

5' TO 7' SIDES

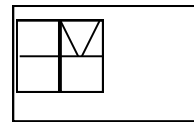

8' & ABOVE SIDES

WILBYES

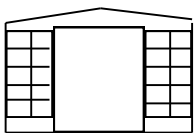

7' TO 11' FRONT

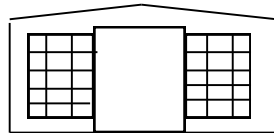

12' TO 17' FRONT

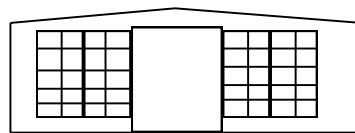

18' & ABOVE FRONT

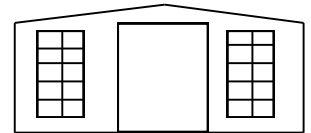

12' TO 17' FRONT OPTION B

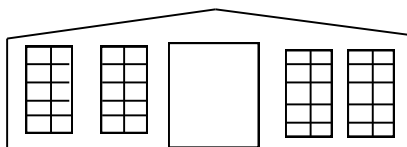

18' & ABOVE FRONT OPTION B

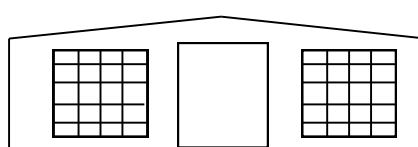

18' & ABOVE FRONT OPTION C

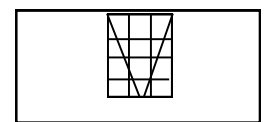

SIDES ALL SIZES



Quality Garden Buildings
Established 1982