

Practice profile

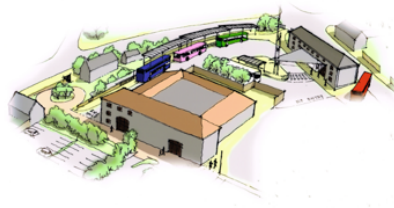

South Elevations



Floor Plan



Client focus ...
...above all else



Catherine Read and **Michael Spicer** formed their practice in February 2012 achieving **RIBA Chartered Practice** status in March – bringing together established design, technical and management expertise from **NPS Group** to provide a client focused, efficient and high quality service offering good value to existing and new clients in the private, commercial and public sectors.



Read Spicer Architecture operate an ethical, socially responsible business, regulated by ARB and the RIBA Code of Conduct. We endeavour to produce practical, pragmatic design solutions which are socially and environmentally sustainable, energy efficient, cost effective and of a quality that enhances the environment and exceeds your expectations..

RSA operate best practice procedures drawn from previous experience. We know what things cost and how long they will take. With established links with other disciplines, our Team approach will benefit your project. We design alongside a project management culture understanding the complexities around planning and change, and work closely with clients to address the importance of communication and inclusive consultation with stakeholders.

RSA proactively operate a change management system for project variations, which may impact on brief, timescale or budget. Initially, change will likely concentrate around brief or design and robust procedures should ensure that you are aware of the implications of any change in terms of cost, programme and quality.



Catherine has worked in church conservation, housing and school design and as consultant on behalf of the DCSF (now DfE). **Michael** is a **RIBA Client Adviser** with experience of **Modern Methods of Construction** and temporary buildings enabling attractive quick interim solutions when budgets and timescale are under pressure rendering a permanent solution unviable.

