

Description

Soundis dry ScreedPanel 20 ULTRA is an interlocking reinforced gypsum fibre floor panel. Due its high density and inherent strength, Screed Panel 20 ULTRA is suitable for use as an overlay and for spanning between bearers such as joists and battens for raised floor applications.

Soundis dry ScreedPanel ULTRA offers high thermal conductivity when used in conjunction with underfloor heating systems, and their ultra-high density provides superior airborne sound performance through a multitude of separating floor types.

Visualisation buildup includes:

1. Soundis dry ScreedPanel 20 ULTRA
2. Routed UFH insulation
3. L Shaped Flanking Strip

Buildup visualisation

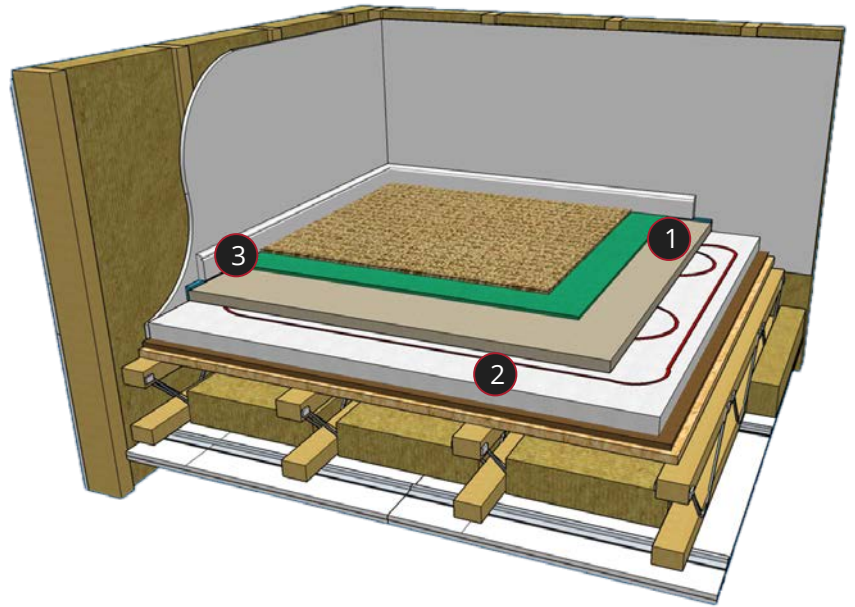

Product Weight and Dimensions

Panel Dimension	600mm (W) x 1200mm (L) x 20mm (H)	Density	1400 kg/m ³
Panel m ²	0.72 m ² Per Panel	Thermal Expansion	0.25mm/m
Panel Per Pallet	50 Panels (36 m ²)	Thermal Conductivity	0.32 W/mK
Weight	28 kg/m ² - 20.2 kg Per Panel	Thermal Resistance	0.0625 m ² K/W (as per DIN EN 12667)
Pallet Dimensions	1200mm (W) x 1200mm (L) x 650mm (H)	Fire Performance	A2:S1 (as per DIN EN13051-1)
Pallet Weight	1025 kg		

Key Benefits



Ceramic and porcelain floors can be laid directly without decoupling mat



Non-combustible



T&G no screws required



High airborne sound performance



High Density