

# STRAIGHT TEE

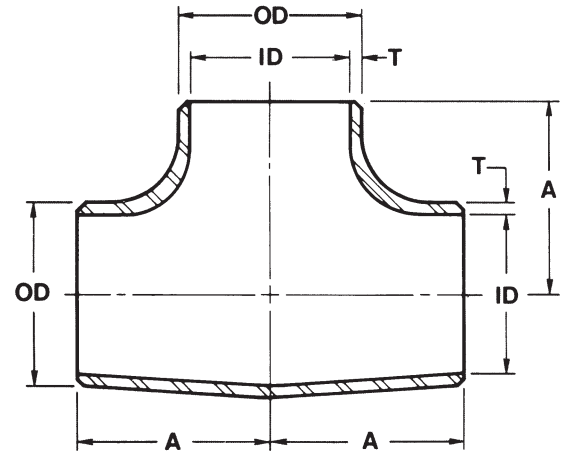

NOM PIPE SIZE	OUTSIDE DIAMETER (OD)	CENTER TO FACE (A)	SCHEDULE 10S Light N.P.S.			SCHEDULE 40S Standard N.P.S.		
			Wall Thickness (T)	Inside Diameter (ID)	Approx. Wt. in Pounds	Wall Thickness (T)	Inside Diameter (ID)	Approx. Wt in Pounds
1/2	.840	1	.083	.674	.12	.109	.622	.13
3/4	1.050	1-1/8	.083	.884	.16	.113	.824	.22
1	1.315	1-1/2	.109	1.097	.36	.133	1.049	.37
1-1/4	1.660	1-7/8	.109	1.442	.63	.140	1.380	.75
1-1/2	1.900	2-1/4	.109	1.682	.86	.145	1.610	1.09
2	2.375	2-1/2	.109	2.157	1.07	.154	2.067	1.62
2-1/2	2.875	3	.120	2.635	1.77	.203	2.469	2.77
3	3.500	3-3/8	.120	3.260	2.23	.216	3.068	4.18
3-1/2	4.000	3-3/4	.120	3.760	3.36	.226	3.548	5.15
4	4.500	4-1/8	.120	4.260	4.36	.237	4.026	6.65
5	5.563	4-7/8	.134	5.295	7.69	.258	5.047	12.00
6	6.625	5-5/8	.134	6.357	10.25	.280	6.065	14.00
8	8.625	7	.148	8.329	14.75	.322	7.981	26.25
10	10.750	8-1/2	.165	10.420	33.75	.365	10.020	45.50
12	12.750	10	.180	12.390	49.75	.375	12.000	78.00
14	14.000	11	.188	13.624	61.25	.375	13.250	100.00
16	16.000	12	.188	15.624	74.25	.375	15.250	126.00
18	18.000	13-1/2	.188	17.624	96.75	.375	17.250	164.00
20	20.000	15	.218	19.564	130.00	.375	19.250	205.00
24	24.000	17	.250	23.500	196.00	.375	23.250	285.00

1. All dimensions are in inches
2. Dimensional tolerances conform to ASME B16.9
3. Fitting wall thicknesses conform with standard schedule 10S and 40S ASME B36.19M wall pipe.
4. Butt welding fittings are permanently marked by electro-chemical etching in accordance with ASME B16.9
5. Estimated fitting weights are based on a density of .163 lbs/cubic inch