

Elevations Are For Illustrative

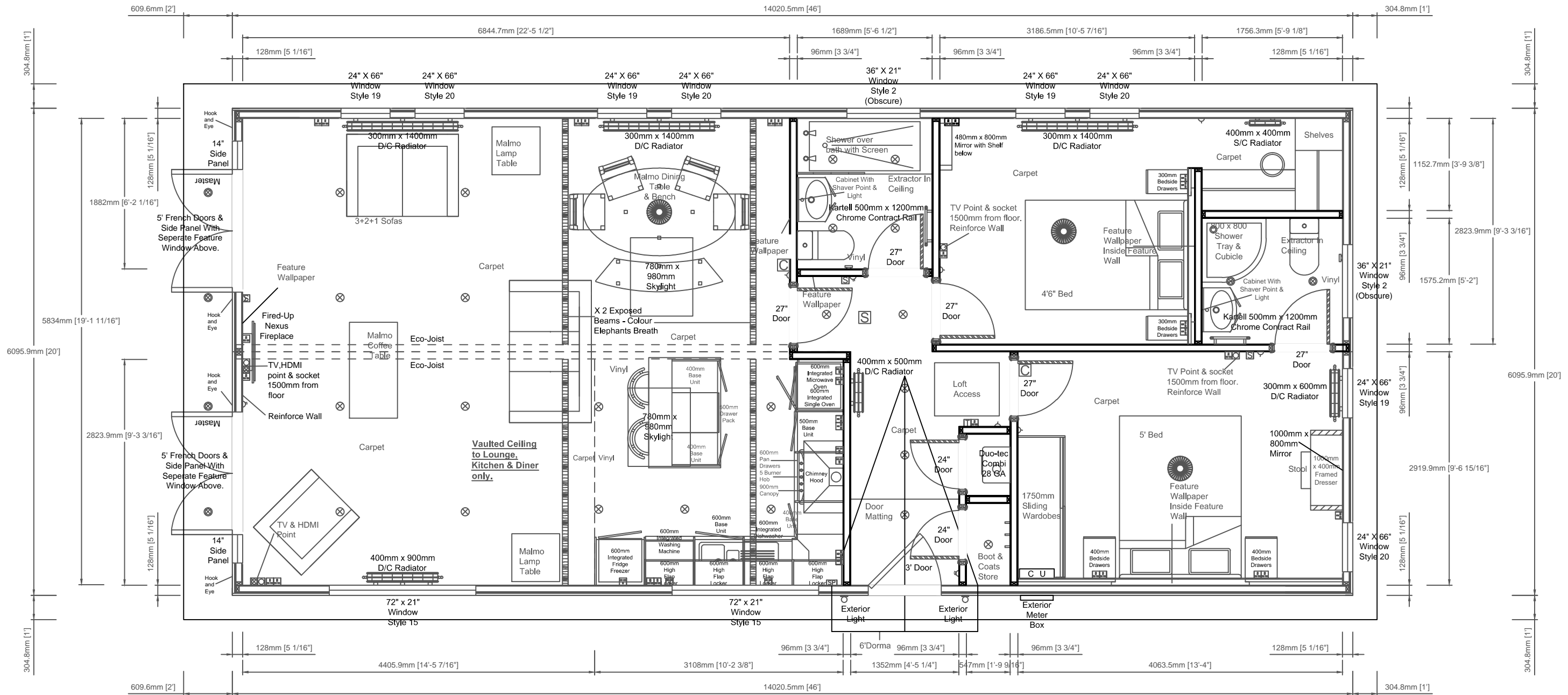

| Room Sizes | | |
|---------------|--------|-------|
| Rooms | Length | Width |
| Lounge/ Diner | 22'6" | 19'2" |
| Kitchen | 10'3" | 9'4" |
| Bathroom | 5'7" | 6'3" |
| Bedroom 1 | 13'4" | 9'7" |
| Bedroom 2 | 10'6" | 9'4" |
| Ensuite | 5'10" | 5'2" |
| Wardrobe | 5'10" | 3'10" |

Prestige Contemporary 46' x 20' (14.02m x 6.09m)
 2Bed, En-Suite, WiW

Customers Signature; _____

Date; _____

| | | | |
|------------|----------|---|-------------------------|
| Date: | | This home is designed in accordance with BS3632 | |
| Scale: | Relative | Legend | |
| Drawn: | | △ Light Switch | ⊕ Exterior Tap |
| Code: | | ○ Pull Card Switch | ⊞ TV Point |
| Dwg No: | | ⊘ Batten Holder | ⊞ Phone Point |
| Serial No: | | ⊙ Globe Light | ⊞ HDMI Point |
| | | ⊗ Exterior Light | ⊞ Thermostat |
| | | ⊙ Downlight | ⊞ CO ₂ Alarm |
| | | ⊞ Single Socket | ⊞ Smoke Alarm |
| | | ⊞ Double Socket | ⊞ Radiator |
| | | ⊞ Spur Socket | ⊞ Consumer Unit |
| | | ⊞ Switching Plate | ⊞ Exterior Meter Box |

| Rev | Date | By | Description |
|-----|------|----|-------------|
| | | | |

Notes;
 • Timber Ogee Door Casings

This plan is a guide and should be used for illustrative purposes only



Unit 4, Pychley Lodge Road Industrial Estate, Kettering, Northants NN15 6JQ
 Tel: 01536 518513 Fax: 01536 523438
 Email: sales@prestigeparkandleisurehomes.com
 Visit our website: www.prestigeparkandleisurehomes.com