



TRUSSED RAFTER ASSOCIATION

Information

Limits for Cutting, Notching and Drilling of Trussed Rafters

It is generally not permitted for trussed rafters to be cut, notched or drilled unless this has been allowed for in the design by the Trussed Rafter Designer. With the specific exception of the rules for cutting and drilling shown below, it should be assumed that trussed rafters must **NOT** be cut, notched or drilled unless there are specific instructions on site, prepared by the Trussed Rafter Designer.

Standard Trussed Rafters

- Overhangs and flying rafters may be trimmed unless otherwise advised by the trussed rafter supplier.
- Cutting, notching and drilling is **NOT** permitted.

'Room in the Roof' (Attic) Trussed Rafters.

The following actions are **NOT** permitted:

- Notching anywhere within the trussed rafter.
- Drilling of the rafter or internal members.

Drilling of the bottom member of the truss is permitted within the following constraints:

- Holes may be drilled only within the areas indicated in Fig. 1
- Holes must be drilled on the centre-line of the member.
- Minimum spacing between adjacent holes is 100 mm.
- Maximum size of drilled holes is as shown in Table 1.
- Under no circumstances should holes be drilled within 500 mm of a loadbearing support or within 250 mm of a plated splice joint.

'Room in the Roof' trussed rafters should never be cut to accommodate dormers or stairwells without obtaining detailed instructions from the Trussed Rafter designer.

Table 1 - Max size of hole within permitted areas, based upon depth of bottom chord

Bottom Chord Depth mm	Maximum Hole Diameter mm
147	15
172	20
197	25

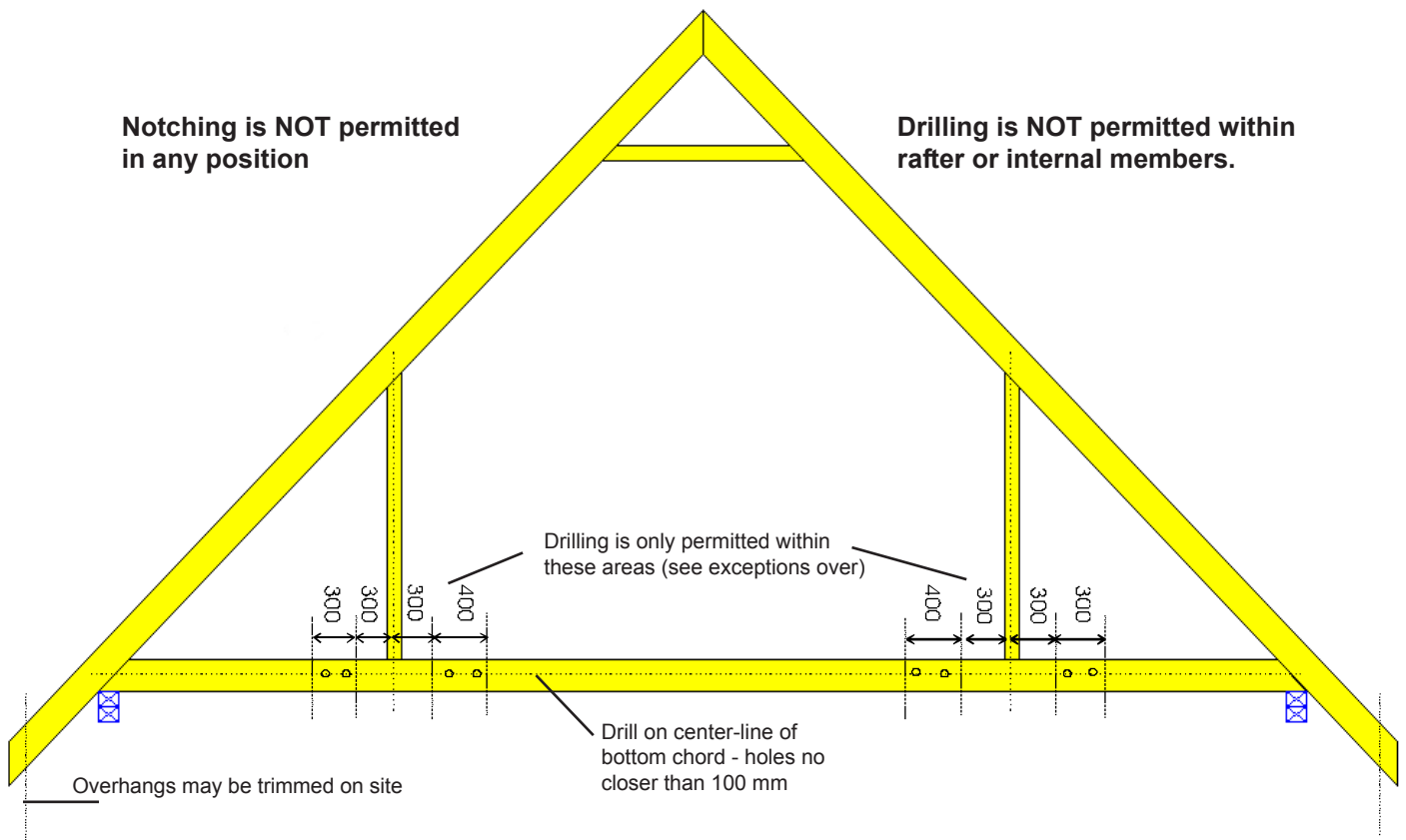

Fig. 1 - Permitted drilling areas within bottom chord