

Ashworth

SUPPLYING MECHANICAL SERVICES
AND PROCESS CONTRACTORS

PIPE HANGING SYSTEMS PRODUCT GUIDE

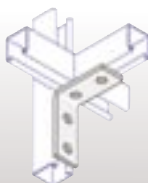
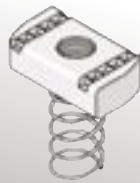

www.ashworth.eu.com



Welcome to Ashworth

Ashworth is recognised as one of the leading distributors to the mechanical services and process industries markets, providing market-leading products from a network of strategically located branches serving all the major conurbations and surrounding territories.

Ashworth continually adapts to changing market conditions and prides itself on developing innovative, problem solving products and services to meet our customers' needs, as well as continuing to supply many proven products in our traditional pipeline, valves and fittings portfolio.

I am pleased to bring you our Hanging Systems Product Guide. This guide features products from major manufacturers both in the UK and from abroad.

As with any product range, our range of Hanging Systems products and accessories is continually changing, if you do not see what you want or have a specific requirement, please call in to your local Ashworth branch or call FREEPHONE 0800 783 7680 and you will automatically be transferred to the nearest branch.

I would like to take this opportunity to thank you for your business and continued support.

Best Regards

Bill Willocks
Brand Director

CONTACT ASHWORTH

FREEPHONE 0800 783 7680

www.ashworth.eu.com

OUR CUSTOMERS

As a leading distributor of quality products and services to the mechanical services and process industries markets, we cover a wide range of customer types, both large and small. We focus our expertise specifically to our customers in our chosen markets.

These include:

- Mechanical services contractors
- Plumbers
- Heating engineers
- Drainage contractors
- Local and government authorities
- Fire protection contractors and fabricators
- International petrochemical companies and associated contractors
- OEM and in-house company engineers
- Secondary distribution channels

SERVICE

We pride ourselves on supplying an unrivalled range of products and services from recognised market leading manufacturers. These products are stocked in depth at all our sites which are linked via a sophisticated IT network to facilitate the sourcing of additional products in rapid time, thus improving on-site deliveries.

We service the UK from our network of strategically placed branches, all of which employ teams of knowledgeable staff equipped to answer the needs of our customers enquiries.

They are all trained to problem solve received enquiries, whether that be sourcing a new range of products or simply providing service on our stocked ranges.

We strive to be at the forefront of innovations and will introduce new product ranges and services on a regular basis, thus providing our customers with the opportunity to differentiate their own service to their clients.

Our objectives in service are to provide:

- A friendly and helpful service to all our customers
- A quick and efficient response to all enquiries
- A core range of products to satisfy immediate customer requirements
- Innovative and efficient solutions to customer needs

PART OF A GLOBAL NETWORK, WITH STRONG SISTER BRANDS

JEWSON

Graham
The Plumbers' Merchant

FRAZER

PLATFORM
BUILDING MATERIALS

SAINT-GOBAIN
TILE GROUP UK

International
TIMBER

International
DECORATIVE SURFACES

MINSTER
INSULATION AND DRY LIVING

As part of internationally renowned Saint-Gobain Building Distribution we have the backing of a global company. Furthermore, we can draw upon many major sister brands in helping our customers source what they need for the job.

MECHANICAL SERVICES

The Ashworth brand has long been associated with the mechanical services market, offering a broad range of tubes, valves and fittings.



HEATING PRODUCTS

Our expertise within this market sector has led to the inclusion of further products in our extensive range. Our technically aware staff are always available to offer advice and support to customers on all types of heating and ventilation projects.



FIRE PROTECTION

In a growing market of legislative change, Ashworth, the market leader in fire protection, has recognised the need to respond to the critical levels of service demanded in this fast-track environment. In tandem with our standard package of fire protection products and consumables, we can offer a bespoke package of equipment and services dedicated to the Industry Standards and Insurance Regulations.



PRESSURE PLASTICS

Ashworth are now the UK's leading distributor in the supply of line pipe to the process market, their fabricators and installers. In addition our quality tube product offering is enhanced by our specialist teams in process valves and pressure plastics.



DRAINAGE

As UK leader in the supply of drainage systems, we offer a product range in a variety of materials including cast iron, steel, PVC, HDPE and aluminium.



SANITARY WARE

Through our association with sister brands, within our group, Graham, Neville Lumb, and Folkard Bolding - we are able to supply a comprehensive range of Commercial Sanitary Ware for all applications.



INDUSTRY

The Ashworth team has extensive knowledge and experience in the supply of Quality Tube and Process Valves to all aspects of industry. Our competence in this area covers both the customer and manufacturing ends of the business.



CONTENTS

Channel Brackets & Fittings	5
Insulating Blocks	8
General Fasteners	10
Channel	13
Plastic Fittings	13
Malleable Iron Fittings	14
Copper & Brass Fittings	15
Pipe Supports	16/19
Quotation request form/Notes	17/18

CHANNEL BRACKETS & FITTINGS

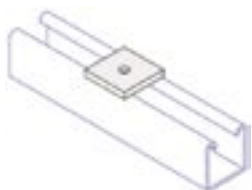

A201 SQUARE WASHER

PRODUCT CODE	DESCRIPTION
19603001	M8 A201 SQUARE WASHER
19603002	M10 A201 SQUARE WASHER
19603003	M12 A201 SQUARE WASHER

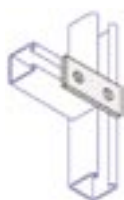

A202 FLAT PLATE 2 HOLE

PRODUCT CODE	DESCRIPTION
19603020	A202 FLAT PLATE 2 HOLE

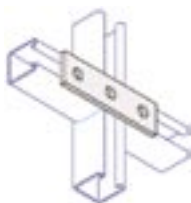

A203 FLAT PLATE 3 HOLE

PRODUCT CODE	DESCRIPTION
19603025	A203 FLAT PLATE 3 HOLE

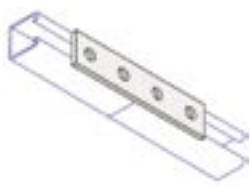

A204 FLAT PLATE 4 HOLE

PRODUCT CODE	DESCRIPTION
19603030	A204 FLAT PLATE 4 HOLE

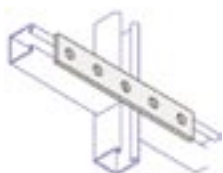

A205 FLAT PLATE 5 HOLE

PRODUCT CODE	DESCRIPTION
19603035	A205 FLAT PLATE 5 HOLE

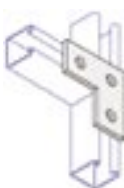

A210 FLAT PLATE 'L' TYPE 3 HOLE

PRODUCT CODE	DESCRIPTION
19603040	A210 FLAT PLATE 'L' TYPE 3 HOLE

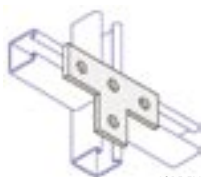

A215 FLAT PLATE 'T' TYPE 4 HOLE

PRODUCT CODE	DESCRIPTION
19603045	A215 FLAT PLATE 'T' TYPE 4 HOLE

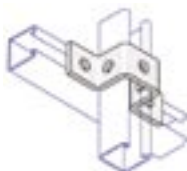

A220 TOP HAT

PRODUCT CODE	DESCRIPTION
19603050	41x41 A220 TOP HAT
19603051	41x21 A220 TOP HAT



A221 WIDE TOP HAT

PRODUCT CODE	DESCRIPTION
19603055	82x42 A221 WIDE TOP HAT

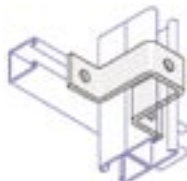

A222 TALL TOP HAT

PRODUCT CODE	DESCRIPTION
19603060	82x42 A222 TALL TOP HAT



A225 EXTERNAL SPLICE

PRODUCT CODE	DESCRIPTION
19603065	41x41 A225 EXTERNAL SPLICE
19603066	41x21 A225 EXTERNAL SPLICE

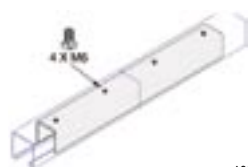

A226 INTERNAL SPLICE

PRODUCT CODE	DESCRIPTION
19603070	41x41 A226 INTERNAL SPLICE

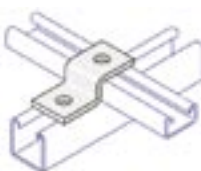

A230 Z BRACKET

PRODUCT CODE	DESCRIPTION
19603075	41x21 A230 Z BRACKET

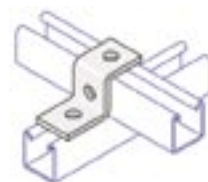

A231 Z BRACKET

PRODUCT CODE	DESCRIPTION
19603080	41x41 A231 Z BRACKET

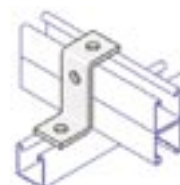

A232 Z BRACKET

PRODUCT CODE	DESCRIPTION
19603085	82x41 A232 Z BRACKET

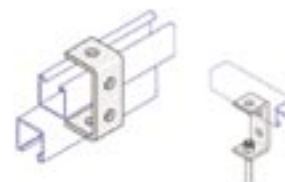

A235 C BRACKET

PRODUCT CODE	DESCRIPTION
19603090	82x41 A235 C BRACKET

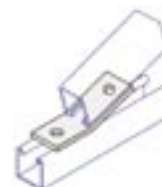

A240 EXT ANGLE BRACKET

PRODUCT CODE	DESCRIPTION
19603095	15deg A240 EXT ANGLE BRACKET
19603096	30deg A240 EXT ANGLE BRACKET



A241 EXT ANGLE BRACKET

PRODUCT CODE	DESCRIPTION
19603100	45deg A241 EXT ANGLE BRACKET
19603101	60deg A241 EXT ANGLE BRACKET
19603102	75deg A241 EXT ANGLE BRACKET

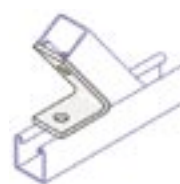

A242 INT ANGLE BRACKET

PRODUCT CODE	DESCRIPTION
19603110	45deg A242 INT ANGLE BRACKET
19603111	60deg A242 INT ANGLE BRACKET
19603112	75deg A242 INT ANGLE BRACKET

CHANNEL BRACKETS & FITTINGS

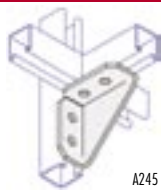

A245 REINFORCED ANGLE BRACKET

PRODUCT CODE	DESCRIPTION
19603120	A245 REINFORCED ANGLE BRACKET

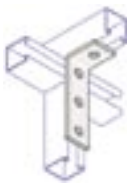

A261 ANGLE BRACKET 4 HOLE

PRODUCT CODE	DESCRIPTION
19603150	A261 ANGLE BRACKET 4 HOLE (3/1)

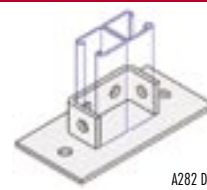

A282 DOUBLE STRUT BASE PLATE

PRODUCT CODE	DESCRIPTION
19603190	A282 DOUBLE STRUT BASE PLATE

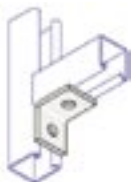

A250 ANGLE BRACKET 2 HOLE

PRODUCT CODE	DESCRIPTION
19603125	A250 ANGLE BRACKET 2 HOLE (50x47)



A265 45DEG CENTRAL ANGLE BRACKET

PRODUCT CODE	DESCRIPTION
19603155	A265 45deg CENTRAL ANGLE BRACKET

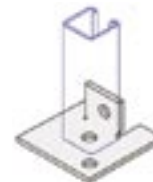

A284 CENTRAL FIX BASE PLATE

PRODUCT CODE	DESCRIPTION
19603195	A284 CENTRAL FIX BASE PLATE

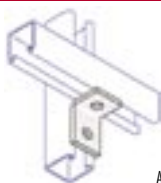

A251 ANGLE BRACKET 2 HOLE

PRODUCT CODE	DESCRIPTION
19603130	A251 ANGLE BRACKET 2 HOLE (57x41)



A270L 90DEG LEFT SIDE WING BRACKET

PRODUCT CODE	DESCRIPTION
19603160	A270L 90deg LEFT SIDE WING BRACKET



A288 DELTA FLOOR FIXING

PRODUCT CODE	DESCRIPTION
19603200	A288 DELTA FLOOR FIXING



A255 ANGLE BRACKET 3 HOLE

PRODUCT CODE	DESCRIPTION
19603135	A255 ANGLE BRACKET 3 HOLE (41x104)



A271R 90DEG RIGHT SIDE WING BRACKET

PRODUCT CODE	DESCRIPTION
19603170	A271R 90deg RIGHT SIDE WING BRACKET

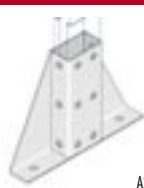

A290 DOUBLE DELTA FLOOR FIXING

PRODUCT CODE	DESCRIPTION
19603205	A290 DOUBLE DELTA FLOOR FIXING

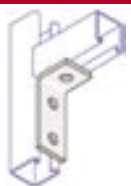

A256 ANGLE BRACKET 3 HOLE

PRODUCT CODE	DESCRIPTION
19603136	A256 ANGLE BRACKET 3 HOLE (47x98)

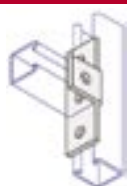

A272C 90DEG CENTRAL WING BRACKET

PRODUCT CODE	DESCRIPTION
19603175	A272C 90deg CENTRAL WING BRACKET



A292 TOWER FIXING

PRODUCT CODE	DESCRIPTION
19603210	A292 TOWER FIXING

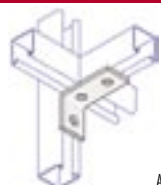

A257 ANGLE BRACKET 3 HOLE

PRODUCT CODE	DESCRIPTION
19603140	A257 ANGLE BRACKET 3 HOLE (89x56)



A274D DOUBLE WING BRACKET

PRODUCT CODE	DESCRIPTION
19603180	A274D DOUBLE WING BRACKET



A295L LARGE 90DEG ANGLE /DELTA FIXING

PRODUCT CODE	DESCRIPTION
19603215	A295L LARGE 90deg ANGLE /DELTA FIXING

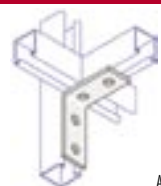

A260 ANGLE BRACKET 4 HOLE

PRODUCT CODE	DESCRIPTION
19603145	A260 ANGLE BRACKET 4 HOLE (2/2)



A280 SINGLE STRUT BASE PLATE

PRODUCT CODE	DESCRIPTION
19603185	A280 SINGLE STRUT BASE PLATE



SMALL 90DEG ANGLE /DELTA FIXING

PRODUCT CODE	DESCRIPTION
19603220	A296S SMALL 90deg ANGLE /DELTA FIXING

CHANNEL BRACKETS & FITTINGS

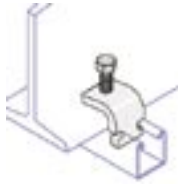

A320 RIDGED BEAM CLEAT

PRODUCT CODE DESCRIPTION

19603250 A320 RIDGED BEAM CLEAT

A321 SHORT LEG
BEAM CLEAT (TYPE 1)**PRODUCT CODE DESCRIPTION**

19603255 A321 SHORT LEG BEAM CLEAT (TYPE 1)

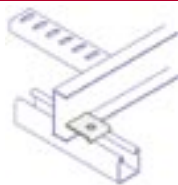
A322 SHORT LEG
BEAM CLEAT (TYPE 2)**PRODUCT CODE DESCRIPTION**

19603260 A322 SHORT LEG BEAM CLEAT (TYPE 2)



A330 PURLIN CLIP (12MM HOLE)

PRODUCT CODE DESCRIPTION

19603270 M10 A330 PURLIN CLIP (12mm HOLE)



FLANGE CLAMP

PRODUCT CODE DESCRIPTION

19603275 M8 FLANGE CLAMP (FL18P)
19603276 M10 FLANGE CLAMP (FL210P)
19603277 M12 FLANGE CLAMP (FL312P)
19603280 M8 FLANGE CLAMP c/w TAPPED HOLE (FL18T)
19603281 M10 FLANGE CLAMP c/w TAPPED HOLE (FL210T)
19603282 M12 FLANGE CLAMP c/w TAPPED HOLE (FL312T)

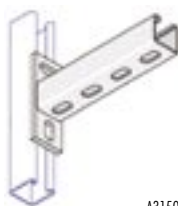
A3150/A3300/A3450/A3600/
A3750 SINGLE CANTILEVER ARM**PRODUCT CODE DESCRIPTION**

19603300 A3150 SINGLE CANTILEVER ARM 150mm LONG
19603301 A3300 SINGLE CANTILEVER ARM 300mm LONG
19603302 A3450 SINGLE CANTILEVER ARM 450mm LONG
19603303 A3600 SINGLE CANTILEVER ARM 600mm LONG
19603304 A3750 SINGLE CANTILEVER ARM 750mm LONG



A380 GIRDER SHACKLE

PRODUCT CODE DESCRIPTION

19603310 M10 A380 GIRDER SHACKLE
19603311 M12 A380 GIRDER SHACKLE



A382 BRIDGE PIECE

PRODUCT CODE DESCRIPTION

19603315 M8 A382 BRIDGE PIECE
19603316 M10 A382 BRIDGE PIECE
19603317 M12 A382 BRIDGE PIECE

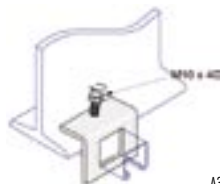

A301 WINDOW BRACKET

PRODUCT CODE DESCRIPTION

19603225 41x21 A301 WINDOW BRACKET
19603226 41x41 A301 WINDOW BRACKET
19603227 41x82 A301 WINDOW BRACKET

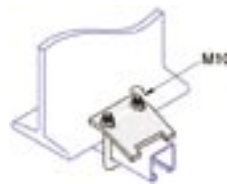

A305 GIRDER PLATE

PRODUCT CODE DESCRIPTION

19603230 41x21 A305 GIRDER PLATE c/w SQUARE U-BOLT
19603231 41x41 A305 GIRDER PLATE c/w SQUARE U-BOLT
19603232 41x82 A305 GIRDER PLATE c/w SQUARE U-BOLT

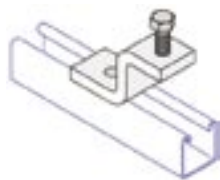

A310 Z BEAM CLAMP TAPPED

PRODUCT CODE DESCRIPTION

19603235 A310 Z BEAM CLAMP TAPPED M10

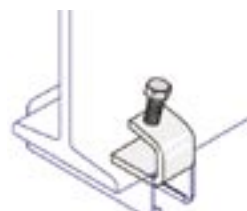

A312 SMALL BEAM CLAMP TAPPED M10

PRODUCT CODE DESCRIPTION

19603240 A312 SMALL BEAM CLAMP TAPPED M10

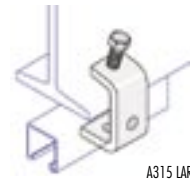

A315 LARGE BEAM CLAMP TAPPED M10

PRODUCT CODE DESCRIPTION

19603245 A315 LARGE BEAM CLAMP TAPPED M10

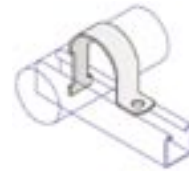

STRUT/CABLE CLAMP

PRODUCT CODE DESCRIPTION

19603500 15NB (21 OD) STRUT/CABLE CLAMP
19603501 20NB (27 OD) STRUT/CABLE CLAMP
19603502 25NB (34 OD) STRUT/CABLE CLAMP
19603503 32NB (43 OD) STRUT/CABLE CLAMP
19603504 40NB (48 OD) STRUT/CABLE CLAMP
19603505 50NB (60 OD) STRUT/CABLE CLAMP
19603506 65NB (76 OD) STRUT/CABLE CLAMP
19603507 80NB (90 OD) STRUT/CABLE CLAMP
19603508 100NB (115 OD) STRUT/CABLE CLAMP
19603509 125NB (140 OD) STRUT/CABLE CLAMP
19603510 150NB (168 OD) STRUT/CABLE CLAMP
19603511 200NB (219 OD) STRUT/CABLE CLAMP



TWO PIECE STRUT/CABLE CLAMP

PRODUCT CODE DESCRIPTION

19603550 25NB (31.8 - 35.9 OD) TWO PIECE STRUT/CABLE CLAMP
19603555 32NB (39.7 - 42.9 OD) TWO PIECE STRUT/CABLE CLAMP
19603560 40NB (46.8 - 50.8 OD) TWO PIECE STRUT/CABLE CLAMP
19603565 50NB (58.7 - 63.5 OD) TWO PIECE STRUT/CABLE CLAMP
19603570 65NB (73.0 - 79.4 OD) TWO PIECE STRUT/CABLE CLAMP
19603575 80NB (88.1 - 95.2 OD) TWO PIECE STRUT/CABLE CLAMP
19603580 100NB (111.1 - 120.7 OD) TWO PIECE STRUT/CABLE CLAMP
19603585 125NB (138.1 - 149.2 OD) TWO PIECE STRUT/CABLE CLAMP
19603590 150NB (161.9 - 174.6 OD) TWO PIECE STRUT/CABLE CLAMP

HC ONE PIECE WRAPAROUND
PURLIN FIXING**PRODUCT CODE DESCRIPTION**

19603840 HC34/145 ONE PIECE WRAPAROUND PURLIN FIXING
19603841 HC34/175 ONE PIECE WRAPAROUND PURLIN FIXING
19603842 HC34/205 ONE PIECE WRAPAROUND PURLIN FIXING
19603843 HC34/235 ONE PIECE WRAPAROUND PURLIN FIXING
19603844 HC34/265 ONE PIECE WRAPAROUND PURLIN FIXING

A4250/A4300/A4350/
A4400/A4500
WALL BRACKET/GANG HANGER**PRODUCT CODE DESCRIPTION**

19603860 A4250 WALL BRACKET/GANG HANGER 250mm LONG
19603861 A4300 WALL BRACKET/GANG HANGER 300mm LONG
19603862 A4350 WALL BRACKET/GANG HANGER 350mm LONG
19603863 A4400 WALL BRACKET/GANG HANGER 400mm LONG
19603864 A4500 WALL BRACKET/GANG HANGER 500mm LONG

CHANNEL BRACKETS & FITTINGS

Lindapter Decking Fixings

Lindapter's range of mechanical fixings, to connect services to composite steel floor decking, brings a range of benefits to both the specifier and installer alike. Designed in conjunction with the decking manufacturer to fulfill the specific requirements of their customers, the advantages of using these mechanical methods of fixing against alternative methods include:

- Reduced installation time
- Adjustable and removeable
- Guaranteed Safe Working Loads
- Minimum Factor of Safety of 3:1 on all decking fixings
- No specialist tools or skills required
- No risk of delamination
- Structural integrity of decking maintained
- No power required on site



Lindapter Alphawedge

The Alphawedge (AW) is designed to lock quickly and securely into the re-entrant channel of Alphaloc or Ribdeck AL decking. The product consists of two parts - a wedge and a plate and has a Safe Working Load of 1kN. The wedge can be tapped to accommodate thread rod sizes M6, M8 or M10.



Lindapter Slimdeck 2 c/w V Nut



Lindapter Toggle Clamp



AW LINDAPTER ALPHAWEDGE

PRODUCT CODE	DESCRIPTION
19603700	M6 AW LINDAPTER ALPHAWEDGE
19603701	M8 AW LINDAPTER ALPHAWEDGE
19603702	M10 AW LINDAPTER ALPHAWEDGE



MW2 LINDAPTER MULTIWEDGE 2

PRODUCT CODE	DESCRIPTION
19603720	M6 MW2 LINDAPTER MULTIWEDGE 2
19603721	M8 MW2 LINDAPTER MULTIWEDGE 2
19603722	M10 MW2 LINDAPTER MULTIWEDGE 2



WF LINDAPTER WEBFIX

PRODUCT CODE	DESCRIPTION
19603800	M10 WF LINDAPTER WEBFIX

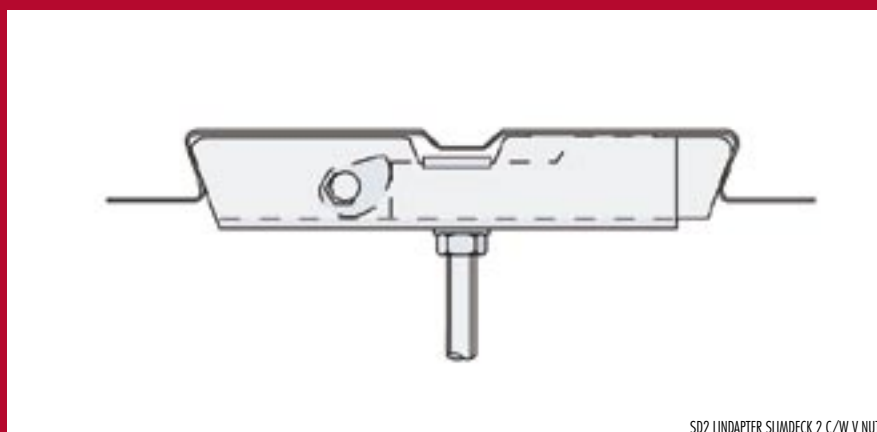

SD2 LINDAPTER SLIMDEK 2 c/w V NUT

PRODUCT CODE	DESCRIPTION
19603740	M6 SD2 LINDAPTER SLIMDEK 2 c/w V NUT
19603741	M8 SD2 LINDAPTER SLIMDEK 2 c/w V NUT
19603742	M10 SD2 LINDAPTER SLIMDEK 2 c/w V NUT



TR60 LINDAPTER WEDGE

PRODUCT CODE	DESCRIPTION
19603760	M6 TR60 LINDAPTER WEDGE
19603761	M8 TR60 LINDAPTER WEDGE
19603762	M10 TR60 LINDAPTER WEDGE

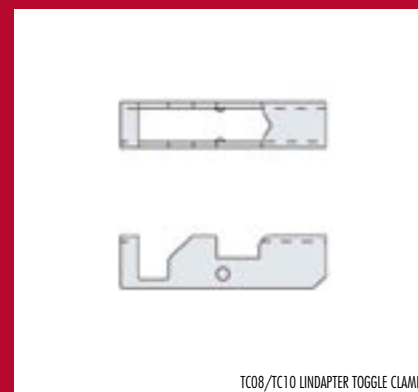

TC08/TC10 LINDAPTER TOGGLE CLAMP

PRODUCT CODE	DESCRIPTION
19603780	M8 TC08 LINDAPTER TOGGLE CLAMP
19603781	M10 TC10 LINDAPTER TOGGLE CLAMP



HC30 LINDAPTER PURLIN CLAMP

PRODUCT CODE	DESCRIPTION
19603805	HC30 LINDAPTER PURLIN CLAMP



HC31 LINDAPTER SUSPENDED CEILING CLIP

PRODUCT CODE	DESCRIPTION
19603810	HC31 LINDAPTER SUSPENDED CEILING CLIP

PHENOLIC BLOCK CHART



A: Phenolic Block



B: Hardwood Block



C: Split Band Clip



D: 'Fastfix' Clamp (M10)

Steel Pipe NB	Copper Pipe OD	Type	Insulation Block Thickness					
			15mm	20mm	25mm	30mm	40mm	50mm
*	15mm	A	19604000	19604016	19604032	19604048	19604064	19604080
		B	19604200	19604216	19604232	19604248	19604264	19604280
		C	19601650	19601654	19601658	19601664	19601676	19601688
		D	19602008	19602012	19602014	19602016	19602022	19602028
1/2" (15mm)	22mm	A	19604001	19604017	19604033	19604049	19604065	19604081
		B	19604201	19604217	19604233	19604249	19604265	19604281
		C	19601652	19601656	19601662	19601666	19601678	19601690
		D	19602010	19602012	19602016	19602018	19602024	19602030
3/4" (20mm)	28mm	A	19604002	19604018	19604034	19604050	19604066	19604082
		B	19604202	19604218	19604234	19604250	19604266	19604282
		C	19601656	19601660	19601664	19601672	19601684	19601692
		D	19602012	19602014	19602018	19602020	19602026	19602032
1" (25mm)	35mm	A	19604003	19604019	19604035	19604051	19604067	19604083
		B	19604203	19604219	19604235	19604251	19604267	19604283
		C	19601658	19601664	19601670	19601676	19601688	19601696
		D	19602014	19602016	19602018	19602022	19602028	19602034
1.1/4" (32mm)	42mm	A	19604004	19604020	19604036	19604052	19604068	19604084
		B	19604204	19604220	19604236	19604252	19604268	19604284
		C	19601662	19601668	19601674	19601680	19601690	19601698
		D	19602016	19602018	19602022	19602024	19602030	19602036
1.1/2" (40mm)	*	A	19604005	19604021	19604037	19604053	19604069	19604085
		B	19604205	19604221	19604237	19604253	19604269	19604285
		C	19601666	19601672	19601678	19601684	19601694	19601706
		D	19602016	19602020	19602024	19602026	19602034	19602038
*	54mm	A	19604007	19604023	19604039	19604055	19604071	19604087
		B	19604207	19604223	19604239	19604255	19604271	19604287
		C	19601672	19601676	19601682	19601686	19601696	19601708
		D	19602020	19602022	19602024	19602028	19602034	19602040
2" (50mm)	*	A	19604006	19604022	19604038	19604054	19604070	19604086
		B	19604206	19604222	19604238	19604254	19604270	19604286
		C	19601674	19601680	19601686	19601690	19601698	19601712
		D	19602020	19602024	19602026	19602030	19602036	19602042
*	67mm	A	19604008	19604024	19604040	19604056	19604072	19604088
		B	19604208	19604224	19604240	19604256	19604272	19604288
		C	19601676	19601684	19601688	19601692	19601702	19601714
		D	19602022	19602024	19602026	19602032	19602038	19602044
2.1/2" (65mm)	76mm	A	19604009	19604025	19604041	19604057	19604073	19604089
		B	19604209	19604225	19604241	19604257	19604273	19604289
		C	19601682	19601688	19601692	19601696	19601710	19601718
		D	19602026	19602028	19602032	19602034	19602040	19602046
3" (80mm)	*	A	19604010	19604026	19604042	19604058	19604074	19604090
		B	19604210	19604226	19604242	19604258	19604274	19604290
		C	19601690	19601694	19601696	19601706	19601716	19601726
		D	19602030	19602034	19602036	19602038	19602044	19602048
*	108mm	A	19604012	19604028	19604044	19604060	19604076	19604092
		B	19604212	19604228	19604244	19604260	19604276	19604292
		C	19601696	19601702	19601710	19601714	19601726	19601738
		D	19602036	19602038	19602042	19602044	19602048	19602052
4" (100mm)	*	A	19604011	19604027	19604043	19604059	19604075	19604091
		B	19604211	19604227	19604243	19604259	19604275	19604291
		C	19601698	19601712	19601714	19601718	19601730	19601742
		D	19602036	19602040	19602044	19602046	19602048	19602052
5" (125mm)	*	A	19604013	19604029	19604045	19604061	19604077	19604093
		B	19604213	19604229	19604245	19604261	19604277	19604293
		C	19601716	19601720	19601726	19601734	19601744	19601754
		D	19602044	19602046	19602048	19602050	19602052	*
*	159mm	A	19604015	19604031	19604047	19604063	19604079	19604095
		B	19604215	19604231	19604247	19604263	19604279	19604295
		C	19601726	19601734	19601738	19601744	19601754	19601762
		D	19602048	19602050	19602050	19602052	*	*
6" (168mm)	*	A	19604014	19604030	19604046	19604062	19604078	19604094
		B	19604214	19604230	19604246	19604262	19604278	19604294
		C	19601734	19601738	19601744	19601748	19601758	19601768
		D	19602050	19602052	19602052	*	*	*

GENERAL FASTENERS



HEXAGON NUT ZINC PLATED

PRODUCT CODE	DESCRIPTION
19600680	M6 HEXAGON NUT ZINC PLATED
19600681	M8 HEXAGON NUT ZINC PLATED
19600682	M10 HEXAGON NUT ZINC PLATED
19600683	M12 HEXAGON NUT ZINC PLATED
19600684	M16 HEXAGON NUT ZINC PLATED
19600685	M20 HEXAGON NUT ZINC PLATED
19600686	M24 HEXAGON NUT ZINC PLATED



PENNY WASHER ZINC PLATED

PRODUCT CODE	DESCRIPTION
19600754	M6x25 PENNY WASHER ZINC PLATED
19600756	M8x25 PENNY WASHER ZINC PLATED
19600758	M10x25 PENNY WASHER ZINC PLATED
19600759	M10x30 PENNY WASHER ZINC PLATED
19600760	M10x40 PENNY WASHER ZINC PLATED
19600765	M12x40 PENNY WASHER ZINC PLATED



REDUCING ROD CONNECTOR ZINC PLATED

PRODUCT CODE	DESCRIPTION
19600880	M10x8 REDUCING ROD CONNECTOR ZINC PLATED
19600884	M12x8 REDUCING ROD CONNECTOR ZINC PLATED
19600888	M12x10 REDUCING ROD CONNECTOR ZINC PLATED



SERRATED FLANGE NUT ZINC PLATED

PRODUCT CODE	DESCRIPTION
19600700	M6 SERRATED FLANGE NUT ZINC PLATED
19600701	M8 SERRATED FLANGE NUT ZINC PLATED
19600702	M10 SERRATED FLANGE NUT ZINC PLATED
19600703	M12 SERRATED FLANGE NUT ZINC PLATED
19600704	M16 SERRATED FLANGE NUT ZINC PLATED
19600705	M20 SERRATED FLANGE NUT ZINC PLATED
19600706	M24 SERRATED FLANGE NUT ZINC PLATED



SHAKEPROOF WASHER ZINC PLATED

PRODUCT CODE	DESCRIPTION
19600780	M6 SHAKEPROOF WASHER ZINC PLATED
19600781	M8 SHAKEPROOF WASHER ZINC PLATED
19600782	M10 SHAKEPROOF WASHER ZINC PLATED
19600783	M12 SHAKEPROOF WASHER ZINC PLATED

ALSO AVAILABLE IN PRE-CUT LENGTH



SCREWED ROD ZINC PLATED

PRODUCT CODE	DESCRIPTION
19600800	M6x1 Mtr SCREWED ROD ZINC PLATED
19600801	M8x1 Mtr SCREWED ROD ZINC PLATED
19600802	M10x1 Mtr SCREWED ROD ZINC PLATED
19600803	M12x1 Mtr SCREWED ROD ZINC PLATED
19600804	M16x1 Mtr SCREWED ROD ZINC PLATED
19600805	M20x1 Mtr SCREWED ROD ZINC PLATED
19600806	M24x1 Mtr SCREWED ROD ZINC PLATED
19600820	M6x3 Mtr SCREWED ROD ZINC PLATED
19600821	M8x3 Mtr SCREWED ROD ZINC PLATED
19600822	M10x3 Mtr SCREWED ROD ZINC PLATED
19600823	M12x3 Mtr SCREWED ROD ZINC PLATED
19600824	M16x3 Mtr SCREWED ROD ZINC PLATED
19600825	M20x3 Mtr SCREWED ROD ZINC PLATED
19600826	M24x3 Mtr SCREWED ROD ZINC PLATED



MALE ROD ADAPTOR ZINC PLATED

PRODUCT CODE	DESCRIPTION
19600910	M8 FEM x M10 MALE ROD ADAPTOR ZINC PLATED
19600914	M8 FEM x M12 MALE ROD ADAPTOR ZINC PLATED
19600918	M10 FEM x M8 MALE ROD ADAPTOR ZINC PLATED
19600922	M10 FEM x M12 MALE ROD ADAPTOR ZINC PLATED
19600926	M12 FEM x M8 MALE ROD ADAPTOR ZINC PLATED
19600930	M12 FEM x M10 MALE ROD ADAPTOR ZINC PLATED



FLAT WASHER ZINC PLATED

PRODUCT CODE	DESCRIPTION
19600720	M6 FLAT WASHER ZINC PLATED
19600721	M8 FLAT WASHER ZINC PLATED
19600722	M10 FLAT WASHER ZINC PLATED
19600723	M12 FLAT WASHER ZINC PLATED
19600724	M16 FLAT WASHER ZINC PLATED
19600725	M20 FLAT WASHER ZINC PLATED
19600726	M24 FLAT WASHER ZINC PLATED



EYE BOLT ZINC PLATED

PRODUCT CODE	DESCRIPTION
19600960	M10x80 EYE BOLT ZINC PLATED
19600964	M10x100 EYE BOLT ZINC PLATED
19600968	M10x150 EYE BOLT ZINC PLATED
19600972	M10x200 EYE BOLT ZINC PLATED
19600976	M10x250 EYE BOLT ZINC PLATED
19600980	M10x300 EYE BOLT ZINC PLATED
19600984	M12x80 EYE BOLT ZINC PLATED
19600988	M12x100 EYE BOLT ZINC PLATED
19600992	M12x150 EYE BOLT ZINC PLATED
19600996	M12x200 EYE BOLT ZINC PLATED
19601000	M12x250 EYE BOLT ZINC PLATED
19601004	M12x300 EYE BOLT ZINC PLATED



SPRING WASHER ZINC PLATED

PRODUCT CODE	DESCRIPTION
19600740	M6 SPRING WASHER ZINC PLATED
19600741	M8 SPRING WASHER ZINC PLATED
19600742	M10 SPRING WASHER ZINC PLATED
19600743	M12 SPRING WASHER ZINC PLATED



ROD CONNECTOR ZINC PLATED

PRODUCT CODE	DESCRIPTION
19600860	M6 ROD CONNECTOR ZINC PLATED
19600861	M8 ROD CONNECTOR ZINC PLATED
19600862	M10 ROD CONNECTOR ZINC PLATED
19600863	M12 ROD CONNECTOR ZINC PLATED
19600864	M16 ROD CONNECTOR ZINC PLATED
19600865	M20 ROD CONNECTOR ZINC PLATED
19600866	M24 ROD CONNECTOR ZINC PLATED



DROP IN CONCRETE ANCHOR

PRODUCT CODE	DESCRIPTION
19601020	M6 DROP IN CONCRETE ANCHOR
19601021	M8 DROP IN CONCRETE ANCHOR
19601022	M10 DROP IN CONCRETE ANCHOR
19601023	M12 DROP IN CONCRETE ANCHOR
19601024	M16 DROP IN CONCRETE ANCHOR

GENERAL FASTENERS

Ashworth

HANGING SYSTEMS

GENERAL FASTENERS



LIPPED ANCHOR

PRODUCT CODE	DESCRIPTION
19601040	M8x30 LIPPED ANCHOR
19601041	M10x30 LIPPED ANCHOR
19601042	M10x40 LIPPED ANCHOR
19601043	M12x50 LIPPED ANCHOR



THREADED LINK EYE

PRODUCT CODE	DESCRIPTION
19601240	M8 THREADED LINK EYE
19601241	M10 THREADED LINK EYE
19601242	M12 THREADED LINK EYE

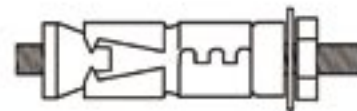

PROJECTING BOLT ANCHOR

PRODUCT CODE	DESCRIPTION
19601320	M6x65 PROJECTING BOLT ANCHOR (M10 FIXTURE THICKNESS)
19601321	M6x80 PROJECTING BOLT ANCHOR (M25 FIXTURE THICKNESS)
19601322	M6x115 PROJECTING BOLT ANCHOR (M60 FIXTURE THICKNESS)
19601323	M8x75 PROJECTING BOLT ANCHOR (M10 FIXTURE THICKNESS)
19601324	M8x90 PROJECTING BOLT ANCHOR (M25 FIXTURE THICKNESS)
19601325	M8x125 PROJECTING BOLT ANCHOR (M60 FIXTURE THICKNESS)
19601326	M10x90 PROJECTING BOLT ANCHOR (M15 FIXTURE THICKNESS)
19601327	M10x105 PROJECTING BOLT ANCHOR (M30 FIXTURE THICKNESS)
19601328	M10x135 PROJECTING BOLT ANCHOR (M60 FIXTURE THICKNESS)
19601329	M12x110 PROJECTING BOLT ANCHOR (M15 FIXTURE THICKNESS)
19601330	M12x125 PROJECTING BOLT ANCHOR (M30 FIXTURE THICKNESS)
19601331	M12x170 PROJECTING BOLT ANCHOR (M75 FIXTURE THICKNESS)
19601332	M16x150 PROJECTING BOLT ANCHOR (M15 FIXTURE THICKNESS)
19601333	M16x170 PROJECTING BOLT ANCHOR (M35 FIXTURE THICKNESS)
19601334	M16x210 PROJECTING BOLT ANCHOR (M75 FIXTURE THICKNESS)
19601335	M20x170 PROJECTING BOLT ANCHOR (M15 FIXTURE THICKNESS)
19601336	M20x185 PROJECTING BOLT ANCHOR (M30 FIXTURE THICKNESS)
19601337	M20x255 PROJECTING BOLT ANCHOR (M100 FIXTURE THICKNESS)
19601338	M24x255 PROJECTING BOLT ANCHOR (M75 FIXTURE THICKNESS)
19601339	M24x300 PROJECTING BOLT ANCHOR (M120 FIXTURE THICKNESS)



WEDGE NUT

PRODUCT CODE	DESCRIPTION
19601060	M6 WEDGE NUT
19601061	M8 WEDGE NUT
19601062	M10 WEDGE NUT

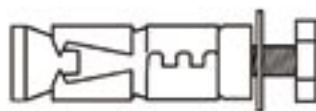

LOOSE BOLT ANCHOR

PRODUCT CODE	DESCRIPTION
19601260	M6x55 LOOSE BOLT ANCHOR (M10 FIXTURE THICKNESS)
19601265	M6x70 LOOSE BOLT ANCHOR (M25 FIXTURE THICKNESS)
19601261	M8x65 LOOSE BOLT ANCHOR (M10 FIXTURE THICKNESS)
19601266	M8x80 LOOSE BOLT ANCHOR (M25 FIXTURE THICKNESS)
19601267	M8x95 LOOSE BOLT ANCHOR (M40 FIXTURE THICKNESS)
19601262	M10x75 LOOSE BOLT ANCHOR (M10 FIXTURE THICKNESS)
19601268	M10x90 LOOSE BOLT ANCHOR (M25 FIXTURE THICKNESS)
19601269	M10x115 LOOSE BOLT ANCHOR (M50 FIXTURE THICKNESS)
19601270	M10x140 LOOSE BOLT ANCHOR (M75 FIXTURE THICKNESS)
19601263	M12x90 LOOSE BOLT ANCHOR (M10 FIXTURE THICKNESS)
19601271	M12x105 LOOSE BOLT ANCHOR (M25 FIXTURE THICKNESS)
19601272	M12x120 LOOSE BOLT ANCHOR (M40 FIXTURE THICKNESS)
19601273	M12x140 LOOSE BOLT ANCHOR (M60 FIXTURE THICKNESS)
19601264	M16x135 LOOSE BOLT ANCHOR (M15 FIXTURE THICKNESS)
19601274	M16x150 LOOSE BOLT ANCHOR (M30 FIXTURE THICKNESS)
19601275	M16x180 LOOSE BOLT ANCHOR (M60 FIXTURE THICKNESS)
19601276	M20x195 LOOSE BOLT ANCHOR (M60 FIXTURE THICKNESS)
19601277	M20x235 LOOSE BOLT ANCHOR (M100 FIXTURE THICKNESS)
19601278	M24x255 LOOSE BOLT ANCHOR (M100 FIXTURE THICKNESS)
19601279	M24x300 LOOSE BOLT ANCHOR (M150 FIXTURE THICKNESS)



MINI WEDGE NUT

PRODUCT CODE	DESCRIPTION
19601200	M6 MINI WEDGE NUT
19601201	M8 MINI WEDGE NUT
19601202	M10 MINI WEDGE NUT



RUBBER RAWLNUT

PRODUCT CODE	DESCRIPTION
19601350	M6 RUBBER RAWLNUT
19601351	M8 RUBBER RAWLNUT
19601352	M10 RUBBER RAWLNUT
19601353	M12 RUBBER RAWLNUT



THRU-BOLT

PRODUCT CODE	DESCRIPTION
19601280	M10x75 THRU-BOLT
19601284	M10x90 THRU-BOLT
19601288	M10x120 THRU-BOLT
19601292	M12x80 THRU-BOLT
19601296	M12x100 THRU-BOLT
19601300	M12x120 THRU-BOLT
19601304	M16x105 THRU-BOLT
19601308	M16x125 THRU-BOLT
19601312	M16x150 THRU-BOLT



BALL/SWIVEL HANGER

PRODUCT CODE	DESCRIPTION
19601220	M8 BALL/SWIVEL HANGER
19601221	M10 BALL/SWIVEL HANGER
19601222	M12 BALL/SWIVEL HANGER



SPRING TOGGLE

PRODUCT CODE	DESCRIPTION
19601380	M10 SPRING TOGGLE

CHANNEL



PRE-GALV PLAIN BACKTOBACK CHANNEL

PRODUCT CODE	DESCRIPTION
1960080	41x41 A41B2B6 PRE-GALV PLAIN BACKTOBACK CHANNEL 6Mtr LEN x 2.5mm THICK



PRE-GALV PLAIN CHANNEL

PRODUCT CODE	DESCRIPTION
1960040	21x41 A21P6 PRE-GALV PLAIN CHANNEL 6Mtr LENGTH x 2.5mm THICK
1960041	21x41 A21P3 PRE-GALV PLAIN CHANNEL 3Mtr LENGTH x 2.5mm THICK
1960060	41x41 A41P6 PRE-GALV PLAIN CHANNEL 6Mtr LENGTH x 2.5mm THICK
1960061	41x41 A41P3 PRE-GALV PLAIN CHANNEL 3Mtr LENGTH x 2.5mm THICK

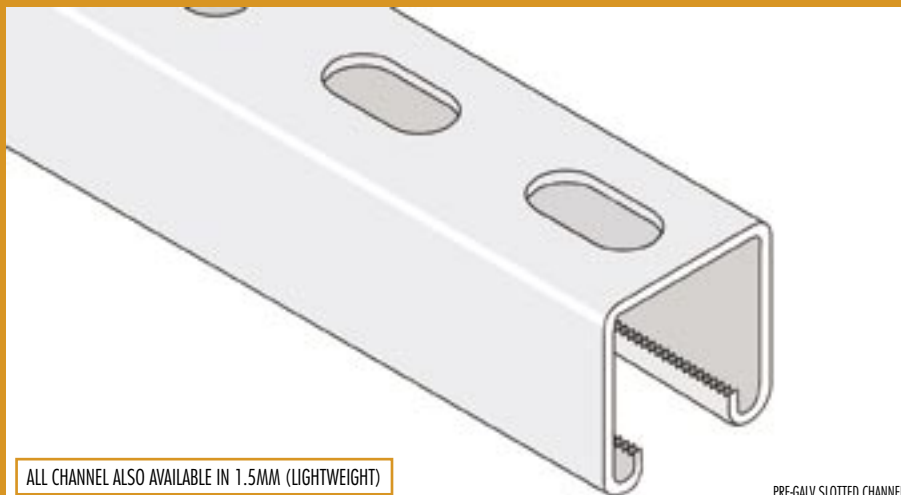

PRE-GALV SLOTTED CHANNEL

ALL CHANNEL ALSO AVAILABLE IN 1.5MM (LIGHTWEIGHT)

PRODUCT CODE	DESCRIPTION
1960000	21x41 A21S6 PRE-GALV SLOTTED CHANNEL 6Mtr LENGTH x 2.5mm THICK
1960001	21x41 A21S3 PRE-GALV SLOTTED CHANNEL 3Mtr LENGTH x 2.5mm THICK
1960002	21x41 A21S2 PRE-GALV SLOTTED CHANNEL 2Mtr LENGTH x 2.5mm THICK

PRODUCT CODE	DESCRIPTION
1960010	41x41 A41S6 PRE-GALV SLOTTED CHANNEL 6Mtr LENGTH x 2.5mm THICK
1960011	41x41 A41S3 PRE-GALV SLOTTED CHANNEL 3Mtr LENGTH x 2.5mm THICK
1960012	41x41 A41S2 PRE-GALV SLOTTED CHANNEL 2Mtr LENGTH x 2.5mm THICK

**ALSO AVAILABLE:
CLOSURE STRIP AND ENDCAPS
FOR CHANNEL**



DID YOU KNOW?

Ashworth offer a bespoke fabrication service specialising in custom products for those non-standard jobs.

PLASTIC FITTINGS

PUSH-IN PLASTIC CLIP

PRODUCT CODE	DESCRIPTION
19606440	15 A651 PUSH-IN PLASTIC CLIP
19606441	22 A651 PUSH-IN PLASTIC CLIP
19606442	28 A651 PUSH-IN PLASTIC CLIP

WRAP OVER PLASTIC CLIP

PRODUCT CODE	DESCRIPTION
19606480	15 A653 WRAP OVER PLASTIC CLIP
19606481	22 A653 WRAP OVER PLASTIC CLIP
19606482	28 A653 WRAP OVER PLASTIC CLIP

NAIL-IN PLASTIC CLIP

PRODUCT CODE	DESCRIPTION
19606500	15 A654 NAIL-IN PLASTIC CLIP
19606501	22 A654 NAIL-IN PLASTIC CLIP
19606502	28 A654 NAIL-IN PLASTIC CLIP

SNAP-OVER PLASTIC CLIP

PRODUCT CODE	DESCRIPTION
19606520	15 A655 SNAP-OVER PLASTIC CLIP
19606521	22 A655 SNAP-OVER PLASTIC CLIP
19606522	28 A655 SNAP-OVER PLASTIC CLIP

DOUBLE SNAP-OVER PLASTIC CLIP

PRODUCT CODE	DESCRIPTION
19606540	15 A656 DOUBLE SNAP-OVER PLASTIC CLIP
19606541	22 A656 DOUBLE SNAP-OVER PLASTIC CLIP
19606542	28 A656 DOUBLE SNAP-OVER PLASTIC CLIP

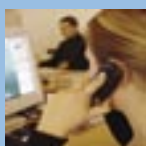

For more information on our range of Plastic Fittings call:

0800 783 7680

to speak to an experienced Sales Advisor

MALLEABLE IRON FITTINGS



ALSO AVAILABLE WITH BSP THREAD

BLK MALLEABLE IRON SCREW-ON-BRACKET

PRODUCT CODE	DESCRIPTION
19605000	8 A501 BLK MALLEABLE IRON SCREW-ON-BRACKET
19605001	10 A501 BLK MALLEABLE IRON SCREW-ON-BRACKET
19605002	15 A501 BLK MALLEABLE IRON SCREW-ON-BRACKET
19605003	20 A501 BLK MALLEABLE IRON SCREW-ON-BRACKET
19605004	25 A501 BLK MALLEABLE IRON SCREW-ON-BRACKET
19605005	32 A501 BLK MALLEABLE IRON SCREW-ON-BRACKET
19605006	40 A501 BLK MALLEABLE IRON SCREW-ON-BRACKET
19605007	50 A501 BLK MALLEABLE IRON SCREW-ON-BRACKET
19605008	65 A501 BLK MALLEABLE IRON SCREW-ON-BRACKET
19605009	80 A501 BLK MALLEABLE IRON SCREW-ON-BRACKET
19605010	100 A501 BLK MALLEABLE IRON SCREW-ON-BRACKET

METRIC BLK MALLEABLE IRON DOUBLE PIPE RING

PRODUCT CODE	DESCRIPTION
19605170	8 METRIC A530M BLK MALLEABLE IRON DOUBLE PIPE RING
19605171	10 METRIC A530M BLK MALLEABLE IRON DOUBLE PIPE RING
19605172	15 METRIC A530M BLK MALLEABLE IRON DOUBLE PIPE RING
19605173	20 METRIC A530M BLK MALLEABLE IRON DOUBLE PIPE RING
19605174	25 METRIC A530M BLK MALLEABLE IRON DOUBLE PIPE RING
19605175	32 METRIC A530M BLK MALLEABLE IRON DOUBLE PIPE RING
19605176	40 METRIC A530M BLK MALLEABLE IRON DOUBLE PIPE RING
19605177	50 METRIC A530M BLK MALLEABLE IRON DOUBLE PIPE RING
19605178	65 METRIC A530M BLK MALLEABLE IRON DOUBLE PIPE RING
19605179	80 METRIC A530M BLK MALLEABLE IRON DOUBLE PIPE RING
19605180	100 METRIC A530M BLK MALLEABLE IRON DOUBLE PIPE RING
19605181	125 METRIC A530M BLK MALLEABLE IRON DOUBLE PIPE RING
19605182	150 METRIC A530M BLK MALLEABLE IRON DOUBLE PIPE RING

METRIC GAL MALLEABLE IRON SINGLE PIPE RING

PRODUCT CODE	DESCRIPTION
19605320	8 METRIC A529M GAL MALLEABLE IRON SINGLE PIPE RING
19605321	10 METRIC A529M GAL MALLEABLE IRON SINGLE PIPE RING
19605322	15 METRIC A529M GAL MALLEABLE IRON SINGLE PIPE RING
19605323	20 METRIC A529M GAL MALLEABLE IRON SINGLE PIPE RING
19605324	25 METRIC A529M GAL MALLEABLE IRON SINGLE PIPE RING
19605325	32 METRIC A529M GAL MALLEABLE IRON SINGLE PIPE RING
19605326	40 METRIC A529M GAL MALLEABLE IRON SINGLE PIPE RING
19605327	50 METRIC A529M GAL MALLEABLE IRON SINGLE PIPE RING
19605328	65 METRIC A529M GAL MALLEABLE IRON SINGLE PIPE RING
19605329	80 METRIC A529M GAL MALLEABLE IRON SINGLE PIPE RING
19605330	100 METRIC A529M GAL MALLEABLE IRON SINGLE PIPE RING
19605331	125 METRIC A529M GAL MALLEABLE IRON SINGLE PIPE RING
19605332	150 METRIC A529M GAL MALLEABLE IRON SINGLE PIPE RING

METRIC BLK MALLEABLE IRON BACKPLATE

PRODUCT CODE	DESCRIPTION
19605070	M6 METRIC A515M BLK MALLEABLE IRON BACKPLATE
19605071	M8 METRIC A515M BLK MALLEABLE IRON BACKPLATE
19605072	M10 METRIC A515M BLK MALLEABLE IRON BACKPLATE
19605073	M12 METRIC A515M BLK MALLEABLE IRON BACKPLATE

GAL MALLEABLE IRON SCREW-ON-BRACKET

PRODUCT CODE	DESCRIPTION
19605200	8 A501 GAL MALLEABLE IRON SCREW-ON-BRACKET
19605201	10 A501 GAL MALLEABLE IRON SCREW-ON-BRACKET
19605202	15 A501 GAL MALLEABLE IRON SCREW-ON-BRACKET
19605203	20 A501 GAL MALLEABLE IRON SCREW-ON-BRACKET
19605204	25 A501 GAL MALLEABLE IRON SCREW-ON-BRACKET
19605205	32 A501 GAL MALLEABLE IRON SCREW-ON-BRACKET
19605206	40 A501 GAL MALLEABLE IRON SCREW-ON-BRACKET
19605207	50 A501 GAL MALLEABLE IRON SCREW-ON-BRACKET
19605208	65 A501 GAL MALLEABLE IRON SCREW-ON-BRACKET
19605209	80 A501 GAL MALLEABLE IRON SCREW-ON-BRACKET
19605210	100 A501 GAL MALLEABLE IRON SCREW-ON-BRACKET

METRIC GAL MALLEABLE IRON DOUBLE PIPE RING

PRODUCT CODE	DESCRIPTION
19605370	8 METRIC A530M GAL MALLEABLE IRON DOUBLE PIPE RING
19605371	10 METRIC A530M GAL MALLEABLE IRON DOUBLE PIPE RING
19605372	15 METRIC A530M GAL MALLEABLE IRON DOUBLE PIPE RING
19605373	20 METRIC A530M GAL MALLEABLE IRON DOUBLE PIPE RING
19605374	25 METRIC A530M GAL MALLEABLE IRON DOUBLE PIPE RING
19605375	32 METRIC A530M GAL MALLEABLE IRON DOUBLE PIPE RING
19605376	40 METRIC A530M GAL MALLEABLE IRON DOUBLE PIPE RING
19605377	50 METRIC A530M GAL MALLEABLE IRON DOUBLE PIPE RING
19605378	65 METRIC A530M GAL MALLEABLE IRON DOUBLE PIPE RING
19605379	80 METRIC A530M GAL MALLEABLE IRON DOUBLE PIPE RING
19605380	100 METRIC A530M GAL MALLEABLE IRON DOUBLE PIPE RING
19605381	125 METRIC A530M GAL MALLEABLE IRON DOUBLE PIPE RING
19605382	150 METRIC A530M GAL MALLEABLE IRON DOUBLE PIPE RING

METRIC BLK MALLEABLE IRON SINGLE PIPE RING

PRODUCT CODE	DESCRIPTION
19605120	8 METRIC A529M BLK MALLEABLE IRON SINGLE PIPE RING
19605121	10 METRIC A529M BLK MALLEABLE IRON SINGLE PIPE RING
19605122	15 METRIC A529M BLK MALLEABLE IRON SINGLE PIPE RING
19605123	20 METRIC A529M BLK MALLEABLE IRON SINGLE PIPE RING
19605124	25 METRIC A529M BLK MALLEABLE IRON SINGLE PIPE RING
19605125	32 METRIC A529M BLK MALLEABLE IRON SINGLE PIPE RING
19605126	40 METRIC A529M BLK MALLEABLE IRON SINGLE PIPE RING
19605127	50 METRIC A529M BLK MALLEABLE IRON SINGLE PIPE RING
19605128	65 METRIC A529M BLK MALLEABLE IRON SINGLE PIPE RING
19605129	80 METRIC A529M BLK MALLEABLE IRON SINGLE PIPE RING
19605130	100 METRIC A529M BLK MALLEABLE IRON SINGLE PIPE RING
19605131	125 METRIC A529M BLK MALLEABLE IRON SINGLE PIPE RING
19605132	150 METRIC A529M BLK MALLEABLE IRON SINGLE PIPE RING

METRIC GAL MALLEABLE IRON BACKPLATE

PRODUCT CODE	DESCRIPTION
19605270	M6 METRIC A515M GAL MALLEABLE IRON BACKPLATE
19605271	M8 METRIC A515M GAL MALLEABLE IRON BACKPLATE
19605272	M10 METRIC A515M GAL MALLEABLE IRON BACKPLATE
19605273	M12 METRIC A515M GAL MALLEABLE IRON BACKPLATE

Visit the Ashworth website
www.ashworth.eu.com

COPPER & BRASS FITTINGS



ALSO AVAILABLE WITH BSP THREAD

A621 COPPER SADDLE BAND

PRODUCT CODE	DESCRIPTION
19606000	15 A621 COPPER SADDLE BAND
19606001	22 A621 COPPER SADDLE BAND
19606002	28 A621 COPPER SADDLE BAND

A622 BRASS HOSPITAL BRACKET

PRODUCT CODE	DESCRIPTION
19606021	22 A622 BRASS HOSPITAL BRACKET
19606022	28 A622 BRASS HOSPITAL BRACKET
19606023	35 A622 BRASS HOSPITAL BRACKET
19606024	42 A622 BRASS HOSPITAL BRACKET
19606025	54 A622 BRASS HOSPITAL BRACKET

A622CP BRASS HOSPITAL BRACKET CHROME PLTD

PRODUCT CODE	DESCRIPTION
19606030	15 A622CP BRASS HOSPITAL BRACKET CHROME PLTD
19606031	22 A622CP BRASS HOSPITAL BRACKET CHROME PLTD
19606032	28 A622CP BRASS HOSPITAL BRACKET CHROME PLTD
19606033	35 A622CP BRASS HOSPITAL BRACKET CHROME PLTD

A623 PRESSED BRASS SCREW ON BRACKET

PRODUCT CODE	DESCRIPTION
19606050	15 A623 PRESSED BRASS SCREW ON BRACKET
19606051	22 A623 PRESSED BRASS SCREW ON BRACKET
19606052	28 A623 PRESSED BRASS SCREW ON BRACKET
19606053	35 A623 PRESSED BRASS SCREW ON BRACKET
19606054	42 A623 PRESSED BRASS SCREW ON BRACKET
19606055	54 A623 PRESSED BRASS SCREW ON BRACKET

A623CP PRESSED BRASS SCREW ON BRACKET CHROME PLTD

PRODUCT CODE	DESCRIPTION
19606060	15 A623CP PRESSED BRASS SCREW ON BRACKET CHROME PLTD
19606061	22 A623CP PRESSED BRASS SCREW ON BRACKET CHROME PLTD
19606062	28 A623CP PRESSED BRASS SCREW ON BRACKET CHROME PLTD
19606063	35 A623CP PRESSED BRASS SCREW ON BRACKET CHROME PLTD
19606064	42 A623CP PRESSED BRASS SCREW ON BRACKET CHROME PLTD
19606065	54 A623CP PRESSED BRASS SCREW ON BRACKET CHROME PLTD

A624 CAST BRASS SCREW ON BRACKET

PRODUCT CODE	DESCRIPTION
19606080	15 A624 CAST BRASS SCREW ON BRACKET
19606081	22 A624 CAST BRASS SCREW ON BRACKET
19606082	28 A624 CAST BRASS SCREW ON BRACKET
19606083	35 A624 CAST BRASS SCREW ON BRACKET
19606084	42 A624 CAST BRASS SCREW ON BRACKET
19606085	54 A624 CAST BRASS SCREW ON BRACKET

A624CP CAST BRASS SCREW ON BRACKET CHROME PLTD

PRODUCT CODE	DESCRIPTION
19606090	15 A624CP CAST BRASS SCREW ON BRACKET CHROME PLTD
19606091	22 A624CP CAST BRASS SCREW ON BRACKET CHROME PLTD
19606092	28 A624CP CAST BRASS SCREW ON BRACKET CHROME PLTD
19606093	35 A624CP CAST BRASS SCREW ON BRACKET CHROME PLTD
19606094	42 A624CP CAST BRASS SCREW ON BRACKET CHROME PLTD
19606095	54 A624CP CAST BRASS SCREW ON BRACKET CHROME PLTD

A632 BRASS SINGLE RING METRIC

PRODUCT CODE	DESCRIPTION
19606161	15xM10 A632 BRASS SINGLE RING METRIC
19606162	22xM10 A632 BRASS SINGLE RING METRIC
19606163	28xM10 A632 BRASS SINGLE RING METRIC
19606164	35xM10 A632 BRASS SINGLE RING METRIC
19606165	42xM10 A632 BRASS SINGLE RING METRIC
19606166	54xM10 A632 BRASS SINGLE RING METRIC
19606167	67xM10 A632 BRASS SINGLE RING METRIC
19606168	76xM10 A632 BRASS SINGLE RING METRIC
19606169	108xM10 A632 BRASS SINGLE RING METRIC
19606170	133xM10 A632 BRASS SINGLE RING METRIC
19606171	159xM10 A632 BRASS SINGLE RING METRIC

A632CP BRASS FEM BACKPLATE

PRODUCT CODE	DESCRIPTION
19606181	15xM10 A632CP BRASS SINGLE RING METRIC CHROME PLTD
19606182	22xM10 A632CP BRASS SINGLE RING METRIC CHROME PLTD
19606183	28xM10 A632CP BRASS SINGLE RING METRIC CHROME PLTD
19606184	35xM10 A632CP BRASS SINGLE RING METRIC CHROME PLTD
19606185	42xM10 A632CP BRASS SINGLE RING METRIC CHROME PLTD
19606186	54xM10 A632CP BRASS SINGLE RING METRIC CHROME PLTD

A636 BRASS DOUBLE RING METRIC

PRODUCT CODE	DESCRIPTION
19606240	15xM10 A636 BRASS DOUBLE RING METRIC
19606241	22xM10 A636 BRASS DOUBLE RING METRIC
19606242	28xM10 A636 BRASS DOUBLE RING METRIC
19606243	35xM10 A636 BRASS DOUBLE RING METRIC
19606244	42xM10 A636 BRASS DOUBLE RING METRIC
19606245	54xM10 A636 BRASS DOUBLE RING METRIC
19606246	67xM10 A636 BRASS DOUBLE RING METRIC
19606247	76xM10 A636 BRASS DOUBLE RING METRIC
19606248	108xM10 A636 BRASS DOUBLE RING METRIC
19606249	133xM10 A636 BRASS DOUBLE RING METRIC
19606250	159xM10 A636 BRASS DOUBLE RING METRIC

A640 METRIC THREAD BRASS FEM BACKPLATE

PRODUCT CODE	DESCRIPTION
19606274	M6 METRIC THREAD A640 BRASS FEM BACKPLATE
19606275	M8 METRIC THREAD A640 BRASS FEM BACKPLATE
19606276	M10 METRIC THREAD A640 BRASS FEM BACKPLATE

A640CP METRIC THREAD BRASS FEM BACKPLATE CHROME PLTD

PRODUCT CODE	DESCRIPTION
19606296	M10 METRIC THREAD A640CP BRASS FEM BACKPLATE CHROME PLTD

A641 METRIC THREAD BRASS MALE BACKPLATE

PRODUCT CODE	DESCRIPTION
19606314	M10 METRIC THREAD A641 BRASS MALE BACKPLATE

A641CP METRIC THREAD BRASS MALE BACKPLATE CHROME PLTD

PRODUCT CODE	DESCRIPTION
19606334	M10 METRIC THREAD A641CP BRASS MALE BACKPLATE CHROME PLTD



A647 BRASS WALL BRACKET

PRODUCT CODE	DESCRIPTION
19606400	15 A647 BRASS WALL BRACKET
19606401	22 A647 BRASS WALL BRACKET
19606402	28 A647 BRASS WALL BRACKET

A647CP BRASS WALL BRACKET CHROME PLTD

PRODUCT CODE	DESCRIPTION
19606420	15 A647CP BRASS WALL BRACKET CHROME PLTD
19606421	22 A647CP BRASS WALL BRACKET CHROME PLTD
19606422	28 A647CP BRASS WALL BRACKET CHROME PLTD

PIPE SUPPORTS



SPLIT BAND FOR STL PIPE ZINC PLTD

PRODUCT CODE	DESCRIPTION
19601600	15NB (21 OD) SPLIT BAND FOR STL PIPE ZINC PLTD (25x3 M6)
19601601	20NB (27 OD) SPLIT BAND FOR STL PIPE ZINC PLTD (25x3 M6)
19601602	25NB (34 OD) SPLIT BAND FOR STL PIPE ZINC PLTD (25x3 M6)
19601603	32NB (42 OD) SPLIT BAND FOR STL PIPE ZINC PLTD (30x3 M10)
19601604	40NB (48 OD) SPLIT BAND FOR STL PIPE ZINC PLTD (30x3 M10)
19601605	50NB (60 OD) SPLIT BAND FOR STL PIPE ZINC PLTD (30x3 M10)
19601606	65NB (76 OD) SPLIT BAND FOR STL PIPE ZINC PLTD (40x3 M10)
19601607	80NB (89 OD) SPLIT BAND FOR STL PIPE ZINC PLTD (40x3 M10)
19601608	100NB (114 OD) SPLIT BAND FOR STL PIPE ZINC PLTD (40x3 M12)
19601609	125NB (140 OD) SPLIT BAND FOR STL PIPE ZINC PLTD (40x5 M12)
19601610	150NB (168 OD) SPLIT BAND FOR STL PIPE ZINC PLTD (40x5 M12)
19601611	200NB (220 OD) SPLIT BAND FOR STL PIPE ZINC PLTD (50x6 M16)
19601612	250NB (273 OD) SPLIT BAND FOR STL PIPE ZINC PLTD (50x6 M16)
19601613	300NB (323 OD) SPLIT BAND FOR STL PIPE ZINC PLTD (50x10 M20)



OVERSIZE SPLIT BAND ZINC PLTD

PRODUCT CODE	DESCRIPTION
19601650	46mm OD OVERSIZE SPLIT BAND ZINC PLTD (30x3 M10)
19601652	53mm OD OVERSIZE SPLIT BAND ZINC PLTD (30x3 M10)
19601654	56mm OD OVERSIZE SPLIT BAND ZINC PLTD (30x3 M10)
19601656	63mm OD OVERSIZE SPLIT BAND ZINC PLTD (30x3 M10)
19601658	66mm OD OVERSIZE SPLIT BAND ZINC PLTD (30x3 M10)
19601660	70mm OD OVERSIZE SPLIT BAND ZINC PLTD (30x3 M10)
19601662	73mm OD OVERSIZE SPLIT BAND ZINC PLTD (30x3 M10)
19601664	77mm OD OVERSIZE SPLIT BAND ZINC PLTD (30x3 M10)
19601666	81mm OD OVERSIZE SPLIT BAND ZINC PLTD (30x3 M10)
19601668	83mm OD OVERSIZE SPLIT BAND ZINC PLTD (30x3 M10)
19601670	85mm OD OVERSIZE SPLIT BAND ZINC PLTD (30x3 M10)
19601672	89mm OD OVERSIZE SPLIT BAND ZINC PLTD (30x3 M10)
19601674	92mm OD OVERSIZE SPLIT BAND ZINC PLTD (30x3 M10)
19601676	96mm OD OVERSIZE SPLIT BAND ZINC PLTD (30x3 M10)
19601678	100mm OD OVERSIZE SPLIT BAND ZINC PLTD (30x3 M10)
19601680	103mm OD OVERSIZE SPLIT BAND ZINC PLTD (30x3 M10)
19601682	106mm OD OVERSIZE SPLIT BAND ZINC PLTD (30x3 M10)
19601684	109mm OD OVERSIZE SPLIT BAND ZINC PLTD (30x3 M10)
19601686	114mm OD OVERSIZE SPLIT BAND ZINC PLTD (30x3 M10)
19601688	117mm OD OVERSIZE SPLIT BAND ZINC PLTD (30x3 M10)
19601690	122mm OD OVERSIZE SPLIT BAND ZINC PLTD (30x3 M10)
19601692	127mm OD OVERSIZE SPLIT BAND ZINC PLTD (30x3 M10)
19601694	132mm OD OVERSIZE SPLIT BAND ZINC PLTD (30x3 M10)
19601696	139mm OD OVERSIZE SPLIT BAND ZINC PLTD (30x3 M10)
19601698	143mm OD OVERSIZE SPLIT BAND ZINC PLTD (30x3 M10)
19601700	145mm OD OVERSIZE SPLIT BAND ZINC PLTD (30x3 M10)
19601702	148mm OD OVERSIZE SPLIT BAND ZINC PLTD (30x3 M10)
19601704	150mm OD OVERSIZE SPLIT BAND ZINC PLTD (30x3 M10)
19601706	152mm OD OVERSIZE SPLIT BAND ZINC PLTD (40x3 M10)
19601708	155mm OD OVERSIZE SPLIT BAND ZINC PLTD (40x3 M12)
19601710	159mm OD OVERSIZE SPLIT BAND ZINC PLTD (40x3 M12)
19601712	163mm OD OVERSIZE SPLIT BAND ZINC PLTD (40x3 M12)
19601714	168mm OD OVERSIZE SPLIT BAND ZINC PLTD (40x3 M12)
19601716	172mm OD OVERSIZE SPLIT BAND ZINC PLTD (40x3 M12)
19601718	176mm OD OVERSIZE SPLIT BAND ZINC PLTD (40x3 M12)
19601720	180mm OD OVERSIZE SPLIT BAND ZINC PLTD (40x5 M12)
19601722	183mm OD OVERSIZE SPLIT BAND ZINC PLTD (40x5 M12)
19601724	185mm OD OVERSIZE SPLIT BAND ZINC PLTD (40x5 M12)
19601726	190mm OD OVERSIZE SPLIT BAND ZINC PLTD (40x5 M12)
19601728	193mm OD OVERSIZE SPLIT BAND ZINC PLTD (40x5 M12)
19601730	196mm OD OVERSIZE SPLIT BAND ZINC PLTD (40x5 M12)
19601732	200mm OD OVERSIZE SPLIT BAND ZINC PLTD (40x5 M12)
19601734	202mm OD OVERSIZE SPLIT BAND ZINC PLTD (40x5 M12)
19601736	205mm OD OVERSIZE SPLIT BAND ZINC PLTD (40x5 M12)
19601738	212mm OD OVERSIZE SPLIT BAND ZINC PLTD (40x5 M12)
19601740	215mm OD OVERSIZE SPLIT BAND ZINC PLTD (40x5 M12)
19601742	216mm OD OVERSIZE SPLIT BAND ZINC PLTD (40x5 M12)
19601744	220mm OD OVERSIZE SPLIT BAND ZINC PLTD (40x5 M12)
19601746	225mm OD OVERSIZE SPLIT BAND ZINC PLTD (40x5 M12)

PRODUCT CODE	DESCRIPTION
19601748	232mm OD OVERSIZE SPLIT BAND ZINC PLTD (40x5 M12)
19601750	235mm OD OVERSIZE SPLIT BAND ZINC PLTD (40x5 M12)
19601752	236mm OD OVERSIZE SPLIT BAND ZINC PLTD (40x5 M12)
19601754	240mm OD OVERSIZE SPLIT BAND ZINC PLTD (40x5 M12)
19601756	245mm OD OVERSIZE SPLIT BAND ZINC PLTD (40x5 M12)
19601758	250mm OD OVERSIZE SPLIT BAND ZINC PLTD (40x5 M12)
19601760	254mm OD OVERSIZE SPLIT BAND ZINC PLTD (40x5 M12)
19601762	260mm OD OVERSIZE SPLIT BAND ZINC PLTD (40x5 M12)
19601764	262mm OD OVERSIZE SPLIT BAND ZINC PLTD (40x5 M12)
19601766	265mm OD OVERSIZE SPLIT BAND ZINC PLTD (40x5 M12)
19601768	270mm OD OVERSIZE SPLIT BAND ZINC PLTD (40x5 M12)
19601770	272mm OD OVERSIZE SPLIT BAND ZINC PLTD (40x5 M12)
19601772	275mm OD OVERSIZE SPLIT BAND ZINC PLTD (40x5 M12)
19601774	280mm OD OVERSIZE SPLIT BAND ZINC PLTD (40x5 M12)
19601776	284mm OD OVERSIZE SPLIT BAND ZINC PLTD (40x5 M12)
19601778	286mm OD OVERSIZE SPLIT BAND ZINC PLTD (40x5 M12)
19601780	289mm OD OVERSIZE SPLIT BAND ZINC PLTD (40x5 M12)
19601782	295mm OD OVERSIZE SPLIT BAND ZINC PLTD (40x5 M12)
19601784	302mm OD OVERSIZE SPLIT BAND ZINC PLTD (40x5 M12)
19601786	305mm OD OVERSIZE SPLIT BAND ZINC PLTD (40x5 M12)
19601788	315mm OD OVERSIZE SPLIT BAND ZINC PLTD (40x5 M12)
19601790	320mm OD OVERSIZE SPLIT BAND ZINC PLTD (40x5 M12)
19601792	325mm OD OVERSIZE SPLIT BAND ZINC PLTD (40x5 M12)
19601794	335mm OD OVERSIZE SPLIT BAND ZINC PLTD (40x5 M12)



SADDLE CLAMP FOR STL PIPE ZINC PLTD

PRODUCT CODE	DESCRIPTION
19601820	15NB (21 OD) SADDLE CLAMP FOR STL PIPE ZINC PLTD
19601821	20NB (27 OD) SADDLE CLAMP FOR STL PIPE ZINC PLTD
19601822	25NB (34 OD) SADDLE CLAMP FOR STL PIPE ZINC PLTD
19601823	32NB (42 OD) SADDLE CLAMP FOR STL PIPE ZINC PLTD
19601824	40NB (48 OD) SADDLE CLAMP FOR STL PIPE ZINC PLTD
19601825	50NB (60 OD) SADDLE CLAMP FOR STL PIPE ZINC PLTD
19601826	65NB (76 OD) SADDLE CLAMP FOR STL PIPE ZINC PLTD
19601827	80NB (89 OD) SADDLE CLAMP FOR STL PIPE ZINC PLTD
19601828	100NB (114 OD) SADDLE CLAMP FOR STL PIPE ZINC PLTD
19601829	125NB (140 OD) SADDLE CLAMP FOR STL PIPE ZINC PLTD
19601830	150NB (168 OD) SADDLE CLAMP FOR STL PIPE ZINC PLTD
19601831	200NB (219 OD) SADDLE CLAMP FOR STL PIPE ZINC PLTD



ZINC PLATED U-BOLT

PRODUCT CODE	DESCRIPTION
19601850	15 (M6 THREAD) ZINC PLATED U-BOLT
19601851	20 (M6 THREAD) ZINC PLATED U-BOLT
19601852	25 (M10 THREAD) ZINC PLATED U-BOLT
19601853	32 (M10 THREAD) ZINC PLATED U-BOLT
19601854	40 (M10 THREAD) ZINC PLATED U-BOLT
19601855	50 (M10 THREAD) ZINC PLATED U-BOLT
19601856	65 (M10 THREAD) ZINC PLATED U-BOLT
19601857	80 (M12 THREAD) ZINC PLATED U-BOLT
19601858	100 (M12 THREAD) ZINC PLATED U-BOLT
19601859	125 (M12 THREAD) ZINC PLATED U-BOLT
19601860	150 (M12 THREAD) ZINC PLATED U-BOLT
19601861	200 (M16 THREAD) ZINC PLATED U-BOLT
19601862	250 (M16 THREAD) ZINC PLATED U-BOLT
19601863	300 (M16 THREAD) ZINC PLATED U-BOLT



ZINC PLATED EXTENDED U-BOLT

PRODUCT CODE	DESCRIPTION
19601880	25 (M10 THREAD) ZINC PLATED EXTENDED U-BOLT
19601881	32 (M10 THREAD) ZINC PLATED EXTENDED U-BOLT
19601882	40 (M10 THREAD) ZINC PLATED EXTENDED U-BOLT
19601883	50 (M10 THREAD) ZINC PLATED EXTENDED U-BOLT
19601884	65 (M10 THREAD) ZINC PLATED EXTENDED U-BOLT
19601885	80 (M12 THREAD) ZINC PLATED EXTENDED U-BOLT
19601886	100 (M12 THREAD) ZINC PLATED EXTENDED U-BOLT
19601887	125 (M12 THREAD) ZINC PLATED EXTENDED U-BOLT
19601888	150 (M12 THREAD) ZINC PLATED EXTENDED U-BOLT



BOSSED HVY DUTY PIPE CLAMP FOR STL PIPE ZINC PLTD

PRODUCT CODE	DESCRIPTION
19601900	15NB (19-23 OD) BOSSED HVY DUTY PIPE CLAMP FOR STL PIPE ZINC PLTD M10
19601901	20NB (24-29 OD) BOSSED HVY DUTY PIPE CLAMP FOR STL PIPE ZINC PLTD M10
19601902	25NB (30-35 OD) BOSSED HVY DUTY PIPE CLAMP FOR STL PIPE ZINC PLTD M10
19601903	32NB (40-46 OD) BOSSED HVY DUTY PIPE CLAMP FOR STL PIPE ZINC PLTD M10
19601904	40NB (48-54 OD) BOSSED HVY DUTY PIPE CLAMP FOR STL PIPE ZINC PLTD M10
19601905	50NB (57-63 OD) BOSSED HVY DUTY PIPE CLAMP FOR STL PIPE ZINC PLTD M10
19601950	65NB (70-76 OD) BOSSED HVY DUTY PIPE CLAMP FOR STL PIPE ZINC PLTD M12
19601951	80NB (87-93 OD) BOSSED HVY DUTY PIPE CLAMP FOR STL PIPE ZINC PLTD M12
19601952	100NB (108-114 OD) BOSSED HVY DUTY PIPE CLAMP FOR STL PIPE ZINC PLTD M12
19601953	125NB (135-141 OD) BOSSED HVY DUTY PIPE CLAMP FOR STL PIPE ZINC PLTD M12
19601954	150NB (159-168 OD) BOSSED HVY DUTY PIPE CLAMP FOR STL PIPE ZINC PLTD M12
19601955	200NB (210-219 OD) BOSSED HVY DUTY PIPE CLAMP FOR STL PIPE ZINC PLTD M12



UNLINED FASTFIX CLAMP

PRODUCT CODE	DESCRIPTION
19602000	18-22mm UNLINED FASTFIX CLAMP M10 TAPPING
19602002	21-23mm UNLINED FASTFIX CLAMP M10 TAPPING
19602004	26-30mm UNLINED FASTFIX CLAMP M10 TAPPING
19602006	32-34mm UNLINED FASTFIX CLAMP M10 TAPPING
19602008	38-42mm UNLINED FASTFIX CLAMP M10 TAPPING
19602010	47-51mm UNLINED FASTFIX CLAMP M10 TAPPING
19602012	54-60mm UNLINED FASTFIX CLAMP M10 TAPPING
19602014	62-68mm UNLINED FASTFIX CLAMP M10 TAPPING
19602016	72-76mm UNLINED FASTFIX CLAMP M10 TAPPING
19602018	79-85mm UNLINED FASTFIX CLAMP M10 TAPPING
19602020	85-89mm UNLINED FASTFIX CLAMP M10 TAPPING
19602022	94mm UNLINED FASTFIX CLAMP M10 TAPPING
19602024	100-105mm UNLINED FASTFIX CLAMP M10 TAPPING
19602026	106-111mm UNLINED FASTFIX CLAMP M10 TAPPING
19602028	110-118mm UNLINED FASTFIX CLAMP M10 TAPPING
19602030	118-125mm UNLINED FASTFIX CLAMP M10 TAPPING
19602032	122-127mm UNLINED FASTFIX CLAMP M10 TAPPING
19602034	129-134mm UNLINED FASTFIX CLAMP M10 TAPPING
19602036	139-144mm UNLINED FASTFIX CLAMP M10 TAPPING
19602038	146-151mm UNLINED FASTFIX CLAMP M10 TAPPING
19602040	155mm UNLINED FASTFIX CLAMP M10 TAPPING
19602042	157-162mm UNLINED FASTFIX CLAMP M10 TAPPING
19602044	164-169mm UNLINED FASTFIX CLAMP M10 TAPPING
19602046	172-180mm UNLINED FASTFIX CLAMP M10 TAPPING
19602048	180-190mm UNLINED FASTFIX CLAMP M10 TAPPING
19602050	190-200mm UNLINED FASTFIX CLAMP M10 TAPPING
19602052	212-219mm UNLINED FASTFIX CLAMP M10 TAPPING

HANGING SYSTEM QUOTATION FORM

To make things easier for our customers we have provided an easy to use QUOTATION request form. Simply fill in the form and fax it back to your nearest Ashworth branch (*Fax numbers below*), alternatively you can post the form back to your nearest Ashworth branch (*Address details on the back of this brochure*).

Please fill in your details below and then list the products you would like to be included in your quotation.

Contact Name	<input type="text"/>	Your Address	<input type="text"/>
Company Name	<input type="text"/>	<input type="text"/>	<input type="text"/>
Telephone Number	<input type="text"/>	<input type="text"/>	<input type="text"/>
Fax Number	<input type="text"/>	<input type="text"/>	<input type="text"/>
Email Address	<input type="text"/>	Preferred contact method:	Post <input type="checkbox"/> Email <input type="checkbox"/> Telephone <input type="checkbox"/>

Product Code	Product Description	Quantity Required

Ashworth Branch Fax Numbers

Wednesfield	01902 867499	Leeds	0113 282 5572	White City	0208 600 3232
Bristol	0117 961 7001	High Wycombe	01494 464211	Rochester	01634 290778
Radcliffe	0161 724 6800	Nottingham	0115 978 1324	Bellshill	01698 745820

Once your quotation request form is received we will respond immediately via your preferred method of contact.

HANGING SYSTEM QUOTATION FORM

Notes

PIPE SUPPORTS



RUBBER LINED 2-SCREW CLAMP

PRODUCT CODE	DESCRIPTION
19602100	12-14mm RUBBER LINED 2-SCREW CLAMP M8/M10 DUAL TAPPING
19602102	15-19mm RUBBER LINED 2-SCREW CLAMP M8/M10 DUAL TAPPING
19602104	21-23mm RUBBER LINED 2-SCREW CLAMP M8/M10 DUAL TAPPING
19602106	26-28mm RUBBER LINED 2-SCREW CLAMP M8/M10 DUAL TAPPING
19602108	32-35mm RUBBER LINED 2-SCREW CLAMP M8/M10 DUAL TAPPING
19602110	40-43mm RUBBER LINED 2-SCREW CLAMP M8/M10 DUAL TAPPING
19602112	44-49mm RUBBER LINED 2-SCREW CLAMP M8/M10 DUAL TAPPING
19602114	50-56mm RUBBER LINED 2-SCREW CLAMP M8/M10 DUAL TAPPING
19602116	57-61mm RUBBER LINED 2-SCREW CLAMP M8/M10 DUAL TAPPING
19602118	63-67mm RUBBER LINED 2-SCREW CLAMP M8/M10 DUAL TAPPING
19602120	74-80mm RUBBER LINED 2-SCREW CLAMP M8/M10 DUAL TAPPING
19602122	83-91mm RUBBER LINED 2-SCREW CLAMP M8/M10 DUAL TAPPING
19602124	108-114mm RUBBER LINED 2-SCREW CLAMP M8/M10 DUAL TAPPING
19602126	131-135mm RUBBER LINED 2-SCREW CLAMP M8/M10 DUAL TAPPING
19602128	136-139mm RUBBER LINED 2-SCREW CLAMP M8/M10 DUAL TAPPING
19602130	159-168mm RUBBER LINED 2-SCREW CLAMP M8/M10 DUAL TAPPING



SPLIT BAND FOR COPPER PIPE NYLON COATED

PRODUCT CODE	DESCRIPTION
19602200	15 SPLIT BAND FOR COPPER PIPE NYLON COATED (25x3 M6)
19602202	22 SPLIT BAND FOR COPPER PIPE NYLON COATED (25x3 M6)
19602204	28 SPLIT BAND FOR COPPER PIPE NYLON COATED (25x3 M6)
19602206	35 SPLIT BAND FOR COPPER PIPE NYLON COATED (25x3 M6)
19602208	42 SPLIT BAND FOR COPPER PIPE NYLON COATED (30x3 M10)
19602210	54 SPLIT BAND FOR COPPER PIPE NYLON COATED (30x3 M10)
19602212	67 SPLIT BAND FOR COPPER PIPE NYLON COATED (30x3 M10)
19602214	76 SPLIT BAND FOR COPPER PIPE NYLON COATED (30x3 M10)
19602216	108 SPLIT BAND FOR COPPER PIPE NYLON COATED (40x3 M12)
19602218	133 SPLIT BAND FOR COPPER PIPE NYLON COATED (40x3 M12)
19602220	159 SPLIT BAND FOR COPPER PIPE NYLON COATED (40x3 M12)



FILBOW CLAMP FM APPROVED

PRODUCT CODE	DESCRIPTION
19602300	15 FILBOW CLAMP FM APPROVED
19602301	20 FILBOW CLAMP FM APPROVED
19602302	25 FILBOW CLAMP FM APPROVED
19602303	32 FILBOW CLAMP FM APPROVED
19602304	40 FILBOW CLAMP FM APPROVED
19602305	50 FILBOW CLAMP FM APPROVED
19602306	65 FILBOW CLAMP FM APPROVED
19602307	80 FILBOW CLAMP FM APPROVED
19602308	100 FILBOW CLAMP FM APPROVED
19602310	150 FILBOW CLAMP FM APPROVED
19602311	200 FILBOW CLAMP FM APPROVED



UNLINED 2-SCREW CLAMP

PRODUCT CODE	DESCRIPTION
19602160	15-17mm UNLINED 2-SCREW CLAMP M8/10 DUAL TAPPING
19602161	18-22mm UNLINED 2-SCREW CLAMP M8/10 DUAL TAPPING
19602162	26-30mm UNLINED 2-SCREW CLAMP M8/10 DUAL TAPPING
19602163	32-34mm UNLINED 2-SCREW CLAMP M8/10 DUAL TAPPING
19602164	41-45mm UNLINED 2-SCREW CLAMP M8/10 DUAL TAPPING
19602165	47-51mm UNLINED 2-SCREW CLAMP M8/10 DUAL TAPPING
19602166	58-64mm UNLINED 2-SCREW CLAMP M8/10 DUAL TAPPING
19602167	62-68mm UNLINED 2-SCREW CLAMP M8/10 DUAL TAPPING
19602168	75-76mm UNLINED 2-SCREW CLAMP M8/10 DUAL TAPPING
19602169	79-85mm UNLINED 2-SCREW CLAMP M8/10 DUAL TAPPING
19602170	85-89mm UNLINED 2-SCREW CLAMP M8/10 DUAL TAPPING
19602171	94mm UNLINED 2-SCREW CLAMP M8/10 DUAL TAPPING
19602172	100-105mm UNLINED 2-SCREW CLAMP M8/10 DUAL TAPPING
19602173	106-111mm UNLINED 2-SCREW CLAMP M8/10 DUAL TAPPING
19602174	110-118mm UNLINED 2-SCREW CLAMP M8/10 DUAL TAPPING
19602175	139-144mm UNLINED 2-SCREW CLAMP M8/10 DUAL TAPPING
19602176	164-169mm UNLINED 2-SCREW CLAMP M8/10 DUAL TAPPING



SADDLE CLAMP FOR COPPER PIPE NYLON COATED

PRODUCT CODE	DESCRIPTION
19602250	15 SADDLE CLAMP FOR COPPER PIPE NYLON COATED
19602252	22 SADDLE CLAMP FOR COPPER PIPE NYLON COATED
19602254	28 SADDLE CLAMP FOR COPPER PIPE NYLON COATED
19602256	35 SADDLE CLAMP FOR COPPER PIPE NYLON COATED
19602258	42 SADDLE CLAMP FOR COPPER PIPE NYLON COATED
19602260	54 SADDLE CLAMP FOR COPPER PIPE NYLON COATED
19602262	67 SADDLE CLAMP FOR COPPER PIPE NYLON COATED
19602264	76 SADDLE CLAMP FOR COPPER PIPE NYLON COATED
19602266	108 SADDLE CLAMP FOR COPPER PIPE NYLON COATED
19602268	133 SADDLE CLAMP FOR COPPER PIPE NYLON COATED
19602270	159 SADDLE CLAMP FOR COPPER PIPE NYLON COATED

HANGERS FOR CPVC PIPES

For more information on our range of Hangers for CPVC pipes, contact our experienced Sales Team.

PRO. CODE	DESCRIPTION
19602400	20 ONE HOLE WRAPAROUND STRAP FOR CPVC PIPE
19602401	25 ONE HOLE WRAPAROUND STRAP FOR CPVC PIPE
19602402	32 ONE HOLE WRAPAROUND STRAP FOR CPVC PIPE
19602403	40 ONE HOLE WRAPAROUND STRAP FOR CPVC PIPE
19602404	50 ONE HOLE WRAPAROUND STRAP FOR CPVC PIPE
19602410	20 TWO HOLE STRAP FOR CPVC PIPE
19602411	25 TWO HOLE STRAP FOR CPVC PIPE
19602412	32 TWO HOLE STRAP FOR CPVC PIPE
19602413	40 TWO HOLE STRAP FOR CPVC PIPE
19602414	50 TWO HOLE STRAP FOR CPVC PIPE
19602420	20 SIDE MOUNT STRAP FOR CPVC PIPE
19602421	25 SIDE MOUNT STRAP FOR CPVC PIPE
19602422	32 SIDE MOUNT STRAP FOR CPVC PIPE
19602423	40 SIDE MOUNT STRAP FOR CPVC PIPE
19602424	50 SIDE MOUNT STRAP FOR CPVC PIPE
19602430	20 STAND OFF TWO HOLE STRAP FOR CPVC PIPE
19602431	25 STAND OFF TWO HOLE STRAP FOR CPVC PIPE
19602432	32 STAND OFF TWO HOLE STRAP FOR CPVC PIPE
19602433	40 STAND OFF TWO HOLE STRAP FOR CPVC PIPE
19602434	50 STAND OFF TWO HOLE STRAP FOR CPVC PIPE



See our full range of Drainage Products in our **NEW Drainage Systems Product Guide.**

To request your free copy please call your local branch or visit:

www.ashworth.eu.com

BRANCHES

Bellshill

Marion Street, Off Main Street, Mossend,
Bellshill ML4 1EB
Main Tel No: 01698 742839
Fax No: 01698 745820

Bristol

Unit 9, Oak Lane,
Fishponds Trading Estate,
Bristol BS5 7UY
Main Tel No: 0117 961 7000
Fax No: 0117 961 7001

High Wycombe

Coronation Road,
Cressex Business Park, High Wycombe,
Buckinghamshire HP12 3TA
Main Tel No: 01494 442144
Fax No: 01494 464211

Leeds

Jawbone Industrial Estate, Wood Lane,
Rothwell, Leeds LS26 0RS
Main Tel No: 0113 282 0002
Fax No: 0113 282 5572

Nottingham

Leengate, Gregory Street,
Lenton, Nottingham,
Nottinghamshire NG7 2PN
Main Tel No: 0115 978 1300
Fax No: 0115 978 1324

Radcliffe

Higher Ainsworth Road,
Radcliffe, Manchester M26 4AF
Main Tel No: 0161 723 3468
Fax No: 0161 724 6800

Rochester

Neptune Way, Medway City Estate,
Rochester, Kent ME2 4NA
Main Tel No: 01634 290731
Fax No: 01634 290778

Wednesfield

Neachells Lane, Wednesfield,
Wolverhampton WV11 3QF
Main Tel No: 01902 867400
Fax No: 01902 867499

White City

3/5 Silver Road, Off Ariel Way,
White City, London W12 7SG
Main Tel No: 0208 600 3210
Fax No: 0208 600 3232



Ashworth

SUPPLYING MECHANICAL SERVICES
AND PROCESS CONTRACTORS