



Celebrating 20 years of change in Perry Common

In March, Witton Lodge Community Association (WLCA) celebrated its 20th anniversary. Having been established in 1994 by members of the local community, for the local community; we are marking this special milestone with a Year Of Celebration. This includes festivals and a local

history project, recording and celebrating the dramatic changes that have happened in the past 20 years.

Of course, there will also be a whole host of activities and events in Perry Common, opportunities available and lots of interesting news and developments to report. It's all in the following pages...



IN THIS ISSUE



Your chance to see the plans



All at the ring



Whats on this Summer

PERRY COMMON REGENERATION

Work is progressing well on the developments that we outlined in the December edition of Perry Common Matters.

DOVEDALE ROAD AREA – HOUSING

Work is now well under-way on this large and exciting development.



20 new WLCA properties are also being built on the site bordering Dovedale, Capilano and Wendover Roads. These homes are due to be completed by Christmas.



39 properties for Birmingham City Council are being built to the north of the Dove Medical Centre and are due to be completed by February 2015.



ENDERBY PARK

Enderby Park is being transformed this summer, with the installation of children's play equipment, new outdoor gym equipment, a signpost to world destinations, new trees, improved pathways, new boundary fencing and a new seating area overlooking the whole park. This work is due to be completed by late August.

The grand opening will be taking place on Saturday 20th September, with an event in the park from 11am-3pm; showing demonstrations on how to use the equipment, healthy food, an arts project and much more.

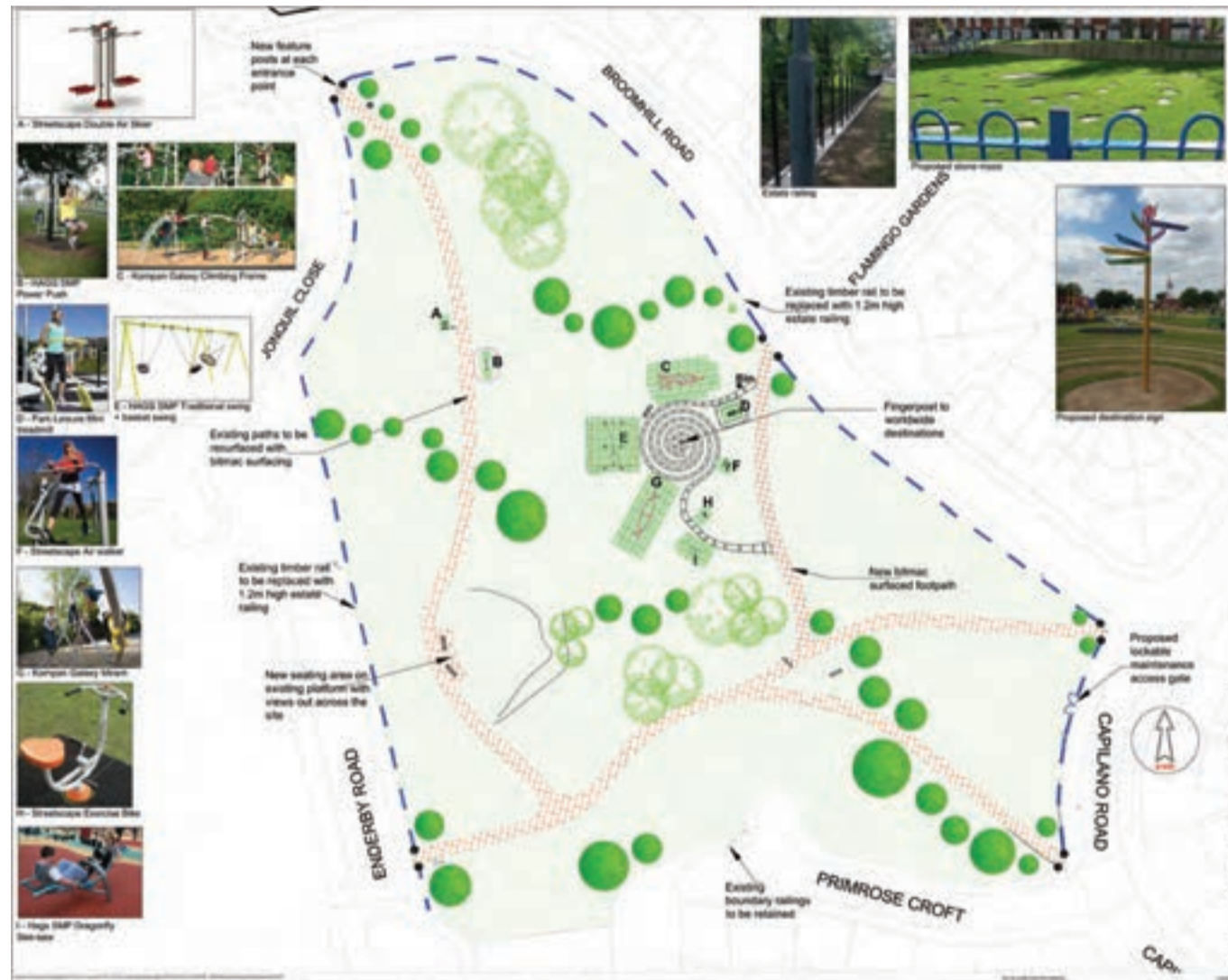

ENDERBY ROAD

Site clearance work has started on 'The Balcony' site at Enderby Road. New homes are planned for this area, which is one of the last to be developed due to the difference between ground levels – from pavement to the site boundary at Story Wood School. The new homes planned for this site will create an attractive link from The Ring to Enderby Park.



WLCA are holding an open evening where residents can have a closer look at the development plans, property types and find out how the properties will be allocated.

This will take place on Monday 28th July from 7:00-9:00pm at Perry Common Community Hall. Please note this date in your diary.



Volunteer Declan really enjoying his work

Enthusiastic Declan McPherson, age 17, started volunteering at WLCA in April – to help out on the reception desk.

With Declan's positive work and great attitude, not only does he work on reception, but also helps out with many activities from: filing, taking phone calls, helps produce leaflets, organises events and much more – being a very important and greatly appreciated member of the WLCA team.

Declan says that "Volunteering has really helped me build my confidence. It is really enjoyable. I have learned lots of new skills, enjoy working in the team and it looks great on my CV".

Declan continues "I would definitely recommend volunteering to other people".

If you are interested in volunteering please call 0121 382 1930 or email Joyce.Wallace@wittonlodge.org.uk.

Volunteer Mary wins Point of Light Award

Local resident and WLCA Resident Director Mary Harvey has been awarded a prestigious award to recognise her wide-ranging volunteering work in Perry Common.

Mary, who is 93 years of age, was awarded a 'Point Of Light' award from Prime Minister David Cameron, for her wealth of voluntary work within the local community.

Mary has limitless energy and is involved in a wide variety of volunteering projects. These include: Duckling Watch – where she takes schoolchildren to Witton Lakes Park to teach them about nature; Community Watch – where she helps prevent crime in the local area; Speed Watch, Gardening Club and at local events including the annual Christmas Lights Switch On and Spring Into Spring festival.

When asked about receiving the award, Mary said "I am honoured. I really enjoy volunteering and helping others. To see the smiles on the youngsters faces on Duckling Watch makes me very happy". Mary goes on to say "volunteering gets me out of the house, I get to meet lots of new people and it keeps me young."

Congratulations Mary.



LOCAL HEROES

Skills and jobs boost for local young people

We are very proud to report that a groundbreaking skills and employment scheme for young people not in education, employment or training (NEETS) has been a huge success.

The Erdington Works initiative began in December 2013. It is a partnership between WLCA, Birmingham City Council, Castle Vale Community Regeneration Services, Castle Vale Tenants and Residents Alliance, John Taylor Hospice and Merlin Venture. Erdington Works has so far created support and training for 34 young people, created 20 paid work placements, leading to 18 jobs.

At WLCA, Christina Ly and Haleema Khathoon have been employed as Youth Employment Ambassadors, while Paramjot Pagpatten was recently appointed as our new Housing Assistant. Sean Rhymes who was also based at WLCA has gained full-time employment, with help from Erdington Works.

All of the young people who have taken part have gained a wide range of skills and experience – with many gaining paid employment, increased confidence and workplace skills. The very positive feedback from the young people involved has been very encouraging indeed.



New park-keeper Darren at Witton Lakes

The start of May saw a new, and very enthusiastic, Park Keeper at Witton Lakes. Darren Murdock is doing a great job – with the park looking really good.

Darren says "I thoroughly enjoy working here. Its great constantly seeing new faces coming into the park, meeting people and seeing the park improve. This really is a fantastic local park and I ask as many people to come and use it as possible."

Darren is now working towards a Green Flag award for Witton Lakes, so please use this excellent local attraction and say hello to Darren.



Cinderella's Beauty

24-26 Kingfisher Road (off the Ring)
Tel: 0121 439 4040
Website: www.cinderellasbeauty.com

Open: Tues-Fri 10am-7pm / Thurs 10am-8pm / Sat 10am-5pm / Sun-Mon Closed

Cinderella's provides an impressive range of hair and beauty treatments from: Nails, Botox, Threading, Waxing, Massage and much more – all in light and modern surroundings with friendly and welcoming staff.

I.S.P Woodwork

127 Witton Lodge Road
Tel: 0121 382 6062 / Mob: 079 5668 8509
Email: ISPWoodwork@hotmail.co.uk

Open: Mon-Fri 9:30am-5pm / Sat 9:30am-3:30pm

Not just your average hardware shop! ISP offers an eye-opening variety of DIY, tools, handmade garden planters and bird feeding tables – with home delivery. The in-store workshop provides: cabinet making, joinery, tool and blade sharpening, furniture repairs and much more.

T & J News

121 Witton Lodge Road
Tel: 0121 350 2455

Open: Mon-Fri 6:30am-8pm / Sat 7am-7:30pm / Sun 8am-1pm.

Open from early morning to late, T & J News offers newspapers, sweets and drinks, convenience store, off-licence, national lottery, mobile phone top-ups, a payzone and cash machine.

Ringside Fish Bar

119 Witton Lodge Road
Tel: 0121 382 4273

Open: Mon-Wed 11:30am-2pm 3:30-9pm / Thu-Sat 11:30am-2pm 3:30-9:30pm / Closed Sun

5 star award winning fish & chip shop (as judged by Birmingham Mail). A varied menu with everything from fish & chips, southern fried chicken, curries, wraps, grilled meals and more. Telephone orders are welcome.

Bella Pizza

117 Witton Lodge Road
Tel: 0121 350 7478

Open: Sun-Thu 3pm-11pm / Fri-Sat 3pm-Midnight / Open Bank Holidays

Bella Pizza will deliver a wide selection of pizza, pasta, burgers and more to your door or as a take-out, 7 days per week.

YOUR SHOPS AT THE RING

Variety and convenience on your door step.



Lodge Pharmacy

115 Witton Lodge Road
Tel: 0121 373 4344
Email: Lodge.Witton@hotmail.co.uk

Open: Mon-Fri 8am-10pm / Sat-Sun 8am-11pm

Open 100 hours per week; selling a wide range of pharmacy products and services, including electronic prescriptions and a late night collection point – the only one for many miles around.

Montana's

113 Witton Lodge Road
Tel: 0121 373 2434

Open: Tues 9am-1pm / Wed-Sat 9am-5pm / Sun-Mon Closed

Unisex hair salon, offering a wide range of styles and treatments in light and modern surroundings. Spray tan and ear piercings are also available.

Jim Duffell Butchers

111 Witton Lodge Road
Tel: 0121 350 7859

Open: Mon-Tue 8am-5pm / Wed: 8am-1pm / Sat 8am-3pm

Jim Duffell butchers provides an impressive selection of meats, delicatessen, fresh fruit and vegetables and provisions. Jim also offers a convenient home delivery service, delivered straight to your door!

Betty's Café

107 Witton Lodge Road
Tel: 0121 377 7567

Open: Mon-Fri 7am-6pm / 7am-3pm

Betty's offers home cooked meals, sandwiches and cakes, all from their wide ranging menu. Eat in or take out. They say 'if there's anything, just ask as you would at home'. Betty's also offer free local delivery.

One Stop Shop

103-105 Witton Lodge Road

Open: Mon-Sat 9am-10pm / Sun 10am-10pm

Convenience store and off-licence, selling scratch-cards, mobile phone tops ups and having an indoor cash machine and paypoint. Davey & Sam are also long-time collectors for Air Ambulance, as the window full of certificates shows.

A FANTASTIC LIBRARY ON OUR DOORSTEP

Officially opened on 5th September 1934, the iconic library was extensively refurbished in 2010-2011, modernising the building but retaining many of the impressive 1930s features, including the oak bookcases, wooden panelling, art deco tiling and glass screens.

Today the library has a wide range of books, talking books, newspapers and two children's libraries – one for children aged 5 and under (with an excellent range of picture books), while the other children's library (for age 5s and over) has everything from non-fiction to homework guides.

Regular events include: Children's Rhyme Time (for children under 5 years on the second and fourth Thursday of the month in term time), Knit and Natter (Mon 1:00-3:00pm), Chat & Cuppa (Mon 11:00am), CV advice and much more. On Tuesdays and Wednesday's, when the library is not open, it is used for Drop In sessions for The Citizens Advice Bureau (from 9:00am-4:00pm).

Along with all public libraries in the UK, Perry Common takes part in The Summer Reading Challenge throughout the summer holidays. It is aimed at children aged 4-11 who can earn stickers, certificates, prizes and gifts by taking up the challenge to read six books.

Over recent years, despite budgetary pressures leading to a reduction in opening hours, Perry Common Library continues to play an important role in the local community. Please use this valuable local asset or we will lose it!



WHATS BEEN GOING ON

Creative commemoration: Knitted poppies artwork marks WW1 Centenary



With 4 months work and 2,500 volunteer hours, 90 volunteers have up-cycled materials to produce their own version of the well-known image of a soldier at an unmarked grave.

1914 knitted and hand-felted poppies make up the artwork, which was displayed at the NEC for Gardener's World Live in June.

The Creative Moments group were very proud to receive a 'Highly Commended' certificate from the Royal Horticultural Society for this show feature, and are looking forward to planning their next project!

The group meets every Monday 11:45am at Perry Common Community Hall. For more information please contact Lesley at creativemoments@outlook.com.

The artwork will be on display at the grand opening of Enderby Park on Saturday 20th September between 11:00am-3:00pm.

Biking Fun and Fitness at Story Wood Cycling Hub



Getting fit and having fun has just got easier in Perry Common.

Bike North Birmingham has helped set-up a 'Community Cycling Hub' at Story Wood School. This is a great opportunity to learn to ride or develop your cycling skills – no matter what your age. It's great fun and great exercise!

- Family Learn To Ride sessions take place on Monday evenings from 6:00-7:25pm and a second session at 7:30-9:00pm. These sessions are a fantastic opportunity to learn to ride or just simply improve your riding skills – in a great family atmosphere.
- Regular Family Rides take place on alternate Thursdays from 6:30-8:00pm. This will involve a leisurely bike ride around the local area and Witton Lakes. Booking for these sessions is essential, so please contact Bike North Birmingham.

Bike North Birmingham will also be hosting Cycle Maintenance Courses and a Drop-In Service from the Story Wood Cycle Hub. For more information please call 0121 464 1020 or visit: www.bikenorthbirmingham.org.uk.

Poppies and wildflowers mark centenary of First World War



Over 60 school students from St Margaret Mary Primary School, local residents and the Friends Of Witton Lakes were out in the rain back in April to make Witton Lakes colourful and mark the centenary of the First World War.

Wildflower seeds, including poppies, were planted along the bund – a 200 metre raised planting bed of topsoil-winding its way across the entire length of the park near Perry Common Road.

The topsoil was kindly donated by Lovell Partnerships Limited, who are building new homes at Capilano and Dovedale Roads, while £138.88p for the wildflower seeds was donated by Friends Of Witton Lakes by collecting Birmingham Mail WISH tokens.

During the planting, Ofure, a pupil at St Margaret Mary School said: "It has been good to come out of school and plant. We will be able to look out of the classroom window and see the flowers when they grow". Joshua, also from St Margaret Mary School, thought the event "has been really good. I really enjoyed it, even though it started to rain".

The seeds are now starting to grow so hopefully we should see a good display of colour very soon.

WHAT WE HAVE ACHIEVED OVER THE PAST YEAR

The past year has been an exciting and eventful one here in Perry Common. Here are some highlights:



Housing & Landlord Services

- Building has started on 20 new WLCA homes and 39 homes for Birmingham City Council.



Health & Wellbeing

- Perry Common Community Hall hosts events and activities throughout the week, including: Aikido, Boxercise, Creative Moments (craft group), Healthy Walks, Kickboxing, Pilates, Slimming World, Zumba and much more.



Green Spaces & Environmental Sustainability

- A colourful trail of planters from The Ring to Witton Lakes has been created.
- WLCA has acquired Witton Lakes Cottage and the Community Orchard from Birmingham City Council. There are exciting plans for this to be an environment and enterprise centre.



Perry Common Community Hall

- Has attracted over 7000 visits from local residents over the past year.
- Hosts a wide range of clubs and activities throughout the week (as listed on the back page of the newsletter).



Employment, Skills & Enterprise

- Erdington Works has provided training for 34 local young people and created 20 paid work placements, leading to 18 jobs.
- Established the Jobs Club at Perry Common Community Hall providing employment advice, CV updates, job search and much more.
- Set-up the Handyperson service for Perry Common residents with money from our Small Grants. He can be contacted on 07956 525 940.



Community Life

- £435 was raised at MacMillan Coffee Morning with St Martin's Church and the Perry Tree Centre.
- Has hosted another very popular Christmas Lights Switch-On with our partners around The Ring.
- Made 10 grants (of up to £500) to individuals/groups that benefit the residents of Perry Common.

Thank you for raising over £300 at Spring into Spring

Hundreds of people of all ages came out in the sunshine on Saturday 3rd May for the Spring Into Spring festival at The Ring - with an impressive £310.19p raised for John Taylor Hospice.

There were loads of attractions displays and stalls, including a bouncy castle, giant mega slide and gladiator duel.

Chloe Pearsall, age 12, said that the event "has been really fun. I have enjoyed the very artistic face painting" while Tristan Cunningham, age 6, said "I super enjoyed the day. I went on the mega slide and the bouncy castle – it was great fun".

The event was organised in partnership between local businesses, WLCA, The Net Church, St Martin's Church and the Urban Devotion (youth group).

Thank you to everyone who helped organise the event, everyone who came along and everyone who donated money to John Taylor Hospice.



BECOME A RESIDENT DIRECTOR AND MAKE A DIFFERENCE TO YOUR AREA

Perry Common is a fantastic neighbourhood. If you care about what goes on locally and have opinions and suggestions for further improving the local area – then why not consider becoming a 'Resident Director' with WLCA.

You could make your ideas a reality and at the same time learn new skills, meet new people and have a really positive impact on your local community.

For more information please contact Afzal Hussain on 0121 382 1930 or Afzal.Hussain@wittonlodge.org.uk.



WHATS ON THIS SUMMER

WHATS ON AT PERRY COMMON COMMUNITY HALL AND AROUND

There are lots of activities and clubs taking place at Perry Common Community Hall throughout the week and many local events coming up throughout the summer.



Monday

PAIN CLINIC

9:30 - 11:30AM

Please attend via GP referral only

HEALTHY WALKS

11:00AM - 12:00 MIDDAY

FREE and everyone welcome

ARTS & CRAFTS 'CREATIVE MOMENTS'

1st and 3rd Monday of each month

11:45AM - 2:15PM

£2.00 per person for non members / £1.00 for members

CUPPA & CHAT

2nd and 4th Monday of each month

11:45AM - 2:15PM

£2.00 per person for non members / £1.00 for members

PILATES

5:15 - 6:15PM

Please attend via GP referral only

Tuesday

JOB SHOP

10:00AM - 1:00PM

FREE Job skills, CV advice, Job Searches and much more
- No appointment needed

KICK BOXING

6:00 - 7:00PM

Under age 16 - £4.00 per person per session

KICK BOXING

7:00 - 8:00PM

Over age 16 - £5.00 per person per session

BOXERCISE

8:00 - 9:00PM

£4.00 per person per session

RING OF SOUND CHOIR

7:00 - 8:00PM at Sycamore Court, 46 Buxton Road, B23 5GA

£1.00 per person per session - under 16 years olds FREE

Summer activities

PERRY FUN

Summer holiday fun for all the family, with creative arts, dance, play, sports, family yoga and more.

Every Wednesday throughout summer:

- 23rd July

- 30th July

- 6th August

- 13th August

11:00AM - 1:00PM

£1.00 PER CHILD (UNDER 12 YEARS ONLY) - FREE FOR ADULTS

Refreshments, snacks and fruit are included

At Perry Common Community Hall, 87 Witton Lodge Road, Perry Common, B23 5JD.

TEDDY BEARS PICNIC

SATURDAY 19TH JULY - 12:00-4:00PM

If you go down to the Ring on the 19th July, you're sure to be entertained. With stalls, arts, bouncy castle, face painting, storytelling, refreshments and much more, there's something for everyone. There's free jelly and ice cream for the first 200 children.

FREE FOR UNDER 16s WITH A TEDDY BEAR

- ADULTS 50P - UNDER 16s WITHOUT A TEDDYBEAR 25P

PERRY COMMON BAKE OFF

SATURDAY 6TH SEPTEMBER - 12:00 - 3:00PM
PERRY COMMON COMMUNITY HALL

If you like tea and cakes this is the event for you. To raise money for John Taylor Hospice, WLCA and the Challenge Network (who help create opportunities and skills for young people), will be hosting a tea party, with lots of mouth-watering cakes and refreshments. There will also be a bake-off competition. If you feel confident, you can enter your cake to be judged and be crowned the 'best baker in Perry Common'. All proceeds will go to John Taylor Hospice.

GRAND OPENING OF ENDERBY PARK

SATURDAY 20TH SEPTEMBER
11AM-3PM IN THE PARK

To celebrate the formal opening of Enderby Park a FREE event will be taking place. There will be:

- Demonstrations on how to use the new outdoor gym equipment and exercise demonstrations
- Forest Schools will be providing healthy food
- Arts Project by The Net
- Urban Devotion Youth Group
- Creative Moments will be exhibiting their WW1 Knitted Poppies display and much more.

For more information, or to get involved, please contact Teresa Compton at Friends Of Perry Common on 079 1332 3645.

DO YOU WANT TO VOLUNTEER

There are loads of volunteering opportunities available. Learn new skills, make new friends and contacts and help your local community. There's everything from helping out at the reception, in the WLCA office, helping with community events, gardening club and lots to get involved with.

Please contact Joyce Wallace on 0121 382 1930 or Joyce.Wallace@wittonlodge.org.uk.

If you're green fingered, why not help out at the Community Orchard at Witton Lakes. For more information call Linda Hines on 079 6038 6252 or email Linda.Hines@wittonlodge.org.uk.

Wednesday

ZUMBA

6:00 - 7:00PM

£4.00 per person per session

AIKIDO

7:30 - 9:30PM

£6.00 per person, per session for persons 18 years and over

Thursday

PAIN CLINIC

9:30 - 1:00PM

Please attend via GP referral only

GARDENING CLUB

1:00 - 2:30PM

Lots of green fingered advice, food to taste and hands-on activities - all completely FREE

SLIMMING WORLD

First session 5:00PM / Second session 7:00PM

£9.95 joining fee - then £4.95 per person per session

Friday

SLIMMING WORLD

10:00AM - 12:00 Midday

£9.95 joining fee - then £4.95 per person per session

Saturday and Sunday

The main hall, meeting room and interview room are available to hire for events, groups and private parties.

Please contact Paul Tse on 0121 382 1930 or Paul.Tse@wittonlodge.org.uk for more information.



COUNCILLOR SURGERIES

Monthly councillor surgeries are held at Perry Common Community Hall with Clr Peter Kane (Labour), Clr Gary Sambrook (Conservative) and Clr Ron Storer (Conservative).

Please contact WLCA for more information.