

Slotted Spring Pins:

A single coil of spring steel with an open slot for easy assembly

Spring Tension Slotted Pins

Slotted spring pins consist of a single coil of spring steel or stainless steel with an open slot sufficiently wide to enable the pin to reduce in diameter as it is driven into a hole of appropriate size.

The ends of the pin have a bevelled chamfer. They are designed for plain drilled holes but a countersink makes assembly easier, especially for the ISO 8752 type.

Slotted pins are normally supplied in the heavy duty form to ISO 8752, but a light duty version can be supplied to ISO 13337.

Increasing Shear Strength Of Spring Pins

It is possible to increase the shear strength of slotted pins by inserting a small diameter pin inside a large one. This should always be done by inserting the larger pin first, then inserting the smaller one, taking care that the slot is between 90° and 180° away from the slot in the larger pin.

Suitable combinations for pins to ISO 8752 standard are:

Outer Pin	Inner Pin
3.5mm	2.0mm
5.0mm	3.0mm
6.0mm	3.5mm
8.0mm	5.0mm
10.0mm	6.0mm
12.0mm	7.0mm

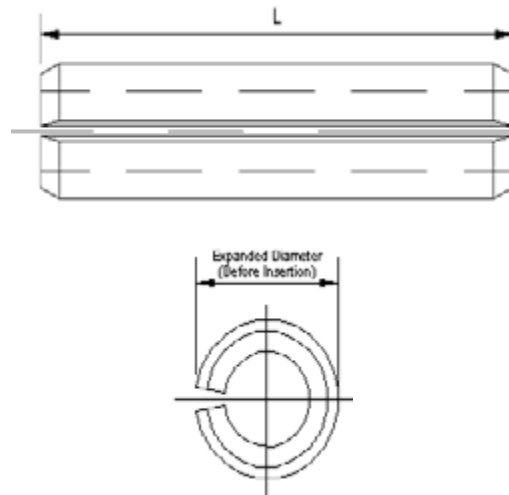

Standards:

- ISO 8752 - Heavy Duty
- DIN 7346 Light Duty
- ISO 13337 Light Duty
- BS7060 - Equivalent To ISO 8752
- DIN 1481 - Equivalent To ISO 8752 But With Plus Only Length Tolerances

Materials:

- Spring Steel CS70 / AISI 1070 / C67
- Stainless Steel A2 AISI 304

[View Slotted Pin Range](#)

[Request A Quote](#)

[Visit Our Website](#)

[Join Our Community](#)

TECHNIFAST

North Folds Road
Oakley Hay Industrial Estate
Corby, Northants, NN18 9AT

+44 (0) 1536 461140
sales@technifast.co.uk
www.technifast.co.uk



Slotted Spring Pins:

A single coil of spring steel with an open slot for easy assembly

Nominal Diameter ISO 8752	1.5mm	2mm	2.5mm	3mm	3.5mm	4mm	5mm	6mm	7mm	8mm	10mm	12mm
Expanded Diameter Min.	1.7mm	2.3mm	2.8mm	3.3mm	3.8mm	4.4mm	5.4mm	6.4mm	7.45mm	8.5mm	10.5mm	12.5mm
Expanded Diameter Max	1.8mm	2.4mm	2.9mm	3.5mm	4.0mm	4.6mm	5.6mm	6.7mm	7.75mm	8.8mm	10.8mm	12.8mm
Hole Size (H12) Min	1.5mm	2.0mm	2.5mm	3.0mm	3.5mm	4.0mm	5.0mm	6.0mm	7.0mm	8.0mm	10.0mm	12.0mm
Hole Size (H12) Max	1.6mm	2.1mm	2.6mm	3.1mm	3.62mm	4.12mm	5.12mm	6.12mm	7.15mm	8.15mm	10.1mm	12.1mm
Material Thickness	0.3mm	0.4mm	0.5mm	0.6mm	0.7mm	0.8mm	1.0mm	1.2mm	1.2mm	1.5mm	2.0mm	2.5mm
Minimum Double Shear Strengths Tested To ISO 8749 kN												
Carbon Steel	1.58mm	2.82mm	4.38mm	6.32mm	9.06mm	11.2mm	17.5mm	26.0mm	30.0mm	42.7mm	70.1mm	104mm
Stainless Steel	0.98mm	1.81mm	2.84mm	4.07mm	5.80mm	7.25mm	10.7mm	16.1mm		26.4mm	42.1mm	
Lengths In mm												
4mm												
5mm												
6mm												
8mm												
10mm												
12mm												
14mm												
16mm												
18mm												
20mm												
22mm												
24mm												
26mm												
28mm												
30mm												
35mm												
40mm												
45mm												
50mm												
55mm												
60mm												
65mm												
75mm												
80mm												
85mm												
90mm												
95mm												
100mm												
120mm												
130mm												
140mm												
150mm												
160mm												
180mm												
200mm												

Please note: Our standard lengths are shown as in the table above, however we can also supply lengths of 1mm, 14mm, 16mm and 20mm upon request as a special order. Please be aware that longer lead times are applicable to special lengths. Talk to our team to find out more.