

KS/KSE 103 Multipole Cable Mounted Receptacles

All dimensions see note 1)

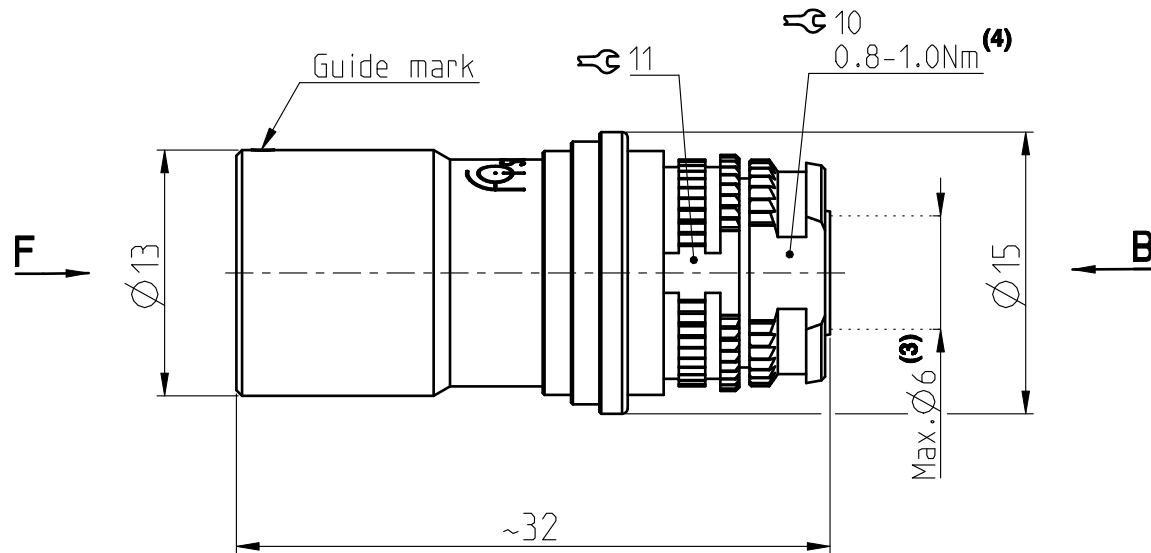

Contact polarity A

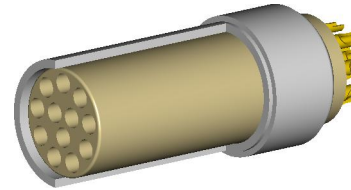

Contact polarity Z

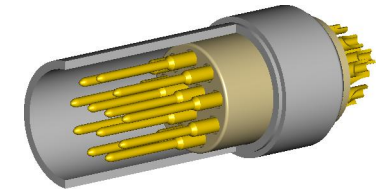

CONTACT CONFIGURATION	Contacts	Solder cup \varnothing	Crimp cup \varnothing ⁽²⁾
103 A Z 051	2	1.18	1.18
103 A Z 052	3	1.18	-
103 A Z 053	4	0.79	-
103 A Z 054	5	0.79	0.80

Contact configuration for polarity A (View from B)

051

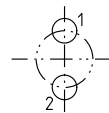

052

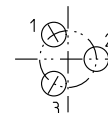

053

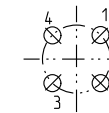

054

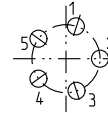

Keying codes (View from F)

Code 1 (-1xx)

Code 2 (-2xx)

Code 3 (-3xx)

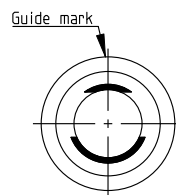
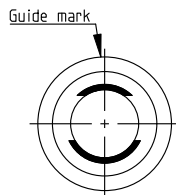
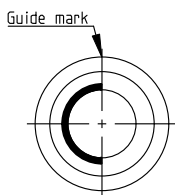

Contact configuration for polarity Z (View from B)

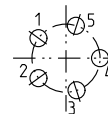
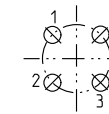
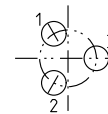
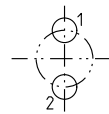

All dimensions in mm

600520

Rev.

2

Pages

1/2

Notes :

- 1) All tolerances resulting from connector assembly are typically ± 0.3 mm
 - 2) For optimum crimping refer to available crimping manual.
 - 3) Max cable diameter below shield
- Part number example : KSE 103 A062-130

4) This torque is a recommended value that may be influenced by the characteristics of the cable. Tests have to be made to evaluate the exact value. To secure the back nut, we recommend the use of thread locking adhesive.

fischer
CONNECTORS

www.fischerconnectors.com

KS/KSE 103 Multipole Cable Mounted Receptacles

All dimensions see note 1)

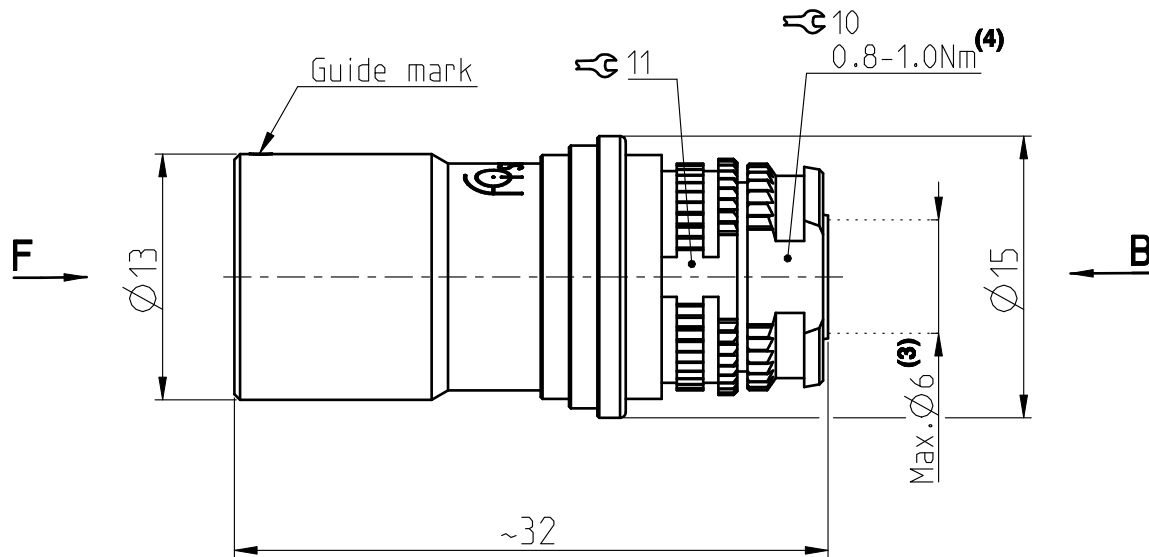

Contact polarity A

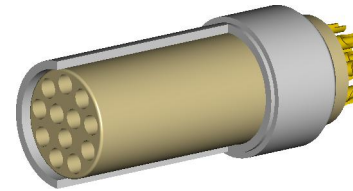

Contact polarity Z

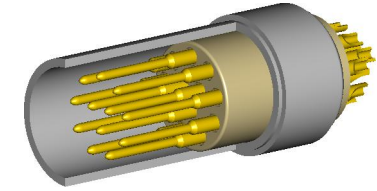

CONTACT CONFIGURATION	Contacts	Solder cup Ø	Crimp cup Ø ⁽²⁾
103 A Z 056	6	0.79	0.60
103 A Z 057	7	0.79	0.60
103 A Z 058	8	0.79	0.60
103 A Z 062	12	0.43	0.43

Contact configuration for polarity A (View from B)

056 (5)

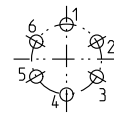

057 (5)

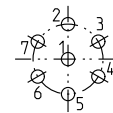

058

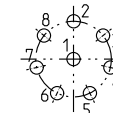

062

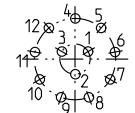

Keying codes (View from F)

Code 1 (-1xx)

Code 2 (-2xx)

Code 3 (-3xx)

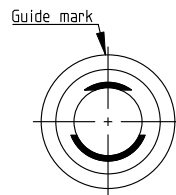
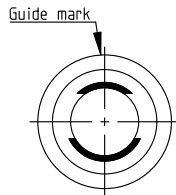
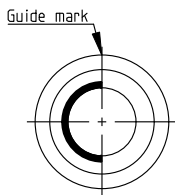

Contact configuration for polarity Z (View from B)

(5)

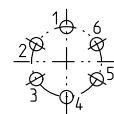

(5)

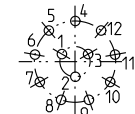
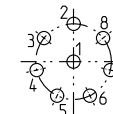
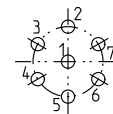

All dimensions in mm

600520

Rev.

2

Pages

2/2

Notes :

- 1) All tolerances resulting from connector assembly are typically $\pm 0.3\text{mm}$
 - 2) For optimum crimping refer to available crimping manual.
 - 3) Max cable diameter below shield
- Part number example : KSE 103 A062-130

4) This torque is a recommended value that may be influenced by the characteristics of the cable.

Tests have to be made to evaluate the exact value.

To secure the back nut, we recommend the use of thread locking adhesive.

5) Only valid for Code1. For other codes please contact us.

fischer
CONNECTORS

www.fischerconnectors.com