



MARIE

WWW.VITTERS.COM

VITTERS

S H I P Y A R D



 *Marie.*



OWNERS' VISION

Owners who are considering building a yacht visit a shipyard with a vision. This vision is based on the freedom to create and, ultimately, the freedom of sailing.



VITERS SHIPYARD, CREATIVE MINDS AND SKILFUL HANDS

Over the past 20 years, Vitters Shipyard has grown to be one of the world's leading builders of custom sailing yachts of 30 metres (100 ft) and above. Led by managing directors Jan Vitters and Louis Hamming, this Dutch yard realises what clients envision. Creative minds and skilful hands create yachts of superior quality, in time and on budget.





MARIE

SY Marie is a fantastic example of a modern classic. The graceful lines of the early twentieth century yachts are combined with a modern underwater body and a carbon ketch rig. This remarkable combination of elements results in a magnificent yacht offering ultimate comfort as well as the thrill of competitive sailing.



Marie combines classic aesthetics with the highest level of modern technology. Her underbody sports a modern bulb keel, the result of years of tank testing. The result is a very fast hull that sails both light winds as well as difficult conditions exceptionally well, facilitated by a sail area offering a truly impressive power and performance.

The high-module carbon spars with in-boom furling, PBO composite rigging, ultra light interior and forward-thinking hydraulic systems maximise the yacht's efficiency.



LIFE ON DECK

The classical teak deck, gleaming dorades, winches and deck hardware, beautifully clad deckhouses and oval mirrored skylights are the epitome of traditional craftsmanship and create a magnificently warm atmosphere. Carefully located seating areas spread across the deck offer comfortable lounging, dining, partying, socialising, sunbathing and sailing at all times.



Marie's outstanding warmth and hospitality is also translated into the large amidships deckhouse with central cockpit. The sofas surrounding a folding central table are a traditional furnishing concept with great maritime appeal. A permanent bimini shelters the outside area.

At sea the action revolves around the main cockpit, home to two steering positions and a control panel for the winches and main hydraulics. The steering consoles seamlessly combine modern sailing technology with bespoke classic woodwork. A sophisticated Vitters' built hydraulic steering system offers a direct helm feeling, adding even more to the ultimate sailing experience.



Aft of the main deckhouse is the owner's cockpit with its own deckhouse, providing direct access to the master suite. This privacy concept offers a remarkably peaceful and quiet place, even at sea when sailing at full speed with guests on board.



INTERIOR

Marie has a bright, spacious and elegant interior bathed in natural light from her large windows and skylights. This is executed in a light-coloured Anigré wood finishing, a choice of wood rarely seen on yachts. The spacious split-level main salon comprises a large upper deckhouse with bar and comfortable sofa plus a striking lower lounge featuring a Steinway Baby Grand Piano.



A formal dining room is located forward and to starboard of the main salon. This area can be closed off to offer the privacy if desired. The oval table is situated below an artistic mirrored skylight. The luxurious VIP guest stateroom to port also benefits from spectacular views to the stars via the skylight. Two more guest suites are situated aft of the main deckhouse.



The full beam master aft of the mizzen mast features a lounge area, his-and-hers bathrooms with steam shower and bathtub, plus a private office with direct access to the owners' cockpit aft.

Another remarkable onboard feature is the unique collection of antiques. Many of the ornamental arms, paintings and collectables date back to the early eighteenth century and each has a remarkable story to tell. The two cannons situated aft either side of the owners' cockpit, for instance, were used in the Habsburg period.

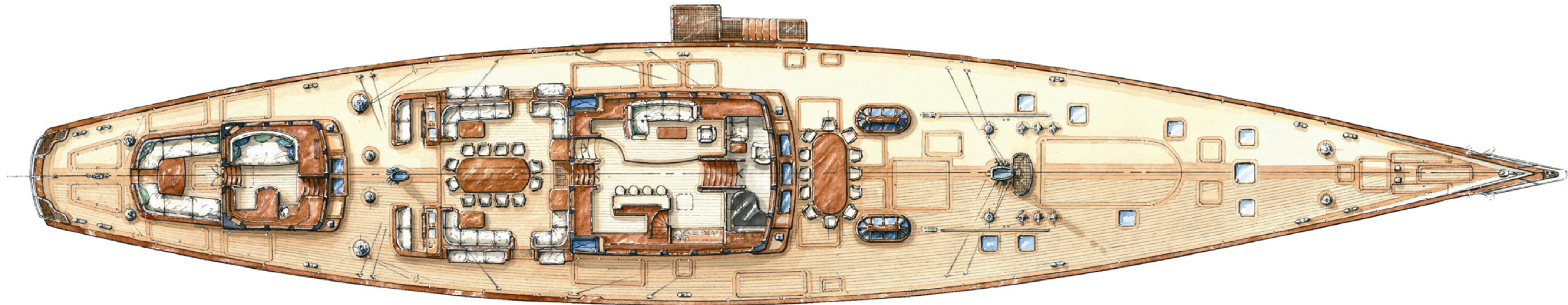

TECHNICAL SPECIFICATIONS

Type	Classic ketch	
Design & Styling	Hoek Design Naval Architects	
Naval Architect	Hoek Design Naval Architects	
Interior Design	David Easton	
Owner's Representative	Marine Construction Management - Nigel Ingram	
Length hull overall	54.6 m	(180 ft)
Length waterline	38.4 m	(126 ft)
Beam (max)	9.5 m	(31 ft)
Draft	4.8 m	(16 ft)

Ballast	77 tonnes
Displacement (half load)	298 tonnes
Hull / Superstructure	Alustar
Exterior paint system	Awl-Grip
Classification	ABS: ⌘ A1 Commercial Yachting Service (sailing yacht) / MCA: LY2
Engine	1 x Caterpillar c32
Power	820 bkW @ 2100 rpm

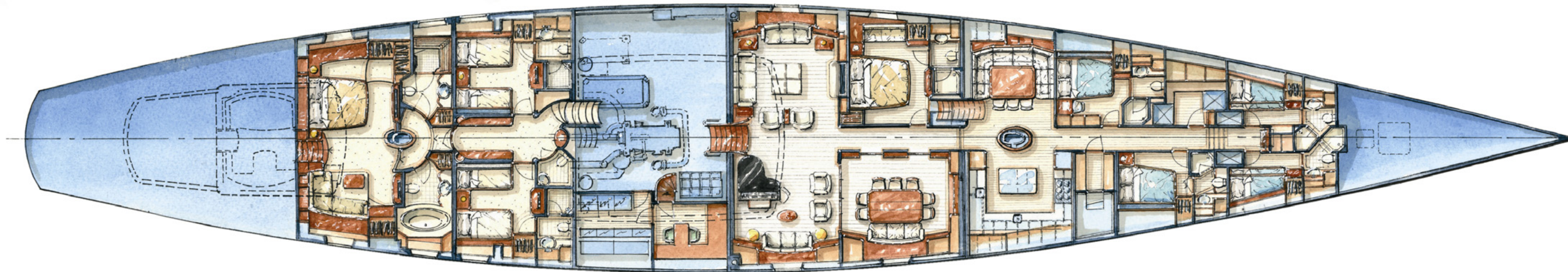

TECHNICAL SPECIFICATIONS

Gearbox	Mekanord 400 HS / LS, ratio 3.04:1
Shaft & propeller	Korsør controllable pitch, 4-blade ø 1300 mm
Bow- & sternthruster	OYS hydraulic 125 hp, swing
Fuel tank capacity	28.100 litres
Water tank capacity	8.722 litres
Generators	Northern Lights, 2 x 67 kW
Spars	Southern Spars
Material	Keel stepped Carbon Fibre Masts, in-boom furling

Main mast

Keel stepped Carbon Fibre

I	: 57.0 m	(187 ft)
P	: 53.5 m	(176 ft)
J	: 17.9 m	(59 ft)
E	: 17.1 m	(56 ft)

Sails

- Main sail	530 m ²
- Mizzen sail	230 m ²
- Yankee	600 m ²
- Staysail	330 m ²
- Gennaker	1610 m ²



SARRISSA.

2011
42.6 m (138 ft)



AGLAIA.

2011
66.0 m (217 ft)



LADY B.

2010
44.7 m (147 ft)



MYSTÈRE.

2006
43.2 m (140 ft)



ADÈLE.

2005
54.6 m (180 ft)



GHOST.

2005
37.2 m (122 ft)



CINDERELLA IV.

2009
39.0 m (128 ft)



ERICA XII.

2009
52.5 m (172 ft)



NIRVANA.

2007
53.5 m (176 ft)



GIMLÄ.

2004
42.9 m (140 ft)



WHIRLAWAY.

2003
42.9 m (140 ft)



RED DRAGON.

2002
42.9 m (140 ft)

CREDITS

Photography

- Thierry Ameller, Nice, France
- Albert Brunsting, Meppel, The Netherlands
- Dana Jenkins, Waitsfield, Vermont, United States of America
- Claire Matches, Puerto Andratx, Mallorca, Spain
- Tom Nitsch Images, Hamburg, Germany
- Rick Tomlinson, Cowes, Isle of Wight, United Kingdom

Concept, design and layout

- Oranja, Meppel, The Netherlands

Printed by

- Scholma Druk, Bedum, The Netherlands

VITTERS
S H I P Y A R D

WWW.VITTERS.COM

Vitters Shipyard B.V. - Stouweg 33 - 8064 PD Zwartsluis - The Netherlands
tel. +31 (0)38 38 67 145 - fax. +31 (0)38 38 68 433 - info@vitters.com