

## What you will find in your Expandastore pack:

### Floor:

1 x Chassis

### Panels:

3 x Wall panels

1 x Door panel

1 x Roof panel

### Fixings:

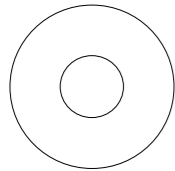

M8 washer:  
2m unit = x 44  
3m unit = x 44  
4m unit = x 48

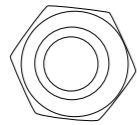

M8 Nut:  
2m unit = x 16  
3m unit = x 16  
4m unit = x 16



M8 x 25mm Bolt:  
2m unit = x 32  
3m unit = x 32  
4m unit = x 36

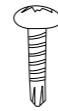

Self-tapping screw:  
x 4



Key sets:  
x 2

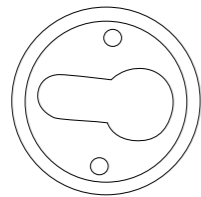

Scutcheon Plate:  
x 4



Door handle:  
x 2

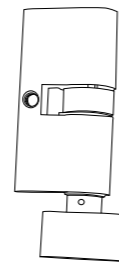

Cylinders:  
x 2

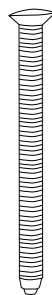

55mm cylinder lock  
screw  
x2

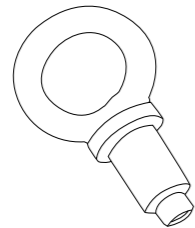

Lifting eyes:  
x4



rubber washers:  
x 4

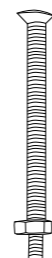

M4 x 50mm Nut &  
Bolt  
x2

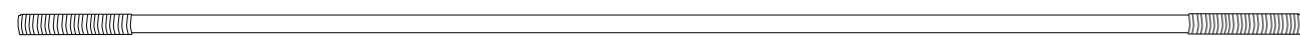

Lifting rods:  
x 4

## The tools that you will need:

A cross-head screwdriver

An 13mm and 19mm socket set

A flat blade screwdriver

2 people

### Notes for assembly:

1. For the best results, assemble the Expandastore on level ground so as to avoid bending of the chassis and complications with the aligning of the panels.

2. On initial assembly, only hand-tighten all nuts and bolts, when assembly is complete tighten all nuts and bolts with your socket spanner.

3. Prior to fitting the door panel, adjust the roller catch on the door to the fully 'in' position before closing (using a standard flat blade screwdriver) on the adjusting screw located on the roller catch. Once the store is fully assembled, the catch can be adjusted back out until the door close with ease.

4. Retain all parts if demounting.

### Notes after assembly:

1. You can expand your Expandastore at any time by purchasing an additional unit and a linking kit, the Expandastore can be linked end to end and side to side.

2. You can return the Expandastore back to it's original flat pack form at any time.

3. Expandastore is not designed to be stacked when it is assembled.

4. You can lift the Expandastore by crane with a load of up to 1,500kg on board.

5. Oil the lock / hinges regularly.

# 1. Unpacking:

a. Exandastore arrives flat-packed.

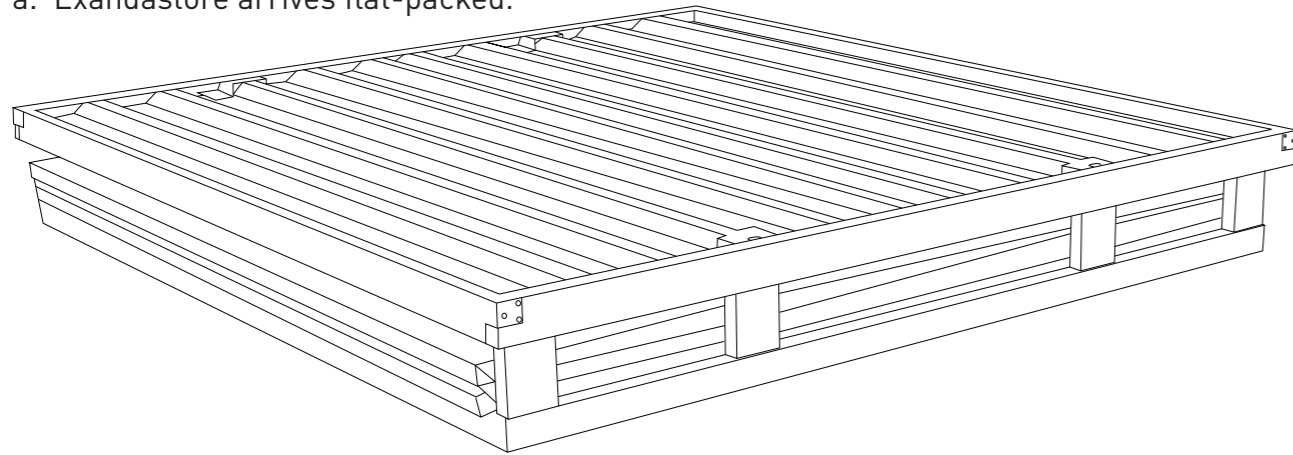

b. Undo and remove the 4 retaining nuts with your 19mm socket spanner (retain these for future use in case you want to return the store to its original flat-pack form).

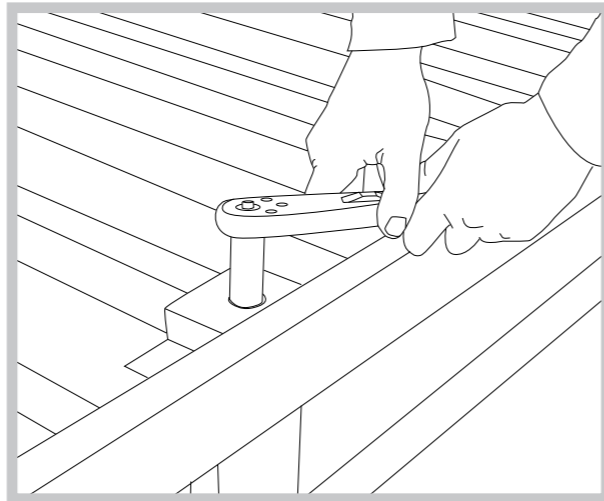

c. Remove the top panel.

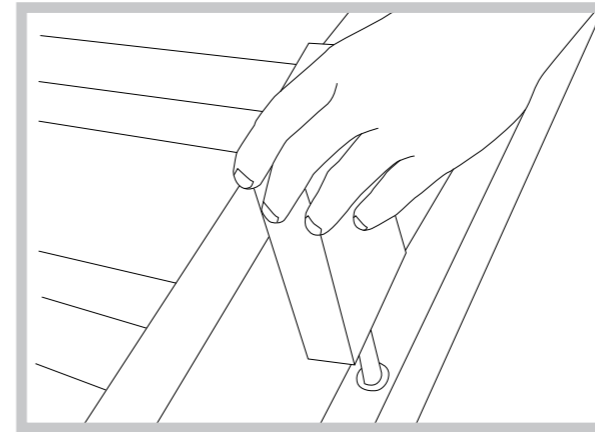
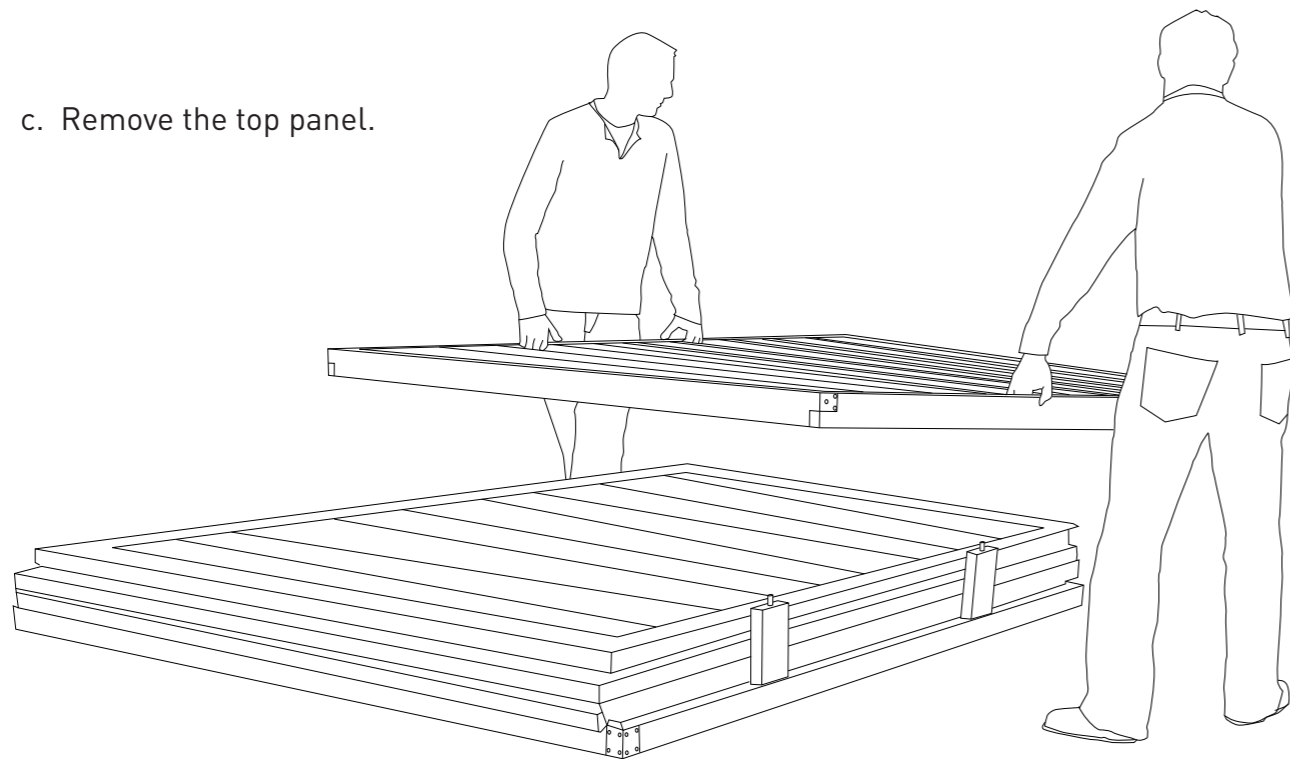

d. Remove the spacer protective blocks (retain these for future use in case you want to return the store to its original flat-pack form).

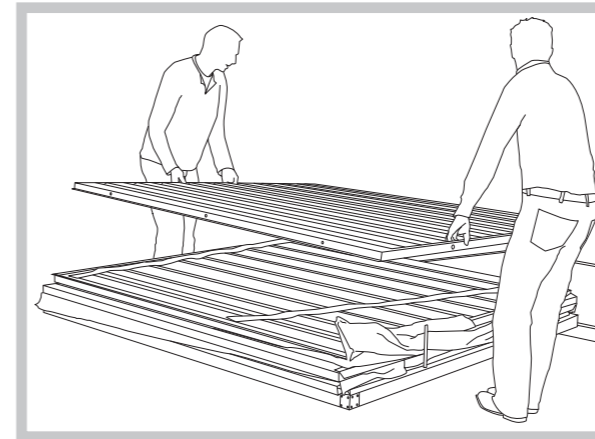

e. Remove all of the panels.

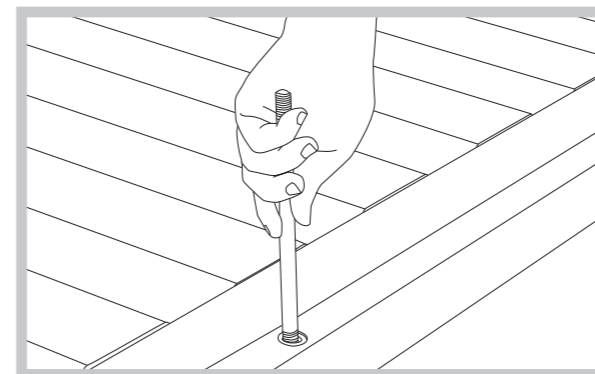
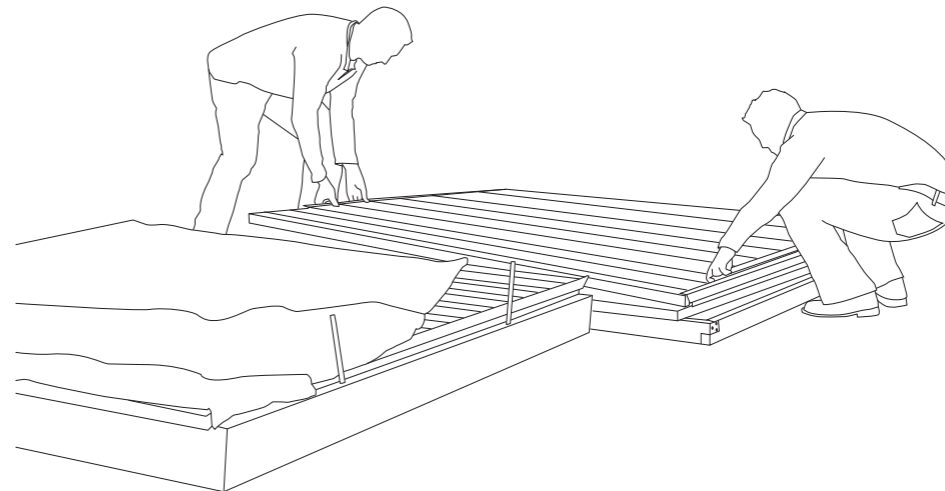

f. Remove the retaining bolts (retain these for future use in case you want to return the store to its original flat-pack form) and the final panel.

## 2. Door Placement

a. Position the chassis on level ground and in its final location (unless you have a crane, forklift or accessory wheels).

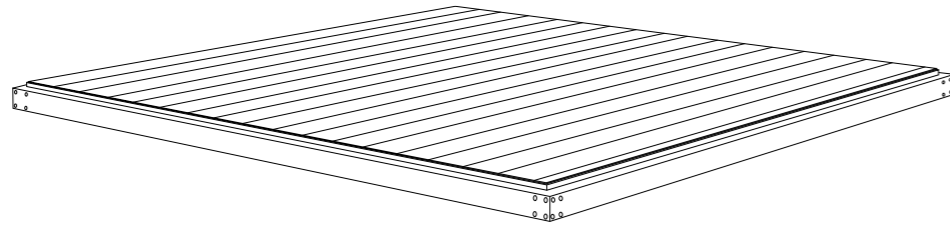

b. Offer up the door panel.

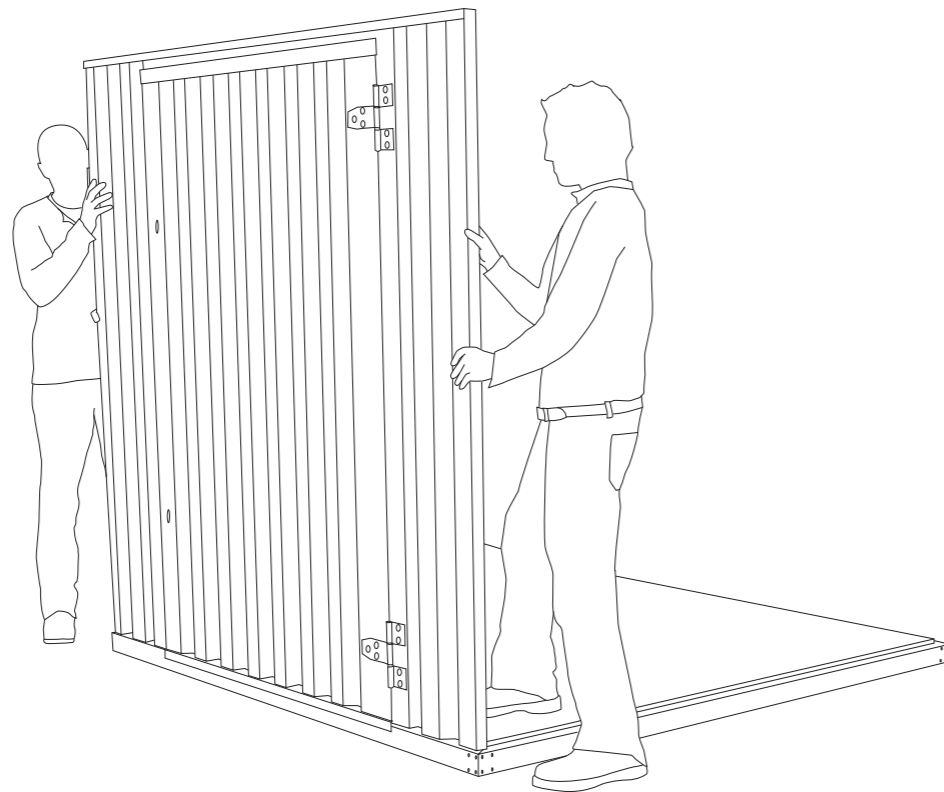

### Panel Positioning Note

When positioning door and wall panels make sure that the overlapped lip edge is at the top and the flat ledge is at the bottom.

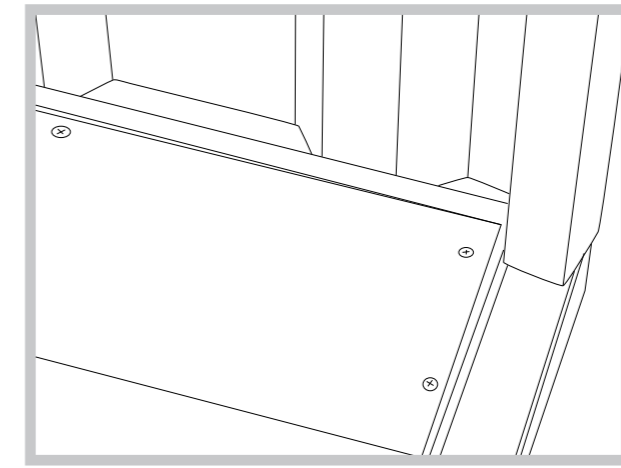
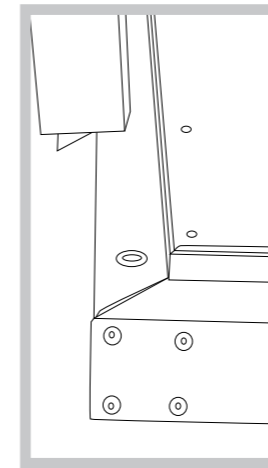
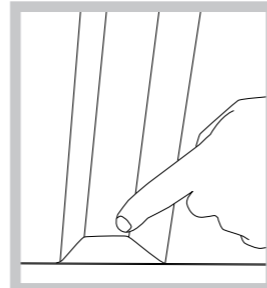
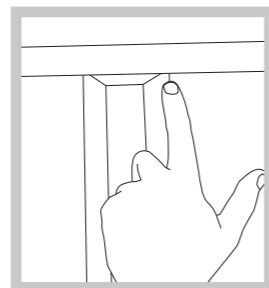

c. Butt the panel up against the chassis edge.

d. Open the door and use it as a natural prop for the door panel.

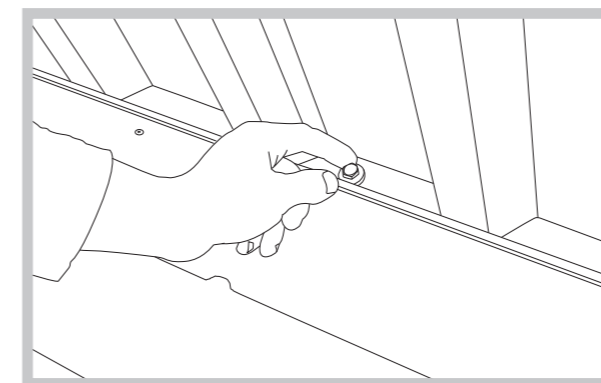

e. Insert the 13mm self-tapping bolts and washers and hand tighten to the chassis.

### 3. Wall Fitting

a. Offer up a wall panel.

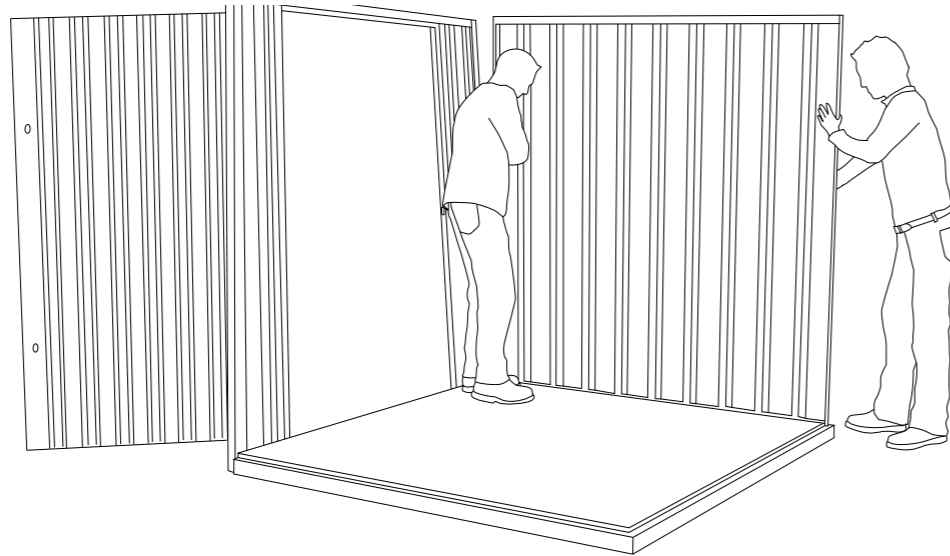

b. The wall panels should inter-lock.

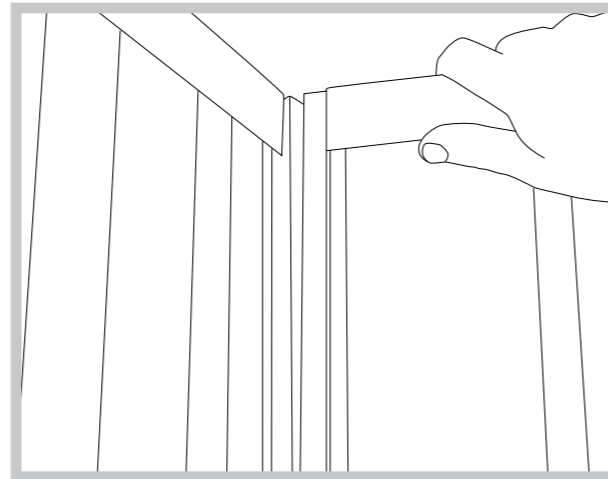

c. Squeeze the panel sides together.

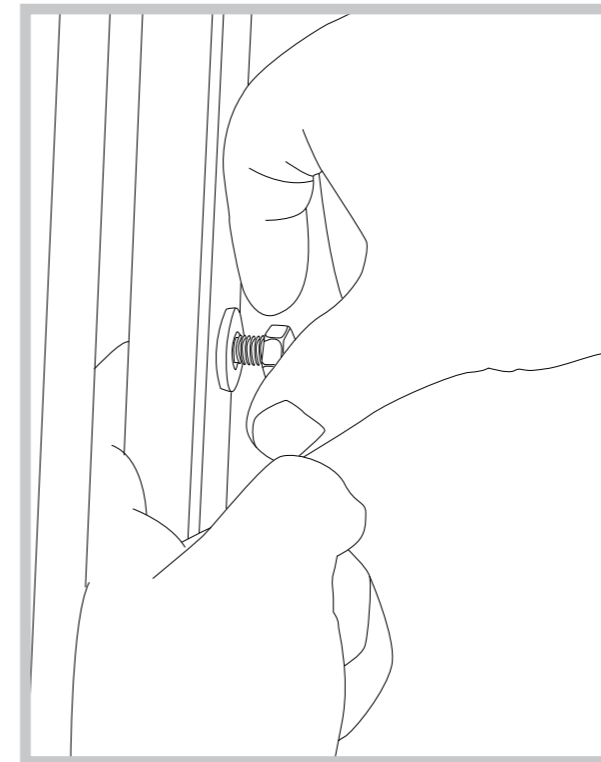
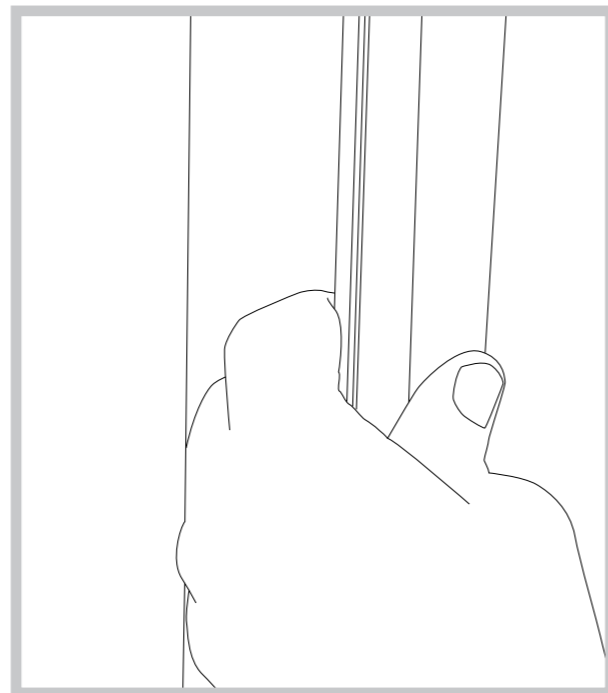

d. Insert the holding nut, bolt and 2 washers and hand tighten.

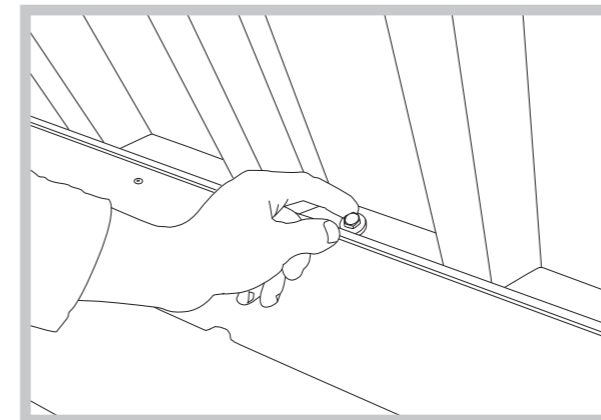

e. Insert the 13mm self-tapping bolts and hand tighten to the chassis.

f. Repeat 'Stage 3' for the 2 remaining wall panels.

### Door Note

Before moving onto stage 4 (roof fitting) you must adjust the self closer door catch. Turn the adjustment screw until the self closer catch is recessed as far as possible.

This is necessary, because if the catch remains unadjusted it can lock into position and is difficult to open if the roof has been fitted.

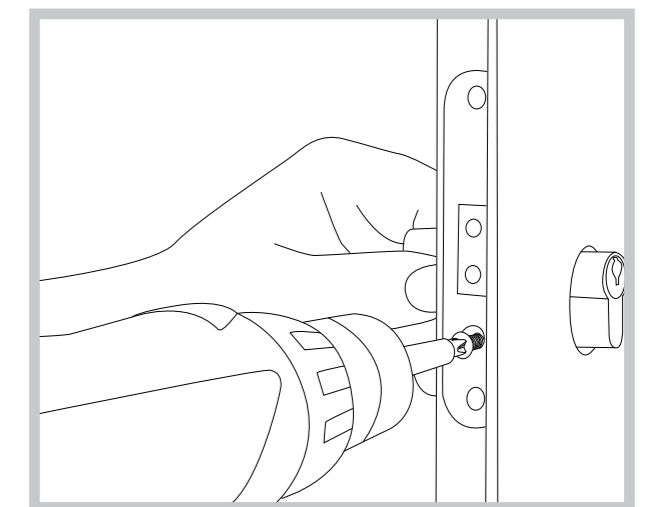

## 4. Roof Fitting

a. Once the walls are in place, lift the roof panel onto the unit.

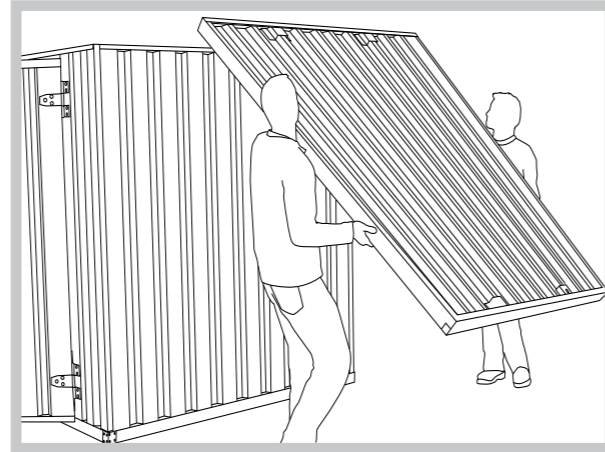

b. Slide the roof panel into position.

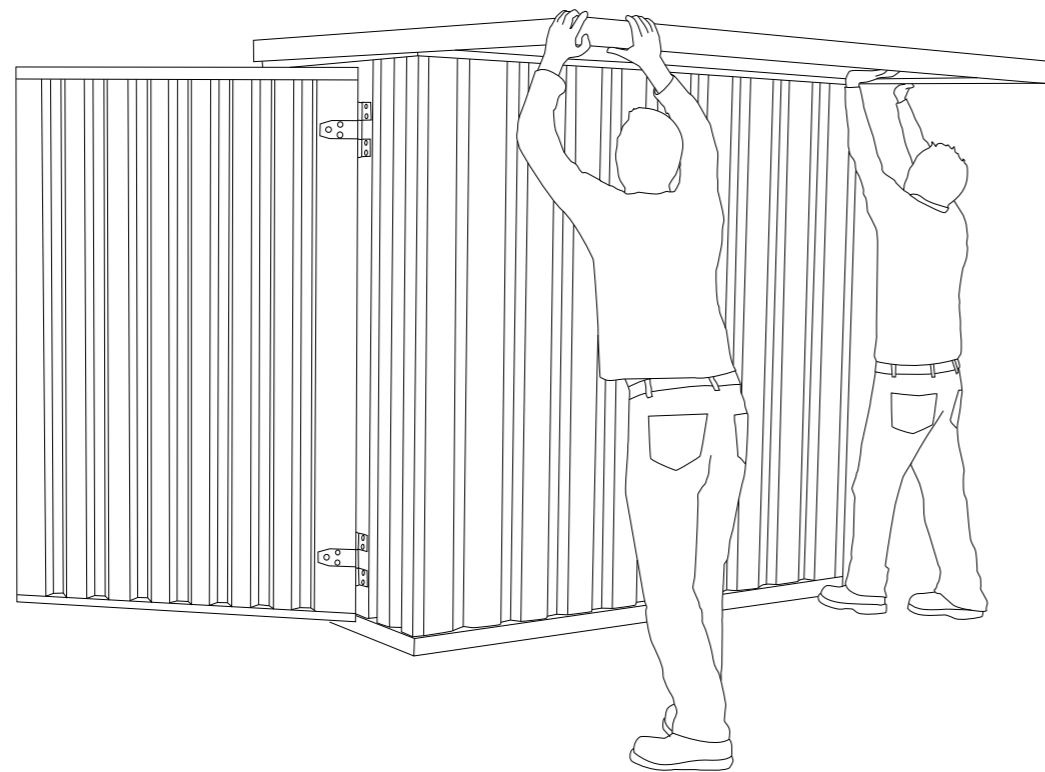

c. Once in position, pull the roof cap so that it locks into position all the way around.

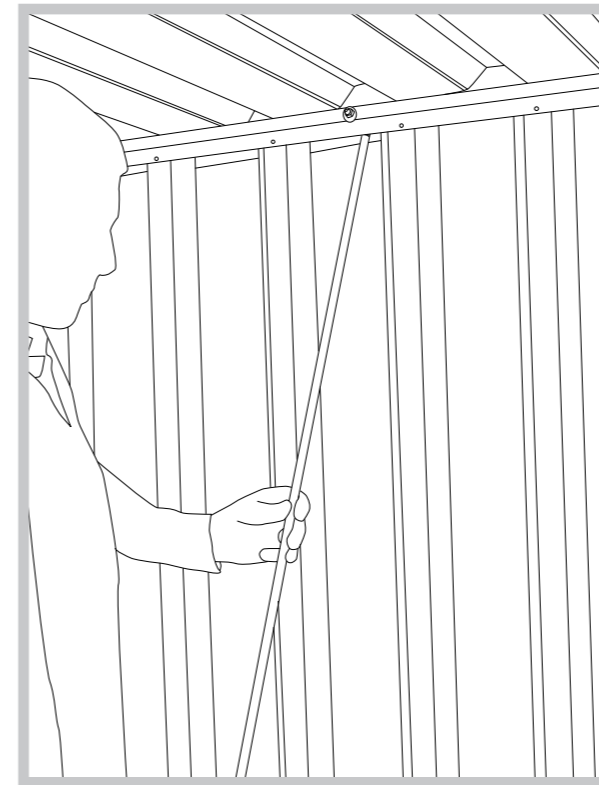
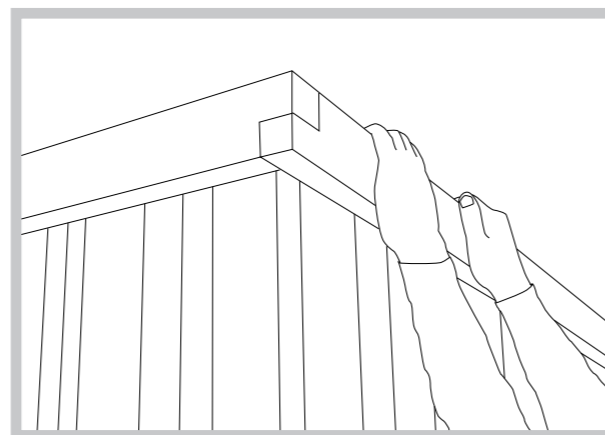

d. Inside insert the 4 lifting rods through the eyelets at the top and into the captive nuts in the chassis.

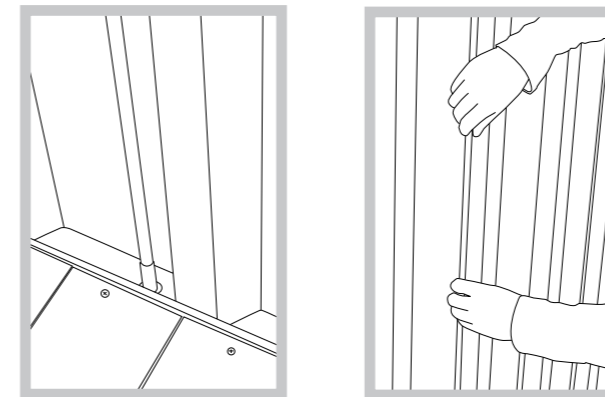

e. Screw the lifting rods into the chassis retaining nuts.

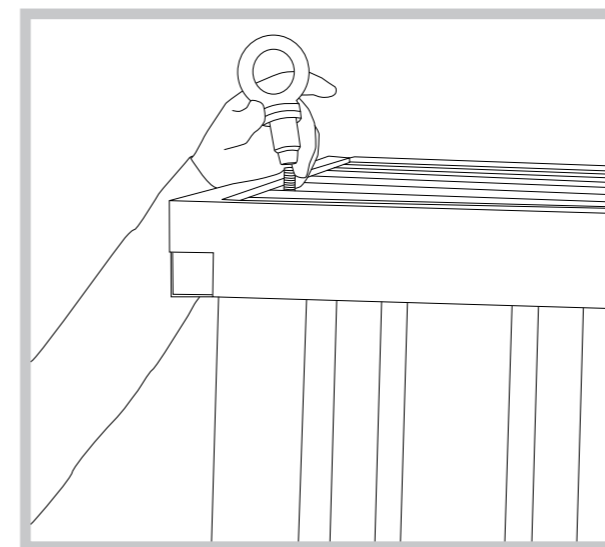

f. Outside attach the lifting eyes (with their rubber washer) to the end of the lifting rods.

## 5. Door Fittings

a. Fit the 2 barrel locks

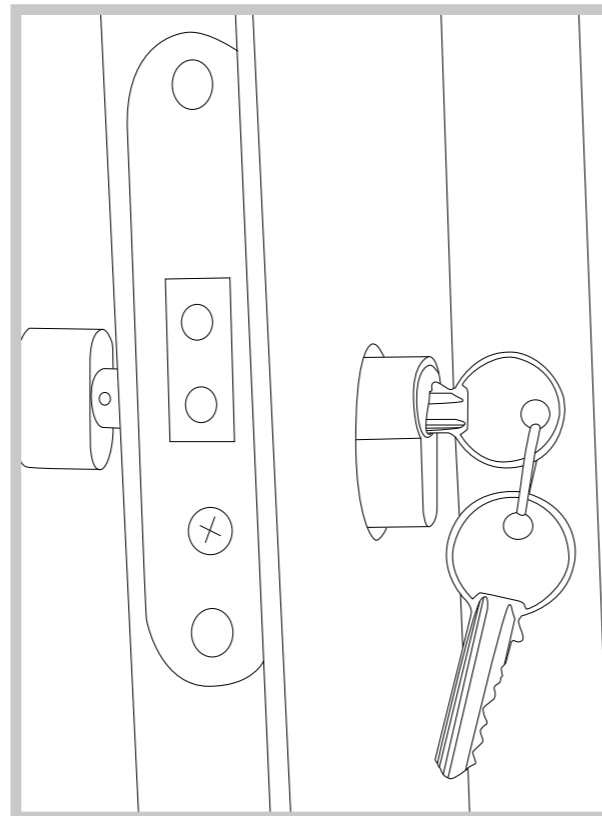
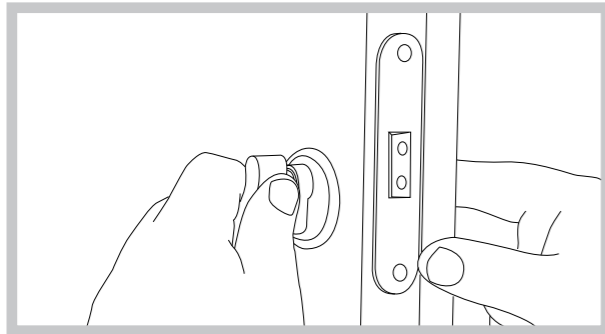
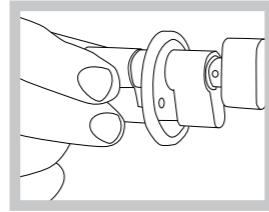

b. Fit the door handle

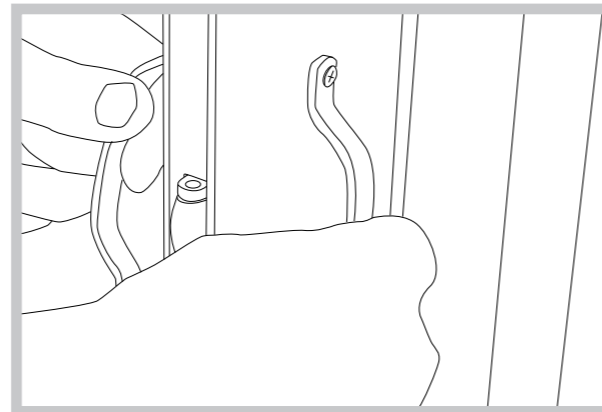

Fully tighten all nuts and bolts

## 6. The Expandastore is now ready for use

Your Expandastore is now ready for use.

We trust it will give you many years of service.

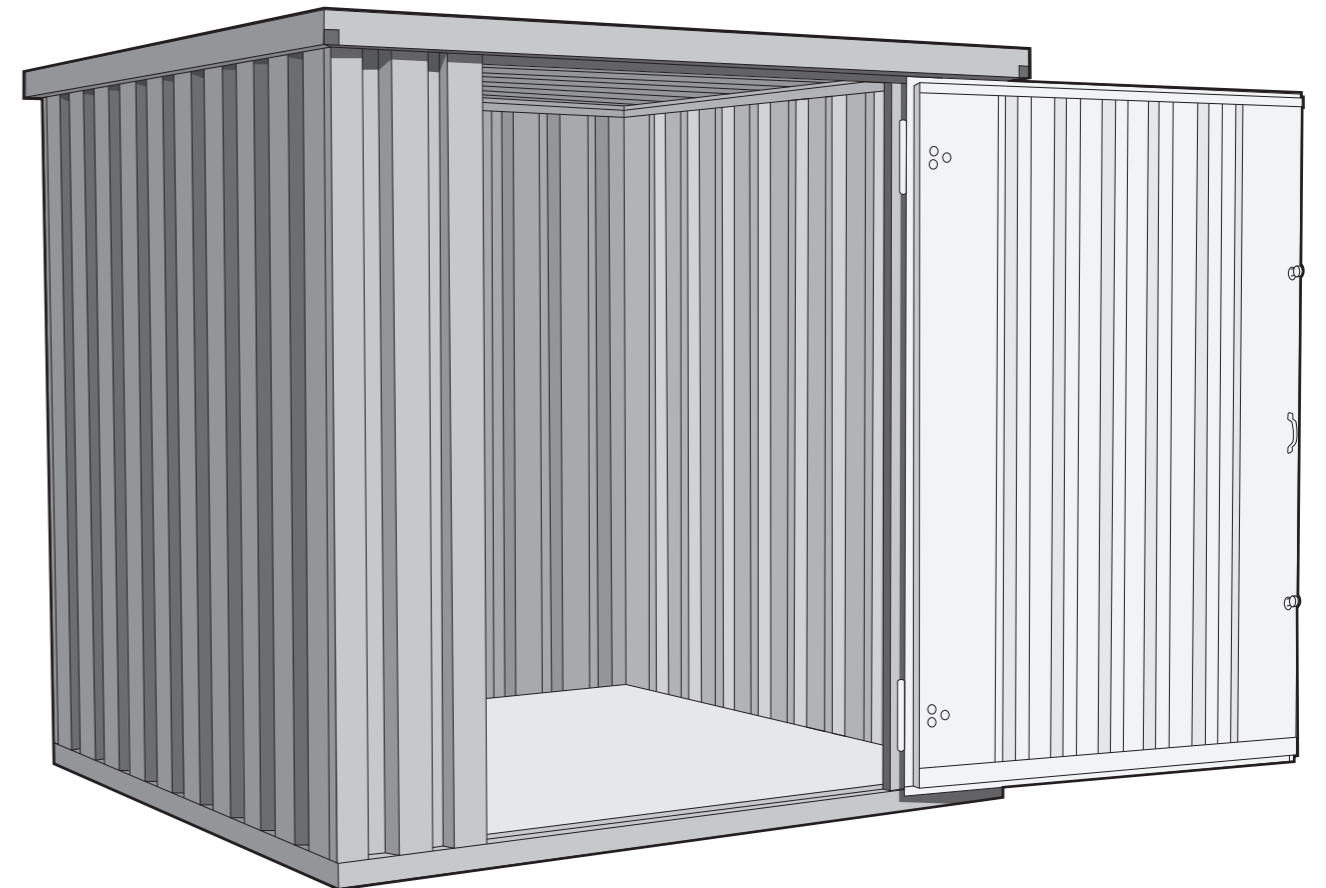

### Accessories

See overleaf for some of the many Expandastore accessories...

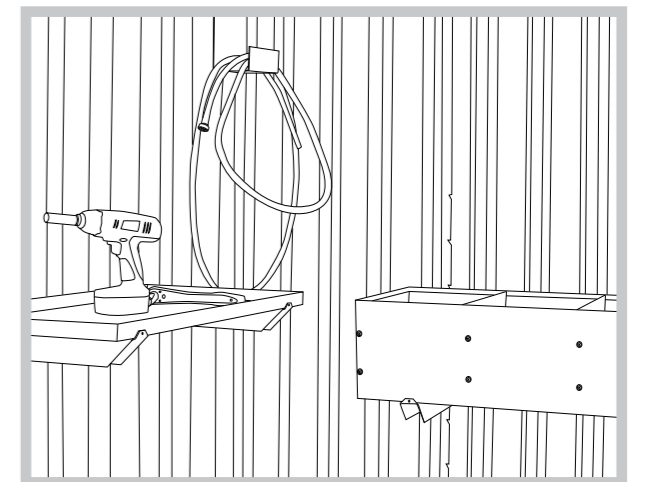

## 7. Accessories

These can be added at any time

### 1. Door Closer

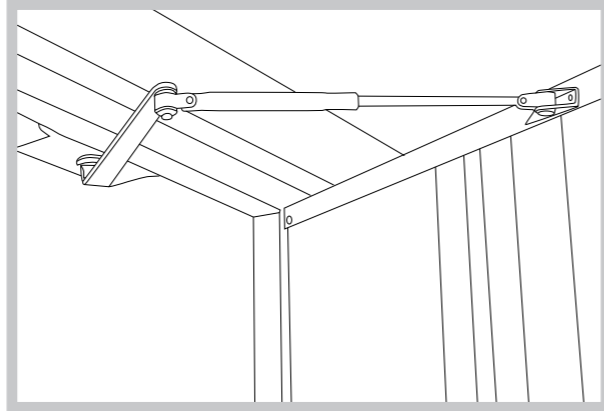

### 2. a. Shelf Arms

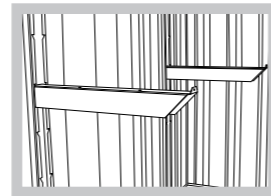
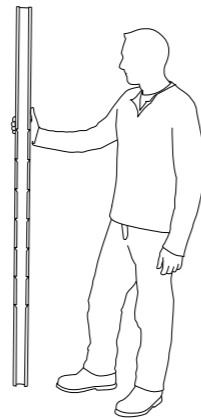

### b. Brackets

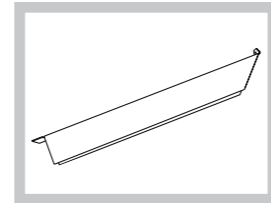

### c. Shelves

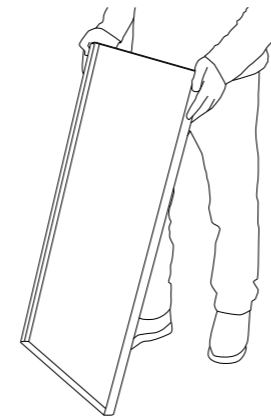

### 3. Wire/hose hook

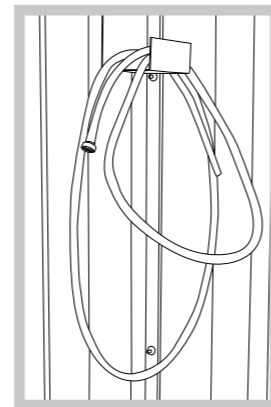
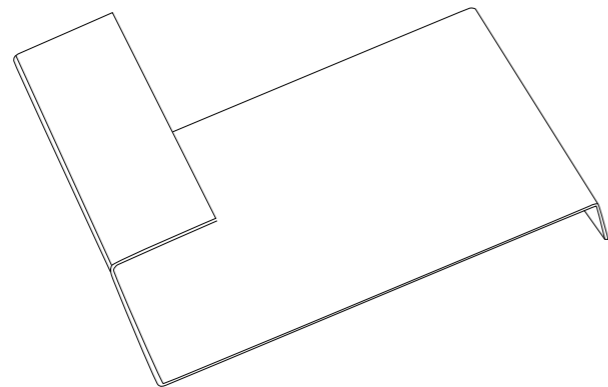

### 4. Tool bin

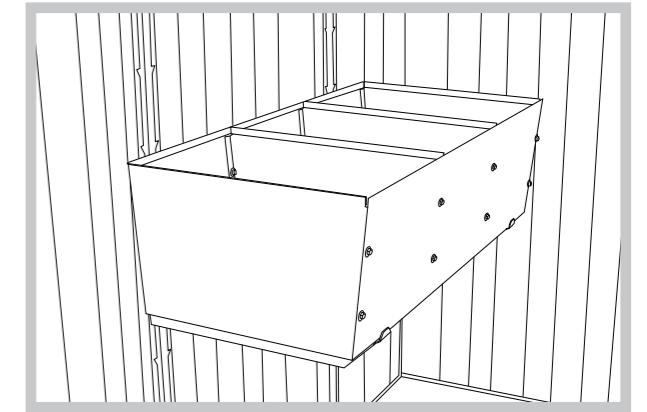

### 5. Ramp

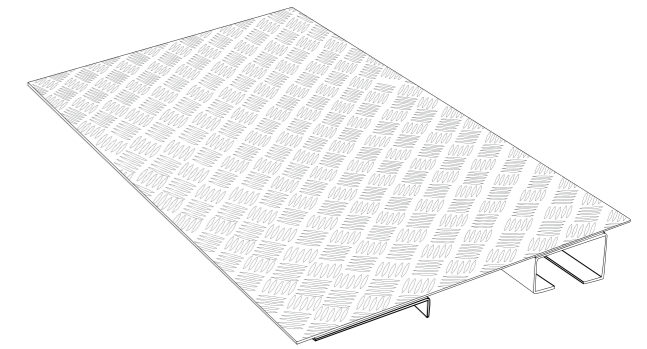

### 6. a. Castors

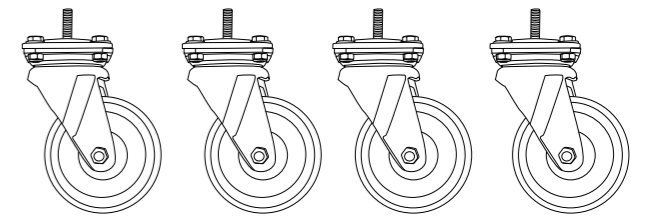

### b. Fork-lift feet

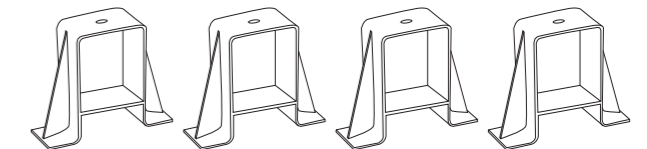

### c. Self-levelling feet

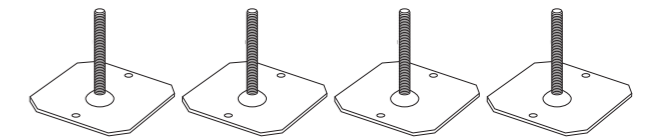

### 7. Linking Kit

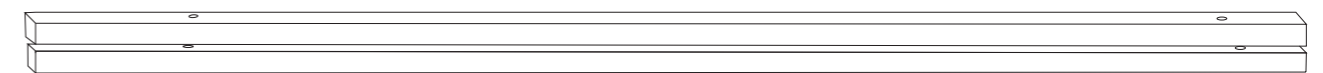

### 8. Touch up spray

We also can provide you with cans of spray paint for touching up powder coated galvanized units