

Electrolux Professional  
Laundry Solutions

**TS4175 WW**  
Professional Laundry  
Equipment for Workwear



*Thinking of you*  
**Electrolux**

## Introducing the new TS4175 WW drying cabinet: Our new high-efficiency cabinet for the fast drying and reliable reproofing of uniforms

The cabinet has been designed specifically for the needs of the fire and rescue services. It is also suitable for heavy duty outdoor apparel constructed of multi-layered textiles that may require a waterproofing maintenance programme.

Drying cabinets can extend the service life of workwear as no mechanical action takes place during the drying process therefore protecting reflective tapes and fastenings. Fast drying times can be critical should a serious emergency incident occur. In some cases, where heavy soiling and infection control is an issue, it is important to ensure the efficient turnaround of the laundry process. The Impregnation cycle restores the water proof layer of the garments providing the best possible protection. Our new drying cabinet TS4175 WW has been designed to offer very quick drying times and reliable reproofing.



### Special new hangers for superb drying results

The four rigid stainless steel airing hangers in the TS4175 WW have been specially designed to promote the flow of air around and through garments, thereby ensuring superb drying results. Warm air is first blown through the hangers to dry the inside of the garments and then diverted to dry the outer layers. The residual heat from the initial heating process is utilised to start drying the outer layers therefore accelerating the drying process resulting in reduced energy consumption. The cabinet can be loaded with just two hangers if required. To save energy the two blanking plates supplied with the cabinet can be fitted in place of the hangers to cover the unused airways.



### Fully insulated

TS4175 WW is an energy-efficient, fully-insulated cabinet that minimises heat loss during the drying process.

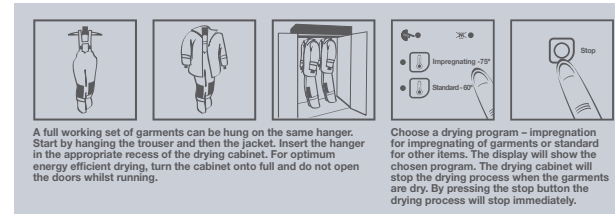

### Easy-to-use control panel

User operation is made easy - the instruction panel uses simple symbols and text to explain how to load and operate the drying cabinet.

### Two automatic drying programs

Choose from two programs with different temperatures:

Impregnation 75° and Standard 60°

Both programs are energy efficient due to the sensor drying feature. The cabinet will run until the garments are dry and then switches off automatically.

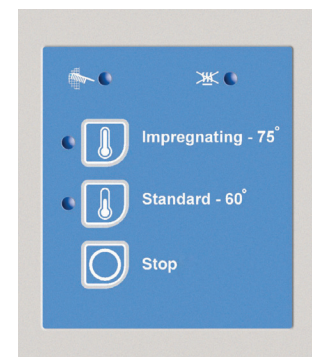

One set of jacket and trousers can be placed on the hanger before loading into the machine. The trousers are suspended by their braces on the hanger and the jacket placed over the top. A maximum of four sets can be processed per drying cycle. Place the hanger into one of the guides in the top of the drying cabinet. For energy-efficient drying, run fully loaded and do not open the cabinet doors until the cabinet has stopped.

Select the required drying program, Impregnation for waterproofing or Standard for the general drying cycle. A light indicates the program selected. The program stops automatically once the garments are dry. To interrupt the program, press the stop button. Opening the door during the cycle will extend the drying time.



Electrolux Laundry Systems  
99 Oakley Road  
Luton  
Bedfordshire  
LU4 9GE

Tel: 08444 631 260  
Fax: 08444 631 268

[www.electrolux.co.uk/laundrysystems](http://www.electrolux.co.uk/laundrysystems)  
[els.info@electrolux.co.uk](mailto:els.info@electrolux.co.uk)