

# EVi-60

## Ei60 Rated Pressure Relief Vent

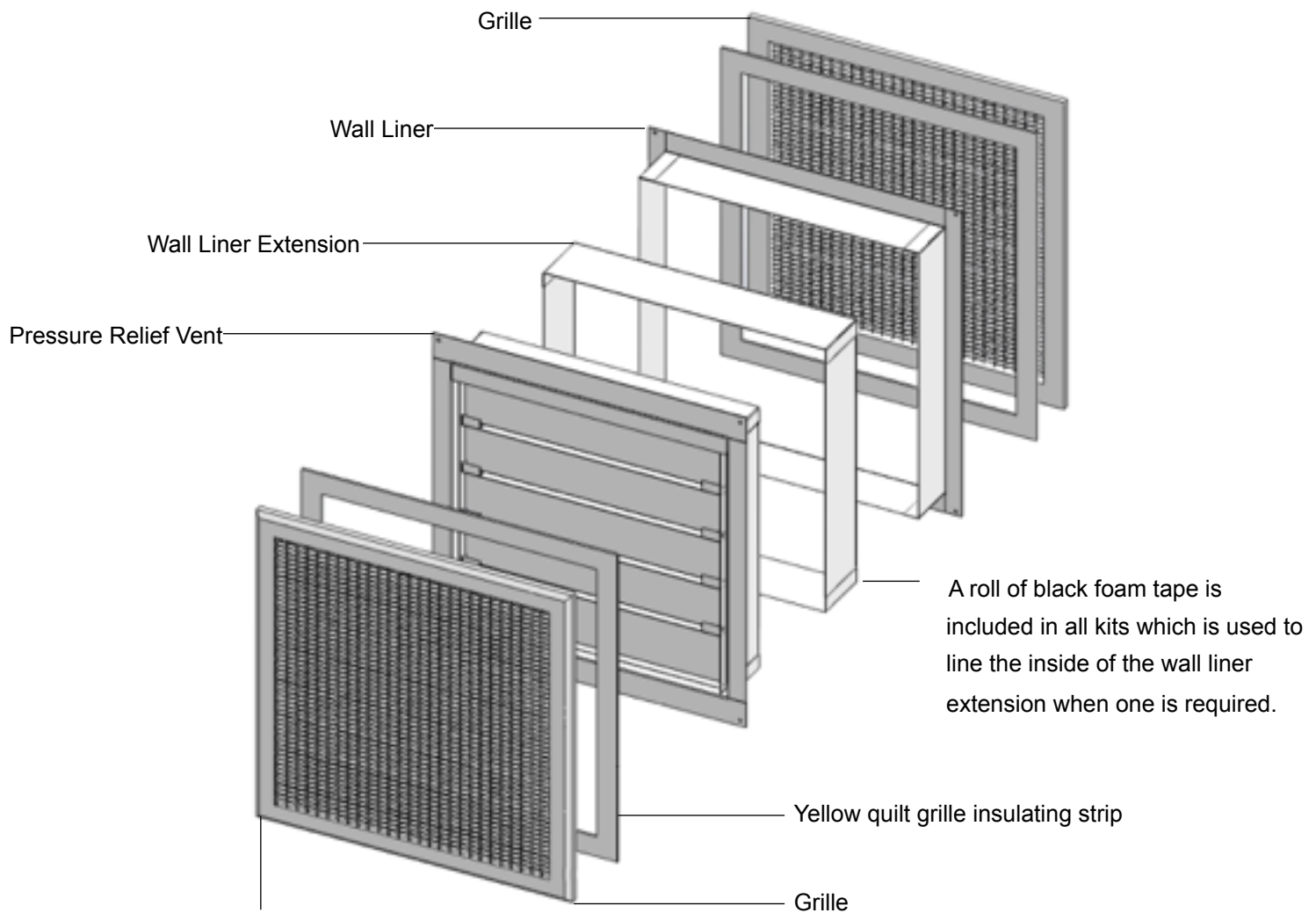

Only 1 grille is included with the (L) kit along with a DWL dynamic weather louvre which is used to replace the second grille. See section 7 & 8

Apply mastic all around the flange.

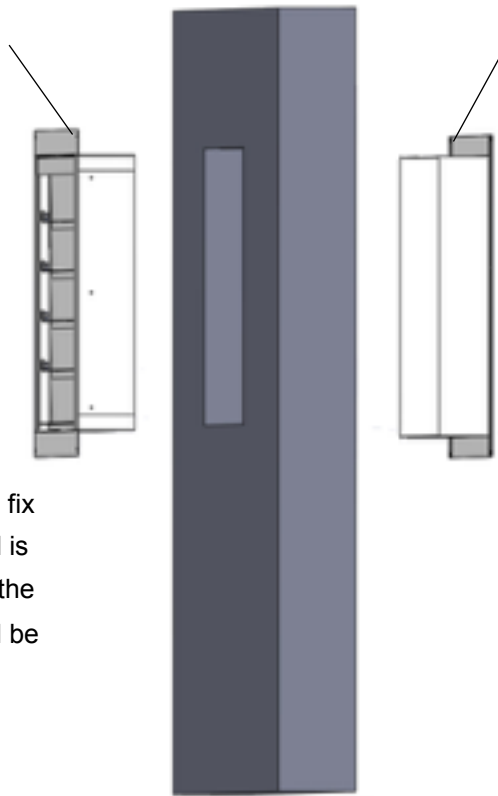

Apply mastic all around the flange.

1. Insert wall liner into wall first and fix into place with 4nr screws.

2. Insert vent into wall and fix with 4nr screws. If the wall is greater than 200mm then the wall liner extension should be used.



3. Fill the gap where the wall liner joins the vent with intumescent mastic.

If using the wall liner extension then all joining gaps should be filled.

4. Stick the yellow quilt grille insulating strips to the back flange of the grille.

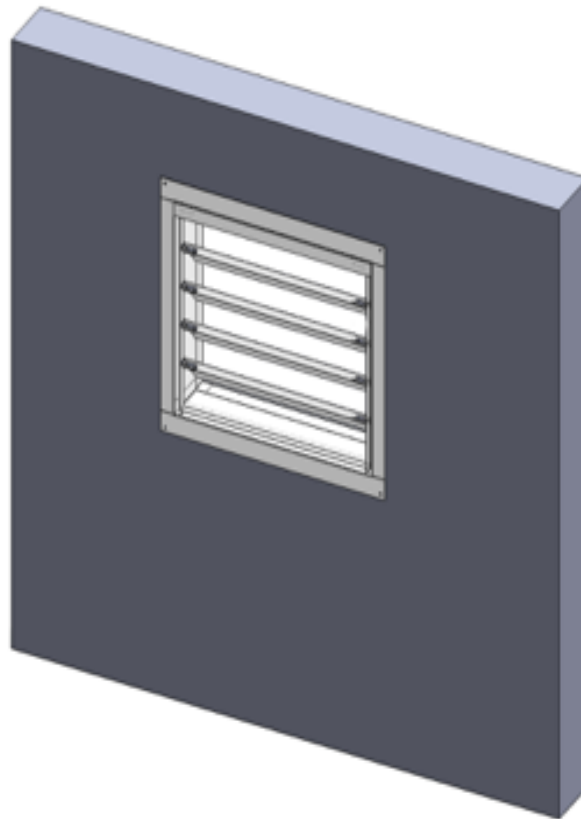
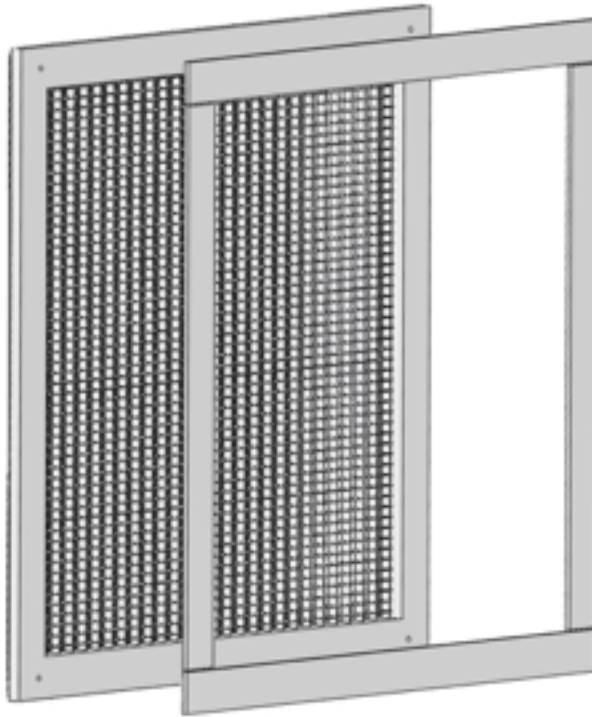

5. Before attaching the grilles make sure that all the blades of the pressure vent open and close fully.

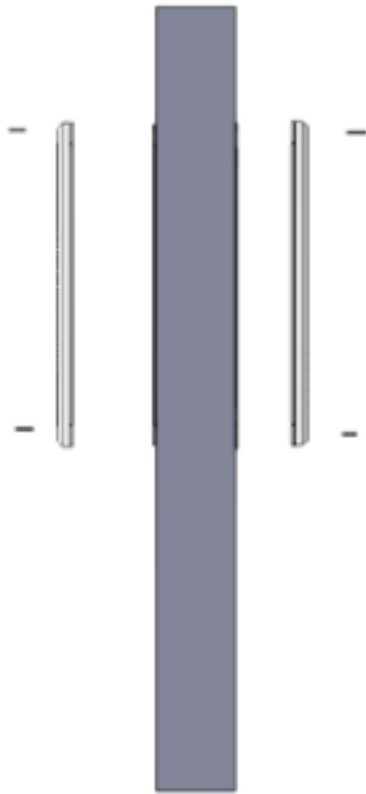

6. Attach grilles using 8nr TEK screws

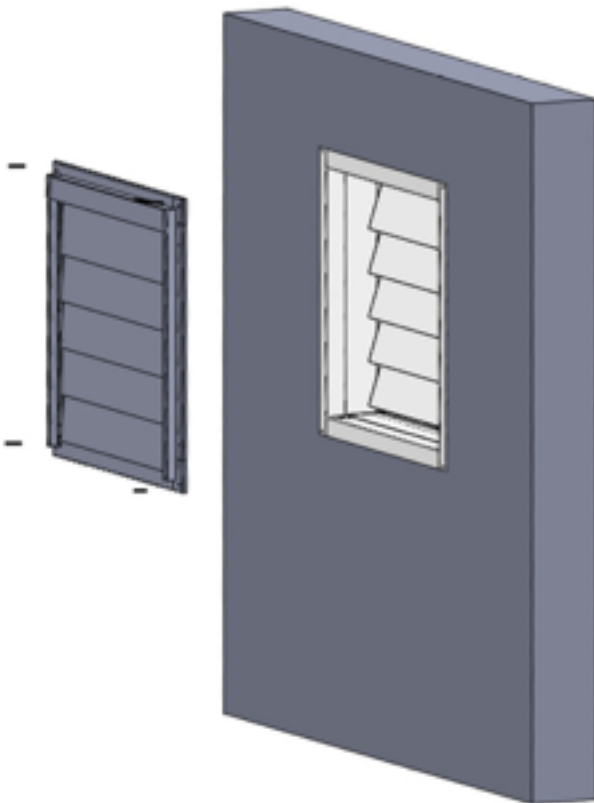
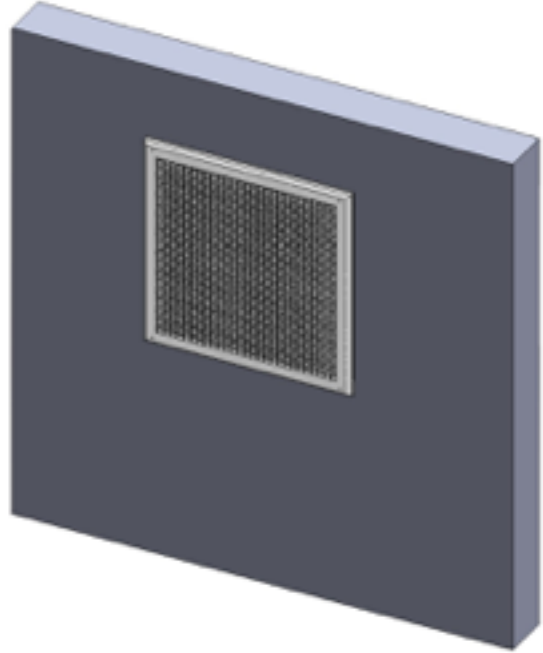

7. If the unit is installed in an outside wall then a DWL should be attached to the outside of the installation using 4nr screws.

8. When installed a bead of silicon mastic should be applied around where the DWL unit touches the wall.

