

GROUND FLOOR PLAN

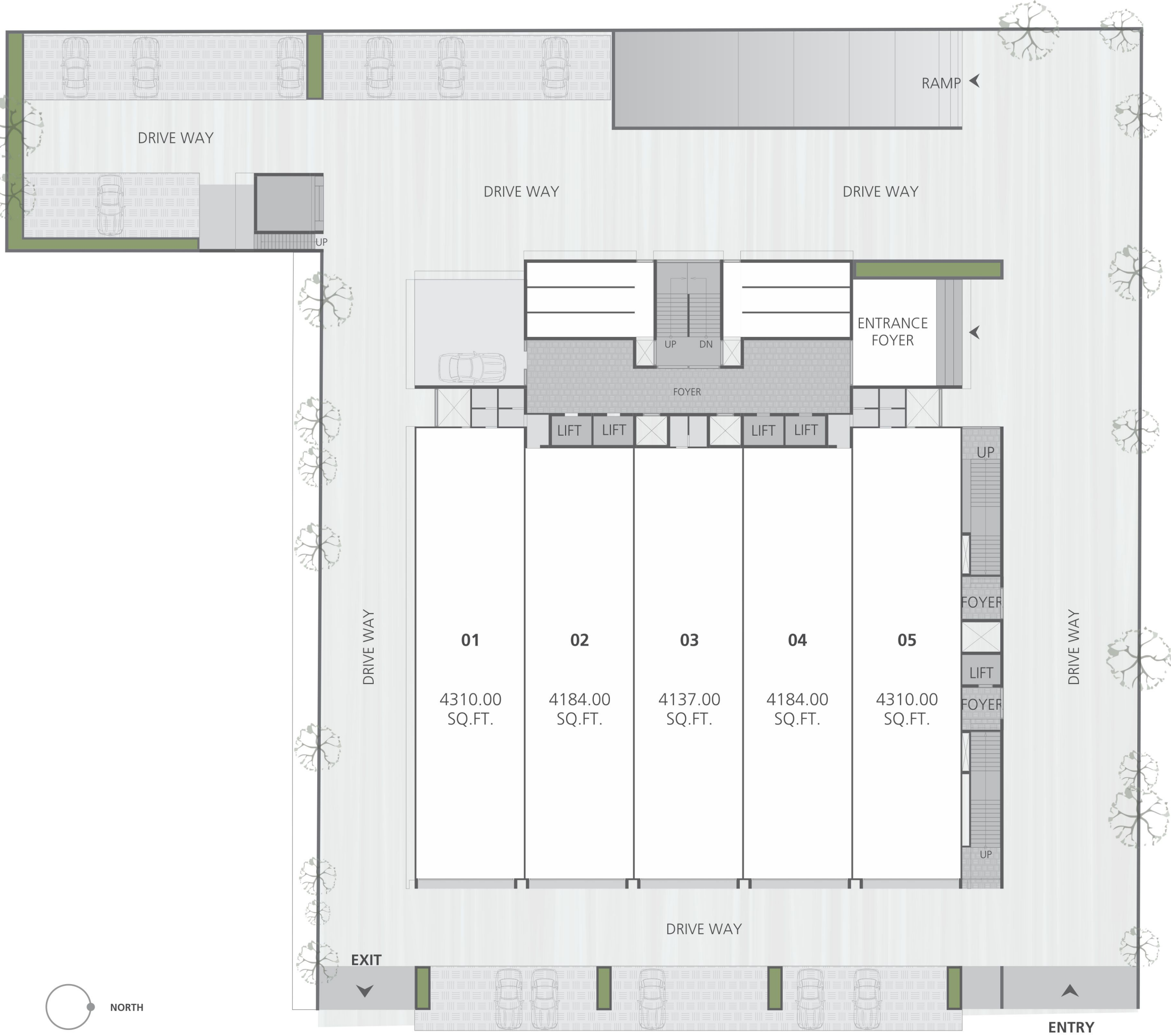

FIRST FLOOR PLAN

(A) SPACE INCLUDED IN AREA OF OFFICE NO.-107

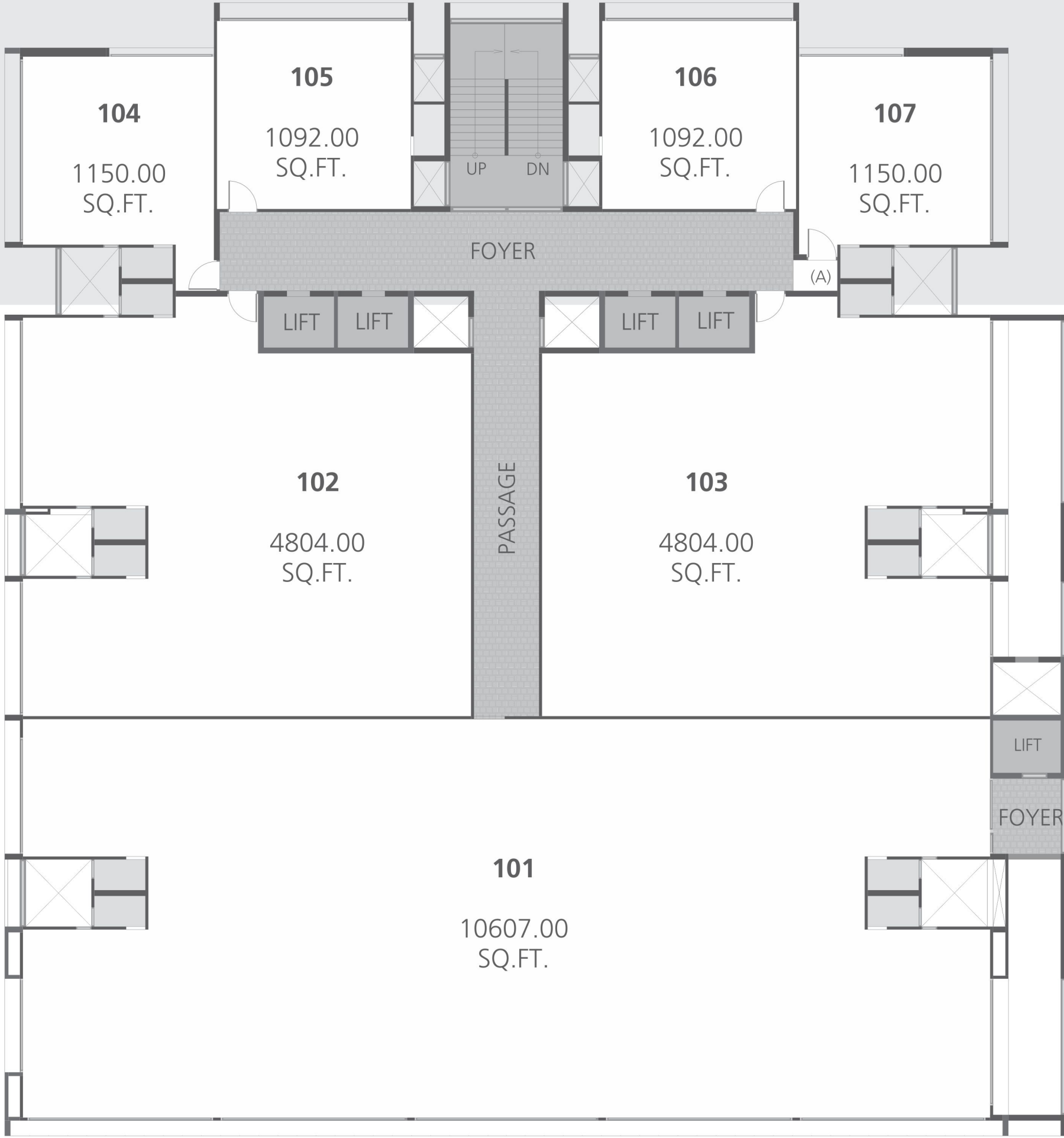

SECOND FLOOR PLAN

(A) SPACE INCLUDED IN AREA OF OFFICE NO - 207

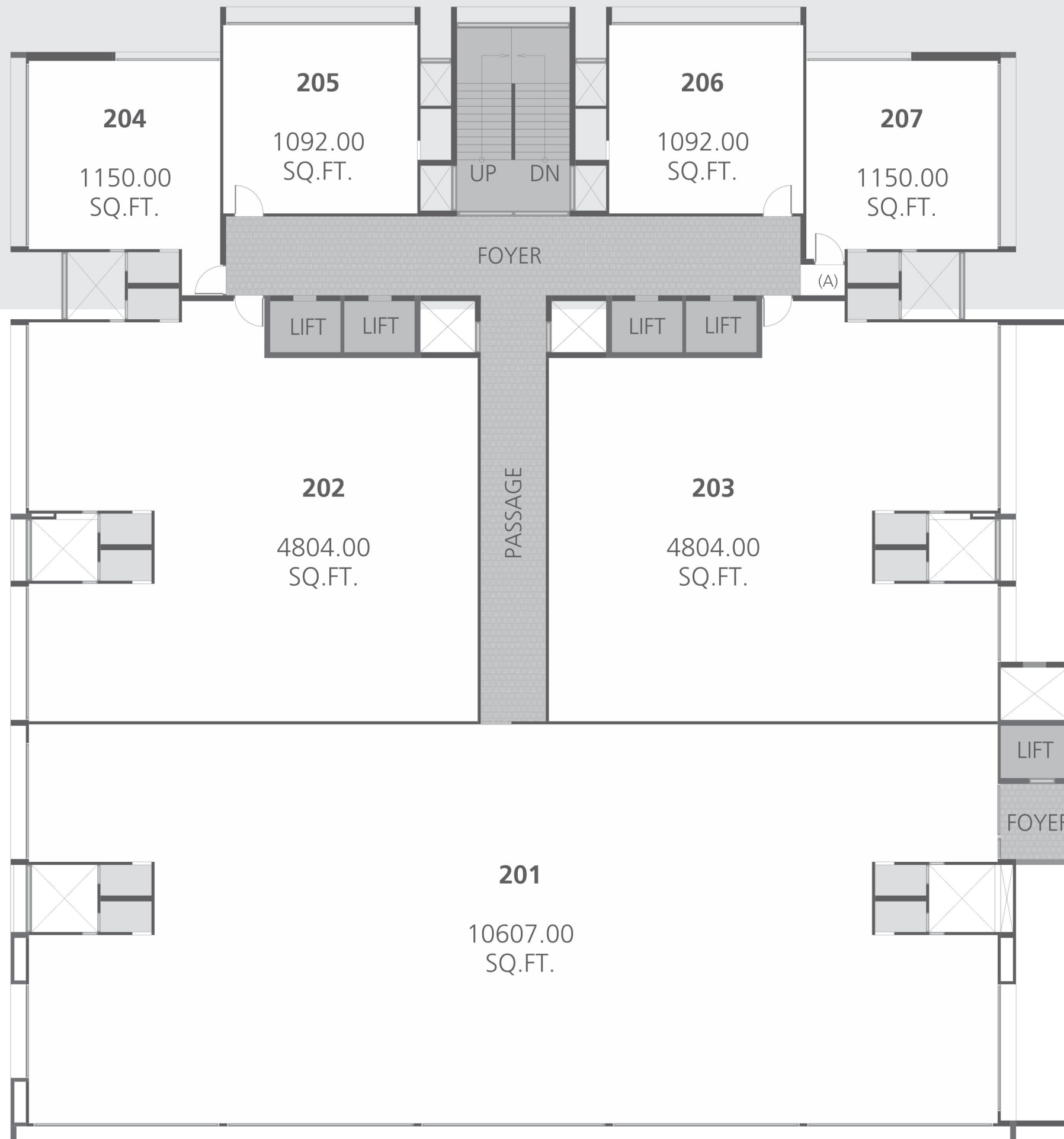

THIRD FLOOR PLAN

(A) SPACE INCLUDED IN AREA OF OFFICE NO - 307
(B) SPACE INCLUDED IN AREA OF OFFICE NO - 301

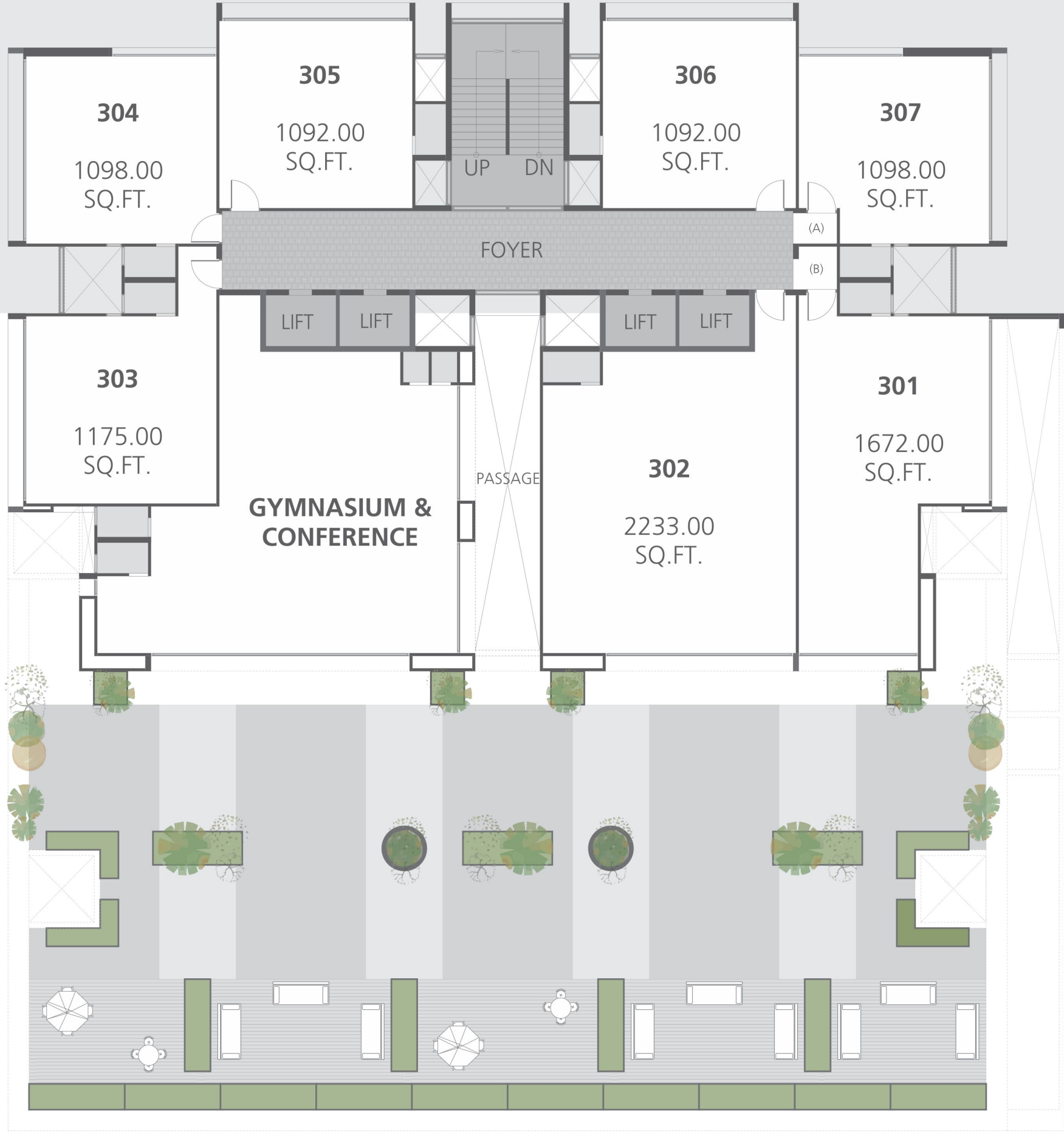

TYPICAL
FLOOR PLAN
(4TH TO 13TH FLOOR)

(A) SPACE INCLUDED IN AREA
OF OFFICE NO - 406

(B) SPACE INCLUDED IN AREA
OF OFFICE NO - 407

