

Adding Insulation to your Superior Walls Panels

Extra insulation may be added to your Superior Walls panels prior to installing drywall. While it may not be required, adding insulation could increase the energy efficiency of your walls. If you are attempting to limit your investment in additional insulation, please consider that you may achieve a greater return on your investment by increasing the insulation in any 'daylight' portions of the panels (sections of the wall that are above grade) then you would with adding insulation to portions that are below grade. However, adding insulation to the entire wall panel would achieve the greatest energy savings.

There are two closed-cell foam insulation methods that will consistently yield satisfactory results and reduce the likelihood of condensation forming within the wall cavity:

1. Spray-on 2-part polyurethane foam, and
2. Extruded or expanded polystyrene foam board.

Spray-on 2-part polyurethane foam can be applied with a do-it-yourself kit, but is typically applied professionally at the required depth to achieve your desired R-Value. Foam boards can be easily added to the wall cavities. Simply cut the board to fit snugly between the Superior Walls studs. An adhesive that will not attack foam insulation (such as Liquid Nails® Heavy Duty Construction Adhesive) can be used to secure the new foam board to the existing Dow Styrofoam™. Any gaps between the studs and new foam board should be sealed with a canned polyurethane-based spray insulation (such as Dow GREAT STUFF™).

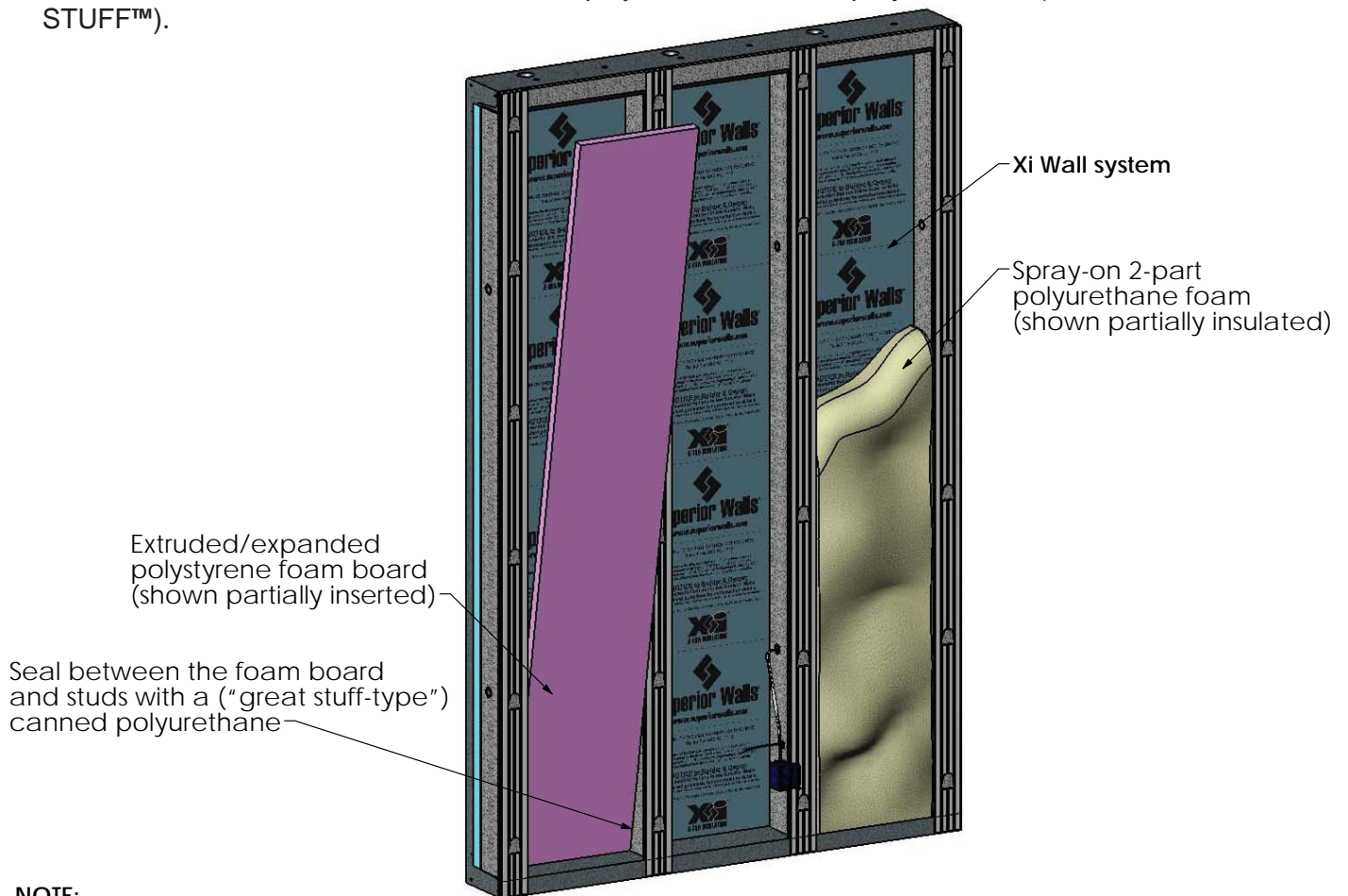

NOTE:

-No additional thermal barrier (drywall) is required UNLESS additional foam insulation has been added after the panel was manufactured. The building code may require that you cover the added insulation with a thermal barrier (drywall). See your local building code for details.

-Fiberglass batt, cellulose, Icynene®, or other materials may perform satisfactorily if the considerations noted in the "HOMEOWNERS GUIDE" section of the [Builder Guideline Booklet](#) are properly dealt with.

-This information is general in nature and may not be applicable in every situation. Your design professional (i.e. builder, architect, engineer, or supplier) can assist you in special conditions. When in doubt, please ask for guidance concerning your particular application.

**Xi Wall system shown R-5 similar.