

NAPLES TOWNE CENTRE SOUTH

3795 – 3895 Tamiami Trail E (US Hwy 41) | Naples, FL 34112



PROPERTY HIGHLIGHTS:

- Lucky's Market anchored center in growing East Naples market
- Ideal space available for restaurant, retail or medical
- High visibility from Tamiami Trail (US Hwy 41) a major thoroughfare in Naples
- Major shopping center renovations completed in 2012
- Explosive residential growth occurring in East Naples
- Collier County ranked in top 10 of nation's fastest growing metro areas
- Shopping center total GLA: 108,768 SF (MOL)

KEY DEMOS	1 MILE	3 MILES	5 MILES
POPULATION			
2017 Estimated Population	10,198	49,603	103,216
2017 Estimated Households	4,585	23,007	46,359
INCOME			
2017 Est. Avg HH Income	\$59,019	\$82,519	\$89,275
AGE			
Median Age	48	52	51
TRAFFIC COUNTS			
Tamiami Trail (US Hwy 41) N/S	42,000 AADT		

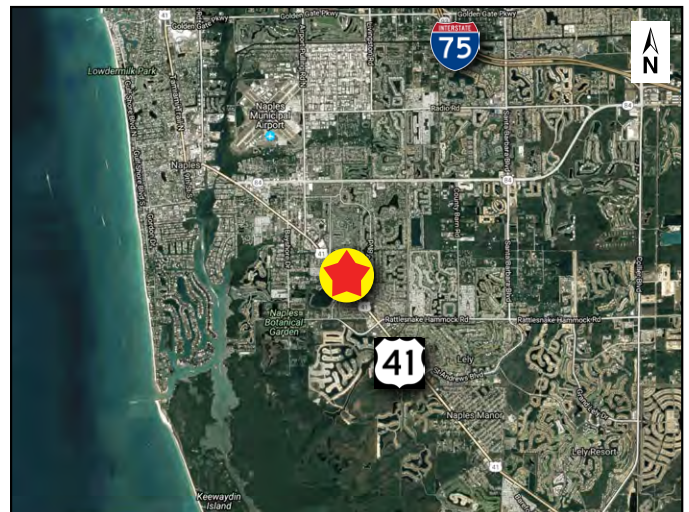

FOR LEASING INFORMATION

Luli Cannon
813.960.8154 x336
lcannon@rmcpg.com

8902 N Dale Mabry Hwy
Tampa, FL 33614
800.728.5379
www.RMCPG.com

NAPLES TOWNE CENTRE SOUTH

3795 – 3895 Tamiami Trail E (US Hwy 41) | Naples, FL 34112



UNIT	TENANT	SF
3795	RX Care Pharmacy	1,750
3801	Platinum Cleaners	2,000
3803	Check Cashing	1,250
3805	Cosmoprof	2,400
3807	JC Hair Design	800
3815	Lucky's Market	38,300
3823	AVAILABLE	1,521
3825	Long Nails	1,042

UNIT	TENANT	SF
3827	Liberty Tax	1,901
3829	AVAILABLE	1,488
3831	Aaron's	9,988
3841	Physical Therapy	2,900
3847	Gelato	1,200
3855	Towne Centre 6	18,995
3861	Peruvian Restaurant	850
3863	The Cleaning Authority	827

UNIT	TENANT	SF
3871	Rib City	4,200
3875	Affordable Pet Care	1,400
3877	Family Dentistry Naples	1,400
3879-81	AVAILABLE	3,150
3883	The Coupe Restaurant	4,760
3887-95	AutoZone	6,806

All information given herein is obtained from sources considered reliable. However, we are not responsible for misstatement of facts, errors, omissions, prior sale, withdrawal from market, modification of mortgage commitment, terms and considerations, or change in price without notice. The information supplied herein is for informational purposes only and shall not contain a warranty or assurance that said information is correct. Any person intending to rely upon the information supplied herein should verify said information independently. UPDATED: 051017



FOR LEASING INFORMATION

Luli Cannon
813.960.8154 x336
lcannon@rmcpg.com

8902 N Dale Mabry Hwy
Tampa, FL 33614
800.728.5379
www.RMCPG.com